

NOTE:  
A QUANTITY OF 500 SY OF AR152511  
SUBGRADE REPAIR HAS BEEN  
INCLUDED IN THE PROJECT TO BE USED  
AS NEEDED OR AS DESIGNATED BY THE  
RESIDENT ENGINEER.

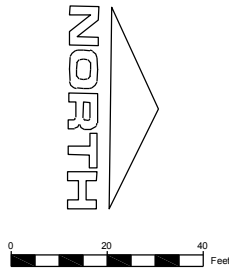

- LEGEND**
- PROPOSED LIMITS OF IMPROVEMENTS
  - PROPOSED 6" P.C.C. PAVEMENT (501)  
PROPOSED 6" CRUSHED AGGREGATE BASE COURSE (209)
  - PROPOSED 2" BITUMINOUS SURFACE COURSE OVERLAY (401)  
PROPOSED TACK COAT (603)
  - PROPOSED BUTT JOINT CONSTRUCTION (401)
  - PROPOSED 4" BITUMINOUS SURFACE COURSE (401)  
PROPOSED 6" CRUSHED AGGREGATE BASE COURSE (209)  
PROPOSED UNCLASSIFIED EXCAVATION (152)
  - PROPOSED CLASS E FENCE 4' (162)
  - TYPE A ISOLATION JOINT (3/4")
  - TYPE B HINGED (TIED) CONTRACTION JOINT
  - TYPE C DOWELED CONTRACTION JOINT
  - TYPE D DUMMY CONTRACTION JOINT
  - TYPE E DOWELED CONTRACTION JOINT
  - THICKENED EDGE

North Apron - West Edge  
STA. = 501+15.98  
OFF. = -148.79  
**CONTROL POINT #1  
SURVEY MONUMENT  
N: 1046546.540  
E: 2533418.600  
ELEV: 613.45'**

North Apron - West Edge  
STA. = 501+25.70  
OFF. = -37.00

North Apron - West Edge  
STA. = 502+00.46  
OFF. = -37.00

TURF RUNWAY 9L/27R

FILE: TAZ-4342-CP101.dwg  
UPDATE BY: Andrew Huebner  
PLOT DATE: 5/1/2014 9:38 AM

**TA006**

REVISIONS

NUMBER	BY	DATE

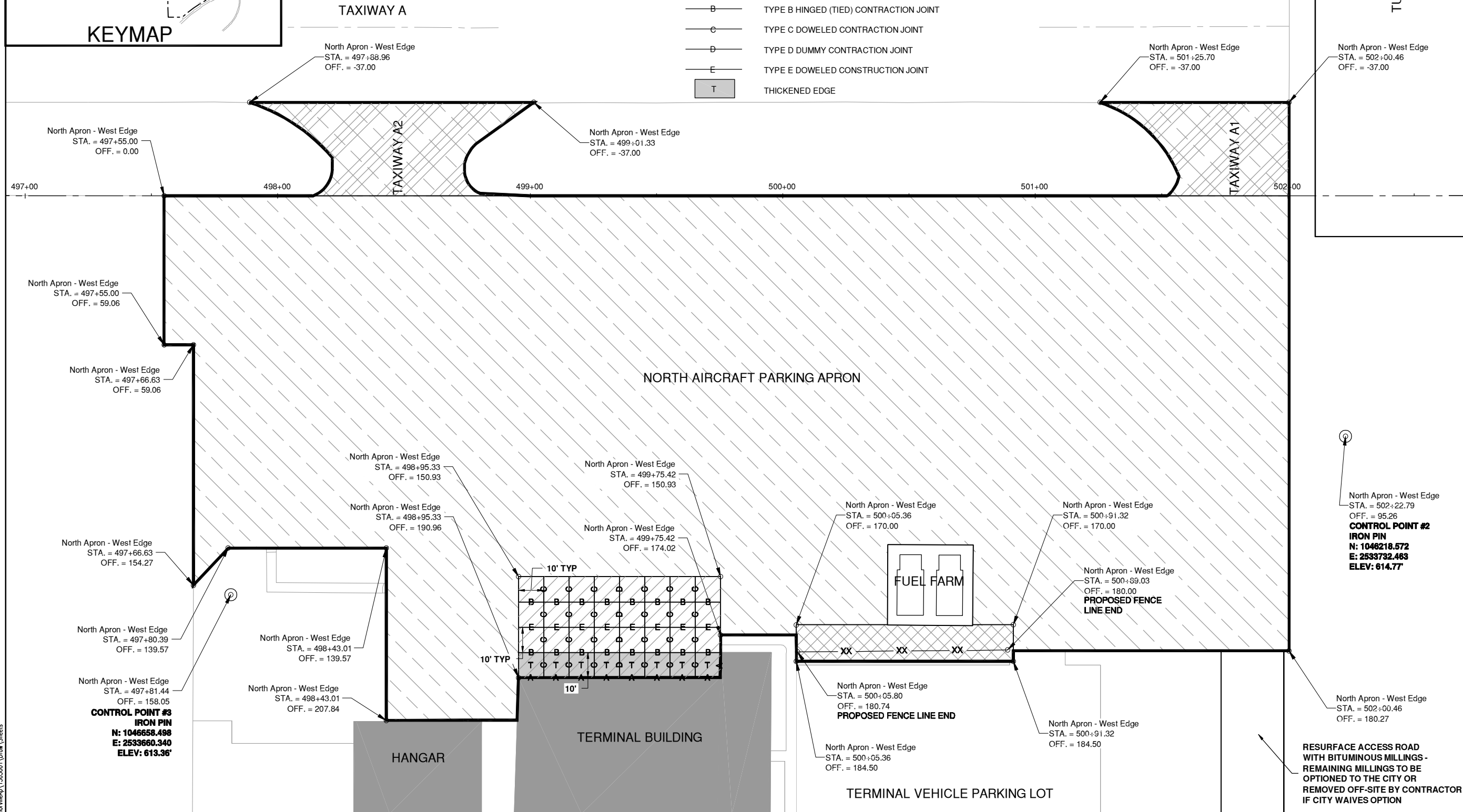
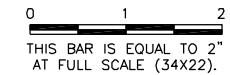

**TAYLORVILLE MUNICIPAL AIRPORT**  
**TAYLORVILLE, ILLINOIS**  
**REHABILITATE NORTH PORTION OF AIRCRAFT PARKING APRON**  
**PROPOSED IMPROVEMENTS**

© Copyright CMT, Inc.

**CMT**  
CRAWFORD, MURPHY & TULLY, INC.  
CONSULTING ENGINEERS  
License No. 184-000618

DESIGN BY:	AJH
DRAWN BY:	CMT
CHECKED BY:	CET
APPROVED BY:	CET
DATE:	APRIL 18, 2014
JOB No:	13050-01
IL PROJ. NO.	TAZ-4342
SBC NO.	3-17-SBGP-XX
SHEET	08 OF 14 SHEETS

K:\Taylorville\1305001\Draw\Sheets