

STATE OF ILLINOIS
DEPARTMENT OF TRANSPORTATION

F.A.I. RTE.	SECTION	COUNTY	TOTAL SHEETS	SHEET NO.
55	2024-1018-RS	COOK	19	1
		CONTRACT NO. 62X64		

FOR INDEX OF SHEETS, SEE SHEET NO. 2

THIS PROJECT IS LOCATED IN THE
VILLAGE OF BURR RIDGE

TRAFFIC DATA:

ADT = 6,200 VPD (2024)
SPEED LIMIT = 35 MPH (POSTED)

**PROPOSED
HIGHWAY PLANS**
FAI ROUTE 55 (I-55 NORTH FRONTAGE ROAD)
COUNTY LINE ROAD TO COMMONWEALTH DRIVE
SECTION 2024-1018-RS
SMART OVERLAY
COOK COUNTY
C-91-075-25

PROJECT BEGINS
STA 3 + 30

T 38 N

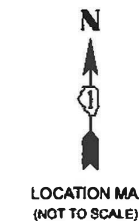
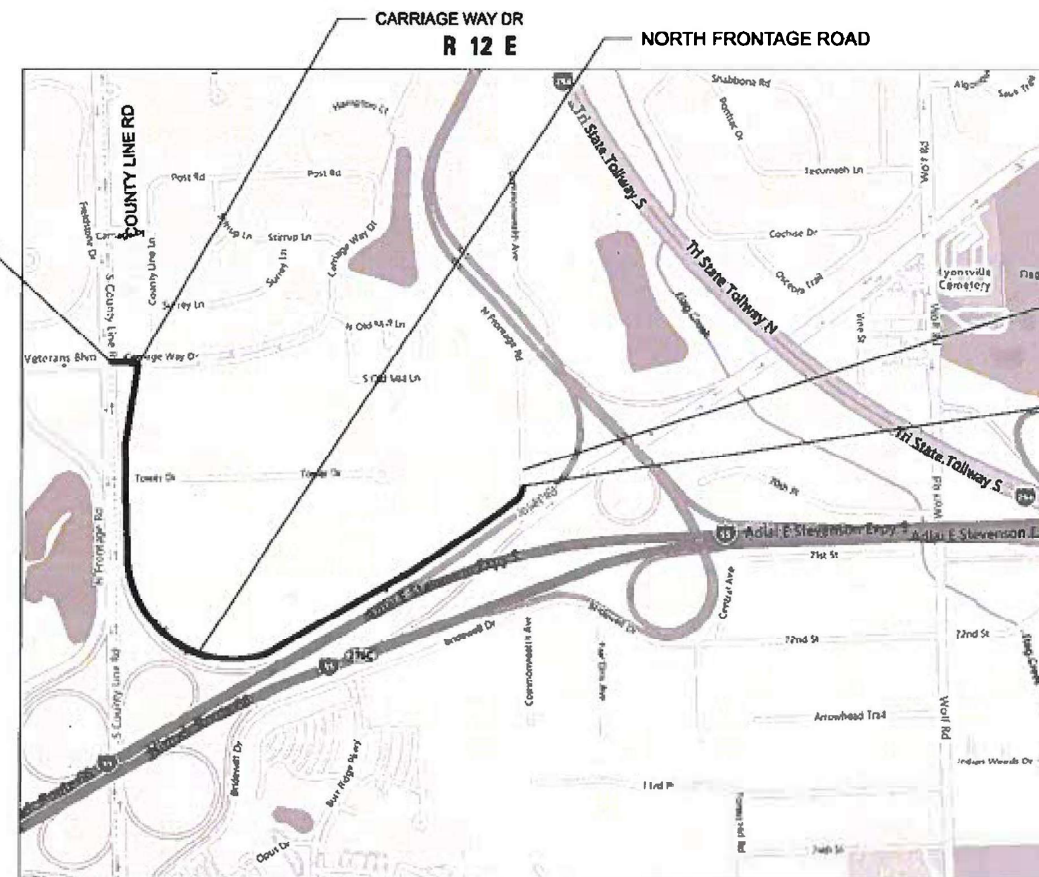

PROJECT ENDS
STA 49 + 32

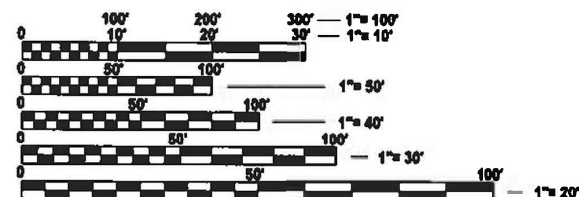

FULL SIZE PLANS HAVE BEEN PREPARED USING STANDARD
ENGINEERING SCALES. REDUCED SIZED PLANS WILL NOT
CONFORM TO STANDARD SCALES. IN MAKING MEASUREMENTS
ON REDUCED PLANS, THE ABOVE SCALES MAY BE USED.

J.U.L.I.E.
JOINT UTILITY LOCATION INFORMATION FOR EXCAVATION
1-800-892-0123
OR 811

PROJECT ENGINEER: VESELIN VELICHKOV (847) 705-4432
PROJECT MANAGER: VESELIN VELICHKOV

CONTRACT NO. 62X64

LYONS TOWNSHIP

GROSS LENGTH = 4,602 FT. = 0.872 MILE
NET LENGTH = 4,602 FT. = 0.872 MILE

STATE OF ILLINOIS
DEPARTMENT OF TRANSPORTATION

SUBMITTED March 26, 2025 IR

REGIONAL ENGINEER

May 9, 2025 Sec. A. E. Etk
ENGINEER OF DESIGN AND ENVIRONMENT

May 9, 2025 J. Barry
DIRECTOR OF HIGHWAYS PROJECT IMPLEMENTATION

**PRINTED BY THE AUTHORITY
OF THE STATE OF ILLINOIS**

INDEX OF SHEETS

SHEET NO.	DESCRIPTION
1	COVER SHEET
2	INDEX OF SHEETS, STATE STANDARDS & GENERAL NOTES
3-4	SUMMARY OF QUANTITIES
5-6	TYPICAL SECTIONS
7-8	ROADWAY AND PAVEMENT MARKING PLAN
9	DETECTOR LOOP REPLACEMENT PLAN
10	BD-01: DRIVEWAY DETAILS - DISTANCE BETWEEN R.O.W. AND FACE OF CURB OR EDGE OF SHOULDER GREATER THAN OR EQUAL TO 15' (4.5 M)
11	BD-22: PAVEMENT PATCHING FOR HMA SURFACED PAVEMENT
12	BD-24: CURB OR CURB AND GUTTER REMOVAL AND REPLACEMENT
13	BD-32: BUTT JOINT AND HMA TAPER DETAILS
14	TC-10: TRAFFIC CONTROL AND PROTECTION FOR SIDE ROADS, INTERSECTIONS AND DRIVEWAYS
15	TC-11: TYPICAL APPLICATIONS: RAISED REFLECTIVE PAVEMENT MARKERS (SNOW-PLOW RESISTANT)
16	TC-13: DISTRICT ONE TYPICAL PAVEMENT MARKINGS
17	TC-14: TRAFFIC CONTROL AND PROTECTION AT TURN BAYS (TO REMAIN OPEN TO TRAFFIC)
18	TC-16: PAVEMENT MARKING LETTERS AND SYMBOLS FOR TRAFFIC STAGING
19	TC-22: ARTERIAL ROAD INFORMATION SIGN

STATE STANDARDS

STANDARD NO.	DESCRIPTION
000001-08	STANDARD SYMBOLS, ABBREVIATIONS AND PATTERNS
442201-03	CLASS C AND D PATCHES
606001-08	CONCRETE CURB TYPE B AND COMBINATION CONCRETE CURB AND GUTTER
701001-02	OFF-ROAD MOVING OPERATIONS, 2L, 2W, MORE THAN 15' (4.5 m) AWAY
701006-05	OFF-ROAD MOVING OPERATIONS, 2L, 2W, 15' (4.5 m) TO 24" (600 mm) FROM PAVEMENT EDGE
701011-04	OFF-ROAD MOVING OPERATIONS, 2L, 2W, DAY ONLY
701301-04	LANE CLOSURE, 2L, 2W, SHORT TIME OPERATIONS
701311-03	LANE CLOSURE, 2L, 2W, MOVING OPERATIONS - DAY ONLY
701501-06	URBAN LANE CLOSURE, 2L, 2W, UNDIVIDED
701601-09	URBAN LANE CLOSURE, MULTILANE, 1W OR 2W WITH NONTRAVERSABLE MEDIAN
701701-10	URBAN LANE CLOSURE, MULTILANE INTERSECTION
701901-10	TRAFFIC CONTROL DEVICES
780001-05	TYPICAL PAVEMENT MARKINGS
886001-01	DETECTOR LOOP INSTALLATIONS
886006-01	TYPICAL LAYOUT FOR DETECTOR LOOPS

GENERAL NOTES

1. BEFORE STARTING ANY EXCAVATION, THE CONTRACTOR SHALL CALL "JULIE" AT (800) 892-0123 OR 811 FOR FIELD LOCATIONS OF BURIED ELECTRIC, TELEPHONE, AND GAS FACILITIES. (48 HOUR NOTIFICATION REQUIRED)
2. THE CONTRACTOR SHALL COORDINATE CONSTRUCTION ACTIVITIES WITH UTILITY COMPANIES AND THE VILLAGE OF BURR RIDGE.
3. THE CONTRACTOR WILL NOT BE ALLOWED TO SET UP A YARD OR FIELD OFFICE ON STATE PROPERTY WITHOUT THE WRITTEN PERMISSION OF THE DEPARTMENT.
4. THE CONTRACTOR SHALL CONTACT THE DISTRICT TRAFFIC CONTROL SUPERVISOR AT KALPANA.KANNAN-HOSADURGA@ILLINOIS.GOV A MINIMUM OF 72 HOURS IN ADVANCE OF BEGINNING WORK.
5. UNLESS OTHER CONDITIONS WARRANT EXTENDED LANE CLOSURE AS DETERMINED AND APPROVED IN WRITING BY THE RESIDENT ENGINEER OR AS PROVIDED FOR IN THE CONTRACT SPECIFICATIONS, OVERNIGHT CLOSURES SHALL NOT BE ALLOWED FOR REHABILITATION PROJECTS INVOLVING DAYTIME MILLING AND RESURFACING OPERATIONS AND CLASS D PATCHING.
6. BEFORE BEGINNING ANY WORK, THE CONTRACTOR SHALL RETAIN AND RECORD FOR FUTURE REFERENCE, ALL EXISTING PAVEMENT MARKING LINES (AND RAISED REFLECTIVE PAVEMENT MARKERS) IN ORDER THAT THESE LOCATIONS CAN BE RE-ESTABLISHED FOR STRIPING. EXACT LOCATIONS OF ALL PAVEMENT MARKINGS SHALL BE AS DIRECTED BY THE RESIDENT ENGINEER.
7. WHEN MILLED PAVEMENT IS OPEN TO TRAFFIC, THE MAXIMUM GRADE DIFFERENTIAL BETWEEN PASSES OF THE MILLING MACHINE SHALL NOT EXCEED 1½ INCHES WHERE THE SPEED LIMIT IS 45 MPH OR LESS, AND 1 INCH WHERE THE SPEED LIMIT IS OVER 45 MPH. WITH WRITTEN APPROVAL FROM THE RESIDENT ENGINEER, A MAXIMUM GRADE DIFFERENTIAL OF 3 INCHES MAY BE ALLOWED IF THE EDGE OF THE MILLING IS SLOPED A MINIMUM OF 1V:3H.
8. ANY LOOSE MATERIAL DEPOSITED IN THE FLOW LINE OF CURB OR DRAINAGE STRUCTURES, WHICH OBSTRUCTS THE NATURAL FLOW OF WATER, SHALL BE REMOVED AT THE CLOSE OF EACH WORKING DAY. PRIOR TO ACCEPTANCE OF THE IMPROVEMENT, ALL DRAINAGE STRUCTURES SHALL BE FREE OF DIRT AND DEBRIS. THIS WORK WILL NOT BE PAID FOR SEPARATELY BUT SHALL BE CONSIDERED AS INCIDENTAL.
9. EXISTING BROKEN FRAMES AND LIDS SHALL BE REMOVED AND DISPOSED OF BY THE CONTRACTOR AND SHALL BE REPLACED AS DIRECTED BY THE ENGINEER. REPLACEMENT FRAMES AND LIDS WILL BE PAID FOR ACCORDING TO ARTICLE 109.04 OF THE STANDARD SPECIFICATIONS, UNLESS A SEPARATE PAY ITEM HAS BEEN PROVIDED.
10. BUTT JOINTS WILL BE INSTALLED AT THE ENDS OF RESURFACING (WHERE RESURFACING MEETS EXISTING PAVEMENT) IN ACCORDANCE WITH THE "BUTT JOINT AND HMA TAPER DETAILS" SHEET INCLUDED IN THE PLANS, UNLESS OTHERWISE SPECIFIED.
11. FRAMES AND GRATES ADJUSTMENT OF PRIVATE UTILITIES WITHIN THE LIMITS OF THE IMPROVEMENTS SHALL BE DONE BY THEIR RESPECTIVE OWNERS AND ARE NOT PART OF THIS CONTRACT.
12. THE RESIDENT ENGINEER SHALL CONTACT ABDULLA, AREA TRAFFIC FIELD ENGINEER, VIA E-MAIL AT ABDULLA.ALI@ILLINOIS.GOV, A MINIMUM OF 2 WEEKS PRIOR TO PLACEMENT OF PERMANENT PAVEMENT MARKINGS.
13. ANY DAMAGE TO EXISTING PAVEMENT MARKINGS OR RAISED REFLECTIVE PAVEMENT MARKERS OUTSIDE THE REMOVAL LINE SHOWN ON THE PLANS SHALL BE REPLACED AT NO ADDITIONAL COST TO THE DEPARTMENT.
14. PAVEMENT PATCHING LOCATIONS ARE SHOWN ON THE CONTRACT AND WILL ALSO BE DETERMINED IN THE FIELD BY THE RESIDENT ENGINEER/TECHNICIAN.
15. ALL PAVEMENT MARKINGS SHALL BE PLACED THROUGHOUT THE IMPROVEMENT ACCORDING TO DISTRICT ONE TYPICAL PAVEMENT MARKING.
16. LOCATION OF COMBINATION CONCRETE CURB AND GUTTER REMOVAL AND REPLACEMENT [OR COMBINATION CURB AND GUTTER (THE TYPE SPECIFIED ON THE PLANS)], WILL BE DETERMINED IN THE FIELD BY THE RESIDENT ENGINEER/TECHNICIAN.
17. IT SHALL BE THE CONTRACTOR'S RESPONSIBILITY TO VERIFY ALL DIMENSIONS AND CONDITIONS EXISTING IN THE FIELD PRIOR TO CONSTRUCTION AND ORDERING OF MATERIALS.

GENERAL NOTES CONTINUED.

18. ALL MILLED SURFACES SHALL BE AT UNIFORM CROSS SLOPE PER LANE AND FREE OF RIDGES BETWEEN PASSES. ANY DEVIATIONS SHALL BE CORRECTED AT NO COST TO THE DEPARTMENT.
19. DO NOT SCALE PLANS FOR CONSTRUCTION DIMENSIONS.
20. THE "ROAD CONSTRUCTION AHEAD" SIGNS SHALL REMAIN INSTALLED UNTIL THE COMPLETION OF THE PROJECT OR WHEN NO ROADWAY HAZARDS REMAIN WITHIN THE WORK ZONE.
21. OVERNIGHT LANE CLOSURES SHALL NOT BE ALLOWED FOR REHABILITATION PROJECTS INVOLVING DAYTIME MILLING AND RESURFACING OPERATIONS AND CLASS D PATCHING UNLESS OTHER CONDITIONS WARRANT EXTENDED LANE CLOSURES AS DETERMINED AND APPROVED IN WRITING BY THE ENGINEER OR AS PROVIDED FOR IN THE CONTRACT SPECIFICATIONS.

STATE OF ILLINOIS
DEPARTMENT OF TRANSPORTATION

GENERAL NOTES
I-55 N. FRONTAGE RD (COUNTY LINE RD TO COMMONWEALTH DR)

SCALE: SHEET OF 1 SHEETS STA. TO STA.

FAI RTE	SECTION	COUNTY	TOTAL SHEETS	SHEET NO.
55	2024-1018-RS	COOK	19	2
CONTRACT NO. 62X64				
ILLINOIS FED. AID PROJECT				

MODEL: SOQ01 [Sheet]
FILE NAME: c:\p_k_work\pw\td\shiranisb\035062\0105625-sh-SOQ.dgn

SUMMARY OF QUANTITIES			TOTAL QUANTITIES	CONSTRUCTION TYPE CODE						SUMMARY OF QUANTITIES			TOTAL QUANTITIES	CONSTRUCTION TYPE CODE					
CODE NO	ITEM	UNIT		0005 100% STATE						CODE NO	ITEM	UNIT		0005 100% STATE					
20200100	EARTH EXCAVATION	CU YD	70	70						44201741	CLASS D PATCHES, TYPE II, 8 INCH	SQ YD	200	200					
21101615	TOPSOIL FURNISH AND PLACE, 4"	SQ YD	58	58						44201745	CLASS D PATCHES, TYPE III, 8 INCH	SQ YD	100	100					
25200110	SODDING, SALT TOLERANT	SQ YD	58	58						44201747	CLASS D PATCHES, TYPE IV, 8 INCH	SQ YD	1000	1000					
25200200	SUPPLEMENTAL WATERING	UNIT	2	2						48102100	AGGREGATE WEDGE SHOULDER, TYPE B	TON	93	93					
35501308	HOT-MIX ASPHALT BASE COURSE, 6"	SQ YD	10	10						✱ 66900200	NON-SPECIAL WASTE DISPOSAL	CU YD	70	70					
35501316	HOT-MIX ASPHALT BASE COURSE, 8"	SQ YD	24	24						✱ 66900530	SOIL DIPOSAL ANALYSIS	EACH	5	5					
40600290	BITUMINOUS MATERIALS (TACK COAT)	POUND	4983	4983						✱ 66901001	REGULATED SUBSTANCES PRE-CONSTRUCTION PLAN	L SUM	1	1					
40600370	LONGITUDINAL JOINT SEALANT	FOOT	4602	4602						✱ 66901003	REGULATED SUBSTANCES FINAL CONSTRUCTION REPORT	L SUM	1	1					
40600400	MIXTURE FOR CRACKS, JOINTS, AND	TON	17	17						✱ 66901006	REGULATED SUBSTANCES MONITORING	CAL DA	10	10					
	FLANGEWAYS																		
										67100100	MOBILIZATION	LSUM	1	1					
40600982	HOT-MIX ASPHALT SURFACE REMOVAL - BUTT JOINT	SQ YD	20	20															
										70102620	TRAFFIC CONTROL AND PROTECTION,	LSUM	1	1					
40604060	HOT-MIX ASPHALT SURFACE COURSE, IL-9.5, MIX "D", N50	TON	4	4							STANDARD 701501								
40604062	HOT-MIX ASPHALT SURFACE COURSE, IL-9.5, MIX "D", N70	TON	931	931						70102630	TRAFFIC CONTROL AND PROTECTION,	LSUM	1	1					
											STANDARD 701601								
42300400	PORTLAND CEMENT CONCRETE DRIVEWAY	SQ YD	150	150															
	PAVEMENT, 8 INCH									70102635	TRAFFIC CONTROL AND PROTECTION,	LSUM	1	1					
											STANDARD 701701								
44000155	HOT-MIX ASPHALT SURFACE REMOVAL, 1 1/2"	SQ YD	11073	11073															
										70300100	SHORT TERM PAVEMENT MARKING	FOOT	3163	3163					
44000200	DRIVEWAY PAVEMENT REMOVAL	SQ YD	42	42															✱ = SPECIALTY ITEMS
		USER NAME = Sarah,Shirani	DESIGNED -	REVISED -	STATE OF ILLINOIS DEPARTMENT OF TRANSPORTATION					I-55 N. FRONTAGE RD (COUNTY LINE RD TO COMMONWEALTH DR) SUMMARY OF QUANTITIES				F.A.I RTE.	SECTION		COUNTY	TOTAL SHEETS	SHEET NO.
		PLOT SCALE = \$SCALE\$	DRAWN -	REVISED -										55	2024-1018-RS		COOK	19	3
		PLOT DATE = 3/31/2025	CHECKED -	REVISED -										CONTRACT NO. 62X64					
			DATE -	REVISED -										ILLINOIS FED. AID PROJECT					

* = SPECIALTY ITEMS

SUMMARY OF QUANTITIES				TOTAL QUANTITIES	CONSTRUCTION TYPE CODE					SUMMARY OF QUANTITIES				TOTAL QUANTITIES	CONSTRUCTION TYPE CODE						
CODE NO	ITEM	UNIT	0005 100% STATE							CODE NO	ITEM	UNIT	0005 100% STATE								
70300150	SHORT TERM PAVEMENT MARKING REMOVAL	SQ FT	1053	1053						X4400501	COMBINATION CURB AND GUTTER REMOVAL AND	FOOT	150	150							
											REPLACEMENT LESS THAN OR EQUAL TO 10 FEET										
70300211	TEMPORARY PAVEMENT MARKING LETTERS AND	SQ FT	64	64																	
	SYMBOLS - PAINT									X4400503	COMBINATION CURB AND GUTTER REMOVAL AND	FOOT	450	450							
											REPLACEMENT GREATER THAN 10 FEET										
70300221	TEMPORARY PAVEMENT MARKING - LINE 4" - PAINT	FOOT	18408	18408																	
										X6700407	ENGINEER'S FIELD OFFICE, TYPE A (D1)	CAL MO	12	12							
70300241	TEMPORARY PAVEMENT MARKING - LINE 6" - PAINT	FOOT	40	40																	
										* X8860105	DETECTOR LOOP REPLACEMENT	FOOT	66	66							
70300281	TEMPORARY PAVEMENT MARKING - LINE 24" - PAINT	FOOT	10	10																	
										X7200061	TEMPORARY INFORMATION SIGNING	SQ FT	77.1	77.1							
70307120	TEMPORARY PAVEMENT MARKING - LINE 4" - TYPE IV TAPE	FOOT	1053	1053																	
* 78000100	THERMOPLASTIC PAVEMENT MARKING -	SQ FT	64	64																	
	LETTERS AND SYMBOLS																				
* 78000200	THERMOPLASTIC PAVEMENT MARKING - LINE	FOOT	18408	18408																	
	4"																				
* 78000400	THERMOPLASTIC PAVEMENT MARKING - LINE	FOOT	40	40																	
	6"																				
* 78000650	THERMOPLASTIC PAVEMENT MARKING - LINE	FOOT	10	10																	
	24"																				
* 78100100	RAISED REFLECTIVE PAVEMENT MARKER	EACH	114	114																	
78300200	RAISED REFLECTIVE PAVEMENT MARKER	EACH	90	90																	
	REMOVAL																				
Z0013798	CONSTRUCTION LAYOUT	L SUM	1	1																	
X2020110	GRADING AND SHAPING SHOULDERS	UNIT	47	47													* = SPECIALTY ITEMS				
		USER NAME = Sarah.Shirani		DESIGNED -		REVISED -		STATE OF ILLINOIS DEPARTMENT OF TRANSPORTATION			I-55 N. FRONTAGE RD (COUNTY LINE RD TO COMMONWEALTH DR) SUMMARY OF QUANTITIES			F.A.I RTE.		SECTION		COUNTY	TOTAL SHEETS	SHEET NO.	
				DRAWN -		REVISED -								55		2024-1018-RS		COOK		19	4
		PLOT SCALE = \$SCALE\$		CHECKED -		REVISED -								CONTRACT NO. 62X64							
		PLOT DATE = 3/31/2025		DATE -		REVISED -								SCALE:		SHEET	OF 2	SHEETS	STA.	TO STA.	ILLINOIS FED. AID PROJECT

MODEL: SQ002 [Sheet]
FILE NAME: c:\p\work\widetoh\htranisb\035062\0105625-4ht-SQ0.dgn

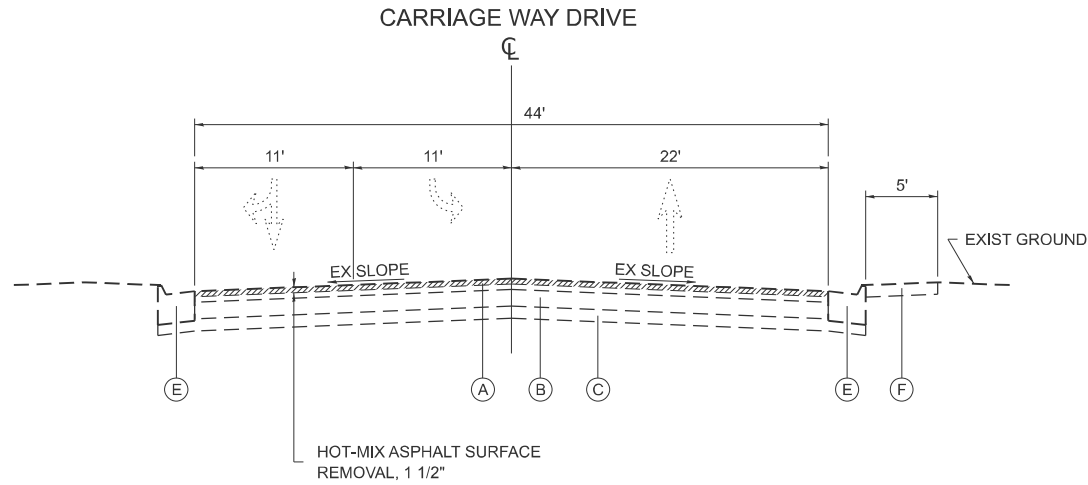

EXISTING TYPICAL SECTION

STA 3+30 TO STA 4+34

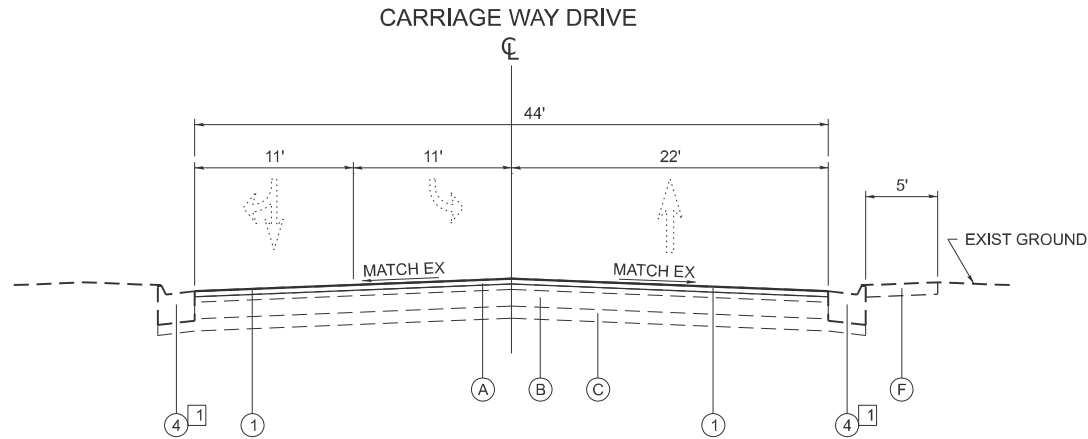

PROPOSED TYPICAL SECTION

STA 3+30 TO STA 4+34

1= LOCATIONS OF COMBINATION CONCRETE CURB AND GUTTER REMOVAL AND REPLACEMENT (OR COMBINATION CURB AND GUTTER (THE TYPE SPECIFIED ON THE PLANS)), WILL BE DETERMINED IN THE FIELD BY THE RESIDENT ENGINEER/TECHNICIAN.

HOT-MIX ASPHALT MIXTURE REQUIREMENTS		QUALITY MANAGEMENT PROGRAM (QMP)
MIXTURE TYPE	AIR VOIDS @ Ndes	
PAVEMENT RESURFACING		
HOT-MIX ASPHALT SURFACE COURSE, MIX "D", IL-9.5, N70, 1 1/2"	4% @ 70 GYR.	QC/QA
DRIVEWAYS		
HMA SURFACE COURSE, MIX "D", IL-9.5, N50; 2"	4% @ 50 GYR.	QC/QA
HMA BASE COURSE (HMA BINDER IL-19.0); PE -6", CE - 8"	4% @ 50 GYR.	QC/QA
PATCHING		
CLASS D PATCHES (HMA BINDER IL-19), 8"	4% @ 70 GYR.	QC/QA
QMP DESIGNATION: QUALITY CONTROL/QUALITY ASSURANCE (QC/QA); QUALITY CONTROL FOR PERFORMANCE (QCP)		

NOTE 1: THE UNIT WEIGHT USED TO CALCULATE ALL HMA SURFACE MIXTURE QUANTITIES IS 112 LBS/SQ YD/IN.

NOTE 2: THE "AC TYPE" FOR POLYMERIZED HMA MIXES SHALL BE "SBS/SBR PG 76-22" AND FOR NON-POLYMERIZED HMA THE "AC TYPE" SHALL BE "PG 64-22" UNLESS MODIFIED BY RECLAIMED MATERIALS SPECIFICATIONS.

LEGEND - EXISTING:

- A HMA SURFACE, (+/-) 4¼"
- B GRAVEL OR CRUSHED STONE BASE COURSE, 7"
- C SUB- BASE GRANULAR MATERIAL, 4"
- D EARTH SHOULDER
- E COMBINATION CONCRETE CURB & GUTTER, TYPE M-4.12
- F PCC SIDEWALK

LEGEND - PROPOSED:

- 1 HOT-MIX ASPHALT SURFACE COURSE, MIX "D", IL-9.5, N70, 1½"
- 2 GRADING AND SHAPING SHOULDERS
- 3 AGGREGATE SHOULDERS, TYPE B
- 4 COMBINATION CONCRETE CURB AND GUTTER REMOVAL AND REPLACEMENT

NOTE:

THE CONTRACTOR SHALL PATCH FIRST BEFORE MILLING.

LONGITUDINAL JOINT SEALANT SHALL BE PLACED OVER THE MILLED SURFACE.

MODEL: Typical Sections 1 [Sheet]
FILE NAME: c:\p\work\p\shirani\sd1035062\D105625-sh-typical.dgn

	USER NAME = Sarah,Shirani	DESIGNED -	REVISED -	STATE OF ILLINOIS DEPARTMENT OF TRANSPORTATION	I-55 N. FRONTAGE RD (COUNTY LINE RD TO COMMONWEALTH DR) EXISTING AND PROPOSED TYPICAL SECTIONS	SCALE:	SHEET 1 OF 2 SHEETS	STA.	TO STA.	F.A.I RTE.	SECTION	COUNTY	TOTAL SHEETS	SHEET NO.
		DRAWN -	REVISED -							55	2024-1018-RS	COOK	19	5
		CHECKED -	REVISED -							CONTRACT NO. 62X64				
	PLOT DATE = 3/28/2025	DATE -	REVISED -							ILLINOIS FED. AID PROJECT				

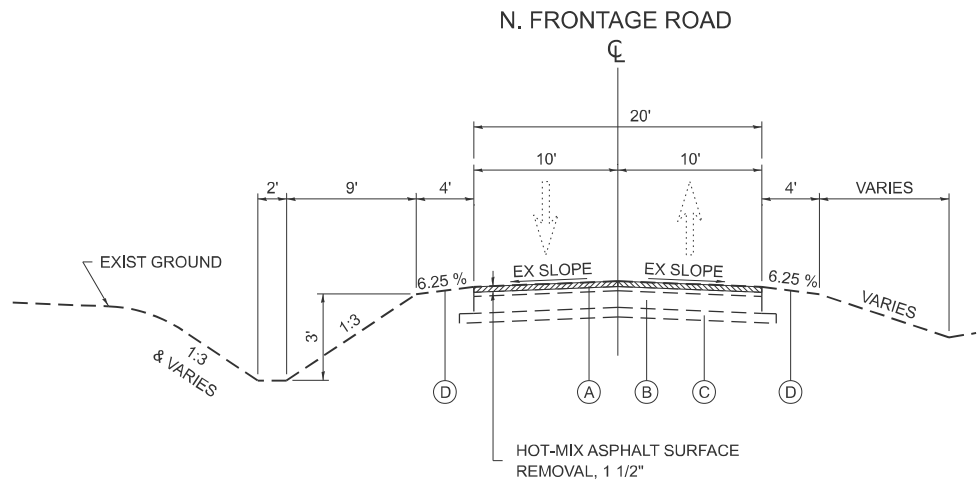

EXISTING TYPICAL SECTION

STA 4+34 TO STA 12+20
STA 17+21 TO STA 49+32

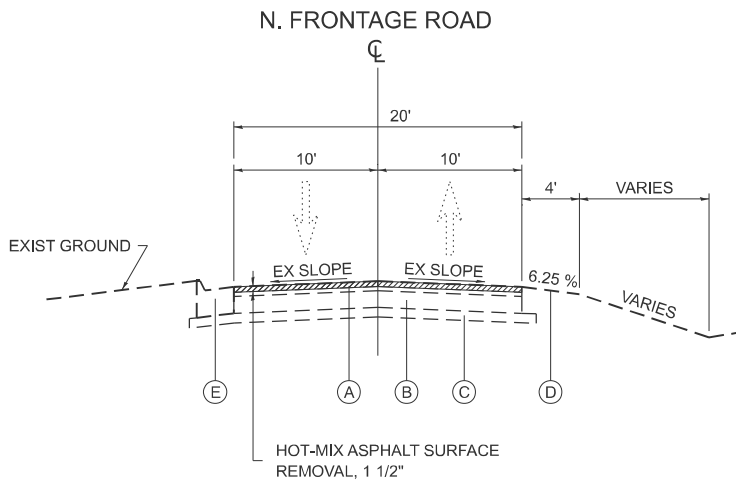

EXISTING TYPICAL SECTION

STA 12+20 TO STA 17+21

LEGEND - EXISTING:

- (A) HMA SURFACE, (+/-) 4 1/4"
- (B) GRAVEL OR CRUSHED STONE BASE COURSE, 7"
- (C) SUB- BASE GRANULAR MATERIAL, 4"
- (D) EARTH SHOULDER
- (E) COMBINATION CONCRETE CURB & GUTTER, TYPE M-4.12
- (F) PCC SIDEWALK

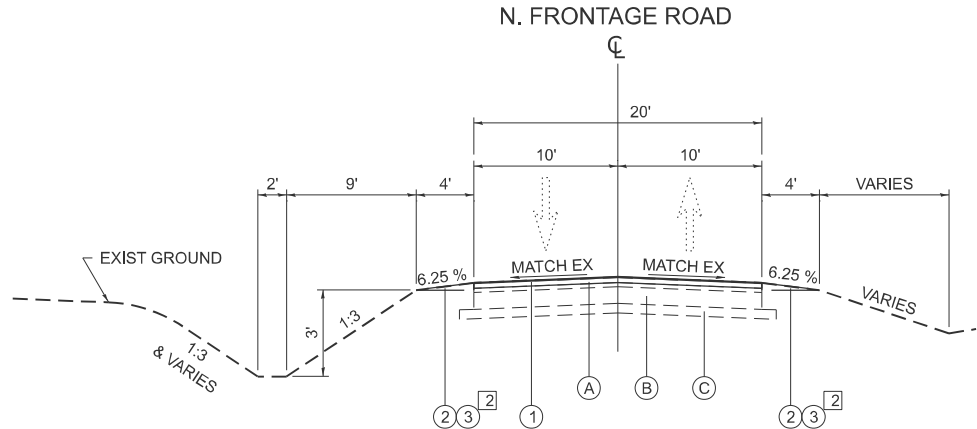

PROPOSED TYPICAL SECTION

STA 4+34 TO STA 12+20
STA 17+21 TO STA 49+32

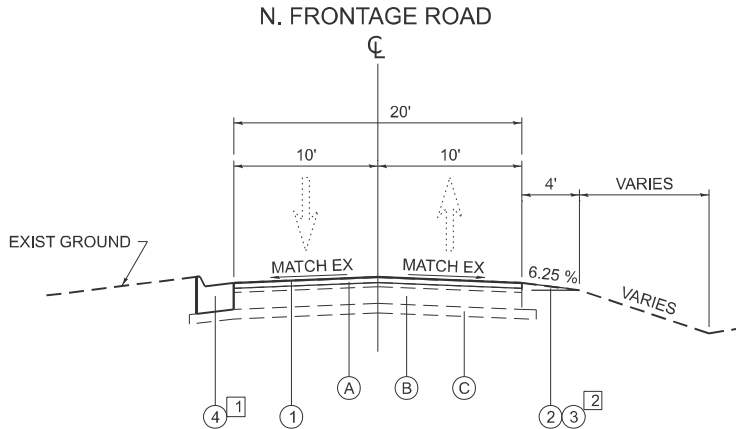

PROPOSED TYPICAL SECTION

STA 12+20 TO STA 17+21

NOTE:

THE CONTRACTOR SHALL PATCH FIRST BEFORE MILLING.
LONGITUDINAL JOINT SEALANT SHALL BE PLACED OVER THE MILLED SURFACE.

- [1]= LOCATIONS OF COMBINATION CONCRETE CURB AND GUTTER REMOVAL AND REPLACEMENT [OR COMBINATION CURB AND GUTTER (THE TYPE SPECIFIED ON THE PLANS)]. WILL BE DETERMINED IN THE FIELD BY THE RESIDENT ENGINEER/TECHNICIAN.
- [2]= LOCATIONS OF GRADING AND SHAPING SHOULDERS AND AGGREGATE SHOULDER, TYPE B WILL BE DETERMINED IN THE FIELD BY THE RESIDENT ENGINEER/TECHNICIAN.

MODEL: Typical Sections 2 [Sheet]
FILE NAME: c:\p\work\shirani\shirani\1035062\1035062-sh-typical.dgn

	USER NAME = Sarah,Shirani	DESIGNED -	REVISED -	STATE OF ILLINOIS DEPARTMENT OF TRANSPORTATION	I-55 N. FRONTAGE RD (COUNTY LINE RD TO COMMONWEALTH DR) EXISTING AND PROPOSED TYPICAL SECTIONS	SCALE:	SHEET 2 OF 2 SHEETS	STA.	TO STA.	F.A.I RTE.	SECTION	COUNTY	TOTAL SHEETS	SHEET NO.
		DRAWN -	REVISED -							55	2024-1018-RS	COOK	19	6
		CHECKED -	REVISED -							CONTRACT NO. 62X64				
	PLOT DATE = 3/28/2025	DATE -	REVISED -							ILLINOIS FED. AID PROJECT				

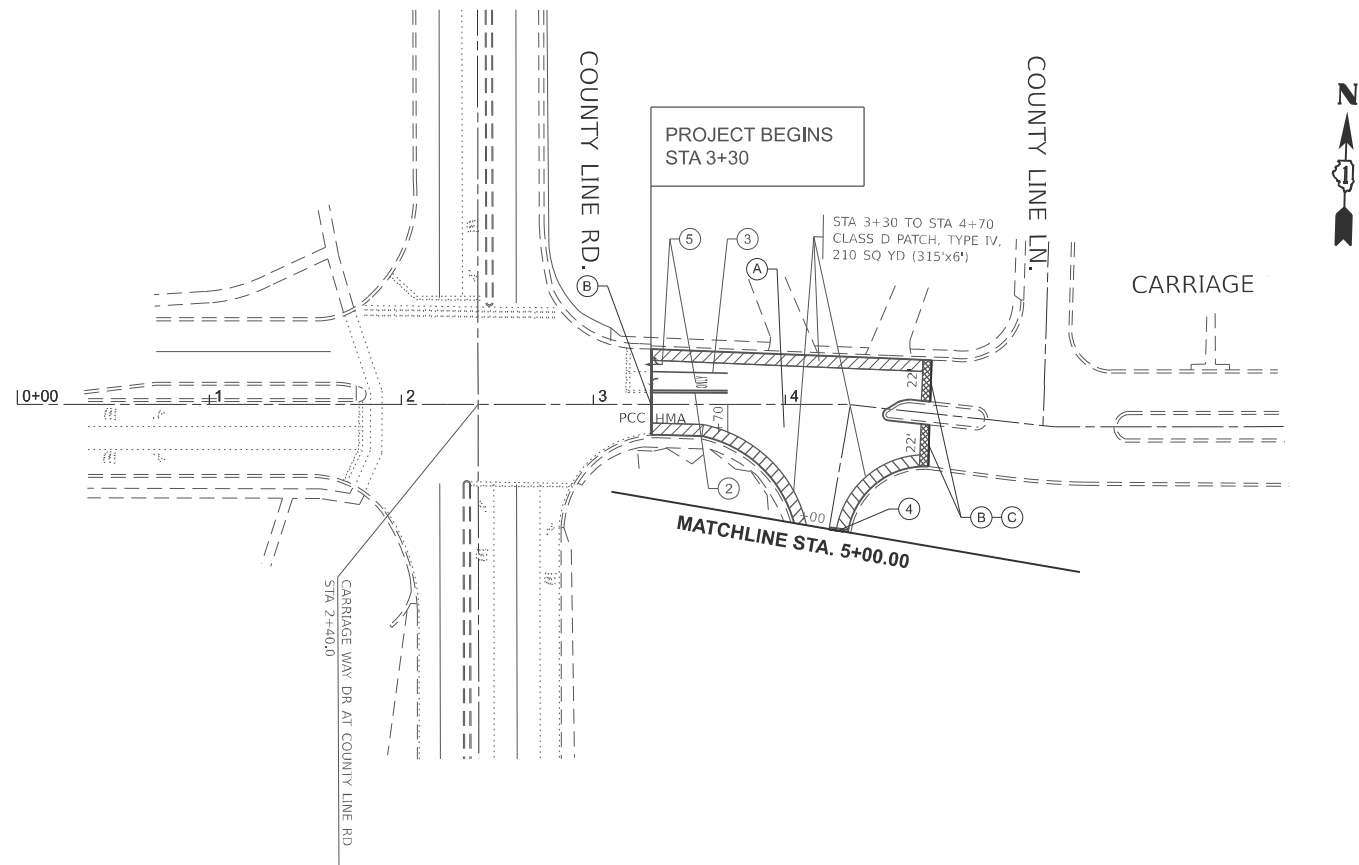

PROPOSED ROADWAY WORK	PROPOSED THERMOPLASTIC PAVEMENT MARKING
(A) PROP. HMA SURFACE REMOVAL 1 1/2"	(1) 4" SOLID WHITE EDGE LINE (TYP.)
(B) PROP. HMA SURF REM BUTT JOINT	(2) 4" DOUBLE SOLID YELLOW LINE, 2 @ 11' C-C (TYP.)
(C) LIMIT OF RESURFACING	(3) 6" SOLID WHITE TURN LANE LINE (TYP.)
	(4) 24" SOLID WHITE STOP LINE (TYP.)
	(5) 24" SOLID WHITE LETTERS & SYMBOLS (TYP.)
	INSTALL FINAL PAVEMENT MARKINGS AND RAISED REFLECTIVE MARKERS PER DISTRICT DETAIL TC-11 AND TC-13.

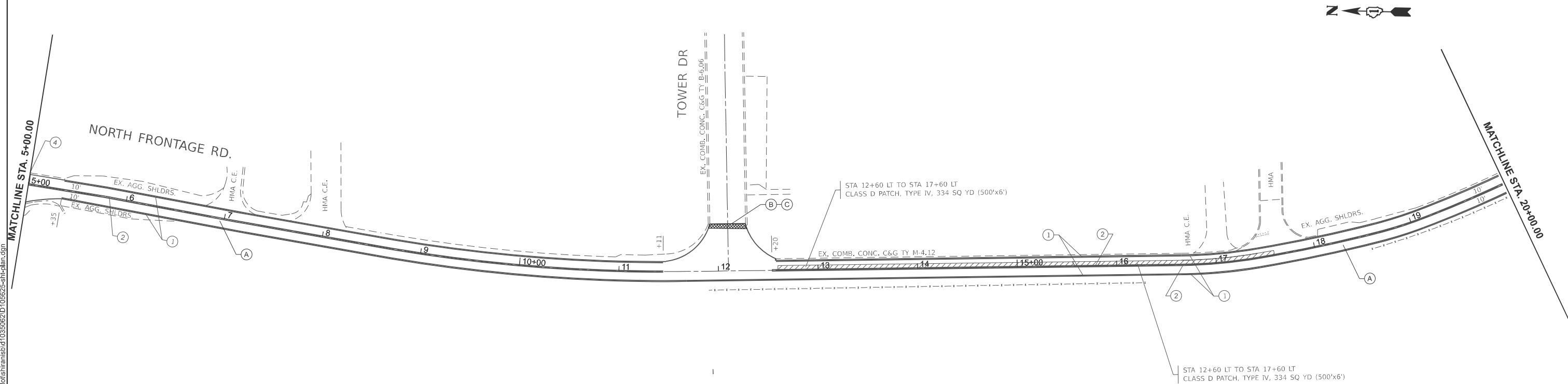

MODEL: EXCL - Plan 1 (Sheet)
FILE NAME: c:\p\work\p\work\shirani\1035062\1035062-shr-plan.dgn

USER NAME	= Sarah,Shirani	DESIGNED	-	REVISED	-
		DRAWN	-	REVISED	-
		CHECKED	-	REVISED	-
PLOT DATE	= 3/28/2025	DATE	-	REVISED	-

STATE OF ILLINOIS
DEPARTMENT OF TRANSPORTATION

I-55 N. FRONTAGE RD (COUNTY LINE RD TO COMMONWEALTH DR)
ROADWAY AND PAVEMENT MARKING PLAN

SCALE: 1"=50' SHEET 1 OF 3 SHEETS STA. 10+00.00 TO STA. 30+00.00

F.A.I RTE.	SECTION	COUNTY	TOTAL SHEETS	SHEET NO.
55	2024-1018-RS	COOK	19	7
CONTRACT NO. 62X64				
ILLINOIS FED. AID PROJECT				

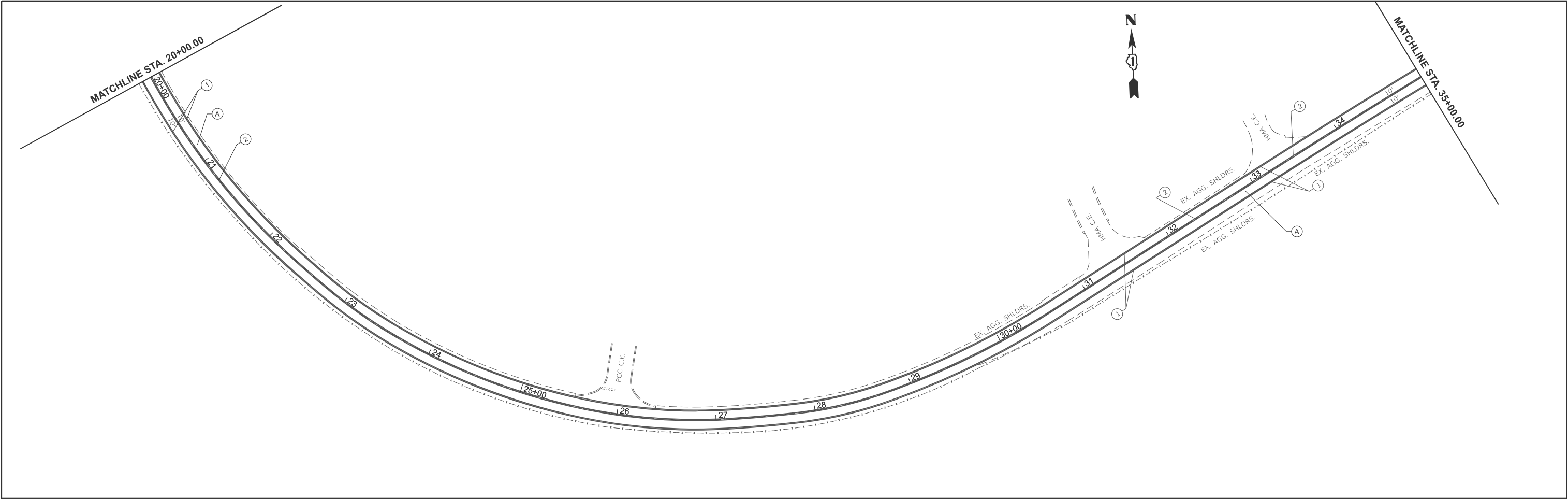

PROPOSED ROADWAY WORK	PROPOSED THERMOPLASTIC PAVEMENT MARKING
<div><div>1</div><div>PROP. HMA SURFACE REMOVAL 1 1/2"</div></div> <div><div>2</div><div>PROP. HMA SURFACE COURSE, MIX "D", IL-9.5, N70, 1 1/2"</div></div> <div><div>3</div><div>PROP. HMA SURF REM BUTT JOINT</div></div> <div><div>4</div><div>LIMIT OF RESURFACING</div></div>	<div><div>1</div><div>4" SOLID WHITE EDGE LINE (TYP.)</div></div> <div><div>2</div><div>4" DOUBLE SOLID YELLOW LINE, 2 @ 11' C-C (TYP.)</div></div> <div><div>3</div><div>6" SOLID WHITE TURN LANE LINE (TYP.)</div></div> <div><div>4</div><div>24" SOLID WHITE STOP LINE (TYP.)</div></div> <div><div>5</div><div>24" SOLID WHITE LETTERS & SYMBOLS (TYP.)</div></div>
INSTALL FINAL PAVEMENT MARKINGS AND RAISED REFLECTIVE MARKERS PER DISTRICT DETAIL TC-11 AND TC-13.	

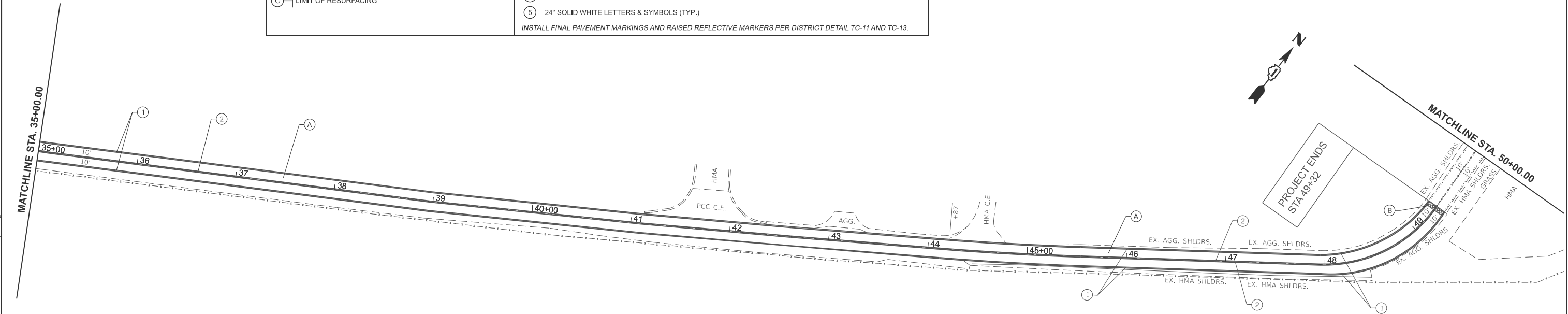

MODEL: EXCL - Plan 3 (Sheet)
FILE NAME: c:\pwy_work\pwy\shirani\sd1035062\D105625-shr-plan.dgn

	USER NAME = Sarah,Shirani	DESIGNED -	REVISED -	STATE OF ILLINOIS DEPARTMENT OF TRANSPORTATION	I-55 N. FRONTAGE RD (COUNTY LINE RD TO COMMONWEALTH DR) ROADWAY AND PAVEMENT MARKING PLAN		F.A.I RTE.	SECTION	COUNTY	TOTAL SHEETS	SHEET NO.
		DRAWN -	REVISED -				55	2024-1018-RS	COOK	19	8
		CHECKED -	REVISED -				CONTRACT NO. 62X64				
	PLOT DATE = 3/28/2025	DATE -	REVISED -				ILLINOIS FED. AID PROJECT				
SCALE: 1"=50'		SHEET 2	OF 3	SHEETS	STA. 30+00.00	TO STA. 60+00.00					

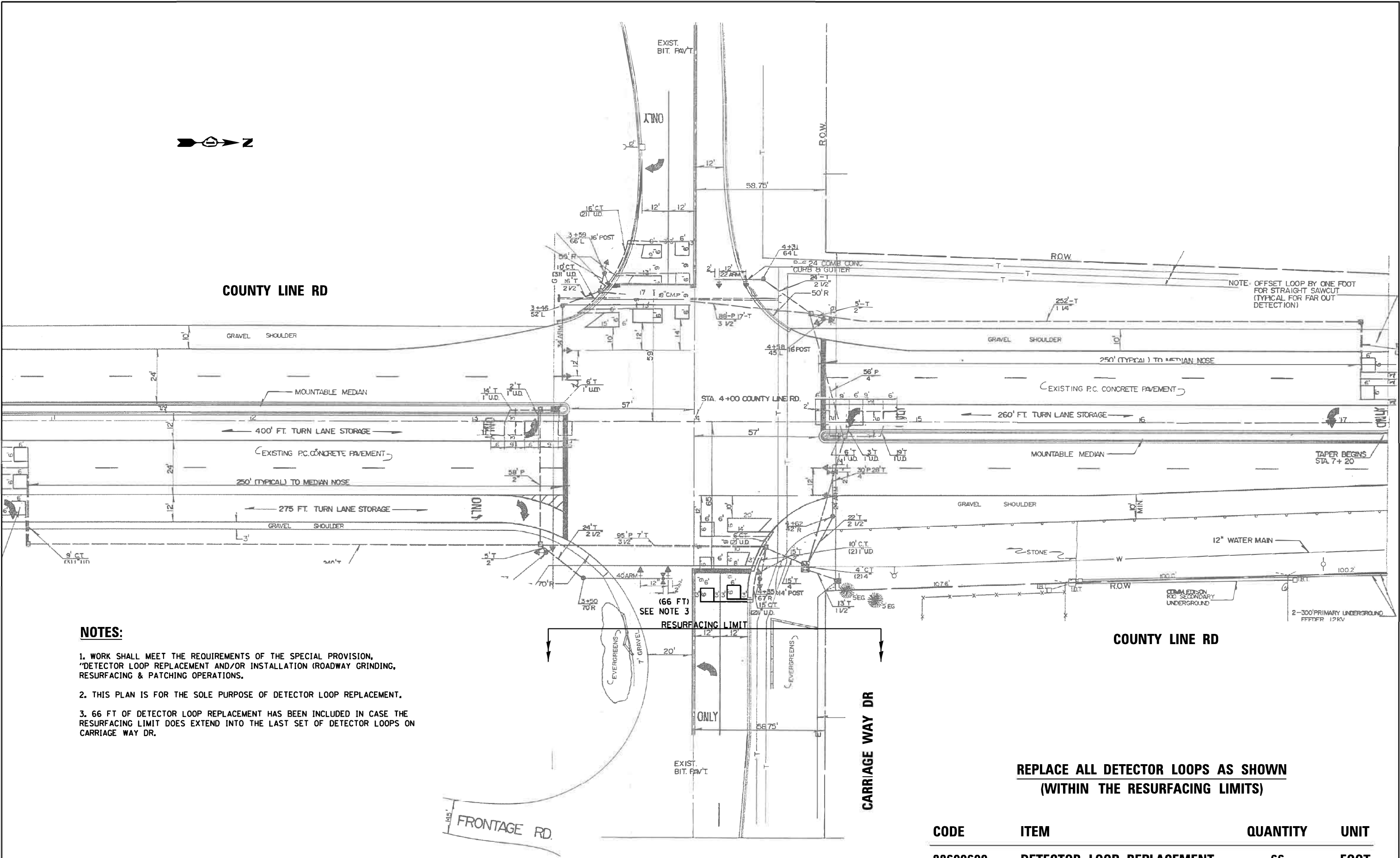

NOTES:

- 1. WORK SHALL MEET THE REQUIREMENTS OF THE SPECIAL PROVISION, "DETECTOR LOOP REPLACEMENT AND/OR INSTALLATION (ROADWAY GRINDING, RESURFACING & PATCHING OPERATIONS).
- 2. THIS PLAN IS FOR THE SOLE PURPOSE OF DETECTOR LOOP REPLACEMENT.
- 3. 66 FT OF DETECTOR LOOP REPLACEMENT HAS BEEN INCLUDED IN CASE THE RESURFACING LIMIT DOES EXTEND INTO THE LAST SET OF DETECTOR LOOPS ON CARRIAGE WAY DR.

**REPLACE ALL DETECTOR LOOPS AS SHOWN
(WITHIN THE RESURFACING LIMITS)**

CODE	ITEM	QUANTITY	UNIT
88600600	DETECTOR LOOP REPLACEMENT	66	FOOT

FILE NAME =		USER NAME = plascencia		DESIGNED - IP		REVISED - IP 9/30/2016		<div>STATE OF ILLINOIS DEPARTMENT OF TRANSPORTATION</div> <div>DETECTOR LOOP REPLACEMENT PLAN COUNTY LINE RD AT CARRIAGE WAY DR</div>										F.A.I. RTE.	SECTION		COUNTY	TOTAL SHEETS	SHEET NO.		
S:\WP\Design\Ivan\Resurfacing\62008 County Line @ Carriage Way Dr\CountyLineRdCarriageWayDr.dgn		DRAWN - IP		REVISED -		REVISED -												55	2024.1018.RS		COOK	19	9		
Default		PLOT SCALE = 40.0000' / in.		CHECKED - LP		REVISED -																		CONTRACT NO. 62X64	
		PLOT DATE = 9/30/2016		DATE = 8/15/2016		REVISED -																		ILLINOIS FED. AID PROJECT	
								SCALE:		SHEET	OF	SHEETS	STA.	TO STA.											

MODEL: Plan Single (Sheet)
FILE NAME: \\illinois.gov\DOT\Users\COTTHOMASELM\My Documents\Bentley\CONNECT1\012\Organization-Civil\DOT_Standards\Dgn\B Street Seeds\Civil_Named_Boundary_SheetSeeds.dgn

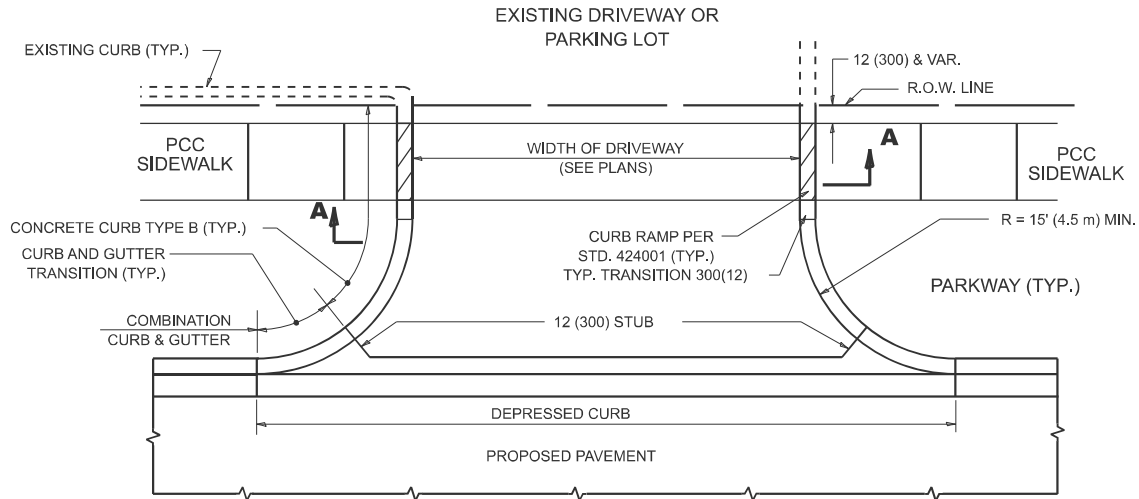

WITH CONCRETE CURB, TYPE B

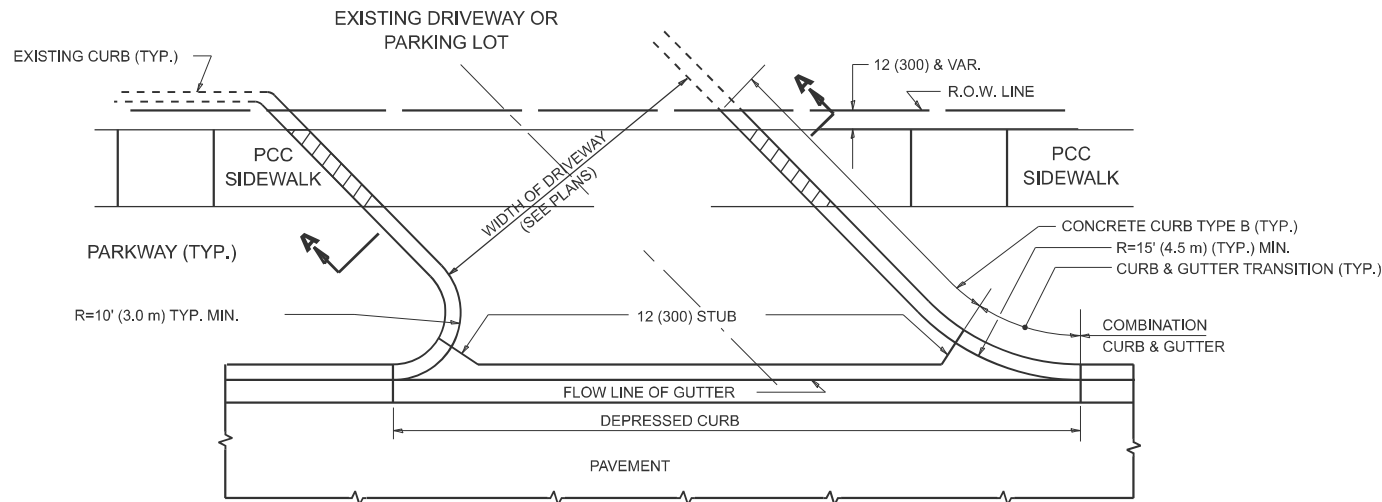

WITH CONCRETE CURB, TYPE B

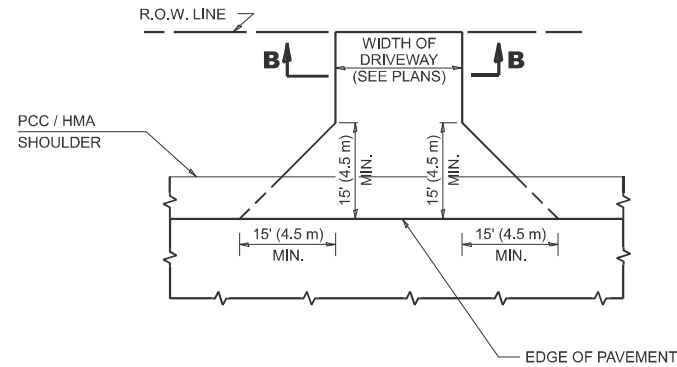
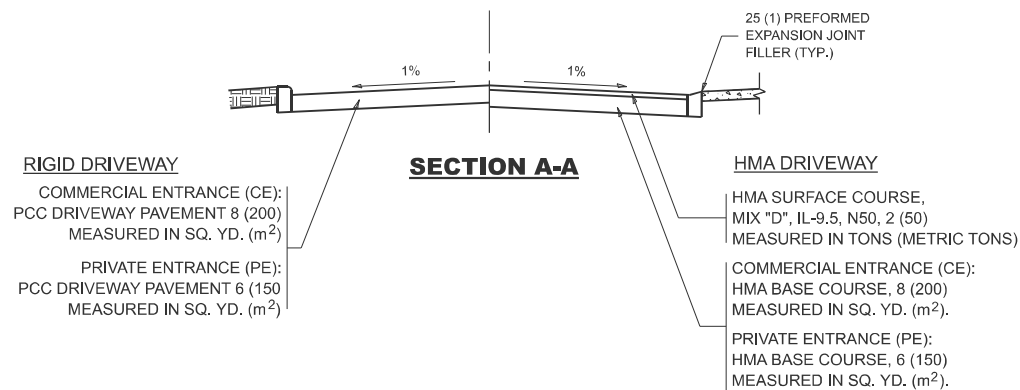

ADJACENT TO PCC / HMA SHOULDER

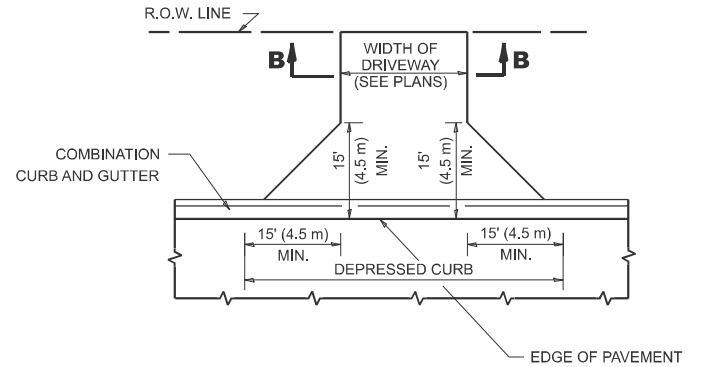

ADJACENT TO CURB AND GUTTER

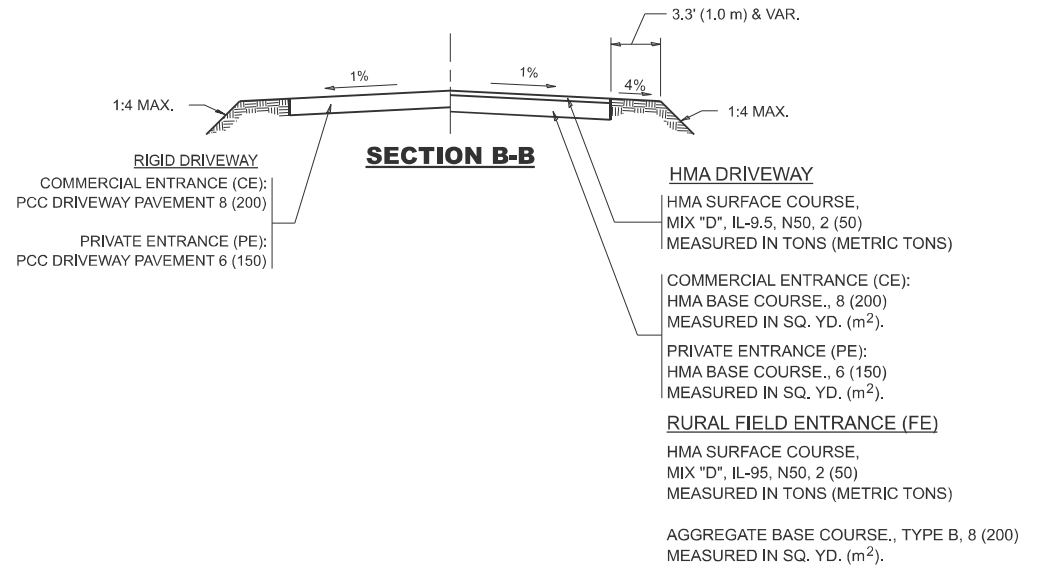

GENERAL NOTES

- DRIVEWAY SLOPES, LOCATIONS, & GEOMETRIC LAYOUT SHALL BE IN ACCORDANCE WITH THE LATEST EDITION OF THE "HANDBOOK FOR POLICY ON PERMITS FOR ACCESS DRIVEWAYS TO STATE HIGHWAYS". FOR FURTHER LAYOUT REQUIREMENTS, REFER TO ILLUSTRATIONS IN THE PERMIT HANDBOOK. DRIVEWAYS SHALL BE REPLACED IN KIND, UNLESS OTHERWISE NOTED ON THE PLANS.
- COMMERCIAL DRIVEWAYS SHALL BE CONSTRUCTED WITH CONCRETE CURB, TYPE B RETURNS EXCEPT WHEN THE SIDEWALK EDGE IS 4 FEET (1.2 METERS) OR LESS FROM THE BACK OF CURB, CONSTRUCT A FLARE DRIVEWAY WITHOUT CURB.

ALL DIMENSIONS ARE IN INCHES (MILLIMETERS)
UNLESS OTHERWISE NOTED.

**STATE OF ILLINOIS
DEPARTMENT OF TRANSPORTATION**

**DRIVEWAY DETAILS - DISTANCE BETWEEN R.O.W.
AND FACE OF CURB & EDGE OF SHOULDER >15'(4.5m)**

SCALE: NONE SHEET 1 OF 1 SHEETS STA. TO STA.

F&I RTE.	SECTION	COUNTY	TOTAL SHEETS	SHEET NO.
55	2024-1018-RS	COOK	19	10
BD400-01 (BD-01)		CONTRACT NO. 62X64		
ILLINOIS		FED. AID PROJECT		

METHOD OF MEASUREMENT

REFER TO SECTION 442 OF THE STANDARD SPECIFICATIONS FOR ROAD AND BRIDGE CONSTRUCTION AND THE RECURRING SPECIAL PROVISION "PATCHING WITH HOT-MIX ASPHALT OVERLAY REMOVAL."

BASIS OF PAYMENT

1. REFER TO SECTION 442 OF THE STANDARD SPECIFICATIONS FOR ROAD AND BRIDGE CONSTRUCTION AND THE RECURRING SPECIAL PROVISION "PATCHING WITH HOT-MIX ASPHALT OVERLAY REMOVAL."
2. SAW CUT/SCORING OF EXISTING HMA OVERLAY IS INCLUDED IN THE COST OF PAVEMENT PATCHING.
3. SAW CUT/SCORING OF EXISTING PAVEMENT IS INCLUDED IN THE COST OF PAVEMENT PATCHING.

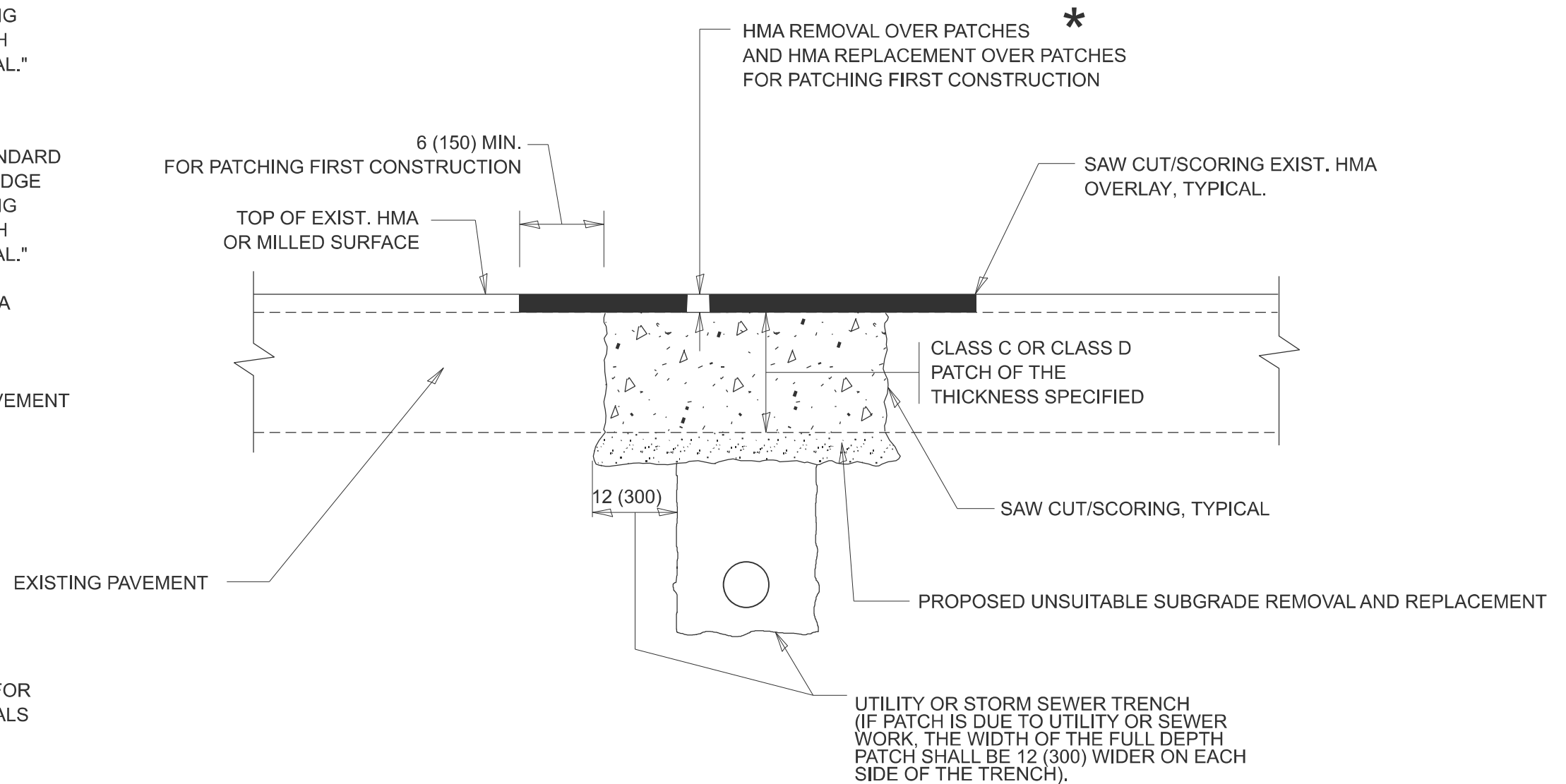

SEQUENCE OF CONSTRUCTION (PATCHING FIRST)

1. REMOVE THE EXISTING HMA MATERIAL OVER THE AREA TO BE PATCHED.
2. REMOVE AND REPLACE WITH CLASS C OR D PATCH.
3. REPLACE HMA MATERIAL OVER THE AREA TO BE PATCHED.

SEQUENCE OF CONSTRUCTION (MILLING FIRST)

1. MILL HMA FIRST IF THERE IS AT LEAST 4 ½ INCHES OR MORE OF HMA MATERIAL ON TOP OF THE EXISTING PAVEMENT OR IF THE PAVEMENT IS FULL DEPTH HMA. A MINIMUM OF 2 INCHES OF HMA MATERIAL SHALL BE IN PLACE AFTER MILLING.
2. REMOVE AND REPLACE WITH FULL DEPTH CLASS D PATCHES TO TOP OF MILLED SURFACE.

ALL DIMENSIONS ARE IN INCHES (MILLIMETERS) UNLESS OTHERWISE SHOWN.

FILE NAME:	USER NAME = Eric.L.Thomas	DESIGNED - R. SHAH	REVISED - R. BORO 01-01-07	STATE OF ILLINOIS DEPARTMENT OF TRANSPORTATION	PAVEMENT PATCHING FOR HMA SURFACED PAVEMENT				F.A.I RTE.	SECTION	COUNTY	TOTAL SHEETS	SHEET NO.
		DRAWN -	REVISED - R. BORO 09-04-07						55	2024-1018-RS	COOK	19	11
		CHECKED -	REVISED - K. ENG 10-27-08		BD400-04 (BD-22) CONTRACT NO. 62X64								
	PLOT DATE = 8/20/2024	DATE = 10-25-94	REVISED - K. SMITH 11-18-22										
					SCALE: NONE	SHEET 1	OF 1	SHEETS	STA.	TO STA.			

MODEL: Plan Single (Sheet)
FILE NAME: \\illinois.gov\DOT\Users\COTTHOMASELM\My Documents\Bentley\CONNECT1\012\Organization-Civil\IDOT_Standards\Drawings\Street Seeds\Civil_Named_Boundary_SheetSeeds.dgn

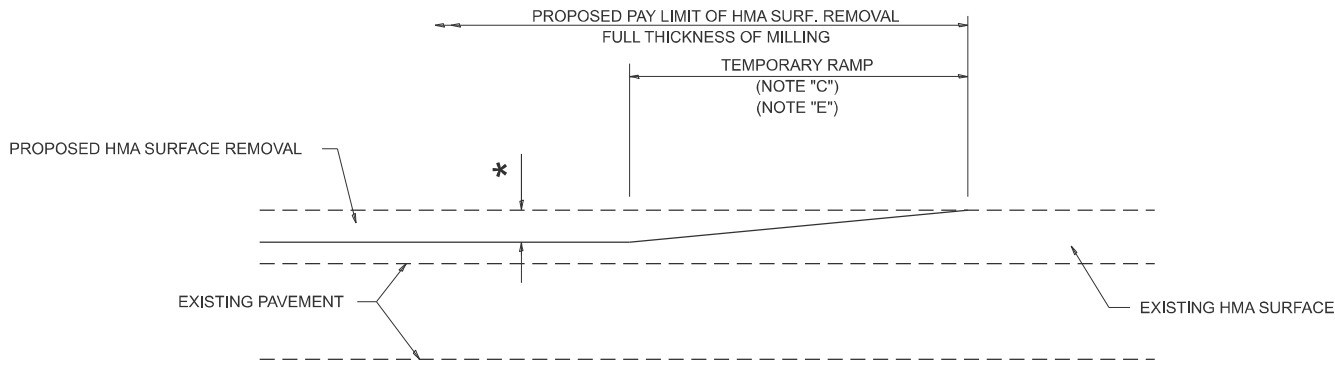

MILLED TEMPORARY RAMP
(FOR BUTT JOINT AND HMA TAPER SEE DETAIL BELOW)

OPTION 1

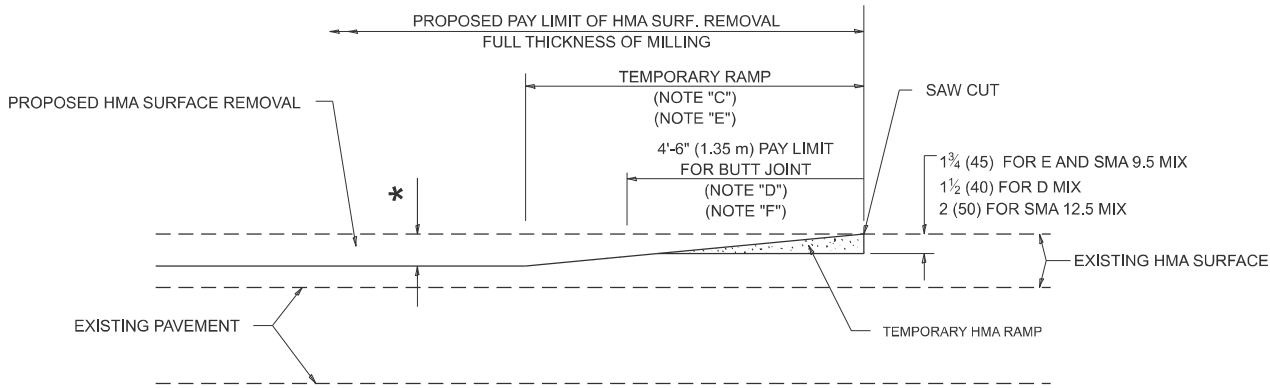

HMA CONSTRUCTED TEMPORARY RAMP
(FOR BUTT JOINT AND HMA TAPER SEE DETAIL BELOW)

OPTION 2

TYPICAL TEMPORARY RAMP

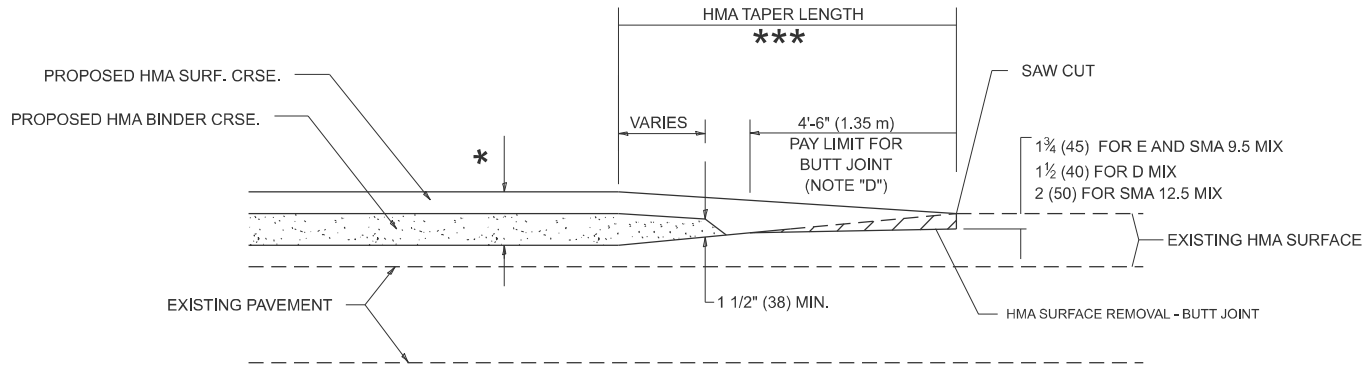

**BUTT JOINT AND
HMA TAPER**

**TYPICAL BUTT JOINT AND HMA TAPER
FOR MILLING AND RESURFACING**

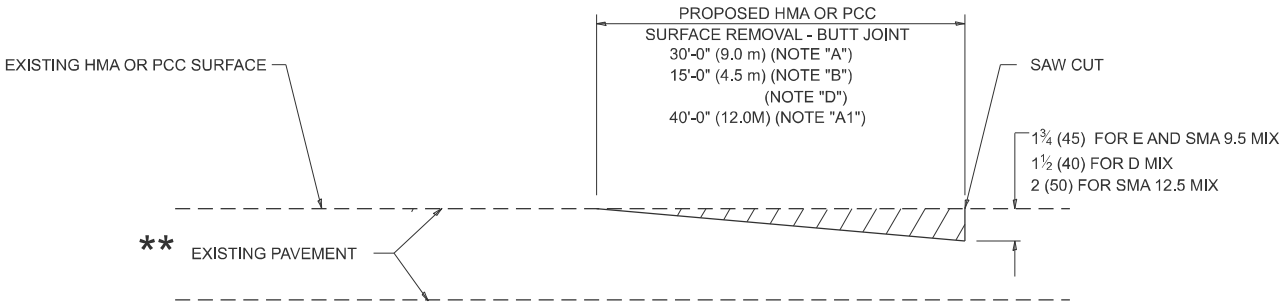

BUTT JOINT DETAIL

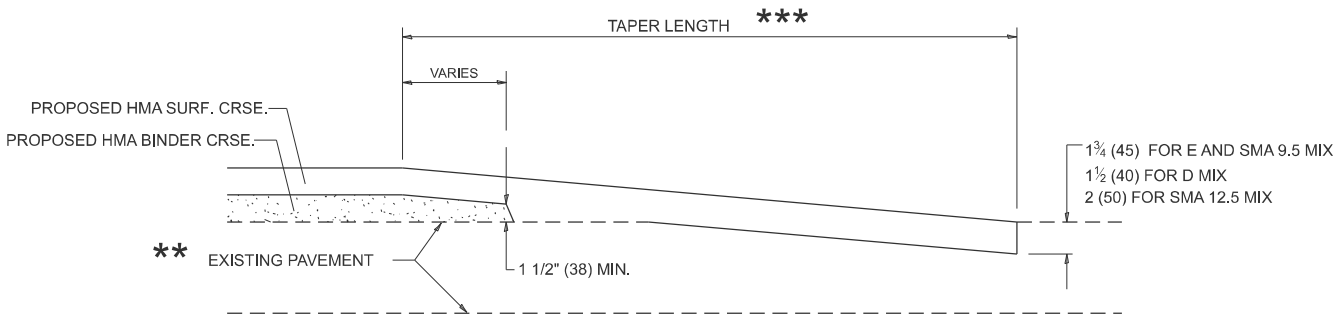

HMA TAPER DETAIL

**TYPICAL BUTT JOINT AND HMA TAPER
FOR RESURFACING ONLY**

** PC CONCRETE, HMA OR HMA RESURFACED PAVEMENT.

GENERAL NOTES

- A. MAINLINE ARTERIAL ROADWAYS AND MAJOR SIDE ROADS.
- A1. INTERSTATES
- B. MINOR SIDE ROADS.
- C. THE TEMP. RAMP SHALL BE CONSTRUCTED IMMEDIATELY UPON REMOVAL OF THE EXISTING HMA SURFACE.
- D. THE BUTT JOINT SHALL BE CONSTRUCTED IMMEDIATELY PRIOR TO PLACING THE PROPOSED HMA COURSES.
- E. TAPER THE TEMP. RAMP AT A RATE OF 3' - 4" (1.02m) PER 1 INCH (25 mm) OF MILLING THICKNESS.
* SEE TYPICAL SECTIONS FOR MILLING THICKNESS.
- F. SEE ARTICLE 406.08 AND 406.14 OF THE STANDARD SPECIFICATIONS FOR "HMA AND/OR PCC SURFACE REMOVAL, BUTT JOINT".

20'-0" (6.1 m) PER 1 (25) RESURFACING (NOTE "A")
10'-0" (3.0 m) PER 1 (25) RESURFACING (NOTE "B")

BASIS OF PAYMENT

1. THE BUTT JOINT WILL BE PAID FOR AT THE CONTRACT UNIT PRICE PER SQUARE YARD (SQUARE METER) FOR "HOT-MIX ASPHALT SURFACE REMOVAL - BUTT JOINT" OR FOR "PORTLAND CEMENT CONCRETE SURFACE REMOVAL- BUTT JOINT".
2. THE TEMPORARY RAMP AND SAW CUT SHALL BE INCLUDED IN THE UNIT COST FOR HMA OR PCC SURFACE REMOVAL-BUTT JOINT.

ALL DIMENSIONS ARE IN INCHES (MILLIMETERS) UNLESS OTHERWISE SHOWN.

USER NAME = Eric.L.Thomas	DESIGNED - M. DE YONG	REVISED - A. ABBAS 03-21-97
	DRAWN -	REVISED - M. GOMEZ 04-06-01
	CHECKED -	REVISED - R. BORO 01-01-07
PLOT DATE = 8/20/2024	DATE - 06-13-90	REVISED - K. SMITH 11-18-22

STATE OF ILLINOIS
DEPARTMENT OF TRANSPORTATION

**BUTT JOINT AND
HMA TAPER DETAILS**

SCALE: NONE SHEET 1 OF 1 SHEETS STA. TO STA.

F.A.I RTE.	SECTION	COUNTY	TOTAL SHEETS	SHEET NO.
55	2024-1018-RS	COOK	19	13
BD400-05 BD-32		CONTRACT NO. 62X64		
		ILLINOIS FED. AID PROJECT		

MODEL: Plan Single [Sheet]
FILE NAME: \\illinois.gov\DOT\Users\COTHOMASELM\Documents\Bentley\CONNECT1\012\Organization-Civil\DOT_Standards\Dgnlib\Sheet Seeds\Civil_Named_Boundary_SheetSeeds.dgnlib

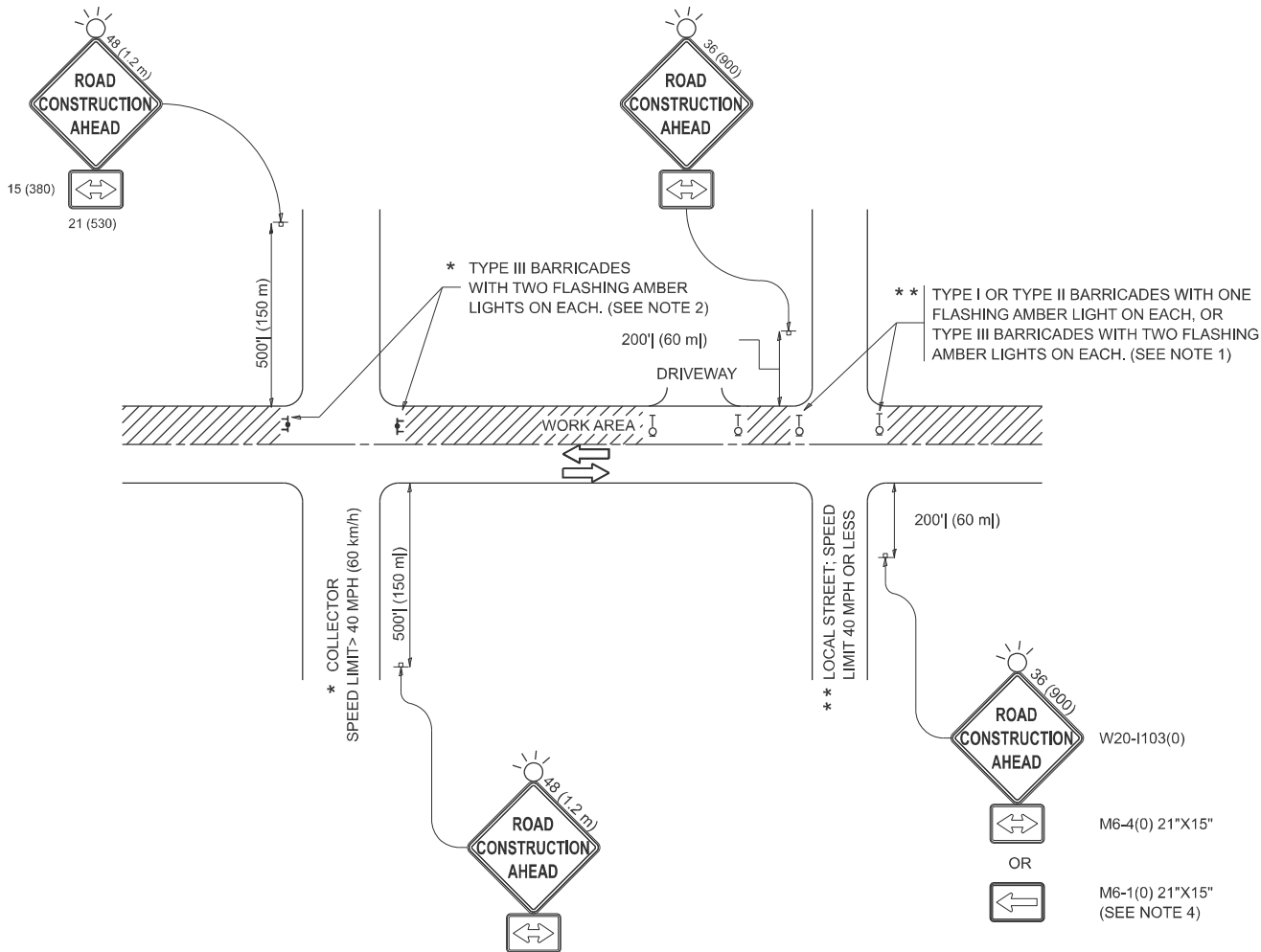

NOTES:

- SIDE ROAD WITH A SPEED LIMIT OF 40 MPH (60 km/h) OR LESS AS SHOWN ON THE DRAWING AND AS DIRECTED BY THE ENGINEER:
 - ONE "ROAD CONSTRUCTION AHEAD" SIGN 36 x 36 (900x900) WITH A FLASHER MOUNTED ON IT APPROXIMATELY 200' (60 m) IN ADVANCE OF THE MAIN ROUTE.
 - THE CLOSED PORTION OF THE MAIN ROUTE SHALL BE PROTECTED BY BLOCKING WITH TYPE I, TYPE II OR TYPE III BARRICADES, 1/3 OF THE CROSS SECTION OF THE CLOSED PORTION.
- SIDE ROAD WITH A SPEED LIMIT GREATER THAN 40 MPH (60 km/h) AS SHOWN ON THE DRAWING AND AS DIRECTED BY THE ENGINEER:
 - ONE "ROAD CONSTRUCTION AHEAD" SIGN 48 x 48 (1.2 m x 1.2 m) WITH A FLASHER MOUNTED ON IT APPROXIMATELY 500' (150 m) IN ADVANCE OF THE MAIN ROUTE.
 - THE CLOSED PORTION OF THE MAIN ROUTE SHALL BE PROTECTED BY BLOCKING WITH TYPE III BARRICADES, 1/2 OF THE CROSS SECTION OF THE CLOSED PORTION.
- CONES MAY BE SUBSTITUTED FOR BARRICADES OR DRUMS AT HALF THE SPACING DURING DAY OPERATIONS. CONES SHALL BE A MINIMUM OF 28 (710) IN HEIGHT.
- WHEN THE SIDE ROAD LIES BETWEEN THE BEGINNING OF THE MAINLINE SIGNING AND THE WORK ZONE, A SINGLE HEADED ARROW (M6-1) SHALL BE USED IN LIEU OF THE DOUBLE HEADED ARROW (M6-4).
- WHEN WORK IS BEING PERFORMED ON A SIDE ROAD OR DRIVEWAY, FOLLOW THE APPLICABLE STANDARD(S). THE DIRECTIONAL ARROW (M6-1 OR M6-4) SHALL BE COVERED OR REMOVED WHEN NO LONGER CONSISTENT WITH THE TRAFFIC CONTROL SET-UP.
- ADVANCE WARNING SIGNS ARE TO BE OMITTED ON DRIVEWAYS UNLESS OTHERWISE SPECIFIED IN THE PLANS OR BY THE ENGINEER.
- THE TRAFFIC CONTROL AND PROTECTION FOR SIDE ROADS, INTERSECTIONS, AND DRIVEWAYS SHALL BE INCLUDED IN THE COST OF SPECIFIED TRAFFIC CONTROL STANDARDS OR ITEMS.

All dimensions are in inches (millimeters) unless otherwise shown.

	USER NAME = Eric.L.Thomas	DESIGNED - L.H.A.	REVISED - T. RAMMACHER 01-06-00	STATE OF ILLINOIS DEPARTMENT OF TRANSPORTATION	TRAFFIC CONTROL AND PROTECTION FOR SIDE ROADS, INTERSECTIONS, AND DRIVEWAYS	SCALE:	SHEET	OF	SHEETS	STA.	TO STA.	F.A.I RTE.	SECTION	COUNTY	TOTAL SHEETS	SHEET NO.			
		DRAWN -	REVISED - A. SCHUETZE 07-01-13									55	2024-1018-RS	COOK	19	14			
		CHECKED -	REVISED - A. SCHUETZE 09-15-06									TC-10					CONTRACT NO. 62X64		
	PLOT DATE = 8/20/2024	DATE - 06-89	REVISED - D. SENDERAK 05-03-24									ILLINOIS FED. AID PROJECT							

MODEL: Plan Single [Sheet]
FILE NAME: \\illinois.gov\DOT\Users\COTHOMASELM\My Documents\Bentley\CONNECT\1012\Organization-Civil\IDOT_Standards\Dgnlib\Sheet Seeds\Civil_Named_Boundary_SheetSeeds.dgnlib

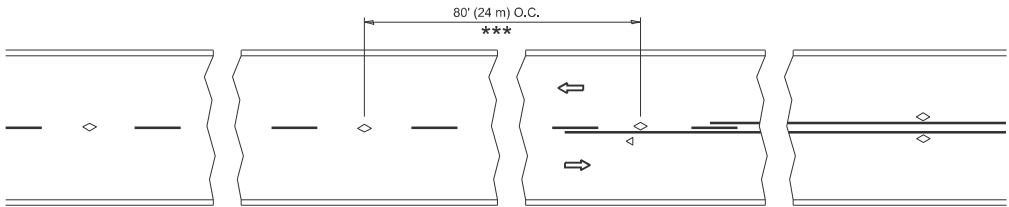

*** REDUCE TO 40' (12 m) O.C. ON CURVES WITH POSTED OR ADVISORY SPEED 45 M.P.H. (70 km/h) OR LESS.

TWO-LANE/TWO-WAY

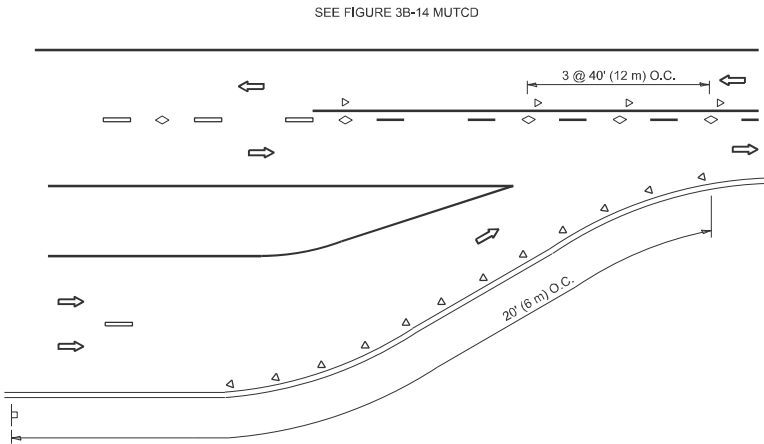

LANE REDUCTION TRANSITION

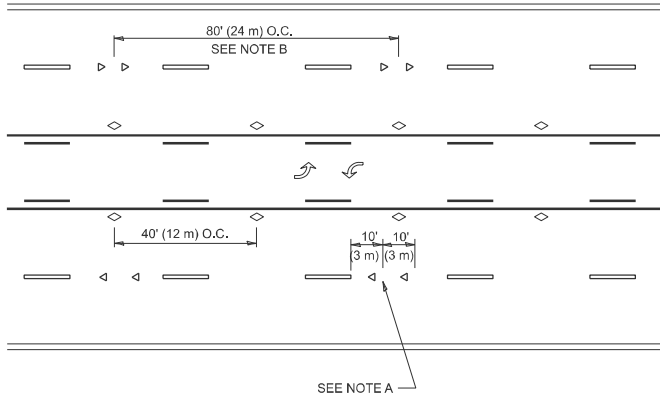

SEE NOTE A

TWO-WAY LEFT TURN

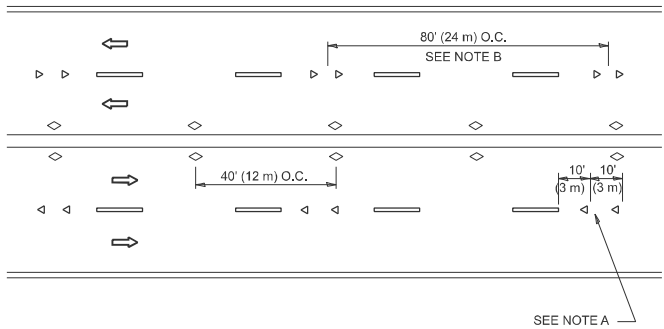

SEE NOTE A

MULTI-LANE/UNDIVIDED

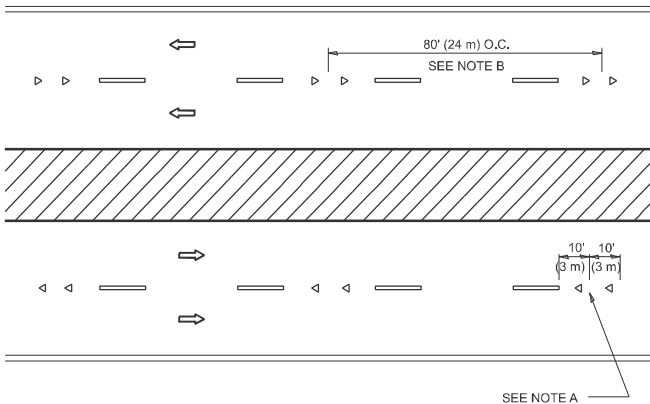

SEE NOTE A

MULTI-LANE/DIVIDED

GENERAL NOTES

- MARKERS USED WITH DASHED LINES SHALL BE CENTERED IN THE GAP BETWEEN SEGMENTS.
- MARKERS USED ADJACENT TO SOLID LINES SHALL BE OFFSET 2 TO 3 (50 TO 75) TOWARD TRAFFIC AS SHOWN.
- MARKERS THROUGH TANGENTS LESS THAN 500' (150 m) IN LENGTH BETWEEN CURVES SHALL BE INSTALLED AT THE LESSER OF THE TWO CURVE SPACINGS.
- MARKERS ARE TO BE USED ADJACENT TO BOTH SOLID WHITE LINES IN DUAL LEFT TURN LANES

SYMBOLS

- YELLOW STRIPE
- WHITE STRIPE
- ONE-WAY AMBER MARKER
- ONE-WAY CRYSTAL MARKER (W/O)
- TWO-WAY AMBER MARKER

LANE MARKER NOTES

- USE DOUBLE LANE LINE MARKERS SPACED AS SHOWN.
- REDUCE TO 40' (12 m) O.C. ON CURVES WHERE ADVISORY SPEEDS ARE 10 M.P.H (20 km/h) LOWER THAN POSTED SPEEDS.

DESIGN NOTES

- DOUBLE LANE LINE MARKERS SHALL BE USED UNLESS SPECIFIED OTHERWISE.
- EXCEPT AS SHOWN ON THE LANE REDUCTION TRANSITION AND FREEWAY EXIT RAMP DETAIL, MARKERS ARE NOT TO BE SPECIFIED ON RIGHT EDGE LINES.
- THE EXACT MARKER LIMITS, SPACING, AND COLOR SHALL BE INCLUDED IN THE PLANS WHEN STANDARD SPECIFICATIONS ARE NOT BEING USED.
- MARKERS SHOULD NOT BE USED ALONGSIDE CURBS EXCEPT FOR EXTREMELY SHORT SECTIONS OF CURBS WHERE NOT MORE THAN TWO MARKERS WOULD BE INVOLVED.

All dimensions are in inches (millimeters)
unless otherwise shown.

PLOT DATE = 8/20/2024	USER NAME = Eric.L.Thomas	DESIGNED -	REVISED - T. RAMMACHER 03-12-99
		DRAWN -	REVISED - T. RAMMACHER 01-06-00
		CHECKED -	REVISED - C. JUCIUS 09-09-09
		DATE -	REVISED - C. JUCIUS 07-01-13

STATE OF ILLINOIS
DEPARTMENT OF TRANSPORTATION

TYPICAL APPLICATIONS
RAISED REFLECTIVE PAVEMENT MARKERS (SNOW-PLOW RESISTANT)

SCALE: NONE SHEET 1 OF 1 SHEETS STA. TO STA.

F.A.I RTE.	SECTION	COUNTY	TOTAL SHEETS	SHEET NO.
55	2024-1018-RS	COOK	19	15
TC-11		CONTRACT NO. 62X64		
ILLINOIS		FED. AID PROJECT		

MODEL: Plan Single [Sheet]
FILE NAME: \\illinois.gov\DOT\Users\COTTHOMASELM\My Documents\Bentley\CONNECT1012\Organization-Civil\IDOT_Standards\Dgnlib\Sheet Seeds\Civil_Named_Boundary_SheetSeeds.dgnlib

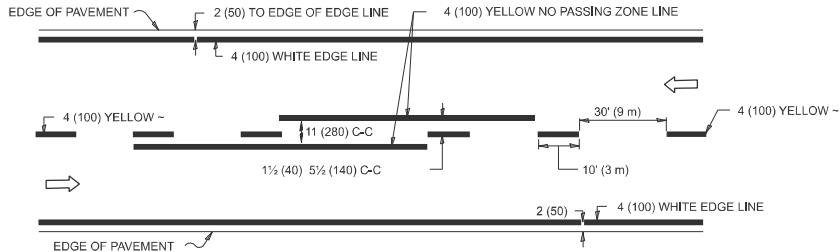

2-LANE ROADWAY

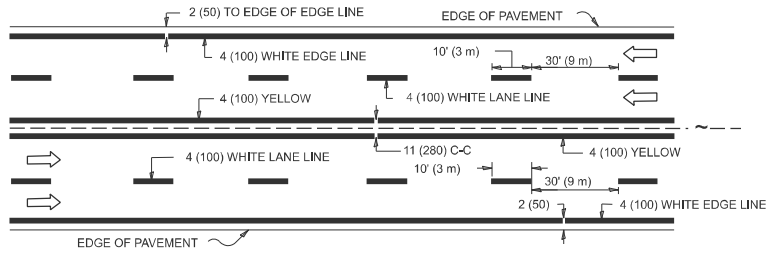

MULTI-LANE UNDIVIDED

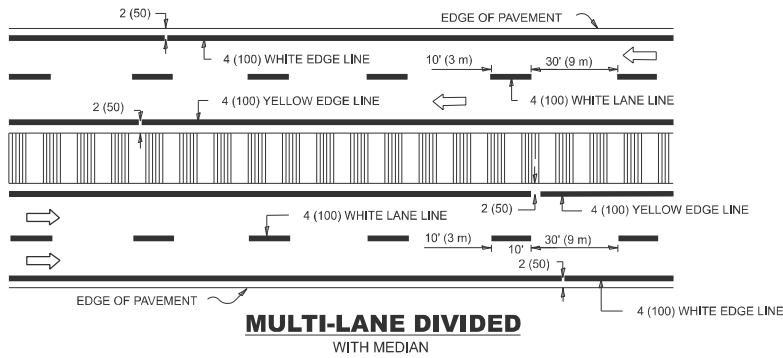

TYPICAL LANE AND EDGE LINE MARKING

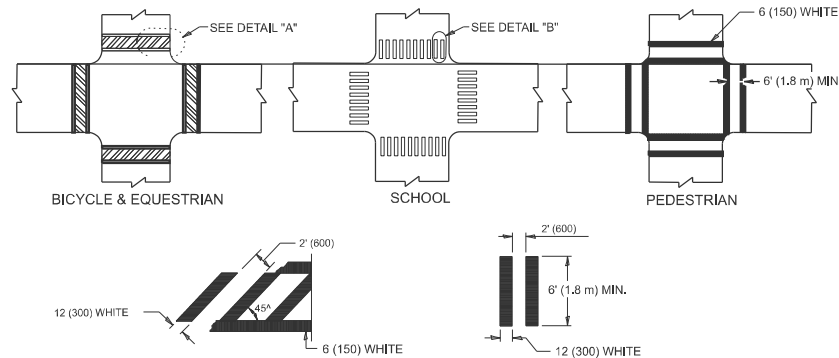

DETAIL "A"

DETAIL "B"

TYPICAL CROSSWALK MARKING

* MARKINGS SHALL BE INSTALLED PARALLEL TO THE CENTERLINE OF THE ROAD WHICH IT CROSSES

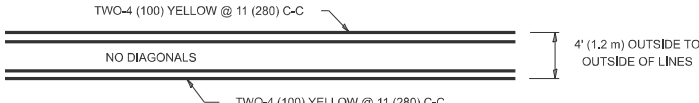

4' (1.2 m) WIDE MEDIANS ONLY

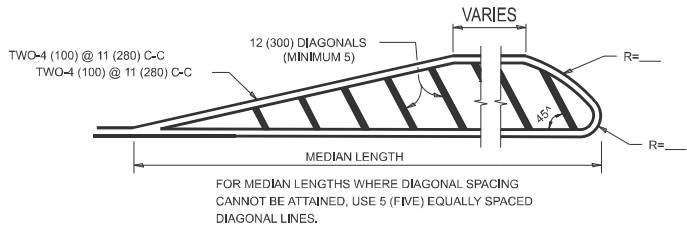

DIAGONAL LINE SPACING: 50' (15 m) C-C (LESS THAN 30MPH (50 km/h))
75' (25 m) C-C 30MPH (50 km/h) TO 45MPH (70 km/h)
150' (45 m) C-C (MORE THAN 45MPH (70 km/h))

MEDIANS OVER 4' (1.2 m) WIDE

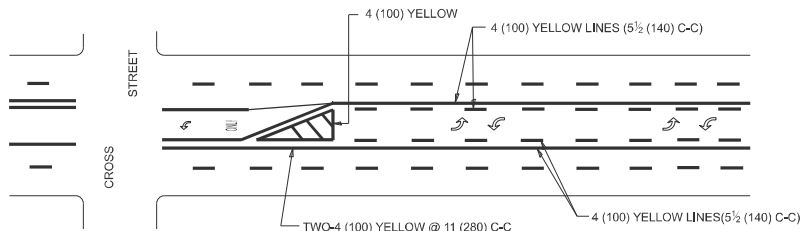

A MINIMUM OF TWO PAIRS OF TURN ARROWS SHALL BE USED, WHITE IN COLOR. ADDITIONAL PAIRS SHALL BE PLACED AT 200' (60 m) TO 300' (90 m) INTERVALS.

MEDIAN WITH TWO-WAY LEFT TURN LANE TYPICAL PAINTED MEDIAN MARKING

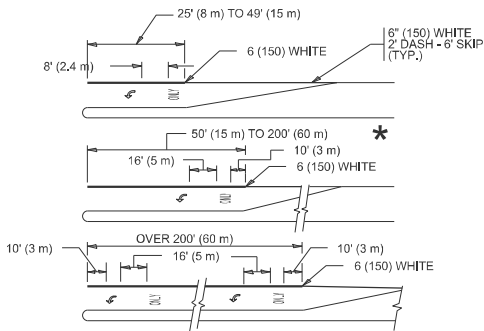

FULL SIZE LETTERS 8' (2.4 m) AND ARROWS SHALL BE USED.
AREA = 15.6 SQ. FT. (1.5 m²) ONLY AREA = 20.8 SQ. FT. (1.9 m²)

* TURN LANES IN EXCESS OF 400' (120 m) IN LENGTH MAY HAVE AN ADDITIONAL SET OF ARROW - "ONLY" INSTALLED MIDWAY BETWEEN THE OTHER TWO SETS OF ARROW - "ONLY".

TYPICAL LEFT (OR RIGHT) TURN LANE

TYPICAL TURN LANE MARKING

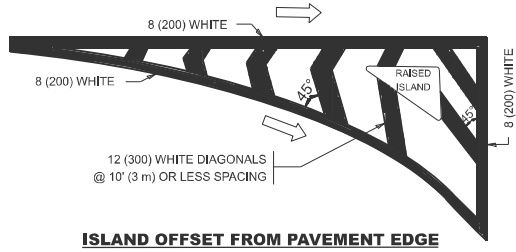

ISLAND OFFSET FROM PAVEMENT EDGE

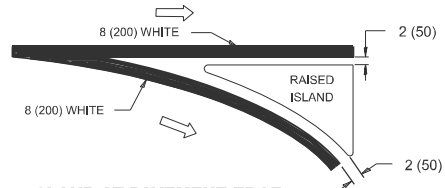

ISLAND AT PAVEMENT EDGE

TYPICAL ISLAND MARKING

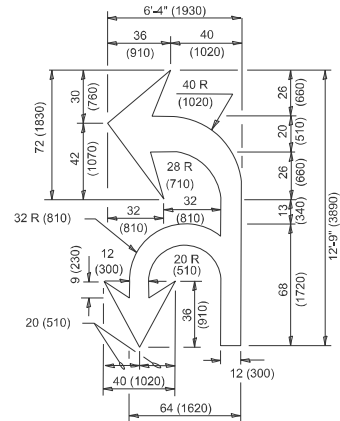

COMBINATION LEFT AND U-TURN

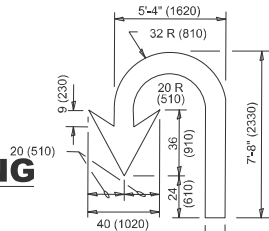

U-TURN

LANE REDUCTION TRANSITION

* LANE REDUCTION ARROWS REQUIRED AT SPEEDS OF 45 MPH OR GREATER OR WHEN SPECIFIED IN PLANS.

TYPE OF MARKING	WIDTH OF LINE	PATTERN	COLOR	SPACING / REMARKS
CENTERLINE ON 2 LANE PAVEMENT	4 (100)	SKIP-DASH	YELLOW	10' (3 m) LINE WITH 30' (9 m) SPACE
CENTERLINE ON MULTI-LANE UNDIVIDED PAVEMENT	2 @ 4 (100)	SOLID	YELLOW	11 (280) C-C
NO PASSING ZONE LINES: FOR ONE DIRECTION FOR BOTH DIRECTIONS	4 (100) 2 @ 4 (100)	SOLID SOLID	YELLOW YELLOW	5 1/2 (140) C-C FROM SKIP-DASH CENTERLINE 11 (280) C-C OMIT SKIP-DASH CENTERLINE BETWEEN
LANE LINES	4 (100) 5 (125) ON FREEWAYS	SKIP-DASH SKIP-DASH	WHITE WHITE	10' (3 m) LINE WITH 30' (9 m) SPACE
DOTTED LINES (EXTENSIONS OF CENTER, LANE OR TURN LANE MARKINGS)	SAME AS LINE BEING EXTENDED	SKIP-DASH	SAME AS LINE BEING EXTENDED	2' (600) LINE WITH 6' (1.8 m) SPACE
EDGE LINES	4 (100)	SOLID	YELLOW-LEFT WHITE-RIGHT	OUTLINE MEDIANS IN YELLOW
TURN LANE MARKINGS	6 (150) LINE: FULL SIZE LETTERS & SYMBOLS (8' (2.4m))	SOLID	WHITE	SEE TYPICAL TURN LANE MARKING DETAIL
TWO WAY LEFT TURN MARKING	2 @ 4 (100) EACH DIRECTION 8' (2.4m) LEFT ARROW	SKIP-DASH AND SOLID IN PAIRS	YELLOW WHITE	10' (3 m) LINE WITH 30' (9 m) SPACE FOR SKIP-DASH: 5 1/2 (140) C-C BETWEEN SOLID LINE AND SKIP-DASH LINE SEE TYPICAL TWO-WAY LEFT TURN MARKING DETAIL
CROSSWALK LINES (PEDESTRIAN) A. DIAGONALS (BIKE & EQUESTRIAN) B. LONGITUDINAL BARS (SCHOOL)	2 @ 6 (150) 12 (300) @ 45° 12 (300) @ 90°	SOLID SOLID SOLID	WHITE WHITE WHITE	NOT LESS THAN 6' (1.8 m) APART 2' (600) APART 2' (600) APART SEE TYPICAL CROSSWALK MARKING DETAILS.
STOP LINES	24 (600)	SOLID	WHITE	PLACE 4' (1.2 m) IN ADVANCE OF AND PARALLEL TO CROSSWALK, IF PRESENT. OTHERWISE, PLACE AT DESIRED STOPPING POINT, PARALLEL TO CROSSROAD CENTERLINE, WHERE POSSIBLE.
PAINTED MEDIANS	2 @ 4 (100) WITH 12 (300) DIAGONALS @ 45° NO DIAGONALS USED FOR 4' (1.2 m) WIDE MEDIANS	SOLID	YELLOW: TWO WAY TRAFFIC WHITE: ONE WAY TRAFFIC	11 (280) C-C FOR THE DOUBLE LINE SEE TYPICAL PAINTED MEDIAN MARKING.
GORE MARKING AND CHANNELIZING LINES	8 (200) WITH 12 (300) DIAGONALS @ 45°	SOLID	WHITE	DIAGONALS: 15' (4.5 m) C-C (LESS THAN 30MPH (50 km/h)) 20' (6 m) C-C 30MPH (50 km/h) TO 45MPH (70 km/h) 30' (9 m) C-C (OVER 45MPH (70 km/h))
RAILROAD CROSSING	24 (600) TRANSVERSE LINES: "RR" IS 6' (1.8 m) LETTERS: 16 (400) LINE FOR "X"	SOLID	WHITE	SEE STATE STANDARD 780001 AREA OF: *R*=3.6 SQ. FT. (0.33 m ²) EACH *X*=54.0 SQ. FT. (5.0 m ²)
SHOULDER DIAGONALS (REQUIRED FOR SHOULDERS ≥ 8')	12 (300) @ 45°	SOLID	WHITE - RIGHT YELLOW - LEFT	50' (15 m) C-C (LESS THAN 30MPH (50 km/h)) 75' (25 m) C-C (30 MPH (50 km/h) TO 45MPH (70 km/h)) 150' (45 m) C-C (OVER 45MPH (70 km/h))
U TURN ARROW	SEE DETAIL	SOLID	WHITE	16.3 SF
2 ARROW COMBINATION LEFT AND U TURN	SEE DETAIL	SOLID	WHITE	30.4 SF

FOR FURTHER DETAILS ON PAVEMENT MARKING REFER TO
STANDARD SPECIFICATIONS FOR ROAD AND BRIDGE
CONSTRUCTION AND STATE STANDARD 780001.

All dimensions are in inches (millimeters)
unless otherwise shown.

USER NAME = Eric.L.Thomas	DESIGNED - EVERS	REVISED - C. JUCIUS 09-09-09
	DRAWN -	REVISED - C. JUCIUS 07-01-13
	CHECKED -	REVISED - C. JUCIUS 12-21-15
PLOT DATE = 8/20/2024	DATE - 03-19-90	REVISED - C. JUCIUS 04-12-16

STATE OF ILLINOIS DEPARTMENT OF TRANSPORTATION

DISTRICT ONE TYPICAL PAVEMENT MARKINGS

SCALE: NONE SHEET 1 OF 1 SHEETS STA. TO STA.

F.A.I RTE.	SECTION	COUNTY	TOTAL SHEETS	SHEET NO.
55	2024-1018-RS	COOK	19	16
TC-13		CONTRACT NO. 62X64		
ILLINOIS		FED. AID PROJECT		

TURN BAY ENTRANCE AT START
OF LANE CLOSURE TAPER

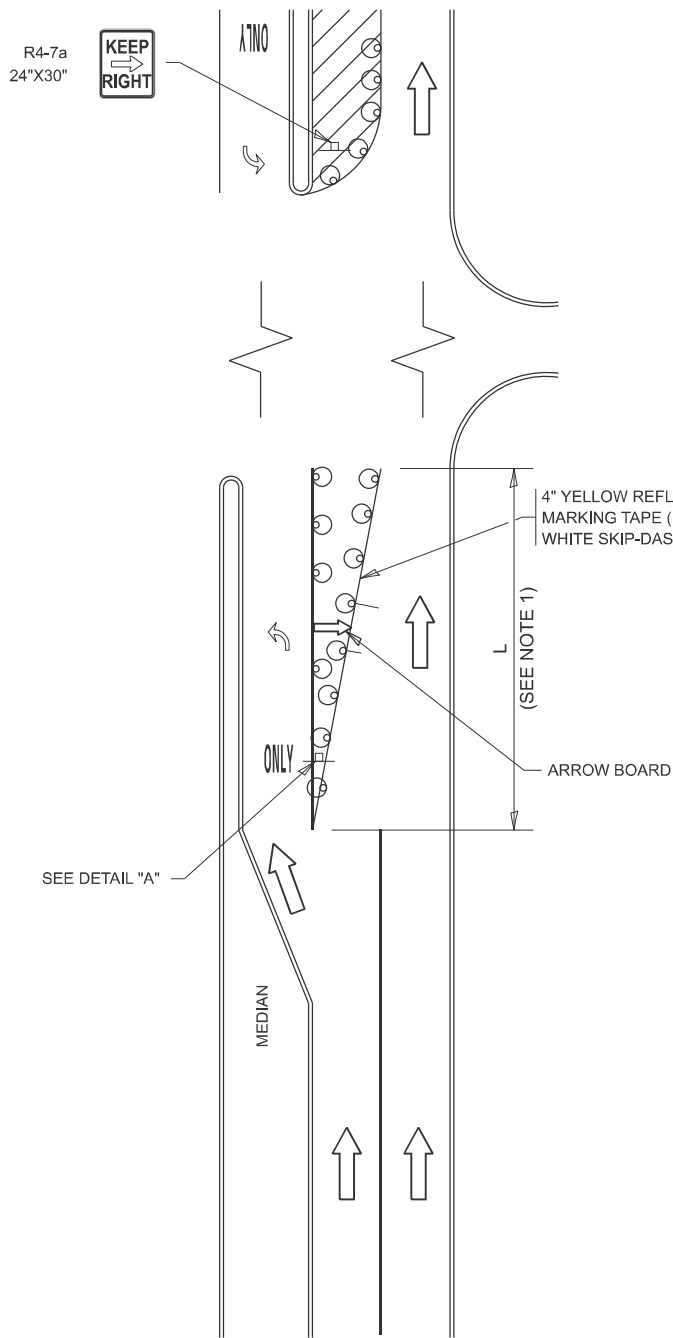
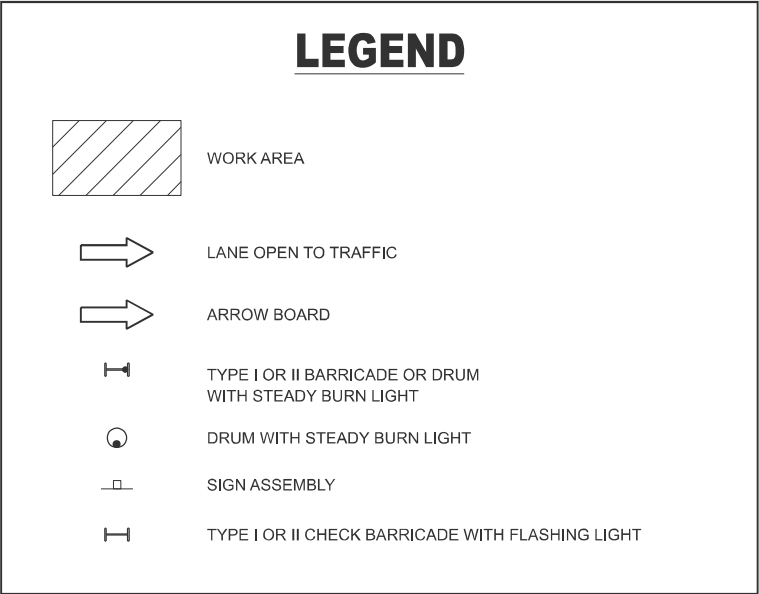

FIGURE 1

LEGEND



NOTES:

- 1. A) WHEN "L" IS ≤ THE STORAGE LENGTH OF THE TURN LANE (AS SHOWN IN FIG. 1), USE FIGURE 1.
B) WHEN "L" IS > THE STORAGE LENGTH OF THE TURN LANE OR THE TURN LANE IS WITHIN THE LANE CLOSURE, USE FIGURE 2.
- 2. CONES MAY BE SUBSTITUTED FOR BARRICADES OR DRUMS AT HALF THE SPACING DURING DAY OPERATIONS. CONES SHALL BE A MINIMUM OF 28 (710) IN HEIGHT.
- 3. LIGHTS WILL NOT BE REQUIRED ON BARRICADES OR DRUMS FOR DAY OPERATIONS. ALL LIGHTS SHALL BE MONODIRECTIONAL.
- 4. REFLECTIVE TEMPORARY PAVEMENT MARKINGS SHALL BE PLACED THROUGHOUT THE BARRICADED AREAS OF EACH TURN BAY AS SHOWN WHERE THE CLOSURE TIME IS GREATER THAN FOURTEEN (14) DAYS.
- 5. THIS APPLICATION ALSO APPLIES WHEN WORK IS BEING PERFORMED IN THE RIGHT LANE(S) AND THE RIGHT TURN BAY IS TO REMAIN OPEN. UNDER THIS CONDITION, "RIGHT TURN LANE" R3-1100R 24 x 24 (600 x 600) AND M6-2R 21 x 15 (530 x 380) SHALL BE USED.
- 6. THESE CONTROLS SHALL SUPPLEMENT MAINLINE TRAFFIC CONTROL FOR LANE CLOSURES.
- 7. THE SIGNS SHALL BE MOUNTED ABOVE THE BARRICADES/DRUMS ON SEPARATE SIGN SUPPORTS THAT MEET NCHRP 350 OR MASH REQUIREMENTS.
- 8. TRAFFIC CONTROL AND PROTECTION AT TURN BAYS (TO REMAIN OPEN TO TRAFFIC) SHALL BE INCLUDED IN THE COST OF SPECIFIED TRAFFIC CONTROL STANDARDS OR ITEMS.

TURN BAY ENTRANCE
WITHIN A LANE CLOSURE

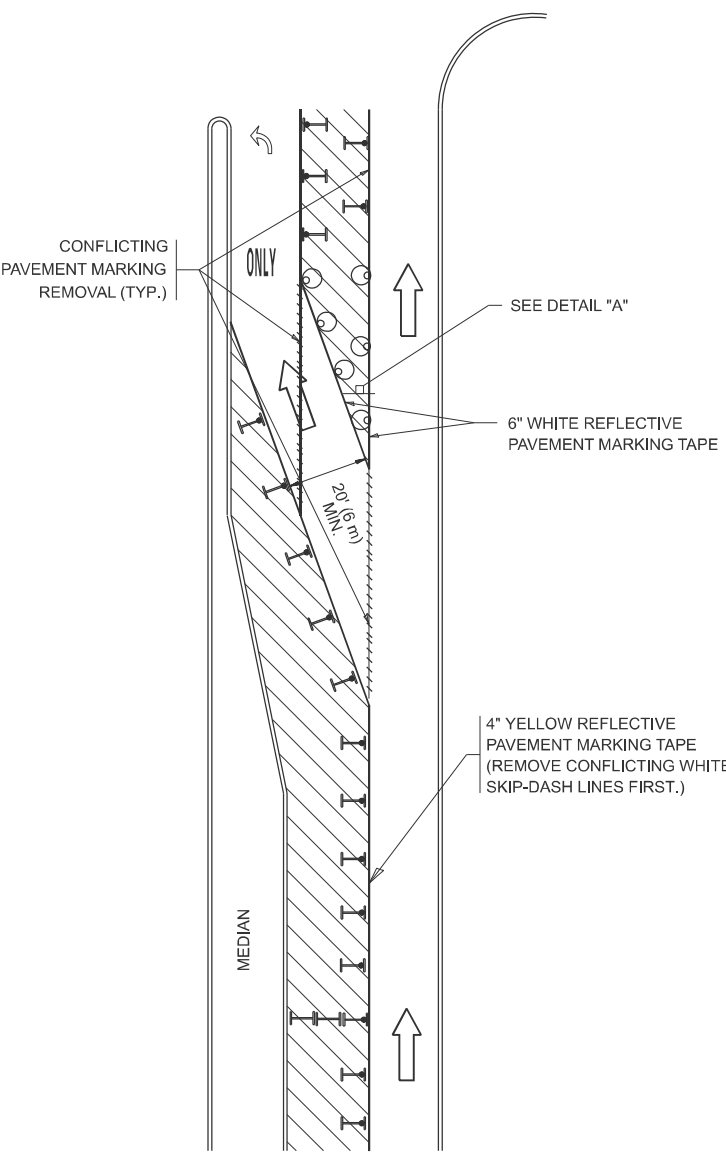
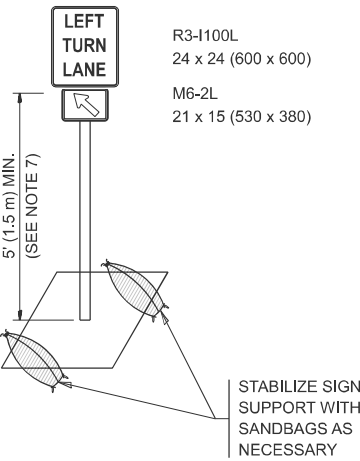

FIGURE 2



DETAIL A

All dimensions are in inches (millimeters) unless otherwise shown.

MODEL: Plan Single [Sheet]
FILE NAME: \\illinois.gov\DOT\Users\COTTHOMASELM\My Documents\Bentley\CONNECT11012\Organization-Civil\DOT_Standards\Drawings\Sheet Seeds\Civil_Named_Boundary_SheetSeeds.dgn

	USER NAME = Eric,L.Thomas	DESIGNED - T. RAMMACHER 09-08-94	REVISED - R. BORO 09-14-09	STATE OF ILLINOIS DEPARTMENT OF TRANSPORTATION	TRAFFIC CONTROL AND PROTECTION AT TURN BAYS (TO REMAIN OPEN TO TRAFFIC)	F.A.I RTE.	SECTION	COUNTY	TOTAL SHEETS	SHEET NO.
		DRAWN - A. HOUSEH 11-07-95	REVISED - A. SCHUETZE 07-01-13			55	2024-1018-RS	COOK	19	17
		CHECKED - A. HOUSEH 10-12-96	REVISED - A. SCHUETZE 09-15-16			TC-14		CONTRACT NO. 62X64		
	PLOT DATE = 8/20/2024	DATE - T. RAMMACHER 01-06-00	REVISED -			ILLINOIS FED. AID PROJECT				

MODEL: Plan Single Sheet]
FILE NAME: \\illinois.gov\DOT\Users\COTHOMASELM\My Documents\Bentley\CONNECT1012\Organization-Civil\DOT_Standards\Dgnlib\Sheet Seeds\Civil_Named_Boundary_SheetSeeds.dgnlib

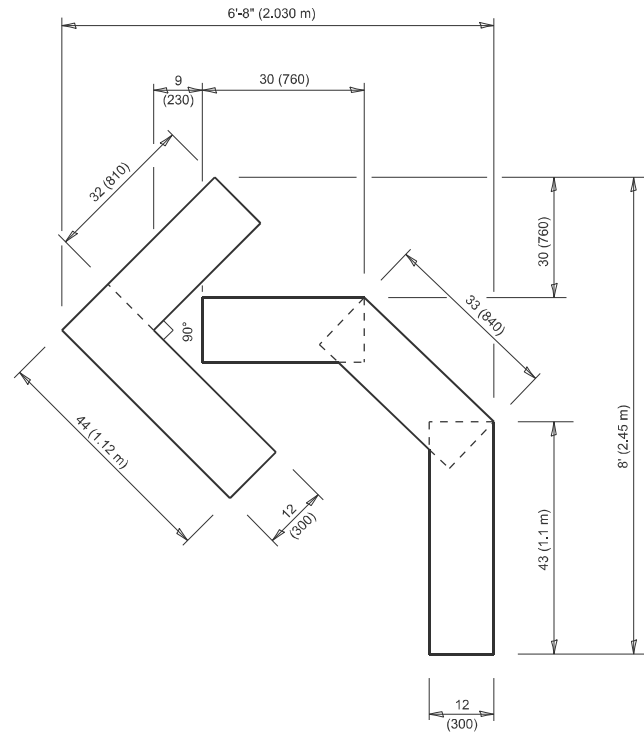

QUANTITY

4 (100) LINE = 45.5 ft. (13.9 m)
15.2 sq. ft. (1.41 sq. m)

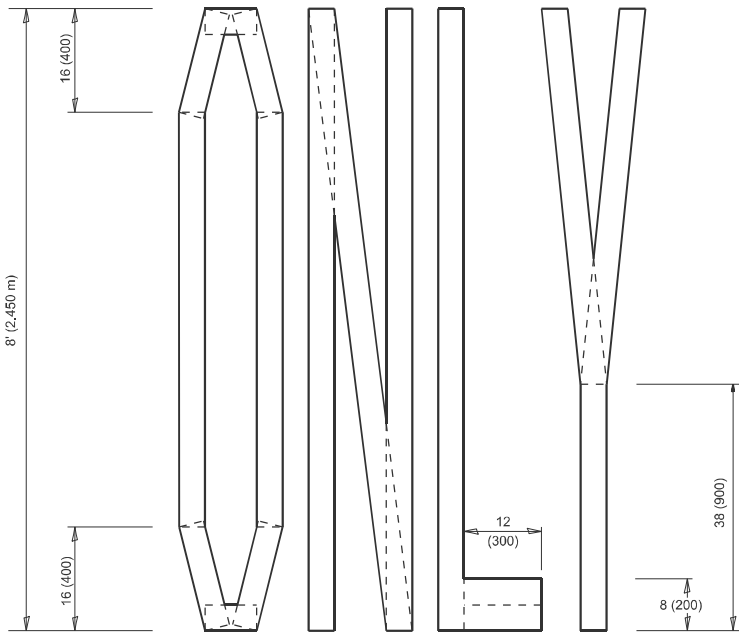
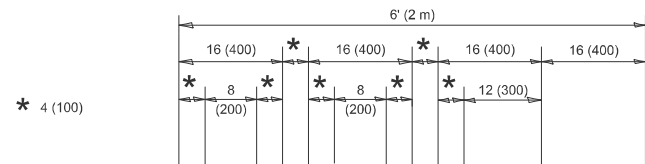

QUANTITY

4 (100) LINE = 64.1 ft. (19.5 m)
21.4 sq. ft. (1.99 sq. m)

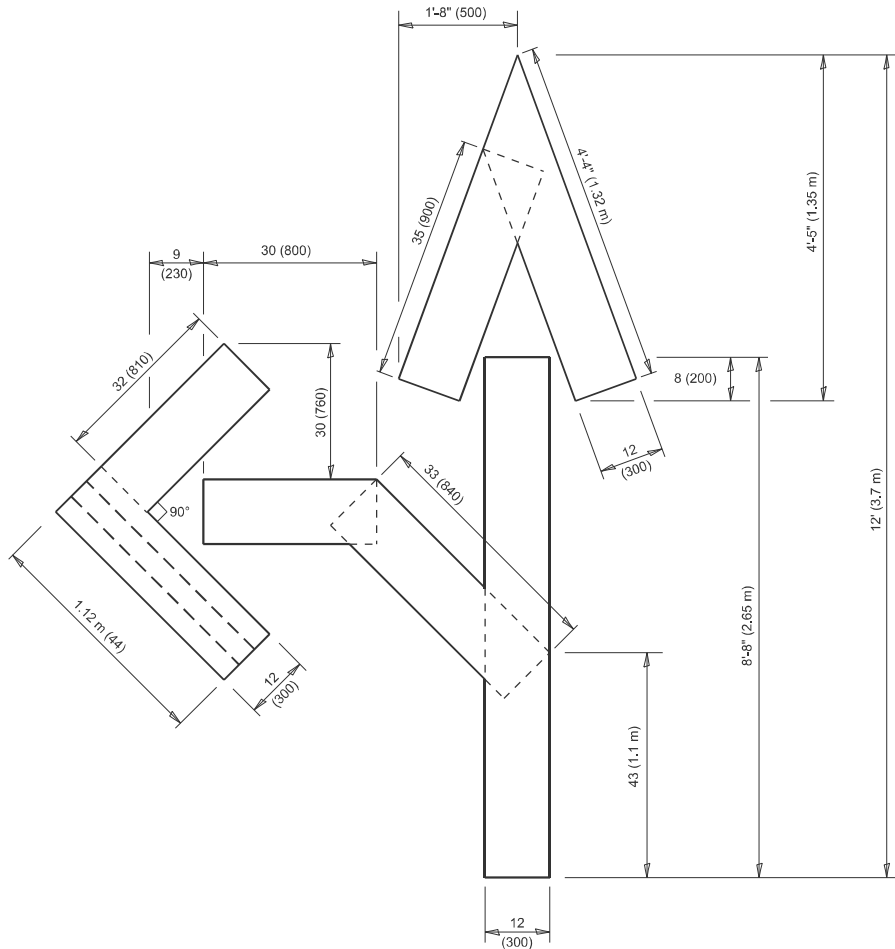

QUANTITY

4 (100) LINE = 82.5 ft. (25.1 m)
27.5 sq. ft. (2.53 sq. m)

NOTE:

ALL QUANTITIES OF PLACEMENT ARE REPRESENTED
IN LINEAR FEET OF 4" LINES TO MATCH THE
4" TEMPORARY TAPE PAY ITEM AND REPRESENTS
THE TOTAL QUANTITY OF 4" TAPE REQUIRED.

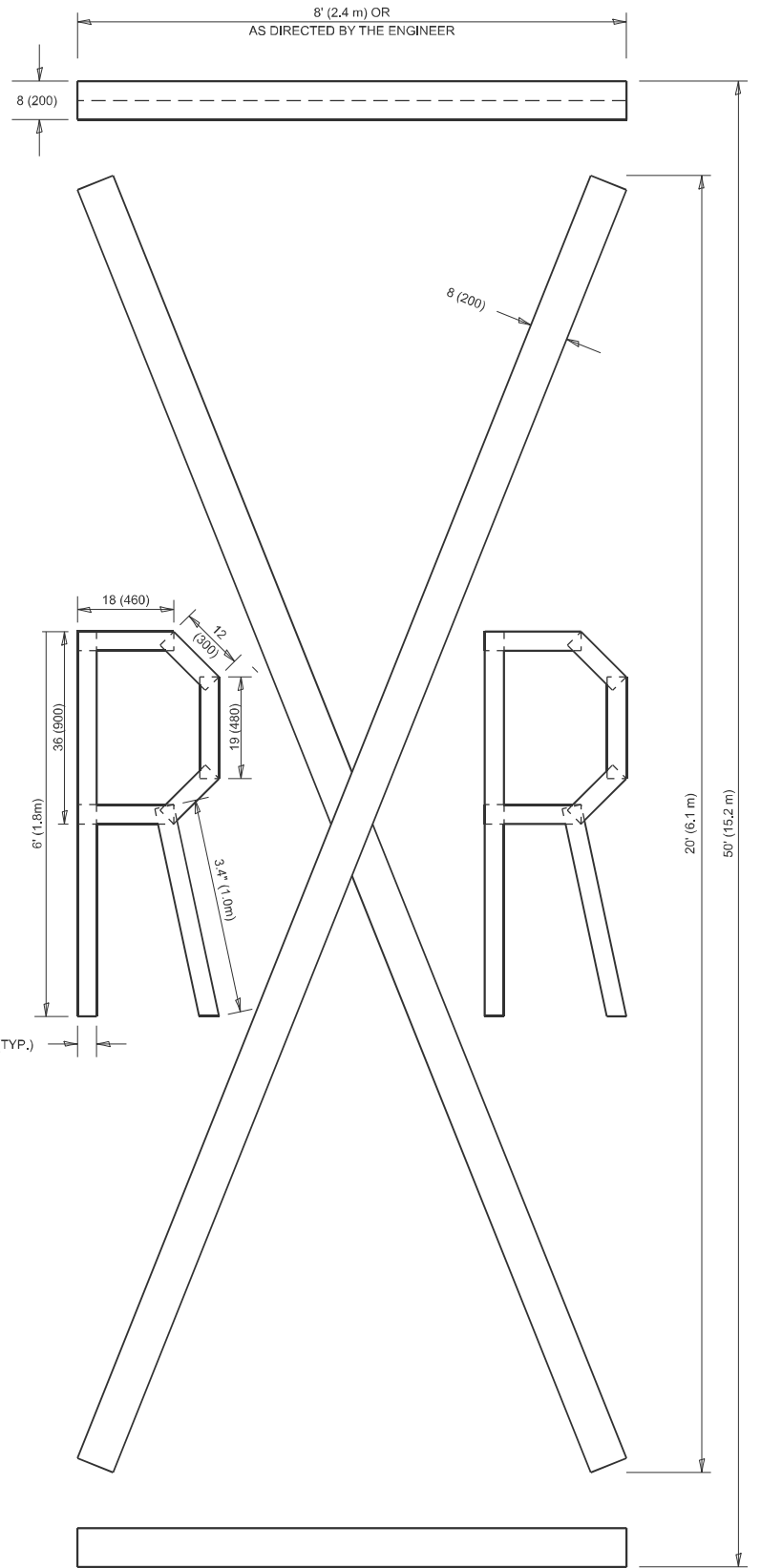

QUANTITY

4 (100) LINE = 225.9 ft. (68.9 m)
75.3 sq. ft. (6.99 sq. m)

All dimensions are in inches (millimeters)
unless otherwise shown.

USER NAME	= Eric.L.Thomas	DESIGNED	-	REVISED	- T. RAMMACHER 03-02-98
		DRAWN	-	REVISED	- E. GOMEZ 08-28-00
		CHECKED	-	REVISED	- E. GOMEZ 08-28-00
PLOT DATE	= 8/20/2024	DATE	- 09-18-94	REVISED	- A. SCHUETZE 09-15-16

**STATE OF ILLINOIS
DEPARTMENT OF TRANSPORTATION**

SHORT TERM PAVEMENT MARKING LETTERS AND SYMBOLS

SCALE: NONE SHEET 1 OF 1 SHEETS STA. TO STA.

F.A.I RTE.	SECTION	COUNTY	TOTAL SHEETS	SHEET NO.
55	2024-1018-RS	COOK	19	18
TC-16		CONTRACT NO. 62X64		
		ILLINOIS	FED. AID PROJECT	

MODEL: Plan Single Sheet]
FILE NAME: \\illinois.gov\DOT\Users\COTTHOMASELM\My Documents\Bentley\CONNECT1\012\Organization-Civil\IDOT_Standards\Dgnlib\Sheet Seeds\Civil_Named_Boundary_SheetSeeds.dgnlib

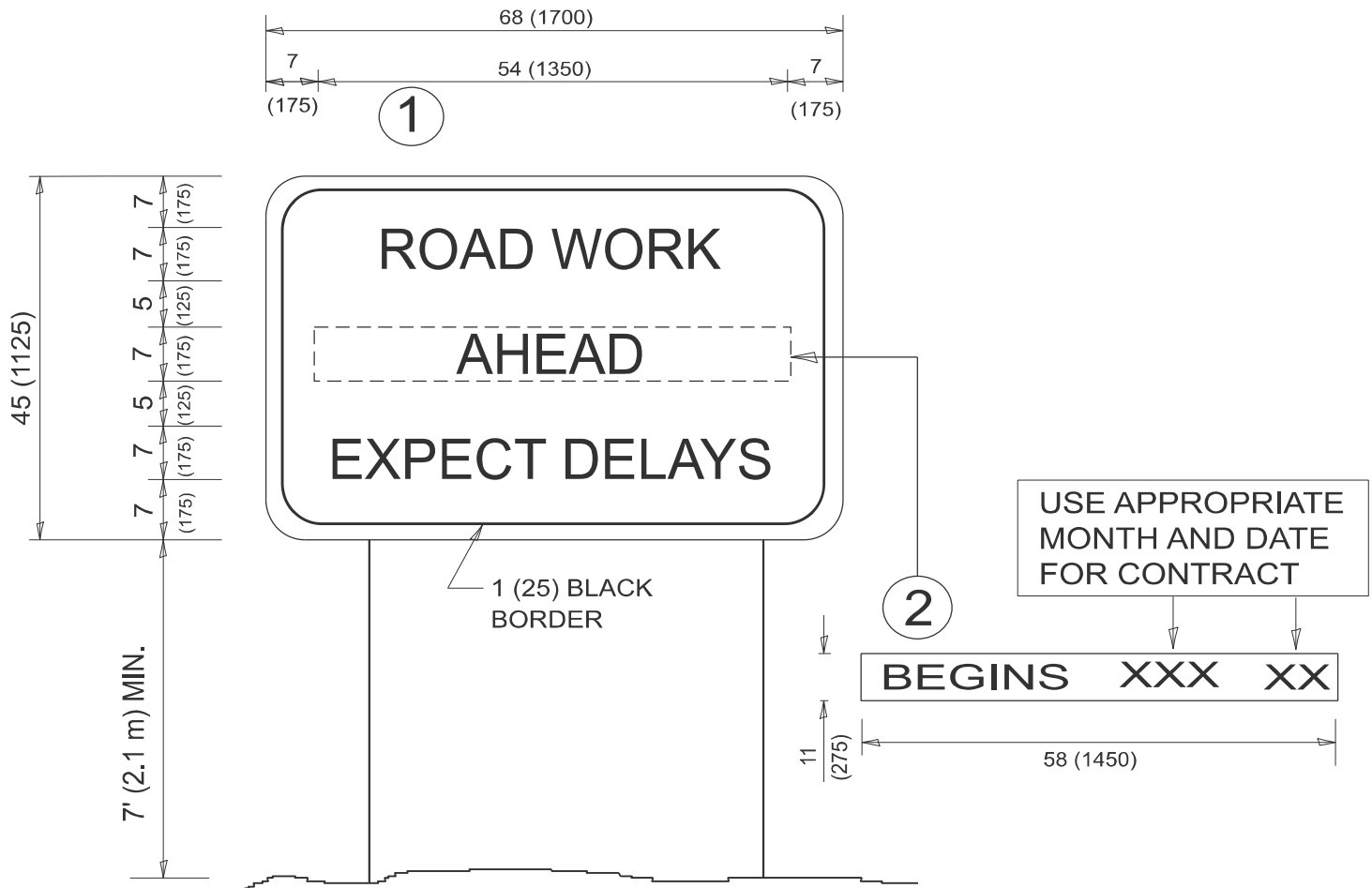

NOTES:

- 1. USE BLACK LETTERING ON ORANGE BACKGROUND.
- 2. ERECT SIGNS IN ADVANCE OF THE LOCATION FOR THE "ROAD CONSTRUCTION AHEAD" SIGN AT LOCATIONS AS DIRECTED BY THE ENGINEER.
- 3. ERECT SIGN ① WITH INSTALLED PANEL ② ONE WEEK PRIOR TO THE START OF CONSTRUCTION.
- 4. REMOVE PANEL ② SOON AFTER THE START OF CONSTRUCTION.
- 5. SEE SPECIAL PROVISION FOR "TEMPORARY INFORMATION SIGNING" FOR ADDITIONAL INFORMATION.
- 6. ONE SIGN ASSEMBLY EQUALS 25.70 SQ. FT. (2.3 SQ. M.)
- 7. SHALL BE PAID FOR AS TEMPORARY INFORMATION SIGNING.

ALL DIMENSIONS ARE IN INCHES (MILLIMETERS)
UNLESS OTHERWISE SHOWN.

	USER NAME = Eric.L.Thomas	DESIGNED -	REVISED - R. MIRS 09-15-97	STATE OF ILLINOIS DEPARTMENT OF TRANSPORTATION	ARTERIAL ROAD INFORMATION SIGN				F.A.I RTE.	SECTION	COUNTY	TOTAL SHEETS	SHEET NO.		
		DRAWN -	REVISED - R. MIRS 12-11-97						55	2024-1018-RS	COOK	19	19		
		CHECKED -	REVISED -T. RAMMACHER 02-02-99						TC-22					CONTRACT NO. 62X64	
	PLOT DATE = 8/20/2024	DATE -	REVISED - C. JUCIUS 01-31-07		SCALE:NONE					SHEET 1	OF 1	SHEETS	STA.	TO STA.	
							ILLINOIS FED. AID PROJECT								