

STATE OF ILLINOIS
DEPARTMENT OF TRANSPORTATION

F.A.U. RTE	SECTION	COUNTY	TOTAL SHEETS	SHEET NO.
2798	2024 1030 RS	COOK	28	1
		ILLINOIS CONTRACT NO. 62X70		

FOR INDEX OF SHEETS, SEE SHEET NO. 2

THE PROJECT IS LOCATED IN THE VILLAGE
OF SKOKIE

TRAFFIC DATA:

2023 ADT - 5600 TO 12700 VPD

SPEED LIMIT - 30 MPH

FUNCTIONAL CLASS: MAJOR COLLECTOR

OMISSIONS:

CHICAGO TRANSIT AUTHORITY (CTA YELLOW LINE)
STA. 24+84 TO 25+01
STA. 25+48 TO 25+66

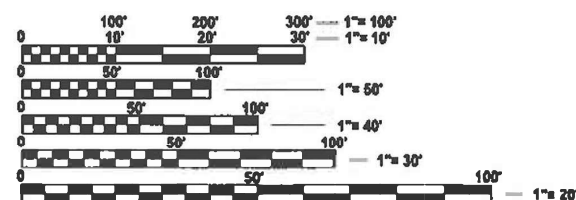

FULL SIZE PLANS HAVE BEEN PREPARED USING STANDARD
ENGINEERING SCALES. REDUCED SIZED PLANS WILL NOT
CONFORM TO STANDARD SCALES. IN MAKING MEASUREMENTS
ON REDUCED PLANS, THE ABOVE SCALES MAY BE USED.

J.U.L.I.E.
JOINT UTILITY LOCATION INFORMATION FOR EXCAVATION
1-800-892-0123
OR 811

PROJECT ENGINEER: VESELIN VELICHKOV (847) 705-4432
PROJECT MANAGER: FAWAD AQUEEL

CONTRACT NO. 62X70

PROPOSED
HIGHWAY PLANS

F.A.U. ROUTE 2798: NILES CENTER ROAD
IL 58 (DEMPSTER STREET) TO MAIN STREET
SECTION: 2024-1030-RS

STANDARD OVERLAY, ADA IMPROVEMENTS
COOK COUNTY

C-91-081-25

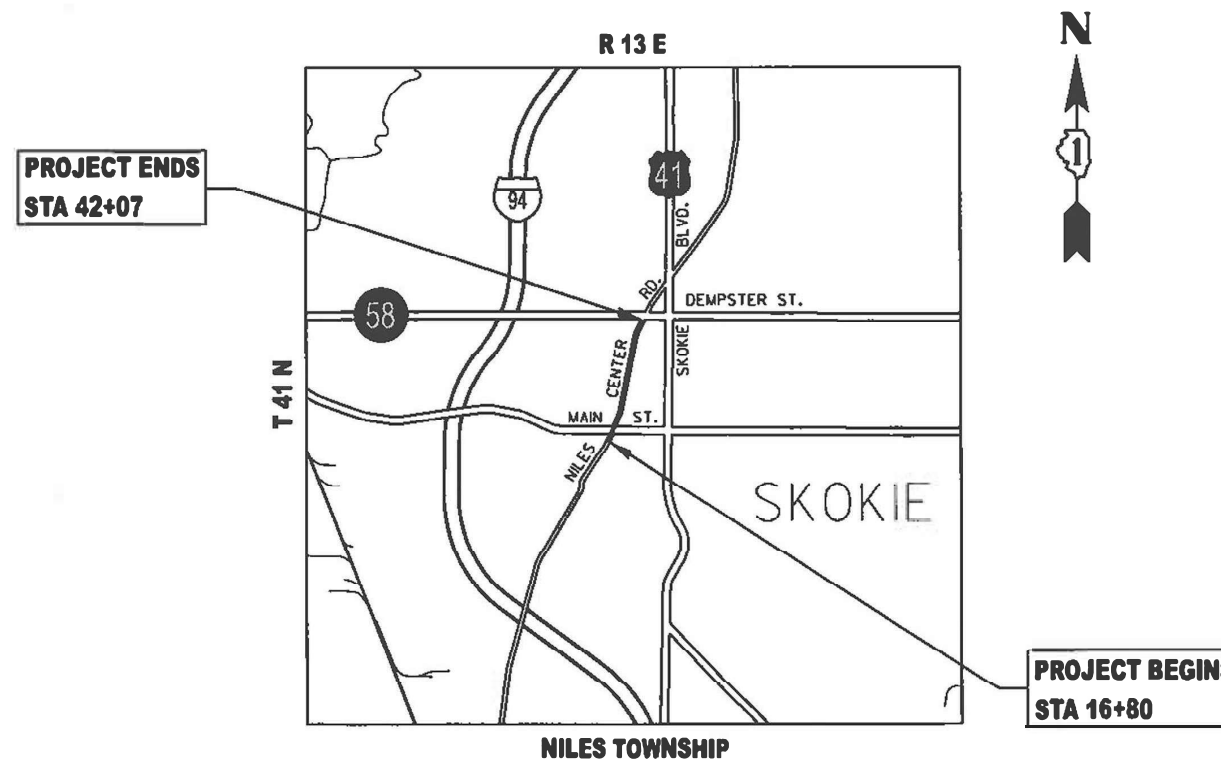

GROSS LENGTH OF PROJECT - 2527 FEET - .48 MILES
NET LENGTH OF PROJECT - 2492 FEET - .47 MILES

D-91-061-25



LOCATION OF SECTION INDICATED THUS: -

STATE OF ILLINOIS
DEPARTMENT OF TRANSPORTATION

SUBMITTED March 19th 2025
James J. [Signature] REGIONAL ENGINEER
May 9 2025
[Signature] ENGINEER OF DESIGN AND ENVIRONMENT
May 9 2025
[Signature] DIRECTOR OF HIGHWAYS PROJECT IMPLEMENTATION

PRINTED BY THE AUTHORITY
OF THE STATE OF ILLINOIS

INDEX OF SHEETS

SHEET NO.	DESCRIPTION
1	COVER SHEET
2	INDEX OF SHEETS, STATE STANDARDS AND GENERAL NOTES
3-5	SUMMARY OF QUANTITIES
6-7	EXISTING AND PROPOSED TYPICAL SECTIONS
8-9	ROADWAY AND PAVEMENT MARKING PLANS
10	DETECTOR LOOP LOCATION AND APS DETAILS
11-12	ADA PEDESTRIAN SIDEWALK PLANS
13-18	ADA SIDEWALK CURB RAMP DETAILS
19	DETAILS FOR FRAMES AND LIDS TO BE ADJUSTED WITH MILLING (BD-08)
20	PAVEMENT PATCHING FOR HMA SURFACED PAVEMENT (BD-22)
21	CURB AND CURB AND GUTTER REMOVAL AND REPLACEMENT (BD-24)
22	BUTT JOINT AND HMA TAPER DETAILS (BD-32)
23	TRAFFIC CONTROL AND PROTECTION FOR SIDE ROADS, INTERSECTIONS AND DRIVEWAYS (TC-10)
24	TYPICAL APPLICATION FOR RAISED REFLECTIVE PAVEMENT MARKERS (SNOW-PLOW RESISTANT) (TC-11)
25	DISTRICT ONE TYPICAL PAVEMENT MARKING (TC-13)
26	TRAFFIC CONTROL AND PROTECTION AT TURN BAYS (TC-14)
27	SHORT-TERM PAVEMENT MARKING--LETTERS AND SYMBOLS (TC-16)
28	ARTERIAL ROAD INFORMATION SIGNING (TC-22)

STATE STANDARDS

000001-08	STANDARD SYMBOLS, ABBREVIATIONS AND PATTERNS
424001-12	PERPENDICULAR CURB RAMPS FOR SIDEWALKS
424006-06	DIAGONAL CURB RAMPS FOR SIDEWALKS
424011-05	CORNER PARALLEL CURB RAMPS FOR SIDEWALKS
424016-06	MID-BLOCK CURB RAMPS FOR SIDEWALKS
424021-07	DEPRESSED CORNER FOR SIDEWALKS
442201-03	CLASS C AND D PATCHES
604001-07	FRAMES AND LIDS, TYPE 1
604086-05	FRAME AND GRATE, TYPE 23
606001-08	CONCRETE CURB TYPE B AND COMBINATION CONCRETE CURB AND GUTTER
701006-05	OFF-ROAD OPERATIONS 2L, 2W, 15' TO 24' FROM PAVEMENT EDGE
701011-04	OFF-ROAD MOVING OPERATIONS, 2L, 2W, DAY ONLY
701301-04	LANE CLOSURE, 2L, 2W, SHORT TIME OPERATIONS
701311-03	LANE CLOSURE, 2L, 2W, MOVING OPERATIONS DAY ONLY
701501-06	URBAN LANE CLOSURE, 2L, 2W, UNDIVIDED
701502-09	URBAN LANE CLOSURE, 2L, 2W WITH BI-DIRECTIONAL LEFT TURN LANE
701701-10	URBAN LANE CLOSURE, MULTILANE INTERSECTION
701801-06	SIDEWALK OR SIDEWALK CLOSURE CORNER
701901-10	TRAFFIC CONTROL DEVICES
780001-05	TYPICAL PAVEMENT MARKINGS
781001-04	TYPICAL APPLICATION FOR RAISED REFLECTIVE PAVEMENT MARKERS
814001-03	HANDHOLES
886001-01	DETECTOR LOOP INSTALLATIONS
886006-01	TYPICAL LAYOUTS FOR DETECTION LOOPS

GENERAL NOTES

- 1) BEFORE STARTING ANY EXCAVATION, THE CONTRACTOR SHALL CALL "JULIE AT (800) 892-0123 OR 811 FOR FIELD LOCATIONS OF BURIED ELECTRIC, TELEPHONE AND GAS FACILITIES, (48 HOURS NOTIFICATION IS REQUIRED).
- 2) TEN (10) FOOT TRANSITION SHALL BE USED TO MATCH PROPOSED CURB AND GUTTER AND MEDIAN ITEMS OF WORK TO EXISTING CURBS AND GUTTERS AND MEDIANS IN THE FIELD, UNLESS OTHERWISE SHOWN. THE TRANSITION SHALL BE PAID FOR AT THE CONTRACT UNIT PRICE FOR THE PROPOSED ITEMS OF WORK SPECIFIED.
- 3) THE CONTRACTOR SHALL COORDINATE CONSTRUCTION ACTIVITIES WITH THE UTILITY COMPAINES AND THE VILLAGE OF SKOKIE.
- 4) THE CONTRACTOR WILL NOT BE ALLOWED TO SET UP A YARD OR FIELD OFFICE ON STATE PROPERTY WITHOUT WRITTEN PERMISSION FROM THE DEPARTMENT INCLUDING THE ROADSIDE DEVELOPMENT UNIT.
- 5) ANY PAVEMENT MARKINGS AND RAISED REFLECTIVE PAVEMENT MARKERS OBLITERATED BY MILLING AND RESURFACING OPERATIONS ON SIDE STREETS AND ENTRANCES SHALL BE REPLACED AND PAID FOR IN KIND.
- 6) ALL DAMAGE TO EXISTING PAVEMENT MARKINGS OR RAISED REFLECTIVE PAVEMENT MARKERS OUTSIDE THE REMOVAL LINE SHOWN ON THE PLANS SHALL BE REPLACED AT NO ADDITIONAL COST TO THE DEPARTMENT.
- 7) ALL PAVEMENT PATCHING LOCATIONS WILL BE DETERMINED IN THE FIELD BY THE ENGINEER.
- 8) LOCATION OF COMBINATION CONCRETE CURB AND GUTTER REMOVAL AND REPLACEMENT [OR COMBINATION CURB AND AND GUTTER (THE TYPE SPECIFIED ON THE PLANS)], WILL BE DETERMINED IN THE FIELD BY THE ENGINEER.
- 9) DRAINAGE ADJUSTMENT OR RECONSTRUCTION LOCATIONS WILL BE DETERMINED IN THE FIELD BY THE ENGINEER.
- 10) IT SHALL BE THE CONTRACTORS RESPONSIBILITY TO VERIFY ALL DIMENSIONS AND EXISTING CONDITIONS IN THE FIELD PRIOR TO CONSTRUCTION AND ORDERING OF MATERIALS.
- 11) FRAMES AND GRATES ADJUSTMENTS OF PRIVATE UTILITIES WITHIN THE LIMITS OF THE IMPROVEMENT SHALL BE DONE BY THEIR RESPECTIVE OWNERS AND ARE NOT IN PART OF THIS CONTRACT.
- 12) BEFORE BEGINNING ANY WORK, THE CONTRACTOR SHALL RETAIN AND RECORD FOR FUTURE REFERENCE, ALL EXISTING PAVEMENT MARKING LINES (RAISED REFLECTIVE PAVEMENT MARKERS) IN ORDER THAT THESE LOCATIONS CAN BE RE-ESTABLISHED FOR STRIPING. EXACT LOCATIONS OF ALL PAVEMENT MARKINGS SHALL BE AS SHOWN ON THE PLANS OR AS DIRECTED BY THE ENGINEER.
- 13) WHEN THE MILLED PAVEMENT IS OPEN TO TRAFFIC THE MAXIMUM GRADE DIFERENTIAL BETWEEN PASSES OF THE MILLING MACHINE SHALL NOT EXCEED 1 1/2 INCH (40 mm) WHERE THE SPEED LIMIT IS 40 MPH (80 km/ h) OR LESS AND 1 INCH (25 mm) WHERE THEN SPEED LIMIT IS GREATER THAN 40 MPH (80 km/ h), WITH WRITTEN APPROVAL OF THE ENGINEER, A MAXIMUM GRADE DIFFERENTIAL 3 INCHES (75 mm) MAY BE ALLOWED IF THE EDGE OF THE MILLING MACHINE IS SLOPED A MINIMUM OF (1:3).
- 14) THE CONTRACTOR SHALL CONTACT THE DISTRICT ONE TRAFFIC CONTROL SUPERVISOR FOR ARTERIALS AT KALPANA.KANNAN-HOSADURGA@ILLINOIS.GOV A MINIMUM OF 72 HOURS IN ADVANCE OF BEGINNING WORK.
- 15) PERMANENT PAVEMENT MARKINGS SHALL BE THERMOPLASTIC (OF THE EXTRUDED TYPE) AND SHOULD BE PLACED IN ACCORDANCE WITH THE "DISTRICT ONE TYPICAL PAVEMENT MARKINGS" DETAIL. (TC-13)
- 16) THE RESIDENT ENGINEER SHALL CONTACT MR. EMAD ALHUSSEINI, AREA TRAFFIC ENGINEER, EMAD.LHUSSEINI@ILLINOIS.GOV, A MINIMUM OF TWO (2) WEEKS PRIOR TO THE PLACEMENT OF PERMANENT PAVEMENT MARKINGS.
- 17) THE CONTRACTOR SHALL MAINTAIN PEDESTRIAN ACCESS AT ALL TIMES DURING CONSTRUCTION.
- 18) THE CONTRACTOR SHALL CONTACT THE ROADSIDE DEVELOPMENT UNIT AT (847) 705-4171 AT LEAST TWO WEEKS PRIOR TO BEGINNING LANDSCAPE AND FORESTRY WORK FOR LAYOUT.
- 19) PAVEMENT MARKING TAPE, TYPE IV SHALL BE USED FOR SHORT-TERM PAVEMENT MARKING ON ALL FINAL SURFACES.
- 20) ALL MILLED SURFACES SHALL BE AT A UNIFORM CROSS SLOPE PER LANE AND FREE OF RIDGES BETWEEN PASSES. ANY DEVIATIONS SHALL BE CORRECTED AT NO COST TO THE DEPARTMENT.
- 21) THE "ROAD CONSTRUCTION AHEAD" SIGNS SHALL REMAIN INSTALLED UNTIL THE COMPLETION OF THE PROJECT OR WHEN NO ROADWAY HAZARDS REMAIN WITHIN THE WORK ZONE.
- 22) OVERNIGHT LANE CLOSURE SHALL NOT BE ALLOWED FOR REHABILITATION PROJECTS INVOLVING DAYTIME MILLING AND RESURFACING OPERATIONS AND CLASS D PATCHING UNLESS OTHER CONDITIONS WARRANT EXTENDED LANE CLOSURES AS DETERMINED AND APPROVED IN WRITING BY THE ENGINEER OR AS PROVIDED FOR IN THE CONTRACT SPECIFICATIONS.

MODEL: Default
FILE NAME: c:\pwwork\pwwork\steed\paid1036857\D106125-shHypical.dgn

	USER NAME = Phillip.Steed	DESIGNED -	REVISED -	STATE OF ILLINOIS DEPARTMENT OF TRANSPORTATION	INDEX OF SHEETS, STATE STANDARDS AND GENERAL NOTES FAU 2798 (NILES CENTER RD.)--IL 58 (DEMPSTER ST.) TO MAIN ST.			F.A.U. RTE.	SECTION	COUNTY	TOTAL SHEETS	SHEET NO.
		DRAWN -	REVISED -					2798	2024 1030 RS	COOK	28	2
		CHECKED -	REVISED -					CONTRACT NO. 62X70				
	PLOT DATE = 3/21/2025	DATE -	REVISED -		SCALE:	SHEET	OF	SHEETS	STA.	TO STA.	ILLINOIS FED. AID PROJECT	

Model: Default
File Name: p:\1\dot-sw-bentley.com\FWIDOT\Documents\DOT 0 cas\District 1\ORSD Projects\J06125\CADData\CADsheets\J06125-sh-500.dgn

SUMMARY OF QUANTITIES				TOTAL QUANTITIES	CONSTRUCTION TYPE CODE						SUMMARY OF QUANTITIES				TOTAL QUANTITIES	CONSTRUCTION TYPE CODE					
CODE NO	ITEM	UNIT	100% STATE		100% STATE					CODE NO	ITEM	UNIT	100% STATE	100% STATE							
			0005		0005								0005	0005							
20200100	EARTH EXCAVATION	CU YD	20	20						44000600	SIDEWALK REMOVAL	SQ FT	714	714							
21101615	TOPSOIL FURNISH AND PLACE, 4"	SQ YD	64	64						44201803	CLASS D PATCHES, TYPE II, 13 INCH	SQ YD	566	566							
25200110	SODDING, SALT TOLERANT	SQ YD	64	64						44201807	CLASS D PATCHES, TYPE III, 13 INCH	SQ YD	340	340							
40600290	BITUMINOUS MATERIALS (TACK COAT)	POUND	7635	7635						44201809	CLASS D PATCHES, TYPE IV, 13 INCH	SQ YD	227	227							
40600370	LONGITUDINAL JOINT SEALANT	FOOT	4840	4840						60300105	FRAMES AND GRATES TO BE ADJUSTED	EACH	3	3							
40600400	MIXTURE FOR CRACKS, JOINTS, AND	TON	17	17						60300305	FRAMES AND LIDS TO BE ADJUSTED	EACH	9	9							
	FLANGEWAYS																				
										★ 66900200	NON-SPECIAL WASTE DISPOSAL	CU YD	20	20							
40600982	HOT-MIX ASPHALT SURFACE REMOVAL - BUTT	SQ YD	444	444																	
	JOINT									★ 66900530	SOIL DISPOSAL ANALYSIS	EACH	1	1							
40603200	POLYMERIZED HOT-MIX ASPHALT BINDER	TON	467	467						★ 66901001	REGULATED SUBSTANCES PRE-CONSTRUCTION	L SUM	1	1							
	COURSE, IL-4.75, N50										PLAN										
40604062	HOT-MIX ASPHALT SURFACE COURSE, IL-9.5,	TON	951	951						★ 66901003	REGULATED SUBSTANCES FINAL CONSTRUCTION	L SUM	1	1							
	MIX "D", N70										REPORT										
42001300	PROTECTIVE COAT	SQ YD	154	154						★ 66901006	REGULATED SUBSTANCES MONITORING	CAL DA	10	10							
42400200	PORTLAND CEMENT CONCRETE SIDEWALK 5	SQ FT	714	714						67100100	MOBILIZATION	L SUM	1	1							
	INCH																				
										70102620	TRAFFIC CONTROL AND PROTECTION,	L SUM	1	1							
42400800	DETECTABLE WARNINGS	SQ FT	121	121							STANDARD 701501										
44000158	HOT-MIX ASPHALT SURFACE REMOVAL, 2	SQ YD	11311	11311						70102622	TRAFFIC CONTROL AND PROTECTION,	L SUM	1	1							
	1/4"										STANDARD 701502										
			USER NAME = Phillip.Steed		DESIGNED -		REVISED -		STATE OF ILLINOIS DEPARTMENT OF TRANSPORTATION			SUMMARY OF QUANTITIES FAU 2798 (NILES CENTER RD.)-IL 58 (DEMPSTER ST.) TO MAIN ST.				F.A.U. RTE.	SECTION		COUNTY	TOTAL SHEETS	SHEET NO.
			DRAWN -		REVISED -		2798	2024-1030-RS								COOK	27	3			
			PLOT SCALE = \$SCALE\$		CHECKED -		REVISED -									CONTRACT NO. 62X70					
			PLOT DATE = 3/21/2025		DATE -		REVISED -					SCALE: NONE		SHEET	OF	SHEETS	STA.	TO STA.		ILLINOIS FED. AID PROJECT	

Model: Default
File Name: p:\1\idnt-sw-bentley.com\FWIDOT\Documents\DOT 0 csg\District 1\ORBD Projects\J106125\CADData\CADsheets\J106125-sh-500.dgn

SUMMARY OF QUANTITIES				TOTAL QUANTITIES	CONSTRUCTION TYPE CODE				
CODE NO	ITEM	UNIT	100% STATE		100% STATE				
			0005		0005				
70102635	TRAFFIC CONTROL AND PROTECTION,	L SUM	1	1					
	STANDARD 701701								
70102640	TRAFFIC CONTROL AND PROTECTION,	L SUM	1	1					
	STANDARD 701801								
70300100	SHORT TERM PAVEMENT MARKING	FOOT	846	846					
70300150	SHORT TERM PAVEMENT MARKING	SQ FT	94	94					
	REMOVAL								
70300211	TEMPORARY PAVEMENT MARKING LETTERS AND	SQ FT	984	984					
	SYMBOLS - PAINT								
70300221	TEMPORARY PAVEMENT MARKING - LINE 4"-	FOOT	6927	6927					
	PAINT								
70300241	TEMPORARY PAVEMENT MARKING - LINE 6"-	FOOT	1323	1323					
	PAINT								
70300261	TEMPORARY PAVEMENT MARKING - LINE 12"-	FOOT	3183	3183					
	PAINT								
70300281	TEMPORARY PAVEMENT MARKING - LINE 24"-	FOOT	924	924					
	PAINT								
70307120	TEMPORARY PAVEMENT MARKING	FOOT	282	282					
	- LINE 24" - TYPE IV TAPE								
★ 78000100	THERMOPLASTIC PAVEMENT MARKING -	SQ FT	328	328					
	LETTERS AND SYMBOLS								

SUMMARY OF QUANTITIES				TOTAL QUANTITIES	CONSTRUCTION TYPE CODE				
CODE NO	ITEM	UNIT	100% STATE		100% STATE				
			0005		0005				
★ 78000200	THERMOPLASTIC PAVEMENT MARKING - LINE	FOOT	2309	2309					
	4"								
★ 78000400	THERMOPLASTIC PAVEMENT MARKING - LINE	FOOT	441	441					
	6"								
★ 78000600	THERMOPLASTIC PAVEMENT MARKING - LINE	FOOT	1061	1061					
	12"								
★ 78000650	THERMOPLASTIC PAVEMENT MARKING - LINE	FOOT	308	308					
	24"								
★ 78100100	RAISED REFLECTIVE PAVEMENT MARKER	EACH	91	91					
78300200	RAISED REFLECTIVE PAVEMENT MARKER	EACH	82	82					
	REMOVAL								
78300202	PAVEMENT MARKING REMOVAL - WATER	SQ FT	94	94					
	BLASTING								
X0320050	CONSTRUCTION LAYOUT (SPECIAL)	L SUM	1	1					
X4400501	COMBINATION CURB AND GUTTER REMOVAL AND	FOOT	379	379					
	REPLACEMENT LESS THAN OR EQUAL TO 10								
	FEET								
X5537800	STORM SEWERS TO BE CLEANED 12"	FOOT	475	475					
X6030310	FRAMES AND LIDS TO BE ADJUSTED	EACH	26	26					
	(SPECIAL)								

		USER NAME = Phillip.Steed		DESIGNED -		REVISED -		STATE OF ILLINOIS DEPARTMENT OF TRANSPORTATION				SUMMARY OF QUANTITIES				F.A.U. RTE.	SECTION		COUNTY	TOTAL SHEETS	SHEET NO.	
		PLOT SCALE = \$SCALE\$		DRAWN -		REVISED -						FAU 2798 (NILES CENTER RD.)-IL 58 (DEMPSTER ST.) TO MAIN ST.				2798	2024-1030-RS		COOK	27	4	
		PLOT DATE = 3/21/2025		CHECKED -		REVISED -										CONTRACT NO. 62X70						
				DATE -		REVISED -													ILLINOIS	FED. AID PROJECT		

[illegible]

MODEL: Default
FILE NAME: c:\pwwork\pwwork\steed\paid1036857\0106125-shTypical.dgn

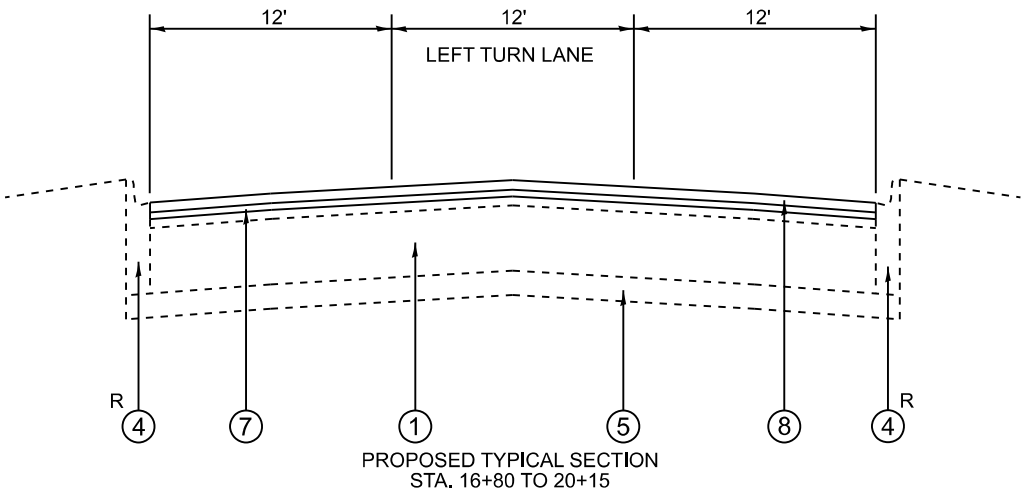
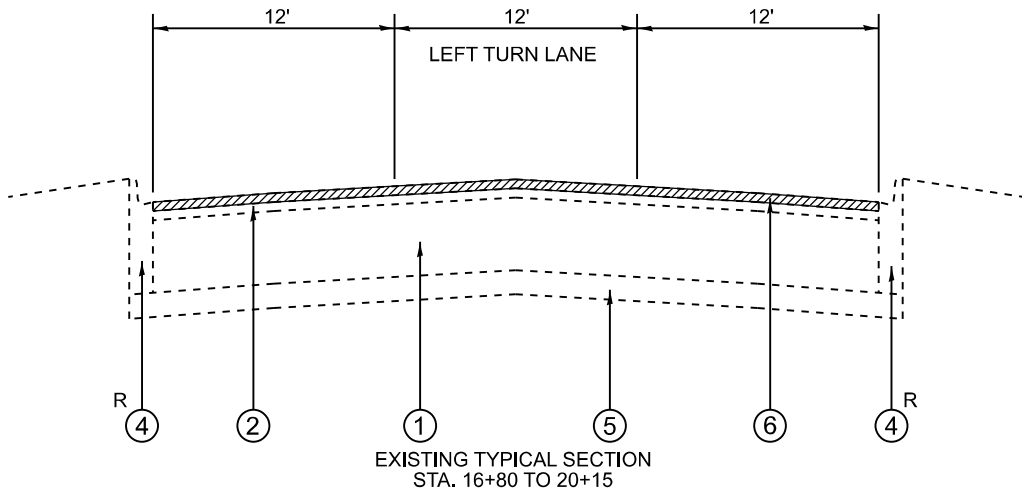

LEGEND:

- ① EXISTING P.C.C. PAVEMENT, PLUS OR MINUS 9"
- ② EXISTING HOT-MIX ASPHALT SURFACE, PLUS OR MINUS 6" (AFTER MILLING)
- ③ EXISTING BARRIER MEDIAN
- ④ EXISTING COMBINATION CONCRETE CURB AND GUTTER, TYPE B-6.12
- ⑤ EXISTING STABILIZED SUB-BASE
- ⑥ PROPOSED HOT-MIX ASPHALT SURFACE REMOVAL, 2 1/4"
- ⑦ PROPOSED POLYMERIZED HOT-MIX ASPHALT BINDER COURSE, IL-4.75, N50, 3/4"
- ⑧ PROPOSED HOT-MIX ASPHALT SURFACE COURSE, MIX 'D', IL-9.5, N70, 1 1/2"
- R CURB AND GUTTER REMOVAL AND REPLACEMENT (AS DIRECTED BY THE ENGINEER)

MIXTURE REQUIREMENTS

MIXTURE TYPE	AIR VOIDS @ Ndes	QMP
PATCHING		
CLASS "D" PATCHES (HMA BINDER, IL-19MM)	4% @ 70 GYR.	QC / QA
PAVEMENT RESURFACING (STANDARD OVERLAY)		
POLYMERIZED HOT-MIX ASPHALT BINDER COURSE, IL-4.75, N50, 3/4"	3.5% @ 50 GYR.	QC / QA
HOT-MIX ASPHALT SURFACE COURSE, MIX 'D', IL-9.5, N70, 1 1/2"	4% @ 70 GYR.	QC / QA
QMP DESIGNATION: QUALITY CONTROL FOR PERFORMANCE (QCP); QUALITY CONTROL / QUALITY ASSURANCE (QC / QA); PAY FOR PERFORMANCE (PFP)		

NOTES:

- THE UNIT WEIGHT USED TO CALCULATE ALL HOT-MIX ASPHALT SURFACE QUANTITIES IS 112 LBS./SQ. YD./ IN.
- THE "AC TYPE" FOR POLYMERIZED HMA MIXES SHALL BE "SBS/SBR PG 76 -22" AND FOR NON-POLYMERIZED HMA THE "AC TYPE" SHALL BE "PG 64 -22" UNLESS MODIFIED BY RECLAIMED MATERIAL SPECIFICATIONS.
- THE MILLING SHALL BE DONE PRIOR TO PATCHING
- THE LONGITUDINAL JOINT SEALANT SHALL BE PLACED ON THE POLYMERIZED HOT-MIX ASPHALT BINDER COURSE, IL-4.75, N50.

USER NAME = Phillip.Steed	DESIGNED -	REVISED -
	DRAWN -	REVISED -
	CHECKED -	REVISED -
PLOT DATE = 3/21/2025	DATE -	REVISED -

STATE OF ILLINOIS
DEPARTMENT OF TRANSPORTATION

EXISTING AND PROPOSED TYPICAL SECTIONS
FAU 2798 (NILES CENTER RD.)-IL 58 (DEMPSTER ST.) TO MAIN ST.

SCALE: SHEET OF SHEETS STA. TO STA.

F.A.U. RTE.	SECTION	COUNTY	TOTAL SHEETS	SHEET NO.
2798	2024 1030 RS	COOK	28	6
CONTRACT NO. 62X70				
ILLINOIS FED. AID PROJECT				

MODEL: Default
FILE NAME: c:\p\work\pwtolsted\paid1036957\06125-shTypical.dgn

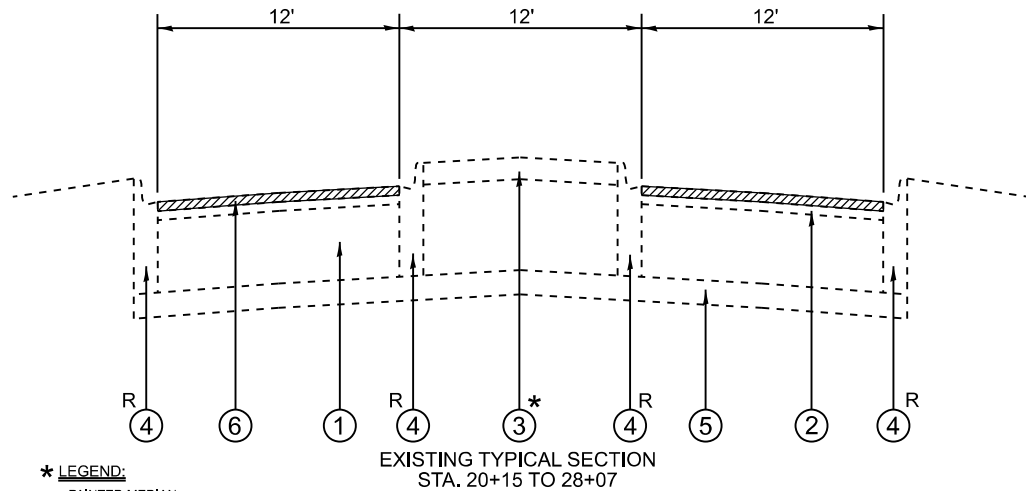

★ **LEGEND:**

PAINTED MEDIAN
STA. 20+15 TO STA. 23+76
STA. 25+66 TO STA. 28+07

BARRIER MEDIAN
STA. 23+76 TO STA. 24+76

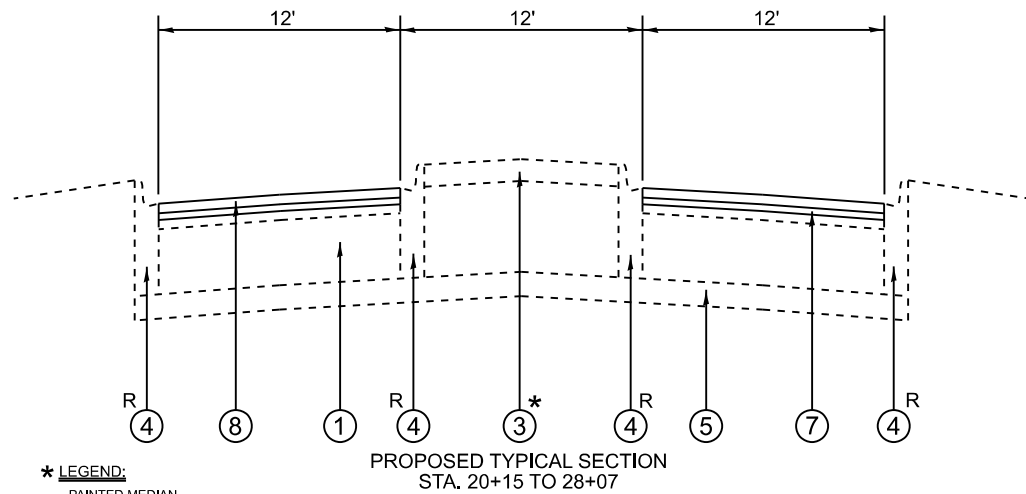

★ **LEGEND:**

PAINTED MEDIAN
STA. 20+15 TO STA. 23+76
STA. 25+66 TO STA. 28+07

BARRIER MEDIAN
STA. 23+76 TO STA. 24+76

LEGEND:

- ① EXISTING P.C.C. PAVEMENT, PLUS OR MINUS 9"
- ② EXISTING HOT-MIX ASPHALT SURFACE, PLUS OR MINUS 6" (AFTER MILLING)
- ③ EXISTING BARRIER MEDIAN
- ④ EXISTING COMBINATION CONCRETE CURB AND GUTTER, TYPE B-6.12
- ⑤ EXISTING STABILIZED SUB-BASE
- ⑥ PROPOSED HOT-MIX ASPHALT SURFACE REMOVAL, 2 1/4"
- ⑦ PROPOSED POLYMERIZED HOT-MIX ASPHALT BINDER COURSE, IL-4.75, N50, 3/4"
- ⑧ PROPOSED HOT-MIX ASPHALT SURFACE COURSE, MIX 'D', IL-9.5, N70, 1 1/2"
- R CURB AND GUTTER REMOVAL AND REPLACEMENT (AS DIRECTED BY THE ENGINEER)

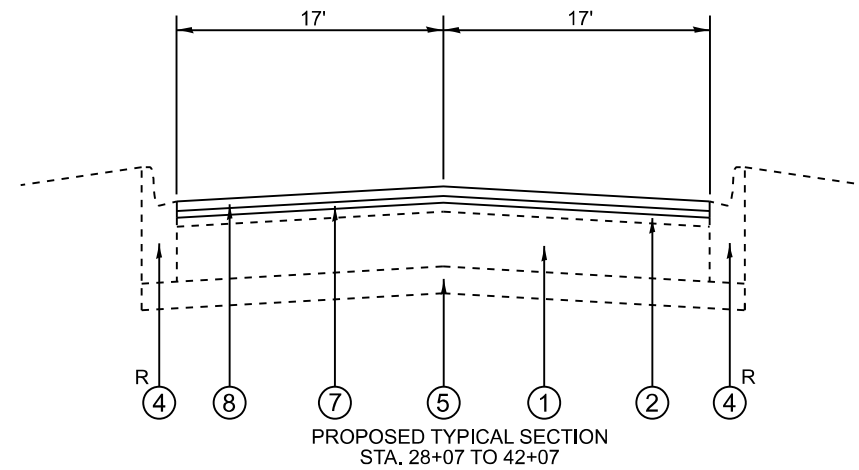
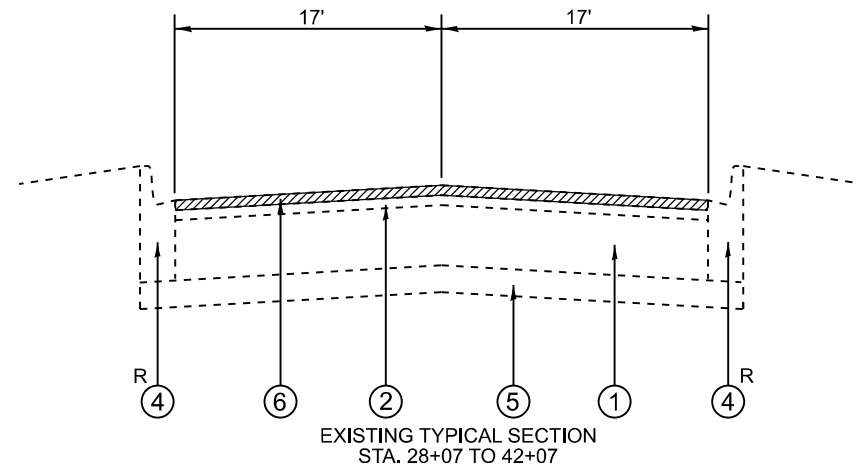

STATE OF ILLINOIS
DEPARTMENT OF TRANSPORTATION

EXISTING AND PROPOSED TYPICAL SECTIONS
FAU 2798 (NILES CENTER RD.)-IL 58 (DEMPSTER ST.) TO MAIN ST.

SCALE: SHEET OF SHEETS STA. TO STA.

F.A.U. RTE.	SECTION	COUNTY	TOTAL SHEETS	SHEET NO.
2798	2024 1030 RS	COOK	28	7
CONTRACT NO. 62X70				
ILLINOIS FED. AID PROJECT				

MODEL: NilesCenterRd_E_RoadwayPlan_1 [Sheet]
FILE NAME: c:\pwworking\dwg\std\paid\1036957\106125-shh-plan.dgn

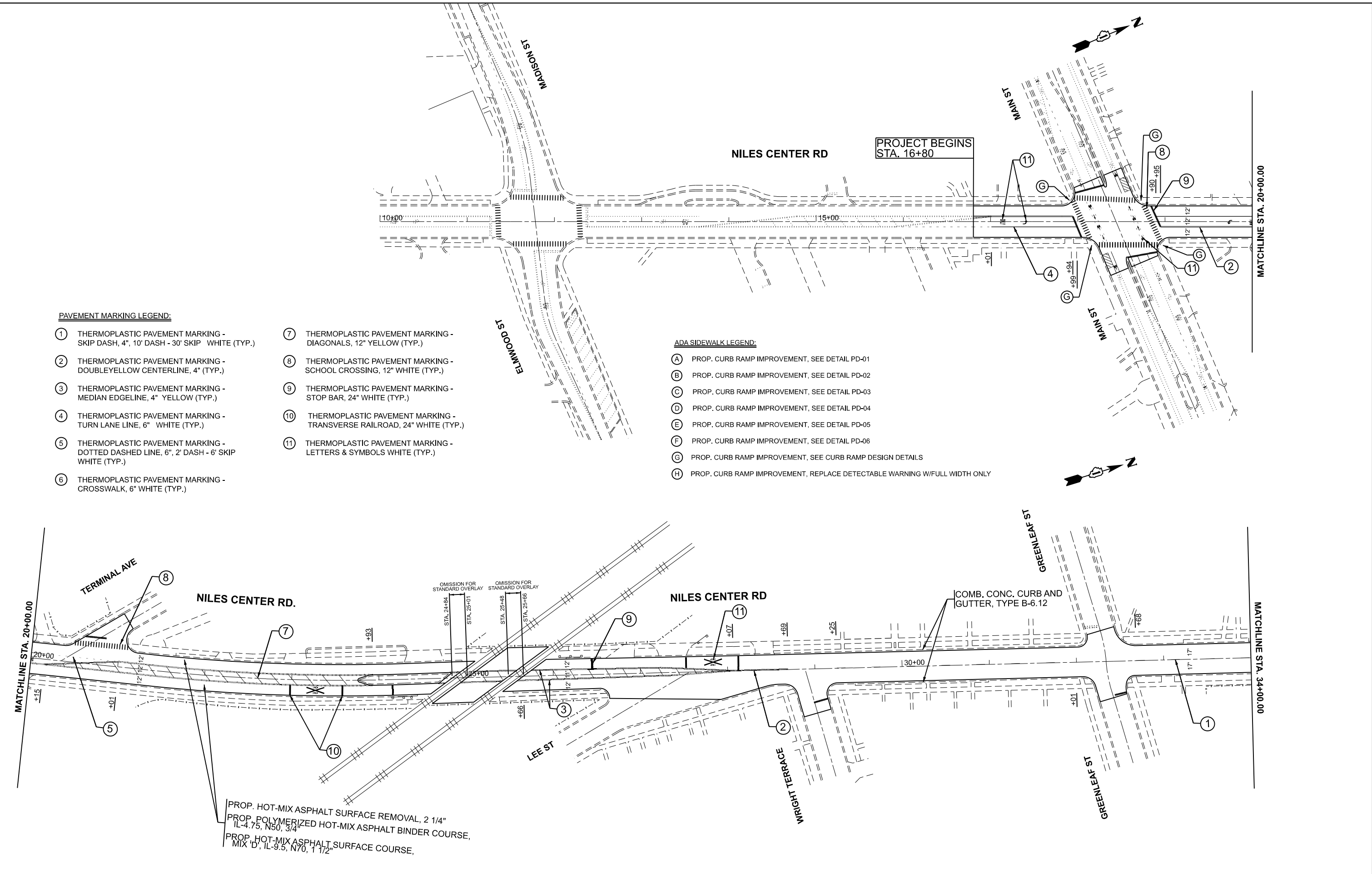

PAVEMENT MARKING LEGEND:

- 1

THERMOPLASTIC PAVEMENT MARKING - SKIP DASH, 4", 10' DASH - 30' SKIP WHITE (TYP.)
- 2

THERMOPLASTIC PAVEMENT MARKING - DOUBLEYELLOW CENTERLINE, 4" (TYP.)
- 3

THERMOPLASTIC PAVEMENT MARKING - MEDIAN EDGELINE, 4" YELLOW (TYP.)
- 4

THERMOPLASTIC PAVEMENT MARKING - TURN LANE LINE, 6" WHITE (TYP.)
- 5

THERMOPLASTIC PAVEMENT MARKING - DOTTED DASHED LINE, 6", 2' DASH - 6' SKIP WHITE (TYP.)
- 6

THERMOPLASTIC PAVEMENT MARKING - CROSSWALK, 6" WHITE (TYP.)
- 7

THERMOPLASTIC PAVEMENT MARKING - DIAGONALS, 12" YELLOW (TYP.)
- 8

THERMOPLASTIC PAVEMENT MARKING - SCHOOL CROSSING, 12" WHITE (TYP.)
- 9

THERMOPLASTIC PAVEMENT MARKING - STOP BAR, 24" WHITE (TYP.)
- 10

THERMOPLASTIC PAVEMENT MARKING - TRANSVERSE RAILROAD, 24" WHITE (TYP.)
- 11

THERMOPLASTIC PAVEMENT MARKING - LETTERS & SYMBOLS WHITE (TYP.)

ADA SIDEWALK LEGEND:

- A

PROP. CURB RAMP IMPROVEMENT, SEE DETAIL PD-01
- B

PROP. CURB RAMP IMPROVEMENT, SEE DETAIL PD-02
- C

PROP. CURB RAMP IMPROVEMENT, SEE DETAIL PD-03
- D

PROP. CURB RAMP IMPROVEMENT, SEE DETAIL PD-04
- E

PROP. CURB RAMP IMPROVEMENT, SEE DETAIL PD-05
- F

PROP. CURB RAMP IMPROVEMENT, SEE DETAIL PD-06
- G

PROP. CURB RAMP IMPROVEMENT, SEE CURB RAMP DESIGN DETAILS
- H

PROP. CURB RAMP IMPROVEMENT, REPLACE DETECTABLE WARNING W/FULL WIDTH ONLY

PROP. HOT-MIX ASPHALT SURFACE REMOVAL, 2 1/4"
PROP. POLYMERIZED HOT-MIX ASPHALT BINDER COURSE,
IL-4.75, N50, 3/4"
PROP. HOT-MIX ASPHALT SURFACE COURSE,
MIX 'D', IL-9.5, N70, 1 1/2"

PLOT DATE	USER NAME	DESIGNED	REVISED
	= Phillip.Steed	-	-
	DRAWN	-	REVISED
	CHECKED	-	REVISED
	DATE	-	REVISED

STATE OF ILLINOIS
DEPARTMENT OF TRANSPORTATION

ROADWAY AND PAVEMENT MARKING PLANS
NILES CENTER RD. (IL. ROUTE 58 (DEMPSTER ST.) TO MAIN ST.)

SCALE: 1"=50' SHEET 1 OF 2 SHEETS STA. 6+00.00 TO STA. 34+00.00

F.A.U RTE.	SECTION	COUNTY	TOTAL SHEETS	SHEET NO.
2798	2024-1030-RS	COOK	28	8
CONTRACT NO. 62X70				
ILLINOIS FED.AID PROJECT				

MODEL: NilesCenterRd_E_Rovvy_Plan_3 [Sheet]
FILE NAME: c:\pwworking\dsteeppaid\036957D\06125-shh-plan.dgn

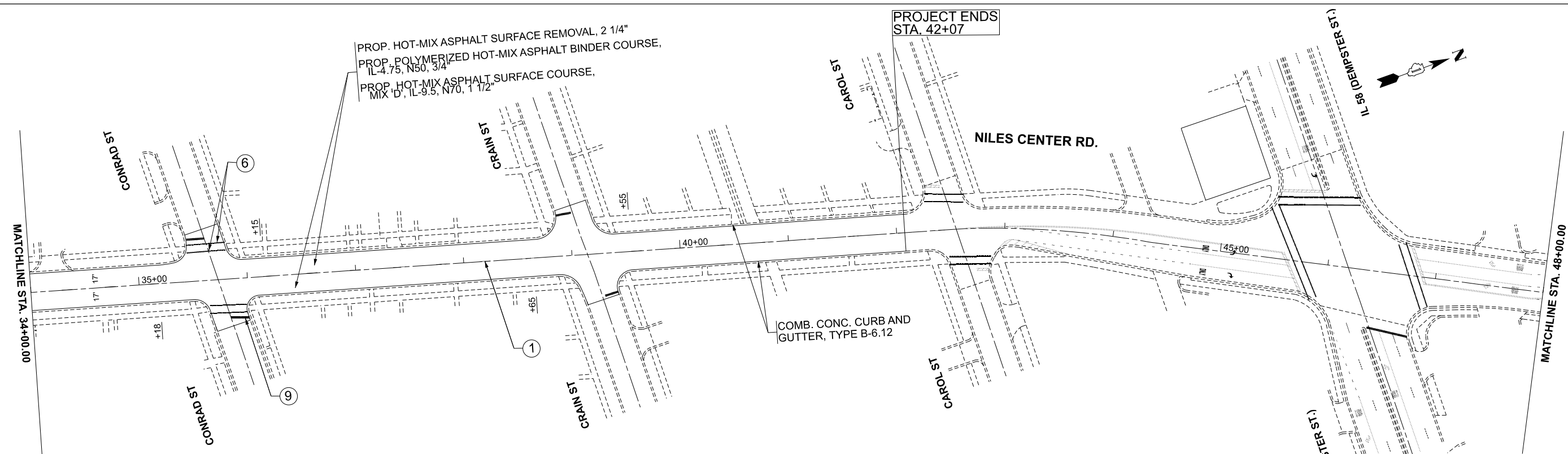

ADA SIDEWALK LEGEND:

- (A) PROP. CURB RAMP IMPROVEMENT, SEE DETAIL PD-01
- (B) PROP. CURB RAMP IMPROVEMENT, SEE DETAIL PD-02
- (C) PROP. CURB RAMP IMPROVEMENT, SEE DETAIL PD-03
- (D) PROP. CURB RAMP IMPROVEMENT, SEE DETAIL PD-04
- (E) PROP. CURB RAMP IMPROVEMENT, SEE DETAIL PD-05
- (F) PROP. CURB RAMP IMPROVEMENT, SEE DETAIL PD-06
- (G) PROP. CURB RAMP IMPROVEMENT, SEE CURB RAMP DESIGN DETAILS
- (H) PROP. CURB RAMP IMPROVEMENT, REPLACE DETECTABLE WARNING W/FULL WIDTH ONLY

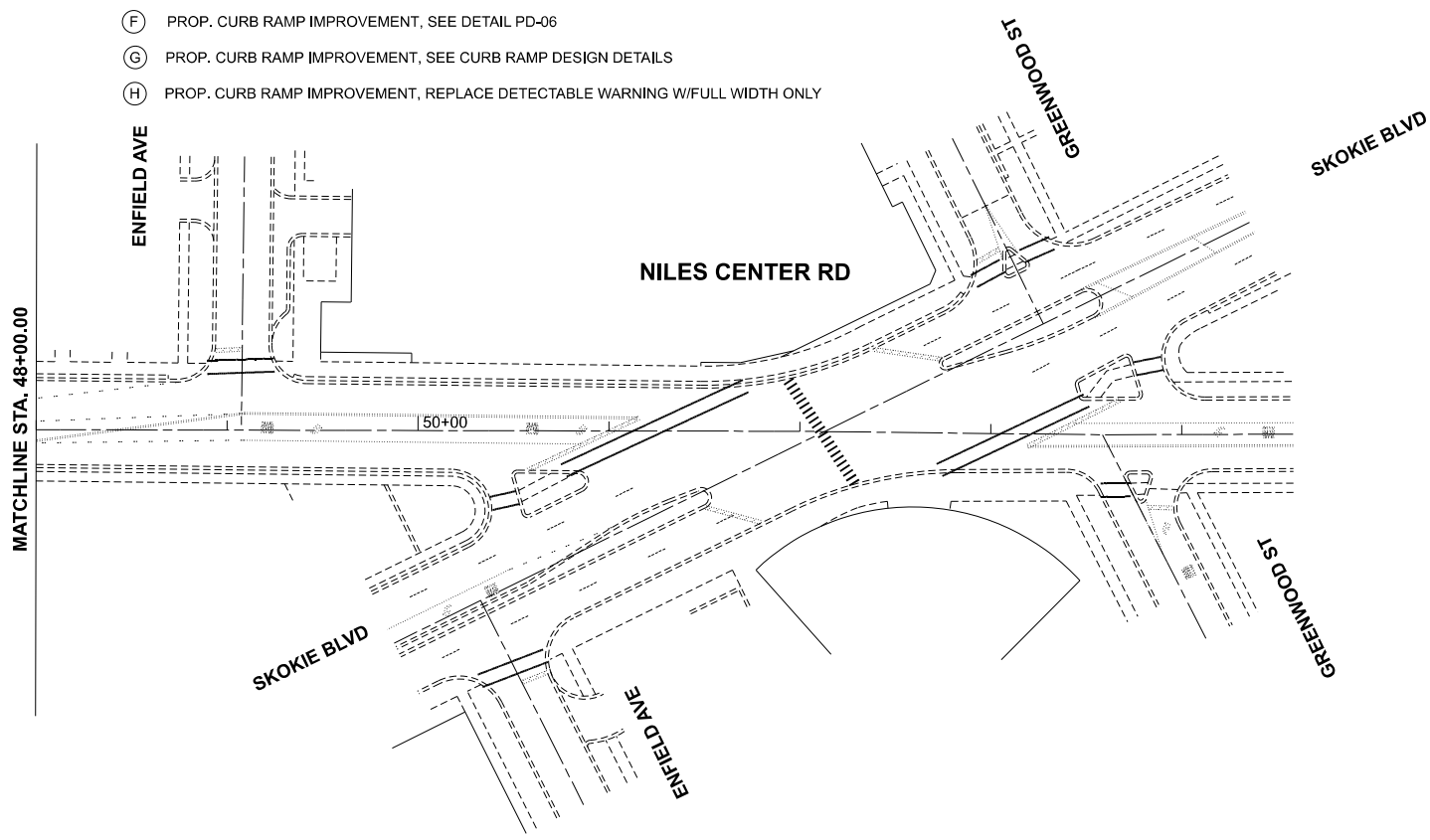

PAVEMENT MARKING LEGEND:

- (1) THERMOPLASTIC PAVEMENT MARKING - SKIP DASH, 4", 10' DASH - 30' SKIP WHITE (TYP.)
 - (2) THERMOPLASTIC PAVEMENT MARKING - DOUBLEYELLOW CENTERLINE, 4" (TYP.)
 - (3) THERMOPLASTIC PAVEMENT MARKING - MEDIAN EDGELINE, 4" YELLOW (TYP.)
 - (4) THERMOPLASTIC PAVEMENT MARKING - TURN LANE LINE, 6" WHITE (TYP.)
 - (5) THERMOPLASTIC PAVEMENT MARKING - DOTTED DASHED LINE, 6", 2' DASH - 6' SKIP WHITE (TYP.)
 - (6) THERMOPLASTIC PAVEMENT MARKING - CROSSWALK, 6" WHITE (TYP.)
- (7) THERMOPLASTIC PAVEMENT MARKING - DIAGONALS, 12" YELLOW (TYP.)
 - (8) THERMOPLASTIC PAVEMENT MARKING - SCHOOL CROSSING, 12" WHITE (TYP.)
 - (9) THERMOPLASTIC PAVEMENT MARKING - STOP BAR, 24" WHITE (TYP.)
 - (10) THERMOPLASTIC PAVEMENT MARKING - TRANSVERSE RAILROAD, 24" WHITE (TYP.)
 - (11) THERMOPLASTIC PAVEMENT MARKING - LETTERS & SYMBOLS WHITE (TYP.)

USER NAME	= Phillip.Steed	DESIGNED	-	REVISED	-
		DRAWN	-	REVISED	-
		CHECKED	-	REVISED	-
PLOT DATE	= 3/21/2025	DATE	-	REVISED	-

STATE OF ILLINOIS
DEPARTMENT OF TRANSPORTATION

ROADWAY AND PAVEMENT MARKING PLANS
NILES CENTER RD. (IL. ROUTE 58 (DEMPSTER ST.) TO MAIN ST.)

SCALE: 1"=50' SHEET 2 OF 2 SHEETS STA. 34+00.00 TO STA. 62+00.00

F.A.U RTE.	SECTION	COUNTY	TOTAL SHEETS	SHEET NO.
2798	2024-1030-RS	COOK	28	9
CONTRACT NO. 62X70				
ILLINOIS		FED. AID PROJECT		

NOTES:

- 1. WORK SHALL MEET THE REQUIREMENTS OF THE SPECIAL PROVISION, "DETECTOR LOOP REPLACEMENT AND/OR INSTALLATION (ROADWAY GRINDING, RESURFACING & PATCHING OPERATIONS)".
- 2. THIS PLAN IS FOR THE SOLE PURPOSE OF DETECTOR LOOP REPLACEMENT.

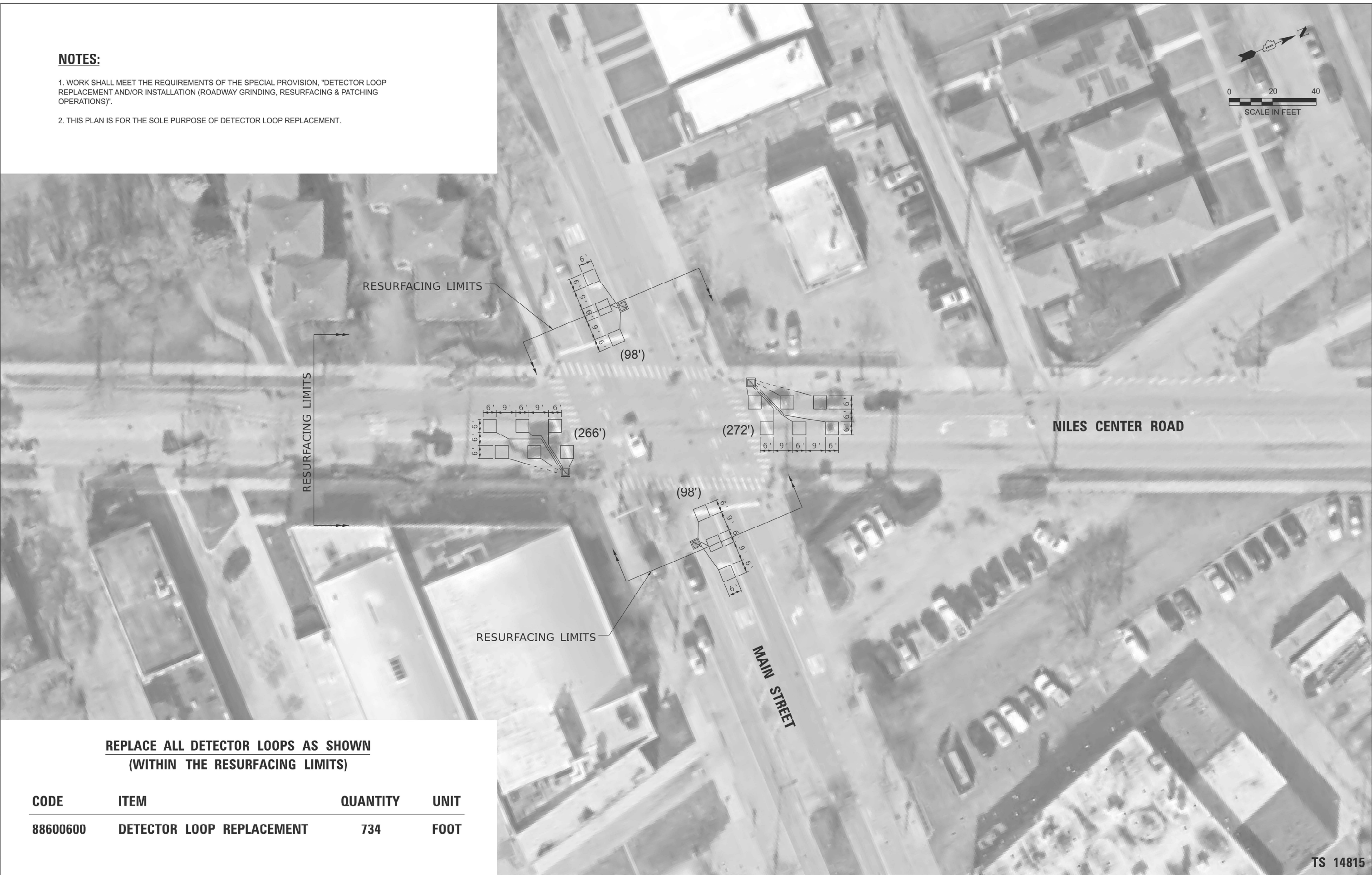
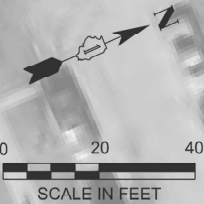

REPLACE ALL DETECTOR LOOPS AS SHOWN
(WITHIN THE RESURFACING LIMITS)

CODE	ITEM	QUANTITY	UNIT
88600600	DETECTOR LOOP REPLACEMENT	734	FOOT

MODEL: Default
FILE NAME: H:\Projects\17000\17180\TechData\CAD\Design\BaseC\04-D\62X70-border.dgn

USER NAME = BCoan	DESIGNED - BWC	REVISED -
	DRAWN - BWC	REVISED -
	CHECKED - KJS	REVISED -
PLOT DATE = 3/12/2025	DATE - 03/14/2025	REVISED -

STATE OF ILLINOIS
DEPARTMENT OF TRANSPORTATION

DETECTOR LOOP REPLACEMENT PLAN
NILES CENTER ROAD AND MAIN STREET

SCALE: 1"=20' SHEET 1 OF 1 SHEETS STA. TO STA.

F.A.U. RTE.	SECTION	COUNTY	TOTAL SHEETS	SHEET NO.
2798	2024-1030-RS	COOK	28	10
CONTRACT NO. 62X70				
ILLINOIS FED. AID PROJECT				

TS 14815

MODEL: Default
FILE NAME: p:\work\new\benley.com\FWIDOT\Documents\DOT 0 cas\DistHt 1\ORIO Projects\0106125\CAD\Draw\Design\0106125-404-Dwg.dgn

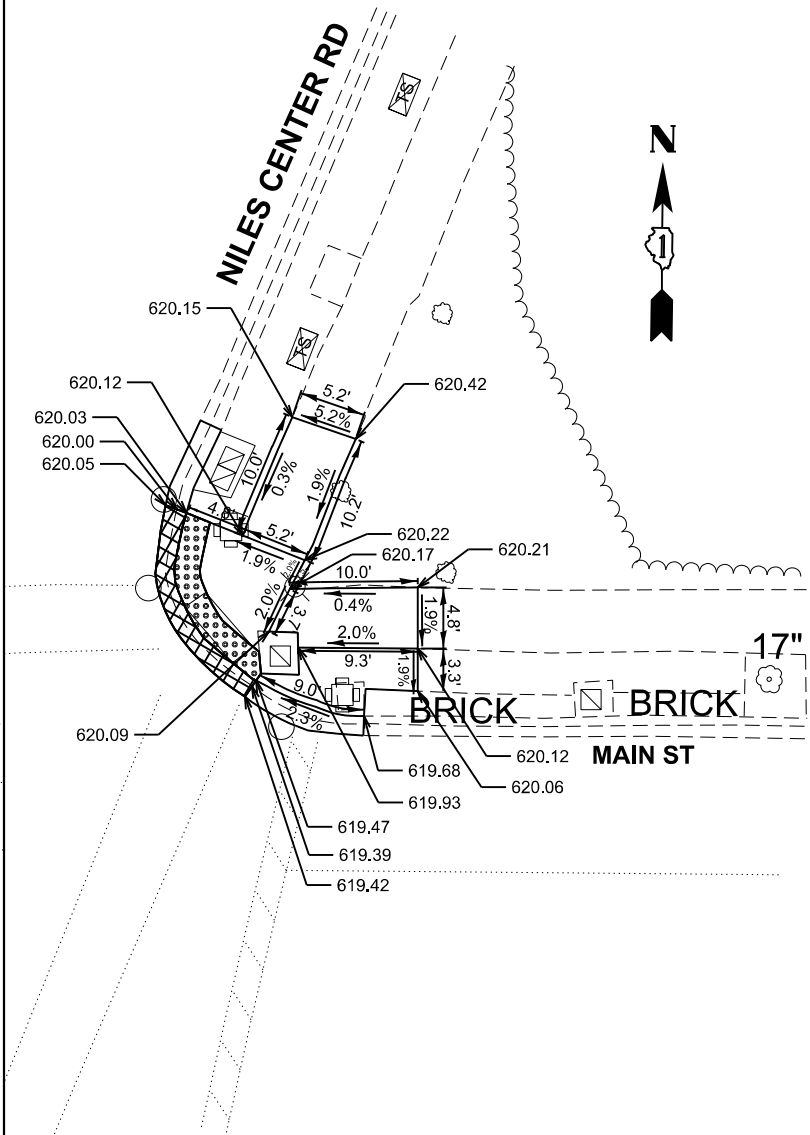
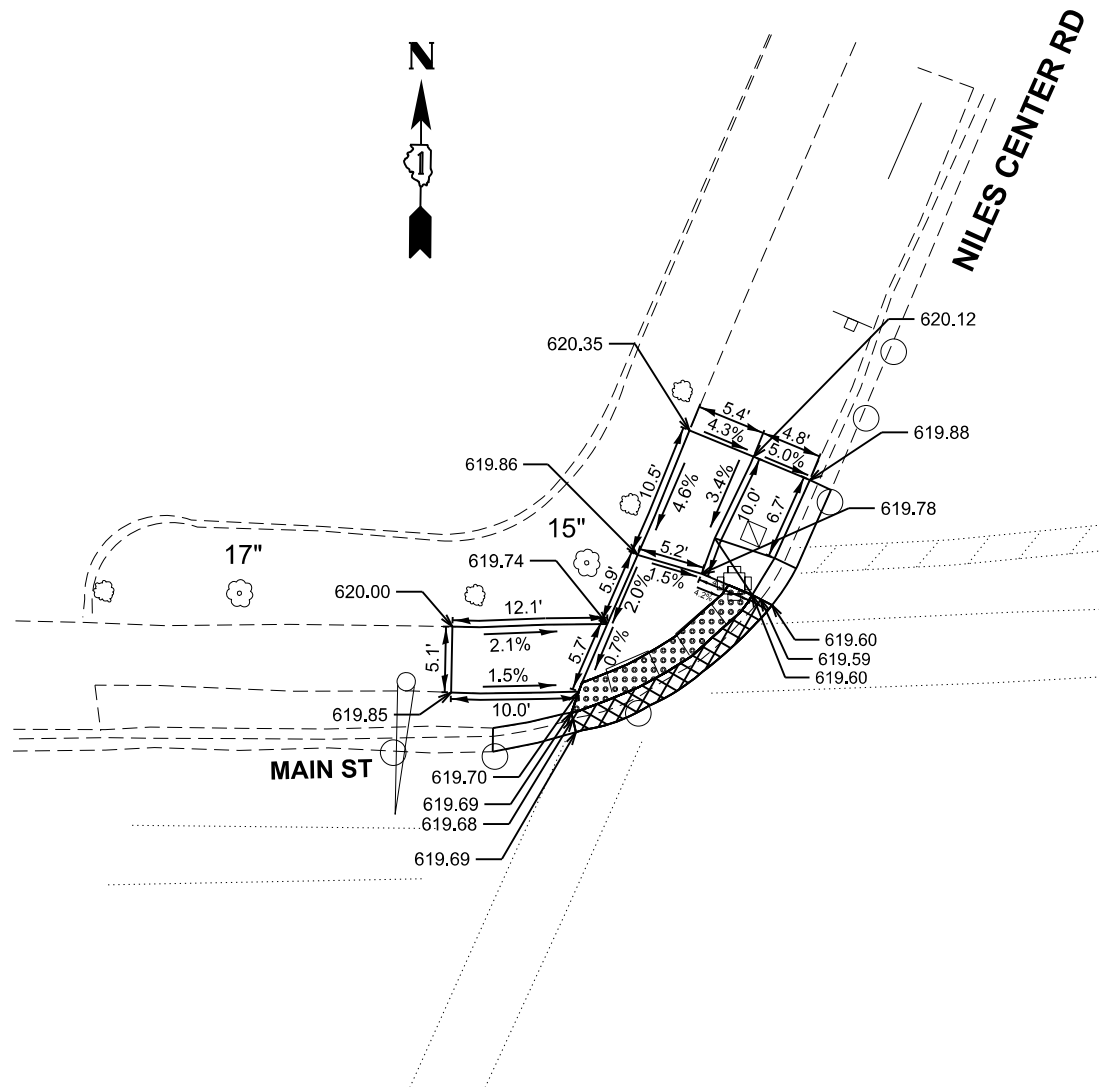

REFERENCE BENCH MARK ELEV 620.76

BENCHMARK : SET 'X' AT SW CORNER OF TRAFFIC SIGNAL CONTROL BOX

LOCATION : TRAFFIC SIGNAL CONTROL BOX AT NE CORNER OF NILES CENTER RD. AT MAIN ST.

LEGEND



EXISTING LENGTH



PROPOSED SIDE CURB



EXISTING ELEVATION/SLOPE



PROPOSED SIDEWALK



DETECTABLE WARNINGS



SIDEWALK REMOVAL
REPLACE W/TOPSOIL & SOD

REFERENCE BENCH MARK ELEV 620.76

BENCHMARK : SET 'X' AT SW CORNER OF TRAFFIC SIGNAL CONTROL BOX

LOCATION : TRAFFIC SIGNAL CONTROL BOX AT NE CORNER OF NILES CENTER RD. AT MAIN ST.

STATE OF ILLINOIS
DEPARTMENT OF TRANSPORTATION

ADA SIDEWALK PLANS (NILES CENTER RD.--NW & NE CORNER)
FAU 2798 (NILES CENTER RD.)-IL 58 (DEMPSTER ST.) TO MAIN ST.

SCALE: NONE SHEET OF SHEETS STA. TO STA.

F.A.U. RTE.	SECTION	COUNTY	TOTAL SHEETS	SHEET NO.
2798	2024-1030-RS	COOK	28	11
CONTRACT NO. 62X70				
ILLINOIS FED. AID PROJECT				

MODEL: Default
FILE NAME: p:\idb\new\benley.com\FWID\DOT Documents\DOT O cas\Dist41_1\ORD Projects\0106125\CAD Data\Design\0106125-4DA-Design.dgn

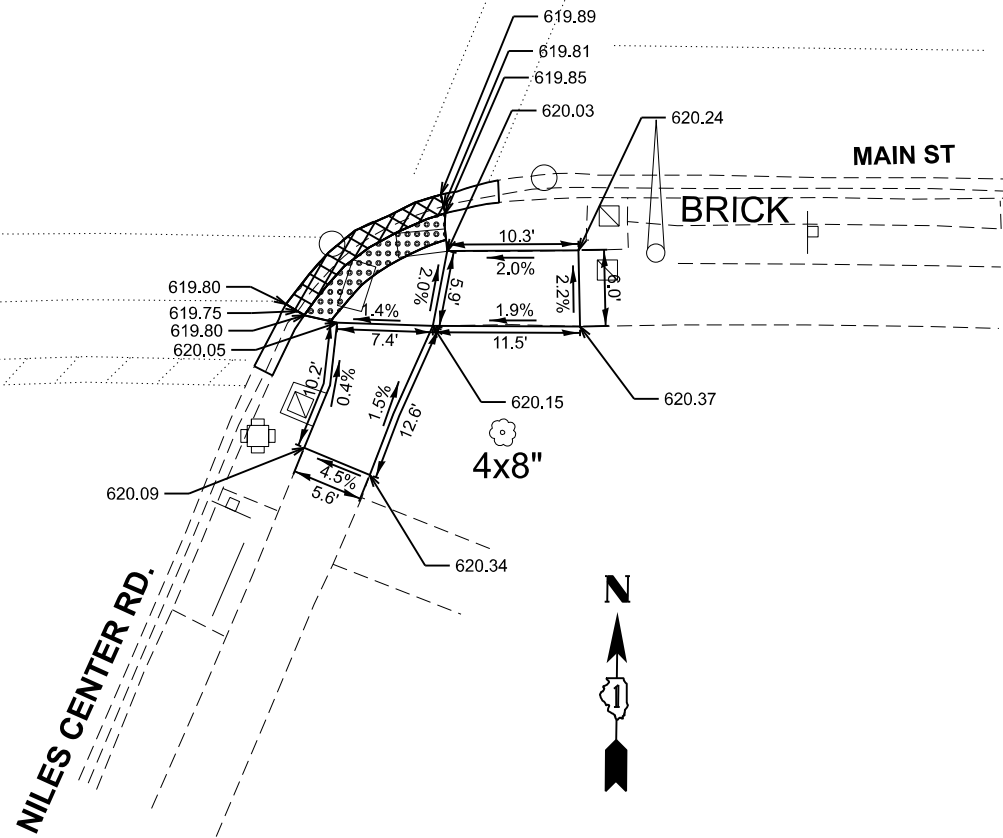
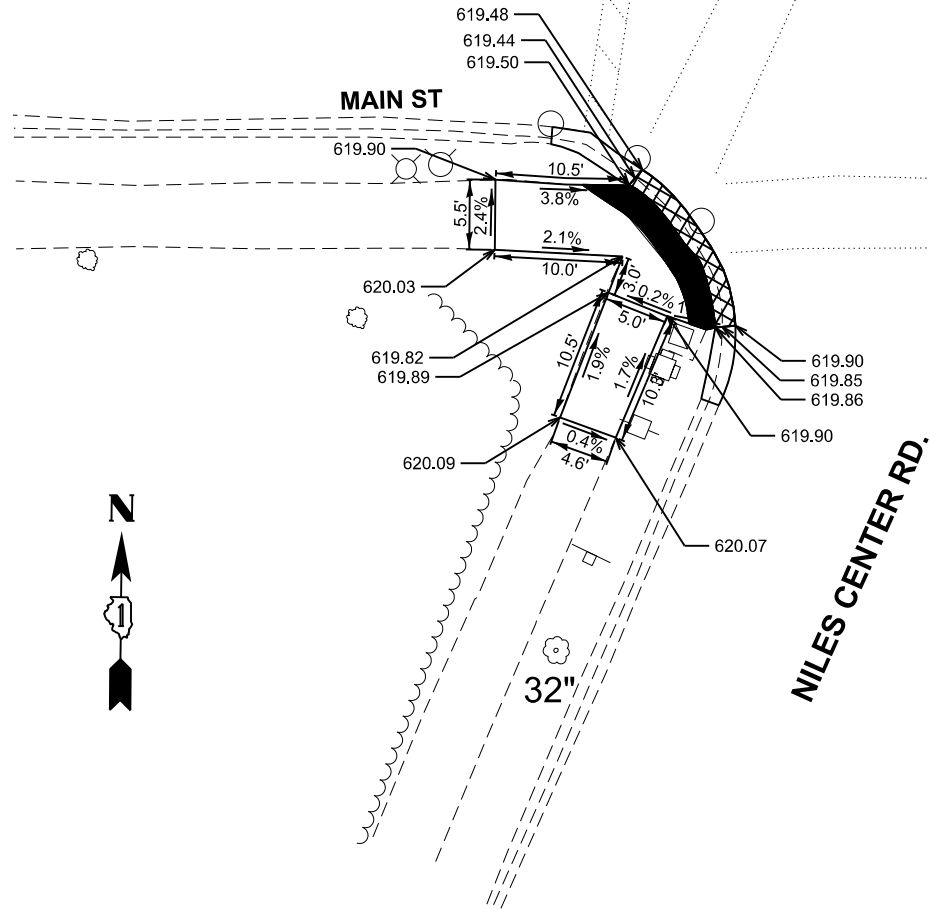

REFERENCE BENCH MARK ELEV 620.76

BENCHMARK : SET 'X' AT SW CORNER OF TRAFFIC SIGNAL CONTROL BOX

LOCATION : TRAFFIC SIGNAL CONTROL BOX AT NE CORNER OF NILES CENTER RD. AT MAIN ST.

LEGEND



EXISTING LENGTH



PROPOSED SIDE CURB



EXISTING ELEVATION/SLOPE



PROPOSED SIDEWALK



DETECTABLE WARNINGS



SIDEWALK REMOVAL
REPLACE W/TOPSOIL & SOD

REFERENCE BENCH MARK ELEV 620.76

BENCHMARK : SET 'X' AT SW CORNER OF TRAFFIC SIGNAL CONTROL BOX

LOCATION : TRAFFIC SIGNAL CONTROL BOX AT NE CORNER OF NILES CENTER RD. AT MAIN ST.

STATE OF ILLINOIS
DEPARTMENT OF TRANSPORTATION

ADA SIDEWALK PLANS (NILES CENTER RD.--NW & NE CORNER)
FAU 2798 (NILES CENTER RD.)-IL 58 (DEMPSTER ST.) TO MAIN ST.

SCALE: NONE

SHEET

OF

SHEETS

STA.

TO STA.

F.A.U. RTE.	SECTION	COUNTY	TOTAL SHEETS	SHEET NO.
2798	2024-1030-RS	COOK	28	12
CONTRACT NO. 62X70				
ILLINOIS FED. AID PROJECT				

ADA DETAIL FOR SINGLE PERPENDICULAR CURB RAMPS W/ EXIST. 5% OR LESS RUN. SLOPE

PD-01A

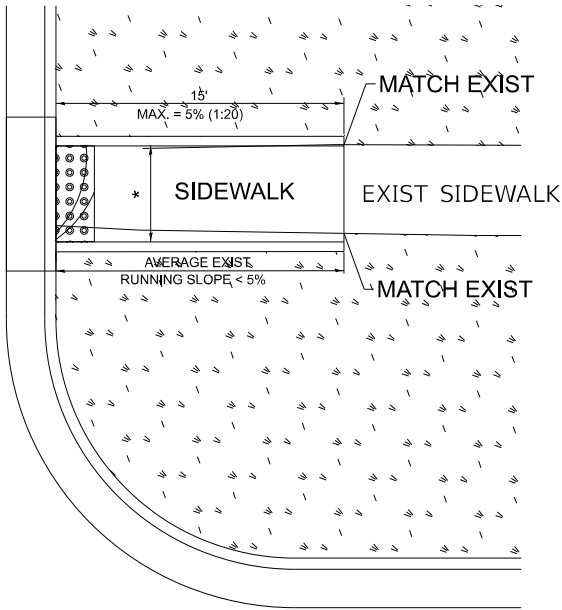

PD-01B

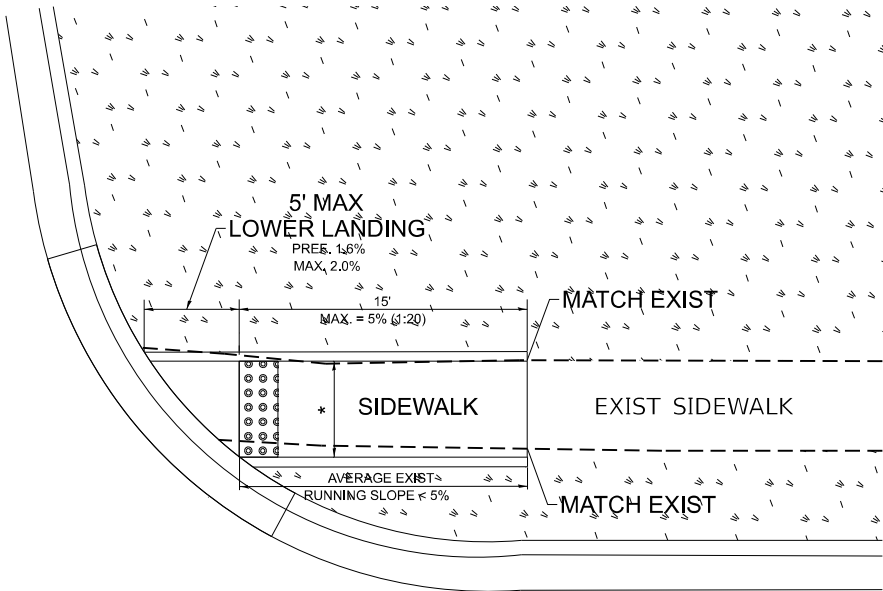

PD-01C

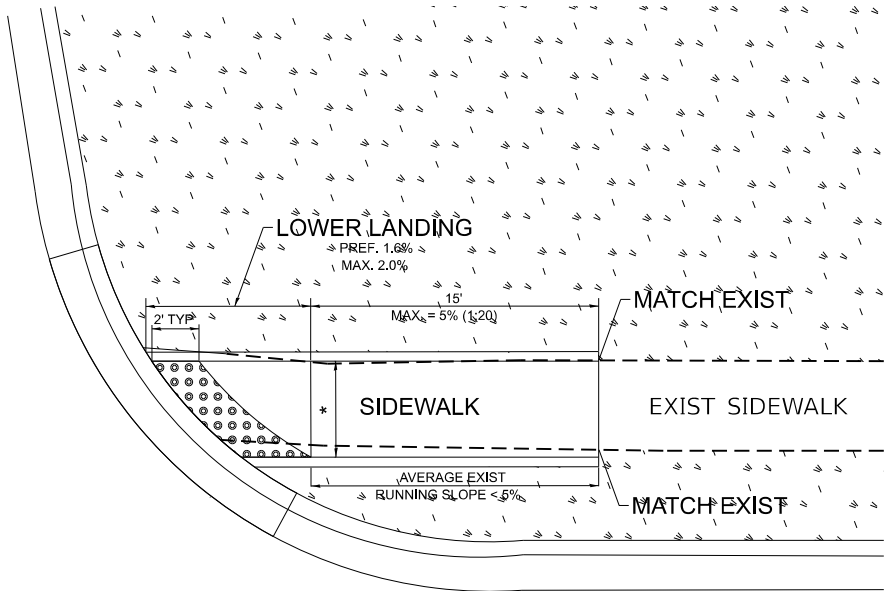

LEGEND

- EXIST. GRASS
- PROPOSED SIDEWALK
- PROPOSED SIDE CURB
- DETECTABLE WARNINGS

CONSTRUCTION NOTES:

- 1) ALL CROSS SLOPES ARE PREFERRED 1.6% (1:64), MAXIMUM 2% (1:50) EXCEPT WHEN TRANSITIONING TO EXISTING SIDEWALK
- * MATCH EXISTING SIDEWALK WIDTH

USER NAME	= Phillip.Steed	DESIGNED	-	REVISED	-
DRAWN	- R. LEDEZMA	REVIS	-	REVISED	-
PLOT SCALE	= \$SCALE\$	CHECKED	-	REVISED	-
PLOT DATE	= 3/21/2025	DATE	- 10/02/2019	REVISED	-

STATE OF ILLINOIS
DEPARTMENT OF TRANSPORTATION

PROJECT DETAIL FOR SINGLE PERPENDICULAR CURB RAMPS
(PD-01)

SCALE: NONE SHEET OF SHEETS STA. TO STA.

F.A.U. RTE.	SECTION	COUNTY	TOTAL SHEETS	SHEET NO.
2798	2024-1030-RS	COOK	28	13
PD-01		CONTRACT NO. 62X70		
		ILLINOIS	FED. AID PROJECT	

MODEL: Default
FILE NAME: p:\11dab-aw-bentley.com\FWIDOT\Documents\DOT 0 cas\Dist41_1\ORD Projects\106125\CAD Data\CAD Sheets\106125-sh-detailed.dgn

ADA DETAIL FOR SINGLE PERPENDICULAR CURB RAMPS W/ EXIST. 5% OR GREATER RUN. SLOPE

PD-02A

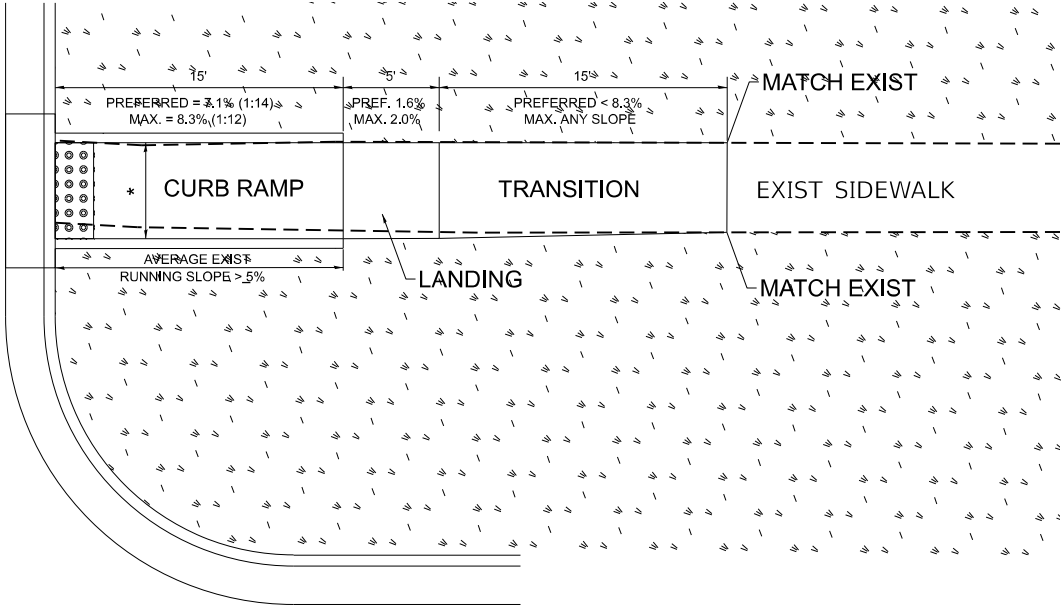

PD-02B

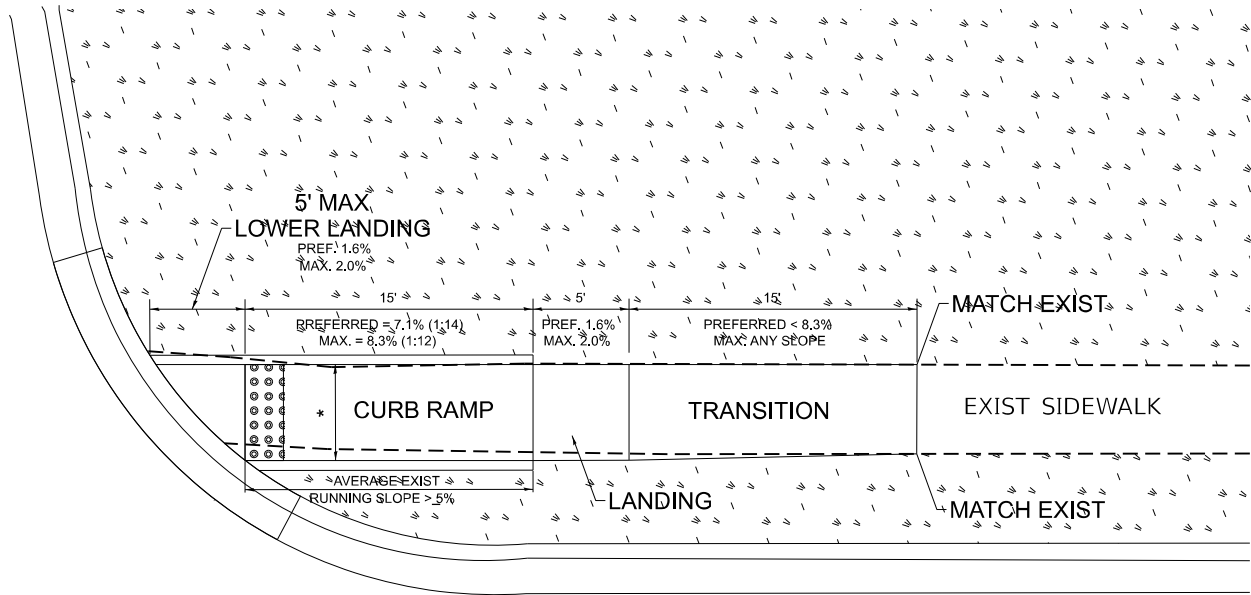

PD-02C

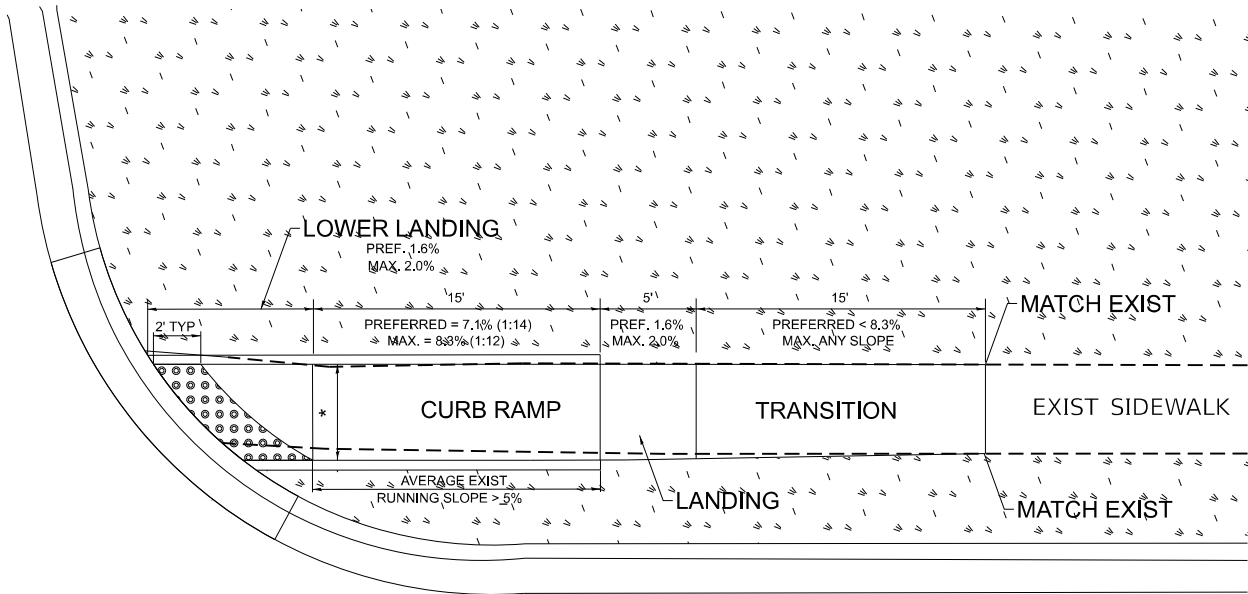

LEGEND

- EXIST. GRASS
- PROPOSED SIDEWALK
- PROPOSED SIDE CURB
- DETECTABLE WARNINGS

CONSTRUCTION NOTES:

- ALL CROSS SLOPES ARE PREFERRED 1.6% (1:64), MAXIMUM 2% (1:50) EXCEPT WHEN TRANSITIONING TO EXISTING SIDEWALK
- MATCH EXISTING SIDEWALK WIDTH

STATE OF ILLINOIS
DEPARTMENT OF TRANSPORTATION

PROJECT DETAIL FOR SINGLE PERPENDICULAR CURB RAMPS
(PD-02)

SCALE: NONE SHEET OF SHEETS STA. TO STA.

F.A.U. RTE.	SECTION	COUNTY	TOTAL SHEETS	SHEET NO.
2798	2024-1030-RS	COOK	28	14
PD-02		CONTRACT NO. 62X70		
		ILLINOIS	FED. AID PROJECT	

ADA DETAIL FOR DOUBLE PERPENDICULAR CURB RAMPS

PD-03A

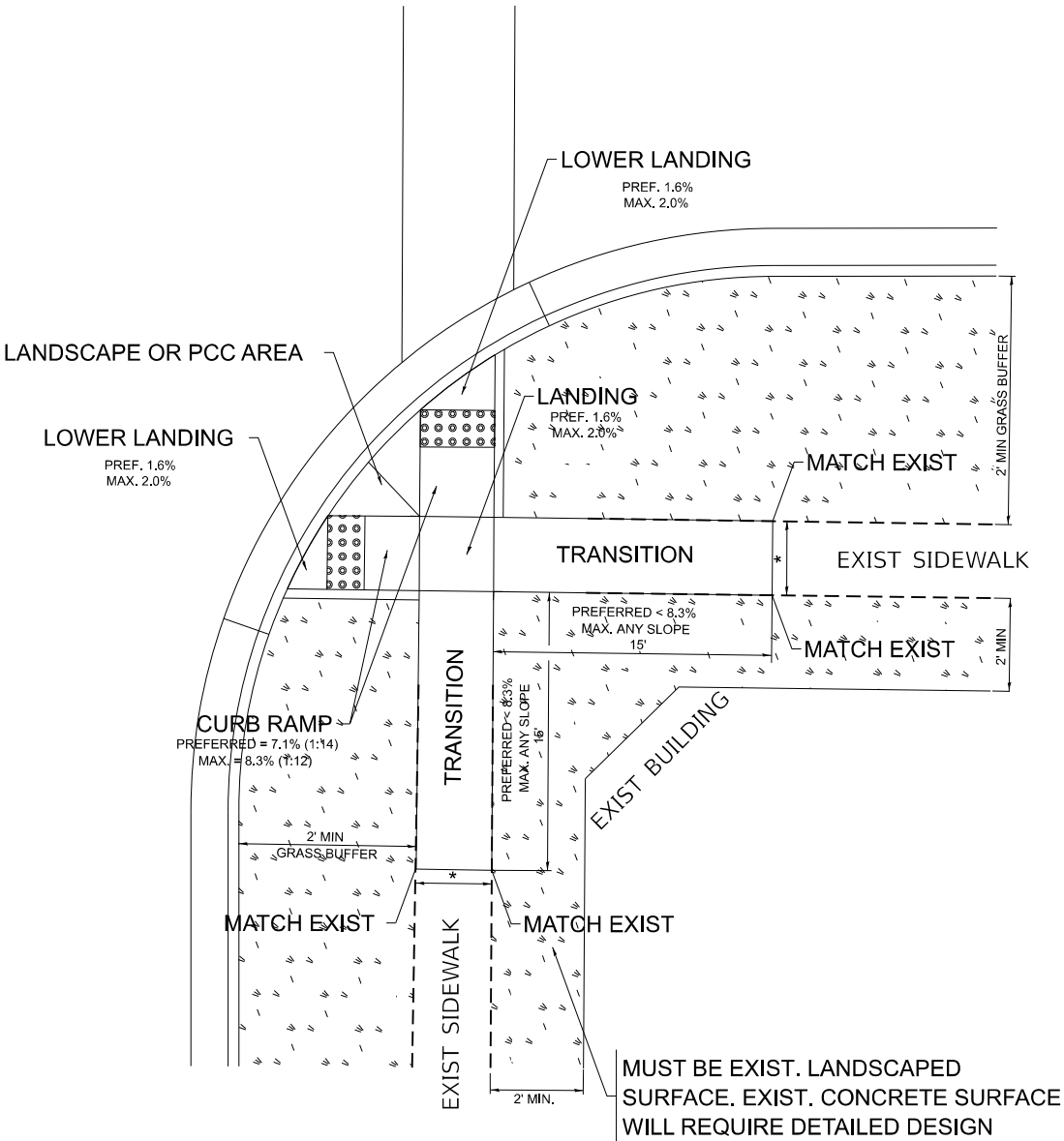

PD-03B

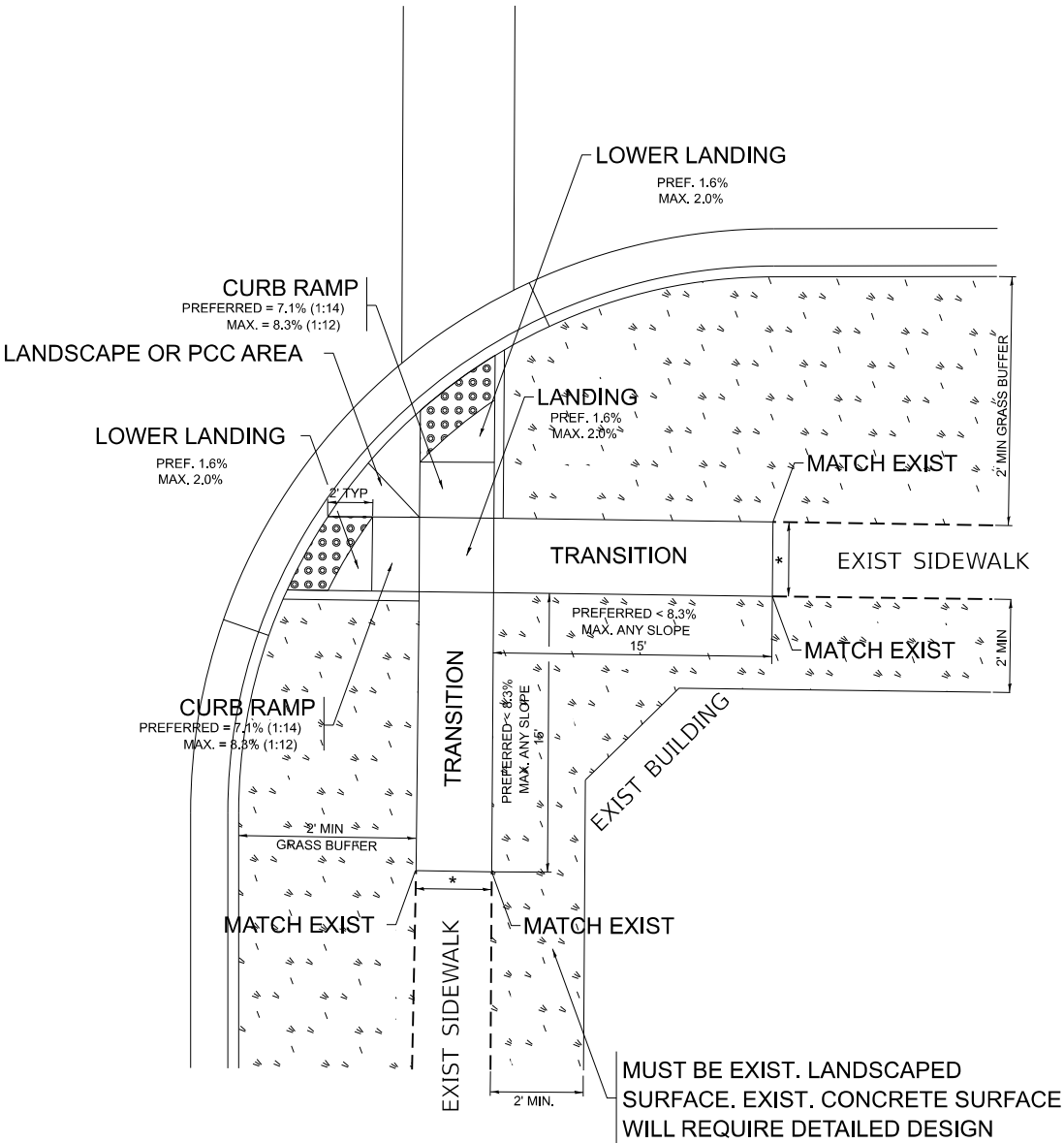

LEGEND

PROPOSED SIDE CURB

EXIST. GRASS

PROPOSED SIDEWALK

DETECTABLE WARNINGS

CONSTRUCTION NOTES:

1) ALL CROSS SLOPES ARE PREFERRED 1.6% (1:64), MAXIMUM 2% (1:50) EXCEPT WHEN TRANSITIONING TO EXISTING SIDEWALK

* MATCH EXISTING SIDEWALK WIDTH

STATE OF ILLINOIS
DEPARTMENT OF TRANSPORTATION

PROJECT DETAIL FOR DOUBLE PERPENDICULAR CURB RAMPS
(PD-03)

SCALE: NONE SHEET OF SHEETS STA. TO STA.

F.A.U. RTE.	SECTION	COUNTY	TOTAL SHEETS	SHEET NO.
2798	2024-1030-RS	COOK	28	15
PD-03		CONTRACT NO. 62X70		
		ILLINOIS	FED. AID PROJECT	

MODEL: Default
FILE NAME: p:\idat-sw-bentley.com\FWIDOT\Documents\DOT 0 cas\Dist41_1080 Projects\ID106125\CAD Data\CAD Sheets\ID106125-sh-detailed.dgn

USER NAME	= Phillip.Steed	DESIGNED	-	REVISED	-
DRAWN	- R. LEDEZMA	CHECKED	-	REVISED	-
PLOT SCALE	= \$SCALE\$	DATE	- 10/02/2019	REVISED	-
PLOT DATE	= 3/21/2025				

ADA DETAIL FOR SINGLE PERPENDICULAR CURB RAMPS W/ TURNING SPACE

PD-04A

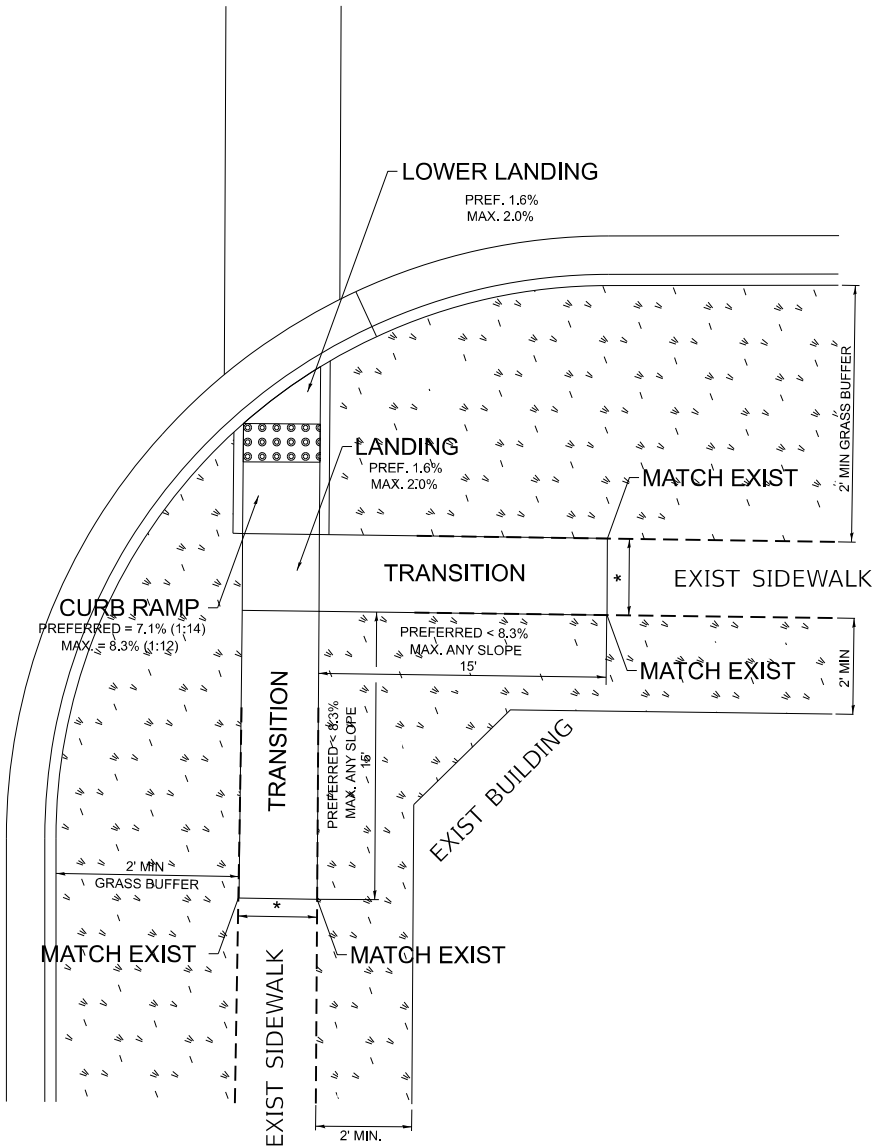

PD-04B

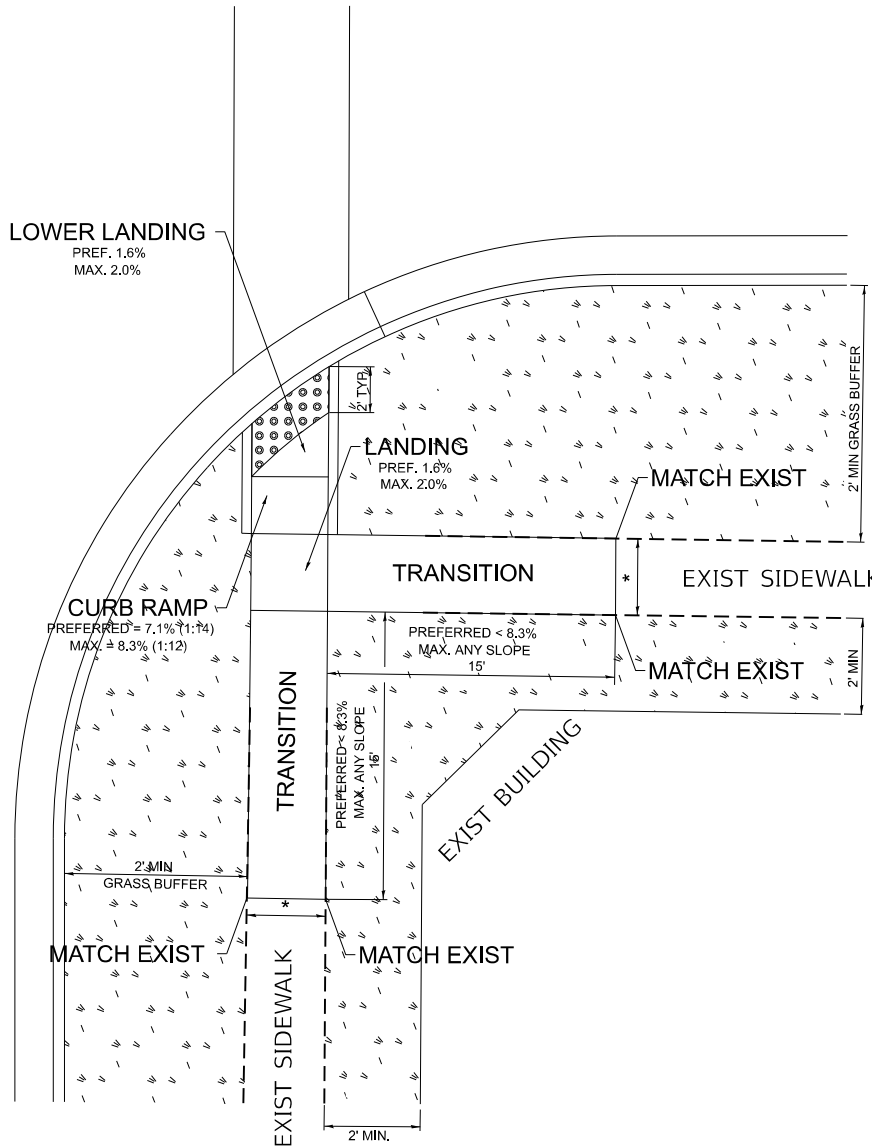

LEGEND

- EXIST. GRASS
- PROPOSED SIDE CURB
- PROPOSED SIDEWALK
- DETECTABLE WARNINGS

CONSTRUCTION NOTES:

- 1) ALL CROSS SLOPES ARE PREFERRED 1.6% (1:64), MAXIMUM 2% (1:50) EXCEPT WHEN TRANSITIONING TO EXISTING SIDEWALK
- * MATCH EXISTING SIDEWALK WIDTH

USER NAME	= Phillip.Steed	DESIGNED	-	REVISED	-
DRAWN	- R. LEDEZMA	REVIS	-	REVIS	-
PLOT SCALE	= \$SCALE\$	CHECKED	-	REVISED	-
PLOT DATE	= 3/21/2025	DATE	- 10/02/2019	REVISED	-

STATE OF ILLINOIS
DEPARTMENT OF TRANSPORTATION

PROJECT DETAIL FOR SINGLE PERPENDICULAR CURB RAMPS
WITH TURNING SPACE (PD-04)

SCALE: NONE SHEET OF SHEETS STA. TO STA.

F.A.U. RTE.	SECTION	COUNTY	TOTAL SHEETS	SHEET NO.
2798	2024-1030-RS	COOK	28	16
PD-04		CONTRACT NO. 62X70		
		ILLINOIS	FED. AID PROJECT	

ADA DETAIL FOR DEPRESSED CORNER CURB RAMPS

PD-05A

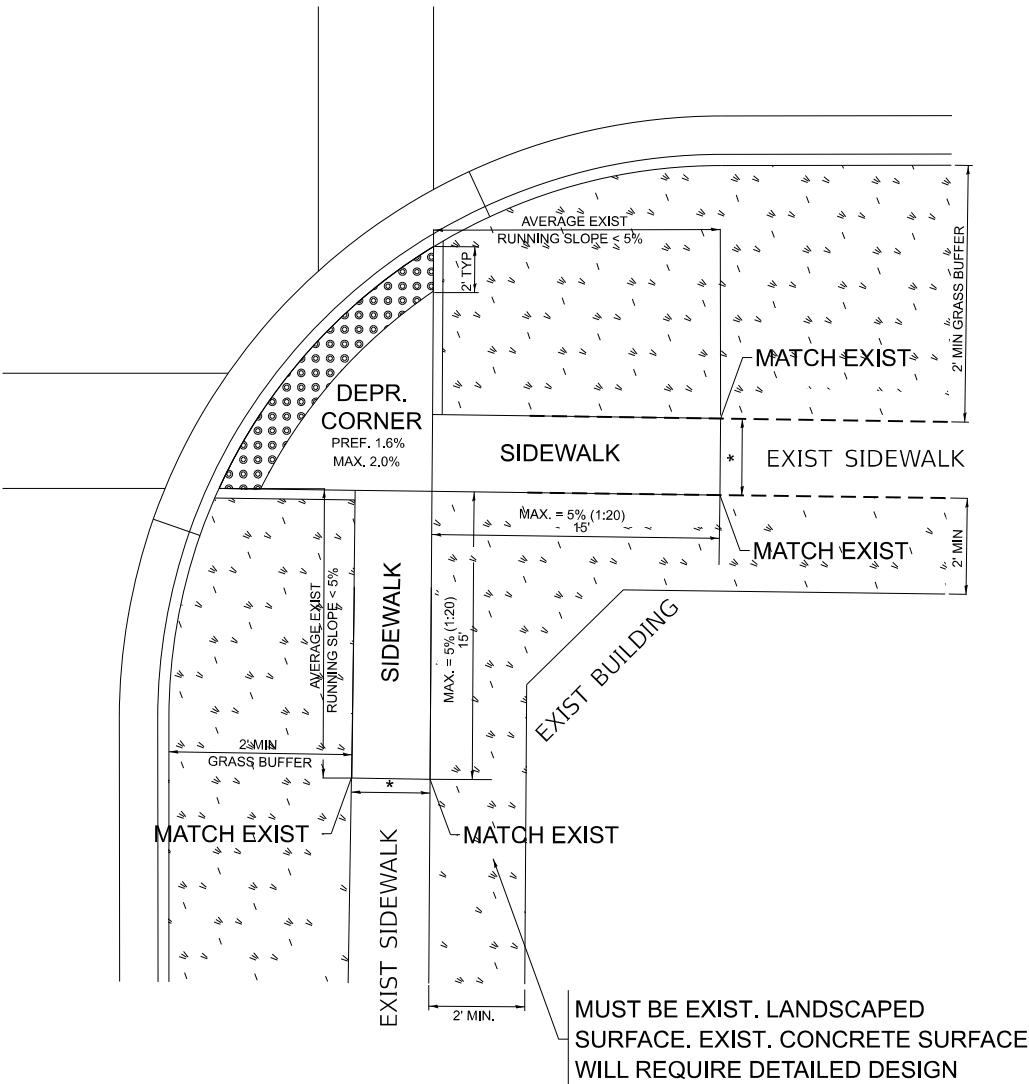

PD-05B

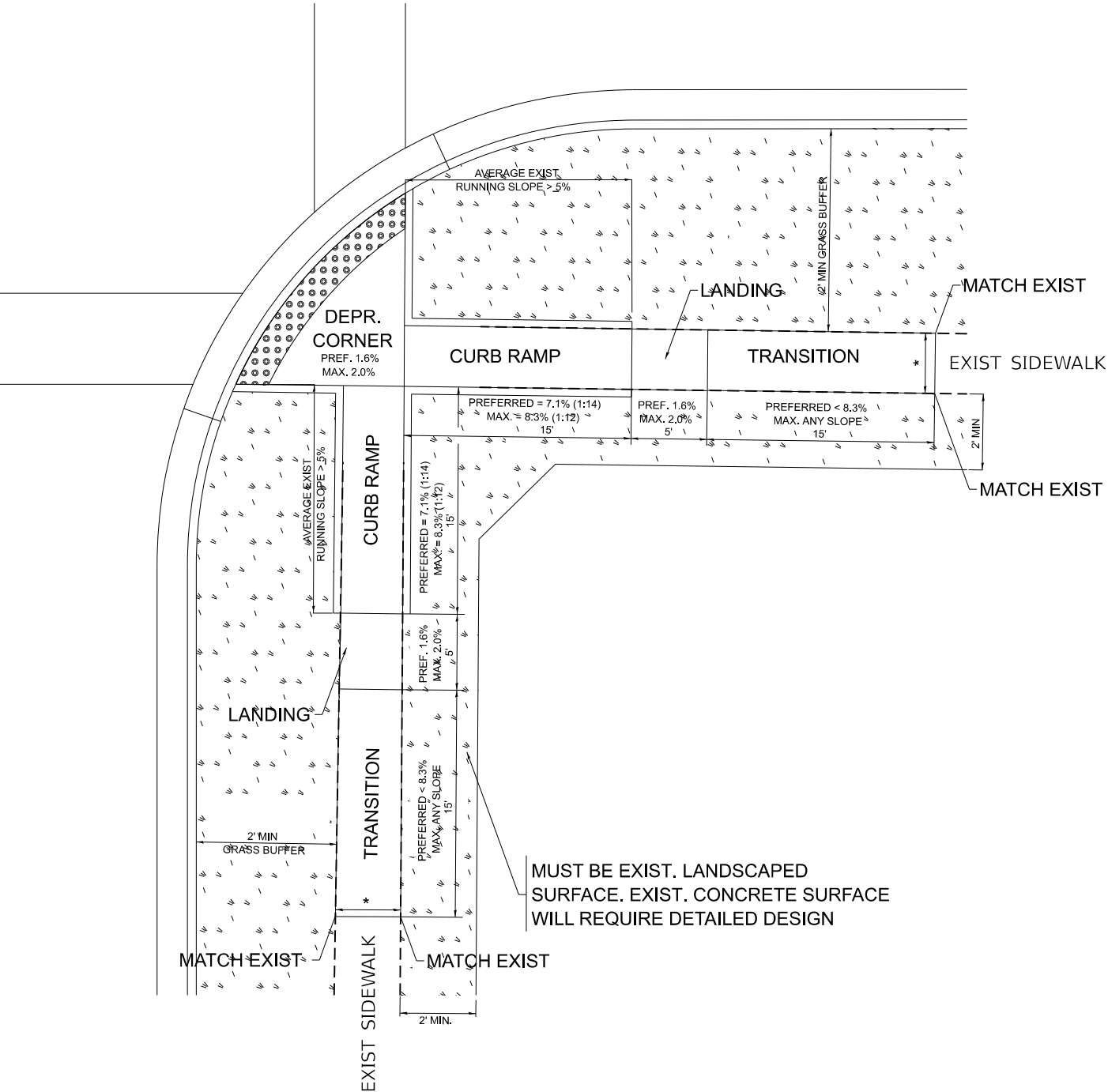

LEGEND

PROPOSED SIDE CURB



PROPOSED SIDEWALK



CONSTRUCTION NOTES:

1) ALL CROSS SLOPES ARE PREFERRED 1.6% (1:64), MAXIMUM 2% (1:50) EXCEPT WHEN TRANSITIONING TO EXISTING SIDEWALK

* MATCH EXISTING SIDEWALK WIDTH

USER NAME	= Phillip.Steed	DESIGNED	-	REVISED	-
DRAWN	- R. LEDEZMA	REVISION	-	REVISION	-
PLOT SCALE	= \$SCALE\$	CHECKED	-	REVISION	-
PLOT DATE	= 3/21/2025	DATE	-	REVISION	-

STATE OF ILLINOIS
DEPARTMENT OF TRANSPORTATION

PROJECT DETAIL FOR SINGLE DEPRESSED CORNER
CURB RAMPS (PD-05)

SCALE: NONE SHEET OF SHEETS STA. TO STA.

F.A.U. RTE.	SECTION	COUNTY	TOTAL SHEETS	SHEET NO.
2798	2024-1030-RS	COOK	28	17
PD-05		CONTRACT NO. 62X70		
		ILLINOIS	FED. AID PROJECT	

Model: Default
File Name: p:\idat-sw-bentley.com\FWIDOT\Documents\DOT 0 cas\Dist41_1\ORD Projects\106125\CAD Data\CAD Sheets\106125-11-detailed.dgn

[illegible]

F.A.U. RTE.	SECTION	COUNTY	TOTAL SHEETS	SHEET NO.
2798	2024-1030-RS	COOK	28	18
PD-06		CONTRACT NO. 62X70		
ILLINOIS		FED. AID PROJECT		

MODEL: Default
FILE NAME: pwr://ilodot-pw.bentley.com:PWIDOT/Documents/IDOT_0 ces/District 1/ORD Projects/D106125/CADData/CADsheets/D106125-sht-details.dgn

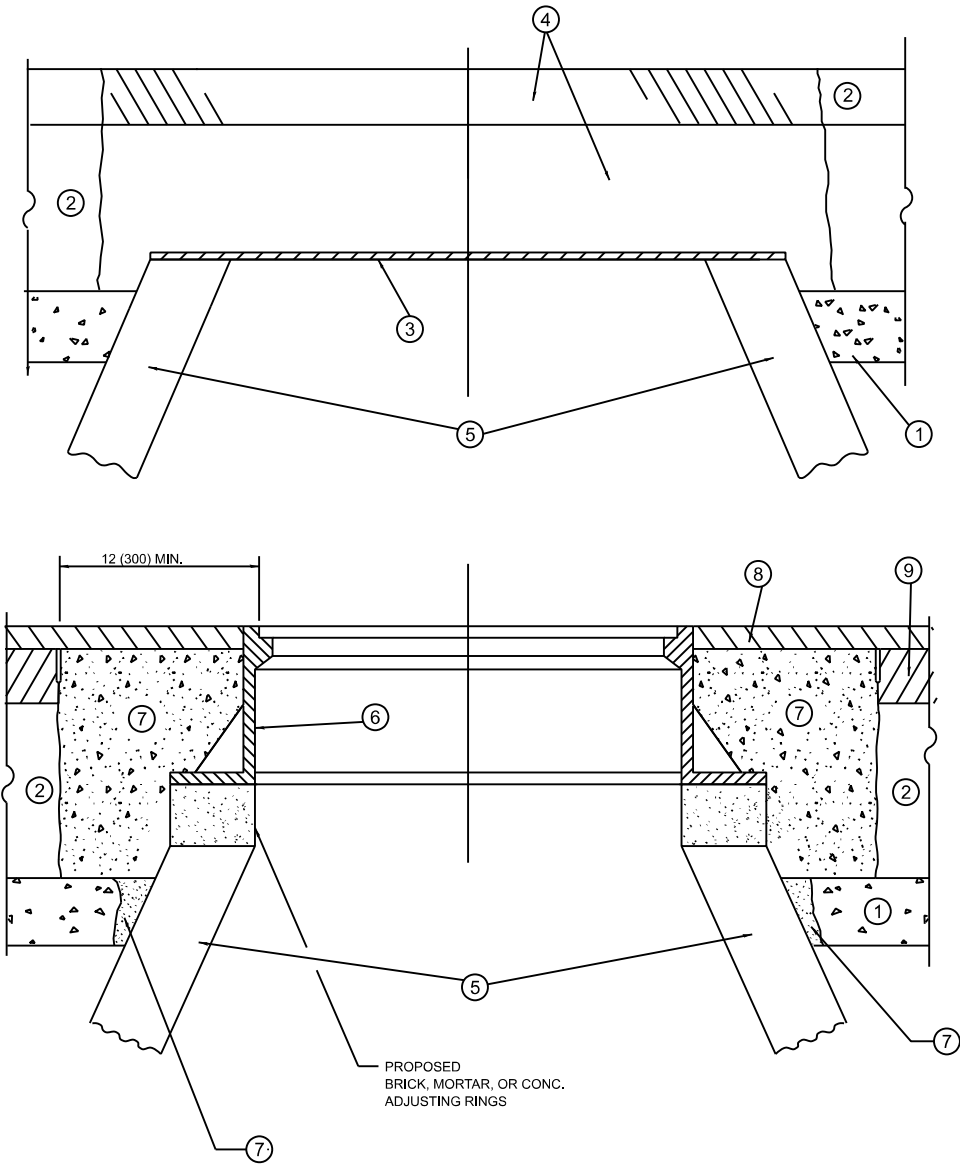

DETAILS FOR FRAMES AND LIDS ADJUSTMENT
WITH MILLING

NOTES

- EXISTING BROKEN FRAMES AND LIDS SHALL BE REMOVED AND DISPOSED OF BY THE CONTRACTOR AND SHALL BE REPLACED AS DIRECTED BY THE ENGINEER. REPLACEMENT FRAMES AND LIDS WILL BE PAID FOR IN ACCORDANCE WITH ARTICLE 109.04 OF THE STANDARD SPECIFICATIONS UNLESS A SEPARATE PAY ITEM HAS BEEN PROVIDED.
- IF THE EXISTING LIDS ARE OPEN, THE FRAME WILL BE ADJUSTED TO THE ELEVATION OF THE MILLED PAVEMENT SURFACE PRIOR TO THE MILLING OPERATION. THE FRAME WILL NOT BE REMOVED AND COVERED BY THE METAL PLATE.
- CITY OF CHICAGO CASTINGS ARE THE PROPERTY OF THE CITY AND THE CONTRACTOR SHALL NOTIFY THE CITY FOR REMOVAL AND DISPOSITION OF THE CASTINGS.
- THE METAL PLATE USED TO COVER THE STRUCTURE SHALL REMAIN THE PROPERTY OF THE CONTRACTOR.
- THE CONTRACTOR SHALL REMOVE ALL TRAFFIC CONTROL DEVICES BY THE END OF EACH WORK SHIFT.

CONSTRUCTION PROCEDURES

- STAGE 1 (BEFORE PAVEMENT MILLING)**
- REMOVE A MINIMUM OF 12 (300) OF THE PAVEMENT FROM AROUND THE STRUCTURE.
 - REMOVE THE EXISTING FRAME AND LID FROM THE STRUCTURE.
 - COVER THE STRUCTURE OPENING WITH A 36 (900) DIAMETER METAL PLATE.
 - BACKFILL WITH CRUSHED STONE AND HMA SURFACE MIX APPROVED BY THE ENGINEER. (MIN. 3 (80) HMA TO REMAIN AFTER MILLING).

- STAGE 2 (AFTER PAVEMENT MILLING)**
- REMOVE THE HMA SURFACE MIX AND CRUSHED STONE.
 - INSTALL THE FRAME AND LID; ADJUST THE FRAME TO ITS FINAL SURFACE ELEVATION.
 - THE SURROUNDING SPACE SHALL BE FILLED WITH CLASS PP-2* CONCRETE TO THE ELEVATION OF THE SURFACE OF THE EXISTING BASE COURSE OR THE BINDER COURSE.

*UNLESS OTHERWISE SPECIFIED IN THE PLANS.

THE PROCEDURE EXPLAINED ABOVE SHALL CONFORM TO THE APPLICABLE PORTIONS OF SECTIONS 353, 406, 602, AND 603 OF THE STANDARD SPECIFICATIONS EXCEPT THAT "THE CONTRACTOR SHALL ADJUST THE STRUCTURES TO THE FINISHED PAVEMENT ELEVATION NO MORE THAN 5 CALENDAR DAYS PRIOR TO PLACEMENT OF THE FINAL LIFT OF SURFACE UNLESS APPROVED BY THE ENGINEER."

LEGEND

- | | |
|--|-------------------------------|
| ① SUB-BASE GRANULAR MATERIAL | ⑥ FRAME AND LID (SEE NOTES) |
| ② EXISTING PAVEMENT | ⑦ CLASS PP-2* CONCRETE |
| ③ 36 (900) DIAMETER METAL PLATE | ⑧ PROPOSED HMA SURFACE COURSE |
| ④ PROPOSED CRUSHED STONE AND HMA SURFACE MIX | ⑨ PROPOSED HMA BINDER COURSE |
| ⑤ EXISTING STRUCTURE | |

LOCATION OF STRUCTURES

THE CONTRACTOR WILL BE REQUIRED TO KEEP A RECORD OF THE LOCATIONS OF THE BURIED STRUCTURES ACCORDING TO THE STATION AND DISTANCE LEFT OR RIGHT OF THE CENTERLINE OF PAVEMENT. UPON COMPLETION OF THE WORK, THE CONTRACTOR WILL DELIVER THE RECORD TO THE ENGINEER.

BASIS OF PAYMENT

- REMOVING FRAMES AND LIDS ON DRAINAGE AND UTILITY STRUCTURES IN THE PAVEMENT PRIOR TO MILLING, AND ADJUSTING TO FINAL GRADE PRIOR TO PLACING THE SURFACE COURSE, WILL BE PAID FOR AT THE CONTRACT UNIT PRICE EACH FOR "FRAMES AND LIDS TO BE ADJUSTED (SPECIAL)."
- THIS WORK WILL NOT BE PAID FOR WHEN DRAINAGE AND UTILITY STRUCTURES ARE SPECIFIED FOR PAYMENT AS STRUCTURE RECONSTRUCTION.
- NEW FRAMES AND LIDS, WHEN SPECIFIED, WILL BE PAID FOR SEPARATELY.
- WHEN STRUCTURES ARE TO BE ADJUSTED OR RECONSTRUCTED, THE LOWERING AND RAISING OF THE FRAMES AND LIDS WILL NOT BE PAID FOR SEPARATELY BUT WILL BE INCLUDED IN THE COST OF THE CORRESPONDING PAY ITEM.

ALL DIMENSIONS ARE IN INCHES (MILLIMETERS) UNLESS OTHERWISE SHOWN

STATE OF ILLINOIS
DEPARTMENT OF TRANSPORTATION

DETAIL FOR
FRAMES AND LIDS ADJUSTMENT WITH MILLING

SCALE: NONE SHEET 1 OF 1 SHEETS STA. TO STA.

F.A.U. RTE.	SECTION	COUNTY	TOTAL SHEETS	SHEET NO.
2798	2024-1030-RS	COOK	28	19
BD600-03 (BD-08)		CONTRACT NO. 62X70		
		ILLINOIS	FED. AID PROJECT	

MODEL: Default
FILE NAME: p:\w\l\dot-sw\benley.com\FW\DOT\Documents\DOT 0 cas\Dist41-1\OR0 Projects\106125\CAD\Draw\CAD\Sheets\106125-sh-detailed.dgn

METHOD OF MEASUREMENT

REFER TO SECTION 442 OF THE STANDARD SPECIFICATIONS FOR ROAD AND BRIDGE CONSTRUCTION AND THE RECURRING SPECIAL PROVISION "PATCHING WITH HOT-MIX ASPHALT OVERLAY REMOVAL."

BASIS OF PAYMENT

- 1. REFER TO SECTION 442 OF THE STANDARD SPECIFICATIONS FOR ROAD AND BRIDGE CONSTRUCTION AND THE RECURRING SPECIAL PROVISION "PATCHING WITH HOT-MIX ASPHALT OVERLAY REMOVAL."
- 2. SAW CUT/SCORING OF EXISTING HMA OVERLAY IS INCLUDED IN THE COST OF PAVEMENT PATCHING.
- 3. SAW CUT/SCORING OF EXISTING PAVEMENT IS INCLUDED IN THE COST OF PAVEMENT PATCHING.

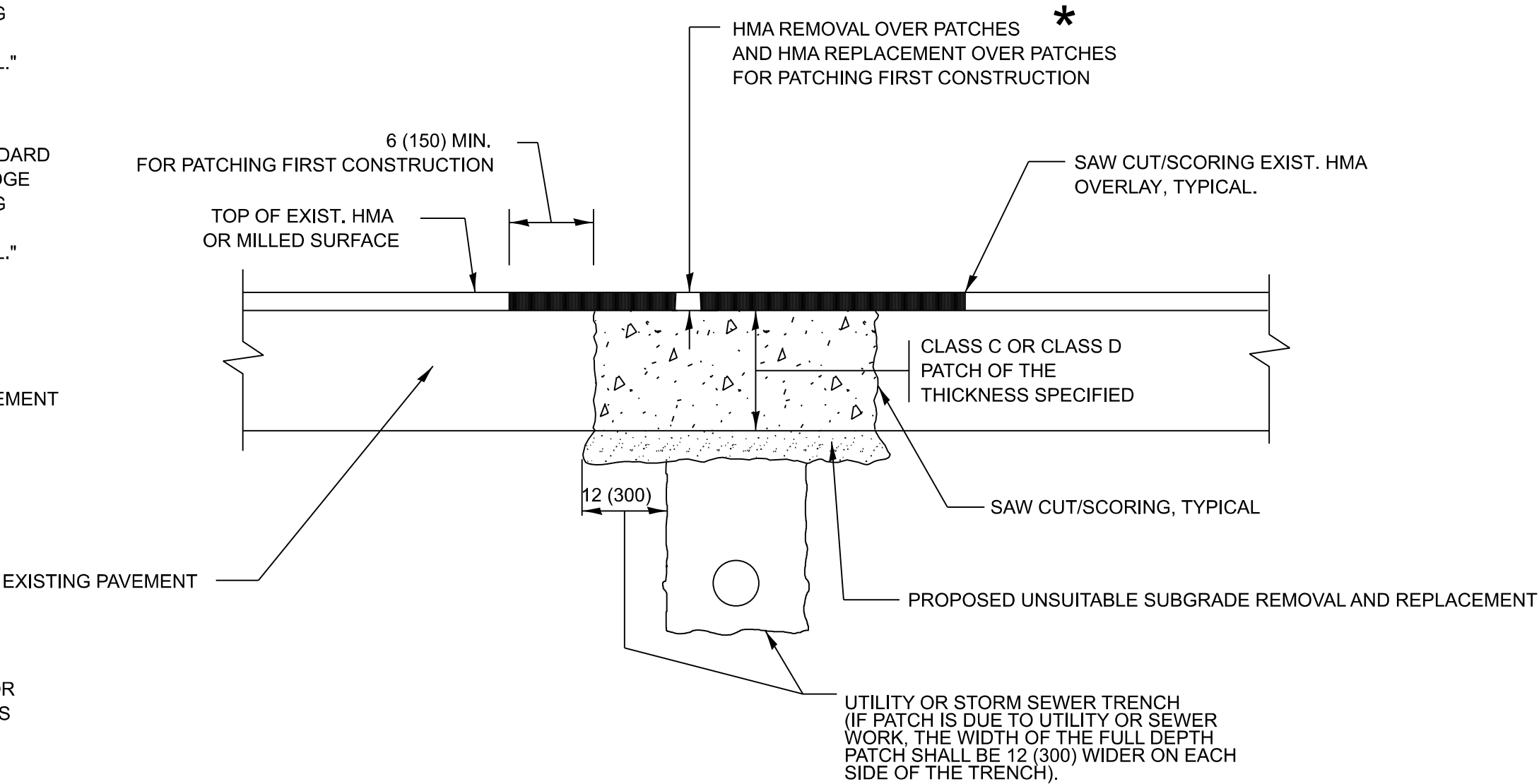

* SEE TYPICAL SECTIONS FOR THICKNESS AND MATERIALS

SEQUENCE OF CONSTRUCTION (PATCHING FIRST)

- 1. REMOVE THE EXISTING HMA MATERIAL OVER THE AREA TO BE PATCHED.
- 2. REMOVE AND REPLACE WITH CLASS C OR D PATCH.
- 3. REPLACE HMA MATERIAL OVER THE AREA TO BE PATCHED.

SEQUENCE OF CONSTRUCTION (MILLING FIRST)

- 1. MILL HMA FIRST IF THERE IS AT LEAST 4 1/2 INCHES OR MORE OF HMA MATERIAL ON TOP OF THE EXISTING PAVEMENT OR IF THE PAVEMENT IS FULL DEPTH HMA. A MINIMUM OF 2 INCHES OF HMA MATERIAL SHALL BE IN PLACE AFTER MILLING.
- 2. REMOVE AND REPLACE WITH FULL DEPTH CLASS D PATCHES TO TOP OF MILLED SURFACE.

ALL DIMENSIONS ARE IN INCHES (MILLIMETERS) UNLESS OTHERWISE SHOWN.

MODEL: Default
FILE: Name: p:\p\libet-aw-bentley.com\FWIDOT\Documents\DOT 0 ces\Dist\11_1080 Projects\106125\CADData\CAD\Sheets\106125-sh-detailed.dgn

	USER NAME = Phillip,Steed	DESIGNED - R. SHAH	REVISED - R. BORO 01-01-07	STATE OF ILLINOIS DEPARTMENT OF TRANSPORTATION	PAVEMENT PATCHING FOR HMA SURFACED PAVEMENT	F.A.U. RTE.	SECTION	COUNTY	TOTAL SHEETS	SHEET NO.
		DRAWN -	REVISED - R. BORO 09-04-07			2798	2024-1030-RS	COOK	28	20
	PLOT SCALE = \$SCALE\$	CHECKED -	REVISED - K. ENG 10-27-08			BD400-04 (BD-22)		CONTRACT NO. 62X70		
	PLOT DATE = 3/21/2025	DATE - 10-25-94	REVISED - K. SMITH 11-18-22			ILLINOIS FED. AID PROJECT				
					SCALE: NONE	SHEET 1 OF 1 SHEETS	STA.	TO STA.		

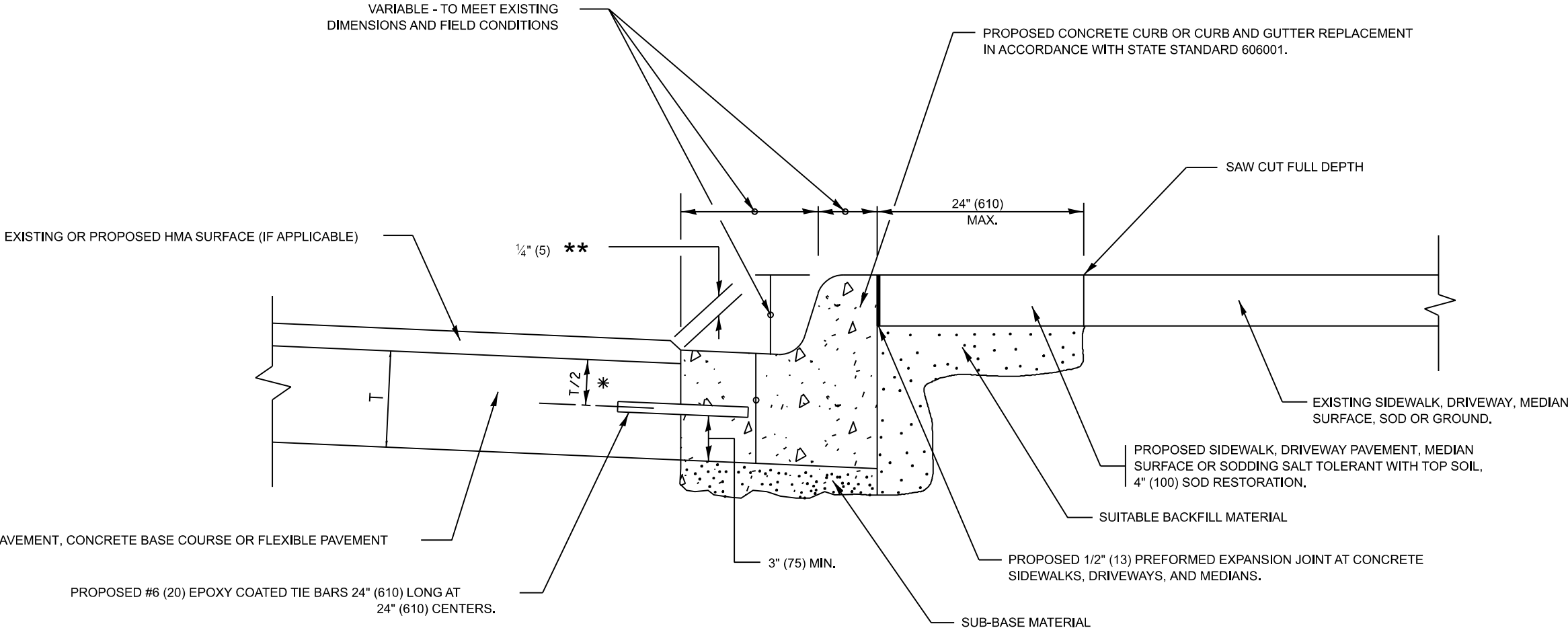

- * 3" (75) MINIMUM FROM TOP AND BOTTOM OF THE CONCRETE PAVEMENT OR BASE COURSE.
- ** IF THE FINAL SURFACE OF THE PAVEMENT IS CONCRETE, THE GUTTER IS TO BE FLUSH WITH THE PAVEMENT.

CURB OR CURB AND GUTTER REMOVAL AND REPLACEMENT

ALL DIMENSIONS ARE IN INCHES (MILLIMETERS)
UNLESS OTHERWISE SHOWN.

MODEL: Default
FILE NAME: p:\work\sw_bentley.com\FWIDOT\Documents\DOT 0 ces\DistHt 1\ORD Projects\106125\CADData\CAD\Sheets\106125-st-detailed.dgn

	USER NAME = Phillip,Steed	DESIGNED - A. HOUSEH	REVISED - A. ABBAS 03-21-97	STATE OF ILLINOIS DEPARTMENT OF TRANSPORTATION	CURB OR CURB AND GUTTER REMOVAL AND REPLACEMENT	F.A.U. RTE.	SECTION	COUNTY	TOTAL SHEETS	SHEET NO.
		DRAWN -	REVISED - M. GOMEZ 01-22-01			2798	2024-1030-RS	COOK	28	21
	PLOT SCALE = \$SCALE\$	CHECKED -	REVISED - R. BORO 12-15-09			BD600-06 (BD-24)		CONTRACT NO. 62X70		
	PLOT DATE = 3/21/2025	DATE - 03-11-94	REVISED - K. SMITH 07-11-19			SCALE: NONE	SHEET 1 OF 1 SHEETS	STA. TO STA.	ILLINOIS	FED. AID PROJECT

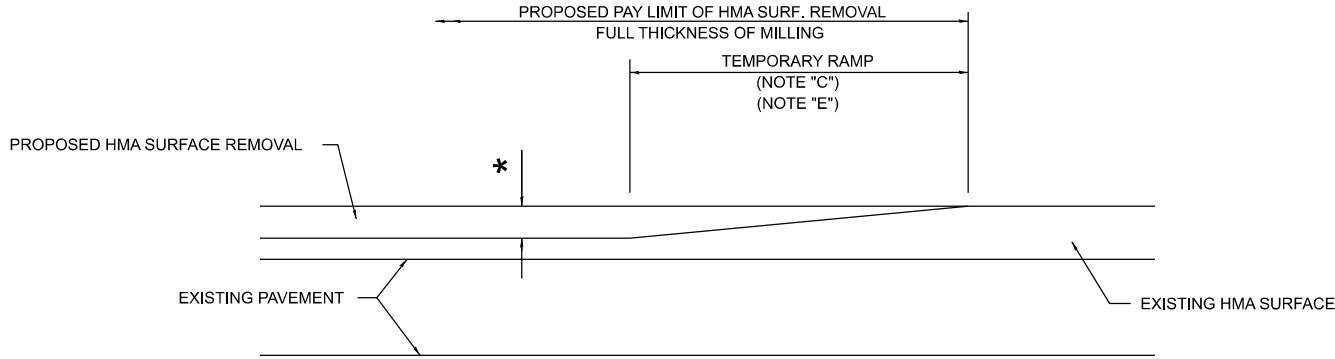

MILLED TEMPORARY RAMP

(FOR BUTT JOINT AND HMA TAPER SEE DETAIL BELOW)

OPTION 1

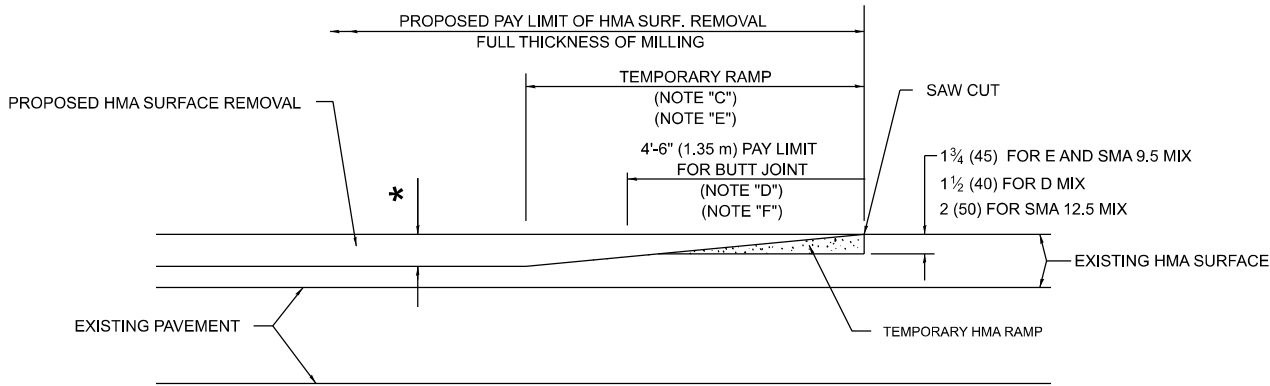

HMA CONSTRUCTED TEMPORARY RAMP

(FOR BUTT JOINT AND HMA TAPER SEE DETAIL BELOW)

OPTION 2

TYPICAL TEMPORARY RAMP

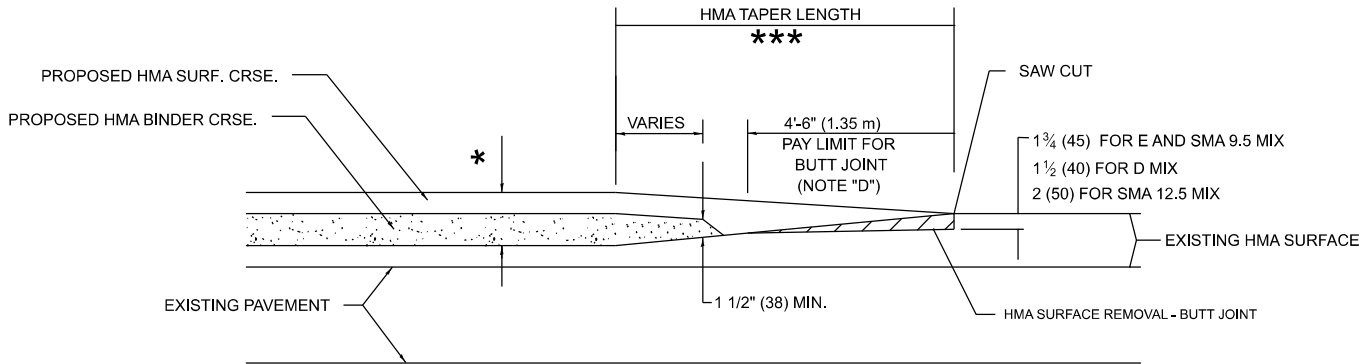

**BUTT JOINT AND
HMA TAPER**

**TYPICAL BUTT JOINT AND HMA TAPER
FOR MILLING AND RESURFACING**

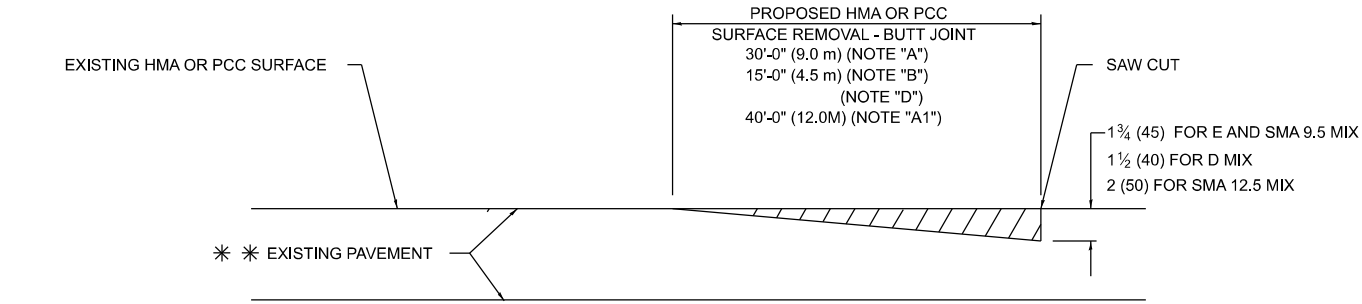

BUTT JOINT DETAIL

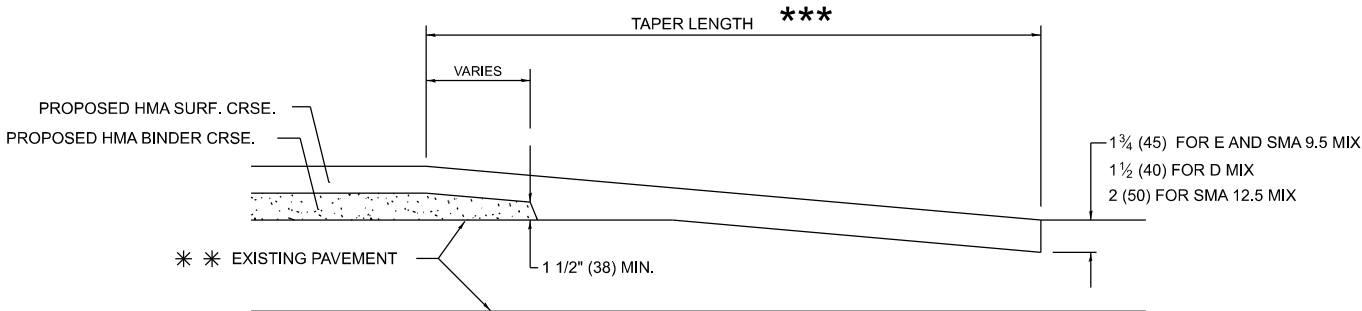

HMA TAPER DETAIL

**TYPICAL BUTT JOINT AND HMA TAPER
FOR RESURFACING ONLY**

****** PC CONCRETE, HMA OR HMA RESURFACED PAVEMENT.

GENERAL NOTES

- A. MAINLINE ARTERIAL ROADWAYS AND MAJOR SIDE ROADS.
- A1. INTERSTATES
- B. MINOR SIDE ROADS.
- C. THE TEMP. RAMP SHALL BE CONSTRUCTED IMMEDIATELY UPON REMOVAL OF THE EXISTING HMA SURFACE.
- D. THE BUTT JOINT SHALL BE CONSTRUCTED IMMEDIATELY PRIOR TO PLACING THE PROPOSED HMA COURSES.
- E. TAPER THE TEMP. RAMP AT A RATE OF 3' - 4" (1.02m) PER 1 INCH (25 mm) OF MILLING THICKNESS.
 - * SEE TYPICAL SECTIONS FOR MILLING THICKNESS.
- F. SEE ARTICLE 406.08 AND 406.14 OF THE STANDARD SPECIFICATIONS FOR "HMA AND/OR PCC SURFACE REMOVAL, BUTT JOINT".
 - *** 20'-0" (6.1 m) PER 1 (25) RESURFACING (NOTE "A")
 - 10'-0" (3.0 m) PER 1 (25) RESURFACING (NOTE "B")

BASIS OF PAYMENT

- 1. THE BUTT JOINT WILL BE PAID FOR AT THE CONTRACT UNIT PRICE PER SQUARE YARD (SQUARE METER) FOR "HOT-MIX ASPHALT SURFACE REMOVAL - BUTT JOINT" OR FOR "PORTLAND CEMENT CONCRETE SURFACE REMOVAL- BUTT JOINT".
- 2. THE TEMPORARY RAMP AND SAW CUT SHALL BE INCLUDED IN THE UNIT COST FOR HMA OR PCC SURFACE REMOVAL-BUTT JOINT.

ALL DIMENSIONS ARE IN INCHES (MILLIMETERS) UNLESS OTHERWISE SHOWN.

**STATE OF ILLINOIS
DEPARTMENT OF TRANSPORTATION**

**BUTT JOINT AND
HMA TAPER DETAILS**

F.A.U. RTE.	SECTION	COUNTY	TOTAL SHEETS	SHEET NO.
2798	2024-1030-RS	COOK	28	22
BD400-05 BD-32		CONTRACT NO. 62X70		
		ILLINOIS	FED. AID PROJECT	

SCALE: NONE SHEET 1 OF 1 SHEETS STA. TO STA.

MODEL: Default
FILE: Name: p:\1\libet-aw-bentley.com\FWIDOT\Documents\DOT 0 ces\Dist41_1\ORD Projects\106125\CADData\CAD\Sheets\106125-sh-detail.dgn

Model: Default
File Name: p:\work\dot-sw-bentley.com\FW\DOT\Documents\DOT 0 cas\DistHt_1\OR0 Projects\0106125\CADData\CAD\Sheets\0106125-sh-detailed.dgn

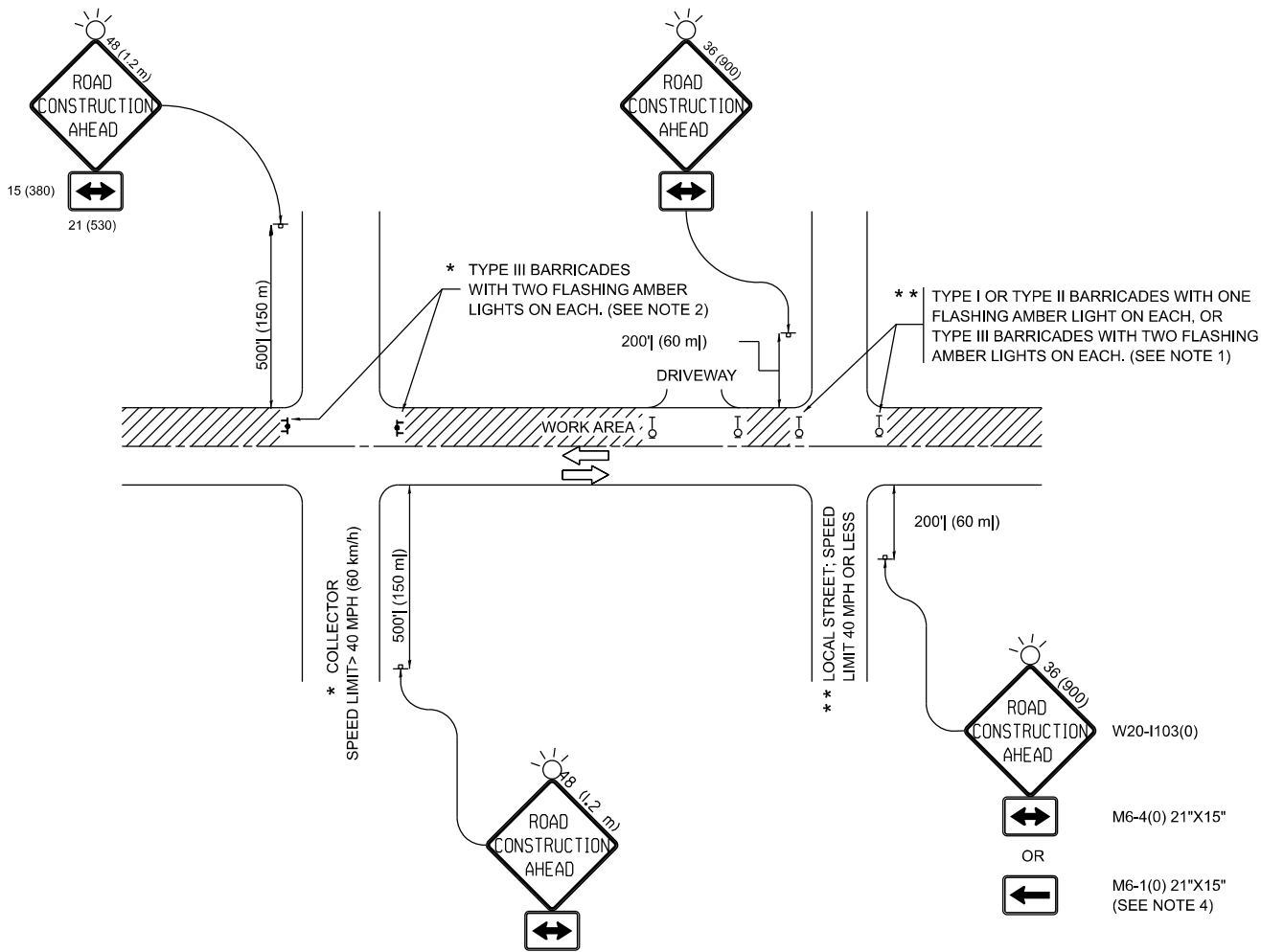

NOTES:

- SIDE ROAD WITH A SPEED LIMIT OF 40 MPH (60 km/h) OR LESS AS SHOWN ON THE DRAWING AND AS DIRECTED BY THE ENGINEER:
 - ONE "ROAD CONSTRUCTION AHEAD" SIGN 36 x 36 (900x900) WITH A FLASHER MOUNTED ON IT APPROXIMATELY 200' (60 m) IN ADVANCE OF THE MAIN ROUTE.
 - THE CLOSED PORTION OF THE MAIN ROUTE SHALL BE PROTECTED BY BLOCKING WITH TYPE I, TYPE II OR TYPE III BARRICADES, 1/3 OF THE CROSS SECTION OF THE CLOSED PORTION.
- SIDE ROAD WITH A SPEED LIMIT GREATER THAN 40 MPH (60 km/h) AS SHOWN ON THE DRAWING AND AS DIRECTED BY THE ENGINEER:
 - ONE "ROAD CONSTRUCTION AHEAD" SIGN 48 x 48 (1.2 m x 1.2 m) WITH A FLASHER MOUNTED ON IT APPROXIMATELY 500' (150 m) IN ADVANCE OF THE MAIN ROUTE.
 - THE CLOSED PORTION OF THE MAIN ROUTE SHALL BE PROTECTED BY BLOCKING WITH TYPE III BARRICADES, 1/2 OF THE CROSS SECTION OF THE CLOSED PORTION.
- CONES MAY BE SUBSTITUTED FOR BARRICADES OR DRUMS AT HALF THE SPACING DURING DAY OPERATIONS. CONES SHALL BE A MINIMUM OF 28 (710) IN HEIGHT.
- WHEN THE SIDE ROAD LIES BETWEEN THE BEGINNING OF THE MAINLINE SIGNING AND THE WORK ZONE, A SINGLE HEADED ARROW (M6-1) SHALL BE USED IN LIEU OF THE DOUBLE HEADED ARROW (M6-4).
- WHEN WORK IS BEING PERFORMED ON A SIDE ROAD OR DRIVEWAY, FOLLOW THE APPLICABLE STANDARD(S). THE DIRECTIONAL ARROW (M6-1 OR M6-4) SHALL BE COVERED OR REMOVED WHEN NO LONGER CONSISTENT WITH THE TRAFFIC CONTROL SET-UP.
- ADVANCE WARNING SIGNS ARE TO BE OMITTED ON DRIVEWAYS UNLESS OTHERWISE SPECIFIED IN THE PLANS OR BY THE ENGINEER.
- THE TRAFFIC CONTROL AND PROTECTION FOR SIDE ROADS, INTERSECTIONS, AND DRIVEWAYS SHALL BE INCLUDED IN THE COST OF SPECIFIED TRAFFIC CONTROL STANDARDS OR ITEMS.

All dimensions are in inches (millimeters)
unless otherwise shown.

	USER NAME = Phillip,Steed	DESIGNED - L.H.A.	REVISED - T. RAMMACHER 01-06-00	STATE OF ILLINOIS DEPARTMENT OF TRANSPORTATION	TRAFFIC CONTROL AND PROTECTION FOR SIDE ROADS, INTERSECTIONS, AND DRIVEWAYS	F.A.U. RTE.	SECTION	COUNTY	TOTAL SHEETS	SHEET NO.
		DRAWN -	REVISED - A. SCHUETZE 07-01-13			2798	2024-1030-RS	COOK	28	23
	PLOT SCALE = \$SCALE\$	CHECKED -	REVISED - A. SCHUETZE 09-15-16			TC-10		CONTRACT NO. 62X70		
	PLOT DATE = 3/21/2025	DATE - 06-89	REVISED - D. SENDERAK 05-03-24			SCALE: NONE	SHEET 1 OF 1 SHEETS	STA. TO STA.	ILLINOIS FED. AID PROJECT	

MODEL: Default
FILE NAME: p:\work\dot-sv-bentley.com\FW\DOT\Documents\DOT 0 cas\Dist44_1\ORD Projects\106125\CADD\Draw/CAD\Sheets\106125-sth-details.dgn

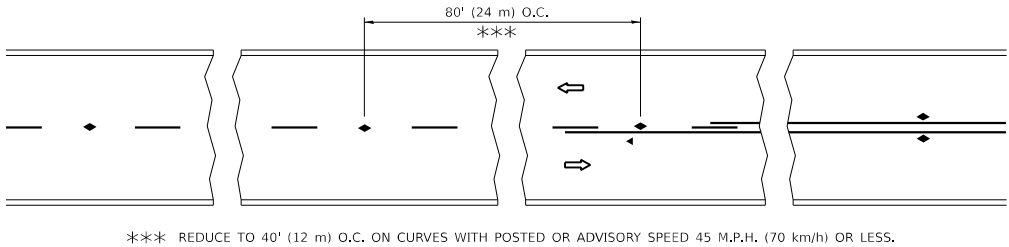

TWO-LANE/TWO-WAY

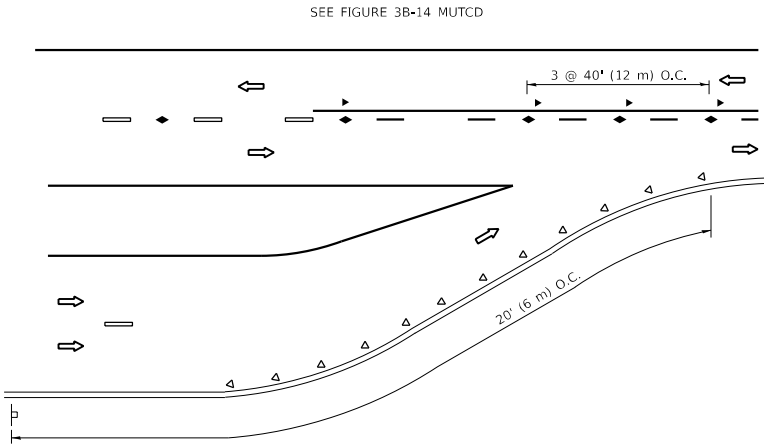

LANE REDUCTION TRANSITION

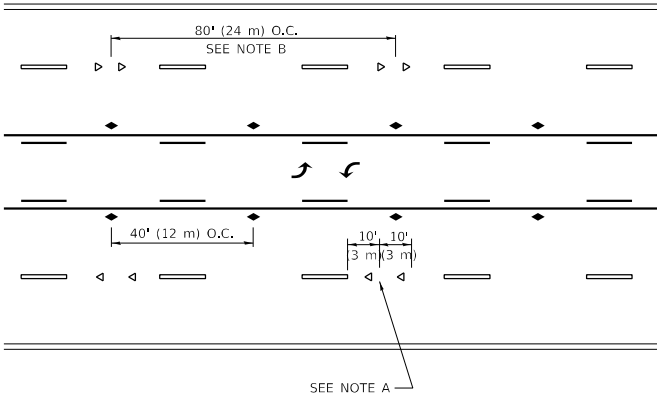

TWO-WAY LEFT TURN

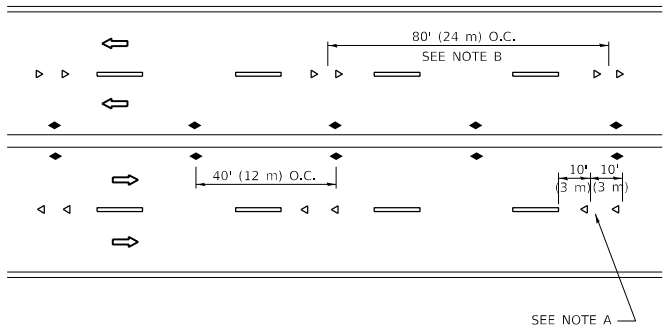

MULTI-LANE/UNDIVIDED

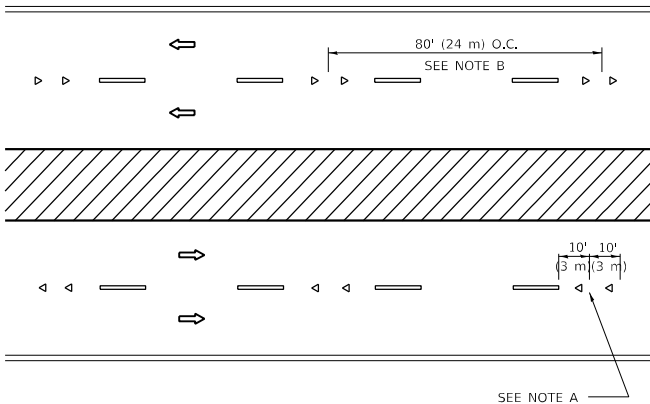

MULTI-LANE/DIVIDED

GENERAL NOTES

- MARKERS USED WITH DASHED LINES SHALL BE CENTERED IN THE GAP BETWEEN SEGMENTS.
- MARKERS USED ADJACENT TO SOLID LINES SHALL BE OFFSET 2 TO 3 (50 TO 75) TOWARD TRAFFIC AS SHOWN.
- MARKERS THROUGH TANGENTS LESS THAN 500' (150 m) IN LENGTH BETWEEN CURVES SHALL BE INSTALLED AT THE LESSER OF THE TWO CURVE SPACINGS.
- MARKERS ARE TO BE USED ADJACENT TO BOTH SOLID WHITE LINES IN DUAL LEFT TURN LANES

LANE MARKER NOTES

- USE DOUBLE LANE LINE MARKERS SPACED AS SHOWN.
- REDUCE TO 40' (12 m) O.C. ON CURVES WHERE ADVISORY SPEEDS ARE 10 M.P.H (20 km/h) LOWER THAN POSTED SPEEDS.

SYMBOLS

- YELLOW STRIPE
- WHITE STRIPE
- ONE-WAY AMBER MARKER
- ONE-WAY CRYSTAL MARKER (W/O)
- TWO-WAY AMBER MARKER

DESIGN NOTES

- DOUBLE LANE LINE MARKERS SHALL BE USED UNLESS SPECIFIED OTHERWISE.
- EXCEPT AS SHOWN ON THE LANE REDUCTION TRANSITION AND FREEWAY EXIT RAMP DETAIL, MARKERS ARE NOT TO BE SPECIFIED ON RIGHT EDGE LINES.
- THE EXACT MARKER LIMITS, SPACING, AND COLOR SHALL BE INCLUDED IN THE PLANS WHEN STANDARD SPECIFICATIONS ARE NOT BEING USED.
- MARKERS SHOULD NOT BE USED ALONGSIDE CURBS EXCEPT FOR EXTREMELY SHORT SECTIONS OF CURBS WHERE NOT MORE THAN TWO MARKERS WOULD BE INVOLVED.

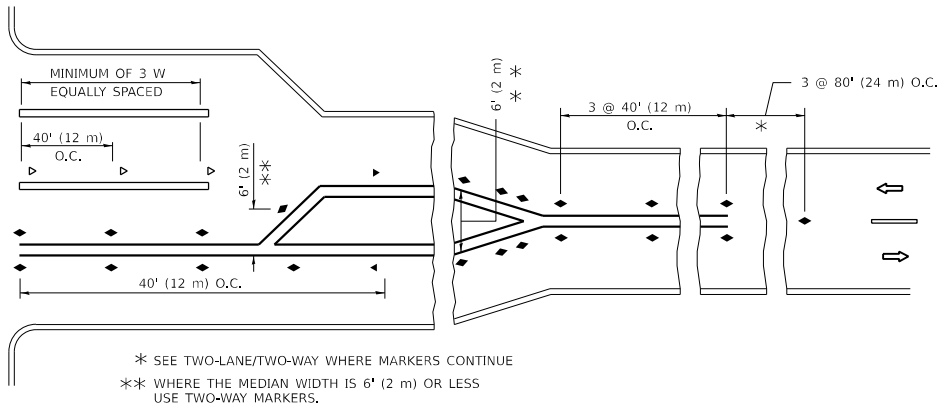
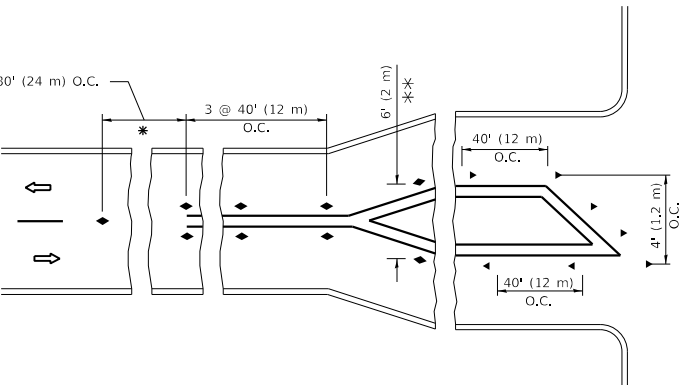

TURN LANES

All dimensions are in inches (millimeters) unless otherwise shown.

USER NAME = Phillip.Steed	DESIGNED -	REVISED - T. RAMMACHER 03-12-99
	DRAWN -	REVISED - T. RAMMACHER 01-06-00
PLOT SCALE = \$SCALE\$	CHECKED -	REVISED - C. JUCIUS 09-09-09
PLOT DATE = 3/21/2025	DATE -	REVISED - C. JUCIUS 07-01-13

STATE OF ILLINOIS
DEPARTMENT OF TRANSPORTATION

TYPICAL APPLICATIONS
RAISED REFLECTIVE PAVEMENT MARKERS (SNOW-PLOW RESISTANT)

SCALE: NONE SHEET 1 OF 1 SHEETS STA. TO STA.

F.A.U. RTE.	SECTION	COUNTY	TOTAL SHEETS	SHEET NO.
2798	2024-1030-RS	COOK	28	24
TC-11		CONTRACT NO. 62X70		
		ILLINOIS	FED. AID PROJECT	

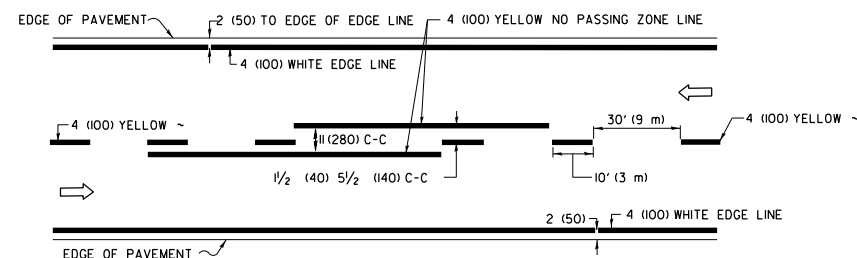

2-LANE ROADWAY

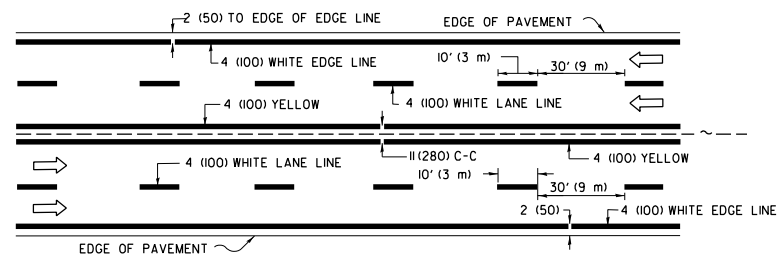

MULTI-LANE UNDIVIDED

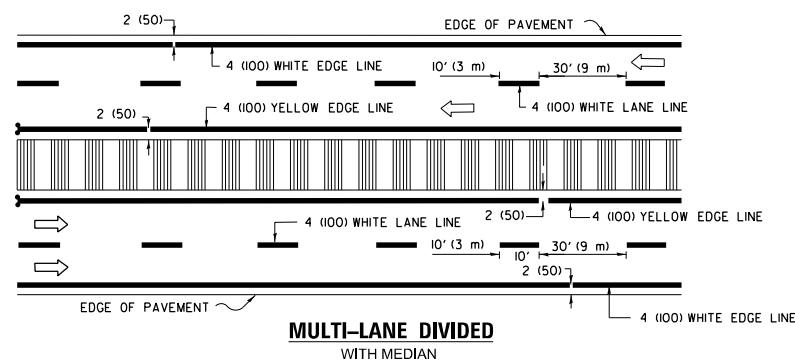

TYPICAL LANE AND EDGE LINE MARKING

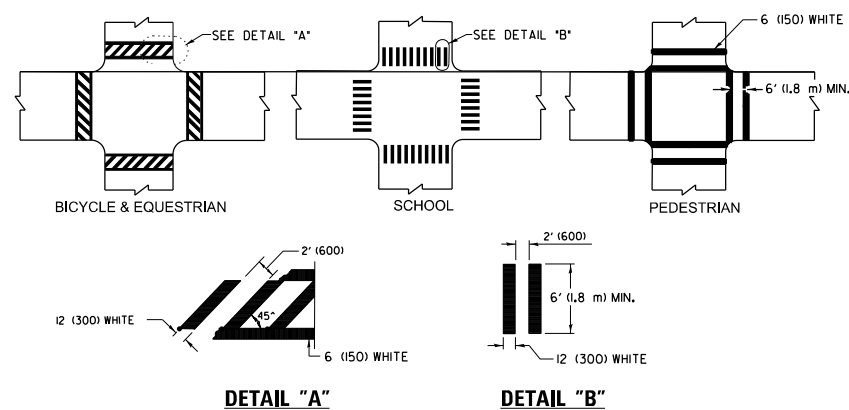

TYPICAL CROSSWALK MARKING

* MARKINGS SHALL BE INSTALLED PARALLEL TO THE CENTERLINE OF THE ROAD WHICH IT CROSSES

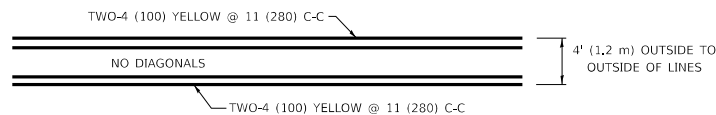

4' (1.2 m) WIDE MEDIANS ONLY

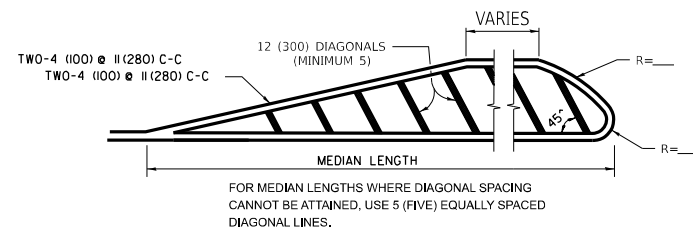

DIAGONAL LINE SPACING: 50' (15 m) C-C (LESS THAN 30MPH (50 km/h))
75' (25 m) C-C 30MPH (50 km/h) TO 45MPH (70 km/h))
150' (45 m) C-C (MORE THAN 45MPH (70 km/h))

MEDIANS OVER 4' (1.2 m) WIDE

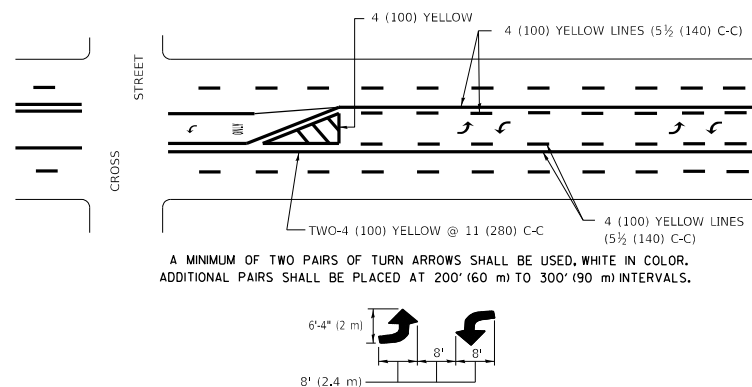

MEDIAN WITH TWO-WAY LEFT TURN LANE

TYPICAL PAINTED MEDIAN MARKING

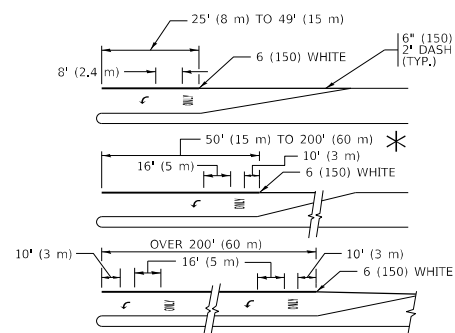

FULL SIZE LETTERS 8" (2.4 m) AND ARROWS SHALL BE USED.

* TURN LANES IN EXCESS OF 400' (120 m) IN LENGTH MAY HAVE AN ADDITIONAL SET OF ARROW - "ONLY" INSTALLED MIDWAY BETWEEN THE OTHER TWO SETS OF ARROW - "ONLY".

TYPICAL LEFT (OR RIGHT) TURN LANE

TYPICAL TURN LANE MARKING

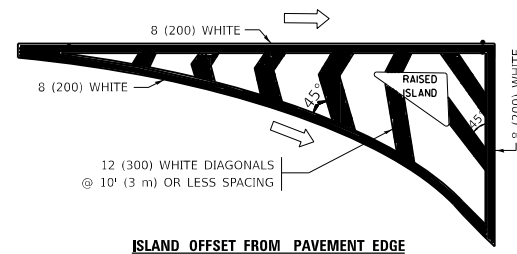

ISLAND OFFSET FROM PAVEMENT EDGE

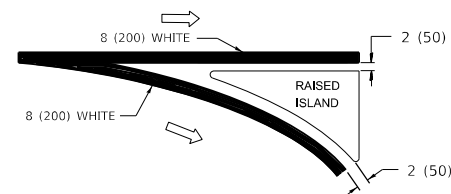

ISLAND AT PAVEMENT EDGE

TYPICAL ISLAND MARKING

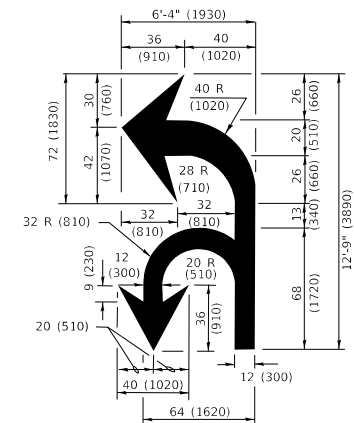

COMBINATION LEFT AND U-TURN

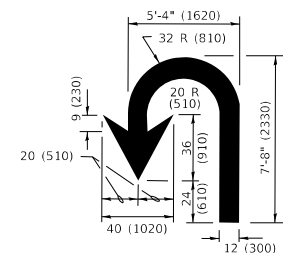

U-TURN

LANE REDUCTION TRANSITION

* LANE REDUCTION ARROWS REQUIRED AT SPEEDS OF 45 MPH OR GREATER OR WHEN SPECIFIED IN PLANS.

D(FT)	SPEED LIMIT
345	30
425	35
500	40
580	45
665	50
750	55

TYPE OF MARKING	WIDTH OF LINE	PATTERN	COLOR	SPACING / REMARKS
CENTERLINE ON 2 LANE PAVEMENT	4 (100)	SKIP-DASH	YELLOW	10' (3 m) LINE WITH 30' (9 m) SPACE
CENTERLINE ON MULTI-LANE UNDIVIDED PAVEMENT	2 @ 4 (100)	SOLID	YELLOW	11 (280) C-C
NO PASSING ZONE LINES: FOR ONE DIRECTION FOR BOTH DIRECTIONS	4 (100) 2 @ 4 (100)	SOLID SOLID	YELLOW YELLOW	5 ½ (140) C-C FROM SKIP-DASH CENTERLINE 11 (280) C-C OMIT SKIP-DASH CENTERLINE BETWEEN
LANE LINES	4 (100) 5 (125) ON FREEWAYS	SKIP-DASH SKIP-DASH	WHITE WHITE	10' (3 m) LINE WITH 30' (9 m) SPACE
DOTTED LINES (EXTENSIONS OF CENTER, LANE OR TURN LANE MARKINGS)	SAME AS LINE BEING EXTENDED	SKIP-DASH	SAME AS LINE BEING EXTENDED	2' (600) LINE WITH 6' (1.8 m) SPACE
EDGE LINES	4 (100)	SOLID	YELLOW-LEFT WHITE-RIGHT	OUTLINE MEDIANS IN YELLOW
TURN LANE MARKINGS	6 (150) LINE; FULL SIZE LETTERS & SYMBOLS (8' (2.4m))	SOLID	WHITE	SEE TYPICAL TURN LANE MARKING DETAIL
TWO WAY LEFT TURN MARKING	2 @ 4 (100) EACH DIRECTION 8' (2.4m) LEFT ARROW	SKIP-DASH AND SOLID IN PAIRS	YELLOW WHITE	10' (3 m) LINE WITH 30' (9 m) SPACE FOR SKIP-DASH; 5 ½ (140) C-C BETWEEN SOLID LINE AND SKIP-DASH LINE SEE TYPICAL TWO-WAY LEFT TURN MARKING DETAIL
CROSSWALK LINES (PEDESTRIAN) A. DIAGONALS (BIKE & EQUESTRIAN) B. LONGITUDINAL BARS (SCHOOL)	2 @ 6 (150) 12 (300) @ 45° 12 (300) @ 90°	SOLID SOLID SOLID	WHITE WHITE WHITE	NOT LESS THAN 6' (1.8 m) APART 2' (600) APART 2' (600) APART SEE TYPICAL CROSSWALK MARKING DETAILS.
STOP LINES	24 (600)	SOLID	WHITE	PLACE 4' (1.2 m) IN ADVANCE OF AND PARALLEL TO CROSSWALK, IF PRESENT. OTHERWISE, PLACE AT DESIRED STOPPING POINT, PARALLEL TO CROSSROAD CENTERLINE, WHERE POSSIBLE
PAINTED MEDIANS	2 @ 4 (100) WITH 12 (300) DIAGONALS @ 45° NO DIAGONALS USED FOR 4' (1.2 m) WIDE MEDIANS	SOLID	YELLOW: TWO WAY TRAFFIC WHITE: ONE WAY TRAFFIC	11 (280) C-C FOR THE DOUBLE LINE SEE TYPICAL PAINTED MEDIAN MARKING.
GORE MARKING AND CHANNELIZING LINES	8 (200) WITH 12 (300) DIAGONALS @ 45°	SOLID	WHITE	DIAGONALS: 15' (4.5 m) C-C (LESS THAN 30MPH (50 km/h)) 20' (6 m) C-C 30MPH (50 km/h) TO 45MPH (70 km/h)) 30' (9 m) C-C (OVER 45MPH (70 km/h))
RAILROAD CROSSING	24 (600) TRANSVERSE LINES; "RR" IS 6' (1.8 m) LETTERS; 16 (400) LINE FOR "X"	SOLID	WHITE	SEE STATE STANDARD 780001 AREA OF: *R=3.6 SQ. FT. (0.33 m) EA OF *X=54.0 SQ. FT. (5.0 m)
SHOULDER DIAGONALS (REQUIRED FOR SHOULDERS ≥ 8')	12 (300) @ 45°	SOLID	WHITE - RIGHT YELLOW - LEFT	50' (15 m) C-C (LESS THAN 30MPH (50 km/h)) 75' (25 m) C-C (30 MPH (50 km/h) TO 45MPH (70 km/h)) 150' (45 m) C-C (OVER 45MPH (70 km/h))
U TURN ARROW	SEE DETAIL	SOLID	WHITE	16.3 SF
2 ARROW COMBINATION LEFT AND U TURN	SEE DETAIL	SOLID	WHITE	30.4 SF

FOR FURTHER DETAILS ON PAVEMENT MARKING REFER TO
STANDARD SPECIFICATIONS FOR ROAD AND BRIDGE
CONSTRUCTION AND STATE STANDARD 780001.

All dimensions are in inches (millimeters) unless otherwise shown.

USER NAME = Phillip, Steed	DESIGNED - EVERS	REVISED - C. JUCIUS 09-09-09
	DRAWN -	REVISED - C. JUCIUS 07-01-13
PLOT SCALE = \$SCALE\$	CHECKED -	REVISED - C. JUCIUS 12-21-15
PLOT DATE = 3/21/2025	DATE - 03-19-90	REVISED - C. JUCIUS 04-12-16

STATE OF ILLINOIS
DEPARTMENT OF TRANSPORTATION

DISTRICT ONE TYPICAL PAVEMENT MARKINGS

SCALE: NONE	SHEET 1 OF 2 SHEETS	STA. TO STA.
-------------	---------------------	--------------

F.A.U. RTE.	SECTION	COUNTY	TOTAL SHEETS	SHEET NO.
2798	2024-1031-RS	COOK	28	25
TC-13		CONTRACT NO. 62X70		
	ILLINOIS	FED. AID PROJECT		

TURN BAY ENTRANCE AT START
OF LANE CLOSURE TAPER

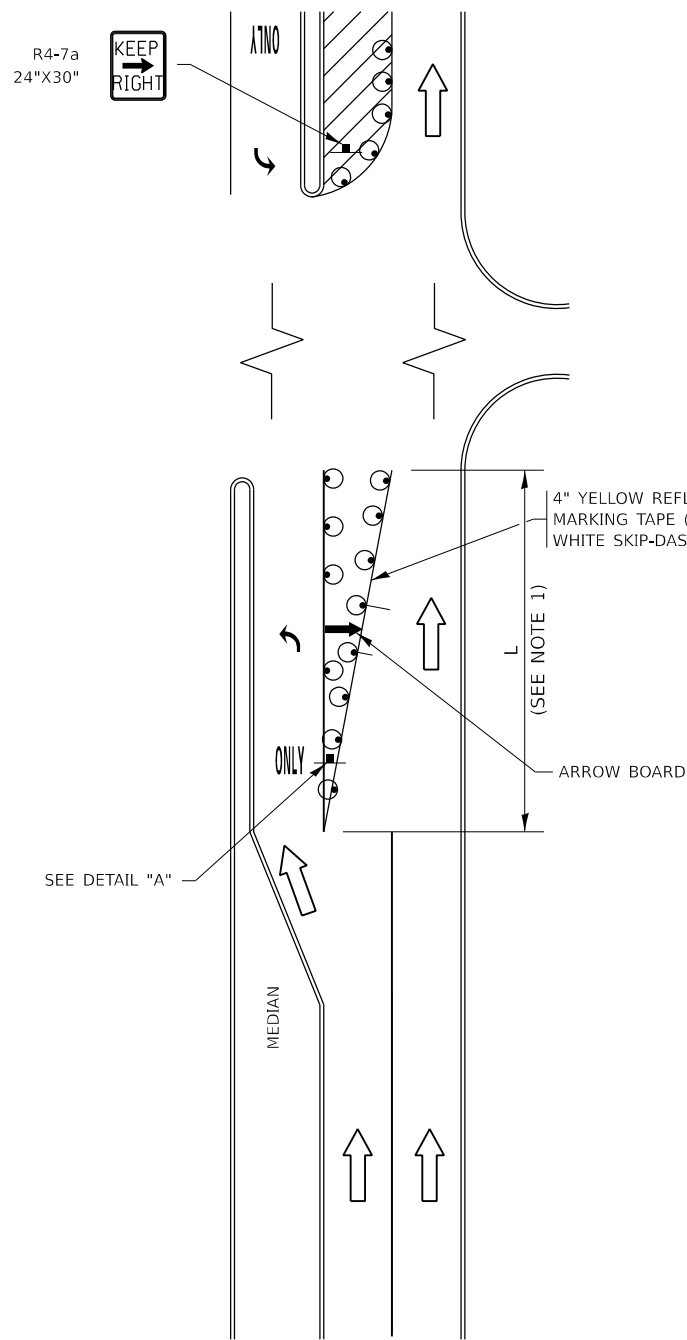

FIGURE 1

LEGEND

- WORK AREA
- LANE OPEN TO TRAFFIC
- ARROW BOARD
- TYPE I OR II BARRICADE OR DRUM WITH STEADY BURN LIGHT
- DRUM WITH STEADY BURN LIGHT
- SIGN ASSEMBLY
- TYPE I OR II CHECK BARRICADE WITH FLASHING LIGHT

NOTES:

- A) WHEN "L" IS \leq THE STORAGE LENGTH OF THE TURN LANE (AS SHOWN IN FIG. 1), USE FIGURE 1.
B) WHEN "L" IS $>$ THE STORAGE LENGTH OF THE TURN LANE OR THE TURN LANE IS WITHIN THE LANE CLOSURE, USE FIGURE 2.
- CONES MAY BE SUBSTITUTED FOR BARRICADES OR DRUMS AT HALF THE SPACING DURING DAY OPERATIONS. CONES SHALL BE A MINIMUM OF 28 (710) IN HEIGHT.
- LIGHTS WILL NOT BE REQUIRED ON BARRICADES OR DRUMS FOR DAY OPERATIONS. ALL LIGHTS SHALL BE MONODIRECTIONAL.
- REFLECTIVE TEMPORARY PAVEMENT MARKINGS SHALL BE PLACED THROUGHOUT THE BARRICADED AREAS OF EACH TURN BAY AS SHOWN WHERE THE CLOSURE TIME IS GREATER THAN FOURTEEN (14) DAYS.
- THIS APPLICATION ALSO APPLIES WHEN WORK IS BEING PERFORMED IN THE RIGHT LANE(S) AND THE RIGHT TURN BAY IS TO REMAIN OPEN. UNDER THIS CONDITION, "RIGHT TURN LANE" R3-I100R 24 x 24 (600 x 600) AND M6-2R 21 x 15 (530 x 380) SHALL BE USED.
- THESE CONTROLS SHALL SUPPLEMENT MAINLINE TRAFFIC CONTROL FOR LANE CLOSURES.
- THE SIGNS SHALL BE MOUNTED ABOVE THE BARRICADES/DRUMS ON SEPARATE SIGN SUPPORTS THAT MEET NCHRP 350 OR MASH REQUIREMENTS.
- TRAFFIC CONTROL AND PROTECTION AT TURN BAYS (TO REMAIN OPEN TO TRAFFIC) SHALL BE INCLUDED IN THE COST OF SPECIFIED TRAFFIC CONTROL STANDARDS OR ITEMS.

TURN BAY ENTRANCE
WITHIN A LANE CLOSURE

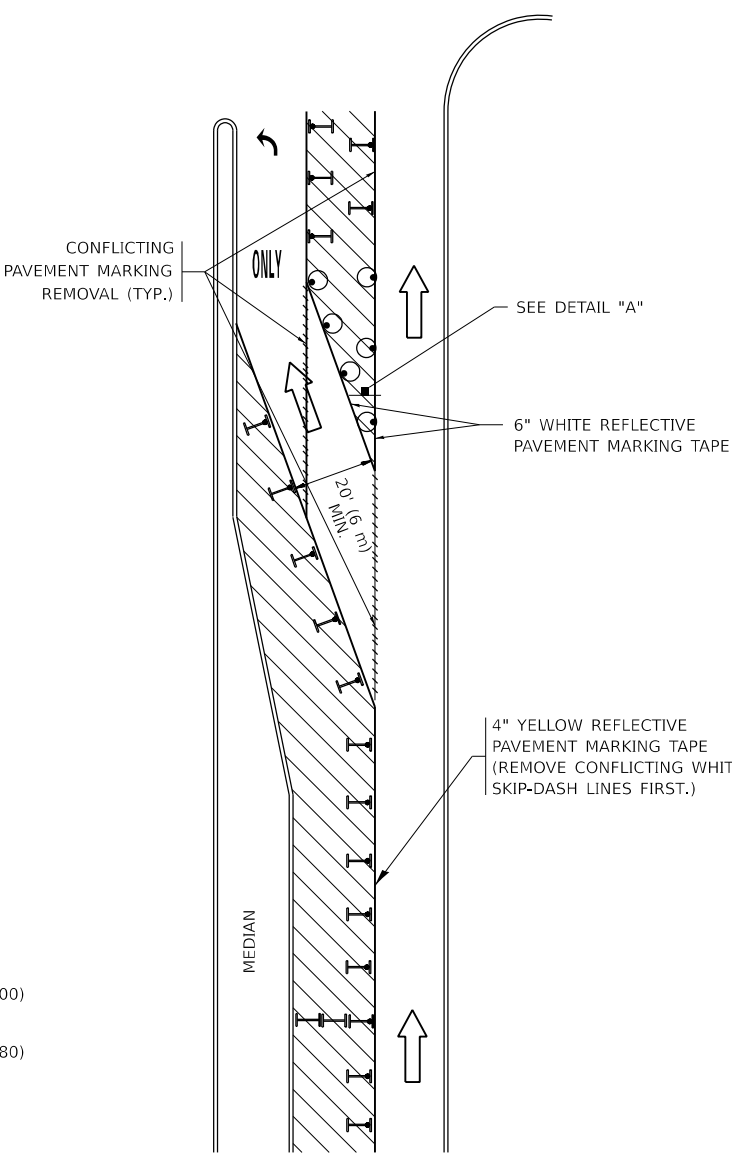
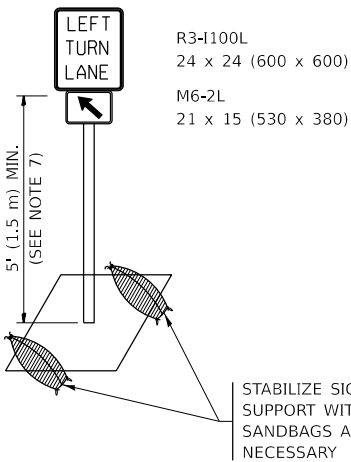

FIGURE 2



DETAIL A

All dimensions are in inches (millimeters) unless otherwise shown.

MODEL: Default
FILE NAME: p:\projects\sw_bentley.com\FW\DOT\Documents\DOT 0 cas\DistHt_1\ORD Projects\106125\CADData\CAD\Sheets\106125-TH-Detail.dgn

USER NAME = Phillip.Steed	DESIGNED - T. RAMMACHER 09-08-94
	DRAWN - A. HOUSEH 11-07-95
PLOT SCALE = \$SCALE\$	CHECKED - A. HOUSEH 10-12-96
PLOT DATE = 3/21/2025	DATE - T. RAMMACHER 01-06-00

REVISED - R. BORO 09-14-09
REVISED - A. SCHUETZE 07-01-13
REVISED - A. SCHUETZE 09-15-16
REVISED -

STATE OF ILLINOIS
DEPARTMENT OF TRANSPORTATION

TRAFFIC CONTROL AND PROTECTION AT TURN BAYS
(TO REMAIN OPEN TO TRAFFIC)

SCALE: NONE SHEET 1 OF 1 SHEETS STA. TO STA.

F.A.U. RTE.	SECTION	COUNTY	TOTAL SHEETS	SHEET NO.
2798	2024-1030-RS	COOK	28	26
TC-14		CONTRACT NO. 62X70		
		ILLINOIS	FED. AID PROJECT	

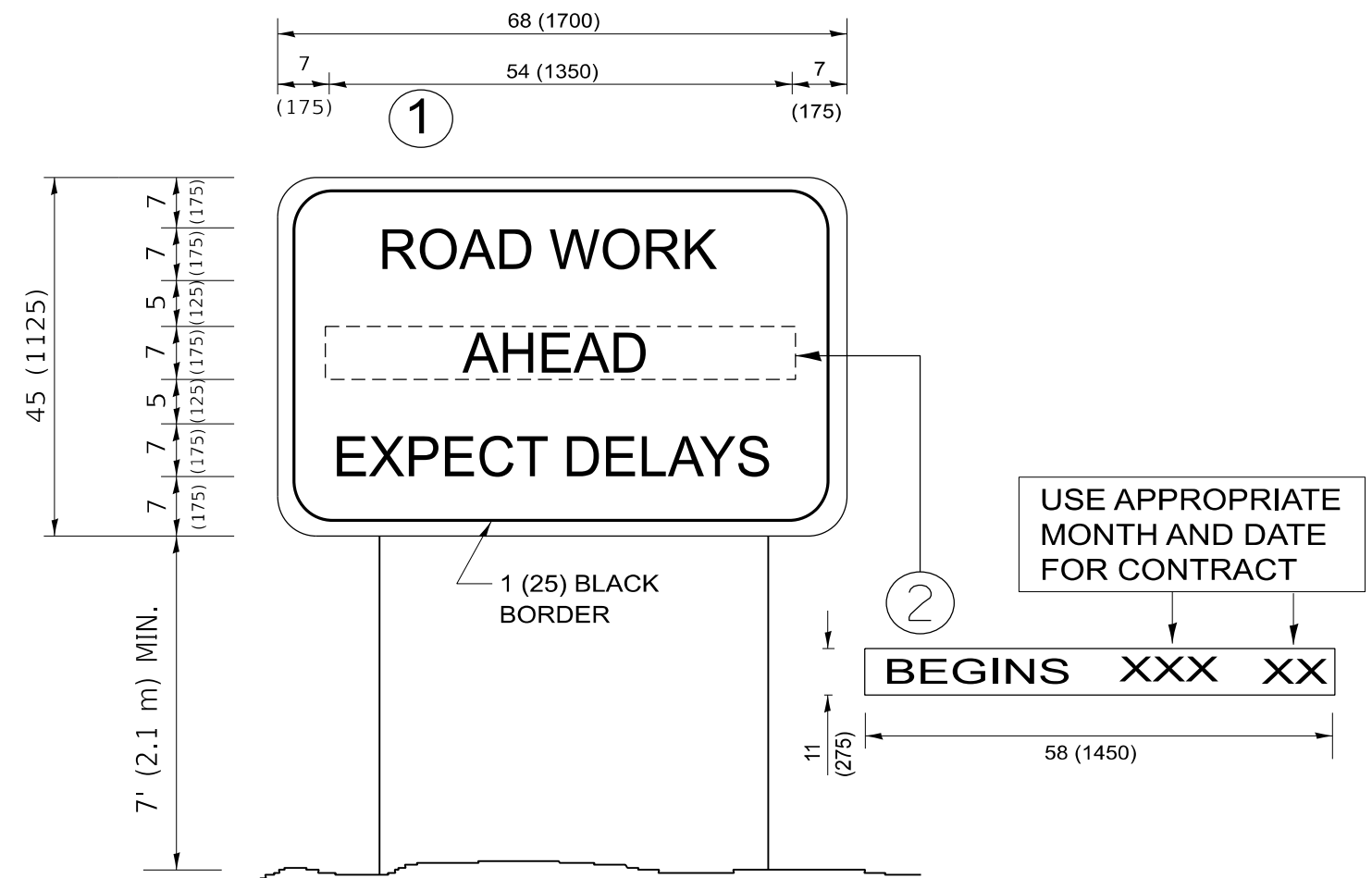

NOTES:

1. USE BLACK LETTERING ON ORANGE BACKGROUND.
2. ERECT SIGNS IN ADVANCE OF THE LOCATION FOR THE "ROAD CONSTRUCTION AHEAD" SIGN AT LOCATIONS AS DIRECTED BY THE ENGINEER.
3. ERECT SIGN ① WITH INSTALLED PANEL 2 ① WEEK PRIOR TO THE START OF CONSTRUCTION.
4. REMOVE PANEL 2 ② SOON AFTER THE START OF CONSTRUCTION.
5. SEE SPECIAL PROVISION FOR "TEMPORARY INFORMATION SIGNING" FOR ADDITIONAL INFORMATION.
6. ONE SIGN ASSEMBLY EQUALS 25.70 SQ. FT. (2.3 SQ. M.)
7. SHALL BE PAID FOR AS TEMPORARY INFORMATION SIGNING.

ALL DIMENSIONS ARE IN INCHES (MILLIMETERS)
UNLESS OTHERWISE SHOWN.

FILE NAME: DWG	USER NAME = Phillip,Steed	DESIGNED -	REVISED - R. MIRS 09-15-97	STATE OF ILLINOIS DEPARTMENT OF TRANSPORTATION	ARTERIAL ROAD INFORMATION SIGN	F.A.U. RTE.	SECTION	COUNTY	TOTAL SHEETS	SHEET NO.
		DRAWN -	REVISED - R. MIRS 12-11-97			279E	2024-1030-RS	COOK	28	28
	PLOT SCALE = \$SCALE\$	CHECKED -	REVISED - T. RAMMACHER 02-02-99			TC-22		CONTRACT NO. 62V87		
	PLOT DATE = 3/21/2025	DATE -	REVISED - C. JUCIUS 01-31-07							
					SCALE: NONE	SHEET 1 OF 1 SHEETS	STA.	TO STA.		
							ILLINOIS	FED. AID PROJECT		