

STATE OF ILLINOIS  
DEPARTMENT OF TRANSPORTATION

F.A.P RTE.	SECTION	COUNTY	TOTAL SHEETS	SHEET NO.
41	(12,13,14)CJS,SR	KANKAKEE	22	1
		ILLINOIS	CONTRACT NO. 66R18	

**INDEX OF SHEETS**

- 1 COVER SHEET
- 2 GENERAL NOTES & COMMITMENTS
- 3 - 5 SUMMARY OF QUANTITIES
- 6 - 8 TYPICAL SECTIONS
- 9 - 14 SCHEDULES
- 15 - 17 LINE DRAWINGS
- 18 - 22 DETAILS

**HIGHWAY STANDARDS**

- 000001-08 STANDARD SYMBOLS, ABBREVIATIONS, AND PATTERNS
- 001006 DECIMAL OF AN INCH AND OF A FOOT
- 406201-01 MAILBOX TURNOUT
- 482001-02 HMA SHOULDER ADJACENT TO FLEXIBLE PAVEMENT
- 642006-01 SHOULDER RUMBLE STRIPS, 8 IN.
- 701006-05 OFF-RD OPERATIONS, 2L, 2W, 15' TO 24" FROM PAVEMENT EDGE
- 701306-04 LANE CLOSURE, 2L, 2W, SLOW MOVING OPERATIONS DAY ONLY, FOR SPEEDS ≥ 45 MPH
- 701311-03 LANE CLOSURE, 2L, 2W, MOVING OPERATIONS - DAY ONLY
- 701326-04 LANE CLOSURE, 2L, 2W, PAVEMENT WIDENING FOR SPEEDS ≥ 45 MPH
- 701901-10 TRAFFIC CONTROL DEVICES
- 781001-04 TYPICAL APPLICATIONS RAISED REFLECTIVE PAVEMENT MARKERS

**PROPOSED  
HIGHWAY PLANS**

**FAP ROUTE 41 (IL 17)  
SECTION (12,13,14)CJS,SR  
CRACK & JOINT SEALING, MICRO-SURFACING,  
SHOULDER WIDENING & RUMBLE STRIPS  
KANKAKEE COUNTY**

C-93-065-25

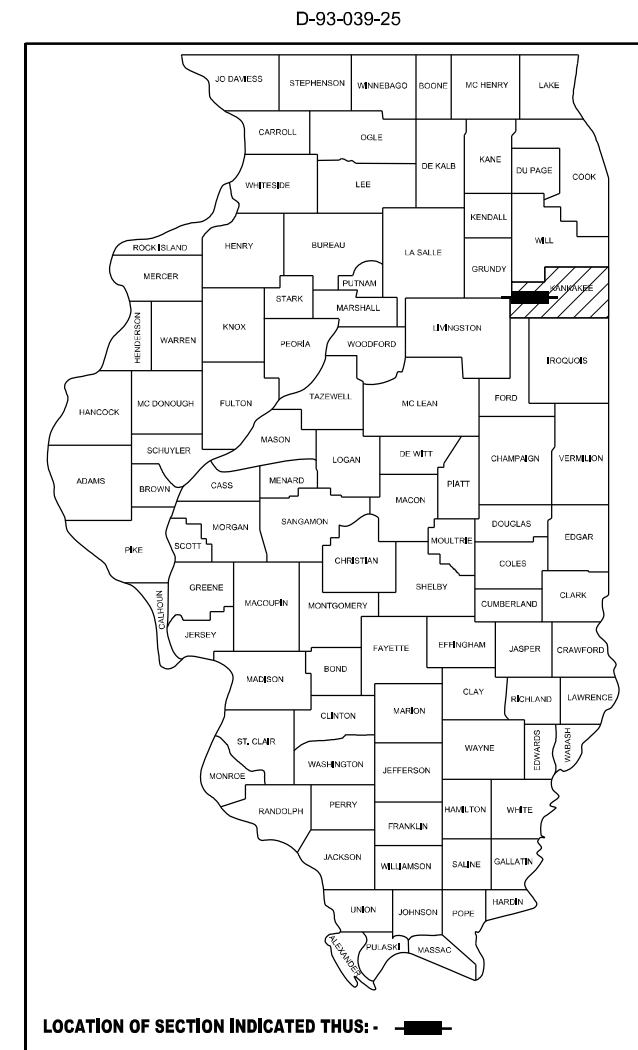

**FUNCTIONAL CLASSIFICATION**

LOCATION 1	LOCATION 2
RURAL MINOR ARTERIAL	RURAL MINOR ARTERIAL
FAP ROUTE 41 (IL 17)	FAP ROUTE 41 (IL 17)
2023 ADT = 2300	2023 ADT = 6750
P.V. = 81.5%	P.V. = 91.1%
S.U. = 6.5%	S.U. = 4.1%
M.U. = 12.0%	M.U. = 4.8%

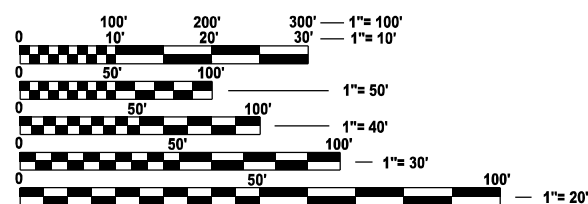
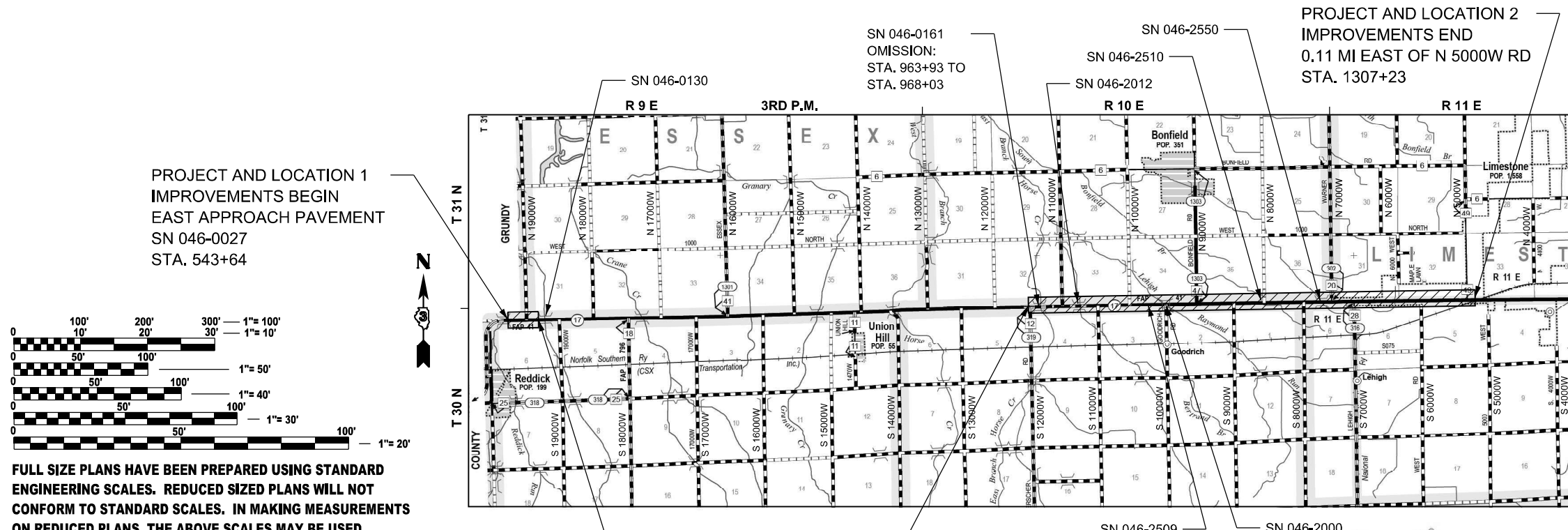

FULL SIZE PLANS HAVE BEEN PREPARED USING STANDARD ENGINEERING SCALES. REDUCED SIZED PLANS WILL NOT CONFORM TO STANDARD SCALES. IN MAKING MEASUREMENTS ON REDUCED PLANS, THE ABOVE SCALES MAY BE USED.

**J.U.L.I.E.**  
JOINT UTILITY LOCATION INFORMATION FOR EXCAVATION  
1-800-892-0123  
OR 811

**PROJECT ENGINEER: JUNIOR SENAT**  
**UNIT CHIEF: RON WOODSHANK**  
**DISTRICT 3 NO.: (815) 434-6131**  
**CONTRACT NO. 66R18**

GROSS LENGTH = 37,079.36 FT. = 7.023 MILE  
NET LENGTH = 36,669.36 FT. = 6.945 MILE

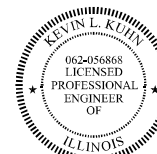

DATE: JANUARY 22 20 25  
EXPIRES: NOVEMBER 30 20 25



**KUHN & TRELLO**  
CONSULTING ENGINEERS  
A Limited Liability Company  
100 N. 7th Street, 3rd Floor  
Springfield, IL 62704  
Phone: 317-679-0044  
Professional Design Firm No. 184-005516

STATE OF ILLINOIS  
DEPARTMENT OF TRANSPORTATION

SUBMITTED: March 25, 20 25

*Trisha Thompson*  
REGIONAL ENGINEER

May 9, 20 25

*Scott E. [Signature]*  
ENGINEER OF DESIGN AND ENVIRONMENT

May 9, 20 25

*[Signature]*  
DIRECTOR OF HIGHWAYS PROJECT IMPLEMENTATION

**PRINTED BY THE AUTHORITY  
OF THE STATE OF ILLINOIS**

## GENERAL NOTES

THE HMA SURFACE OF ALL MAILBOX TURNOUTS, PRIVATE ENTRANCES, COMMERCIAL ENTRANCES, AND SIDE ROADS SHALL BE MADE NEATLY, IN A WORKMANLIKE MANNER, AND SHALL ACCURATELY CONFORM TO THE SHAPES AND DIMENSIONS SHOWN ON THE PLAN DETAILS. IF REQUIRED BY THE ENGINEER, THE CONTRACTOR SHALL SAW CUT THE HMA SURFACE TO CONFORM TO THE SHAPES AND DIMENSIONS SHOWN ON THE PLAN DETAILS. THIS WORK WILL BE INCLUDED IN THE COST OF THE HMA SURFACE.

PLAN DIMENSIONS AND DETAILS RELATIVE TO EXISTING PLANS ARE SUBJECT TO NOMINAL CONSTRUCTION VARIATIONS. THE CONTRACTOR SHALL FIELD VERIFY EXISTING DIMENSIONS AND DETAILS AFFECTING NEW CONSTRUCTION AND MAKE NECESSARY APPROVED ADJUSTMENTS PRIOR TO CONSTRUCTION OR ORDERING OF MATERIALS. SUCH VARIATIONS SHALL NOT BE CAUSE FOR ADDITIONAL COMPENSATION FOR A CHANGE IN SCOPE OF WORK; HOWEVER, THE CONTRACTOR WILL BE PAID FOR THE QUANTITY ACTUALLY FURNISHED AT THE UNIT PRICE BID FOR THE WORK.

ANY REFERENCE TO A STANDARD IN THESE PLANS SHALL BE INTERPRETED TO MEAN THE EDITION AS INDICATED BY THE SUBNUMBER SHOWN IN THE LIST OF STANDARDS OR THE COPY INCLUDED IN THESE PLANS.

THE ENGINEER WILL BE THE SOLE JUDGE CONCERNING CURING TIME FOR THE VARIOUS HMA LIFTS.

THE ENGINEER WILL BE THE SOLE JUDGE CONCERNING CURING TIME FOR THE MICRO-SURFACING AND WHEN THE ROADWAY WILL BE OPENED TO TRAFFIC.

THE AGGREGATES FOR THE SURFACE LIFT OF MICRO-SURFACING SHALL MEET THE FRICTION AGGREGATE REQUIREMENTS FOR MIXTURE D IN ARTICLE 1004.03(a).

THE CONTRACTOR SHALL CONTACT JULIE AT LEAST 48 HOURS PRIOR TO EXCAVATION TO DETERMINE WHICH UTILITIES ARE IN THE AREA.

THE INTENT OF CRACK FILLING ON THIS PROJECT IS TO ROUT AND SEAL WORKING TRANSVERSE CRACKS AND PRIMARY LONGITUDINAL CRACKS GREATER THAN 1/4" IN WIDTH. SECONDARY CRACKS GREATER THAN 1/4" IN WIDTH SHALL BE CLEANED AND SEALED.

THE ENGINEER SHALL DETERMINE WHETHER SECTIONS OF CRACK SEALING SHOULD BE OMITTED IN ORDER TO AVOID DAMAGING THE PAVEMENT MARKING IN THOSE AREAS.

ALL PCC BRIDGE DECKS AND PAVEMENT SHALL BE OMITTED. BRIDGE DECKS WITH HMA OVERLAYS ARE TO BE SEALED ONLY (NO ROUTING).

ALL EXCAVATED MATERIAL, WHICH INCLUDES DIGGING OR GRADING OF ANY SOIL OR FILL MATERIAL, WITH THE EXCEPTION OF AGGREGATE FILLS, MUST BE INCORPORATED WITHIN THE IDOT RIGHT OF WAY.

FINAL PAVEMENT MARKINGS INCLUDING STRIPING AND RAISED REFLECTIVE PAVEMENT MARKERS SHALL BE OFFSET FROM CENTERLINE 2"

THE FOLLOWING RATES OF APPLICATION HAVE BEEN USED IN CALCULATING PLAN QUANTITIES:

HMA RESURFACING	112	LBS / SQ YD / IN
CRACK FILLING	0.5	POUND / FOOT
MIX FOR CRACKS, JTS & FLGWYS	0.0003	TONS / SQ YD

## COMMITMENTS

NONE.

**HMA MIXTURE REQUIREMENT TABLE**

LOCATIONS:	HOT-MIX ASPHALT		
	SHOULDERS		ENTIRE PROJECT
	HMA BINDER	HMA SURFACE	LONGITUDINAL PARTIAL DEPTH PATCHING
MIXTURE USE(S):	BOTTOM LIFTS	TOP LIFT (1.5")	
BINDER GRADE (PG):	PG 64-22	PG 64-22	PG 64-22
DESIGN AIR VOIDS:	4% @ N50	4% @ N50	4% @ N70
MIXTURE COMPOSITION: (MIXTURE GRADATION):	IL 19.0	IL 9.5	IL 9.5
FRICTION AGGREGATE:		MIXTURE C	MIXTURE D
MIXTURE WEIGHT:	112.0 LB/SY/IN	112.0 LB/SY/IN	112.0 LB/SY/IN
QUALITY MANAGEMENT PROGRAM:	QC/QA	QC/QA	QC/QA
SUBLOT SIZE:	N/A	N/A	N/A
DENSITY TEST METHOD:	CORES / NUCLEAR	CORES / NUCLEAR	CORES / NUCLEAR

STATE OF ILLINOIS  
DEPARTMENT OF TRANSPORTATION  
DISTRICT 3  
AS-BUILT INFORMATION

SUPERVISING CONSTRUCTION FIELD ENGINEER

RESIDENT ENGINEER / TECHNICIAN

START & END DATES OF CONSTRUCTION:

INSPECTORS:

STATE OF ILLINOIS  
DEPARTMENT OF TRANSPORTATION

GENERAL NOTES

SCALE: SHEET 1 OF 1 SHEETS STA. TO STA.

F.A.P. RTE.	SECTION	COUNTY	TOTAL SHEETS	SHEET NO.
41	(12,13,14)CJS,SR	KANKAKEE	22	2
CONTRACT NO. 66R18				
ILLINOIS FED. AID PROJECT				

MODEL: Commote Sheet  
FILE NAME: I:\2022\22069.09 IDOT D3 - PTB\_205-023 - W09 - Kankakee County 66R18\CADD\Drawings\CAD\Drawings\18-shit-Commote.dgn



USER NAME = msulheard  
DESIGNED - JS  
DRAWN - MS  
CHECKED - JS  
DATE - 10/21/24  
PLOT DATE = 1/20/2025

REVISIED -  
REVISIED -  
REVISIED -  
REVISIED -

MODEL: SOQ Sheet  
 FILE NAME: I:\2022\22069.09 IDOT D3 - PTB 205-023 - W09 - Kankakee County 66R18\CADD\Drawings\CAD\Drawings\18-shit-SOQ01.dgn

CODE NO.	ITEM	UNIT	TOTAL QUANTITY	CONSTRUCTION CODE
				CONTRACT MAINTENANCE
				100% STATE
				ROADWAY
				0005
				NONE
20200600	EXCAVATING AND GRADING EXISTING SHOULDER	UNIT	590	590
25000200	SEEDING, CLASS 2	ACRE	14	14
25000400	NITROGEN FERTILIZER NUTRIENT	POUND	1219	1219
25000500	PHOSPHORUS FERTILIZER NUTRIENT	POUND	1219	1219
25000600	POTASSIUM FERTILIZER NUTRIENT	POUND	1219	1219
25100105	MULCH, METHOD 1	ACRE	14	14
40400118	MICRO-SURFACING, SINGLE PASS	SQ YD	16213	16213
40600290	BITUMINOUS MATERIALS (TACK COAT)	POUND	16144	16144
40600400	MIXTURE FOR CRACKS, JOINTS, AND FLANGEWAYS	TON	2.4	2.4
45100100	CRACK ROUTING (PAVEMENT)	FOOT	21600	21600
45100200	CRACK FILLING	POUND	10800	10800
48203029	HOT-MIX ASPHALT SHOULDERS, 8"	SQ YD	19662	19662
64200108	SHOULDER RUMBLE STRIPS, 8 INCH	FOOT	57778	57778
67000400	ENGINEER'S FIELD OFFICE, TYPE A	CAL MO	6	6



USER NAME = msulheard  
 PLOT DATE = 1/20/2025

DESIGNED - JS  
 DRAWN - MS  
 CHECKED - JS  
 DATE - 12/19/24

REVISED -  
 REVISED -  
 REVISED -  
 REVISED -

**STATE OF ILLINOIS  
 DEPARTMENT OF TRANSPORTATION**

**SUMMARY OF QUANTITIES**

SCALE: SHEET 1 OF 3 SHEETS STA. TO STA.

F.A.P. RTE.	SECTION	COUNTY	TOTAL SHEETS	SHEET NO.
41	(12,13,14)CJS,SR	KANKAKEE	22	3
CONTRACT NO. 66R18				
ILLINOIS FED. AID PROJECT				

MODEL: SOQ Sheet  
 FILE NAME: I:\2022\22069.09 IDOT D3 - PTB 205-023 - W09 - Kankakee County 66R18\CADD\Drawings\CAD\Drawings\18-shit-SOQ02.dgn

CONSTRUCTION CODE	
CONTRACT MAINTENANCE	
100% STATE	
ROADWAY	
0005	
NONE	

CODE NO.	ITEM	UNIT	TOTAL QUANTITY	
67100100	MOBILIZATION	L SUM	1	1
70100460	TRAFFIC CONTROL AND PROTECTION, STANDARD 701306	L SUM	1	1
70100500	TRAFFIC CONTROL AND PROTECTION, STANDARD 701326	L SUM	1	1
70103815	TRAFFIC CONTROL SURVEILLANCE	CAL DA	20	20
70300100	SHORT TERM PAVEMENT MARKING	FOOT	9544	9544
70300150	SHORT TERM PAVEMENT MARKING REMOVAL	SQ FT	1590	1590
* 78004600	PREFORMED PLASTIC PAVEMENT MARKING, TYPE D - STANDARD - LETTERS AND SYMBOLS	SQ FT	170.4	170.4
* 78004720	PREFORMED PLASTIC PAVEMENT MARKING, TYPE D - STANDARD - LINE 24"	FOOT	66	66
* 78009004	MODIFIED URETHANE PAVEMENT MARKING - LINE 4"	FOOT	159807	159807
* 78009006	MODIFIED URETHANE PAVEMENT MARKING - LINE 6"	FOOT	16728	16728
* 78009008	MODIFIED URETHANE PAVEMENT MARKING - LINE 8"	FOOT	1268	1268
* 78009012	MODIFIED URETHANE PAVEMENT MARKING - LINE 12"	FOOT	1124	1124
* 78011000	GROOVING FOR RECESSED PAVEMENT MARKING, LETTERS AND SYMBOLS	SQ FT	170.4	170.4
* 78011125	GROOVING FOR RECESSED PAVEMENT MARKING 25"	FOOT	66	66

\*= SPECIALTY ITEM



USER NAME = msulheard	DESIGNED - JS	REVISED -
	DRAWN - MS	REVISED -
	CHECKED - JS	REVISED -
PLOT DATE = 1/20/2025	DATE - 12/19/24	REVISED -

**STATE OF ILLINOIS  
 DEPARTMENT OF TRANSPORTATION**

**SUMMARY OF QUANTITIES**

SCALE: SHEET 2 OF 3 SHEETS STA. TO STA.

F.A.P. RTE.	SECTION	COUNTY	TOTAL SHEETS	SHEET NO.
41	(12,13,14)CJS,SR	KANKAKEE	22	4
CONTRACT NO. 66R18			ILLINOIS FED. AID PROJECT	

MODEL: SOQ Sheet  
 FILE NAME: I:\2022\2069.09 IDOT D3 - PTB 205-023 - W09 - Kankakee County 66R18\CADD\Drawings\CAD\Sheet\66R18-shr-SOQ03.dgn

CODE NO.	ITEM	UNIT	TOTAL QUANTITY	CONSTRUCTION CODE	
				CONTRACT MAINTENANCE	
				100% STATE	
				ROADWAY	
				0005	NONE
* 78100100	RAISED REFLECTIVE PAVEMENT MARKER	EACH	540		540
78300200	RAISED REFLECTIVE PAVEMENT MARKER REMOVAL	EACH	540		540
X4405020	LONGITUDINAL PARTIAL DEPTH REMOVAL 2"	FOOT	36480		36480
X4420900	LONGITUDINAL PARTIAL DEPTH PATCHING	TON	908		908
X7200061	TEMPORARY INFORMATION SIGNING	SQ FT	42		42

\*= SPECIALTY ITEM



USER NAME = msutheard	DESIGNED - JS	REVISED -
	DRAWN - MS	REVISED -
	CHECKED - JS	REVISED -
PLOT DATE = 1/20/2025	DATE = 12/19/24	REVISED -

**STATE OF ILLINOIS  
 DEPARTMENT OF TRANSPORTATION**

**SUMMARY OF QUANTITIES**

SCALE: SHEET 3 OF 3 SHEETS STA. TO STA.

F.A.P. RTE.	SECTION	COUNTY	TOTAL SHEETS	SHEET NO.
41	(12,13,14)CJS,SR	KANKAKEE	22	5
CONTRACT NO. 66R18				
ILLINOIS FED. AID PROJECT				

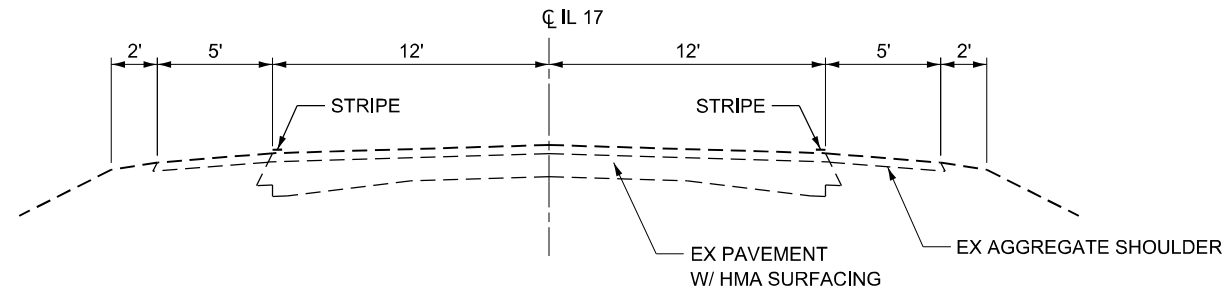

**EXISTING TYPICAL SECTION - LOCATION 1**

STA. 543+64 TO STA. 564+42

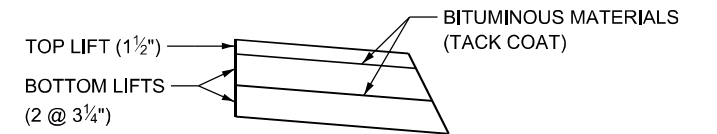

**HMA SHOULDER DETAIL**

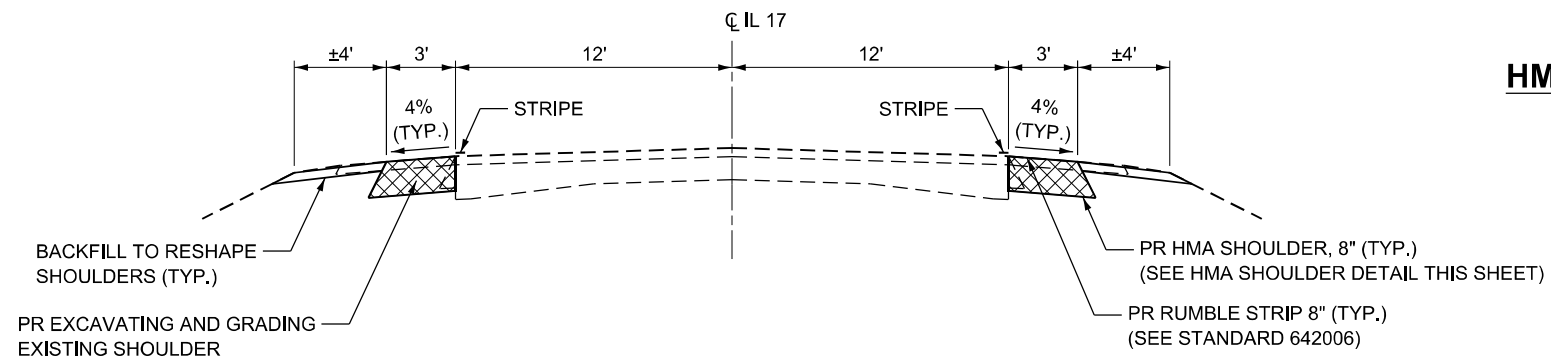

**PROPOSED TYPICAL SECTION - LOCATION 1**

STA. 543+64 TO STA. 564+42

MODEL: Typical Sheet  
 FILE NAME: I:\2022\22069.09 IDOT D3 - PTB, 205-023 - W09 - Kankakee County 66R18\CADD\DATA\CAD\sheet\0366R18-sh1-Typical01.dgn



USER NAME = msulheard	DESIGNED - JS	REVISED -
	DRAWN - MS	REVISED -
	CHECKED - JS	REVISED -
PLOT DATE = 1/22/2025	DATE - 12/20/24	REVISED -

**STATE OF ILLINOIS  
 DEPARTMENT OF TRANSPORTATION**

**TYPICAL SECTIONS**

SCALE: SHEET 1 OF 3 SHEETS STA. TO STA.

F.A.P. RTE.	SECTION	COUNTY	TOTAL SHEETS	SHEET NO.
41	(12,13,14)CJS,SR	KANKAKEE	22	6
CONTRACT NO. 66R18			ILLINOIS FED. AID PROJECT	

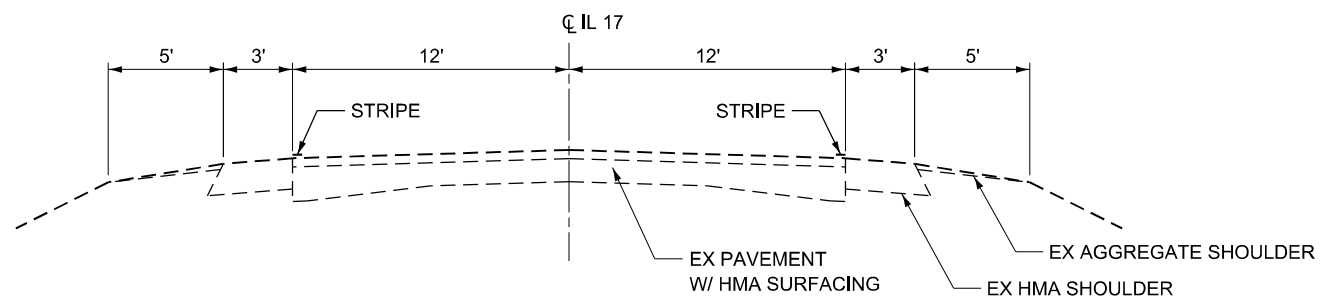

**EXISTING TYPICAL SECTION - LOCATION 2**

STA. 957+33 TO STA. 1208+68  
 STA. 1220+63 TO STA. 1296+78

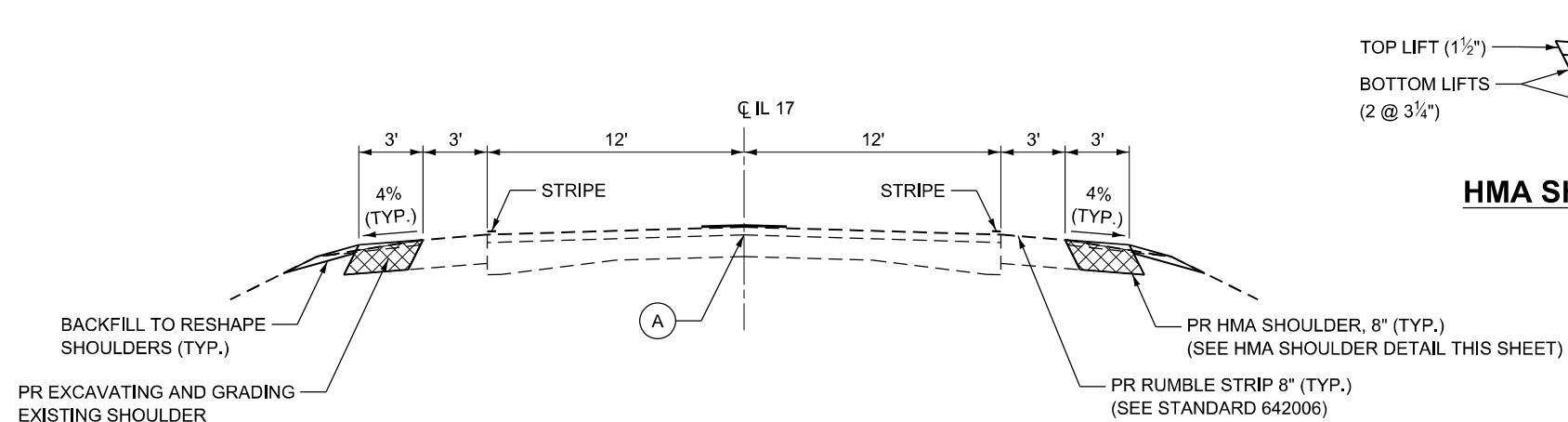

**PROPOSED TYPICAL SECTION - LOCATION 2**

STA. 957+33 TO STA. 1208+68  
 STA. 1220+63 TO STA. 1296+78

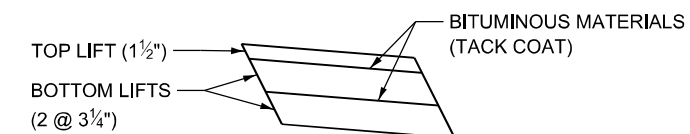

**HMA SHOULDER DETAIL**

(A) PR MICRO-SURFACING, SINGLE PASS  
 PR LONGITUDINAL PAVEMENT REMOVAL, 2"  
 PR PARTIAL DEPTH PATCHING  
 (SEE LONGITUDINAL PARTIAL DEPTH PATCHING  
 DETAIL, SHEET 21)

MODEL: Typical Sheet  
 FILE NAME: I:\2022\22069.09 IDOT D3 - PTB\_205-023 - W09 - Kankakee County 66R18\CADD\Drawings\CAD\Drawings\66R18-sh1-Typical02.dgn



USER NAME = msulheard	DESIGNED - JS	REVISED -
	DRAWN - MS	REVISED -
	CHECKED - JS	REVISED -
PLOT DATE = 1/22/2025	DATE - 12/20/24	REVISED -

**STATE OF ILLINOIS  
 DEPARTMENT OF TRANSPORTATION**

**TYPICAL SECTIONS**

SCALE: SHEET 2 OF 3 SHEETS STA. TO STA.

F.A.P. RTE.	SECTION	COUNTY	TOTAL SHEETS	SHEET NO.
41	(12,13,14)CJS,SR	KANKAKEE	22	7
CONTRACT NO. 66R18				
ILLINOIS FED. AID PROJECT				

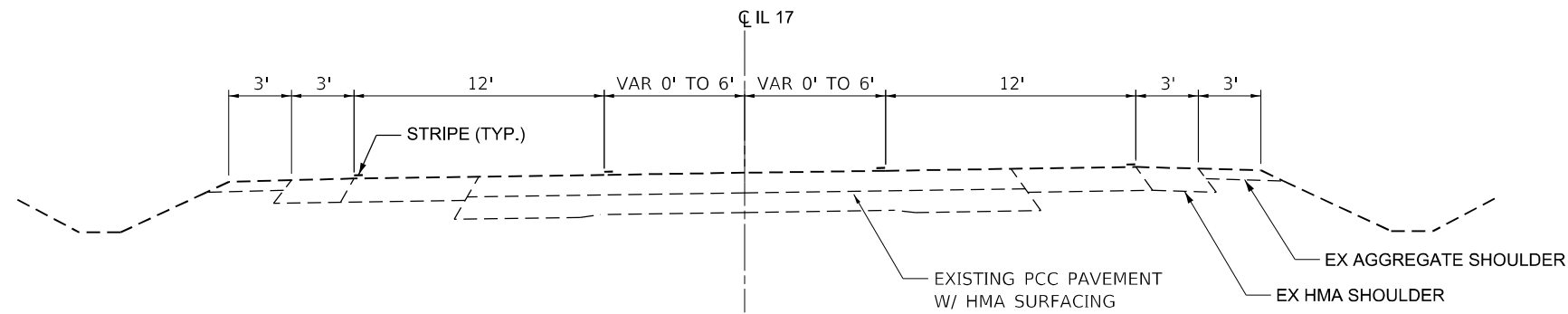

**EXISTING TYPICAL SECTION - LOCATION 2**

STA. 1208+68 TO STA. 1220+63  
 STA. 1296+78 TO STA. 1307+23

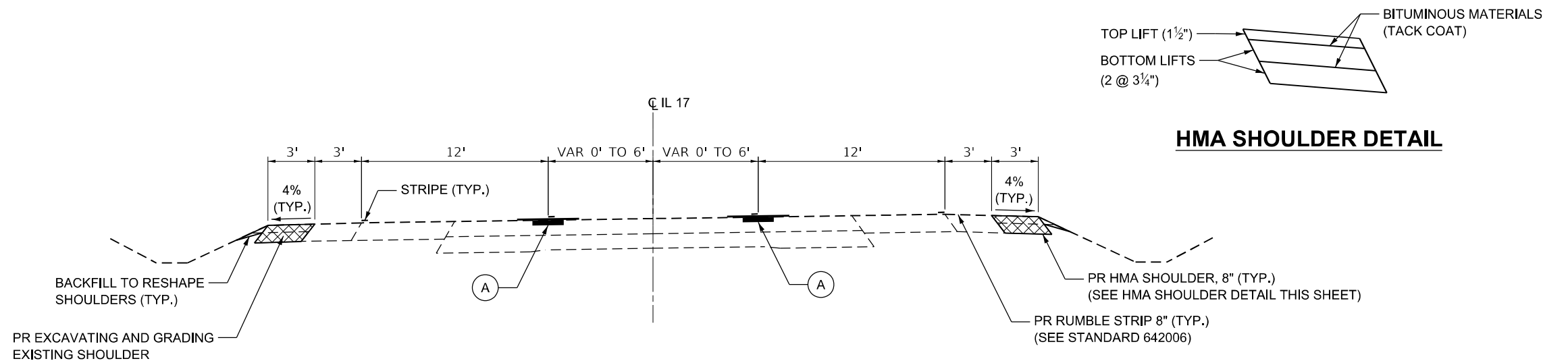

**HMA SHOULDER DETAIL**

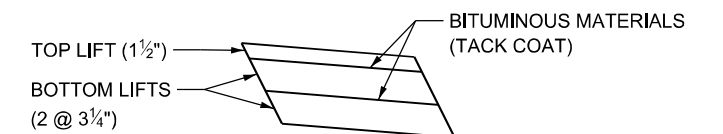

**PROPOSED TYPICAL SECTION - LOCATION 2**

STA. 1208+68 TO STA. 1220+63  
 STA. 1296+78 TO STA. 1307+23

(A) PR MICRO-SURFACING, SINGLE PASS  
 PR LONGITUDINAL PAVEMENT REMOVAL, 2"  
 PR PARTIAL DEPTH PATCHING  
 (SEE LONGITUDINAL PARTIAL DEPTH PATCHING  
 DETAIL, SHEET 21)

MODEL: Typical Sheet  
 FILE NAME: I:\2022\22069.09 IDOT D3 - PTB\_205-023 - W09 - Kankakee County 66R18\CADD\Drawings\66R18-sh1-Typical03.dgn



USER NAME = msulheard	DESIGNED - JS	REVISED -
	DRAWN - MS	REVISED -
	CHECKED - JS	REVISED -
PLOT DATE = 1/7/2025	DATE - 12/20/24	REVISED -

**STATE OF ILLINOIS  
 DEPARTMENT OF TRANSPORTATION**

TYPICAL SECTIONS			
SCALE:	SHEET 3	OF 3 SHEETS	STA. TO STA.

F.A.P. RTE.	SECTION	COUNTY	TOTAL SHEETS	SHEET NO.
41	(12,13,14)CJS,SR	KANKAKEE	22	8
CONTRACT NO. 66R18				
ILLINOIS FED. AID PROJECT				



MODEL - Schedules Sheet  
 FILE NAME: I:\2022\22069.09 IDOT D3 - W09 - Kankakee County 66R18\CADD\Drawings\66R18-shl-Schedule01.dgn

SHOULDER SCHEDULE										
LOCATION		APPLICATIONS	LENGTH	WIDTH	AREA	SHOULDER RUMBLE STRIPS, 8 INCH	HOT-MIX ASPHALT SHOULDER, 8"	EXCAVATING AND GRADING EXISTING SHOULDER	BITUMINOUS MATERIALS (TACK COAT)	
LOCATION	STATION TO STATION		FT	FT	SQ FT	FOOT	SQ YD	UNIT	POUND	
1	543+73 LT 545+22 LT		149			149				
1	543+55 RT 545+22 RT		167			167				
1	545+23 LT 545+57 LT		34			34				
1	545+57 LT 560+17 LT	2	1460	3.0	4380	1460	487	14.6	219	
1	561+07 LT 564+42 LT	2	335	3.0	1005	335	112	3.4	50	
1	545+23 RT 545+92 RT		69			69				
1	546+77 RT 547+06 RT		29			29				
1	547+06 RT 564+42 RT	2	1736	3.0	5208	1736	579	17.4	260	
2	957+33 LT 960+43 LT	2	310	3.0	930	310	103	3.1	47	
2	960+43 LT 963+93 LT	2	350	3.0	1050	350	117	3.5	53	
2	968+03 LT 969+83 LT	2	180	3.0	540	180	60	1.8	27	
2	969+83 LT 978+00 LT	2	817	3.0	2452	817	272	8.2	123	
2	958+58 RT 960+43 RT	2	185	3.0	555	185	62	1.9	28	
2	960+43 RT 960+63 RT	2	20	3.0	60	20	7	0.2	3	
2	961+28 RT 961+98 RT	2	70	3.0	210	70	23	0.7	11	
2	962+43 RT 963+43 RT	2	100	3.0	300	100	33	1.0	15	
2	967+83 RT 969+83 RT	2	200	3.0	600	200	67	2.0	30	
2	969+83 RT 977+43 RT	2	760			760				
2	977+96 LT 982+93 LT	2	498	3.0	1493	498	166	5.0	75	
2	983+93 LT 1006+63 LT	2	2270	3.0	6810	2270	757	22.7	341	
2	978+38 RT 982+28 RT	2	390	3.0	1170	390	130	3.9	59	
2	983+78 RT 985+53 RT	2	175	3.0	525	175	58	1.8	26	
2	986+28 RT 987+78 RT	2	150	3.0	450	150	50	1.5	23	
2	987+78 RT 988+08 RT	2	30	3.0	90	30	10	0.3	5	
2	988+08 RT 988+88 RT	2	80	3.0	240	80	27	0.8	12	
2	989+68 RT 1007+04 RT	2	1736	3.0	5208	1736	579	17.4	260	
2	1007+00 LT 1012+94 LT	2	594	3.0	1782	594	198	5.9	89	
2	1013+64 LT 1036+24 LT	2	2260	3.0	6780	2260	753	22.6	339	
2	1037+04 LT 1050+74 LT	2	1370	3.0	4110	1370	457	13.7	206	
2	1051+44 LT 1055+44 LT	2	400	3.0	1200	400	133	4.0	60	
2	1056+64 LT 1058+98 LT	2	234	3.0	703	234	78	2.3	35	
2	1007+00 RT 1011+04 RT	2	404	3.0	1212	404	135	4.0	61	
2	1011+84 RT 1038+64 RT	2	2680	3.0	8040	2680	893	26.8	402	
2	1039+24 RT 1058+98 RT	2	1974	3.0	5923	1974	658	19.7	296	
2	1059+00 LT 1063+01 LT	2	401	3.0	1203	401	134	4.0	60	
2	1065+56 LT 1080+00 LT	2	1444	3.0	4333	1444	481	14.4	217	
2	1059+00 RT 1063+01 RT	2	401	3.0	1202	401	134	4.0	60	
2	1065+91 RT 1080+00 RT	2	1409	3.0	4228	1409	470	14.1	211	
2	1079+96 LT 1084+96 LT	2	501	3.0	1502	501	167	5.0	75	
2	1084+96 LT 1085+96 LT	2	100	3.0	300	100	33	1.0	15	
2	1085+96 LT 1088+61 LT	2	265	3.0	795	265	88	2.7	40	
2	1090+21 LT 1110+00 LT	2	1979	3.0	5936	1979	650	19.8	297	
2	1079+96 RT 1085+36 RT	2	541	3.0	1622	541	180	5.4	81	
2	1086+36 RT 1087+61 RT	2	125	3.0	375	125	42	1.3	19	
2	1088+01 RT 1102+41 RT	2	1440	3.0	4320	1440	480	14.4	216	
2	1105+56 RT 1108+06 RT	2	250	3.0	750	250	83	2.5	38	
2	1109+06 RT 1110+00 RT	2	94	3.0	281	94	31	0.9	14	
2	1109+96 LT 1122+87 LT	2	1291	3.0	3874	1291	430	12.9	194	
2	1123+52 LT 1137+00 LT	2	1348	3.0	4044	1348	449	13.5	202	
2	1109+96 RT 1110+02 RT	2	6	3.0	19	6	2	0.1	1	
2	1110+92 RT 1118+17 RT	2	725	3.0	2175	725	242	7.3	109	
2	1119+02 RT 1122+92 RT	2	390	3.0	1170	390	130	3.9	59	
2	1123+37 RT 1127+92 RT	2	455	3.0	1365	455	152	4.6	68	
2	1129+42 RT 1133+52 RT	2	410	3.0	1230	410	137	4.1	62	
2	1134+47 RT 1136+27 RT	2	180	3.0	540	180	60	1.8	27	

SHOULDER SCHEDULE												
LOCATION		APPLICATIONS	LENGTH	WIDTH	AREA	SHOULDER RUMBLE STRIPS, 8 INCH	HOT-MIX ASPHALT SHOULDER, 8"	EXCAVATING AND GRADING EXISTING SHOULDER	BITUMINOUS MATERIALS (TACK COAT)			
LOCATION	STATION TO STATION		FT	FT	SQ FT	FOOT	SQ YD	UNIT	POUND			
2	1136+97 LT 1142+14 LT	2	517	3.0	1551	517	172	5.2	78			
2	1143+14 LT 1156+14 LT	2	1300	3.0	3900	1300	433	13.0	195			
2	1157+24 LT 1158+49 LT	2	125	3.0	375	125	42	1.3	19			
2	1159+74 LT 1162+54 LT	2	280	3.0	840	280	93	2.8	42			
2	1164+84 LT 1166+74 LT	2	190	3.0	570	190	63	1.9	29			
2	1167+54 LT 1168+00 LT	2	46	3.0	139	46	15	0.5	7			
2	1137+84 RT 1140+44 RT	2	260	3.0	780	260	87	2.6	39			
2	1141+14 RT 1146+14 RT	2	500	3.0	1500	500	167	5.0	75			
2	1146+74 RT 1148+89 RT	2	215	3.0	645	215	72	2.2	32			
2	1149+64 RT 1151+14 RT	2	150	3.0	450	150	50	1.5	23			
2	1151+89 RT 1152+89 RT	2	100	3.0	300	100	33	1.0	15			
2	1153+74 RT 1154+39 RT	2	65	3.0	195	65	22	0.7	10			
2	1155+14 RT 1168+00 RT	2	1286	3.0	3859	1286	429	12.9	193			
2	1167+95 LT 1195+09 LT	2	2714	3.0	8141	2714	905	27.1	407			
2	1196+59 LT 1202+00 LT	2	541	3.0	1624	541	180	5.4	81			
2	1167+95 RT 1173+09 RT	2	514	3.0	1541	514	171	5.1	77			
2	1174+34 RT 1179+09 RT	2	475	3.0	1425	475	150	4.8	71			
2	1180+24 RT 1182+69 RT	2	245	3.0	735	245	82	2.5	37			
2	1185+79 RT 1187+19 RT	2	140	3.0	420	140	47	1.4	21			
2	1187+99 RT 1191+99 RT	2	400	3.0	1200	400	133	4.0	60			
2	1192+59 RT 1193+99 RT	2	140	3.0	420	140	47	1.4	21			
2	1195+89 RT 1197+79 RT	2	190			190						
2	1199+39 RT 1202+00 RT	2	261	3.0	784	261	87	2.6	39			
2	1201+99 LT 1221+68 LT	2	1969	3.0	5906	1969	656	19.7	295			
2	1222+08 LT 1231+00 LT	2	892	3.0	2676	892	297	8.9	134			
2	1201+99 RT 1204+08 RT	2	209	3.0	626	209	70	2.1	31			
2	1205+73 RT 1207+93 RT	2	220	3.0	660	220	73	2.2	33			
2	1208+58 RT 1209+38 RT	2	80			80						
2	1210+08 RT 1212+58 RT	2	250	3.0	750	250	83	2.5	38			
2	1214+68 RT 1228+53 RT	2	1385	3.0	4155	1385	462	13.9	208			
2	1229+28 RT 1231+00 RT	2	172	3.0	516	172	57	1.7	26			
2	1231+04 LT 1233+37 LT	2	233	3.0	699	233	78	2.3	35			
2	1233+97 LT 1235+37 LT	2	140	3.0	420	140	47	1.4	21			
2	1235+92 LT 1241+37 LT	2	545	3.0	1635	545	182	5.5	82			
2	1242+02 LT 1248+62 LT	2	660	3.0	1980	660	220	6.6	99			
2	1249+67 LT 1250+52 LT	2	85			85						
2	1252+12 LT 1256+27 LT	2	415	3.0	1245	415	138	4.2	62			
2	1268+27 LT 1269+02 LT	2	75	3.0	225	75	25	0.8	11			
2	1269+87 LT 1272+17 LT	2	230	3.0	690	230	77	2.3	35			
2	1274+52 LT 1278+77 LT	2	425	3.0	1275	425	142	4.3	64			
2	1291+33 LT 1292+03 LT	2	70	3.0	210	70	23	0.7	11			
2	1292+58 LT 1294+93 LT	2	235	3.0	705	235	78	2.4	35			
2	1300+73 LT 1301+33 LT	2	60	3.0	180	60	20	0.6	9			
2	1231+04 RT 1235+07 RT	2	403	3.0	1209	403	134	4.0	60			
2	1235+67 RT 1241+12 RT	2	545	3.0	1635	545	182	5.5	82			
2	1242+02 RT 1260+42 RT	2	1840	3.0	5520	1840	613	18.4	276			
2	1261+42 RT 1263+72 RT	2	230	3.0	690	230	77	2.3	35			
2	1264+42 RT 1265+87 RT	2	145	3.0	435	145	48	1.5	22			
2	1266+87 RT 1280+32 RT	2	1345	3.0	4035	1345	448	13.5	202			
2	1289+72 RT 1291+04 RT	2	132	3.0	396	132	44	1.3	20			
2	1291+00 RT 1292+68 RT	2	168	3.0	504	168	56	1.7	25			
2	1295+18 RT 1295+93 RT	2	75	3.0	225	75	25	0.8	11			
2	1296+88 RT 1297+43 RT	2	55	3.0	165	55	18	0.6	8			
2	1298+23 RT 1298+73 RT	2	50	3.0	150	50	17	0.5	8			
2	1300+63 RT 1303+83 RT	2	320	3.0	960	320	107	3.2	48			
2	1304+58 RT 1307+23 RT	2	265	3.0	795	265	88	2.7	40			
<b>TOTAL</b>									57,778	19,662	590	8,848

NOTE: BITUMINOUS MATERIALS (TACK COAT) QUANTITY IS 2 APPLICATIONS @ 0.025 POUNDS/SQ FT



USER NAME = msulheard  
 DESIGNED - JS  
 DRAWN - MS  
 CHECKED - JS  
 DATE - 12/19/24  
 PLOT DATE = 1/20/2025

REVISIED -  
 REVISIED -  
 REVISIED -  
 REVISIED -

STATE OF ILLINOIS  
 DEPARTMENT OF TRANSPORTATION

SCHEDULES

SCALE: SHEET 1 OF 6 SHEETS STA. TO STA.

F.A.P. RTE.	SECTION	COUNTY	TOTAL SHEETS	SHEET NO.
41	(12,13,14)CJS,SR	KANKAKEE	22	9
CONTRACT NO. 66R18				
ILLINOIS FED. AID PROJECT				

CENTERLINE REPAIR SCHEDULE													
LOCATION				LENGTH	WIDTH	AREA	LONGITUDINAL PARTIAL DEPTH REMOVAL 2"	BITUMINOUS MATERIALS (TACK COAT)		MIXTURE FOR CRACKS JOINTS AND FLANGEWAYS	LONGITUDINAL PARTIAL DEPTH PATCHING	MICRO-SURFACING, SINGLE PASS	
								0.05 LBS/SQ FT	0.025 LBS/SQ FT				
LOCATION	STATION	TO	STATION	FT	FT	SQ FT	FOOT	POUNDS		TON	TON	SQ YD	
2	957+33	CL	960+43	CL	310.0	4.0	1240	310	31	31	0.02	8	138
2	969+83	CL	978+00	CL	817.4	4.0	3269	817	82	82	0.05	20	363
2	977+96	CL	1007+04	CL	2908.6	4.0	11634	2909	291	291	0.19	73	1293
2	1007+00	CL	1058+98	CL	5198.4	4.0	20794	5198	520	520	0.35	129	2310
2	1059+00	CL	1063+96	CL	495.6	4.0	1982	496	50	50	0.03	12	220
2	1064+61	CL	1080+00	CL	1539.4	4.0	6157	1539	154	154	0.10	38	684
2	1079+96	CL	1110+00	CL	3004.4	4.0	12017	3004	300	300	0.20	75	1335
2	1109+96	CL	1137+00	CL	2704.3	4.0	10817	2704	270	270	0.18	67	1202
2	1136+97	CL	1168+00	CL	3103.4	4.0	12413	3103	310	310	0.21	77	1379
2	1167+95	CL	1202+00	CL	3405.0	4.0	13620	3405	340	340	0.23	85	1513
2	1201+99	CL	1220+63	CL	1863.6	4.0	7455	1864	186	186	0.12	46	828
2	1208+68	TL	1220+63	TL	1195.0	4.0	4780	1195	120	120	0.08	30	531
2	1220+63	CL	1231+00	CL	1037.1	4.0	4148	1037	104	104	0.07	26	461
2	1231+04	CL	1291+04	CL	6000.0	4.0	24000	6000	600	600	0.40	149	2667
2	1291+00	CL	1307+23	CL	1622.9	4.0	6492	1623	162	162	0.11	41	721
2	1298+73	*	1306+58	*	785.0	4.0	3140	785	79	79	0.05	20	349
2	1301+33	**	1306+23	**	490.0	4.0	1960	490	49	49	0.03	12	218
SUB TOTALS									3648	3648			
<b>TOTAL</b>					36,480		145,920	36,480	7,296		2.4	908	16,213

\* EAST BOUND TURN LANE JOINT  
 \*\* WEST BOUND TURN LANE JOINT

TRANSVERSE CRACK ROUTING AND FILLING				
LOCATION	CRACKS	LENGTH	CRACK ROUTING (PAVEMENT)	CRACK FILLING
EAST BOUND	900	12.0	10800	5400
WEST BOUND	900	12.0	10800	5400
<b>TOTAL</b>			21,600.00	10,800

MODEL: Schedules Sheet  
 FILE NAME: I:\2022\22069.09\DOT D3 - PTB\_205-023 - W09 - Kankakee County 66R18\CADD\Drawings\CAD\Drawings\18-sht-Schedule02.dgn



USER NAME = msulheard	DESIGNED - JS	REVISED -
	DRAWN - MS	REVISED -
	CHECKED - JS	REVISED -
PLOT DATE = 1/20/2025	DATE - 12/19/24	REVISED -

**STATE OF ILLINOIS**  
**DEPARTMENT OF TRANSPORTATION**

**SCHEDULES**  
 SCALE: SHEET 2 OF 6 SHEETS STA. TO STA.

F.A.P RTE.	SECTION	COUNTY	TOTAL SHEETS	SHEET NO.
41	(12,13,14)CJS,SR	KANKAKEE	22	10
CONTRACT NO. 66R18				
ILLINOIS FED. AID PROJECT				

**PAVEMENT MARKING SCHEDULE**

LOCATION	STATION TO	STATION	COMMENT	APPLICATIONS	LENGTH FT	WIDTH FT	PREFORMED PLASTIC PAVEMENT MARKING, TYPE D- STANDARD LETTERS & SYMBOLS	GROOVING FOR RECESSED PAVEMENT MARKING, LETTERS & SYMBOLS	MODIFIED URETHANE PAVEMENT MARKING - LINE 4"		MODIFIED URETHANE PAVEMENT MARKING - LINE 6"	MODIFIED URETHANE PAVEMENT MARKING - LINE 8"	MODIFIED URETHANE PAVEMENT MARKING - LINE 12"		PREFORMED PLASTIC PAVEMENT MARKING, TYPE D- STANDARD- LINE 24"	GROOVING FOR RECESSED PAVEMENT MARKING 25"	RAISED REFLECTIVE PAVEMENT MARKER		RAISED REFLECTIVE PAVEMENT MARKER REMOVAL	
									WHITE	YELLOW			WHITE	YELLOW			BI-DIR (A)	MONO (W)		
1	543+55 RT	545+22 RT	EDGE LINE	2	167				333											
1	543+64 CL	545+22 CL	CL (SKIP DASH)	2	158					79										
1	543+73 LT	545+22 LT	EDGE LINE	2	149				297											
EQUATION:	545+21.90 BK =	545+22.60 AH																		
1	545+23 RT	564+42 RT	EDGE LINE	2	1919				3839											
1	545+23 CL	564+42 CL	CL (SKIP DASH)	2	1919					960										
1	545+23 LT	560+17 LT	KANKAKEE RD	2	1494				2989											
1	561+07 LT	564+42 LT	EDGE LINE	2	335				670											
EQUATION:	947+00.00 BK =	947+00.00 AH																		
2	957+33 LT	960+43 LT	SN 046-0161	2	310				620											
2	957+33 CL	960+43 CL	CL (SKIP DASH)	2	310					155								4		4
2	957+33 RT	957+63 RT	SR S 12000W	2	30				60											
2	958+58 RT	960+43 RT	SN 046-0161	2	185				370											
2	969+83 LT	978+00 LT	EDGE LINE	2	817				1635									10		10
2	969+83 CL	978+00 CL	CL (SKIP DASH)	2	817					409										
2	969+83 RT	978+00 RT	EDGE LINE	2	817				1635											
EQUATION:	978+00.00 BK =	977+95.81 AH			0															
2	977+96 LT	982+93 LT	SR N 11000W RD	2	498				995											
2	983+93 LT	1007+04 LT	EDGE LINE	2	2311				4622											
2	977+96 CL	1007+04 CL	CL (SKIP DASH)	2	2909					1454								36		36
2	977+96 RT	1007+04 RT	EDGE LINE	2	2909				5817											
EQUATION:	1007+04.42 BK =	1007+00.00 AH			0															
2	1007+00 LT	1036+24 LT	SR N 10000W RD	2	2924				5848											
2	1037+04 LT	1058+98 LT	EDGE LINE	2	2194				4389											
2	1007+00 CL	1058+98 CL	CL (SKIP DASH)	2	5198					2599								65		65
2	1007+00 RT	1011+04 RT	SR S 11000W RD	2	404				808											
2	1011+84 RT	1058+98 RT	EDGE LINE	2	4714				9429											
EQUATION:	1058+89.40 BK =	1059+00.00 AH			0															
2	1059+00 LT	1080+00 LT	EDGE LINE	2	2100				4200											
2	1059+00 CL	1080+00 CL	CL (SKIP DASH)	2	2100					1050								26		26
2	1059+00 RT	1065+11 RT	SR S 10000W RD	2	611				1221											
2	1066+01 RT	1080+00 RT	EDGE LINE	2	1399				2799											
EQUATION:	1080+00.00 BK =	1079+95.63 AH			0															
2	1079+96 LT	1088+61 LT	SR N 9000W RD	2	866				1731											
2	1090+21 LT	1110+00 LT	EDGE LINE	2	1979				3957											
2	1079+96 CL	1110+00 CL	CL (SKIP DASH)	2	3004					1502								38		38
2	1079+96 RT	1109+96 RT	EDGE LINE	2	3000				6000											
EQUATION:	1110+00.00 BK =	1109+95.70 AH			0															
2	1109+96 LT	1137+04 LT	EDGE LINE	2	2709				5417											
2	1109+96 CL	1137+04 CL	CL (SKIP DASH)	2	2709					1354								34		34
2	1109+96 RT	1118+21 RT	SR S 9000W RD	2	826				1651											
2	1119+02 RT	1137+00 RT	EDGE LINE	2	1798				3596											
EQUATION:	1137+00.00 BK =	1136+96.63 AH			0															
2	1136+97 LT	1142+14 LT	SR N 8000W RD	2	517				1034											
2	1143+14 LT	1168+00 LT	EDGE LINE	2	2486				4973											
2	1136+97 CL	1168+00 CL	CL (SKIP DASH)	2	3103					1552								39		39
2	1136+97 RT	1168+00 RT	EDGE LINE	2	3103				6206											
EQUATION:	1168+00.00 BK =	1167+95.03 AH			0															
2	1168+00 LT	1195+14 LT	SR N 7000W RD	2	2714				5428											
2	1196+59 LT	1202+00 LT	EDGE LINE	2	541				1083											
2	1167+95 CL	1202+00 CL	CL (SKIP DASH)	2	3405					1702								43		43
2	1167+95 RT	1173+09 RT	SR S 8000W RD	2	514				1027											
2	1174+34 RT	1202+00 RT	EDGE LINE	2	2766				5533											
EQUATION:	1202+00.00 BK =	1201+99.26 AH			0															
2	1201+99 LT	1231+00 LT	EDGE LINE	2	2901				5801											
2	1201+99 CL	1202+58 CL	CL (SKIP DASH)	2	59					29								1		1
2	1202+58 CL	1206+58 CL	NPZ (EB)	2	400					800								5		5
2	1206+58 CL	1208+68 CL	NPZ DBL YELLOW	2	210					840								7		7

MODEL: Schedules Sheet  
 FILE NAME: I:\2022\22069.09 IDOT D3 - PTB 205-023 - W09 - Kankakee County 66R18\CADD\Drawings\CAD\Drawings\Drawings\Drawings\Schedule03.dgn



USER NAME = msulheard  
 PLOT DATE = 1/20/2025

DESIGNED - JS  
 DRAWN - MS  
 CHECKED - JS  
 DATE - 12/19/24

REVISED -  
 REVISED -  
 REVISED -  
 REVISED -

**STATE OF ILLINOIS  
 DEPARTMENT OF TRANSPORTATION**

**SCHEDULES**

SCALE: SHEET 3 OF 6 SHEETS STA. TO STA.

F.A.P. RTE.	SECTION	COUNTY	TOTAL SHEETS	SHEET NO.
41	(12,13,14)CJS,SR	KANKAKEE	22	11
CONTRACT NO. 66R18				
ILLINOIS FED. AID PROJECT				

**PAVEMENT MARKING SCHEDULE**

LOCATION	STATION TO	STATION	COMMENT	APPLICATIONS	LENGTH	WIDTH	PREFORMED PLASTIC PAVEMENT MARKING, TYPE D-STANDARD LETTERS & SYMBOLS	GROOVING FOR RECESSED PAVEMENT MARKING, LETTERS & SYMBOLS	MODIFIED URETHANE PAVEMENT MARKING - LINE 4"		MODIFIED URETHANE PAVEMENT MARKING - LINE 6"	MODIFIED URETHANE PAVEMENT MARKING - LINE 8"	MODIFIED URETHANE PAVEMENT MARKING - LINE 12"		PREFORMED PLASTIC PAVEMENT MARKING, TYPE D-STANDARD-LINE 24"	GROOVING FOR RECESSED PAVEMENT MARKING 25"	RAISED REFLECTIVE PAVEMENT MARKER		RAISED REFLECTIVE PAVEMENT MARKER REMOVAL	
									WHITE	YELLOW			WHITE	YELLOW			BI-DIR (A)	MONO (W)		
2	1208+68 CL	1212+93 CL	ISLAND DBL YELLOW	2	425					3400				316				29		29
2	1213+83 CL	1215+08 CL	NPZ DBL YELLOW	2	125					500								6		6
2	1213+83 TL	1214+88 TL	WB LT TURN LANE SOLID	2	105							210							3	3
2	1213+83 TL	1214+88 TL	TURN ARROWS (2)	1			31.2	31.2				0								
2	1214+88 TL	1216+08 TL	WB LT TURN DOTTED	2	120							60								
2	1215+08 CL	1220+63 CL	ISLAND DBL YELLOW	2	555					4440				256				28		28
2	1220+63 CL	1221+83 CL	NPZ DBL YELLOW	2	120					480								6		6
2	1221+83 CL	1231+00 CL	CL (SKIP DASH)	2	917						459							11		11
2	1201+99 RT	1212+58 RT	SR S 7000W RD	2	1059					2117										
2	1213+58 RT	1231+00 RT	EDGE LINE	2	1742					3484										
EQUATION: 1231+00.00 BK = 1231+03.70 AH					0															
2	1231+04 LT	1248+62 LT	SR N 6000 RD	2	1758					3516										
2	1249+67 LT	1291+04 LT	EDGE LINE	2	4137					8274										
2	1231+04 CL	1290+72 CL	CL (SKIP DASH)	2	5968						2984							75		75
2	1290+72 CL	1291+04 CL	NPZ (EB)	2	32						64	16								
2	1231+04 RT	1265+87 RT	SR S 6000W RD	2	3483					6966										
2	1266+87 RT	1291+04 RT	EDGE LINE	2	2417					4834										
EQUATION: 1291+03.70 BK = 1291+00.00 AH					0															
2	1291+00 LT	1301+88 LT	EDGE LINE	2	1088					2176										
2	1291+00 CL	1295+48 CL	NPZ (EB)	2	448						896	224						6		6
2	1295+48 CL	1296+78 CL	NPZ DBL YELLOW	2	130						520							6		6
2	1296+78 CL	1301+08 CL	ISLAND DBL YELLOW	2	430						3440			192				22		22
2	1301+08 CL	1302+48 CL	NPZ DBL YELLOW	2	140						560							6		6
2	1303+18 CL	1307+23 CL	ISLAND DBL YELLOW	2	405						3240			300				26		26
2	1291+00 RT	1307+23 RT	EDGE LINE	2	1623					3246										
2	1299+38 TL	1301+43 TL	EB LT TURN DOTTED	2	205							103								
2	1301+43 TL	1302+48 TL	EB LT TURN LANE SOLID	2	105							210							3	3
2	1301+43 TL	1302+48 TL	TURN ARROWS (2)	1			31.2	31.2												
2	1303+18 TL	1305+08 TL	WB RT TURN LANE SOLID	2	190							380							5	5
2	1303+18 TL	1305+08 TL	TURN ARROWS (3)	1			46.8	46.8												
2	1305+08 TL	1306+38 TL	WB RT TURN DOTTED	2	130							65								
2	1304+98	1305+00	RRX MARKING	1	2	12.0									12	12				
2	1305+13	1305+33	RRX MARKING	1			61.2	61.2												
2	1305+48	1305+50	RRX MARKING	1	2	12.0									12	12				
2	1302+38	1302+54	STOP BAR	1	22										22	22				
2	1302+73	1302+93	STOP BAR	1	20										20	20				
2	1302+43	1302+73	MEDIAN ISLAND	2	120							240	60							
<b>SUBTOTALS</b>									140627	19180			60	1064			529	11		
<b>TOTAL</b>									170.4	170.4	159,807	16,728	1,268	1,124	66	66	540	11	540	

MODEL: Schedules Sheet  
 FILE NAME: I:\2022\22069.09\DOT D3 - W09 - Kankakee County 66R18\CADD\Drawings\CAD\Drawings\18-shht-Schedule04.dgn

**KUHN & TRELLO**  
 CONSULTING ENGINEERS  
 A Limited Liability Company  
 109 N. 7th Street, 3rd Floor  
 Springfield, IL 62702  
 Phone: 217-628-0044  
 Professional Design Firm No. 284-00536

USER NAME = msulheard	DESIGNED - JS	REVISED -
	DRAWN - MS	REVISED -
	CHECKED - JS	REVISED -
PLOT DATE = 1/20/2025	DATE - 12/19/24	REVISED -

**STATE OF ILLINOIS**  
**DEPARTMENT OF TRANSPORTATION**

<b>SCHEDULES</b>			
SCALE:	SHEET 4	OF 6 SHEETS	STA. TO STA.

F.A.P. RTE.	SECTION	COUNTY	TOTAL SHEETS	SHEET NO.
41	(12,13,14)CJS,SR	KANKAKEE	22	12
CONTRACT NO. 66R18				
ILLINOIS FED. AID PROJECT				

**SHORT TERM PAVEMENT MARKING SCHEDULE**

LOCATION	COMMENT	APPLICATIONS	LENGTH	WIDTH	SHORT TERM PAVEMENT MARKING		SHORT TERM PAVEMENT REMOVAL
					WHITE FOOT	YELLOW FOOT	SQ FT
1	543+64 CL 545+22 CL	CL (SKIP DASH)	2	158		32	5
EQUATION:	545+21.90 BK = 545+22.60 AH						
1	545+23 CL 564+42 CL	CL (SKIP DASH)	2	1919		384	64
EQUATION:	947+00.00 BK = 947+00.00 AH						
2	957+33 CL 960+43 CL	CL (SKIP DASH)	2	310		62	10
2	969+83 CL 978+00 CL	CL (SKIP DASH)	2	817		163	27
EQUATION:	978+00.00 BK = 977+95.81 AH						
2	977+96 CL 1007+04 CL	CL (SKIP DASH)	2	2909		582	97
EQUATION:	1007+04.42 BK = 1007+00.00 AH						
2	1007+00 CL 1058+98 CL	CL (SKIP DASH)	2	5198		1040	173
EQUATION:	1058+89.40 BK = 1059+00.00 AH						
2	1059+00 CL 1080+00 CL	CL (SKIP DASH)	2	2100		420	70
EQUATION:	1080+00.00 BK = 1079+95.63 AH						
2	1079+96 CL 1110+00 CL	CL (SKIP DASH)	2	3004		601	100
EQUATION:	1110+00.00 BK = 1109+95.70 AH						
2	1109+96 CL 1137+04 CL	CL (SKIP DASH)	2	2709		542	90
EQUATION:	1137+00.00 BK = 1136+96.63 AH						
2	1136+97 CL 1168+00 CL	CL (SKIP DASH)	2	3103		621	103
EQUATION:	1168+00.00 BK = 1167+95.03 AH						
2	1167+95 CL 1202+00 CL	CL (SKIP DASH)	2	3405		681	113
EQUATION:	1202+00.00 BK = 1201+99.26 AH						
2	1201+99 CL 1208+68 CL	CL (SKIP DASH)	2	669		134	22
2	1208+68 CL 1212+93 CL	ISLAND DBL YELLOW	2	425		340	57
2	1213+83 CL 1215+08 CL	TURN LANE DBL YELLOW	2	125		50	8
2	1213+83 TL 1214+88 TL	WB LT TURN LANE	2	105	21		4
2	1213+83 TL 1214+88 TL	TURN ARROWS (2)			192		32
2	1215+08 CL 1220+63 CL	ISLAND DBL YELLOW	2	555		444	74
2	1220+63 CL 1231+00 CL	CL (SKIP DASH)	2	1037		207	35
EQUATION:	1231+00.00 BK = 1231+03.70 AH						
2	1231+04 CL 1291+04 CL	CL (SKIP DASH)	2	6000		1200	200
EQUATION:	1291+03.70 BK = 1291+00.00 AH						
2	1291+00 CL 1296+78 CL	CL (SKIP DASH)	2	578		116	19
2	1296+78 CL 1301+08 CL	ISLAND DBL YELLOW	2	430		344	57
2	1301+08 CL 1302+38 CL	TURN LANE DBL YELLOW	2	130		52	9
2	1301+33 TL 1302+38 TL	EB LT TURN LANE	2	105	21		7
2	1301+33 TL 1302+38 TL	TURN ARROWS (2)			192		32
2	1303+18 CL 1307+23 CL	ISLAND DBL YELLOW	2	405		324	54
2	1303+08 TL 1304+98 TL	WB LT TURN LANE	2	190	38		6
2	1303+08 TL 1304+98 TL	TURN ARROWS (3)			288		48
2	1304+88 RR 1305+38 RR	RRX MARKING	2	50	8.0	452	75
SUBTOTAL						1204	8340
<b>TOTAL</b>						<b>9,544</b>	<b>1,590</b>

MODEL: Schedules Sheet  
FILE NAME: I:\2022\22068.09 IDOT D3 - PTB 205-023 - W09 - Kankakee County 66R18\CADD\Drawings\66R18-eh-Schedule05.dgn



USER NAME = msulheard	DESIGNED - JS	REVISED -
	DRAWN - MS	REVISED -
	CHECKED - JS	REVISED -
PLOT DATE = 1/24/2025	DATE - 12/19/24	REVISED -

**STATE OF ILLINOIS  
DEPARTMENT OF TRANSPORTATION**

<b>SCHEDULES</b>			
SCALE:	SHEET 5	OF 6 SHEETS	STA. TO STA.

F.A.P. RTE.	SECTION	COUNTY	TOTAL SHEETS	SHEET NO.
41	(12,13,14)CJS,SR	KANKAKEE	22	13
CONTRACT NO. 66R18				
ILLINOIS FED. AID PROJECT				

SEEDING SCHEDULE											
LOCATION	STATION	TO	STATION	LENGTH FT	WIDTH FT	AREA SQ FT	SEEDING, CLASS 2 ACRE	NITROGEN FERTILIZER NUTRIENT POUND	PHOSPHORUS FERTILIZER NUTRIENT POUND	POTASSIUM FERTILIZER NUTRIENT POUND	MULCH, METHOD 1 ACRE
1	545+57	LT	560+17	1460	10.0	14600	0.34	30	30	30	0.34
1	561+07	LT	564+42	335	10.0	3350	0.08	7	7	7	0.08
1	547+06	RT	564+42	1736	10.0	17360	0.40	36	36	36	0.40
2	957+33	LT	960+43	310	10.0	3100	0.07	6	6	6	0.07
2	960+43	LT	963+93	350	10.0	3500	0.08	7	7	7	0.08
2	968+03	LT	969+83	180	10.0	1800	0.04	4	4	4	0.04
2	969+83	LT	978+00	817	10.0	8174	0.19	17	17	17	0.19
2	958+58	RT	960+43	185	10.0	1850	0.04	4	4	4	0.04
2	960+43	RT	960+63	20	10.0	200	0.00	0	0	0	0.00
2	961+28	RT	961+98	70	10.0	700	0.02	1	1	1	0.02
2	962+43	RT	963+43	100	10.0	1000	0.02	2	2	2	0.02
2	967+03	RT	969+03	200	10.0	2000	0.05	4	4	4	0.05
2	977+96	LT	982+93	498	10.0	4976	0.11	10	10	10	0.11
2	983+93	LT	1006+63	2270	10.0	22700	0.52	47	47	47	0.52
2	978+38	RT	982+28	390	10.0	3900	0.09	8	8	8	0.09
2	983+78	RT	985+53	175	10.0	1750	0.04	4	4	4	0.04
2	986+28	RT	987+78	150	10.0	1500	0.03	3	3	3	0.03
2	987+78	RT	988+08	30	10.0	300	0.01	1	1	1	0.01
2	988+08	RT	988+88	80	10.0	800	0.02	2	2	2	0.02
2	989+68	RT	1007+04	1736	10.0	17360	0.40	36	36	36	0.40
2	1007+00	LT	1012+94	594	10.0	5940	0.14	12	12	12	0.14
2	1013+64	LT	1036+24	2260	10.0	22600	0.52	47	47	47	0.52
2	1037+04	LT	1050+74	1370	10.0	13700	0.31	28	28	28	0.31
2	1051+44	LT	1055+44	400	10.0	4000	0.09	8	8	8	0.09
2	1050+64	LT	1058+98	234	10.0	2344	0.05	5	5	5	0.05
2	1007+00	RT	1011+04	404	10.0	4040	0.09	8	8	8	0.09
2	1011+84	RT	1038+64	2680	10.0	26800	0.62	55	55	55	0.62
2	1039+24	RT	1058+98	1974	10.0	19744	0.45	41	41	41	0.45
2	1059+00	LT	1063+01	401	10.0	4006	0.09	8	8	8	0.09
2	1065+56	LT	1080+00	1444	10.0	14444	0.33	30	30	30	0.33
2	1059+00	RI	1063+01	401	10.0	4006	0.09	8	8	8	0.09
2	1065+91	RT	1080+00	1409	10.0	14094	0.32	29	29	29	0.32
2	1079+96	LT	1084+96	501	10.0	5006	0.11	10	10	10	0.11
2	1084+96	LT	1085+96	100	10.0	1000	0.02	2	2	2	0.02
2	1085+96	LT	1088+61	265	10.0	2650	0.06	5	5	5	0.06
2	1090+21	LT	1110+00	1979	10.0	19787	0.45	41	41	41	0.45
2	1079+96	RT	1085+36	541	10.0	5406	0.12	11	11	11	0.12
2	1086+36	RT	1087+61	125	10.0	1250	0.03	3	3	3	0.03
2	1088+01	RT	1102+41	1440	10.0	14400	0.33	30	30	30	0.33
2	1105+56	RT	1108+06	250	10.0	2500	0.06	5	5	5	0.06
2	1109+06	RT	1110+00	94	10.0	937	0.02	2	2	2	0.02
2	1109+96	LT	1122+87	1291	10.0	12913	0.30	27	27	27	0.30
2	1123+52	LT	1137+00	1348	10.0	13480	0.31	28	28	28	0.31
2	1109+96	RT	1110+02	6	10.0	63	0.00	0	0	0	0.00
2	1110+92	RT	1118+17	725	10.0	7250	0.17	15	15	15	0.17
2	1119+02	RT	1122+92	390	10.0	3900	0.09	8	8	8	0.09
2	1123+37	RT	1127+92	455	10.0	4550	0.10	9	9	9	0.10
2	1129+42	RT	1133+52	410	10.0	4100	0.09	8	8	8	0.09
2	1134+47	RT	1136+27	180	10.0	1800	0.04	4	4	4	0.04
2	1136+97	LT	1142+14	517	10.0	5170	0.12	11	11	11	0.12
2	1143+14	LT	1156+14	1300	10.0	13000	0.30	27	27	27	0.30

SEEDING SCHEDULE											
LOCATION	STATION	TO	STATION	LENGTH FT	WIDTH FT	AREA SQ FT	SEEDING, CLASS 2 ACRE	NITROGEN FERTILIZER NUTRIENT POUND	PHOSPHORUS FERTILIZER NUTRIENT POUND	POTASSIUM FERTILIZER NUTRIENT POUND	MULCH, METHOD 1 ACRE
2	1157+24	LT	1158+49	125	10.0	1250	0.03	3	3	3	0.03
2	1159+74	LT	1162+54	280	10.0	2800	0.06	6	6	6	0.06
2	1164+84	LT	1166+74	190	10.0	1900	0.04	4	4	4	0.04
2	1167+54	LT	1168+00	46	10.0	464	0.01	1	1	1	0.01
2	1137+84	RT	1140+44	260	10.0	2600	0.06	5	5	5	0.06
2	1141+14	RT	1146+14	500	10.0	5000	0.11	10	10	10	0.11
2	1146+74	RT	1148+89	215	10.0	2150	0.05	4	4	4	0.05
2	1149+64	RT	1151+14	150	10.0	1500	0.03	3	3	3	0.03
2	1151+89	RT	1152+89	100	10.0	1000	0.02	2	2	2	0.02
2	1153+74	RT	1154+39	65	10.0	650	0.01	1	1	1	0.01
2	1155+14	RT	1168+00	1286	10.0	12864	0.30	27	27	27	0.30
2	1167+95	LT	1195+09	2714	10.0	27136	0.62	56	56	56	0.62
2	1196+59	LT	1202+00	541	10.0	5414	0.12	11	11	11	0.12
2	1167+95	RT	1173+09	514	10.0	5136	0.12	11	11	11	0.12
2	1174+34	RT	1179+09	475	10.0	4750	0.11	10	10	10	0.11
2	1180+24	RT	1182+69	245	10.0	2450	0.06	5	5	5	0.06
2	1185+79	RT	1187+19	140	10.0	1400	0.03	3	3	3	0.03
2	1187+99	RT	1191+99	400	10.0	4000	0.09	8	8	8	0.09
2	1192+59	RT	1193+99	140	10.0	1400	0.03	3	3	3	0.03
2	1199+39	RT	1202+00	261	10.0	2614	0.06	5	5	5	0.06
2	1201+99	LT	1221+68	1969	10.0	19686	0.45	41	41	41	0.45
2	1222+08	LT	1231+00	892	10.0	8921	0.20	18	18	18	0.20
2	1201+99	RT	1204+08	209	10.0	2086	0.05	4	4	4	0.05
2	1205+73	RT	1207+93	220	10.0	2200	0.05	5	5	5	0.05
2	1210+08	RI	1212+58	250	10.0	2500	0.06	5	5	5	0.06
2	1214+68	RT	1228+53	1385	10.0	13850	0.32	29	29	29	0.32
2	1229+28	RT	1231+00	172	10.0	1721	0.04	4	4	4	0.04
2	1231+04	LT	1233+37	233	10.0	2329	0.05	5	5	5	0.05
2	1233+97	IT	1235+37	140	10.0	1400	0.03	3	3	3	0.03
2	1235+92	LT	1241+37	545	10.0	5450	0.13	11	11	11	0.13
2	1242+02	LT	1248+62	660	10.0	6600	0.15	14	14	14	0.15
2	1252+12	LT	1256+27	415	10.0	4150	0.10	9	9	9	0.10
2	1268+27	LT	1269+02	75	10.0	750	0.02	2	2	2	0.02
2	1269+87	LT	1272+17	230	10.0	2300	0.05	5	5	5	0.05
2	1274+52	LT	1278+77	425	10.0	4250	0.10	9	9	9	0.10
2	1291+33	LT	1292+03	70	10.0	700	0.02	1	1	1	0.02
2	1292+58	IT	1294+93	235	10.0	2350	0.05	5	5	5	0.05
2	1300+73	LT	1301+33	60	10.0	600	0.01	1	1	1	0.01
2	1231+04	RT	1235+07	403	10.0	4029	0.09	8	8	8	0.09
2	1235+67	RT	1241+12	545	10.0	5450	0.13	11	11	11	0.13
2	1242+02	RT	1260+42	1840	10.0	18400	0.42	38	38	38	0.42
2	1261+42	RT	1263+72	230	10.0	2300	0.05	5	5	5	0.05
2	1264+42	RT	1265+87	145	10.0	1450	0.03	3	3	3	0.03
2	1266+87	RT	1280+32	1345	10.0	13450	0.31	28	28	28	0.31
2	1289+72	RT	1291+04	132	10.0	1321	0.03	3	3	3	0.03
2	1291+00	RT	1292+68	168	10.0	1679	0.04	3	3	3	0.04
2	1295+18	RT	1295+93	75	10.0	750	0.02	2	2	2	0.02
2	1296+88	RT	1297+43	55	10.0	550	0.01	1	1	1	0.01
2	1298+23	RT	1298+73	50	10.0	500	0.01	1	1	1	0.01
2	1300+63	RT	1303+83	320	10.0	3200	0.07	7	7	7	0.07
2	1304+58	RT	1307+23	265	10.0	2650	0.06	5	5	5	0.06
<b>TOTAL</b>							14	1,219	1,219	1,219	14

MODEL - Schedules Sheet  
FILE NAME: I:\2022\22068.09 IDOT D3 - W09 - Kankakee County 66R18\CADD\Drawings\66R18\Sheet-Schedule06.dgn



USER NAME = msulheard  
PLOT DATE = 12/31/2024

DESIGNED - JS  
DRAWN - MS  
CHECKED - JS  
DATE - 12/19/24

REVISED -  
REVISED -  
REVISED -  
REVISED -

STATE OF ILLINOIS  
DEPARTMENT OF TRANSPORTATION

SCHEDULES

SCALE: SHEET 6 OF 6 SHEETS STA. TO STA.

F.A.P. RTE.	SECTION	COUNTY	TOTAL SHEETS	SHEET NO.
41	(12,13,14)CJS,SR	KANKAKEE	22	14
CONTRACT NO. 66R18				
ILLINOIS FED. AID PROJECT				

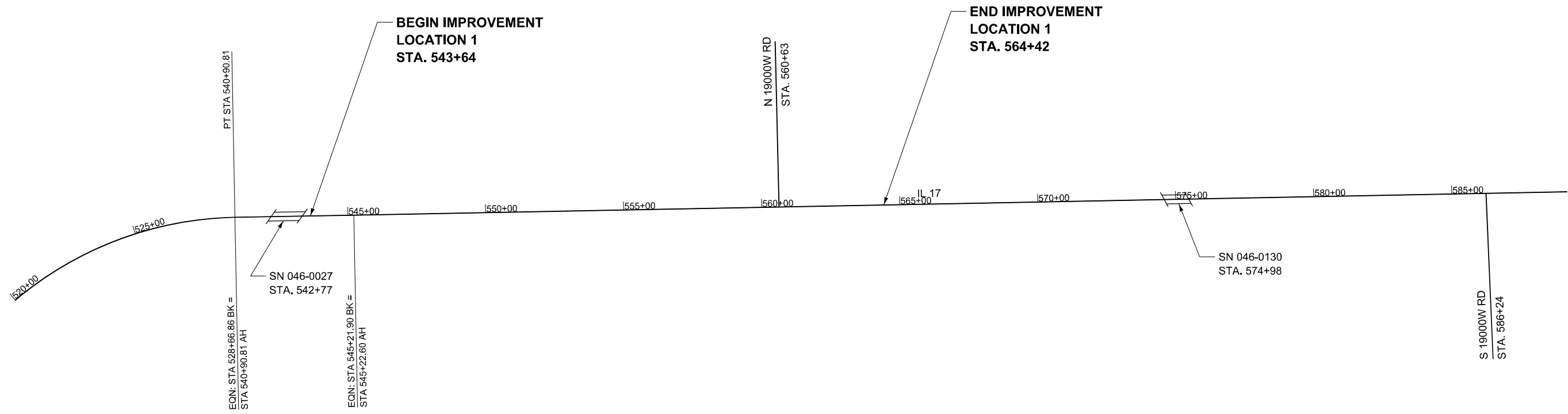

EX CURVE  
 PI STA = 521+41.42  
 $\Delta = 90^{\circ}27'20''$  (RT)  
 $D = 04^{\circ}30'29''$   
 $R = 1,271.00'$   
 $T = 1,281.15'$   
 $L = 2006.59'$   
 $E = 533.66'$   
 $e =$   
 PC STA = 508+60.27  
 PT STA = 540+90.81

MODEL: Sheet  
 FILE NAME: I:\2022\22069.09\DOT D3 - PTB\_205-023 - W09 - Kankakee County 66R18\CADD\DATA\CAD\Sheets\18-sh1-LineDrawing1.dgn



USER NAME = msulheard	DESIGNED - JS	REVISED -
	DRAWN - MS	REVISED -
	CHECKED - JS	REVISED -
PLOT DATE = 1/22/2025	DATE - 11/21/24	REVISED -

**STATE OF ILLINOIS  
 DEPARTMENT OF TRANSPORTATION**

**PROJECT LAYOUT  
 LOCATION 1**

SCALE: SHEET 1 OF 3 SHEETS STA. TO STA.

F.A.P. RTE.	SECTION	COUNTY	TOTAL SHEETS	SHEET NO.
41	(12,13,14)CJS,SR	KANKAKEE	22	15
CONTRACT NO. 66R18				
ILLINOIS FED. AID PROJECT				

MODEL: Sheet  
 FILE NAME: I:\2022\22069.09 IDOT D3 - PTB\_205-023 - W09 - Kankakee County 66R18\CADD\Drawings\CAD\Drawings\18-sh1-LineDrawing2A.dgn



USER NAME = msulheard  
 PLOT DATE = 1/22/2025

DESIGNED - JS  
 DRAWN - MS  
 CHECKED - JS  
 DATE - 11/21/24

REVISED -  
 REVISED -  
 REVISED -  
 REVISED -

**STATE OF ILLINOIS  
 DEPARTMENT OF TRANSPORTATION**

**PROJECT LAYOUT  
 LOCATION 2**

SCALE: SHEET 2 OF 3 SHEETS STA. TO STA.

F.A.P. RTE.	SECTION	COUNTY	TOTAL SHEETS	SHEET NO.
41	(12,13,14)CJS,SR	KANKAKEE	22	16
CONTRACT NO. 66R18				
ILLINOIS FED. AID PROJECT				

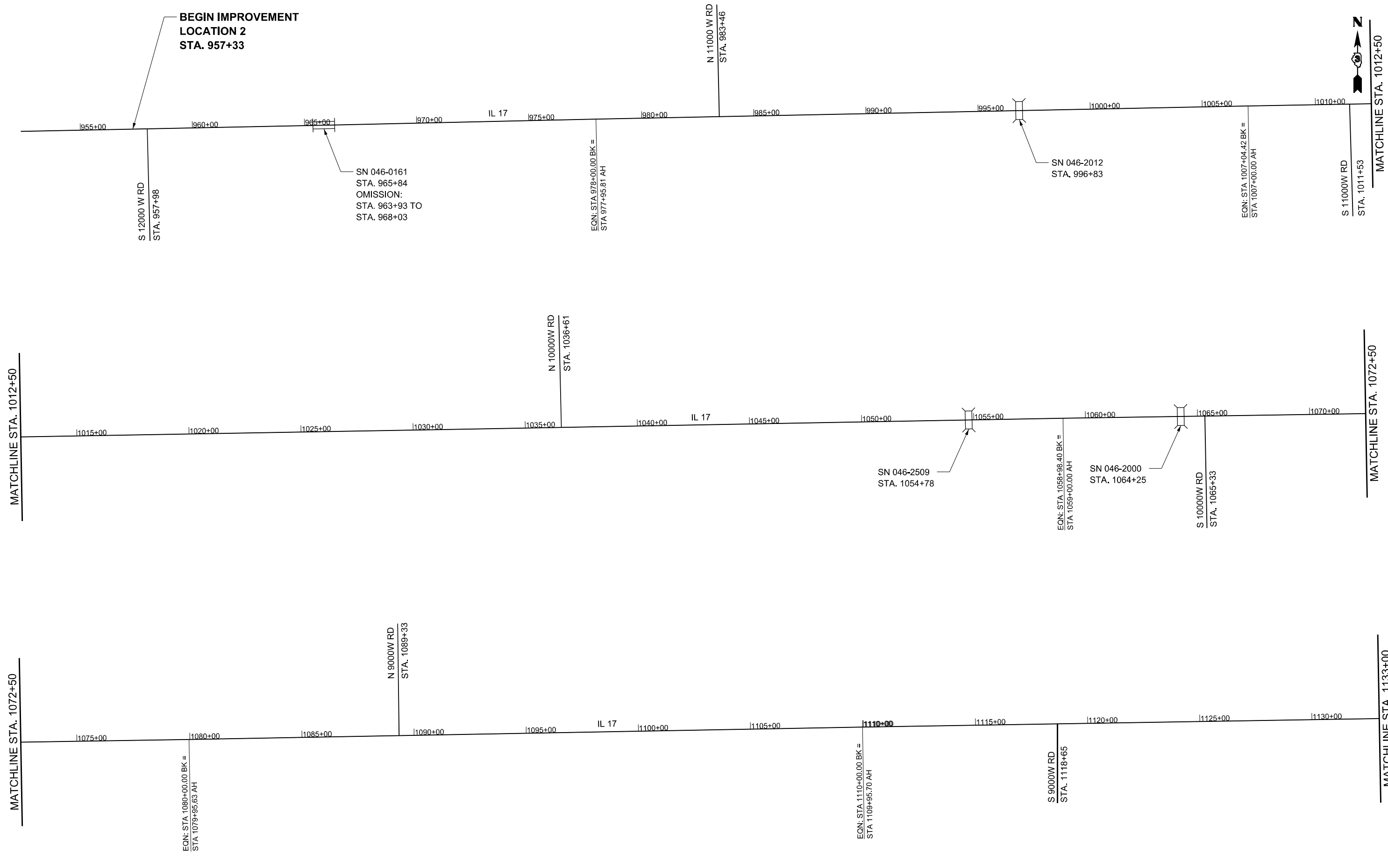



MODEL: Sheet  
 FILE NAME: I:\2022\22069.09\DOT D3 - PTB\_205-023 - W09 - Kankakee County 66R18\CADD\Drawings\CAD\Drawings\18-sh1-LineDrawing2B.dgn

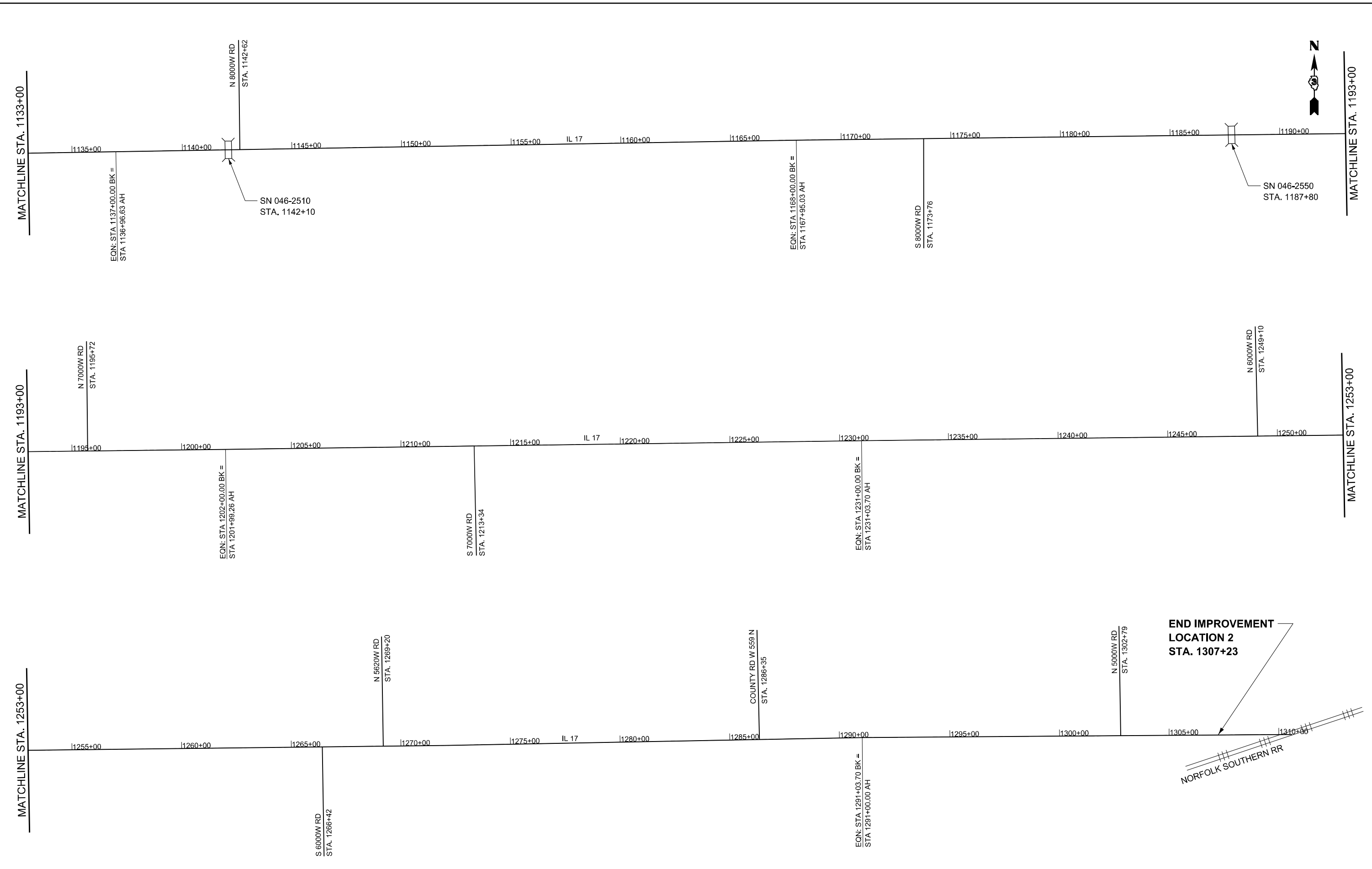

USER NAME = msulheard	DESIGNED - JS	REVISED -
	DRAWN - MS	REVISED -
	CHECKED - JS	REVISED -
PLOT DATE = 1/8/2025	DATE - 11/21/24	REVISED -



**STATE OF ILLINOIS  
 DEPARTMENT OF TRANSPORTATION**

<b>PROJECT LAYOUT LOCATION 2</b>	
SCALE:	SHEET 3 OF 3 SHEETS STA. TO STA.

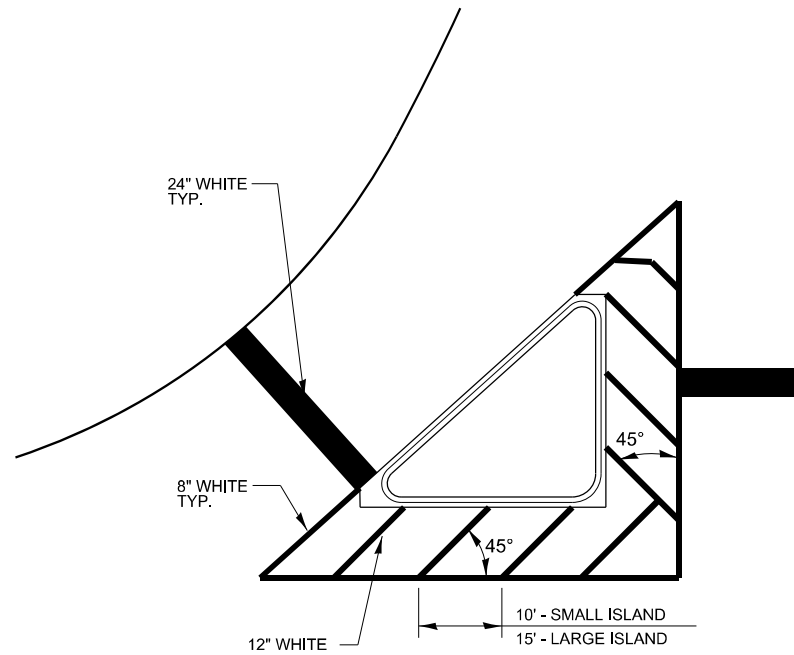
F.A.P. RTE.	SECTION	COUNTY	TOTAL SHEETS	SHEET NO.
41	(12,13,14)CJS,SR	KANKAKEE	22	17
CONTRACT NO. 66R18				
ILLINOIS FED. AID PROJECT				

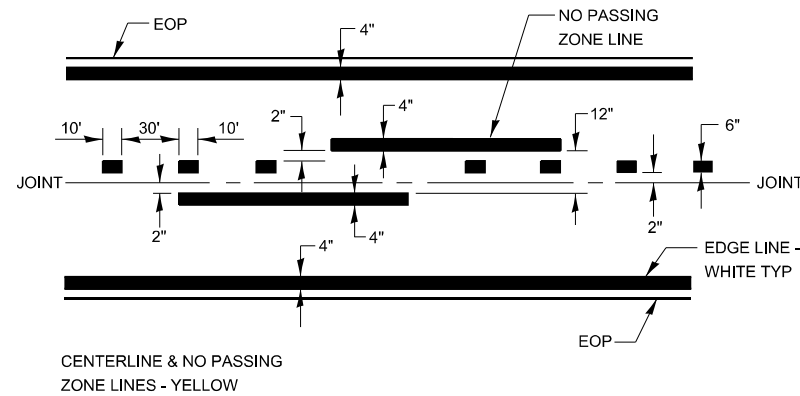

**TYPICAL ISLAND MARKINGS**



CENTERLINE & NO PASSING ZONE LINES - YELLOW

**PAVEMENT MARKING**

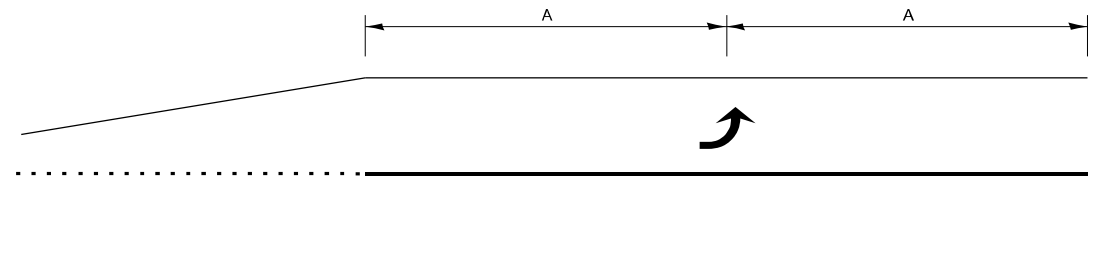

**99' AND UNDER**

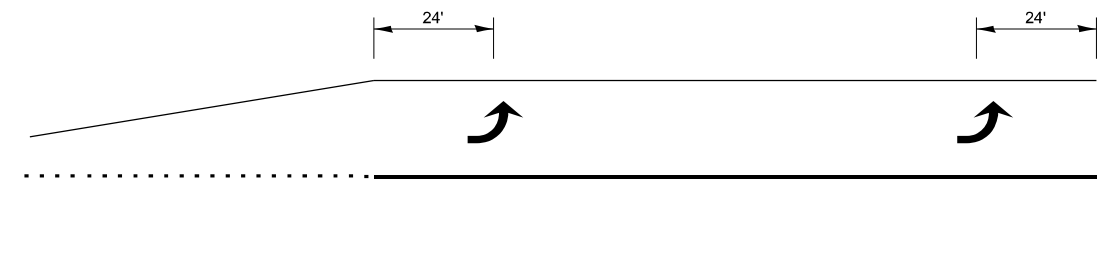

**100' TO 149'**

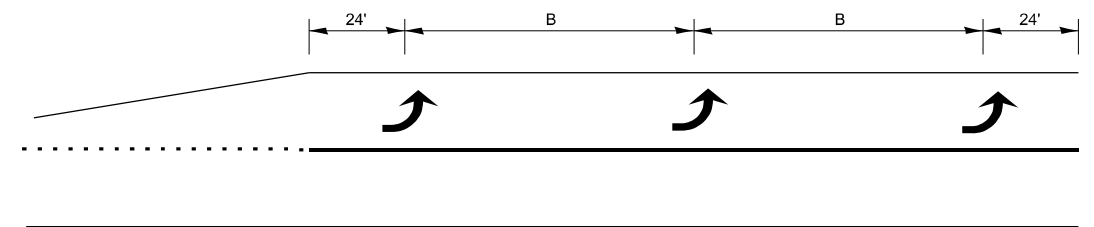

**150' AND LONGER**

**TYPICAL PLACEMENT OF ARROWS IN TURN LANES**

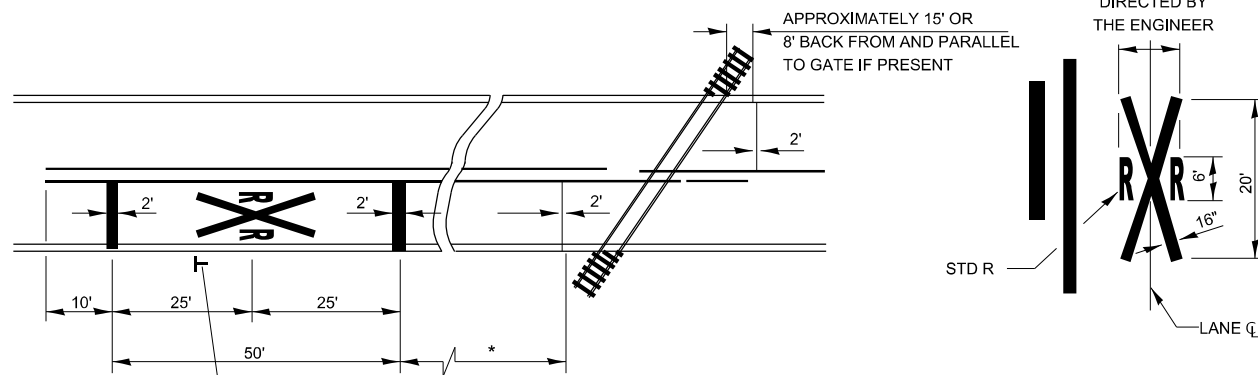

\* MINIMUM DISTANCE  
500' FOR 55 MPH  
375' FOR 45 MPH  
250' FOR 35 MPH OR LESS

NOTES:  
THE TRANSVERSE SPREAD OF THE "X" MAY VARY ACCORDING TO LANE WIDTH.

ON MULTI-LANE ROADS, THE STOP LINES SHALL EXTEND ACROSS ALL APPROACH LANES AND SEPARATE RXR SYMBOLS SHALL BE PLACED ADJACENT TO EACH OTHER IN EACH LANE.

WHEN THE PAVEMENT MARKING SYMBOL IS USED, A PORTION OF THE SYMBOL SHOULD BE LOCATED DIRECTLY ADJACENT TO THE ADVANCE WARNING SIGN (W10-1).

**PAVEMENT MARKINGS AT RAILROAD-HIGHWAY GRADE CROSSING**

MODEL: Details Sheet  
FILE NAME: I:\2022\22069.09 IDOT D3 - PTB\_205-023 - W09 - Kankakee County 66R18\CADD\DrawCAD\Drawings\66R18-sh1-Details01.dgn



USER NAME = msulheard	DESIGNED - JS	REVISED -
	DRAWN - MS	REVISED -
	CHECKED - JS	REVISED -
PLOT DATE = 1/20/2025	DATE - 12/20/24	REVISED -

STATE OF ILLINOIS  
DEPARTMENT OF TRANSPORTATION

DETAILS			
SCALE:	SHEET 1	OF 5 SHEETS	STA. TO STA.

F.A.P. RTE.	SECTION	COUNTY	TOTAL SHEETS	SHEET NO.
41	(12,13,14)CJS,SR	KANKAKEE	22	18
CONTRACT NO. 66R18				
ILLINOIS FED. AID PROJECT				

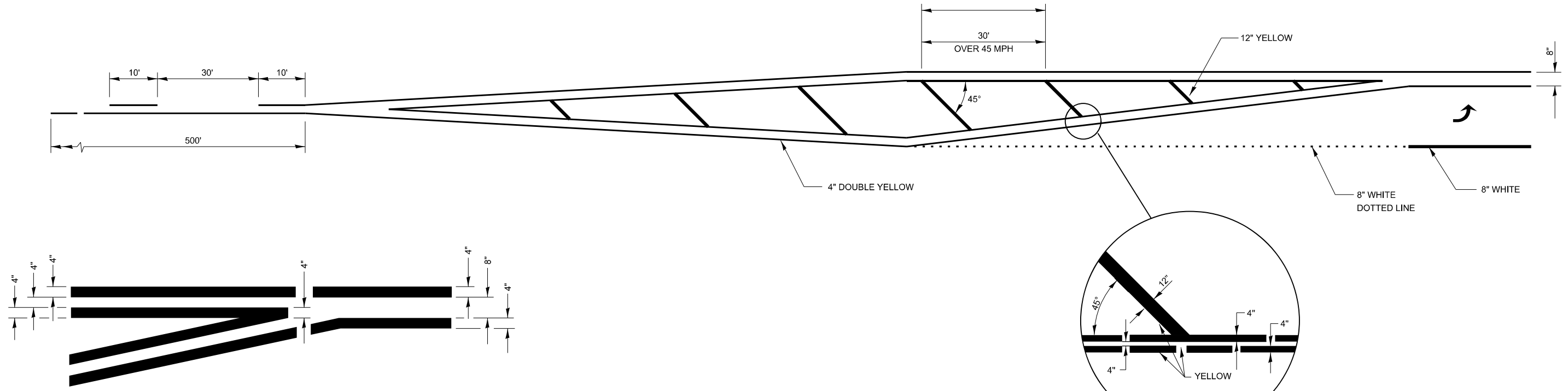

**LEFT TURN LANE  
TYPICAL APPLICATION**

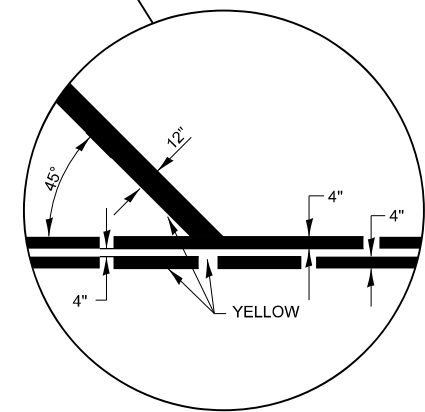

**ADVANCE AND INTERSECTION LANE  
DIVIDER LINES**

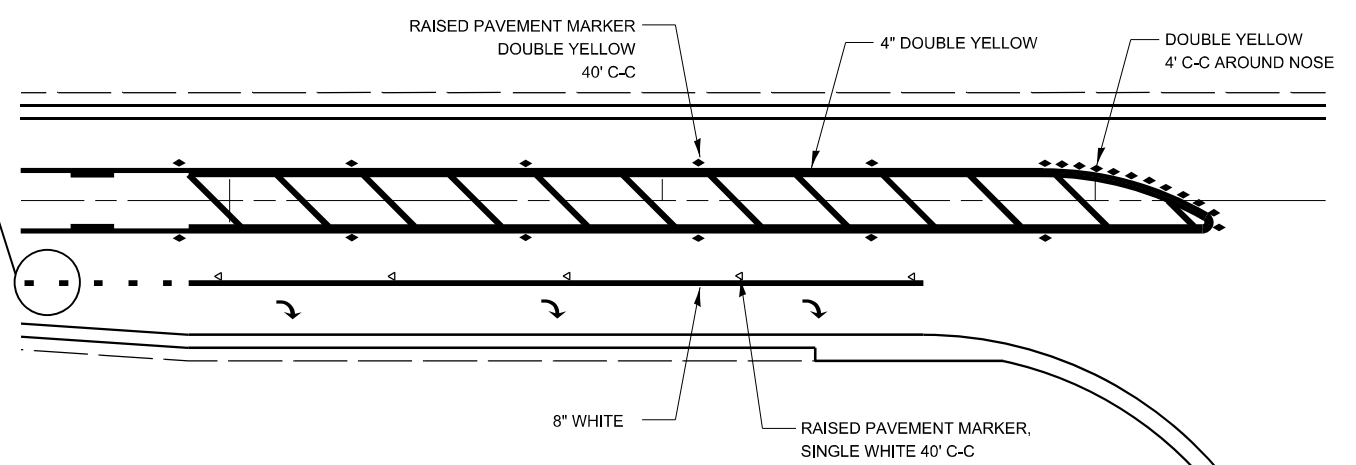
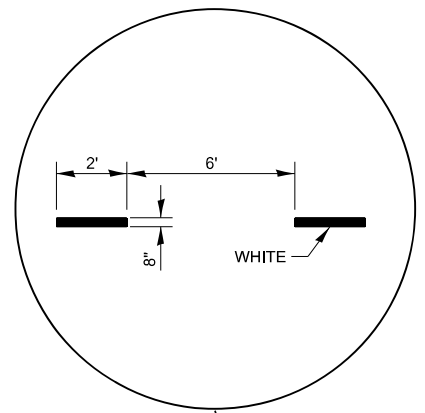

**RAISED REFLECTIVE AND PAVEMENT MARKERS  
@ RIGHT TURN LANE**

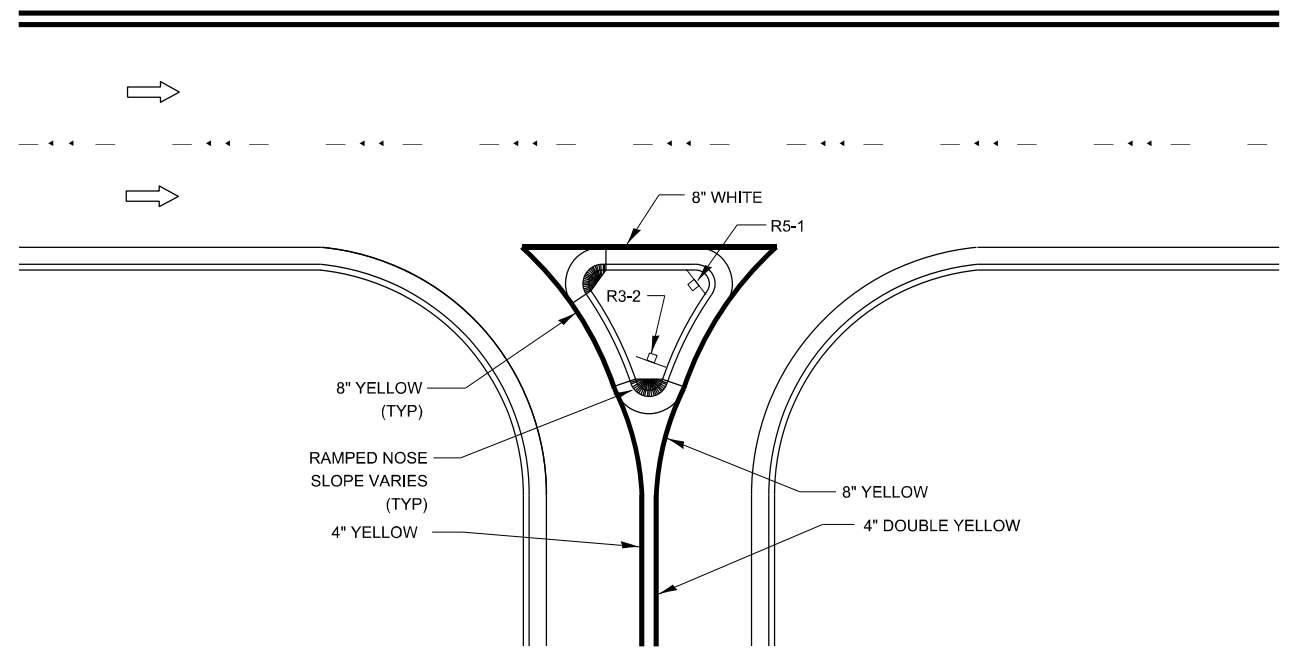

**RIGHT IN RIGHT OUT ACCESS PAVEMENT MARKING**

MODEL: Details Sheet  
 FILE NAME: I:\2022\22069.09 IDOT D3 - PTB\_205-023 - W09 - Kankakee County 66R18\CADD\Drawings\CAD\Drawings\66R18-shd-Details02.dgn



USER NAME = msulheard	DESIGNED - JS	REVISED -
	DRAWN - MS	REVISED -
	CHECKED - JS	REVISED -
DATE = 12/20/24	DATE = 12/20/24	REVISED -
PLOT DATE = 1/20/2025		

**STATE OF ILLINOIS  
DEPARTMENT OF TRANSPORTATION**

<b>DETAILS</b>			
SCALE:	SHEET 2	OF 5 SHEETS	STA. TO STA.

F.A.P. RTE.	SECTION	COUNTY	TOTAL SHEETS	SHEET NO.
41	(12,13,14)CJS,SR	KANKAKEE	22	19
CONTRACT NO. 66R18				
ILLINOIS FED. AID PROJECT				

MODEL: Details Sheet  
 FILE NAME: I:\2022\22069.09 IDOT D3 - PTB 205-023 - W09 - Kankakee County 66R18\CADD\Detail\CAD\sheet\66R18-sh1-Details03.dgn

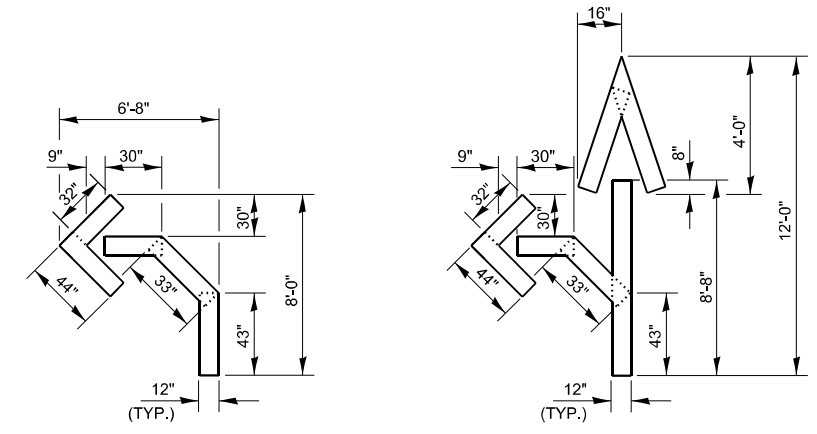

**QUANTITY**  
 12" LINE = 16 LIN FT  
 OR 4" LINE = 48 LIN FT

**QUANTITY**  
 12" LINE = 29 LIN FT  
 OR 4" LINE = 87 LIN FT

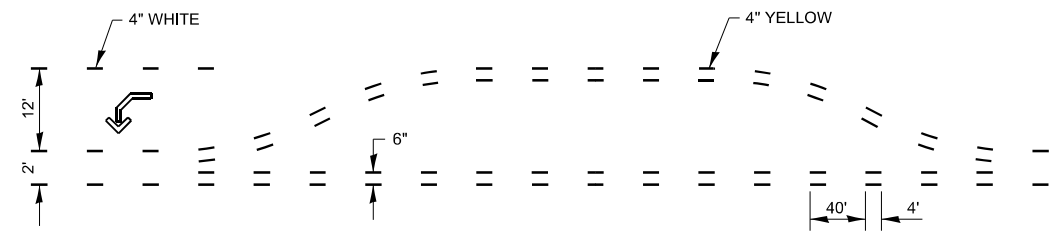

**SHORT-TERM PAVEMENT MARKING FOR MEDIANS AND ARROWS**

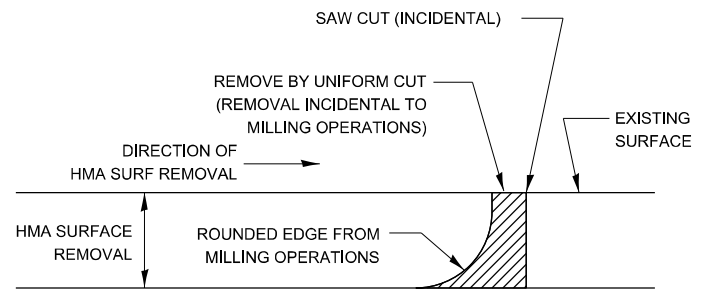

**NOTE:**  
 WHEN MILLING OPERATIONS PRODUCE A ROUNDED EDGE, THEN A SAW CUT SHALL BE USED TO MANUFACTURE A PERPENDICULAR EDGE AS SHOWN IN THE DETAIL. THE ENGINEER SHALL BE THE SOLE JUDGE CONCERNING THE USE OF THIS DETAIL.

**HMA BUTT JOINT SAW CUTS**

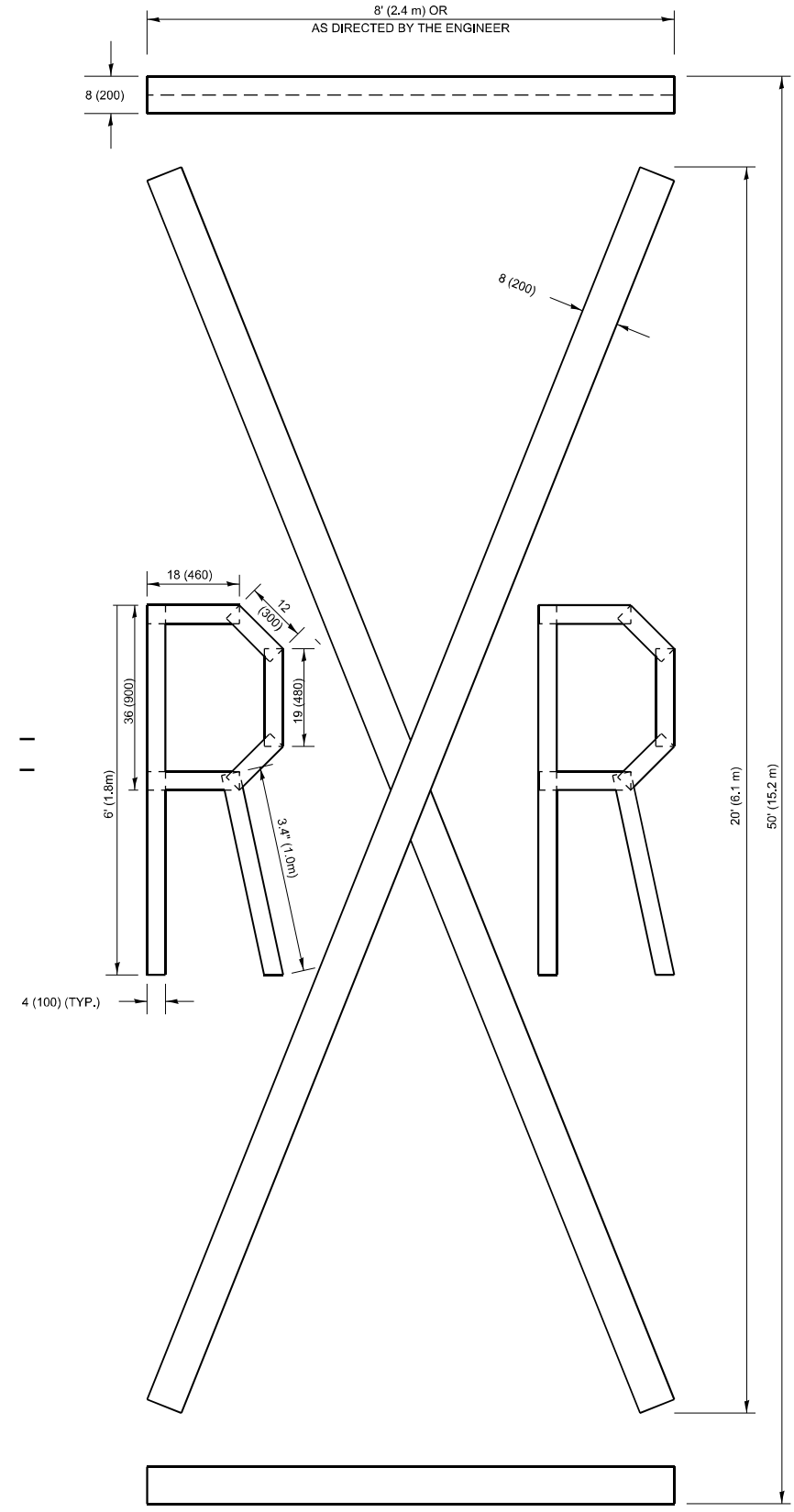

**QUANTITY**  
 4 (100) LINE = 225.9 ft. (68.9 m)  
 75.3 sq. ft. (6.99 sq. m)

All dimensions are in inches (millimeters) unless otherwise shown.

**SHORT TERM MARKINGS AT RR CROSSINGS**

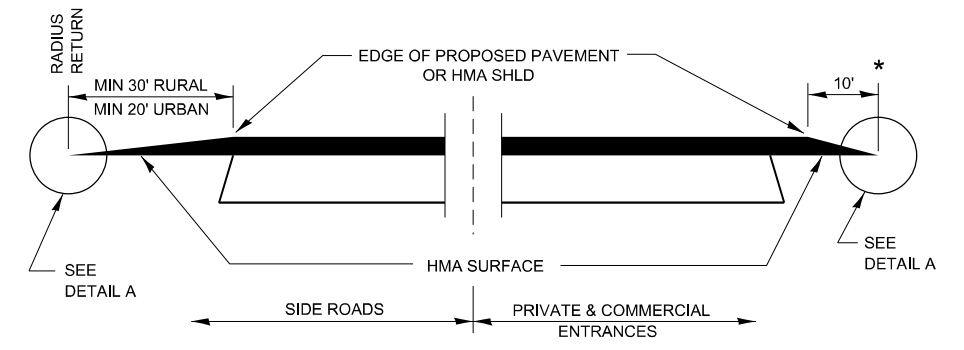

**SECTION A-A  
 DETAILS AT ENTRANCES & SIDE ROADS**

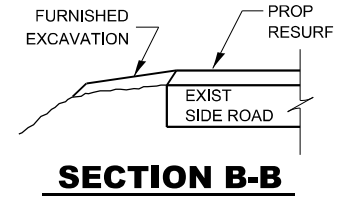

**SECTION B-B**

THE COST OF REMOVAL AT EXISTING HMA OR PCC LOCATIONS SHALL BE PAID FOR PER SQ YD BY THE APPROPRIATE PAY ITEM. REMOVAL AT THE EXISTING AGG LOCATIONS SHALL BE INCIDENTAL TO THE HMA. A-3 LOCATIONS SHALL BE FEATHER TAPERED.

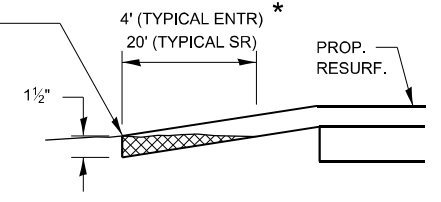

**DETAIL A**

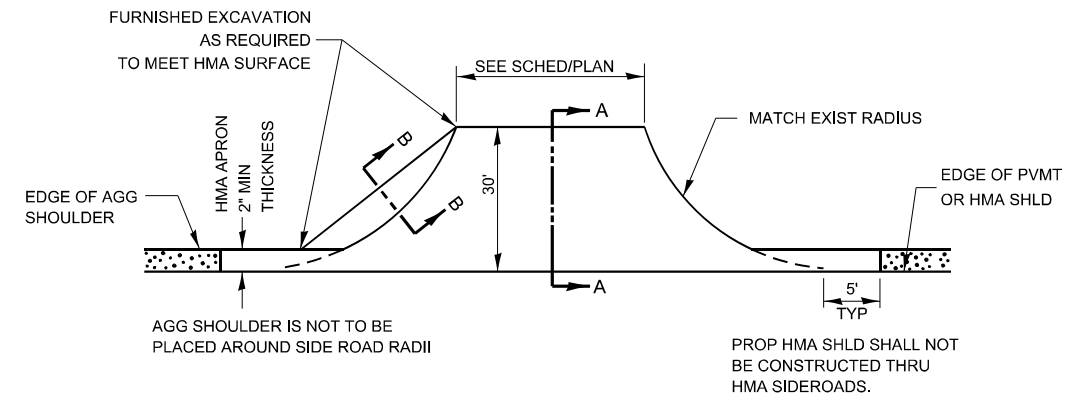

**PLAN AT SIDE ROADS**

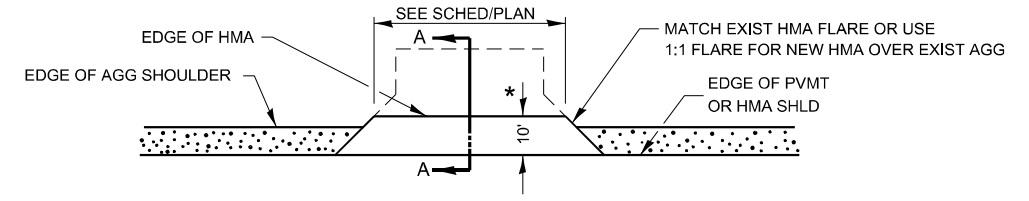

**PLAN AT PRIVATE & COMMERCIAL ENTRANCES**

(DO NOT RESURFACE FIELD ENTRANCES)

\* PROPOSED HMA RESURFACING AT PUBLIC EDUCATIONAL FACILITY ENTRANCES SHALL BE EXTENDED TO THE RIGHT-OF-WAY LIMITS.



USER NAME = msulheard	DESIGNED - JS	REVISED -
	DRAWN - MS	REVISED -
	CHECKED - JS	REVISED -
PLOT DATE = 1/20/2025	DATE - 12/20/24	REVISED -

**STATE OF ILLINOIS  
 DEPARTMENT OF TRANSPORTATION**

<b>DETAILS</b>			
SCALE:	SHEET 3	OF 5 SHEETS	STA. TO STA.

F.A.P RTE.	SECTION	COUNTY	TOTAL SHEETS	SHEET NO.
41	(12,13,14)CJS,SR	KANKAKEE	22	20
CONTRACT NO. 66R18				
ILLINOIS FED. AID PROJECT				

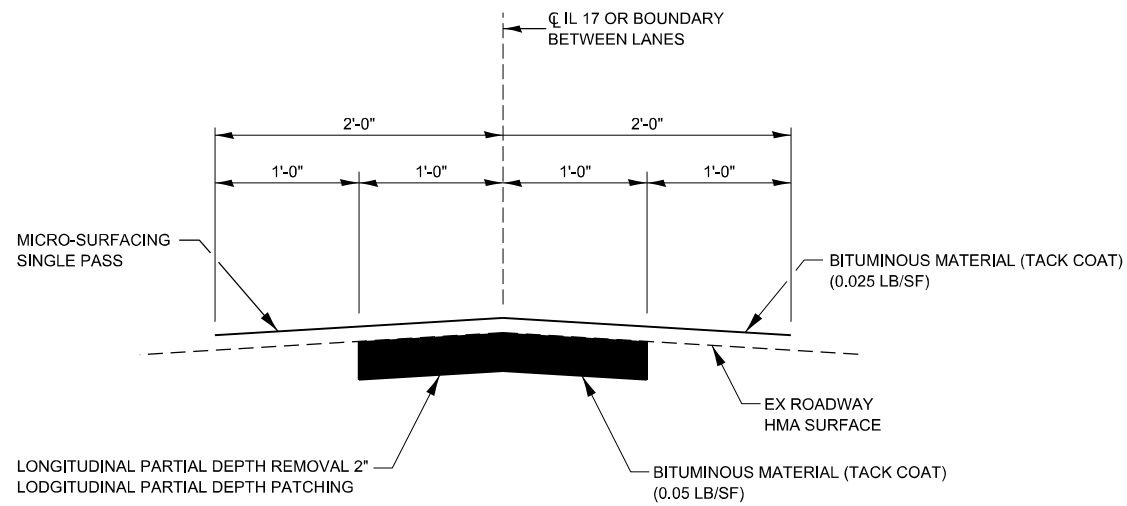

## LONGITUDINAL PARTIAL DEPTH PATCHING

### NOTES:

- RESURFACING SHALL BE LOCATED AT THE CENTERLINE OF PAVEMENT JOINT OR THE JOINT AT THE BOUNDARY BETWEEN LANES. ACTUAL LOCATIONS TO BE DETERMINED BY THE ENGINEER PRIOR TO THE CONTRACTOR BEGINNING HIS/HER CONSTRUCTION OPERATIONS.
- OFFSET OF THE PERMANENT CENTERLINE PAVEMENT STRIPING SHALL BE FIELD DETERMINED BY THE ENGINEER. SHORT TERM AND/OR TEMPORARY PAVEMENT MARKING SHALL BE PLACED AT THE SAME LOCATION AS THE PROPOSED PAVEMENT MARKING.
- AFTER MILLING, AND PRIOR TO PLACING THE HMA MIXTURE, AREAS WITH SIGNIFICANT ADDITIONAL DETERIORATION ALONG THE JOINT SHALL BE PREFILLED WITH MIXTURE FOR CRACKS, JOINTS AND FLANGEWAYS AND COMPACTED TO THE SATISFACTION OF THE ENGINEER.

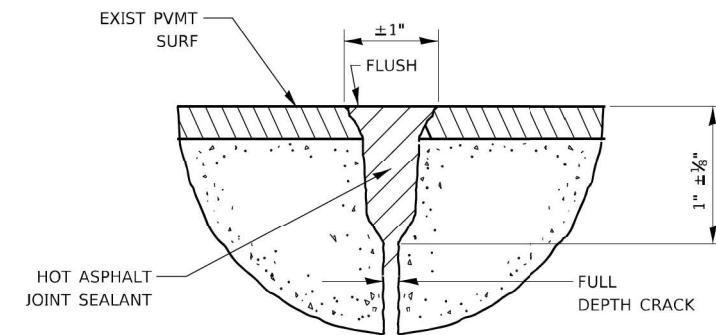

## ROUTING & SEALING JOINTS

TRANSVERSE PATCH BOUNDARIES)

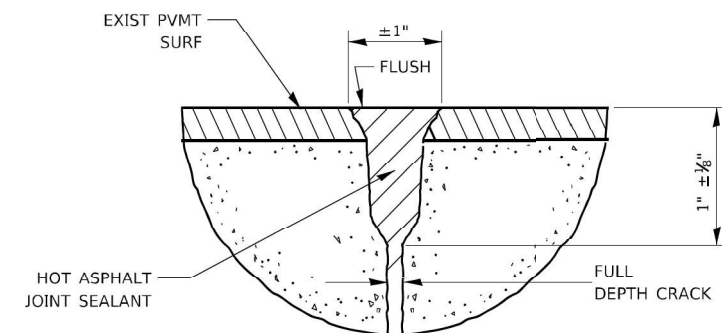

## SEALING CRACKS (PAVEMENT) DETAIL

NOTE: ALL CRACKS LESS THAN 3/8" WIDTH REQUIRE ROUTING

STATE OF ILLINOIS  
DEPARTMENT OF TRANSPORTATION

DETAILS

SCALE: SHEET 4 OF 5 SHEETS STA. TO STA.

F.A.P. RTE.	SECTION	COUNTY	TOTAL SHEETS	SHEET NO.
41	(12,13,14)CJS,SR	KANKAKEE	22	21
CONTRACT NO. 66R18				
ILLINOIS FED. AID PROJECT				

USER NAME = msulheard	DESIGNED - JS	REVISED -
	DRAWN - MS	REVISED -
	CHECKED - JS	REVISED -
PLOT DATE = 12/20/2024	DATE - 12/20/24	REVISED -

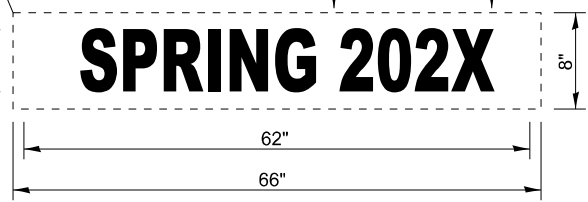
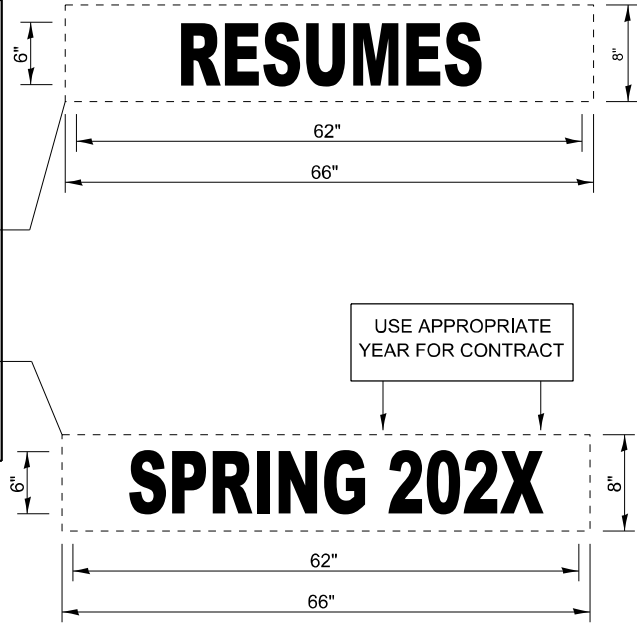
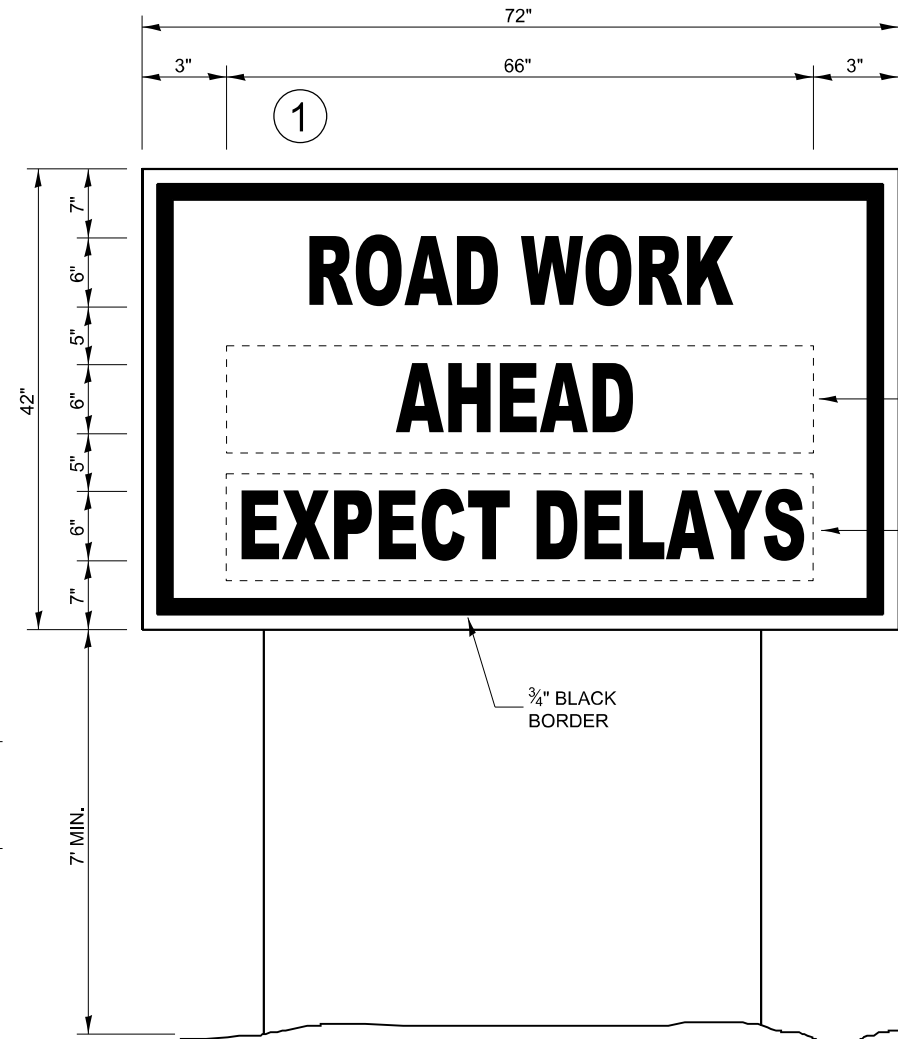
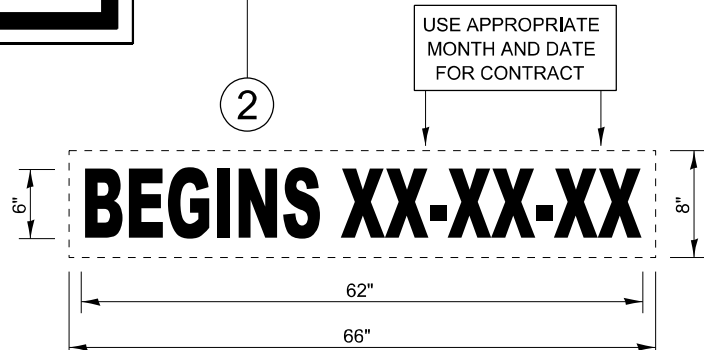
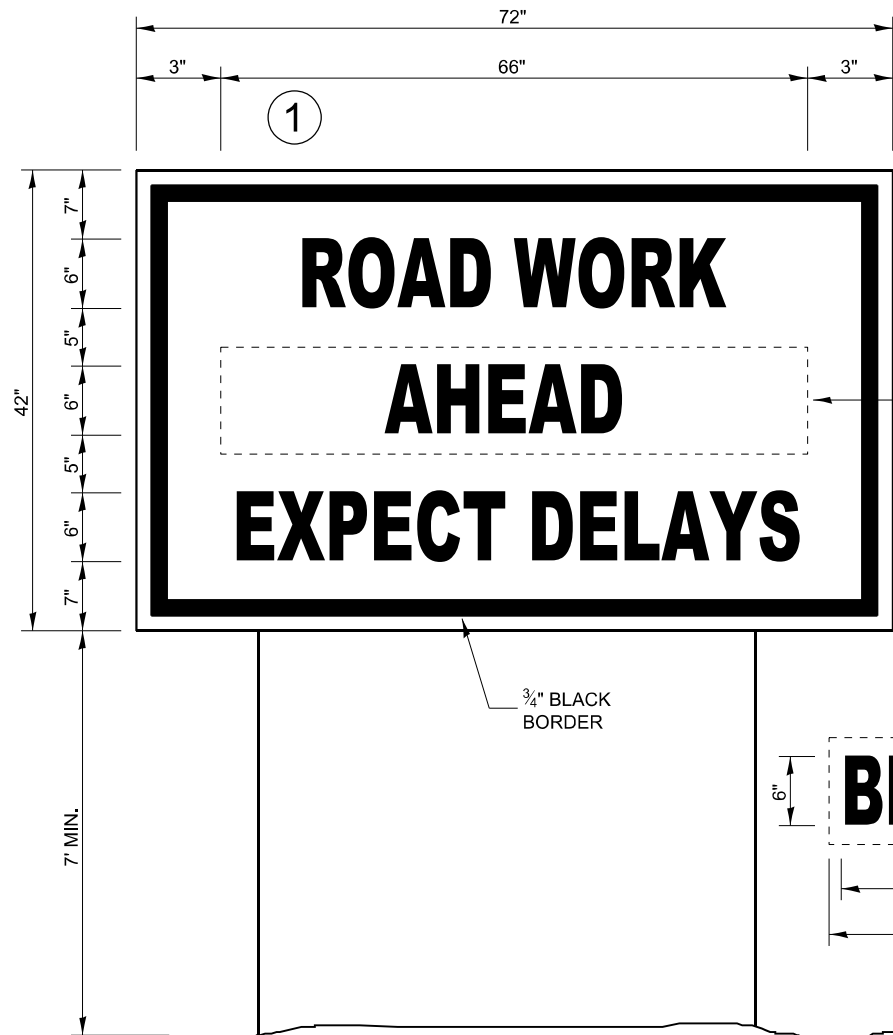

**TEMPORARY INFORMATION SIGNING**

**WINTER SHUT DOWN SIGNING**

**NOTES:**

1. USE 6" D BLACK LETTERING ON FLOURESENT ORANGE BACKGROUND.
2. ERECT SIGNS AT LOCATIONS IN ADVANCE OF THE "ROAD CONSTRUCTION AHEAD" SIGNS AS DIRECTED BY THE ENGINEER.
3. ERECT SIGN①WITH INSTALLED PANEL②A MINIMUM OF ONE WEEK PRIOR TO THE START OF THE LANE CLOSURE.
4. REMOVE PANEL②ON THAT DATE.
5. SEE SPECIAL PROVISION "TEMPORARY INFORMATION SIGNING" FOR ADDITIONAL INFORMATION.
6. WILL BE PAID FOR PER SQ FT AS "TEMPORARY INFORMATION SIGNING". EACH SIGN = 21 SQ FT AND THE DATE PANEL②WILL NOT BE MEASURED SEPARATELY FOR PAYMENT.

MODEL - Details Sheet  
FILE NAME: I:\2022\22069.09 IDOT D3 - PTB\_205-023 - W09 - Kankakee County 66R18\CADD\Drawings\CAD\Drawings\66R18-eh1-Details05.dgn



USER NAME = msulheard	DESIGNED - JS	REVISED -
	DRAWN - MS	REVISED -
	CHECKED - JS	REVISED -
PLOT DATE = 12/20/2024	DATE - 12/20/24	REVISED -

**STATE OF ILLINOIS  
DEPARTMENT OF TRANSPORTATION**

<b>DETAILS</b>			
SCALE:	SHEET 5	OF 5 SHEETS	STA. TO STA.

F.A.P. RTE.	SECTION	COUNTY	TOTAL SHEETS	SHEET NO.
41	(12,13,14)CJS,SR	KANKAKEE	22	22
CONTRACT NO. 66R18				
ILLINOIS FED. AID PROJECT				