

06-13-2025 LETTING ITEM 167

INDEX OF SHEETS

- 1 COVER SHEET
- 2 GENERAL NOTES & SUMMARY OF QUANTITIES
- 3 TYPICAL SECTION
- 4 OVERALL PLAN
- 5-6 DISTRICT 4 STANDARDS

LIST OF HIGHWAY STANDARDS

- 701301-04 LANE CLOSURE, 2L, 2W, SHORT TIME OPERATIONS
- 701306-04 LANE CLOSURE, 2L, 2W, SLOW MOVING OPERATIONS  
DAY ONLY, FOR SPEEDS ≤ 45 MPH
- 701311-03 LANE CLOSURE, 2L, 2W, MOVING OPERATIONS - DAY ONLY
- 701901-10 TRAFFIC CONTROL DEVICES

# KNOX COUNTY COUNTY HIGHWAY 25 RECONSTRUCTION

STR FUNDS  
F.A.S. 401 (COUNTY HIGHWAY 25)  
FROM COUNTY HIGHWAY 26 (1050 N)  
TO SOUTH SEMINARY ST  
SECTION 20-00059-02-RS

**PROPOSED IMPROVEMENT:**  
PROJECT CONSISTS OF COLD-IN-PLACE RECYCLING  
AND 2" HMA OVERLAY. THIS WORK INCLUDES CAPE  
SEAL, AGGREGATE SHOULDERS AND OTHER COLLATERAL  
WORK.

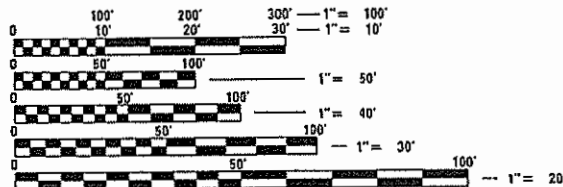

FULL SIZE PLANS HAVE BEEN PREPARED USING STANDARD  
ENGINEERING SCALES. REDUCED SIZED PLANS WILL NOT  
CONFORM TO STANDARD SCALES. IN MAKING MEASUREMENTS  
ON REDUCED PLANS, THE ABOVE SCALES MAY BE USED.

J.U.L.I.E.  
JOINT UTILITY LOCATION INFORMATION FOR EXCAVATION  
1-800-892-0123  
OR 811

PROJECT MANAGER: SHANE LARSON, P.E.  
PROJECT ENGINEER: ARLENE OTERO FEBUS

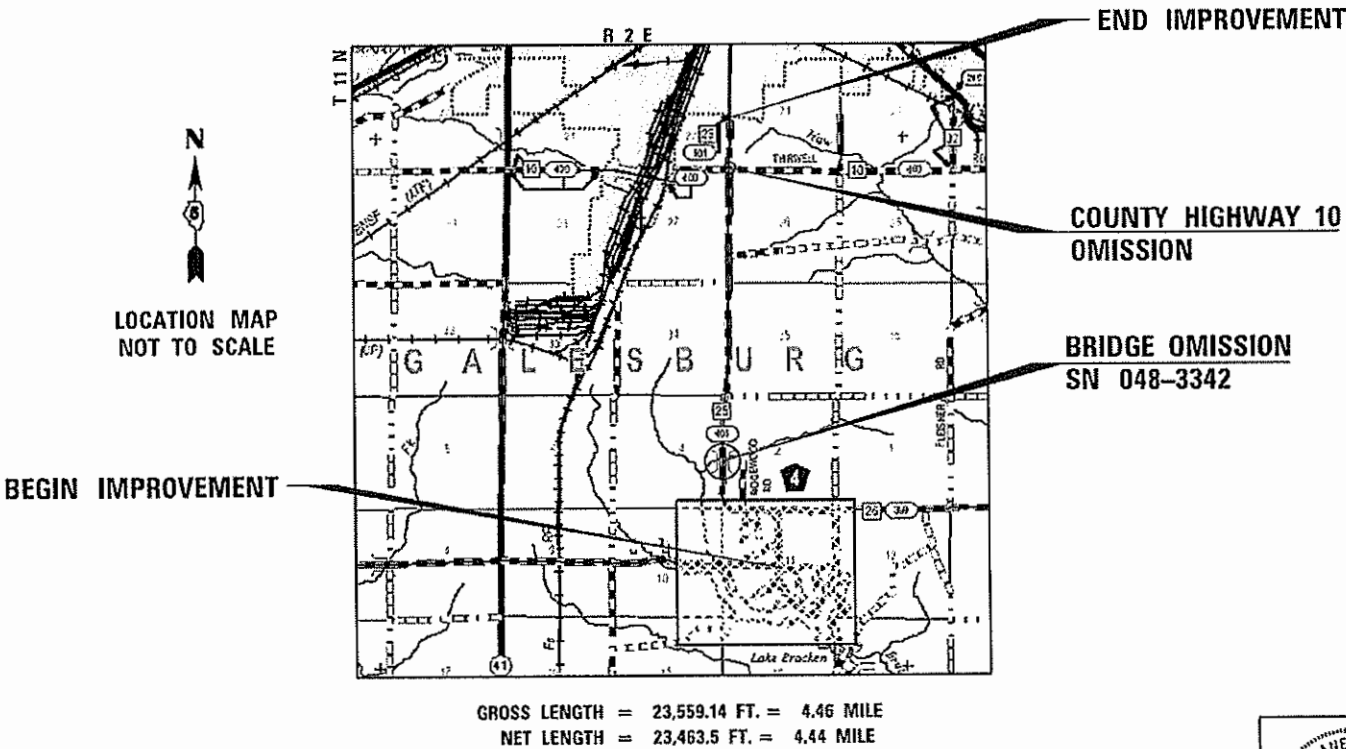

GROSS LENGTH = 23,559.14 FT. = 4.46 MILE  
NET LENGTH = 23,463.5 FT. = 4.44 MILE



FUNCTIONAL CLASSIFICATION  
RURAL MAJOR COLLECTOR  
2022 ADT = 1150  
DESIGN SPEED = 55 MPH  
PV = 88% SU = 7% MU = 5%

APPROVED	DATE
<i>Shane Larson</i>	April 7, 2025
KNOX COUNTY	
PASSED	DATE
<i>Arlene Otero Febus</i>	04-09 20 25
DISTRICT 4 ENGINEER OF LOCAL ROADS & STREETS	
Releasing For Bid Based on Limited Review	DATE
	April 9, 2025
<i>Kenneth A. Garnett</i>	
DEPUTY DIRECTOR OF HIGHWAYS, REGION 3 ENGINEER	
STATE OF ILLINOIS	
DEPARTMENT OF TRANSPORTATION	

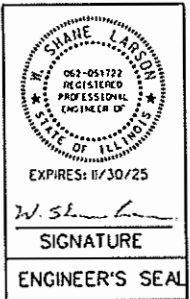

PRINTED BY THE AUTHORITY  
OF THE STATE OF ILLINOIS

GENERAL NOTES

AVAILABILITY OF ELECTRONIC FILES

MICROSTATION AND OPENROADS DESIGNER FILES OF THIS PROJECT WILL BE MADE AVAILABLE TO THE CONTRACTOR AFTER CONTRACT AWARD. IF THERE IS A CONFLICT BETWEEN THE ELECTRONIC FILES AND THE PRINTED CONTRACT PLANS AND DOCUMENTS, THE PRINTED CONTRACT PLANS AND DOCUMENTS SHALL TAKE PRECEDENCE OVER THE ELECTRONIC FILES. THE CONTRACTOR SHALL ACCEPT ALL RISK ASSOCIATED WITH USING THE ELECTRONIC FILES AND SHALL HOLD THE DEPARTMENT HARMLESS FOR ANY ERRORS OR OMISSIONS IN THE ELECTRONIC FILES AND THE DATA CONTAINED THEREIN. ERRORS OR DELAYS RESULTING FROM THE USE OF THE ELECTRONIC FILES BY THE CONTRACTOR SHALL NOT RESULT IN AN EXTENSION OF TIME FOR ANY INTERIM OR FINAL COMPLETION DATE OR SHALL NOT BE CONSIDERED CAUSE FOR ADDITIONAL COMPENSATION. THE CONTRACTOR SHALL NOT USE, SHARE, OR DISTRIBUTE THESE ELECTRONIC FILES EXCEPT FOR THE PURPOSE OF CONSTRUCTING THIS CONTRACT. ANY CLAIMS BY THIRD PARTIES DUE TO USE OR ERRORS SHALL BE THE SOLE RESPONSIBILITY OF THE CONTRACTOR. THE CONTRACTOR SHALL INCLUDE THIS DISCLAIMER WITH THE TRANSFER OF THESE ELECTRONIC FILES TO ANY OTHER PARTIES AND SHALL INCLUDE APPROPRIATE LANGUAGE BINDING THEM TO SIMILAR RESPONSIBILITIES.

ENVIRONMENTAL REVIEWS

PRIOR TO THE USE OF ANY PROPOSED BORROW AREAS, USE AREAS (TEMPORARY ACCESS ROADS, DETOURS RUN-AROUNDS, ETC.) AND/OR WASTE AREAS, THE CONTRACTOR SHALL FILE THE REQUIRED ENVIRONMENTAL RESOURCE REQUEST SURVEYS ACCORDING TO SECTION 107.22 OF THE STANDARD SPECIFICATIONS. THESE SURVEYS ARE REQUIRED IN ORDER FOR THE DEPARTMENT TO CONDUCT CULTURAL AND BIOLOGICAL RESOURCE SURVEYS FOR THE PROPOSED SITE.

THE REQUIRED ENVIRONMENTAL RESOURCE DOCUMENTATION SHALL INCLUDE THE FOLLOWING:

- BDE FORM 2289 (CULTURAL AND NATURAL RESOURCES REVIEW OF BORROW AREAS)
- BDE FORM 2290 (WASTE/USE AREA REVIEW)
- A LOCATION MAP SHOWING THE SIZE LIMITS AND LOCATION OF THE USE AREA
- COLOR PHOTOGRAPHS DEPICTING THE USE AREA
- BORROW AREA ENTRY AGREEMENT FORM - D4 P10101

PRIOR TO ANY WASTE MATERIALS BEING REMOVED FROM THE CONSTRUCTION SITE THE REQUIRED ENVIRONMENTAL RESOURCE SURVEYS WILL NEED TO BE OBTAINED AND FILED BY THE CONTRACTOR. EXCESS WASTE PRODUCTS REMOVED FROM THE CONSTRUCTION SITE SHALL BE DISPOSED OF AS REQUIRED IN SECTION 202.03 OF THE STANDARD SPECIFICATIONS.

ANY PROTRUDING METAL BARS SHALL BE REMOVED PRIOR TO THE DISPOSAL OF BROKEN CONCRETE AT APPROVED DISPOSAL SITES.

PLEASE NOTE THAT A MINIMUM OF FOUR WEEKS SHALL BE ALLOWED FOR I.D.O.T. DISTRICT 4 TO OBTAIN THE REQUIRED WASTE SITE ENVIRONMENTAL CLEARANCES AND FIVE WEEKS FOR THE REQUIRED BORROW SITE ENVIRONMENTAL CLEARANCES.

PROPERTY OWNER ACCESS REQUIREMENT

ACCESS MUST BE MAINTAINED TO ALL EXISTING PROPERTIES DURING CONSTRUCTION PER ARTICLE 107.09 UNLESS ARRANGEMENTS ARE MADE IN WRITING BY THE CONTRACTOR WITH THE PROPERTY OWNERS WITH A COPY TO THE ENGINEER FOR SHORT-TERM CLOSURES.

NO PASSING ZONE VERIFICATION

THE RESIDENT SHALL CONTACT THE COUNTY ENGINEER TO VERIFY THE LOCATION OF NO PASSING ZONES PRIOR TO PLACEMENT OF CENTERLINE STRIPING. WHERE POSSIBLE, THE RESIDENT SHALL ALSO NOTE THE LOCATION OF EXISTING NO PASSING ZONE PAVEMENT MARKINGS PRIOR TO COMMENCEMENT OF WORK.

MIXTURE REQUIREMENTS

THE FOLLOWING MIXTURE REQUIREMENTS ARE APPLICABLE FOR THIS PROJECT:

LOCATION(S):	ENTIRE PROJECT
MIXTURE USE(S):	HMA SURFACE COURSE
AC/PG:	PG 64-22
DESIGN AIR VOIDS	4.0% @ NDES = N50
MIXTURE COMPOSITION (GRADATION MIXTURE)	IL 9.5
FRICTION	MIX "C"
AGGREGATE QUALITY MANAGEMENT PROGRAM	QA/QC
SUBLOT SIZE	N/A
MATERIAL TRANSFER DEVICE (REQUIRED?)	NO

SUMMARY OF QUANTITIES			
CODE NO.	DESCRIPTION	UNIT	TOTAL QUANTITY
* 30201700	PORTLAND CEMENT	TON	153
35101400	AGGREGATE BASE COURSE, TYPE B	TON	2577
40600290	BITUMINOUS MATERIALS (TACK COAT)	POUND	24350
40604050	HOT-MIX ASPHALT SURFACE COURSE, IL-9.5, MIX "C", N50	TON	6745
48102100	AGGREGATE WEDGE SHOULDER, TYPE B	TON	1309
67100100	MOBILIZATION	L SUM	1
70300100	SHORT TERM PAVEMENT MARKING	FOOT	4928
70300150	SHORT TERM PAVEMENT MARKING REMOVAL	SQ FT	822
* 78001110	PAINT PAVEMENT MARKING - LINE 4"	FOOT	62335
X7010216	TRAFFIC CONTROL AND PROTECTION (SPECIAL)	L SUM	1
* LR400055	CIR-FDR EMULSIFIED ASPHALT	TON	430
* LR400740	COLD-IN-PLACE RECYCLING, 4.0"	SQ YD	64417
* LR403300	SURFACE PROFILE MILLING	SQ YD	64417

\* SPECIALTY ITEM

NOTE:

- (1) SHORT TERM PAVEMENT MARKING QUANTITY SHOWS TWO APPLICATIONS.  
(2) USE PAINT AT THE FIRST APPLICATION (OVER COLD-IN-PLACE), AND TAPE OVER THE FINAL PAVEMENT SURFACE PRIOR TO FINAL PAVEMENT MARKING.  
(3) CEMENT IS ESTIMATED AT 4.5 LB/SQ YD BUT SHALL BE DETERMINED IN THE PAVEMENT DESIGN PROCESS.  
(4) EMULSIFIED ASPHALT IS ESTIMATED AT 240 GAL/TON BUT SHALL BE DETERMINED IN THE PAVEMENT DESIGN PROCESS.  
(5) AGGREGATE BASE COURSE, TYPE B IS ESTIMATED AT 80 LBS/SQ YD BUT SHALL BE DETERMINED IN THE PAVEMENT PROCESS.  
(6) BITUMINOUS MATERIALS (TACK COAT) IS ESTIMATED AT 0.04 LB/SQ FT BUT SHALL BE DETERMINED IN THE PAVEMENT DESIGN PROCESS.

MODE: I: D:\HutP  
FILE NAME: V:\5511 - CH 25 Reconstruction PH III Knox County\CA\CH25\25ch25511-shr-hatchmate & SQO.dgn



DESIGNED - AOF	DATE - 11-11-24
DRAWN -	
CHECKED -	
PROJECT #: - 5511	

COUNTY HIGHWAY 25  
COLD-IN-PLACE RECYCLING



KNOX COUNTY, ILLINOIS

GENERAL NOTES & SUMMARY OF QUANTITIES

SHEET  
2 OF 6

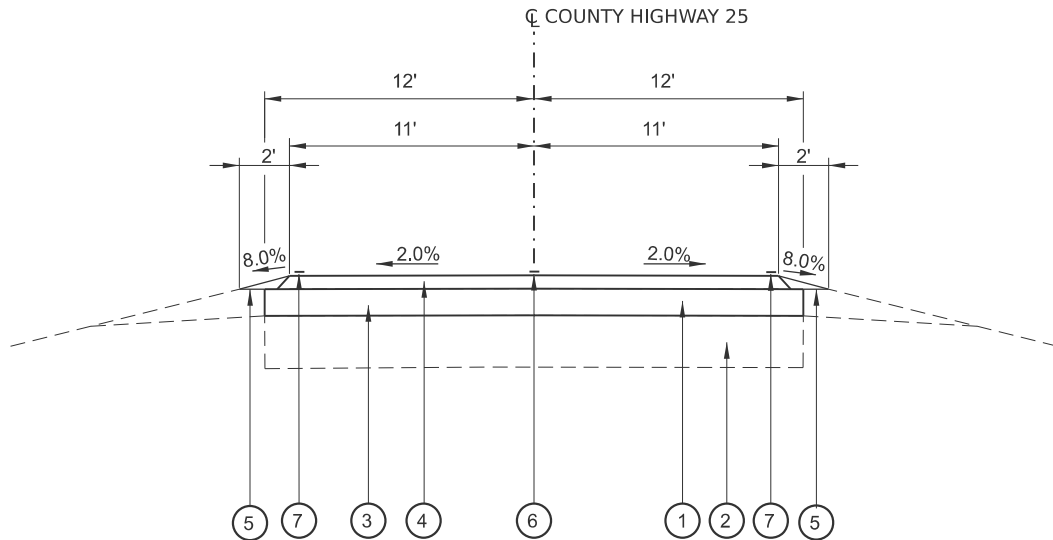

- 1 EXISTING HOT-MIX ASPHALT PAVEMENT (HMA VAR 2" - 4" WITH MICRO-SURFACE)
- 2 EXISTING BITUMINOUS AGGREGATE MIX (VAR 9" - 14")
- 3 PROPOSED COLD-IN-PLACE RECYCLING, 4.0"
- 4 PROPOSED 2" HOT-MIX ASPHALT SURFACE COURSE, IL-9.5, MIX "C", N50
- 5 PROPOSED AGGREGATE WEDGE SHOULDER, TYPE B
- 6 PROPOSED PAINT PAVEMENT MARKING - LINE 4" (YELLOW)
- 7 PROPOSED PAINT PAVEMENT MARKING - LINE 4" (WHITE)

**COUNTY HIGHWAY 25**  
**PROPOSED TYPICAL SECTION**

NOTES:

CIR EMULSION IS ESTIMATED AT 1.6 GALLONS PER SQUARE YARD.

CEMENT IS ESTIMATED AT 4.5 POUND PER SQUARE YARD.

EXISTING PAVEMENT CROSS SLOPE IS VARIABLE.

NO PASSING ZONE SHALL BE PLACED IT IN THE SAME LOCATION AS THE PREVIOUS MARKING.

MODEL: Default  
FILE NAME: 89806 - CH 25 Reconstruction PH1.dgn  
Knox City/CADD/CADD Sheets/89806 - CH 25 Reconstruction PH1.dgn



DESIGNED -	AOB	DATE -	11-11-24
DRAWN -	AOB		
CHECKED -			
PROJECT #:	5511		

**COUNTY HIGHWAY 25**  
**COLD-IN-PLACE RECYCLING**



**KNOX COUNTY, ILLINOIS**  
Welcome to Knox County, Illinois. Established in 1825.

**TYPICAL SECTION**

**SHEET**  
**3 OF 6**



**MAINTENANCE OF TRAFFIC NOTES:**

IMPROVEMENTS SHALL BE CONSTRUCTED USING TRAFFIC CONTROL IN ACCORDANCE WITH HIGHWAY STANDARDS 701306 & 701311 AND AS DIRECTED BY THE ENGINEER.

SHORT TERM PAVEMENT MARKINGS SHALL BE USED TO SEPARATE THE TWO DIRECTIONS OF TRAVEL UNTIL PERMANENT MARKINGS ARE PLACED.

LENGTH OF PROJECT SHALL BE TEMPORARILY SIGNED WITH SIGN G20-1100 (NO PASSING ZONES NOT STRIPPED NEXT XX MILES PER IL MUTCD), ANY EXISTING PASSING ZONES SIGNS SHALL BE COVERED UNTIL PERMANENT PAVEMENT MARKINGS HAVE BEEN PLACED.

ALL WORK ASSOCIATED WITH MAINTENANCE OF TRAFFIC SHALL BE PAID FOR AS TRAFFIC CONTROL AND PROTECTION (SPECIAL) AND SHORT TERM PAVEMENT MARKINGS.

END IMPROVEMENT

CH 10 OMISSION

**COLD IN-PLACE RECYCLING LIMITS**

- PAY ITEMS INCLUDE:
- SURFACE PROFILE MILLING
  - COLD IN-PLACE RECYCLING, 4.0"
  - PORTLAND CEMENT
  - CIR-FDR EMULSIFIED ASPHALT
  - HOT-MIX ASPALT SURFACE COURSE 2"
  - SHORT TERM PAVEMENT MARKING
  - SHORT TERM PAVEMENT MARKING REMOVAL
  - PAINT PAVEMENT MARKING - LINE 4"

BRIDGE SN 048-3342  
COLD IN-PLACE RECYCLING OMISSION

BEGIN IMPROVEMENT

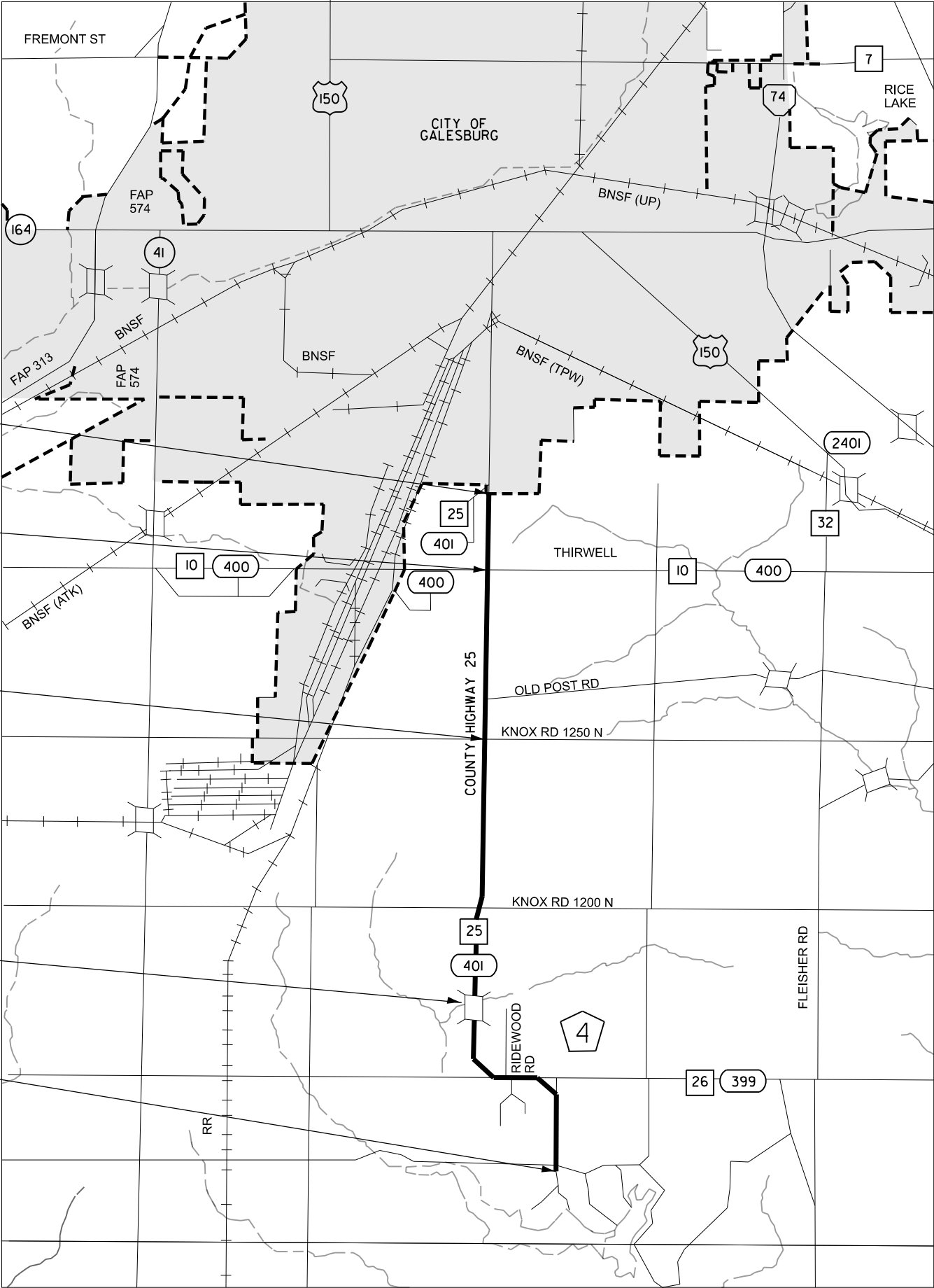

MODEL: Default  
FILE NAME: V05511 - CH 25 Reconstruction PH 1.dgn (Knox City) (CADD/CADD Sheets) 5511-ah-plan.dgn



DESIGNED	- AOF	DATE	- 11-11-24
DRAWN	-		
CHECKED	-		
PROJECT #:	- 5511		

**COUNTY HIGHWAY 25  
COLD-IN-PLACE RECYCLING**



**KNOX COUNTY, ILLINOIS**  
Welcome to Knox County, Illinois. Established in 1825.

**OVERALL PLAN**

**SHEET**

**4 OF 6**

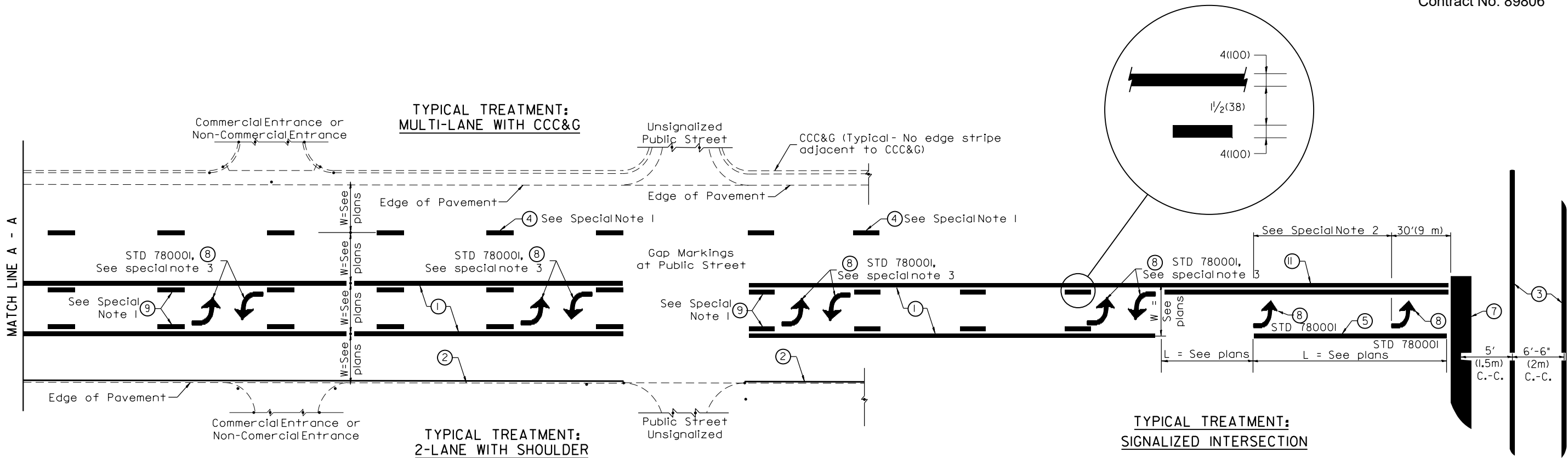

FLUSH PAVED MEDIAN: TWO-WAY LEFT TURN LANE  
WITH ONE-WAY LEFT TURN LANE AT SIGNALIZED INTERSECTION

TYPICAL PAVEMENT MARKING LEGEND

(Note: This is a District Standard Legend.  
Some elements may not apply to specific project.)

- ① 4(100) Solid (Yellow)
- ② 4(100) Solid (White)
- ③ 2-6(150) Crosswalk @ 6'-6" (2m) min C.-C. (White)  
2-8(200) Crosswalk @ 6'-6" (2m) min C.-C. (White) (When traffic signals are present.)
- ④ 6(150) Skip-Dash (White) (See Special Note 1)
- ⑤ 8(200) Solid (White)
- ⑥ 12(300) Diagonal (White) (Item 6 (13) shown on Std. 780001)
- ⑦ 24(600) Stop Bar (White)
- ⑧ Letters & Arrows (See Std. 780001 and Special Notes 2 & 3)
- ⑨ 4(100) Skip-Dash (Yellow) (See Special Note 1)
- ⑩ 12(300) Diagonal (Yellow) (See Table A)
- ⑪ 4(100) Double Solid (Yellow)

SPECIAL NOTES

- Skip-Dash markings will be centered between both ends of city blocks and shall be placed in alignment transversely across the pavement.
- The following shall apply to arrows located in one-way left turn lanes:
  - A. A minimum of two (2) arrows is required.
  - B. The maximum spacing between arrows is 80' (24 m).
  - C. Arrows shall be evenly spaced if three (3) or more are required.
- The following shall apply to arrow pairs located in two-way left turn lanes:
  - A. A minimum of two (2) arrow pairs is required.
  - B. The maximum spacing between arrow pairs is 200' (61 m).
  - C. Arrow pairs shall be evenly spaced if three (3) or more are required.
  - D. The spacing between Bi Directional Left Turn Arrows is 33' (10 m).

GENERAL NOTES

- Refer to State Standard 780001 for additional Pavement Markings including letters & arrows.
- See Plans for Pavement Markings adjacent to curbed islands and medians, and through lane reductions.
- Refer to Article 780.13 for letter, number and symbol areas (sq. ft.).
- Areas are grooved 1" beyond each edge for the following symbols:
  - Through Arrow= 14.8 sq. ft.
  - Large Left or Right Arrow= 21.9 sq. ft.
  - 2 Arrow Combination Left (or Right) and Through= 34.9 sq. ft.
  - Wrong Way Arrow= 29.5 sq. ft.
  - Railroad Crossing Symbol= 69.8 sq. ft.
  - (For further information, refer to BDE Special Provision: Grooving for Recessed Pavement Markings)

DESIGNER NOTES:  
1. Include State Standard 780001 (Typical Pavement Markings)

01-01-97	RENUM. F-8.03, NEW REVISION BOX	T.P.	10-16-06	REVISED TO 2007 SPEC.		STATE OF ILLINOIS DEPARTMENT OF TRANSPORTATION	TYPICAL PAVEMENT MARKINGS	SHT. 10F 2 CADD STD. 780001-D4	F.A.S RTE.	SECTION	COUNTY	TOTAL SHEETS	SHEET NO.
02-07-97	ADD BIDIRECTIONAL DIMENSION	J.A.	2/29/16	ADDED GROOVING AREAS	R.D.				401	20-00059-02-RS	KNOX	6	5
10-97	CORRECT BIDIRECTIONAL DIMENSION	J.A.	07-16-19	SPELLING CORRECTIONS	R.D.				CONTRACT NO. 89806				
08-02	ADD CROSSWALK DMNS. WITH T.S.	M.A.							FED. ROAD DIST. NO. ILLINOIS FED. AID PROJECT				

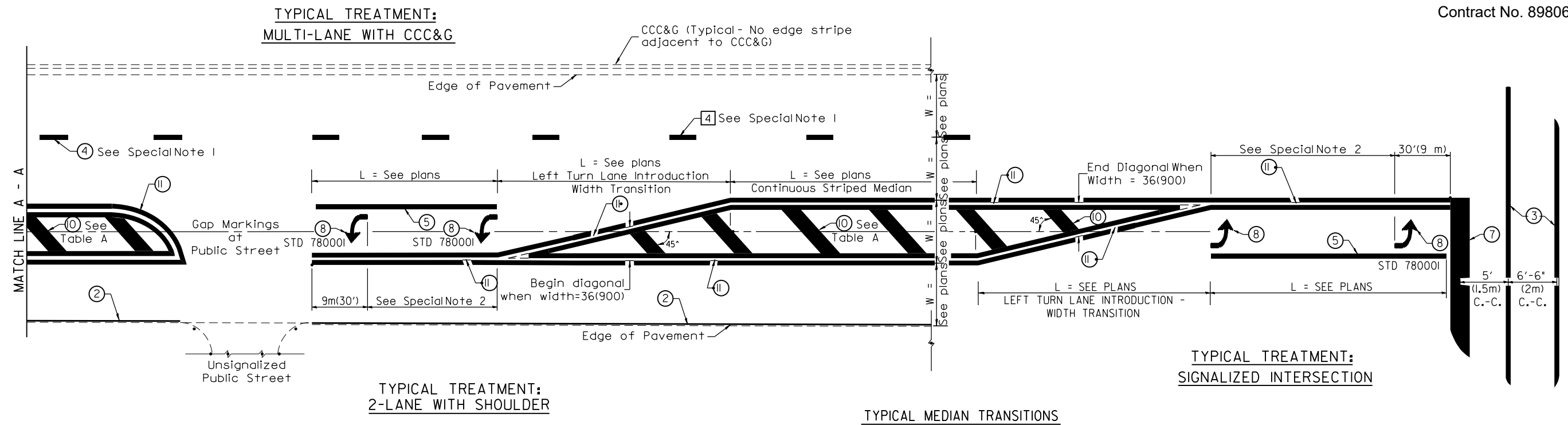

FLUSH PAVED MEDIAN: RESTRICTED LEFT TURN LANE

TABLE A  
RECOMMENDED SPACING BETWEEN DIAGONAL LINES

<u>SPEED LIMIT RANGE</u>	<u>CONTINUOUS</u>	INTERSECTION CHANNELIZATION
		(Includes Width Transitions for Median and Left Turn Lane Introductions)
Less Than 30 mph (50 km/h)	50' (15m)	15' (5m)
30 - 45 mph (50 - 70 km/h)	75' (23m)	20' (6m)
Over 45 mph (70 km/h)	150' (46m)	30' (9m)

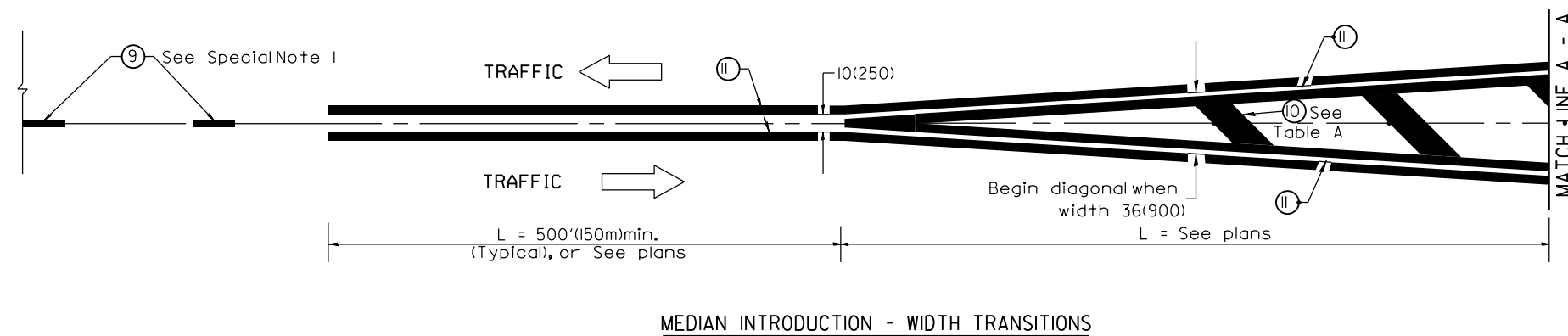

All dimensions are in inches (millimeters) unless otherwise noted.