

06-13-2025 LETTING ITEM 170

FOR INDEX OF SHEETS, SEE SHEET NO. 2  
FOR LIST OF STANDARDS, SEE SHEET NO. 2

DESIGN DESIGNATION

	FAU ROUTE 6552 (CLOVERDALE ROAD)
2022 ADT	3650
PV (100%)	3650
SU (0%)	0
MU (0%)	0
DESIGN SPEED (MPH)	40
FUNCTIONAL CLASSIFICATION	MAJOR COLLECTOR

STATE OF ILLINOIS  
DEPARTMENT OF TRANSPORTATION

CITY OF CHILLICOTHE  
CLOVERDALE ROAD RESURFACING

FAU ROUTE 6552 (CLOVERDALE ROAD)  
SECTION 24-00044-00-RS  
PROJECT 9XXJ(839)  
RESURFACING  
PEORIA COUNTY

C-94-049-25

FAU RTE.	SECTION	COUNTY	TOTAL SHEET SHEETS NO.
6552	24-00044-00-RS	PEORIA	33 1
ILLINOIS			CONTRACT NO. 89869

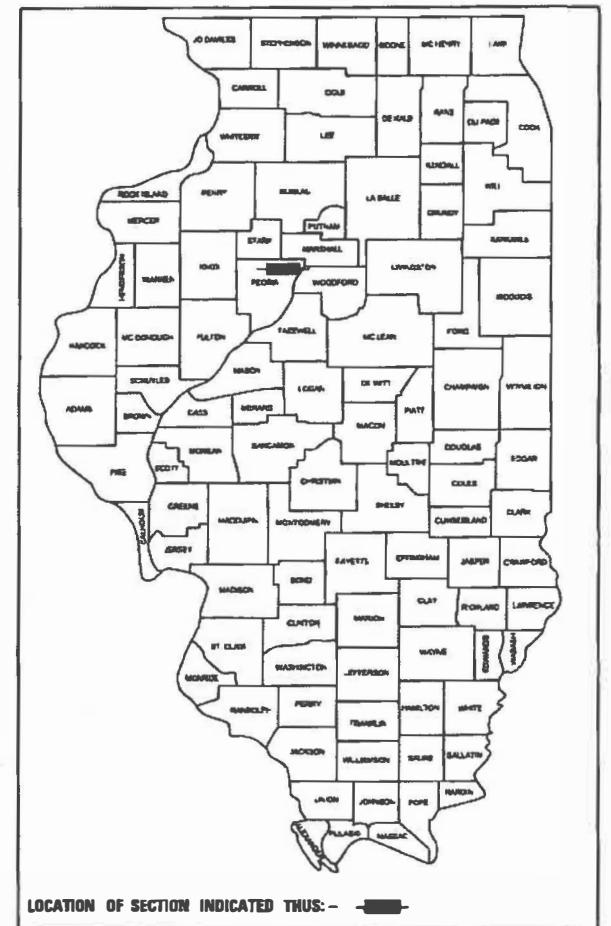

LOCATION OF SECTION INDICATED THUS: -

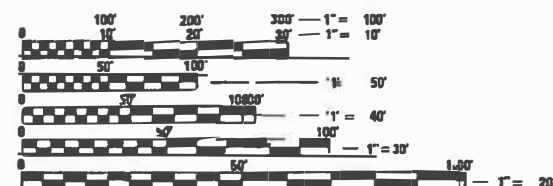

FULL SIZE PLANS HAVE BEEN PREPARED USING STANDARD  
ENGINEERING SCALES. REDUCED SIZED PLANS WILL NOT  
CONFORM TO STANDARD SCALES. IN MAKING MEASUREMENTS  
ON REDUCED PLANS, THE ABOVE SCALES MAY BE USED.

J.U.L.I.E.  
JOINT UTILITY LOCATION INFORMATION FOR EXCAVATION  
1-800-892-0123  
OR 811

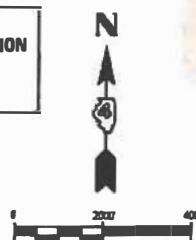

CONTRACT NO. 89869  
CATALOG NO. (036635-00D)

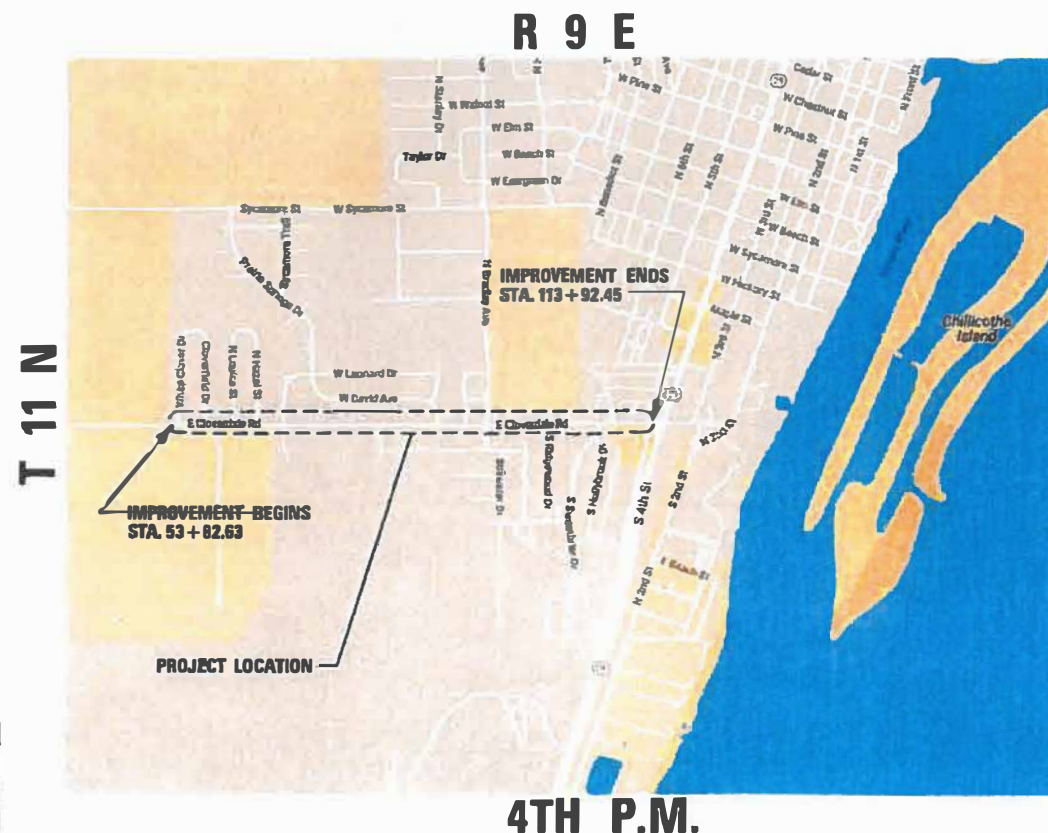

GROSS LENGTH = 6010 FT. = 1.138 MILE  
NET LENGTH = 6010 FT. = 1.138 MILE



*David L. Horton* 4/09/2025  
DAVID L. HORTON DATE  
ILLINOIS REGISTERED PROFESSIONAL ENGINEER  
No. 062-050421  
EXPIRATION DATE 11/30/25

**FEHR GRAHAM**  
ENGINEERING & ENVIRONMENTAL

APPROVED	4-10-2025	CITY OF CHILLICOTHE
<i>David O. Jones</i>		
PASSED	04-18-2025	DISTRICT FOUR ENGINEER OF LOCAL ROADS & STREETS
<i>Tony Basine M4</i>		
RELEASING FOR BID BASED ON LIMITED REVIEW	April 18 2025	REGION THREE ENGINEER STATE OF ILLINOIS DEPARTMENT OF TRANSPORTATION
<i>David L. Horton</i>		

PRINTED BY THE AUTHORITY  
OF THE STATE OF ILLINOIS

GENERAL NOTES

AVAILABILITY OF ELECTRONIC FILES

AUTO CAD AND CIVIL3D FILES OF THIS PROJECT WILL BE MADE AVAILABLE TO THE CONTRACTOR AFTER CONTRACT AWARD. IF THERE IS A CONFLICT BETWEEN THE ELECTRONIC FILES AND THE PRINTED CONTRACT PLANS AND DOCUMENTS, THE PRINTED CONTRACT PLANS AND DOCUMENTS SHALL TAKE PRECEDENCE OVER THE ELECTRONIC FILES. THE CONTRACTOR SHALL ACCEPT ALL RISK ASSOCIATED WITH USING THE ELECTRONIC FILES AND SHALL HOLD THE DEPARTMENT HARMLESS FOR ANY ERRORS OR OMISSIONS IN THE ELECTRONIC FILES AND THE DATA CONTAINED THEREIN. ERRORS OR DELAYS RESULTING FROM THE USE OF THE ELECTRONIC FILES BY THE CONTRACTOR SHALL NOT RESULT IN AN EXTENSION OF TIME FOR ANY INTERIM OR FINAL COMPLETION DATE OR SHALL NOT BE CONSIDERED CAUSE FOR ADDITIONAL COMPENSATION. THE CONTRACTOR SHALL NOT USE, SHARE, OR DISTRIBUTE THESE ELECTRONIC FILES EXCEPT FOR THE PURPOSE OF CONSTRUCTING THIS CONTRACT. ANY CLAIMS BY THIRD PARTIES DUE TO USE OR ERRORS SHALL BE THE SOLE RESPONSIBILITY OF THE CONTRACTOR. THE CONTRACTOR SHALL INCLUDE THIS DISCLAIMER WITH THE TRANSFER OF THESE ELECTRONIC FILES TO ANY OTHER PARTIES AND SHALL INCLUDE APPROPRIATE LANGUAGE BINDING THEM TO SIMILAR RESPONSIBILITIES.

ENVIRONMENTAL REVIEWS AND EXCAVATION

NO EXCAVATION IS ANTICIPATED IN THIS PROJECT. ANY EARTH EXCAVATION WILL BE SUBJECT TO ENVIRONMENTAL REVIEWS IN ACCORDANCE WITH IDOT REQUIREMENTS.

PRIOR TO THE USE OF ANY PROPOSED BORROW AREAS, USE AREAS (TEMPORARY ACCESS ROADS, DETOURS, RUN-AROUNDS, ETC.) AND/OR WASTE AREAS, THE CONTRACTOR SHALL FILE THE REQUIRED ENVIRONMENTAL RESOURCE REQUEST SURVEYS ACCORDING TO SECTION 107.22 OF THE STANDARD SPECIFICATIONS. THESE SURVEYS ARE REQUIRED IN ORDER FOR THE DEPARTMENT TO CONDUCT CULTURAL AND BIOLOGICAL RESOURCE SURVEYS FOR THE PROPOSED SITE.

THE REQUIRED ENVIRONMENTAL RESOURCE DOCUMENTATION SHALL INCLUDE THE FOLLOWING:

- BDE FORM 2289 (BORROW SITE REVIEW)
- BDE FORM 2290 (WASTE/USE AREA REVIEW)
- A LOCATION MAP SHOWING THE SIZE LIMITS AND LOCATION OF THE USE AREA
- COLOR PHOTOGRAPHS DEPICTING THE USE AREA
- BORROW AREA ENTRY AGREEMENT FORM – D4 PI0101

PRIOR TO ANY WASTE MATERIALS BEING REMOVED FROM THE CONSTRUCTION SITE THE REQUIRED ENVIRONMENTAL RESOURCE SURVEYS SHALL BE OBTAINED AND FILED BY THE CONTRACTOR. EXCESS WASTE PRODUCTS REMOVED FROM THE CONSTRUCTION SITE SHALL BE DISPOSED OF AS REQUIRED IN SECTION 202.03 OF THE STANDARD SPECIFICATIONS.

ANY PROTRUDING METAL BARS SHALL BE REMOVED PRIOR TO THE DISPOSAL OF BROKEN CONCRETE AT APPROVED DISPOSAL SITES.

PLEASE NOTE THAT A MINIMUM OF FOUR WEEKS SHALL BE ALLOWED FOR THE DISTRICT TO OBTAIN THE REQUIRED WASTE SITE ENVIRONMENTAL CLEARANCES AND SIX WEEKS FOR THE REQUIRED BORROW SITE ENVIRONMENTAL CLEARANCES.

AGGREGATE FOR DRIVEWAY REPLACEMENT

THE MATERIAL USED FOR CONSTRUCTION OF PERMANENT AGGREGATE DRIVEWAYS SHALL BE GRAVEL OR CRUSHED STONE, AS DIRECTED BY THE ENGINEER, TO REPLACE IN KIND THE EXISTING AGGREGATE DRIVEWAYS. NO ADDITIONAL COMPENSATION SHALL BE PROVIDED FOR THIS REQUIREMENT BUT SHALL BE CONSIDERED AS INCLUDED IN THE COST OF THE PAY ITEM FOR THE AGGREGATE AS SPECIFIED ON THE PLANS.

HOT-MIX ASPHALT MIXTURE REQUIREMENTS

THE FOLLOWING MIXTURE REQUIREMENTS ARE APPLICABLE FOR THIS PROJECT:

LOCATION:	CLOVERDALE ROAD
MIXTURE USE(S):	SURFACE
AC/PG:	PG 70-22
DESIGN AIR VOIDS:	4.0% @ N=50
MIXTURE COMPOSITION: (GRADATION MIXTURE)	IL 9.5
QUALITY MANAGEMENT:	QC/QA
FRICTION AGGREGATE:	MIXTURE C
MATERIAL TRANSFER DEVICE:	NO

NOTES:

- INDIVIDUAL LIFT THICKNESSES WILL BE NO LESS THAN THREE (3) TIMES NOMINAL MAXIMUM AGGREGATE SIZE AND NO MORE THAN FIVE (5) TIMES NOMINAL AGGREGATE MAXIMUM SIZE, UNLESS OTHERWISE APPROVED BY THE ENGINEER.
- FOR DESIGN PURPOSES, MIXTURE WEIGHT FOR ALL MIXES IS DETERMINED TO BE 112.0 LB/SQ. YARD/IN., UNLESS OTHERWISE NOTED.
- SUBLOT SIZES FOR PFP AND QCP MIXES WILL BE 1,000 TONS, UNLESS OTHERWISE AGREED TO BY THE ENGINEER AND THE PAVING CONTRACTOR.

BITUMINOUS MATERIALS (TACK COAT) RATES

SURFACE TYPE	RESIDUAL RATES
MILLED (HMA OR PCC)	0.08 LBS/SF
EXISTING PAVEMENT	0.08 LBS/SF
FOG COAT ( BETWEEN LIFTS)	0.08 LBS/SF

PAVING SURFACE COURSE

CONTINUOUS PAVING OPERATIONS ON THE MAIN ROADWAY SHALL BE MAINTAINED AT ALL TIMES DURING THE CONSTRUCTION OF THE HOT-MIX ASPHALT SURFACE. NO INTERRUPTIONS FOR SIDE ROADS, ENTRANCES, ETC. WILL BE ALLOWED.

UTILITIES

THE LOCATION, SIZE, AND TYPE OF MATERIAL OF EXISTING UNDERGROUND AND/OR ABOVE- GROUND UTILITIES INDICATED ON THE PLANS ARE NOT REPRESENTED AS BEING ACCURATE, SUFFICIENT, OR COMPLETE. NEITHER THE OWNER NOR THE ENGINEER ASSUMES ANY RESPONSIBILITY WHATSOEVER WITH RESPECT TO THE ACCURACY, COMPLETENESS, OR SUFFICIENCY OF THE INFORMATION. THERE IS NO GUARANTEE EITHER EXPRESSED OR IMPLIED, THAT THE LOCATIONS, SIZE, AND TYPE OF MATERIAL OF EXISTING UNDERGROUND UTILITIES INDICATED ARE REPRESENTATIVE OF THOSE TO BE ENCOUNTERED IN CONSTRUCTION. IT SHALL BE THE CONTRACTOR'S RESPONSIBILITY TO DETERMINE THE ACTUAL UNDERGROUND UTILITIES PRIOR TO CONSTRUCTION. THE CONTRACTOR SHALL NOTIFY THE UTILITY COMPANIES OF HIS OPERATIONAL PLANS AND SHALL OBTAIN FROM THE RESPECTIVE UTILITY COMPANIES DETAILED INFORMATION AND ASSISTANCE RELATIVE TO THE LOCATION OF THEIR FACILITIES AND THE WORKING SCHEDULE OF THE COMPANIES FOR REMOVAL OR ADJUSTMENT WHERE REQUIRED. IN THE EVENT AN UNEXPECTED UTILITY INTERFERENCE IS ENCOUNTERED DURING CONSTRUCTION, THE CONTRACTOR SHALL IMMEDIATELY NOTIFY THE UTILITY COMPANY OF JURISDICTION. THE OWNER'S REPRESENTATIVE AND/OR THE RESIDENT ENGINEER SHALL ALSO BE IMMEDIATELY NOTIFIED. ANY DAMAGE TO SUCH MAINS AND SERVICES SHALL BE RESTORED TO SERVICE AT ONCE AND PAID FOR BY THE CONTRACTOR AT NO ADDITIONAL COST TO THE CONTRACT.

NOTICE

THE CONTRACTOR SHALL NOTIFY THE CHILLICOTHE PUBLIC WORKS SUPERINTENDENT, THE CHILLICOTHE POLICE, AND THE CHILLICOTHE FIRE DEPARTMENT 48 HOURS PRIOR TO ANY STREET CLOSURES.

MONUMENTS

WHERE SECTION, SUBSECTION, SUBDIVISION OR PROPERTY MONUMENTS ARE ENCOUNTERED, THE ENGINEER SHALL BE NOTIFIED BEFORE ANY SUCH MONUMENTS ARE REMOVED. THE CONTRACTOR SHALL PROTECT AND CAREFULLY PRESERVE ALL PROPERTY MARKERS AND MONUMENTS UNTIL THE OWNER AND AUTHORIZED SURVEYOR OR AGENT HAS WITNESSED OR OTHERWISE REFERENCED THEIR LOCATIONS.

STANDARDS

ANY REFERENCE TO A STANDARD IN THE PLANS SHALL BE INTERPRETED TO MEAN THE LATEST EDITION OR THE COPY OF THE STANDARD INCLUDED IN THE PLANS.

DRAINAGE

WHEN, DURING CONSTRUCTION OPERATIONS, LOOSE MATERIAL IS DEPOSITED IN DRAINAGE STRUCTURES AND THE FLOW OF WATER IS OBSTRUCTED, IT SHALL BE REMOVED AT THE CLOSE OF EACH WORKING DAY AT THE CONCLUSION OF CONSTRUCTION OPERATIONS. ALL DRAINAGE STRUCTURES (NEW AND EXISTING) SHALL BE FREE FROM ALL DIRT AND DEBRIS. THIS WORK SILL NOT BE PAID FOR SEPARATELY BUT SHALL BE CONSIDERED INCLUDED IN THE CONTRACT.

ELEVATIONS

THE ELEVATIONS SHOWN ON PLAN SHEETS ARE FINISHED GRADES OF PROPOSED BITUMINOUS SURFACE COURSE UNLESS OTHERWISE INDICATED. THIS NOTE DOES NOT APPLY TO CROSS SECTION SHEETS.

CONSECUTIVE SIDE STREET (ROAD) CLOSURE -PROHIBITED

- NO TWO CONSECUTIVE SIDE STREETS (ROADS) MAY BE CLOSED AT THE SAME TIME DURING CONSTRUCTION. THE CONTRACTOR MUST ALTERNATE STREETS (ROADS).

AGGREGATE WEDGE SHOULDER, AS DIRECTED

AGGREGATE WEDGE SHOULDER SHALL BE PLACED WHERE DIRECTED BY THE ENGINEER. NO EXCAVATION WILL BE ALLOWED. ESTIMATED QUANTITY ASSUMES 1" DEEP AT EDGE OF PAVEMENT, TAPERED DOWN TO 0", 2-FEET FROM EDGE OF PAVEMENT.

INDEX OF SHEETS

1	COVER SHEET
2	INDEX OF SHEETS, LIST OF STANDARDS, COMMITMENTS AND GENERAL NOTES
3	SUMMARY OF QUANTITIES
4-8	TYPICAL SECTIONS
9-19	REMOVAL PLAN AND PROFILE
20-30	PAVEMENT MARKING PLANS
31-33	DISTRICT 4 BUTT JOINT STANDARD

COMMITMENTS

COMMITMENTS ARE NOT TO BE ALTERED WITHOUT THE WRITTEN APPROVAL OF ALL PARTIES TO WHICH THE COMMITMENT WAS MADE.

- ACCESS SHALL BE ALLOWED TO THE WATER TOWER. AT ALL TIMES

LIST OF STANDARDS

000001-08	STANDARD SYMBOLS, ABBREVIATIONS, AND PATTERNS
001006	DECIMAL OF AN INCH AND OF A FOOT
701006-05	OFF -RD OPERATIONS 2L 2W 15' TO 24" FROM PAVEMENT EDGE
701301-04	LANE CLOSURE, 2L, 2W, SHORT TIME OPERATIONS
701311-03	LANE CLOSURE, 2L, 2W MOVING OPERATIONS - DAY ONLY
701501-06	URBAN LANE CLOSURE, 2L, 2W UNDIVIDED
701901-10	TRAFFIC CONTROL DEVICES
780001-05	TYPICAL PAVEMENT MARKINGS

CITY OF CHILLICOTHE

CLOVERDALE ROAD – INDEX OF SHEETS,  
LIST OF STANDARDS, COMMITMENTS AND GENERAL NOTES

SCALE: \_\_\_\_\_ SHEET \_\_ OF \_\_ SHEETS STA. \_\_\_\_\_ TO STA. \_\_\_\_\_

F.A.U RTE	SECTION	COUNTY	TOTAL SHEETS	SHEET NO.
6552	24-00044-00-RS	PEORIA	33	2
CONTRACT NO. 89869				
ILLINOIS FED. AID PROJECT				
Long Section Number				

USER NAME = FGA	DESIGNED - MEC	REVISED - _____
	DRAWN - KRS	REVISED - _____
PLOT SCALE = 2.0000" = 1 in.	CHECKED - DLH	REVISED - _____
PLOT DATE = 4/10/2025	DATE - 04/09/2025	REVISED - _____

SUMMARY OF QUANTITIES				FUNDING CATEGORY \ CONSTRUCTION TYPE CODE
SPECIALTY ITEM	PAY CODE	PAY ITEM	UNIT	TOTAL QUANTITY STU \ 005
	40600295	POLYMERIZED BITUMINOUS MATERIALS (TACK COAT)	POUND	14,736
	40600990	TEMPORARY RAMP	SQ.YD.	108
	40604150	POLYMERIZED HOT-MIX ASPHALT SURFACE COURSE, IL-9.5, MIX C, N50	TON	2,293
	44000157	HOT-MIX ASPHALT SURFACE REMOVAL, 2"	SQ YD	20,467
	48102100	AGGREGATE WEDGE SHOULDER, TYPE B	TON	724
	67100100	MOBILIZATION	LSUM	1
*	78001100	PAINT PAVEMENT MARKING - LETTERS AND SYMBOLS	SQ FT	9
*	78001110	PAINT PAVEMENT MARKING - LINE 4"	FOOT	12,480
*	78001180	PAINT PAVEMENT MARKING - LINE 24"	FOOT	263
	X7010216	TRAFFIC CONTROL AND PROTECTION, SPECIAL	LSUM	1

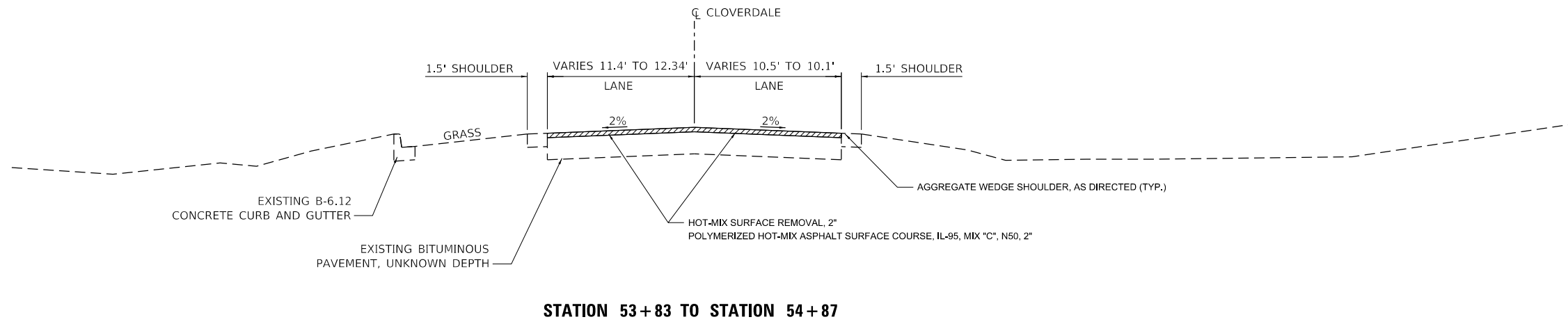
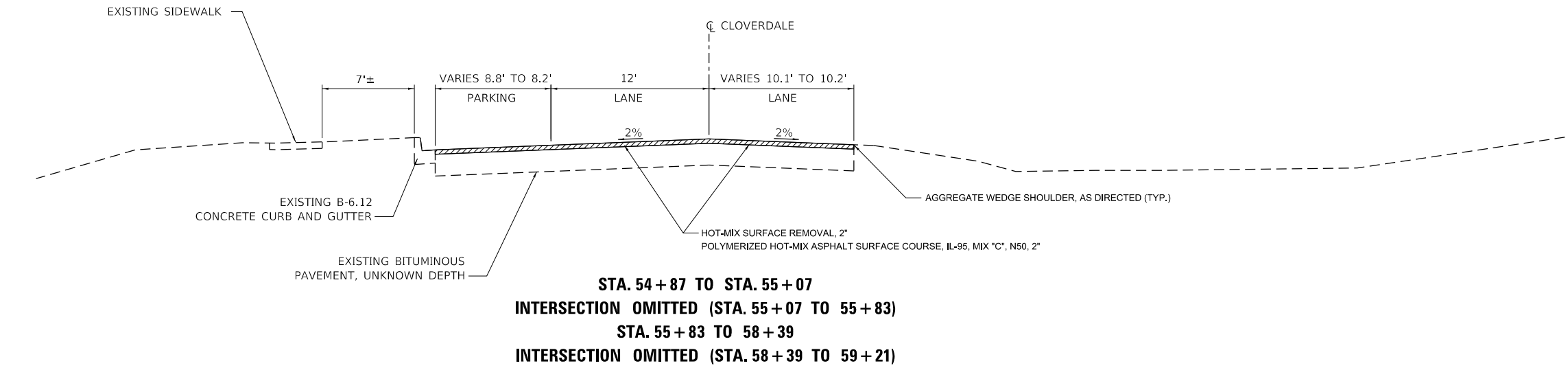

MODEL: S:\MODEL\NAMES  
FILE NAME: Typical Section.dgn

**FEHR GRAHAM**  
ENGINEERING & ENVIRONMENTAL  
ILLINOIS DESIGN FIRM NO. 184-003525

ILLINOIS    IOWA    WISCONSIN

USER NAME = FGA	DESIGNED - MEC	REVISED -
	DRAWN - KRS	REVISED -
PLOT SCALE = 10,0000' / 1" =	CHECKED - DLH	REVISED -
PLOT DATE = 4/22/2025	DATE - 04/09/2025	REVISED -

CITY OF CHILLICOTHE

CLOVERDALE ROAD  
TYPICAL SECTIONS

SCALE: N.T.S.    SHEET    OF    SHEETS    STA.    TO STA.

F.A.U. RTE.	SECTION	COUNTY	TOTAL SHEETS	SHEET NO.
6552	24-00044-00-RS	PEORIA	33	4
CONTRACT NO. 89869				

Long Section Number



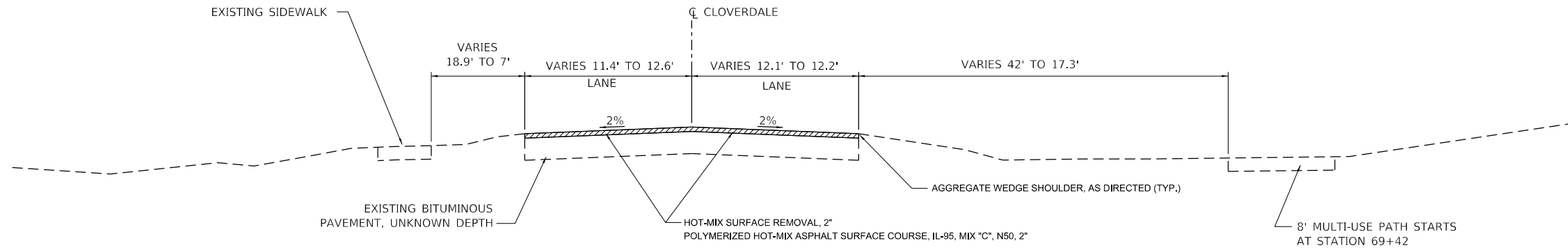

**STA. 60+42 TO STA. 62+00**  
**INTERSECTION OMITTED (STA. 62+00 TO 62+68)**  
**STA. 62+68 TO STA. 65+04**  
**INTERSECTION OMITTED (STA. 65+04 TO 65+68)**  
**STA. 65+68 TO STA. 68+21**  
**INTERSECTION OMITTED (STA. 68+21 TO 68+88)**  
**STA. 68+88 TO STA. 80+08**  
**INTERSECTION OMITTED (STA. 80+08 TO STA. 81+00)**

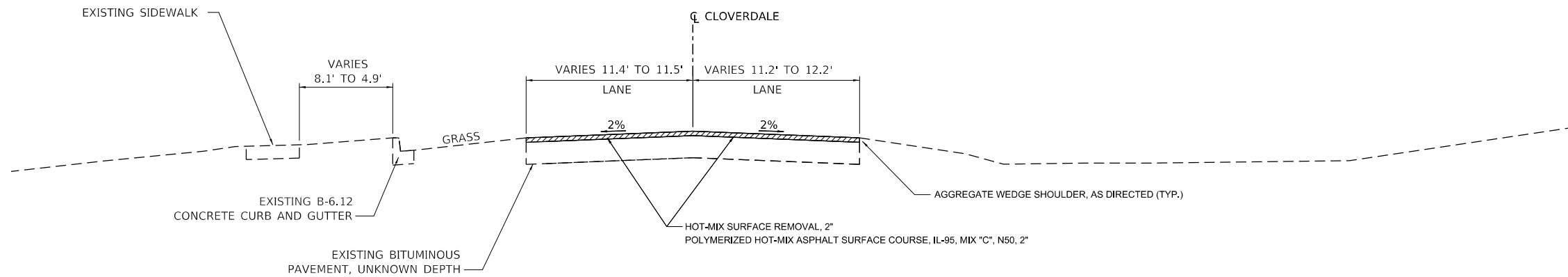

**STATION 59+21 TO STATION 60+42**

MODEL: MODEL NAMES  
FILE NAME: Typical Section.dgn

**FEHR GRAHAM**  
ENGINEERING & ENVIRONMENTAL  
ILLINOIS DESIGN FIRM NO. 184-003525

ILLINOIS    IOWA    WISCONSIN

USER NAME = FGA	DESIGNED - MEC	REVISED -
	DRAWN - KRS	REVISED -
PLOT SCALE = 10,0000' / 1" =	CHECKED - DLH	REVISED -
PLOT DATE = 4/22/2025	DATE - 04/09/2025	REVISED -

CITY OF CHILLICOTHE

CLOVERDALE ROAD  
TYPICAL SECTIONS

SCALE: N.T.S	SHEET	OF	SHEETS	STA.	TO STA.
--------------	-------	----	--------	------	---------

F.A.U. RTE.	SECTION	COUNTY	TOTAL SHEETS	SHEET NO.
6552	24-00044-00-RS	PEORIA	33	5
		CONTRACT NO. 89869		
ILLINOIS		FED. AID PROJECT		
Long Section Number				

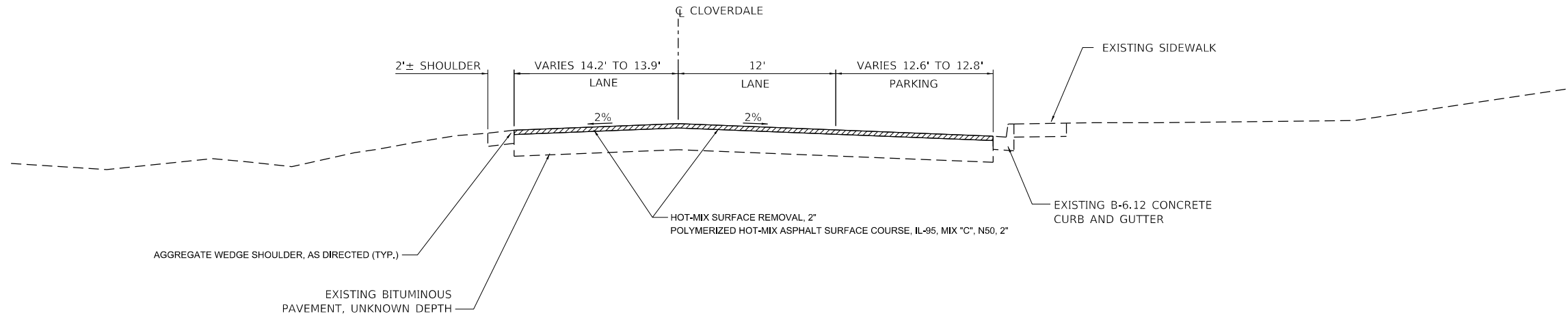

STATION 94 + 63 TO STATION 96 + 70

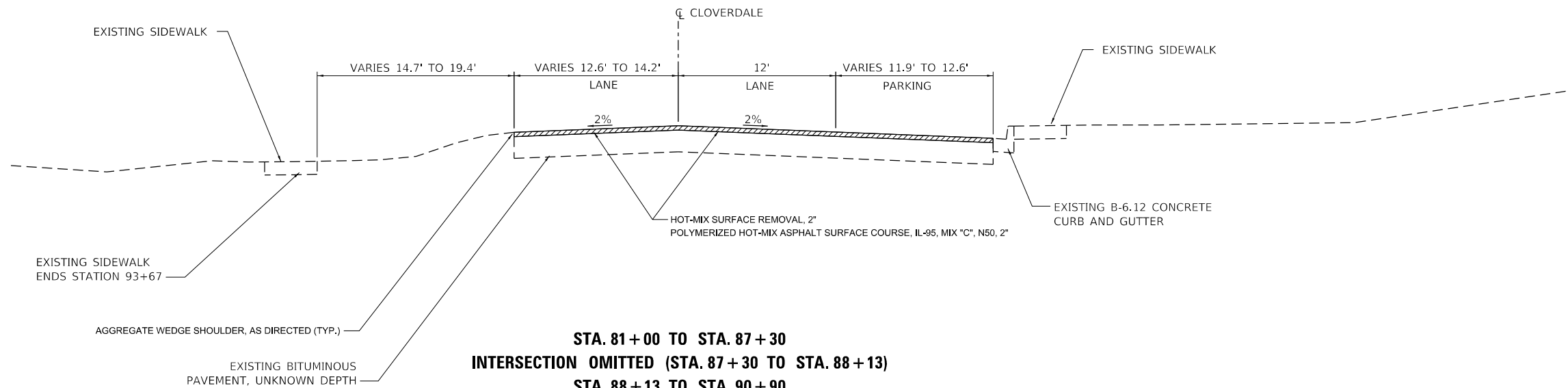

STA. 81 + 00 TO STA. 87 + 30  
INTERSECTION OMITTED (STA. 87 + 30 TO STA. 88 + 13)  
STA. 88 + 13 TO STA. 90 + 90  
INTERSECTION OMITTED (STA. 90 + 90 TO STA. 91 + 56)  
STA. 91 + 56 TO STA. 93 + 38  
INTERSECTION OMITTED (STA. 93 + 38 TO STA. 94 + 63)

MODEL: MODEL NAMES  
FILE NAME: Typical Section.dgn

**FEHR GRAHAM**  
ENGINEERING & ENVIRONMENTAL  
ILLINOIS DESIGN FIRM NO. 184-003525

ILLINOIS    IOWA    WISCONSIN

USER NAME = FGA	DESIGNED - MEC	REVISED -
	DRAWN - KRS	REVISED -
PLOT SCALE = 10,0000' / 1" =	CHECKED - DLH	REVISED -
PLOT DATE = 4/22/2025	DATE - 04/09/2025	REVISED -

CITY OF CHILLICOTHE
---------------------

CLOVERDALE ROAD TYPICAL SECTIONS			
SCALE: N.T.S	SHEET	OF SHEETS	STA. TO STA.

F.A.U. RTE.	SECTION	COUNTY	TOTAL SHEETS	SHEET NO.
6552	24-00044-00-RS	PEORIA	33	6
		CONTRACT NO. 89869		
ILLINOIS		FED. AID PROJECT		

Long Section Number

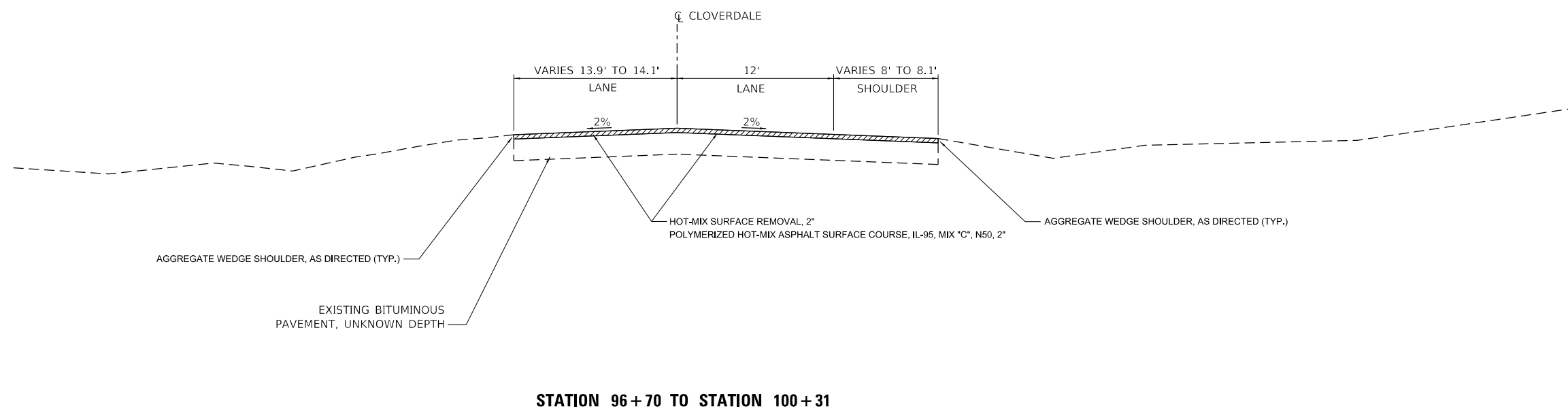

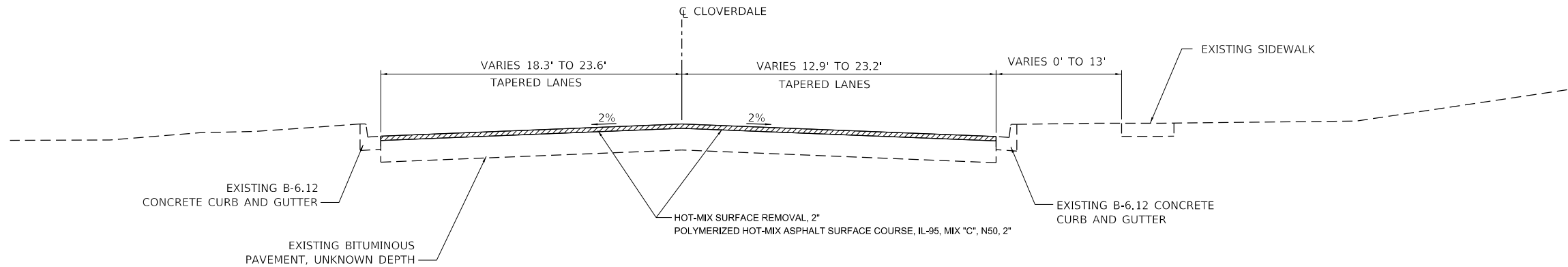

STA. 113+06 TO STA. 113+92.45

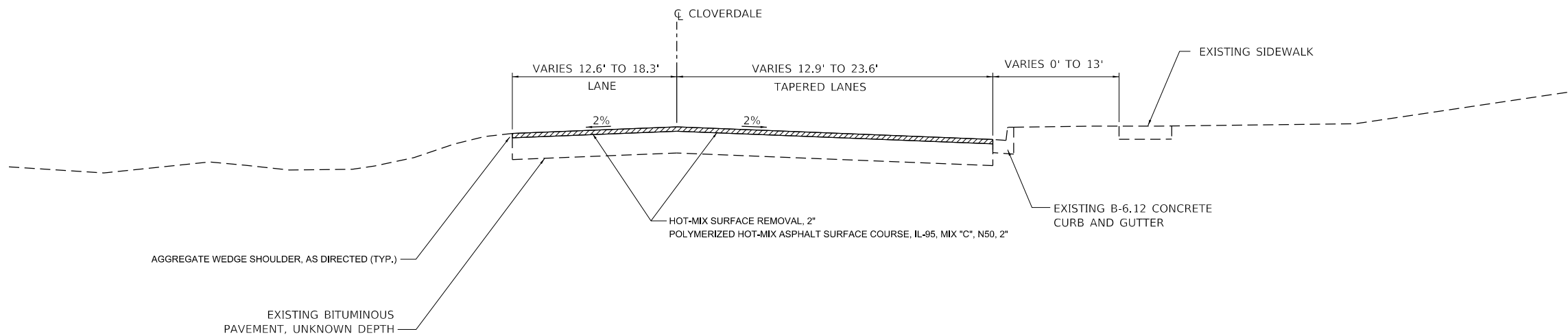

DRIVEWAY OMITTED (STA. 110+42 TO STA. 111+68)  
STA. 111+68 TO STA. 113+06

MODEL: S:\MODEL\NAMES  
FILE NAME: Typical Section.dgn

**FEHR GRAHAM**

ENGINEERING & ENVIRONMENTAL

ILLINOIS DESIGN FIRM NO. 184-003525

ILLINOIS    IOWA    WISCONSIN

USER NAME = FGA	DESIGNED - MEC	REVISED -
	DRAWN - KRS	REVISED -
PLOT SCALE = 10,0000' / 1"	CHECKED - DLH	REVISED -
PLOT DATE = 4/22/2025	DATE - 04/09/2025	REVISED -

CITY OF CHILLICOTHE

CLOVERDALE ROAD  
TYPICAL SECTIONS

SCALE: N.T.S    SHEET    OF    SHEETS    STA.    TO STA.

F.A.U. RTE.	SECTION	COUNTY	TOTAL SHEETS	SHEET NO.
6552	24-00044-00-RS	PEORIA	33	8
CONTRACT NO. 89869				

Long Section Number

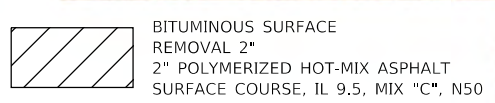

<b>PROFILE</b>	SURVEYED _____	BY _____	DATE _____
	PLOTTED _____		
	GRADES CHECKED _____		
	B.M. NOTED _____		
NOTE BOOK _____	STRUCTURE NOTATIONS CH'KD _____		
NO. _____			

[illegible]

 <b>FEHR GRAHAM</b> ENGINEERING & ENVIRONMENTAL <small>LANDS DESIGN FIRM NO. 184-003025</small> ILLINOIS    IOWA    WISCONSIN	USER NAME    = FGA	DESIGNED   -   MEC	REVISED   -	<b>CITY OF CHILLICOTHE</b>	<b>CLOVERDALE ROAD REMOVAL PLAN AND PROFILE</b>					F.A.U. RTE.	SECTION	COUNTY	TOTAL SHEETS	SHEET NO.
	PLOT SCALE    = 40,000' / in.	DRAWN       -   KRS	REVISED   -							6552	24-00044-00-RS	PEORIA	33	9
	PLOT DATE     = 4/10/2025	CHECKED   -   DLH	REVISED   -		CONTRACT NO. 89869									
	DATE           - 04/09/2025	REVISED   -	SCALE:							SHEET	OF	SHEETS	STA.	TO



PLAN	SURVEYED	BY	DATE
	PLOTTED		
NOTE BOOK	ALIGNMENT CHECKED		
	AS SHOWN		
NO.	CADD FILE NAME		

PROFILE	SURVEYED	BY	DATE
	PLOTTED		
NOTE BOOK	GRADES CHECKED		
	STRUCTURE NOTATIONS CHKD		
NO.			

MODEL: SH06LNAME\$  
FILE NAME: R1002.dgn

**FEHR GRAHAM**  
ENGINEERING & ENVIRONMENTAL  
ILLINOIS DESIGN FIRM NO. 181-003025  
ILLINOIS IOWA WISCONSIN

USER NAME	= FGA
DESIGNED	- MEC
DRAWN	- KRS
PLOT SCALE	= 40,0000 ' / in.
PLOT DATE	= 4/10/2025

DESIGNED	- MEC	REVISED	-
DRAWN	- KRS	REVISED	-
CHECKED	- DLH	REVISED	-
DATE	- 04/09/2025	REVISED	-

CITY OF CHILLICOTHE

CLOVERDALE ROAD  
REMOVAL PLAN AND PROFILE

SCALE: SHEET OF SHEETS STA. TO STA.

F.A.U. RTE.	SECTION	COUNTY	TOTAL SHEETS	SHEET NO.
6552	24-00044-00-RS	PEORIA	33	10
CONTRACT NO. 89869				
		ILLINOIS	FED. AID PROJECT	

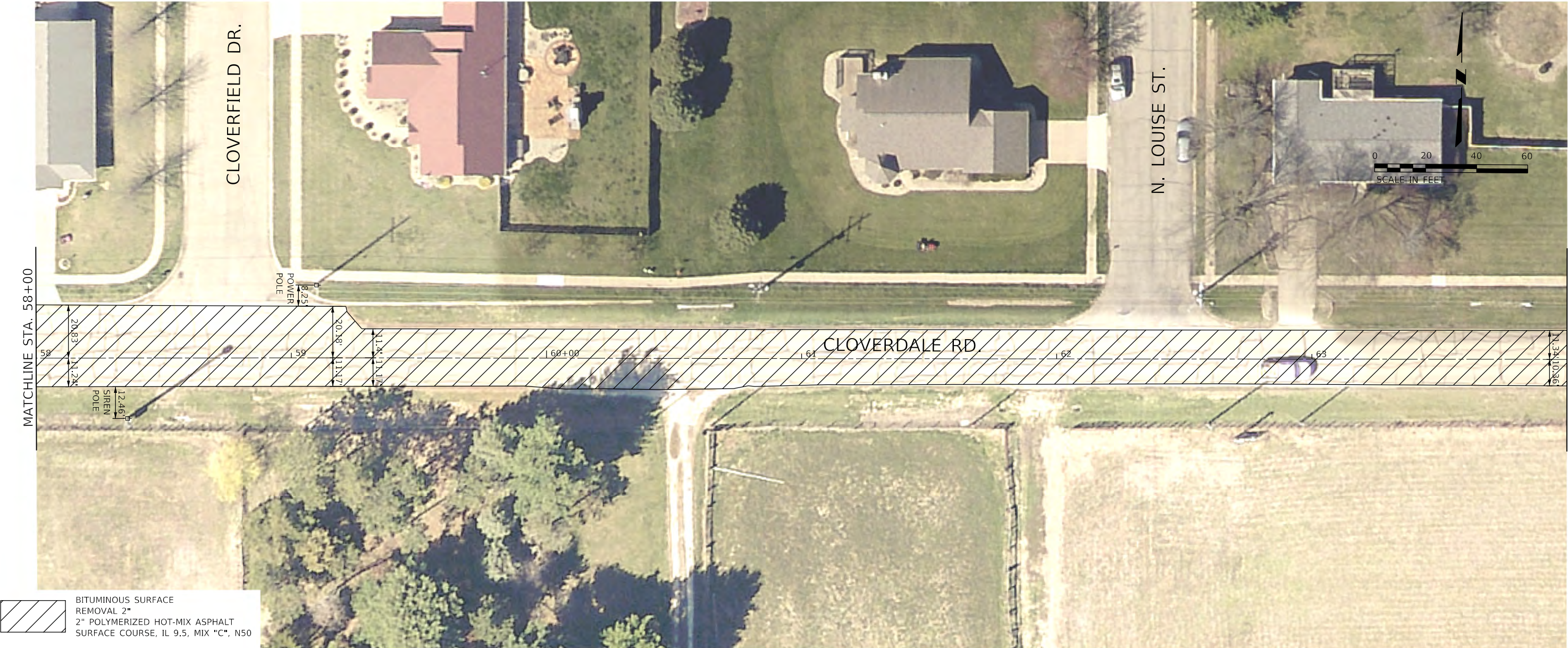
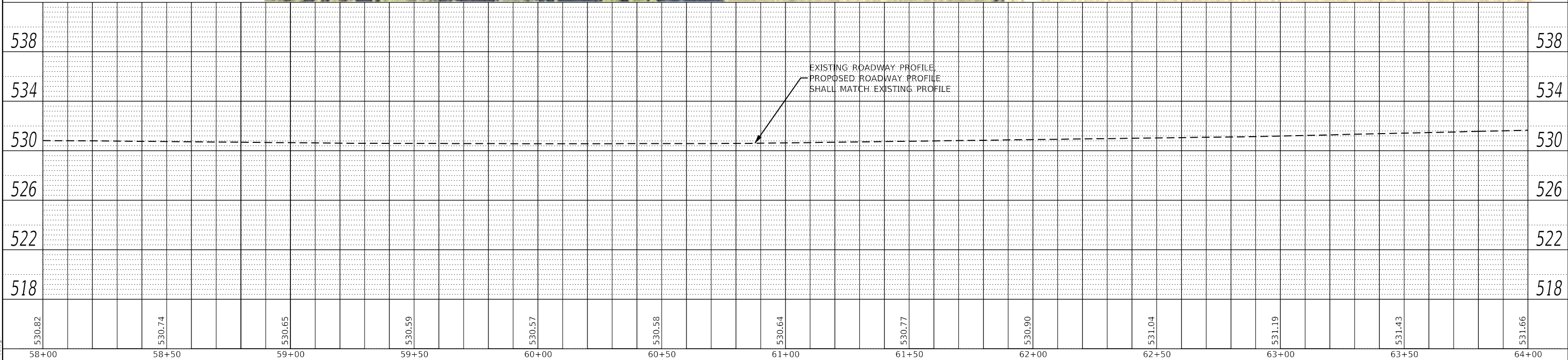

MATCHLINE STA. 58+00

MATCHLINE STA. 64+00



<b>PROFILE</b>	SURVEYED _____	BY _____	DATE _____
	PLOTTED _____		
NOTE BOOK _____	GRADES CHECKED _____		
NO. _____	B.M. NOTED _____		
	STRUCTURE NOTATIONS CHKD _____		

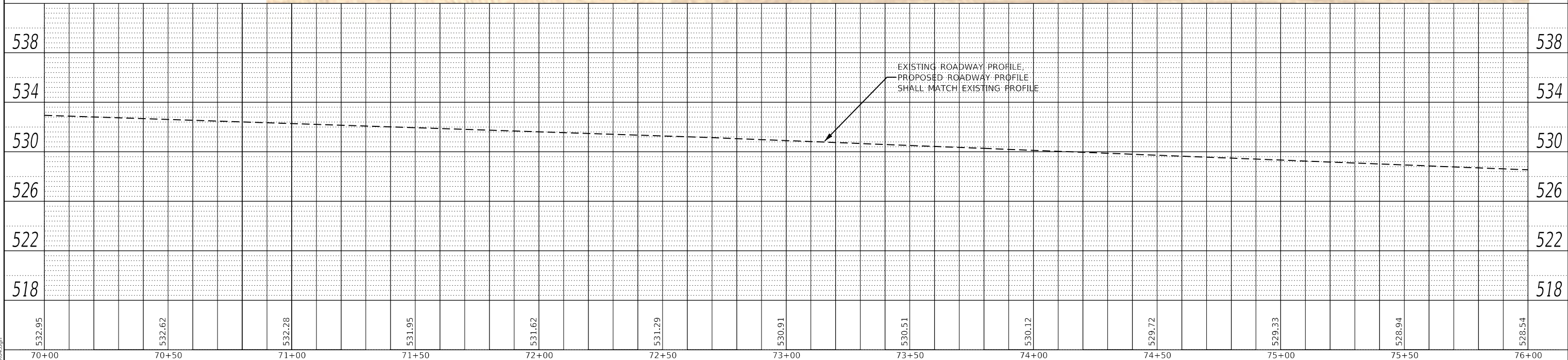
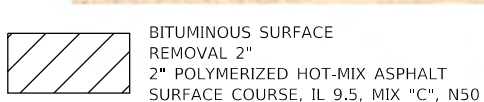
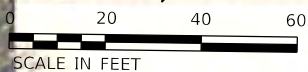
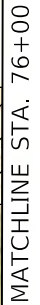

PROFILE		BY	DATE
SURVEYED _____			
PLOTTED _____			
GRADES CHECKED _____			
B.M. NOTED _____			
STRUCTURE NOTATIONS CHKD _____			

[illegible]



PROFILE		BY	DATE
NOTE BOOK NO. _____	SURVEYED _____		
	PLOTTED _____		
	GRADES CHECKED _____		
	B.M. NOTED _____		
	STRUCTURE NOTATIONS CHK'D _____		

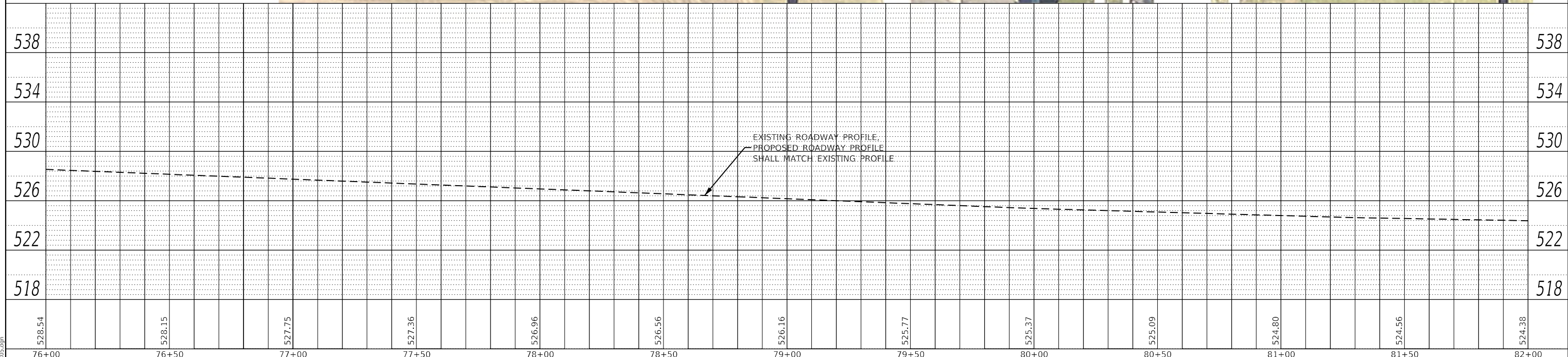

<div><div>FEHR GRAHAM</div><div>ENGINEERING &amp; ENVIRONMENTAL</div><div>ILLINOIS DESIGN FIRM NO. 184-000028</div><div>ILLINOIS IOWA WISCONSIN</div></div>	USER NAME = FGA	DESIGNED - MEC	REVISED -	CITY OF CHILLICOTHE	CLOVERDALE ROAD REMOVAL PLAN AND PROFILE			F.A.U. RTE.	SECTION	COUNTY	TOTAL SHEETS	SHEET NO.
		DRAWN - KRS	REVISED -					6552	24-00044-00-R5	PEORIA	33	13
	PLOT SCALE = 40.0000 ' / in.	CHECKED - DLH	REVISED -					CONTRACT NO. 89869				
	PLOT DATE = 4/10/2025	DATE - 04/09/2025	REVISED -		SCALE:	SHEET OF SHEETS	STA. TO STA.					
								ILLINOIS FED. AID PROJECT				



PROFILE		BY	DATE
	SURVEYED _____		
	PLOTTED _____		
NOTE BOOK	GRADES CHECKED _____		
	B.M. NOTED _____		
NO. _____	STRUCTURE NOTATIONS CHK'D _____		

**FEHR GRAHAM**  
ENGINEERING & ENVIRONMENTAL  
ILLINOIS DESIGN FIRM NO. 184-003525  
ILLINOIS IOWA WISCONSIN

USER NAME = FGA	DESIGNED - MEC	REVISED - _____
	DRAWN - KRS	REVISED - _____
PLOT SCALE = 40,0000 ' / in.	CHECKED - DLH	REVISED - _____
PLOT DATE = 4/10/2025	DATE - 04/09/2025	REVISED - _____

**CITY OF CHILLICOTHE**

## CLOVERDALE ROAD REMOVAL PLAN AND PROFILE

SCALE: _____	SHEET ____ OF ____ SHEETS	STA. _____ TO STA. _____
--------------	---------------------------	--------------------------

F.A.U. RTE.	SECTION	COUNTY	TOTAL SHEETS	SHEET NO.
6552	24-00044-00-R5	PEORIA	33	14
		CONTRACT NO. 89869		
ILLINOIS		FED. AID PROJECT		



PLAN	SURVEYED	BY	DATE
	PLOTTED		
	ALIGNMENT CHECKED		
	NOTE BOOK NO.		

PROFILE	SURVEYED	BY	DATE
	PLOTTED		
	GRADES CHECKED		
	NOTE BOOK NO.		

MODEL: SH01ELNAME'S  
FILE NAME: R01007.dgn

**FEHR GRAHAM**  
ENGINEERING & ENVIRONMENTAL  
ILLINOIS DESIGN FIRM NO. 184-003025  
ILLINOIS IOWA WISCONSIN

USER NAME = FGA	DESIGNED - MEC	REVISED -
	DRAWN - KRS	REVISED -
PLOT SCALE = 40,0000 ' / in.	CHECKED - DLH	REVISED -
PLOT DATE = 4/10/2025	DATE - 04/09/2025	REVISED -

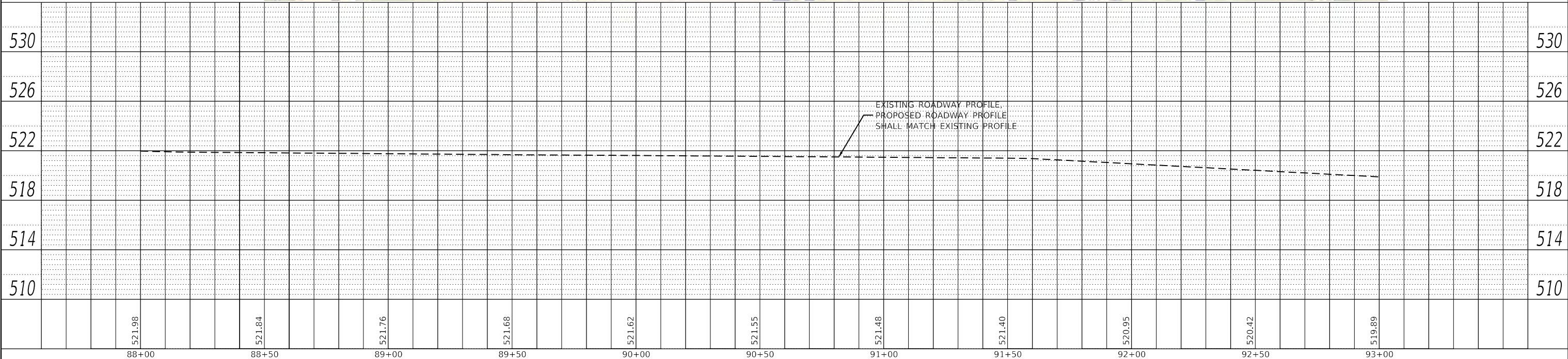
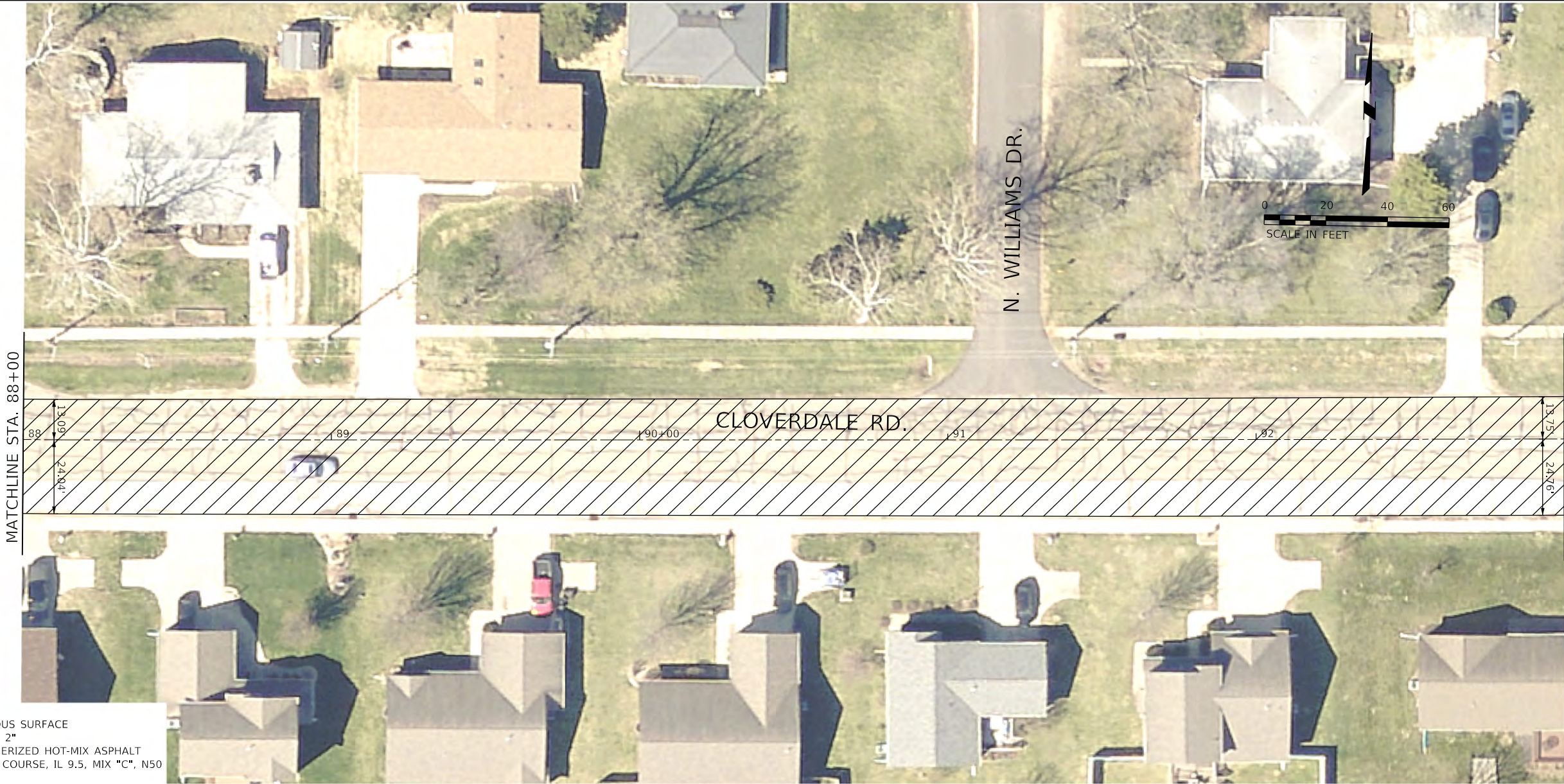

<b>FEHR GRAHAM</b> ENGINEERING & ENVIRONMENTAL <small>ILLINOIS DESIGN FIRM NO. 184-003025</small> ILLINOIS IOWA WISCONSIN	USER NAME = FGA	DESIGNED - MEC	REVISED -	CITY OF CHILLICOTHE	CLOVERDALE ROAD REMOVAL PLAN AND PROFILE	SCALE:      SHEET      OF      SHEETS      STA.      TO STA.	F.A.U. RTE. 6552	SECTION 24-00044-00-RS	COUNTY PEORIA	TOTAL SHEETS 33	SHEET NO. 15
	PLOT SCALE = 40,0000 ' / in.	CHECKED - DLH	REVISED -				CONTRACT NO. 89869				
	PLOT DATE = 4/10/2025	DATE - 04/09/2025	REVISED -								
							ILLINOIS FED. AID PROJECT				



PLAN	SURVEYED	BY	DATE
NO.	PLOTTED		
	ALIGNMENT CHECKED		
	AS SHOWN		
	CADD FILE NAME		

PROFILE	SURVEYED	BY	DATE
NO.	PLOTTED		
	GRADES CHECKED		
	STRUCTURE NOTATIONS CHKD		

MODEL: SH06LNAME'S  
FILE NAME: P1008.dgn

**FEHR GRAHAM**  
ENGINEERING & ENVIRONMENTAL  
ILLINOIS DESIGN FIRM NO. 184-003025  
ILLINOIS    IOWA    WISCONSIN

USER NAME = FGA	DESIGNED - MEC	REVISED -
	DRAWN - KRS	REVISED -
PLOT SCALE = 40,0000 ' / in.	CHECKED - DLH	REVISED -
PLOT DATE = 4/10/2025	DATE - 04/09/2025	REVISED -

DESIGNED - MEC	REVISED -
DRAWN - KRS	REVISED -
CHECKED - DLH	REVISED -
DATE - 04/09/2025	REVISED -

CITY OF CHILLICOTHE

CLOVERDALE ROAD  
REMOVAL PLAN AND PROFILE

SCALE:      SHEET      OF      SHEETS      STA.      TO STA.

F.A.U. RTE.	SECTION	COUNTY	TOTAL SHEETS	SHEET NO.
6552	24-00044-00-RS	PEORIA	33	16
CONTRACT NO. 89869				
		ILLINOIS	FED. AID PROJECT	

MATCHLINE STA. 93+00

MATCHLINE STA. 99+00

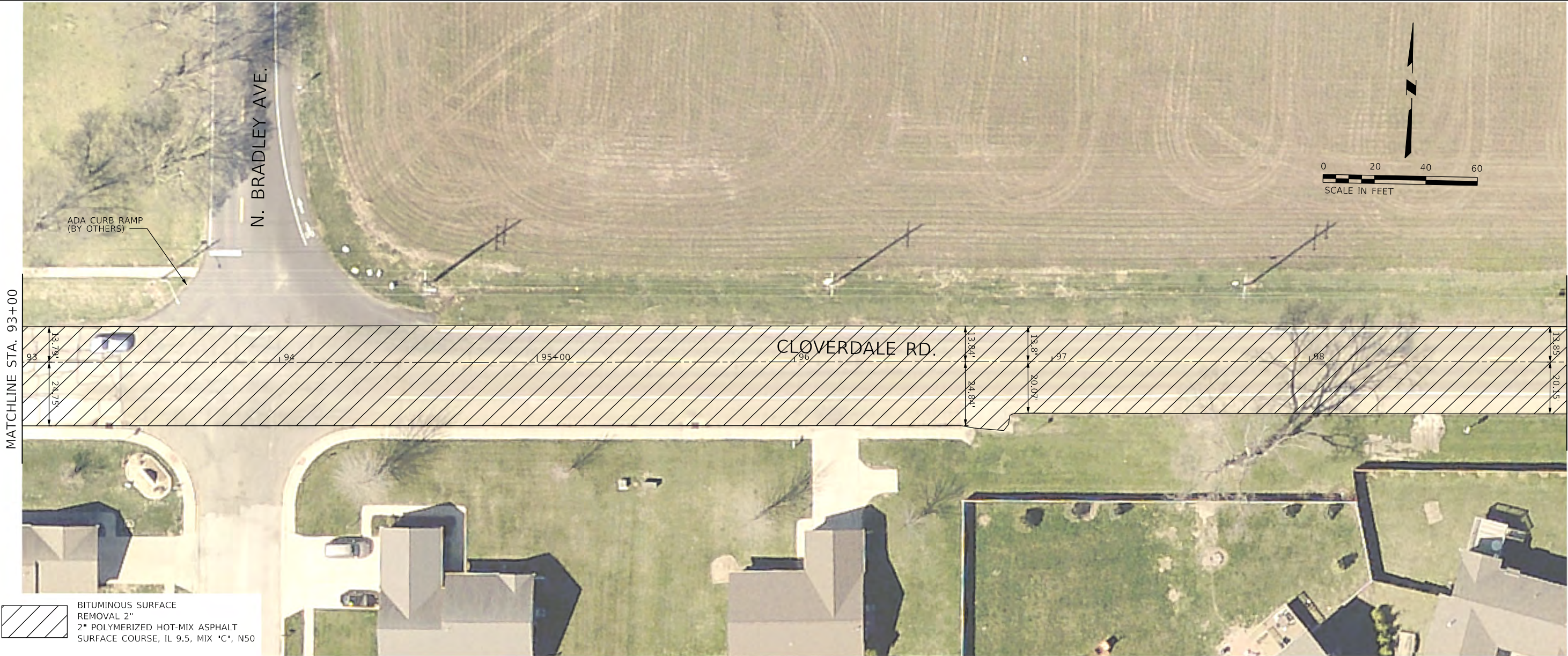

BITUMINOUS SURFACE  
REMOVAL 2"  
2" POLYMERIZED HOT-MIX ASPHALT  
SURFACE COURSE, IL 9.5, MIX "C", N50

EXISTING ROADWAY PROFILE  
PROPOSED ROADWAY PROFILE  
SHALL MATCH EXISTING PROFILE



PLAN	SURVEYED	BY	DATE
NOTE BOOK NO.	PLOTTED		
	ALIGNMENT CHECKED		
	AS-BUILT FILE NAME		
	CADD FILE NAME		

PROFILE	SURVEYED	BY	DATE
NOTE BOOK NO.	PLOTTED		
	GRADES CHECKED		
	STRUCTURE NOTATIONS CHKD		

MODEL: SH01ELNAME'S  
FILE NAME: P10003.dgn

**FEHR GRAHAM**  
ENGINEERING & ENVIRONMENTAL  
ILLINOIS DESIGN FIRM NO. 184-003025  
ILLINOIS IOWA WISCONSIN

USER NAME = FGA	DESIGNED - MEC	REVISED -
	DRAWN - KRS	REVISED -
PLOT SCALE = 40,0000 ' / in.	CHECKED - DLH	REVISED -
PLOT DATE = 4/10/2025	DATE - 04/09/2025	REVISED -

CITY OF CHILLICOTHE

CLOVERDALE ROAD  
REMOVAL PLAN AND PROFILE

SCALE: SHEET OF SHEETS STA. TO STA.

F.A.U. RTE.	SECTION	COUNTY	TOTAL SHEETS	SHEET NO.
6552	24-00044-00-RS	PEORIA	33	17
CONTRACT NO. 89869				
		ILLINOIS	FED. AID PROJECT	

MATCHLINE STA. 99+00

MATCHLINE STA. 105+00

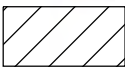
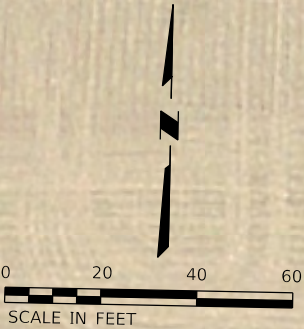

BITUMINOUS SURFACE  
REMOVAL 2"  
2" POLYMERIZED HOT-MIX ASPHALT  
SURFACE COURSE, IL 9.5, MIX "C", N50

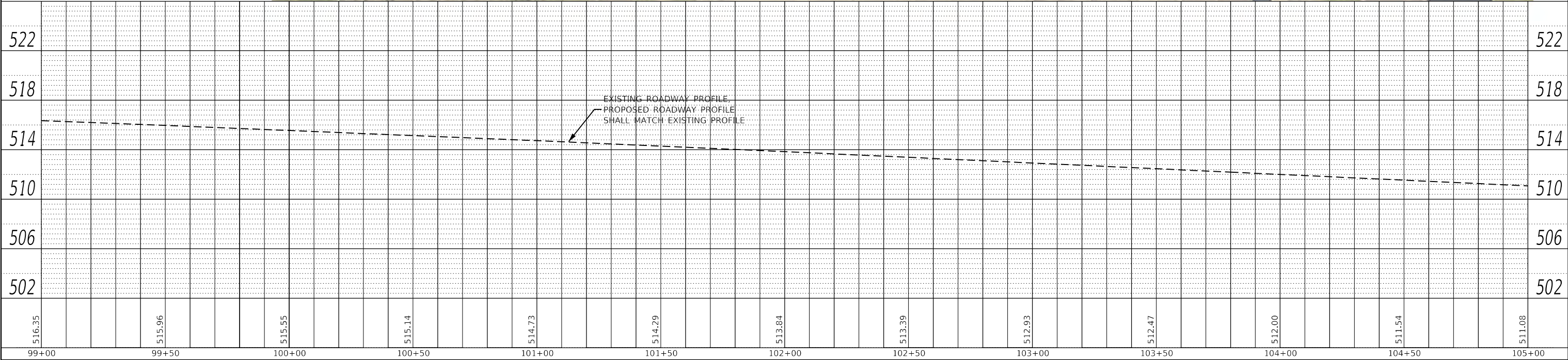



PLAN	SURVEYED PLOTTED	BY	DATE
NOTE BOOK NO.	ALIGNMENT CHECKED DATE	CADD FILE NAME	

PROFILE	SURVEYED PLOTTED	BY	DATE
NOTE BOOK NO.	GRADES CHECKED DATE	STRUCTURE NOTATIONS CHWD	

MODEL: SH06LNAME\$  
FILE NAME: R01010.dgn

**FEHR GRAHAM**  
ENGINEERING & ENVIRONMENTAL  
ILLINOIS IOWA WISCONSIN

USER NAME = FGA	DESIGNED - MEC	REVISED -
	DRAWN - KRS	REVISED -
PLOT SCALE = 40,0000 ' / in.	CHECKED - DLH	REVISED -
PLOT DATE = 4/10/2025	DATE - 04/09/2025	REVISED -

CITY OF CHILLICOTHE

CLOVERDALE ROAD  
REMOVAL PLAN AND PROFILE

SCALE: SHEET OF SHEETS STA. TO STA.

F.A.U. RTE.	SECTION	COUNTY	TOTAL SHEETS	SHEET NO.
6552	24-00044-00-RS	PEORIA	33	18
CONTRACT NO. 89869				
ILLINOIS FED. AID PROJECT				

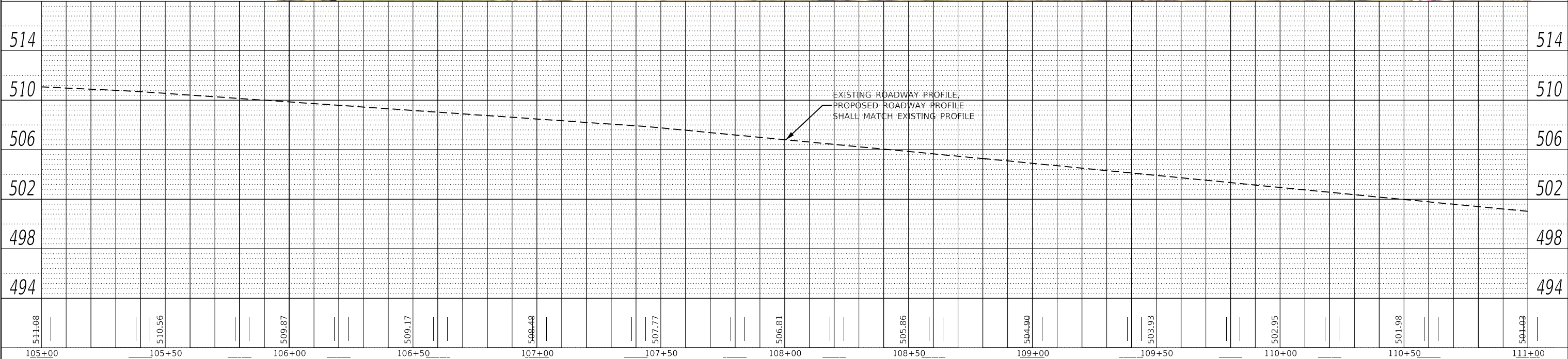

MATCHLINE STA. 105+00

MATCHLINE STA. 111+00





PLAN	SURVEYED PLOTTED ALIGNMENT CHECKED BY: _____ CADD FILE NAME	BY	DATE	
				NOTE BOOK
				NO.

PROFILE	SURVEYED PLOTTED GRADES CHECKED BY: _____ STRUCTURE NOTATION CHWD	BY	DATE	
				NOTE BOOK
				NO.

MODEL: SH06LNAME\$  
FILE NAME: R04R11.dgn

**FEHR GRAHAM**  
ENGINEERING & ENVIRONMENTAL  
ILLINOIS DESIGN FIRM NO. 184-033025  
ILLINOIS    IOWA    WISCONSIN

USER NAME = FGA	DESIGNED - MEC	REVISED -
	DRAWN - KRS	REVISED -
PLOT SCALE = 40,0000 ' / in.	CHECKED - DLH	REVISED -
PLOT DATE = 4/10/2025	DATE - 04/09/2025	REVISED -



CITY OF CHILLICOTHE

CLOVERDALE ROAD  
REMOVAL PLAN AND PROFILE

SCALE:      SHEET      OF      SHEETS      STA.      TO STA.

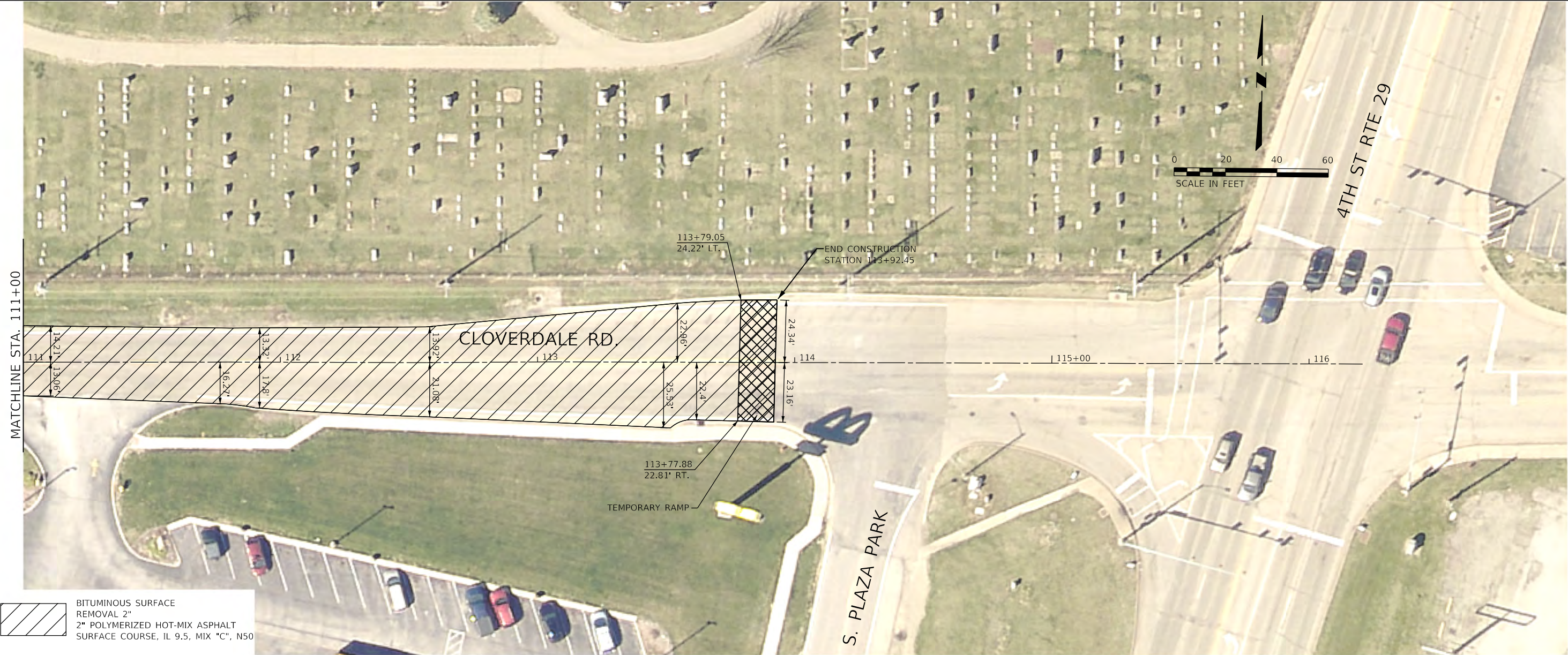
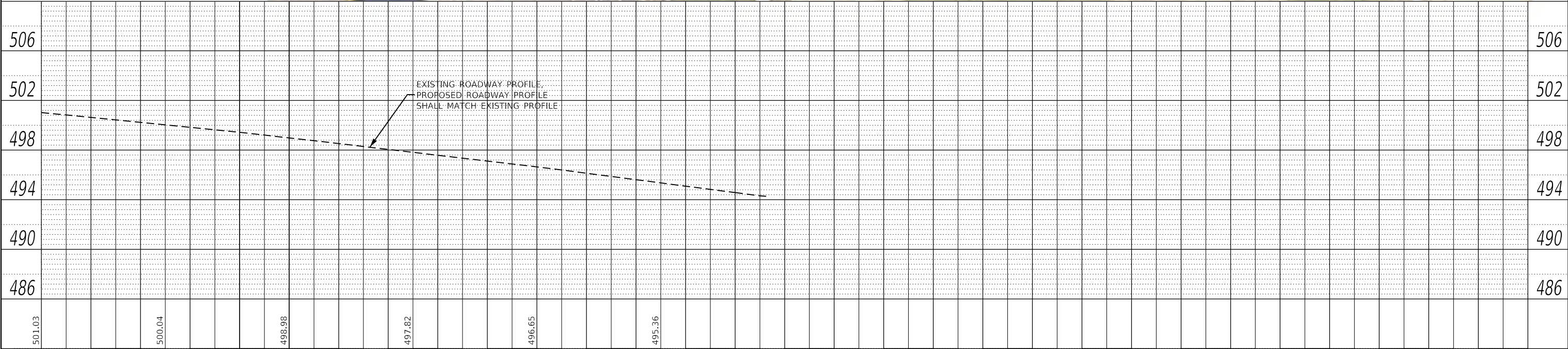
F.A.U. RTE.	SECTION	COUNTY	TOTAL SHEETS	SHEET NO.
6552	24-00044-00-RS	PEORIA	33	19
CONTRACT NO. 89869				
		ILLINOIS	FED. AID PROJECT	



 BITUMINOUS SURFACE  
REMOVAL 2"  
 2" POLYMERIZED HOT-MIX ASPHALT  
SURFACE COURSE, IL 9.5, MIX "C", N50



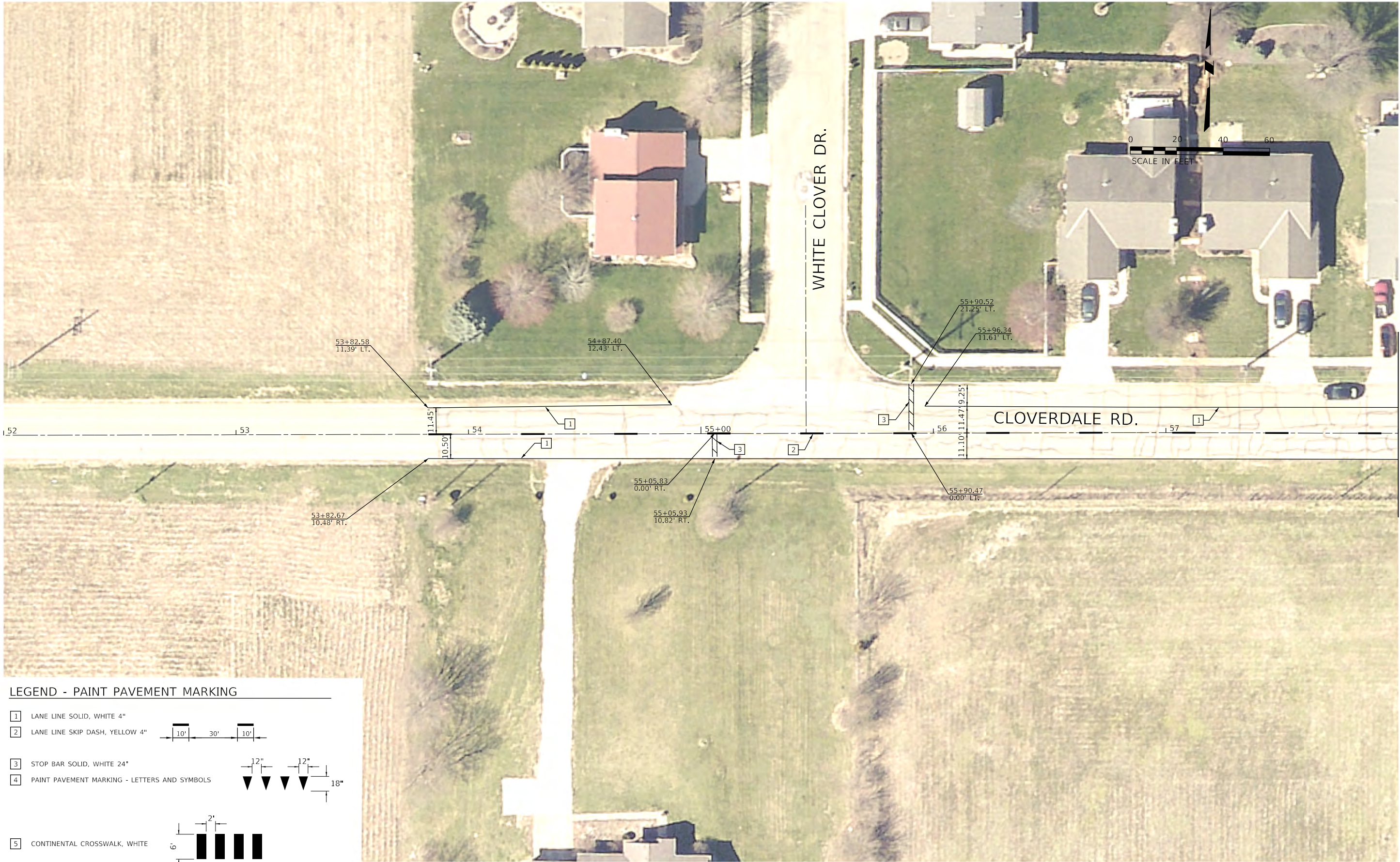

MATCHLINE STA. 58+00

LEGEND - PAINT PAVEMENT MARKING

- 1

LANE LINE SOLID, WHITE 4"
- 2

LANE LINE SKIP DASH, YELLOW 4"
- 3

STOP BAR SOLID, WHITE 24"
- 4

PAINT PAVEMENT MARKING - LETTERS AND SYMBOLS
- 5

CONTINENTAL CROSSWALK, WHITE

MODEL: SHOWNAMES  
FILE NAME: 10032501

**FEHR GRAHAM**  
ENGINEERING & ENVIRONMENTAL  
ILLINOIS DESIGN FIRM NO. 184-003025  
ILLINOIS    IOWA    WISCONSIN

USER NAME	= FGA
DESIGNED -	MEC
DRAWN -	KRS
PLOT SCALE	= 40,0000 ' / in.
PLOT DATE	= 4/10/2025

REVISED -	_____
REVISD -	_____
CHECKED -	DLH
DATE -	04/09/2025
REVISED -	_____

CITY OF CHILLICOTHE

CLOVERDALE ROAD  
PAVEMENT MARKING

SCALE: \_\_\_\_\_ SHEET \_\_\_\_ OF \_\_\_\_ SHEETS STA. \_\_\_\_\_ TO STA. \_\_\_\_\_

F.A.U RTE.	SECTION	COUNTY	TOTAL SHEETS	SHEET NO.
6552	24-00044-00-RS	PEORIA	33	20
CONTRACT NO. 89869				
ILLINOIS FED. AID PROJECT				





LEGEND - PAINT PAVEMENT MARKING

- 1 LANE LINE SOLID, WHITE 4"
- 2 LANE LINE SKIP DASH, YELLOW 4" (10' solid, 30' dash, 10' solid)
- 3 STOP BAR SOLID, WHITE 24"
- 4 PAINT PAVEMENT MARKING - LETTERS AND SYMBOLS (12" high, 18" wide)
- 5 CONTINENTAL CROSSWALK, WHITE (2' wide, 2' high)

MODEL: 3/20/2025  
FILE: 2025-03-20-2025

**FEHR GRAHAM**  
ENGINEERING & ENVIRONMENTAL  
ILLINOIS IOWA WISCONSIN

USER NAME = FGA	DESIGNED - MEC	REVISED - _____
	DRAWN - KRS	REVISED - _____
PLOT SCALE = 40,0000 ' / in.	CHECKED - DLH	REVISED - _____
PLOT DATE = 4/10/2025	DATE - 04/09/2025	REVISED - _____

CITY OF CHILLICOTHE

CLOVERDALE ROAD  
PAVEMENT MARKING

SCALE: \_\_\_\_\_ SHEET \_\_\_\_\_ OF \_\_\_\_\_ SHEETS STA. \_\_\_\_\_ TO STA. \_\_\_\_\_

F.A.U. RTE.	SECTION	COUNTY	TOTAL SHEETS	SHEET NO.
6552	24-00044-00-RS	PEORIA	33	21
CONTRACT NO. 89869				
ILLINOIS FED. AID PROJECT				





LEGEND - PAINT PAVEMENT MARKING

- 1

LANE LINE SOLID, WHITE 4"
- 2

LANE LINE SKIP DASH, YELLOW 4"

10'

30'

10'
- 3

STOP BAR SOLID, WHITE 24"
- 4

PAINT PAVEMENT MARKING - LETTERS AND SYMBOLS

12"

12"

18"
- 5

CONTINENTAL CROSSWALK, WHITE

2'

2'



MODEL: SH06L01NAMES  
FILE NAME: 24-00044-00-RS

**FEHR GRAHAM**  
ENGINEERING & ENVIRONMENTAL  
LUNDS DESIGN FIRM NO. 184-003525

ILLINOIS    IOWA    WISCONSIN

USER NAME	= FGA
PLOT SCALE	= 40,0000 ' / in.
PLOT DATE	= 4/10/2025

DESIGNED -	MEC
DRAWN -	KRS
CHECKED -	DLH
DATE -	04/09/2025

REVISED -	_____
REVISED -	_____
REVISED -	_____
REVISED -	_____

CITY OF CHILLICOTHE

CLOVERDALE ROAD  
PAVEMENT MARKING

SCALE: \_\_\_\_\_ SHEET \_\_\_\_ OF \_\_\_\_ SHEETS STA. \_\_\_\_\_ TO STA. \_\_\_\_\_

F.A.U RTE.	SECTION	COUNTY	TOTAL SHEETS	SHEET NO.
6552	24-00044-00-RS	PEORIA	33	23
CONTRACT NO. 89869				
		ILLINOIS	FED. AID PROJECT	

MATCHLINE STA. 70+00



MATCHLINE STA. 76+00

LEGEND - PAINT PAVEMENT MARKING

- 1

LANE LINE SOLID, WHITE 4"
- 2

LANE LINE SKIP DASH, YELLOW 4"

10'

30'

10'
- 3

STOP BAR SOLID, WHITE 24"

12"

12"

18"
- 4

PAINT PAVEMENT MARKING - LETTERS AND SYMBOLS
- 5

CONTINENTAL CROSSWALK, WHITE

2'

2'



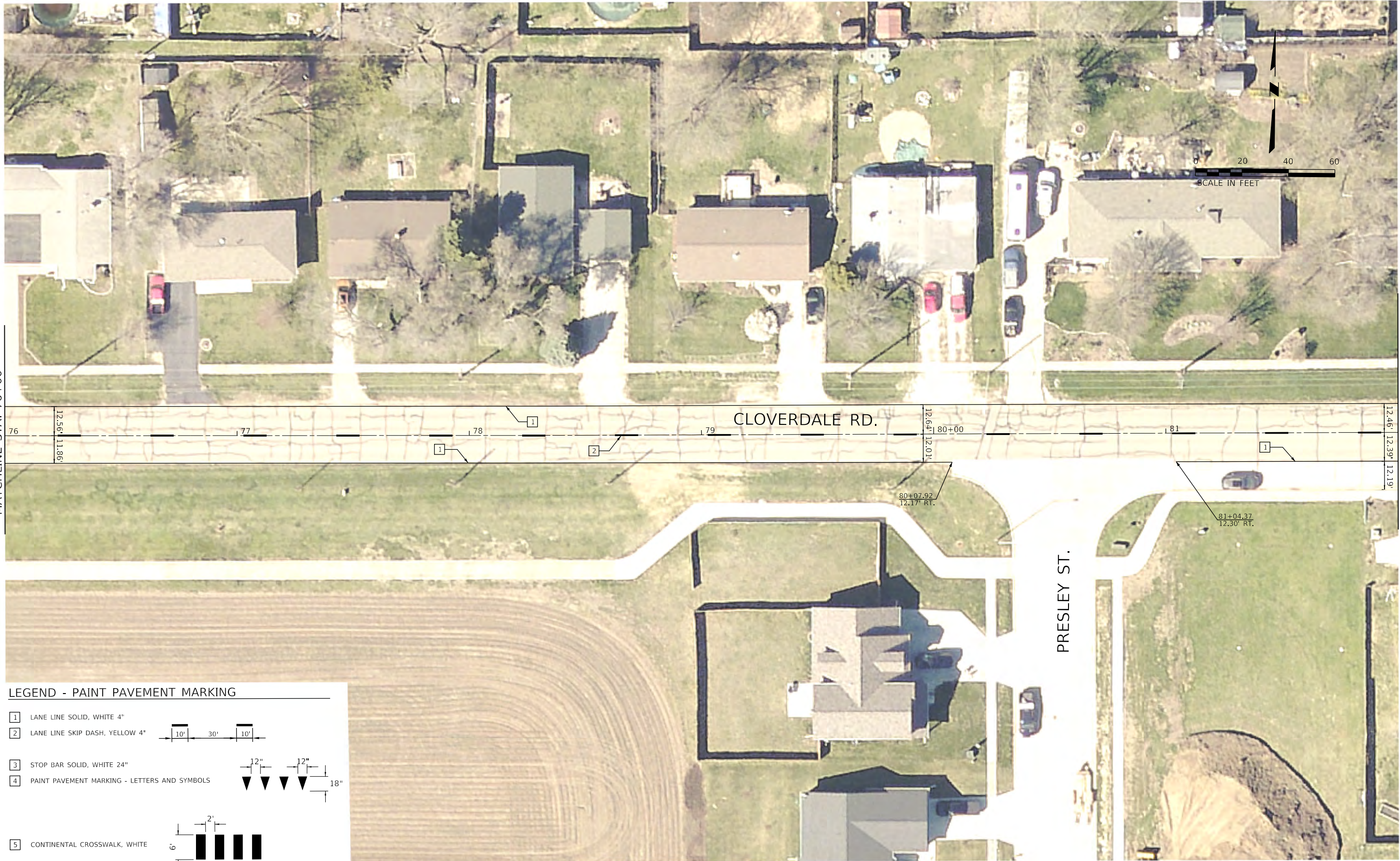

MATCHLINE STA. 76+00

MATCHLINE STA. 82+00

LEGEND - PAINT PAVEMENT MARKING

- 1 LANE LINE SOLID, WHITE 4"
- 2 LANE LINE SKIP DASH, YELLOW 4" 10' 30' 10'
- 3 STOP BAR SOLID, WHITE 24"
- 4 PAINT PAVEMENT MARKING - LETTERS AND SYMBOLS 12" 12" 18"
- 5 CONTINENTAL CROSSWALK, WHITE 2' 2'

**FEHR GRAHAM**  
ENGINEERING & ENVIRONMENTAL  
ILLINOIS DESIGN FIRM NO. 184-003525  
ILLINOIS IOWA WISCONSIN

USER NAME	= FGA
DESIGNED -	MEC
DRAWN -	KRS
PLOT SCALE	= 40,0000 ' / in.
CHECKED -	DLH
PLOT DATE	= 4/10/2025
DATE	= 04/09/2025

REVISED -	_____
REVISED -	_____
REVISED -	_____
REVISED -	_____

CITY OF CHILLICOTHE

CLOVERDALE ROAD  
PAVEMENT MARKING

SCALE: \_\_\_\_\_ SHEET \_\_\_\_ OF \_\_\_\_ SHEETS STA. \_\_\_\_\_ TO STA. \_\_\_\_\_

F.A.U. RTE.	SECTION	COUNTY	TOTAL SHEETS	SHEET NO.
6552	24-00044-00-RS	PEORIA	33	24
CONTRACT NO. 89869				
ILLINOIS FED. AID PROJECT				



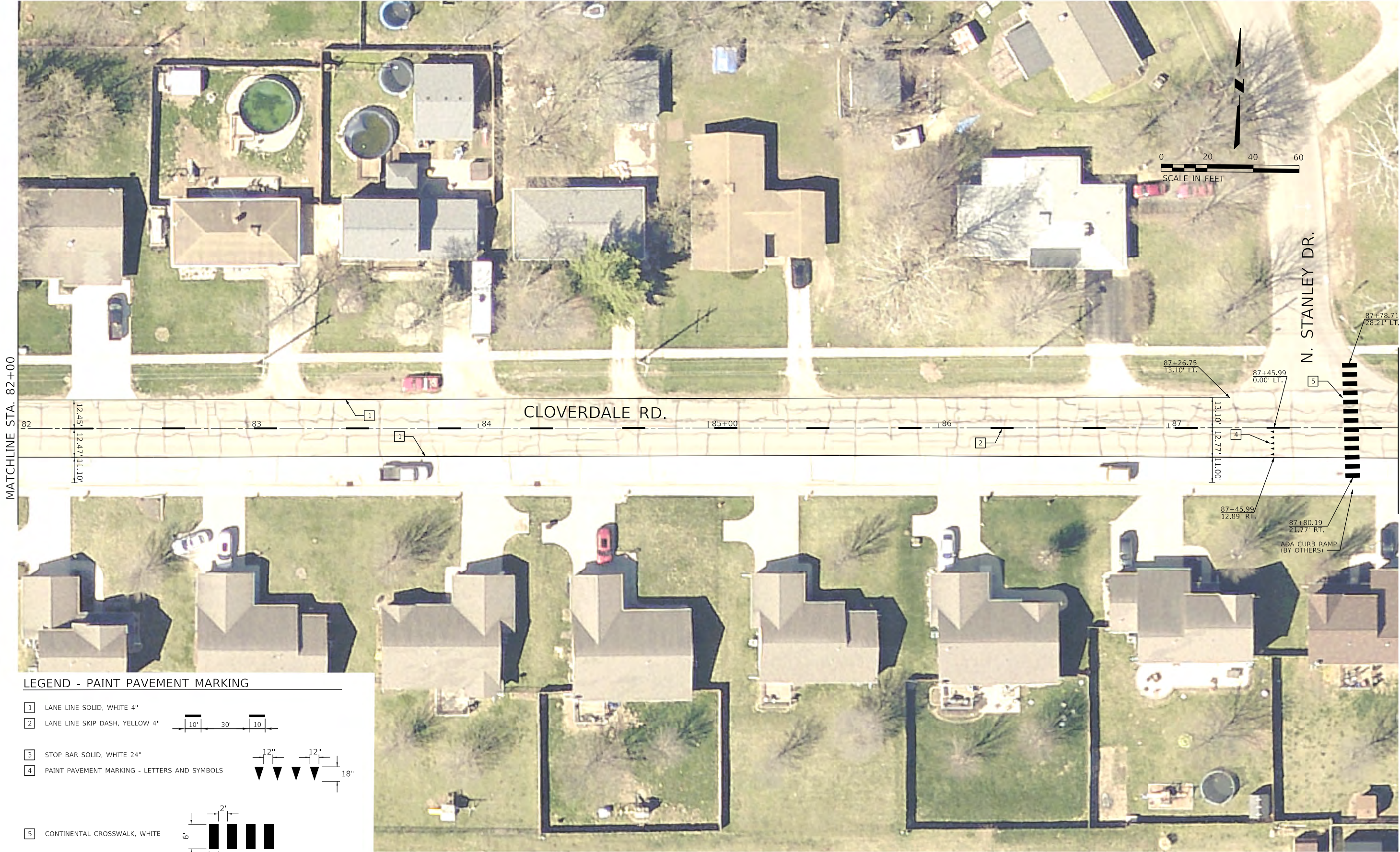

LEGEND - PAINT PAVEMENT MARKING

- 1 LANE LINE SOLID, WHITE 4"
- 2 LANE LINE SKIP DASH, YELLOW 4"
- 3 STOP BAR SOLID, WHITE 24"
- 4 PAINT PAVEMENT MARKING - LETTERS AND SYMBOLS
- 5 CONTINENTAL CROSSWALK, WHITE

MODEL: SHOWNELNAMES  
FILE NAME: 21050520

**FEHR GRAHAM**  
ENGINEERING & ENVIRONMENTAL  
ILLINOIS DESIGN FIRM NO. 184-003025  
ILLINOIS IOWA WISCONSIN

USER NAME = FGA	DESIGNED - MEC	REVISED - _____
	DRAWN - KRS	REVISED - _____
PLOT SCALE = 40.0000 ' / in.	CHECKED - DLH	REVISED - _____
PLOT DATE = 4/10/2025	DATE - 04/09/2025	REVISED - _____

CITY OF CHILLICOTHE

CLOVERDALE ROAD  
PAVEMENT MARKING

SCALE: \_\_\_\_\_ SHEET \_\_\_\_ OF \_\_\_\_ SHEETS STA. \_\_\_\_\_ TO STA. \_\_\_\_\_

F.A.U. RTE.	SECTION	COUNTY	TOTAL SHEETS	SHEET NO.
6552	24-00044-00-RS	PEORIA	33	25
CONTRACT NO. 89869				
ILLINOIS FED. AID PROJECT				



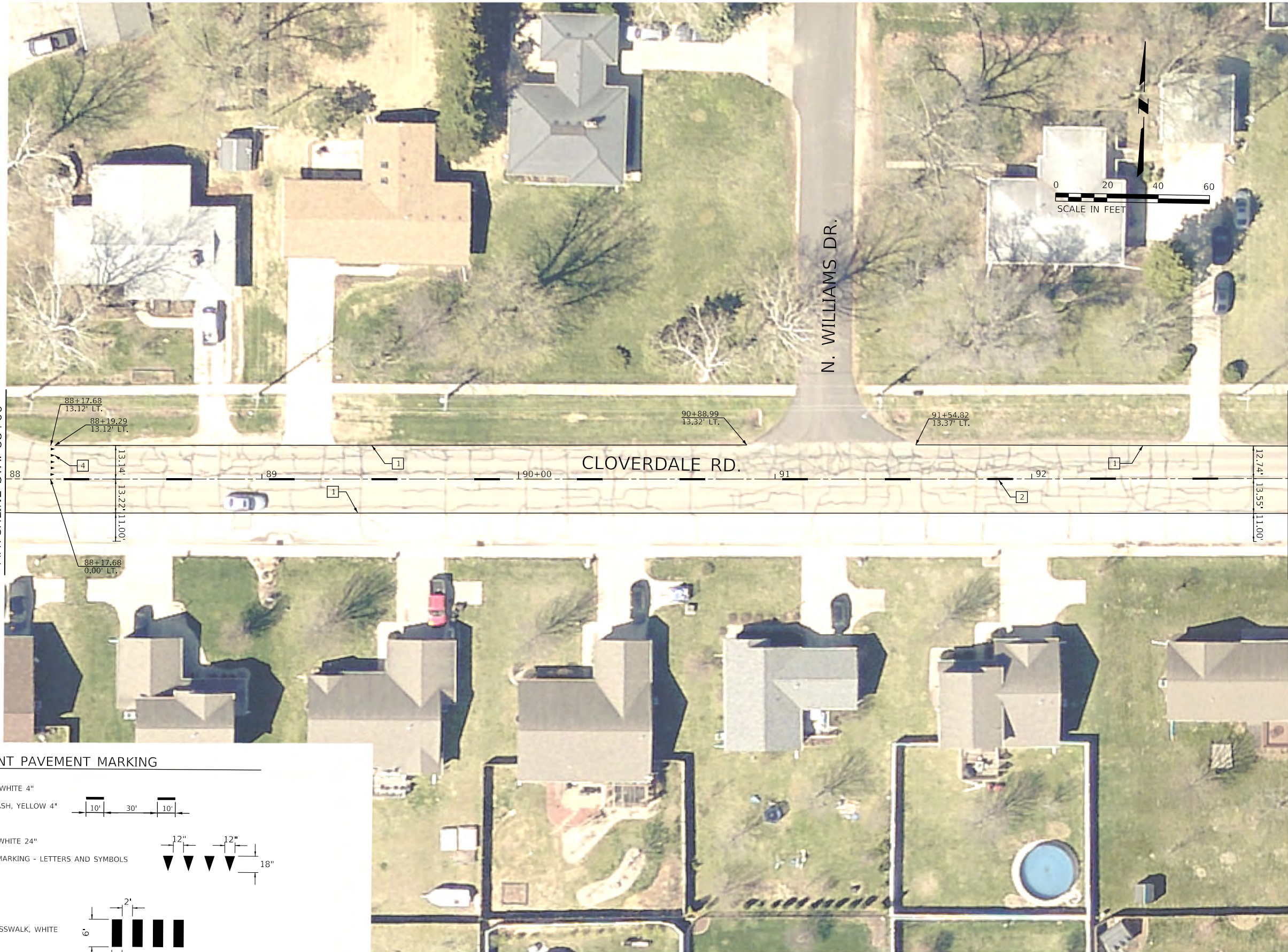

LEGEND - PAINT PAVEMENT MARKING

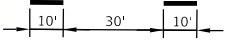
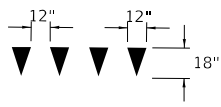
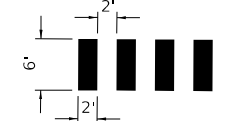
- 1 LANE LINE SOLID, WHITE 4"
- 2 LANE LINE SKIP DASH, YELLOW 4" 
- 3 STOP BAR SOLID, WHITE 24" 
- 4 PAINT PAVEMENT MARKING - LETTERS AND SYMBOLS
- 5 CONTINENTAL CROSSWALK, WHITE 

MODEL: SHOWN NAMES  
FILE: NAME: PHOTO: 500

**FEHR GRAHAM**  
ENGINEERING & ENVIRONMENTAL  
ILLINOIS IOWA WISCONSIN

USER NAME = FGA	DESIGNED - MEC	REVISED - _____
	DRAWN - KRS	REVISED - _____
PLOT SCALE = 40,0000 ' / in.	CHECKED - DLH	REVISED - _____
PLOT DATE = 4/10/2025	DATE - 04/09/2025	REVISED - _____

CITY OF CHILLICOTHE

CLOVERDALE ROAD  
PAVEMENT MARKING

SCALE: \_\_\_\_\_ SHEET \_\_\_\_ OF \_\_\_\_ SHEETS STA. \_\_\_\_\_ TO STA. \_\_\_\_\_

F.A.U. RTE.	SECTION	COUNTY	TOTAL SHEETS	SHEET NO.
6552	24-00044-00-RS	PEORIA	33	26
CONTRACT NO. 89869				
ILLINOIS FED. AID PROJECT				





LEGEND - PAINT PAVEMENT MARKING

- 1 LANE LINE SOLID, WHITE 4"
- 2 LANE LINE SKIP DASH, YELLOW 4"
- 3 STOP BAR SOLID, WHITE 24"
- 4 PAINT PAVEMENT MARKING - LETTERS AND SYMBOLS
- 5 CONTINENTAL CROSSWALK, WHITE

MODEL: ST0001.NAMES  
FILE: 0001.DWG

**FEHR GRAHAM**  
ENGINEERING & ENVIRONMENTAL  
ILLINOIS IOWA WISCONSIN

USER NAME = FGA	DESIGNED - MEC	REVISED - _____
	DRAWN - KRS	REVISED - _____
PLOT SCALE = 40,0000 ' / in.	CHECKED - DLH	REVISED - _____
PLOT DATE = 4/10/2025	DATE - 04/09/2025	REVISED - _____

CITY OF CHILLICOTHE

CLOVERDALE ROAD  
PAVEMENT MARKING

SCALE: \_\_\_\_\_ SHEET \_\_\_\_ OF \_\_\_\_ SHEETS STA. \_\_\_\_\_ TO STA. \_\_\_\_\_

F.A.U. RTE.	SECTION	COUNTY	TOTAL SHEETS	SHEET NO.
6552	24-00044-00-RS	PEORIA	33	27
CONTRACT NO. 89869				
ILLINOIS FED. AID PROJECT				



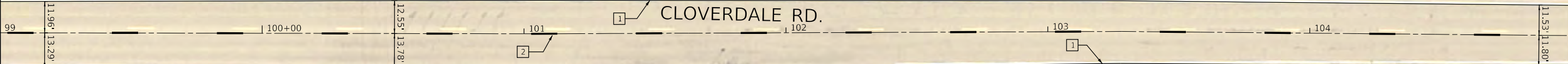

**LEGEND - PAINT PAVEMENT MARKING**

- 1 LANE LINE SOLID, WHITE 4"
- 2 LANE LINE SKIP DASH, YELLOW 4"
- 3 STOP BAR SOLID, WHITE 24"
- 4 PAINT PAVEMENT MARKING - LETTERS AND SYMBOLS
- 5 CONTINENTAL CROSSWALK, WHITE

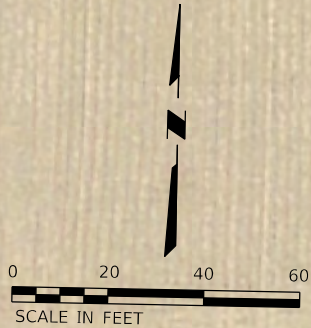

MODEL: STAMODEL.NAMES  
FILE NAME: 10025500

**FEHR GRAHAM**  
ENGINEERING & ENVIRONMENTAL  
ILLINOIS IOWA WISCONSIN

USER NAME = FGA	DESIGNED - MEC	REVISED - _____
DRAWN - KRS	REVISOR - _____	
PLOT SCALE = 40,0000 ' / in.	CHECKED - DLH	REVISED - _____
PLOT DATE = 4/10/2025	DATE - 04/09/2025	REVISED - _____

CITY OF CHILLICOTHE

CLOVERDALE ROAD  
PAVEMENT MARKING

SCALE: \_\_\_\_\_ SHEET \_\_\_\_ OF \_\_\_\_ SHEETS STA. \_\_\_\_\_ TO STA. \_\_\_\_\_

F.A.U. RTE.	SECTION	COUNTY	TOTAL SHEETS	SHEET NO.
6552	24-00044-00-RS	PEORIA	33	28
CONTRACT NO. 89869				
ILLINOIS FED. AID PROJECT				



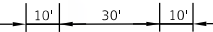
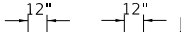
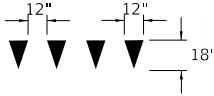
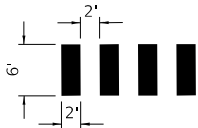

LEGEND - PAINT PAVEMENT MARKING

- 1 LANE LINE SOLID, WHITE 4"
- 2 LANE LINE SKIP DASH, YELLOW 4" 
- 3 STOP BAR SOLID, WHITE 24" 
- 4 PAINT PAVEMENT MARKING - LETTERS AND SYMBOLS 
- 5 CONTINENTAL CROSSWALK, WHITE 

MODEL: ST00010001  
FILE: ST00010001.DWG

**FEHR GRAHAM**  
ENGINEERING & ENVIRONMENTAL  
ILLINOIS IOWA WISCONSIN

USER NAME = FGA  
DESIGNED - MEC  
DRAWN - KRS  
PLOT SCALE = 40,0000 ' / in.  
CHECKED - DLH  
PLOT DATE = 4/10/2025  
DATE - 04/09/2025

REVISED - \_\_\_\_\_  
REVISED - \_\_\_\_\_  
REVISED - \_\_\_\_\_  
REVISED - \_\_\_\_\_

CITY OF CHILLICOTHE

CLOVERDALE ROAD  
PAVEMENT MARKING

SCALE: \_\_\_\_\_ SHEET \_\_\_\_\_ OF \_\_\_\_\_ SHEETS STA. \_\_\_\_\_ TO STA. \_\_\_\_\_

F.A.U. RTE.	SECTION	COUNTY	TOTAL SHEETS	SHEET NO.
6552	24-00044-00-RS	PEORIA	33	29
CONTRACT NO. 89869				

ILLINOIS FED. AID PROJECT





MATCHLINE STA. 111+00

LEGEND - PAINT PAVEMENT MARKING

- 1 LANE LINE SOLID, WHITE 4"
- 2 LANE LINE SKIP DASH, YELLOW 4"
- 3 STOP BAR SOLID, WHITE 24"
- 4 PAINT PAVEMENT MARKING - LETTERS AND SYMBOLS
- 5 CONTINENTAL CROSSWALK, WHITE

MODEL: S:\MODEL\NAMES  
FILE: 24-00044-00-RS.DWG

**FEHR GRAHAM**  
ENGINEERING & ENVIRONMENTAL  
ILLINOIS IOWA WISCONSIN

USER NAME = FGA	DESIGNED - MEC	REVISED - _____
	DRAWN - KRS	REVISED - _____
PLOT SCALE = 40,0000 ' / in.	CHECKED - DLH	REVISED - _____
PLOT DATE = 4/10/2025	DATE - 04/09/2025	REVISED - _____

CITY OF CHILLICOTHE

CLOVERDALE ROAD  
PAVEMENT MARKING

SCALE: \_\_\_\_\_ SHEET \_\_\_\_ OF \_\_\_\_ SHEETS STA. \_\_\_\_\_ TO STA. \_\_\_\_\_

F.A.U. RTE.	SECTION	COUNTY	TOTAL SHEETS	SHEET NO.
6552	24-00044-00-RS	PEORIA	33	30
CONTRACT NO. 89869				
ILLINOIS FED. AID PROJECT				



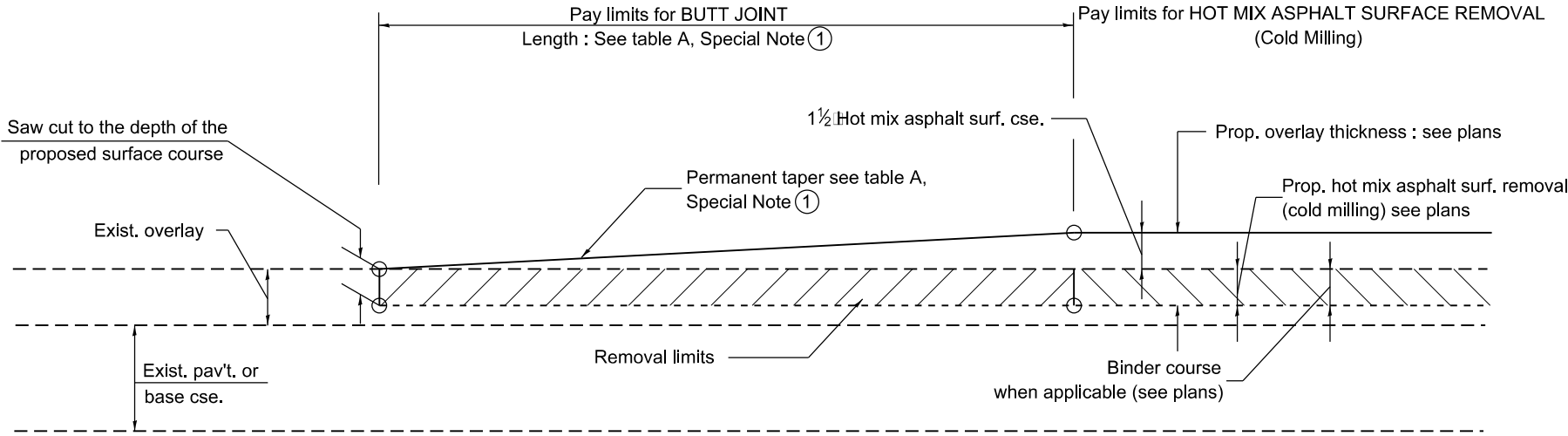

CASE 1 : WITH HOT MIX ASPHALT SURFACE REMOVAL (COLD MILLING)

TABLE A  
TAPER RATES

SPECIAL NOTE NUMBER	ELEMENT	MAINLINE INTERSTATES & 4-LANE EXPRESSWAYS	ALL OTHERS
1	BUTT JOINT TAPER RATE	1:480	1:240
2	TEMPORARY RAMP TAPER RATE	1:40	1:80

GENERAL NOTES

1. The work shall be done in accordance with Article 406.08 and the Special Provision for Butt Joints.
2. The pavement surface to be removed may be either bituminous or P.C. concrete. The work shall be performed in accordance with Article 440.04 and the Special Provisions for Butt Joints.
3. The saw cut joints shall be primed just prior to the placing of bituminous material. The work will be in accordance with the applicable portions of Article 406.05.
4. The length of butt joint is based on the taper rate times change in cold milling depth within the butt joint pay limits, unless otherwise indicated.
5. Temporary ramps are paid for separately and not included in the cost of the butt joints.

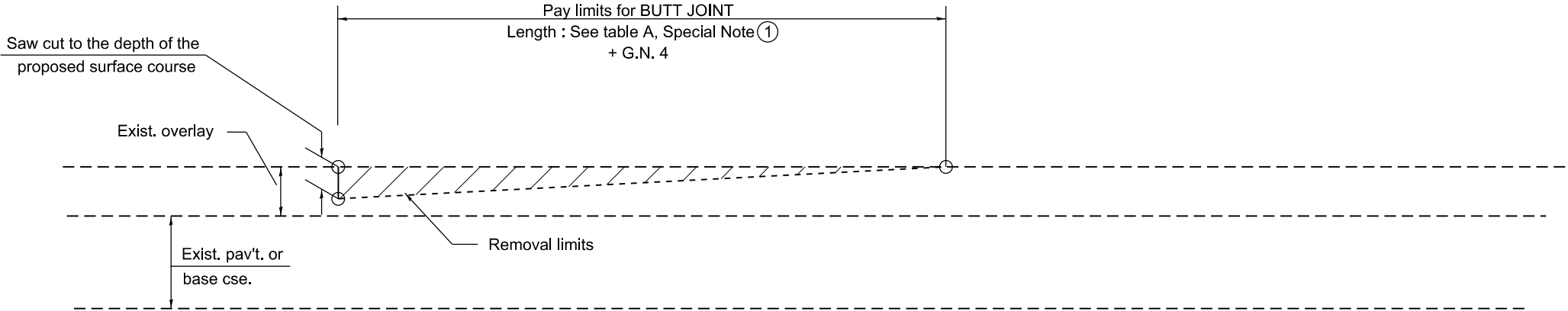

CASE 2 : NO HOT MIX ASPHALT SURFACE REMOVAL (COLD MILLING)

All dimensions are in inches unless otherwise noted.

MODEL: ###  
FILE NAME: G:\24\Chillicothe, City of\24-1951 - Cloverdale resurfacing\400 CAD\402 Xref\04-406101.dgn

	USER NAME = Kevin.Sills	DESIGNED -	REVISED -	STATE OF ILLINOIS DEPARTMENT OF TRANSPORTATION	BUTT JOINTS			F.A.U. RTE.	SECTION	COUNTY	TOTAL SHEETS	SHEET NO.
		DRAWN -	REVISED -					6552	24-00044-00-RS	PEORIA	33	31
		CHECKED -	REVISED -					DISTRICT 4 STANDARD NO. 406101		CONTRACT NO. 89869		
	PLOT DATE = 4/8/2025	DATE -	REVISED -		SCALE: NOT TO SCALE	SHEET 1 OF 3 SHEETS	STA.	TO STA.		ILLINOIS FED. AID PROJECT		



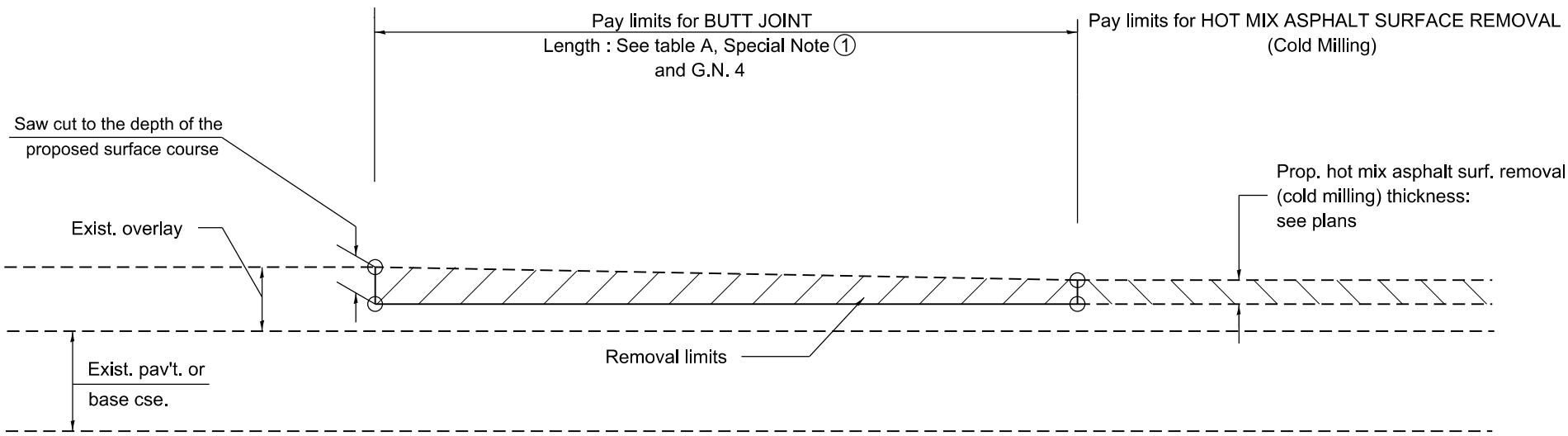

CASE 3 : HOT MIX ASPHALT SURFACE REMOVAL (COLD MILLING)  
TIE-IN TO EXISTING BITUMINOUS TAPER

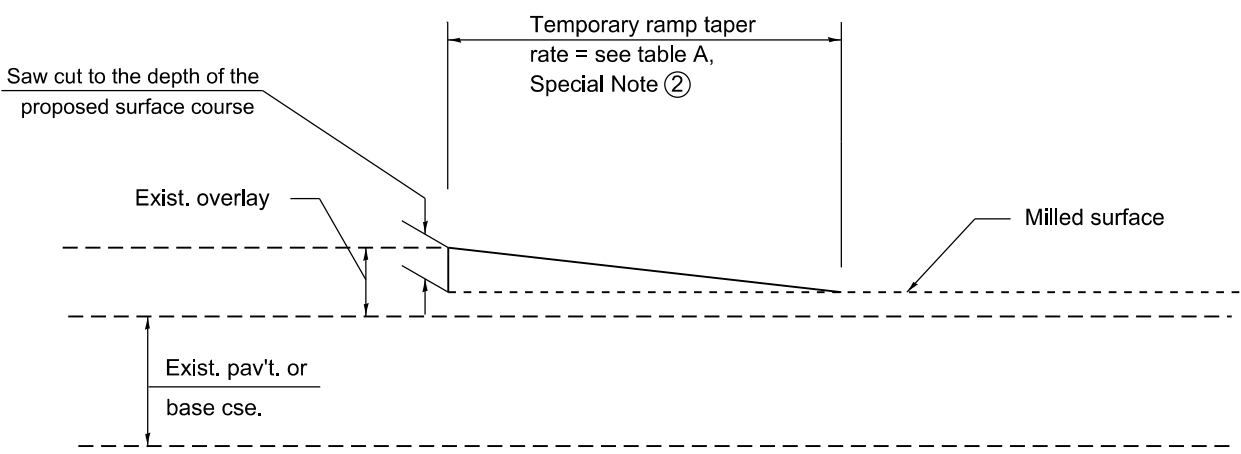

DETAIL TEMPORARY RAMP

All dimensions are in inches  
unless otherwise noted.

MODEL : ###  
FILE NAME : G:\24\Chillicothe, City of\24-1951 - Cloverdale resurfacing\400 CAD\402 Xref\D4-406101.dgn

	USER NAME = Kevin.Sills	DESIGNED -	REVISED -	STATE OF ILLINOIS DEPARTMENT OF TRANSPORTATION	BUTT JOINTS			F.A.U. RTE.	SECTION	COUNTY	TOTAL SHEETS	SHEET NO.
		DRAWN -	REVISED -					6552	24-00044-00-RS	PEORIA	33	32
		CHECKED -	REVISED -		SCALE: NOT TO SCALE   SHEET 2 OF 3 SHEETS   STA. TO STA.			DISTRICT 4 STANDARD NO. 406101 CONTRACT NO. 89869				
	PLOT DATE = 4/8/2025	DATE -	REVISED -					ILLINOIS   FED. AID PROJECT				



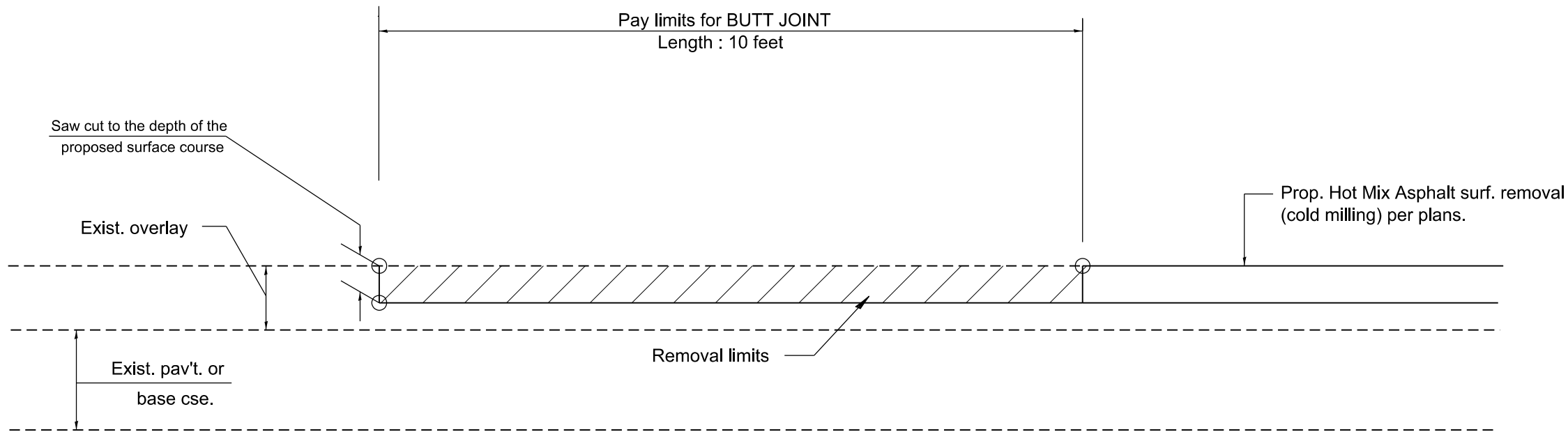

**CASE 4 : SINGLE LIFT OVERLAY WITH EQUIVALENT DEPTH  
HOT MIX ASPHALT SURFACE REMOVAL (COLD MILLING)  
TIE-IN TO EXISTING BITUMINOUS TAPER**

All dimensions are in inches unless otherwise noted.

MODEL : ###  
FILE NAME : G:\24\Chillicothe, City of\24-1951 - Cloverdale resurfacing\400 CAD\402 Xref\04-406101.dgn

	USER NAME = Kevin.Sills	DESIGNED -	REVISED -	STATE OF ILLINOIS DEPARTMENT OF TRANSPORTATION	BUTT JOINTS			F.A.U. RTE.	SECTION	COUNTY	TOTAL SHEETS	SHEET NO.
		DRAWN -	REVISED -					6552	24-00044-00-RS	PEORIA	33	33
		CHECKED -	REVISED -		SCALE: NOT TO SCALE   SHEET 3 OF 3 SHEETS   STA. TO STA.			DISTRICT 4 STANDARD NO. 406101   ILLINOIS   FED. AID PROJECT   CONTRACT NO. 89869				
	PLOT DATE = 4/8/2025	DATE -	REVISED -									