

**BILL OF MATERIALS - ROCK CREEK**

ITEM	UNIT	TOTAL
EARTH EXCAVATION	CU YD	29
FURNISHED EXCAVATION	CU YD	4
TRENCH BACKFILL	CU YD	7.7
TOPSOIL FURNISH AND PLACE, 4"	SO YD	79
GRADING AND SHAPING DITCHES	FOOT	161
AGGREGATE BASE COURSE, TYPE A 8"	SO YD	13
AGGREGATE BASE COURSE, TYPE A 12"	SO YD	87
PREPARATION OF BASE	SO YD	1,127
AGGREGATE SURFACE COURSE, TYPE A 6"	SO YD	1,138
HOT-MIX ASPHALT BINDER COURSE, IL 19.0, N50	TON	19.5
HOT-MIX ASPHALT SURFACE COURSE, MIX "C", N50	TON	8.1
PAVEMENT REMOVAL	SO YD	16
AGGREGATE WEDGE SHOULDER, TYPE B	TON	0.8
PIPE CULVERT REMOVAL	FOOT	27
PIPE CULVERTS, CLASS D, TYPE 1 24"	FOOT	40
END SECTIONS 24"	EACH	2
SIGN PANEL - TYPE 1	SO FT	7
WOOD SIGN SUPPORT	FOOT	40
PAINT PAVEMENT MARKING - LINE 24"	FOOT	9
REMOVE EXISTING GATE	EACH	1
TUBULAR STEEL GATE	EACH	1
SIGN PANEL - TYPE 1 (SPECIAL)	SO FT	8
BITUMINOUS MATERIALS (PRIME COAT)	POUND	203

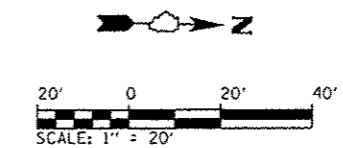
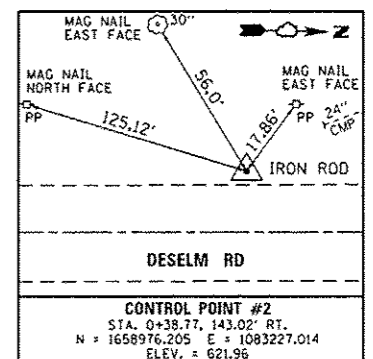
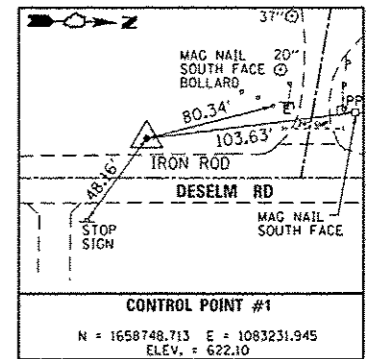
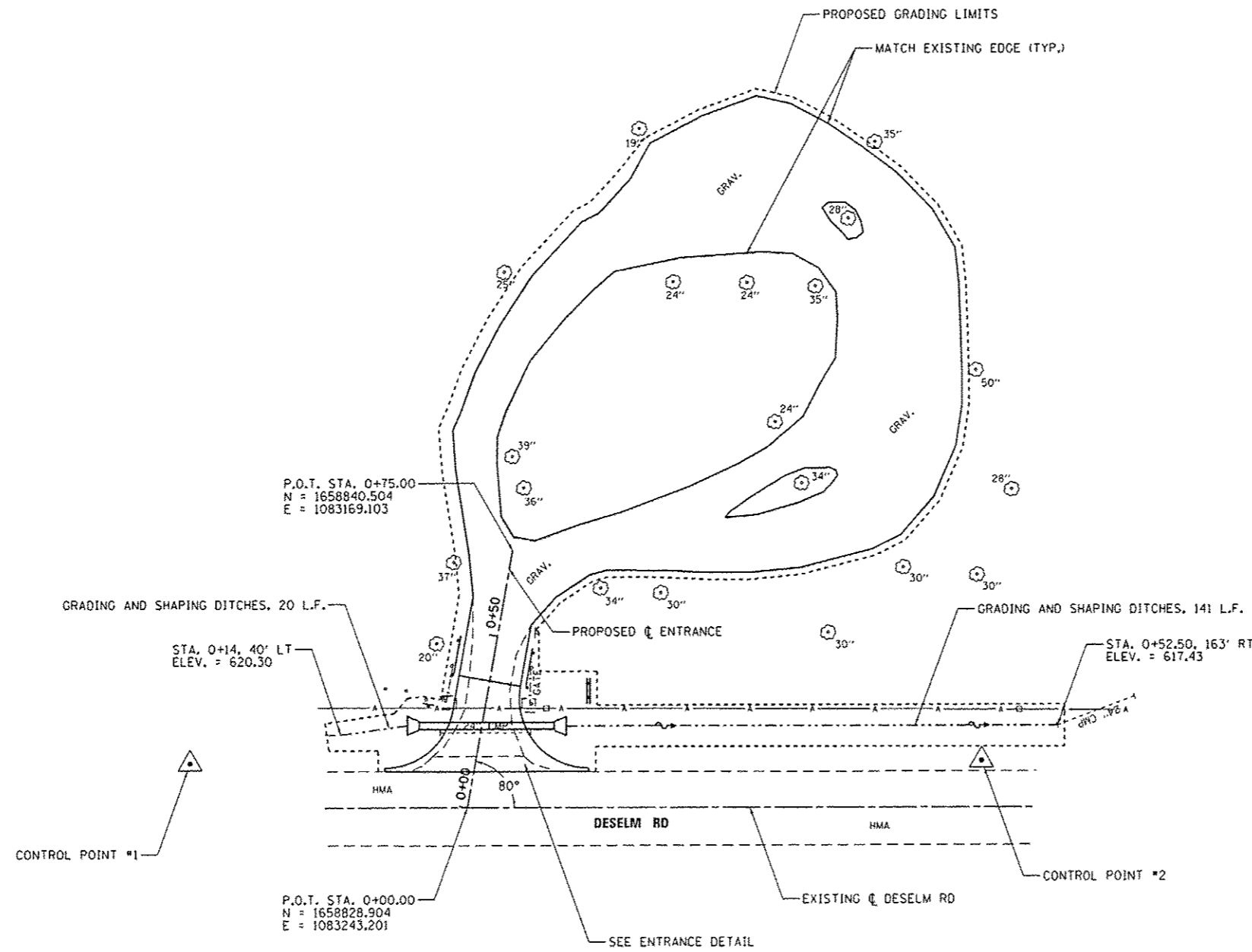

FILE NAME : L:\1007\1106610\W0.15\Draw\CADD_Sheets\46251-shl-RockCreek-01SitePlan.dgn	USER NAME : Brad Downen	DESIGNED - MJO	REVISED -	<b>STATE OF ILLINOIS DEPARTMENT OF TRANSPORTATION</b>	<b>SITE PLAN - ROCK CREEK KANKAKEE RIVER STATE PARK</b>		F.A. RTE.	SECTION	COUNTY	TOTAL SHEETS	SHEET NO.	
Default	PLOT SCALE = 40.0000 / 1 in.	CHECKED - BJO	REVISED -		SCALE: 1" = 20'	SHEET 1 OF 2 SHEETS	STA.	TO STA.	PARK ROADS	*	140	83
	PLOT DATE = 4/6/2013	DATE - 3/29/2013	REVISED -						* WILL & KANKAKEE		CONTRACT NO. 46251	
											ILLINOIS FED. AID PROJECT	