

DATE	3/29
BY	RAH
CHECKED	JMM
DATE	3/29/2013
DESIGNED	BMB
DATE	3/29/2013
DRAWN	RAH
DATE	3/29/2013
CHECKED	JMM
DATE	3/29/2013
DESIGNED	BMB
DATE	3/29/2013

DATE	3/29
BY	RAH
CHECKED	JMM
DATE	3/29/2013
DESIGNED	BMB
DATE	3/29/2013
DRAWN	RAH
DATE	3/29/2013
CHECKED	JMM
DATE	3/29/2013
DESIGNED	BMB
DATE	3/29/2013

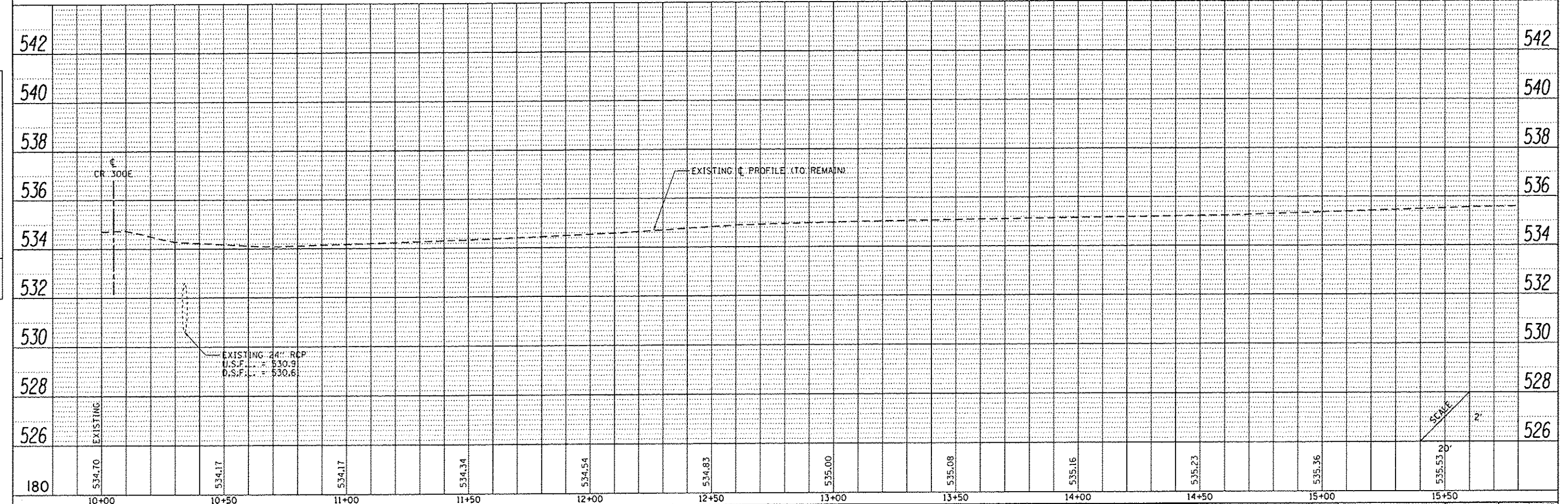
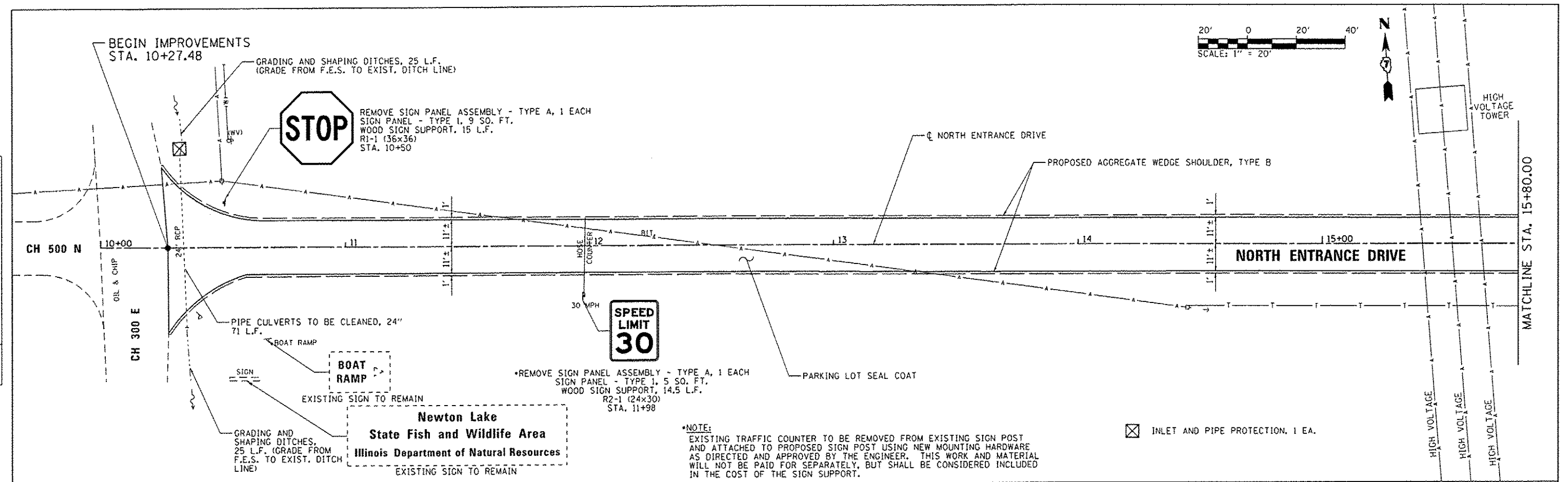

FILE NAME :	USER NAME :	DESIGNED -	REVISED -	NORTH ENTRANCE DRIVE - PLAN AND PROFILE SHEET				F.A. RTE.	SECTION	COUNTY	TOTAL SHEETS	SHEET NO.
L:\1001\1186618\W0.13\Draw\CA00.Sheets\07	255_Php North-1 810.dgn	DRAWN -	REVISED -	NEWTON LAKE STATE FISH AND WILDLIFE AREA				N/A	PARKS ROADS	JASPER	66	13
Default	PLOT SCALE = 40.0000 / in.	CHECKED -	REVISED -	SCALE: 1"=20'				SHEET OF SHEETS		STA. 10+00 TO STA. 15+80		CONTRACT NO. 46255
	PLOT DATE = 3/29/2013	DATE -	REVISED -	STATE OF ILLINOIS DEPARTMENT OF TRANSPORTATION				ILLINOIS FED. AID PROJECT				