

PLAN	DESIGNED	DATE
	PLOTTED	
	NOTES CHECKED	
	BY	
	FILE NAME	

PROFILE	DESIGNED	DATE
	PLOTTED	
	NOTES CHECKED	
	BY	
	FILE NAME	

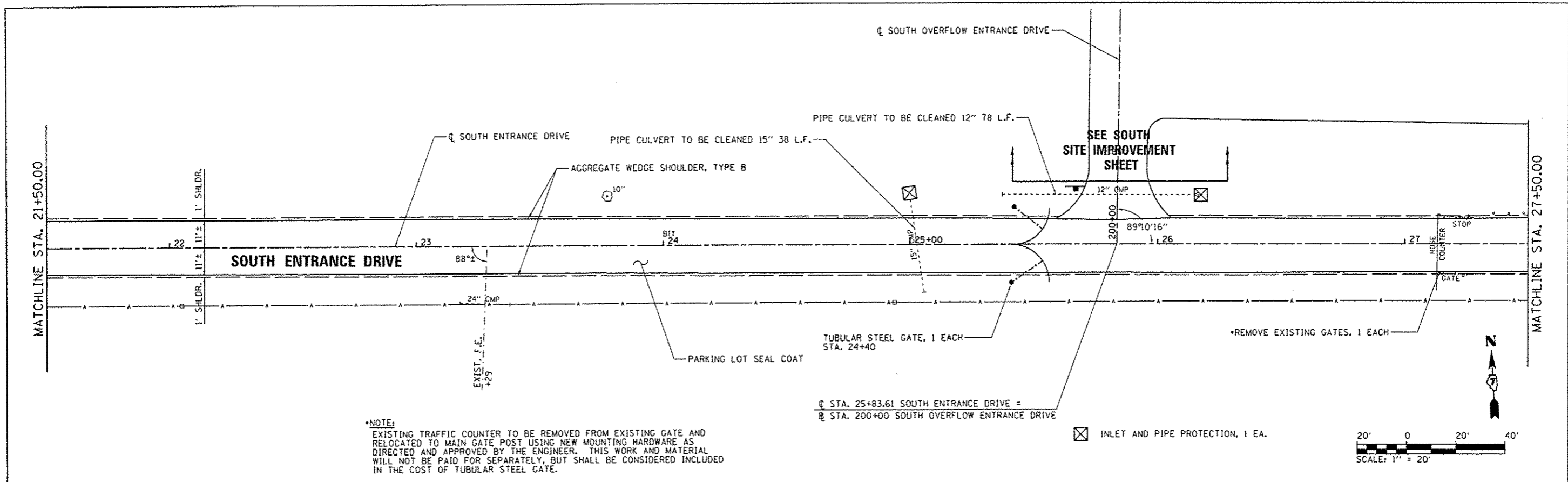

***NOTE:**
 EXISTING TRAFFIC COUNTER TO BE REMOVED FROM EXISTING GATE AND RELOCATED TO MAIN GATE POST USING NEW MOUNTING HARDWARE AS DIRECTED AND APPROVED BY THE ENGINEER. THIS WORK AND MATERIAL WILL NOT BE PAID FOR SEPARATELY, BUT SHALL BE CONSIDERED INCLUDED IN THE COST OF TUBULAR STEEL GATE.

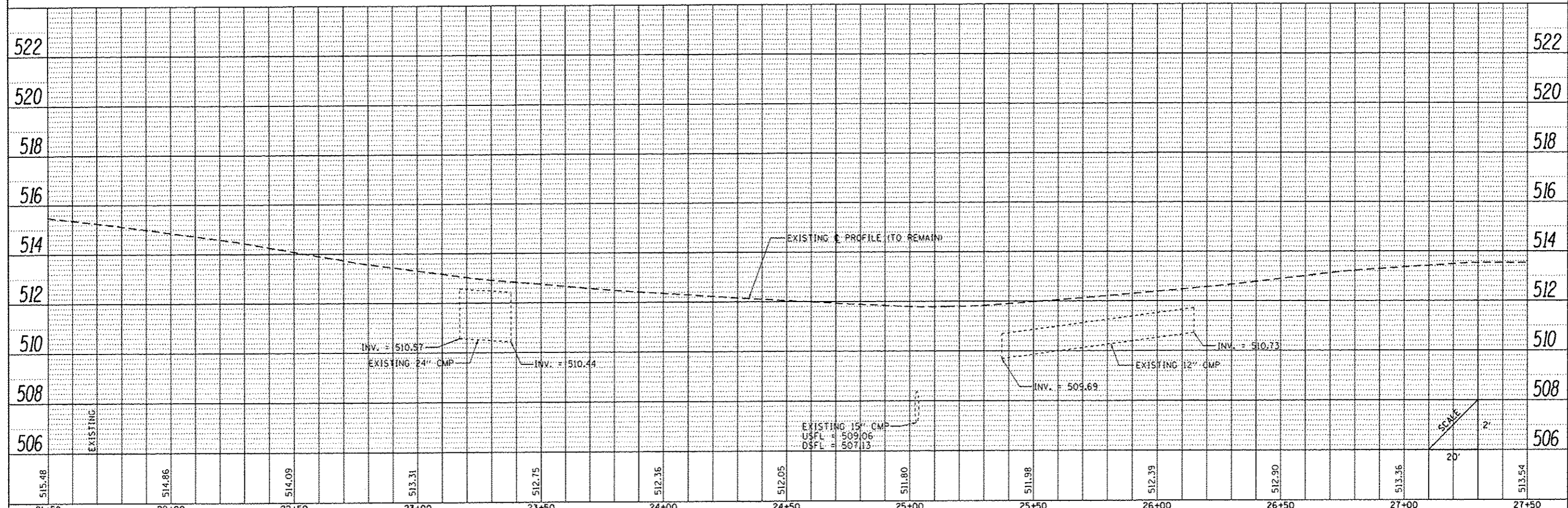

FILE NAME: L:\1007\1108610\10_13\10-20-13\10-20-13\CADD_Sheets\107	USER NAME: Brian Bond	DESIGNED: BMB	REVISED:	STATE OF ILLINOIS DEPARTMENT OF TRANSPORTATION		SOUTH ENTRANCE DRIVE - PLAN AND PROFILE SHEET NEWTON LAKE STATE FISH AND WILDLIFE AREA			F.A. RTE.	SECTION	COUNTY	TOTAL SHEETS	SHEET NO.
Default	PLOT SCALE: 1/8" = 1' / in.	CHECKED: JMM	REVISED:						N/A	PARKS ROADS	JASPER	66	36
	PLOT DATE: 3/29/2013	DATE: 3/29/2013	REVISED:						CONTRACT NO. 46255			ILLINOIS FED. AID PROJECT	
									SCALE: 1" = 20'			SHEET OF SHEETS STA. 21+50 TO STA. 27+50	