

- Notes:**
1. Wall dimensions are measured along F.F. of wall. See sheet SW1 for location.
 2. Stations and offsets for the wall are given from the Ramp C to the F.F. of wall.

REINFORCEMENT BAR LIST				
Bar	No.	Size	Length	Shape
h ₃₀₀ (E)	24	#6	24'-8"	—
h ₃₀₁ (E)	24	#6	21'-8"	—
h ₃₀₂ (E)	24	#6	27'-8"	—
v ₃₁₀ (E)	77	#6	10'-8"	—
v ₃₁₁ (E)	49	#6	10'-6"	—
v ₃₂₄ (E)	15	#6	20'-9"	—

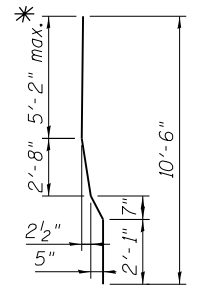
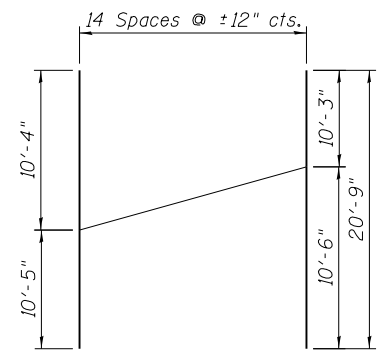

BAR v₃₂₄ (E)
BAR CUTTING DIAGRAM
 * Order Bars Full Length, Cut to Fit

BARS v₃₁₀ (E)
 * Cut in Field to Fit

BILL OF MATERIAL

DESCRIPTION	UNIT	QUANTITY
Structure Excavation	Cu. Yd.	124.6
Concrete Structures	Cu. Yd.	34
Stud Shear Connectors	Each	318
Reinforcement Bars, Epoxy Coated	Pound	5,158
Concrete Sealer	Sq. Ft.	741
Geocomposite Wall Drain	Sq. Yd.	29
Untreated Timber Lagging	Sq. Ft.	683
Furnishing Soldier Piles (W Section)	Foot	903
Pipe Underdrains for Structures 4"	Foot	75
Drilling and Setting Soldier Piles (In Soil)	Cu. Ft.	6,372

LEGEND

- E.F. = Each face
- F.F. = Front Face
- B.F. = Back Face
- C.I.P. = Cast-In-Place
- (C) = Construction Joint
- (E) = Expansion Joint
- (4) = Panel Numbers
- (12) = Pile Numbers

NOTE:

For Top of Pile Elevations & Pile Tip Elevations, see Soldier Pile Schedule, Sht. SW9.



USER NAME =	DESIGNED - GFP	REVISD -
	CHECKED - GMK	REVISD -
PLOT SCALE =	DRAWN - GFP	REVISD -
PLOT DATE	DATE - 3/5/2013	REVISD -

STATE OF ILLINOIS
DEPARTMENT OF TRANSPORTATION

PLAN AND ELEVATION (STA. 121 + 50.00 TO STA. 122 + 23.76)
STRUCTURE NO. 016-Z014

SHEET NO. SW6 OF SW11 SHEETS

F.A.I. R.T.E.	SECTION	COUNTY	TOTAL SHEETS	SHEET NO.
90/94	0303-474HB-R	COOK	368	318
CONTRACT NO. 60F63			ILLINOIS FED. AID PROJECT	