

PT STA. 4037+97.72

119

CP436

FOR RAMP BASELINE INFORMATION SEE ALIGNMENT, BENCHMARKS, AND TIES RAMP BASELINE DATA SHEETS

FOR NB AND SB BASELINE INFORMATION SEE ALIGNMENT, BENCHMARKS, AND TIES ILLINOIS ROUTE 59 NORTHBOUND AND SOUTHBOUND BASELINE DATA SHEETS

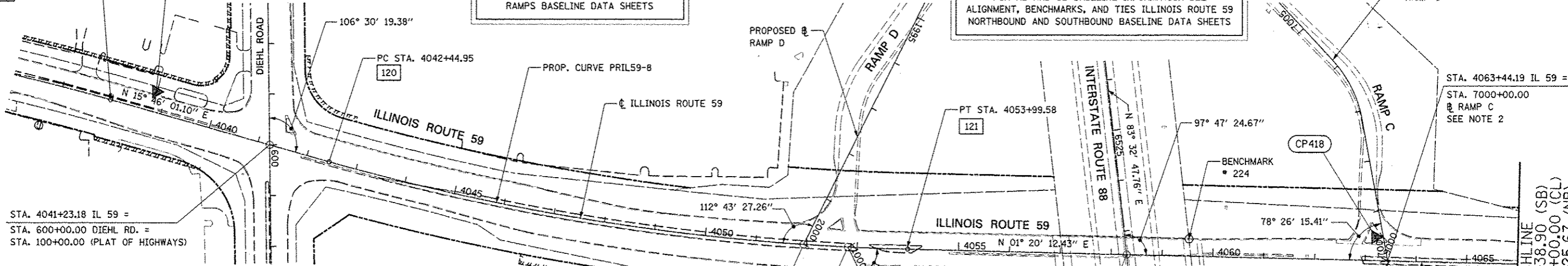

STA. 4041+23.18 IL 59 =
STA. 600+00.00 DIEHL RD. =
STA. 100+00.00 (PLAT OF HIGHWAYS)

ALIGNMENT DATA

119	N 869176.88 E 19325.93
120	N 869607.28 E 19447.45
121	N 870746.07 E 19618.70

PROP. CURVE PRIL59-8
PI STA. = 4048+25.34
Δ = 14° 25' 49" (LT)
D = 1° 14' 59"
R = 4,584.55'
T = 580.39'
L = 1,154.64'
E = 36.59'
P.C. STA. = 4042+44.95
P.T. STA. = 4053+99.58

STA. 4051+94.06 IL 59 =
STA. 2000+00.00 RAMP D
SEE NOTE 2

STA. 4052+81.36 IL 59 =
STA. 1000+00.00 RAMP A
SEE NOTE 1

STA. 4058+30.47 IL 59 =
STA. 6527+46.68 I-88
SEE NOTE 2

STA. 4063+46.99 IL 59 =
STA. 9000+00.00 RAMP B
SEE NOTE 2

STA. 4063+44.19 IL 59 =
STA. 7000+00.00 RAMP C
SEE NOTE 2

MATCHLINE
STA 828+38.90 (SB)
STA. 4066+00.00 (CL)
STA. 928+25.67 (NB)

MATCHLINE
STA 828+38.90 (SB)
STA. 4066+00.00 (CL)
STA. 928+25.67 (NB)

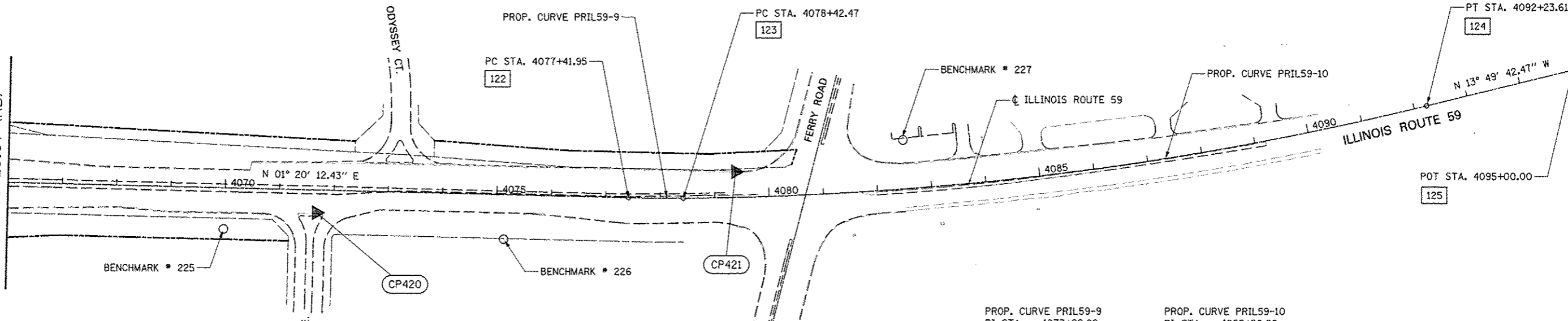

BENCHMARK * 225

BENCHMARK * 226

BENCHMARK * 227

POT STA. 4095+00.00

ALIGNMENT DATA

122	N 873087.80 E 19673.34	124	N 874555.65 E 19503.02
123	N 873188.31 E 19674.13	125	N 874824.02 E 19436.96

PROP. CURVE PRIL59-9
PI STA. = 4077+92.22
Δ = 1° 46' 28" (LT)
D = 1° 45' 55"
R = 3,245.62'
T = 50.26'
L = 100.52'
E = 0.39'
P.C. STA. = 4077+41.95
P.C.C. STA. = 4078+42.47

PROP. CURVE PRIL59-10
PI STA. = 4085+36.20
Δ = 13° 23' 27" (LT)
D = 0° 58' 10"
R = 5,909.58'
T = 693.73'
L = 1,381.14'
E = 40.58'
P.C.C. STA. = 4078+42.47
P.T. STA. = 4092+23.61

NOTE:

1. PLAT OF HIGHWAYS STATION EQUATION NOT APPLICABLE TO RAMP A. ALIGNMENT WAS CHANGED TO ACCOMMODATE DDI DESIGN.
2. PLAT OF HIGHWAYS STATION EQUATION NOT APPLICABLE TO RAMP B, C, D, & FERRY RD.

