

ALIGNMENT DATA

1400	N 871690.41 E 19640.74
1401	N 871640.01 E 19361.30
1402	N 871582.12 E 19245.54
1403	N 871413.32 E 19063.94
1404	N 871115.44 E 18430.90
1405	N 870972.56 E 17344.22

PROPOSED CURVE  
RAMP C-1  
PI STA. = 7003+51.38  
 $\Delta = 32^\circ 40' 58''$  (LT)  
D = 24° 54' 40"  
R = 230.00'  
T = 67.44'  
L = 131.20'  
E = 9.68'  
P.C. STA. = 7002+83.95  
P.T. STA. = 7004+15.14  
SE = 7.1%

PROPOSED CURVE  
RAMP C-2  
PI STA. = 7010+30.29  
 $\Delta = 35^\circ 25' 05''$  (RT)  
D = 4° 58' 56"  
R = 1,150.00'  
T = 367.21'  
L = 710.88'  
E = 57.20'  
P.C. STA. = 7006+63.08  
P.T. STA. = 7013+73.97  
SE = 8.0%

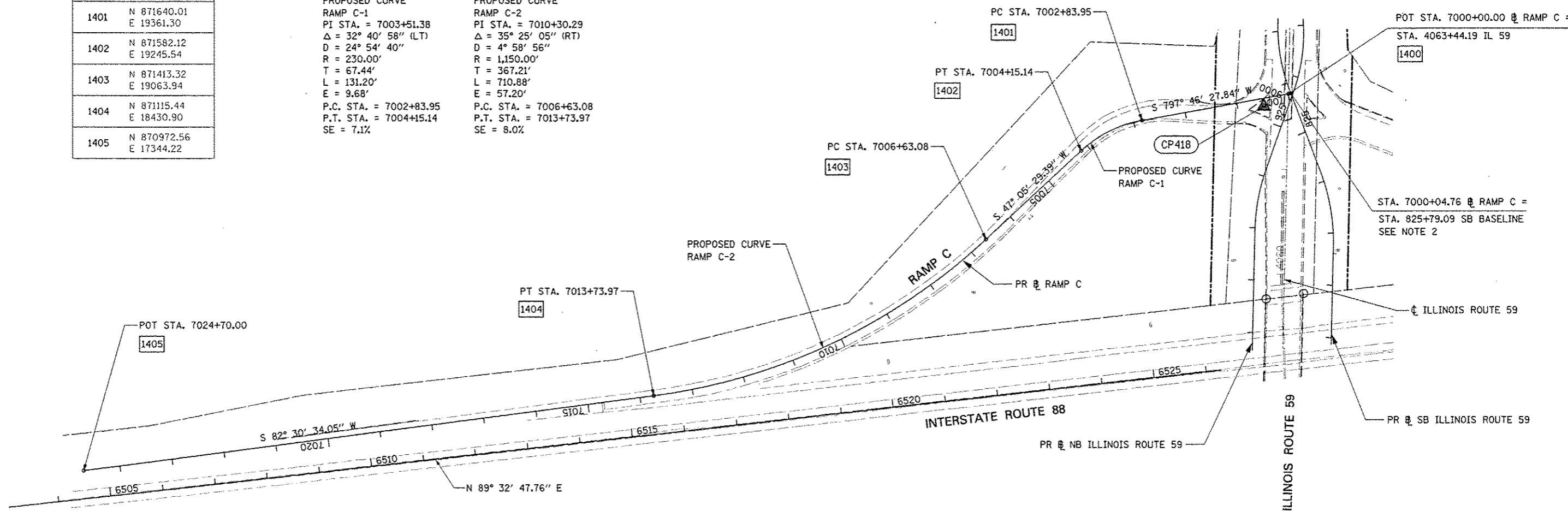

NOTE:

1. PLAT OF HIGHWAYS STATION EQUATION NOT APPLICABLE TO RAMP A. ALIGNMENT WAS CHANGED TO ACCOMMODATE DDI DESIGN.
2. PLAT OF HIGHWAYS STATION EQUATION NOT APPLICABLE TO RAMP B, C, D, & FERRY RD.



FILE NAME: AF11.EL#	USER NAME: RUSERS	DESIGNED: PJO	REVISED: -	<b>STATE OF ILLINOIS DEPARTMENT OF TRANSPORTATION</b>	<b>ALIGNMENT, BENCHMARKS, AND TIES RAMP C BASELINE DATA</b>	F.A.P. RTE.:	SECTION:	COUNTY:	TOTAL SHEETS:	SHEET NO.:
		DRAWN: KFS	REVISED: -			338	(112 & 113) WRS-5	DUPAGE	963	82
		CHECKED: JCM	REVISED: -			CONTRACT NO. 60131				
		DATE: 10/15/2012	REVISED: -			ILLINOIS FED. AID PROJECT				
		SCALE:		SHEET NO. 6 OF 9 SHEETS		STA. 7024+70 TO STA. 7000+04.76				