

CONTROL POINT 436
 STA. 4038+79.94 39.71' LT.
 CROSS (+) CUT ON TOP OF CURVE AT MID CURVE, SOUTHERN CURB RETURN AT ENTRANCE/EXIT TO MOBILE GAS STATION.
 N 869266.8021
 E 19310.0510
 ELEV. = 709.44

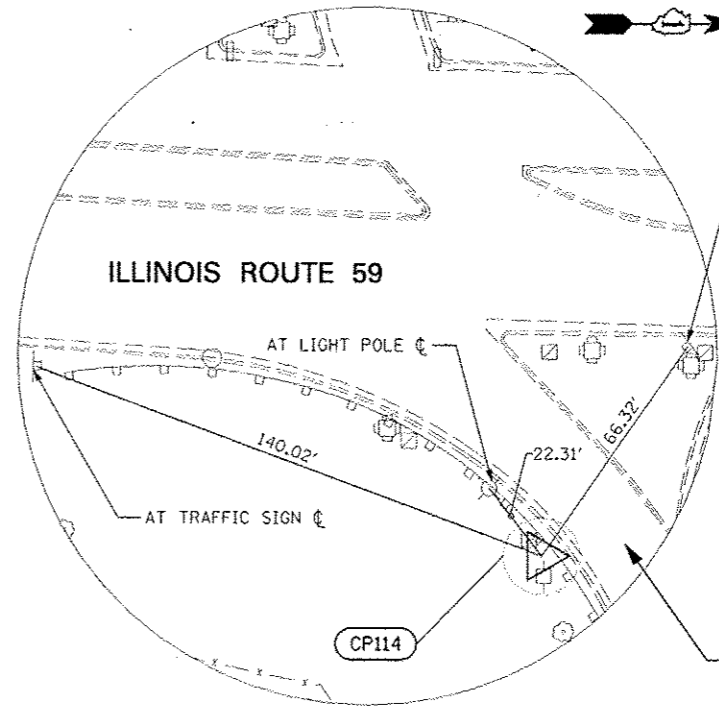

CONTROL POINT 114
 STA. 4053+32.93 93.56' RT.
 3/4" IRON PIPE W/CAP 3' SOUTHEAST ON GUARD RAIL, 5' SOUTHEAST OF EAST MID CURVE ON RTE 59 ENTRANCE RAMP TO INTERSTATE 88, 4' EAST OF HAND HOLE, 5' WEST OF POWER POLE, SOUTHEAST INTERSECTION OF RTE 59 AND EASTBOUND I-88 RAMP.
 N 870675.9021
 E 19710.1510
 ELEV. = 721.42

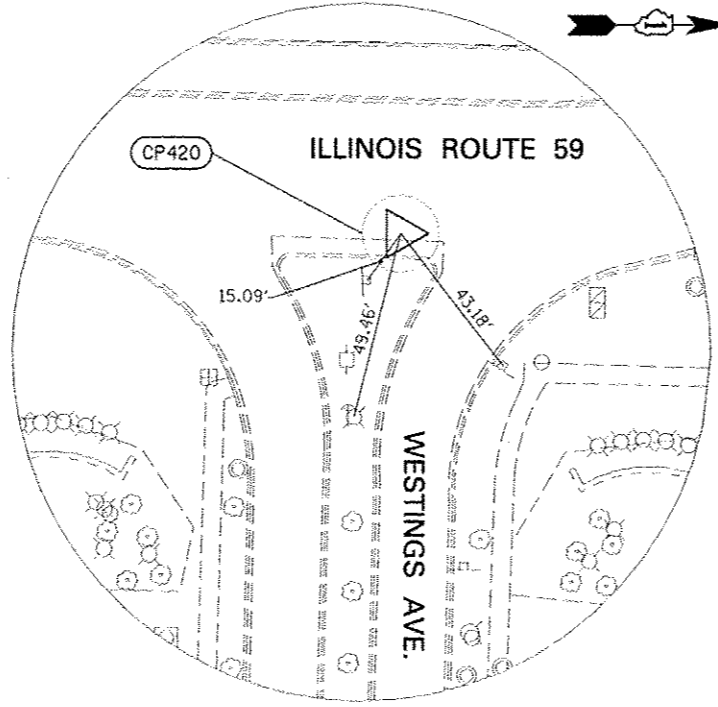

CONTROL POINT 420
 STA. 4071+68.47 41.82' RT.
 MAG NAIL 1.50' WEST OF 4' FLAG OF ISLAND, EAST SIDE OF RTE 59 AT ENTRANCE OF WESTINGS AVE, 10' SOUTH OF NORTH FLAG CORNER OF CURB.
 N 872513.5010
 E 19701.7710
 ELEV. = 718.10

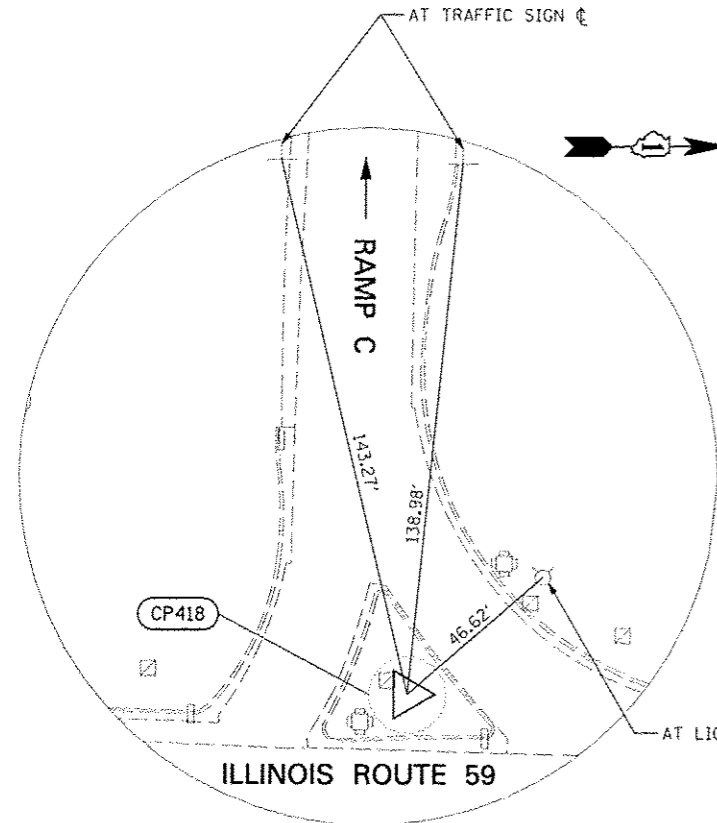

CONTROL POINT 418
 STA. 4063+19.28 46.40' LT.
 CROSS (+) CUT CENTER OF PORKCHOP ISLAND ON SOUTHBOUND RTE 59 AT RAMP TO WESTBOUND INTERSTATE 88, NORTHWEST INTERSECTION OF RTE 59 AND INTERSTATE 88.
 N 871666.6010
 E 19593.7710
 ELEV. = 726.60

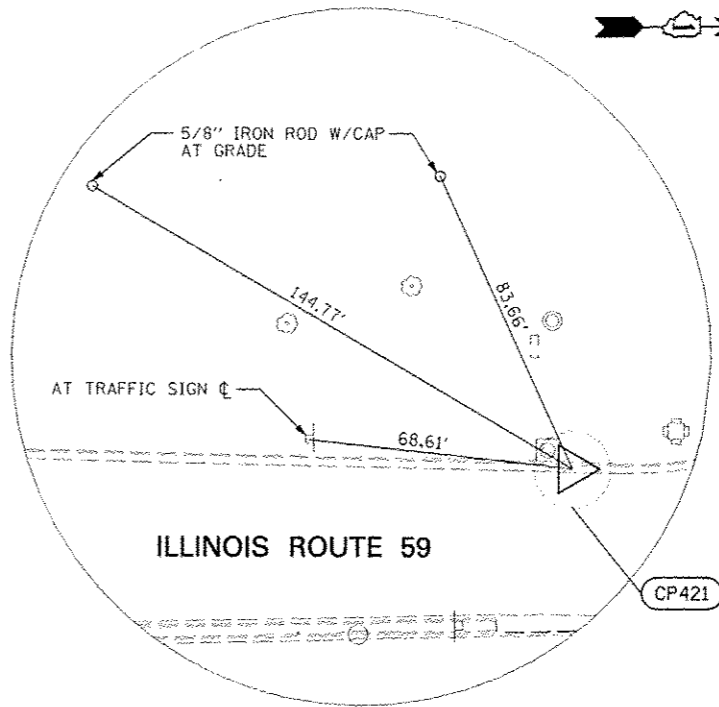

CONTROL POINT 421
 STA. 4079+39.34 47.11' LT.
 CROSS (+) CUT IN FLOW LINE OF WEST CURB ON RTE 59, SOUTHWEST CORNER OF RTE 59 AND FERRY RD, 10' SOUTH OF SOUTHERN POINT OF CURVATURE OF RTE 59 CURB.
 N 873284.1010
 E 19625.5010
 ELEV. = 721.79

FILE NAME	USER NAME	DESIGNED	REVISED	STATE OF ILLINOIS DEPARTMENT OF TRANSPORTATION	ALIGNMENT, TIES, AND BENCHMARKS				F.A.P. RTE.	SECTION	COUNTY	TOTAL SHEETS	SHEET NO.
#FILES		DRAWN	REVISED						338	(112 & 113) WRS-5	DUPAGE	963	84
		CHECKED	REVISED		CONTRACT NO. 60131								
		DATE	REVISED		ILLINOIS FED. AID PROJECT								