

ADVANCE WARNING SIGN SEQUENCE DETAIL
WESTBOUND

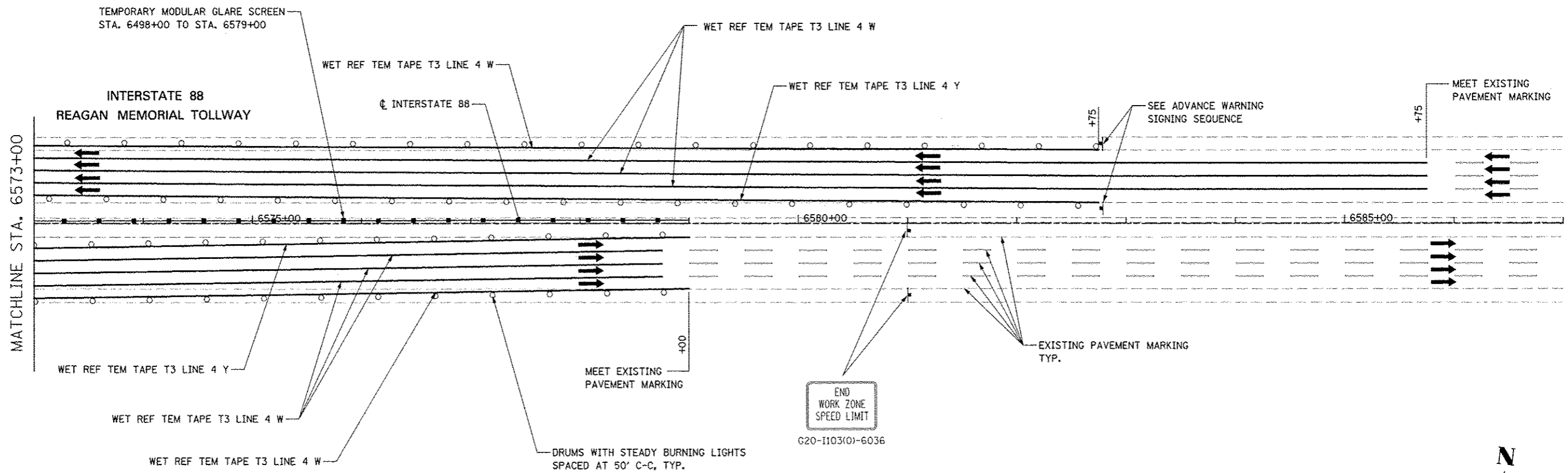

TOLLWAY TRAFFIC CONTROL

TRAFFIC CONTROL ON INTERSTATE 88 AND AT RAMP TERMINALS SHALL BE IN ACCORDANCE WITH THE FOLLOWING ILLINOIS TOLLWAY STANDARDS:

E1-02 CONSTRUCTION SIGNS
 E2-02 LANE CLOSURE DETAILS
 E3-02 SHOULDER CLOSURE DETAILS
 E4-01 MAINTENANCE OF TRAFFIC REVERSE CURVE
 E5-01 TEMPORARY GORE DETAILS

NOTES

1. LOCATION OF TRAILER MOUNTED FULL MATRIX PORTABLE CHANGEABLE MESSAGE SIGN SHALL BE COORDINATED WITH THE ENGINEER AND THE ILLINOIS TOLLWAY. MESSAGE TO BE DISPLAYED WILL BE REMOTELY CONTROLLED BY THE ILLINOIS TOLLWAY TRAFFIC MANAGEMENT CENTER.
2. THE TRAILER MOUNTED FULL MATRIX PORTABLE CHANGEABLE MESSAGE SIGN SHALL REMAIN IN PLACE FOR THE ENTIRE DURATION OF THE CONTRACT. NO ADDITIONAL COMPENSATION WILL BE ALLOWED FOR DELAYS EXTENDING THE CONTRACT BEYOND COMPLETION DATE AS SHOWN IN THE SPECIAL PROVISIONS.

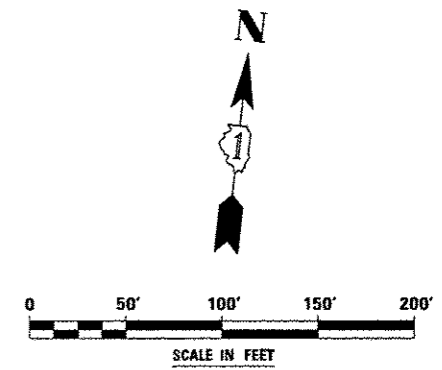

FILE NAME: #111111	USER NAME: #USER#	DESIGNED: PJO	REVISED: -	STATE OF ILLINOIS DEPARTMENT OF TRANSPORTATION	MAINTENANCE OF TRAFFIC - STAGE 1A INTERSTATE 88		F.A.P. RTE: 338	SECTION: (112 & 113) WRS-5	COUNTY: DUPAGE	TOTAL SHEETS: 963	SHEET NO.: 149	
		DRAWN: KES	REVISED: -		SCALE: 1" = 100'	SHEET NO. 33 OF 118 SHEETS	STA. 6573+00 TO STA. 6587+00	CONTRACT NO. 60131		ILLINOIS FED. AID PROJECT		
		CHECKED: JCM	REVISED: -									
		DATE: 10/15/2012	REVISED: -									