

REAGAN MEMORIAL TOLLWAY  
INTERSTATE 88

MATCH LINE STA. 4058+00

MATCH LINE STA. 4071+50  
(SEE STAGE 3)

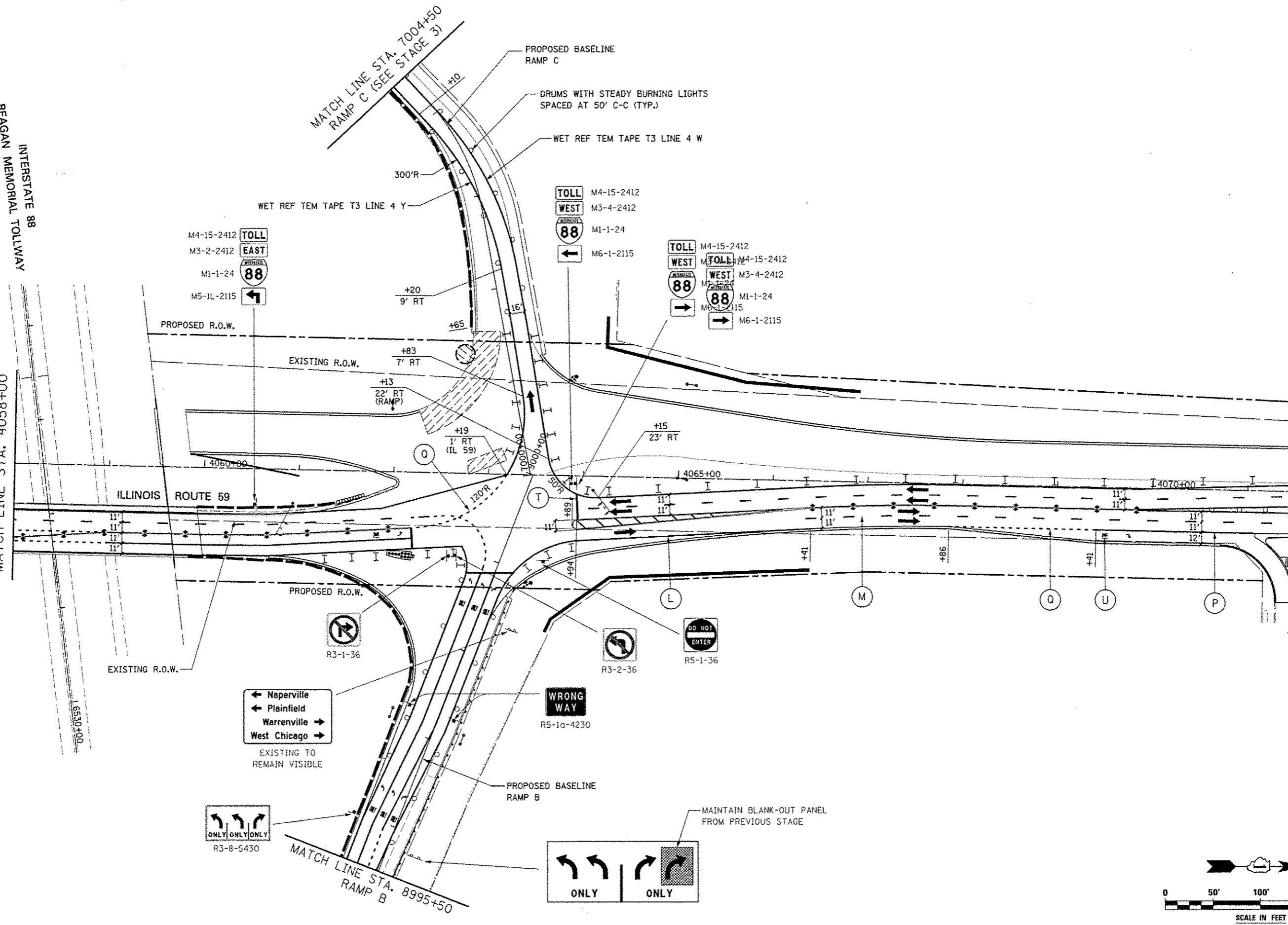

← Naperville  
← Plainfield  
Warrenville →  
West Chicago →  
EXISTING TO REMAIN VISIBLE

ONLY ONLY ONLY  
R3-8-5430

ONLY ONLY

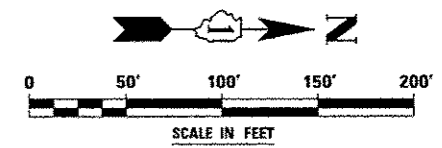

FILE NAME :	USER NAME : * USER#	DESIGNED : PJO	REVISED :	<b>STATE OF ILLINOIS DEPARTMENT OF TRANSPORTATION</b>	<b>MAINTENANCE OF TRAFFIC -- STAGE 3A ILLINOIS ROUTE 59</b>	F.A.P. RTE.:	SECTION:	COUNTY:	TOTAL SHEETS:	SHEET NO.:	
FILE# :		DRAWN : RES	REVISED :			338	(112 & 113)	WRS-5	DUPAGE	963	182
		CHECKED : JCM	REVISED :			CONTRACT NO. 60131					
		DATE : 10/15/2012	REVISED :			ILLINOIS FED. AID PROJECT					
				SCALE:		SHEET NO. 66 OF 118 SHEETS   STA. 4058+00 TO STA. 4065+00					