

TOLLWAY TRAFFIC CONTROL

TRAFFIC CONTROL ON INTERSTATE 88 AND AT RAMP TERMINALS SHALL BE IN ACCORDANCE WITH THE FOLLOWING ILLINOIS TOLLWAY STANDARDS:

- E1 CONSTRUCTION SIGNS
- E2 LANE CLOSURE DETAILS
- E3 SHOULDER CLOSURE DETAILS
- E4 MAINTENANCE OF TRAFFIC REVERSE CURVE
- E5 TEMPORARY GORE DETAILS

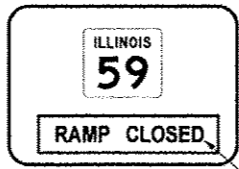

INSTALL TEMPORARY BLANK OUT PANEL WITH "RAMP CLOSED" (BLACK/ ORANGE) OVER "1/4 MILE" ON EXISTING GROUND MOUNTED SIGN IN THIS STAGE (SEE RAMP D DETOUR PLAN)

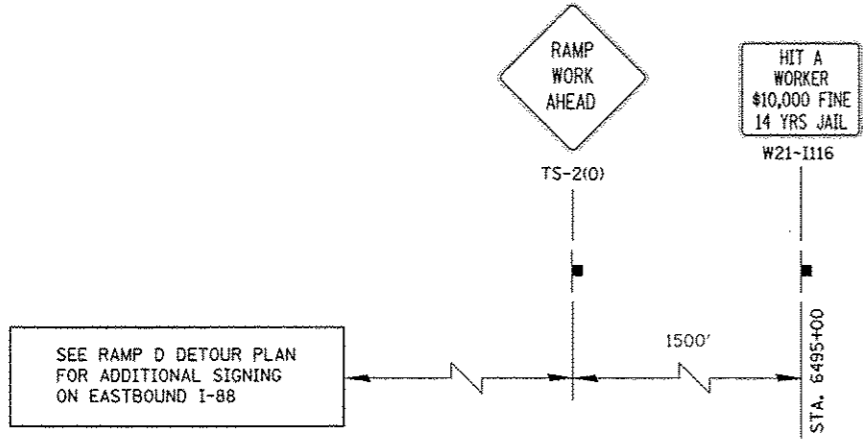

ADVANCE WARNING SIGN SEQUENCE DETAIL
EASTBOUND

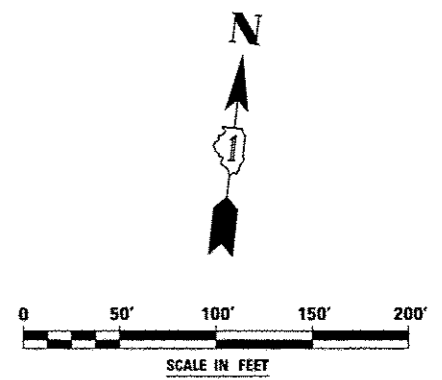

FILE NAME: 4FDLEL#	USER NAME: RUSERS	DESIGNED: PJO	REVISED: -	STATE OF ILLINOIS DEPARTMENT OF TRANSPORTATION	MAINTENANCE OF TRAFFIC - STAGE 3C INTERSTATE 88	F.A.P. RTE.	SECTION	COUNTY	TOTAL SHEETS	SHEET NO.	
		DRAWN: KES	REVISED: -			338	(112 & 113) WRS-5	DUPAGE	963	212	
		CHECKED: JCM	REVISED: -			CONTRACT NO. 60131					
		DATE: 10/15/2012	REVISED: -			ILLINOIS FED. AID PROJECT					
					SCALE:	SHEET NO. 96 OF 118 SHEETS STA. 6488+50 TO STA. 6496+00					