

ADVANCE WARNING SIGN SEQUENCE DETAIL  
WESTBOUND

SEE RAMP B DETOUR PLAN  
FOR ADDITIONAL SIGNING  
ON WESTBOUND I-88

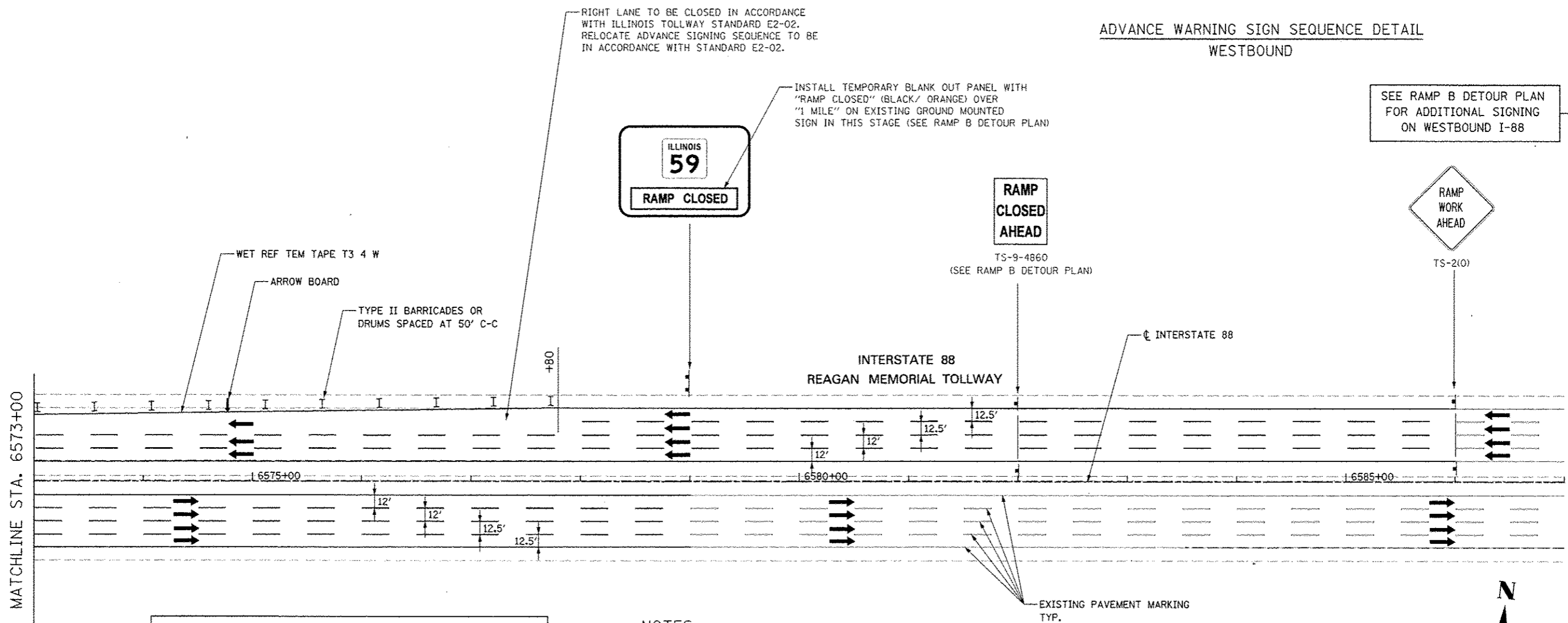

RIGHT LANE TO BE CLOSED IN ACCORDANCE WITH ILLINOIS TOLLWAY STANDARD E2-02. RELOCATE ADVANCE SIGNING SEQUENCE TO BE IN ACCORDANCE WITH STANDARD E2-02.

INSTALL TEMPORARY BLANK OUT PANEL WITH "RAMP CLOSED" (BLACK/ ORANGE) OVER "1 MILE" ON EXISTING GROUND MOUNTED SIGN IN THIS STAGE (SEE RAMP B DETOUR PLAN)

**TOLLWAY TRAFFIC CONTROL**

TRAFFIC CONTROL ON INTERSTATE 88 AND AT RAMP TERMINALS SHALL BE IN ACCORDANCE WITH THE FOLLOWING ILLINOIS TOLLWAY STANDARDS:

- E1 CONSTRUCTION SIGNS
- E2 LANE CLOSURE DETAILS
- E3 SHOULDER CLOSURE DETAILS
- E4 MAINTENANCE OF TRAFFIC REVERSE CURVE
- E5 TEMPORARY GORE DETAILS

**NOTES**

1. LOCATION OF TRAILER MOUNTED FULL MATRIX PORTABLE CHANGEABLE MESSAGE SIGN SHALL BE COORDINATED WITH THE ENGINEER AND THE ILLINOIS TOLLWAY. MESSAGE TO BE DISPLAYED WILL BE REMOTELY CONTROLLED BY THE ILLINOIS TOLLWAY TRAFFIC MANAGEMENT CENTER.
2. THE TRAILER MOUNTED FULL MATRIX PORTABLE CHANGEABLE MESSAGE SIGN SHALL REMAIN IN PLACE FOR THE ENTIRE DURATION OF THE CONTRACT. NO ADDITIONAL COMPENSATION WILL BE ALLOWED FOR DELAYS EXTENDING THE CONTRACT BEYOND COMPLETION DATE AS SHOWN IN THE SPECIAL PROVISIONS.

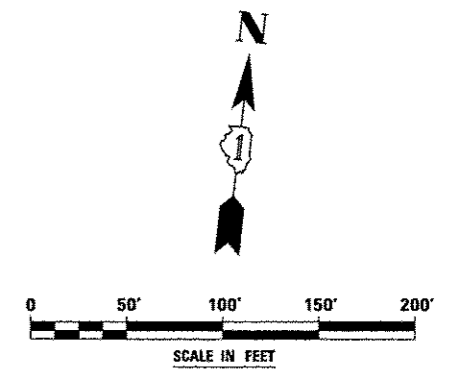

FILE NAME: 60131	USER NAME: RUSSELL	DESIGNED: PJO	REVISED: -	<b>STATE OF ILLINOIS DEPARTMENT OF TRANSPORTATION</b>	<b>MAINTENANCE OF TRAFFIC -- STAGE 3C INTERSTATE 88</b>	F.A.P. RTE.:	SECTION:	COUNTY:	TOTAL SHEETS:	SHEET NO.:	
		DRAWN: RES	REVISED: -			33B	(112 & 113) WRS-S	DUPAGE	963	215	
		CHECKED: JCM	REVISED: -			CONTRACT NO. 60131					
		DATE: 10/15/2012	REVISED: -			ILLINOIS FED. AID PROJECT					
				SCALE:		SHEET NO. 99 OF 118 SHEETS STA. 6573+00 TO STA. 6587+00					