

PERMANENT SIGN STRUCTURE
INSTALLED IN A PREVIOUS STAGE

MAINTAIN BLANK-OUT PANEL
OVER "RIGHT ONLY" FROM
PREVIOUS STAGE

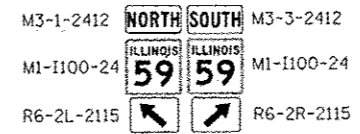

SIGN LEGEND

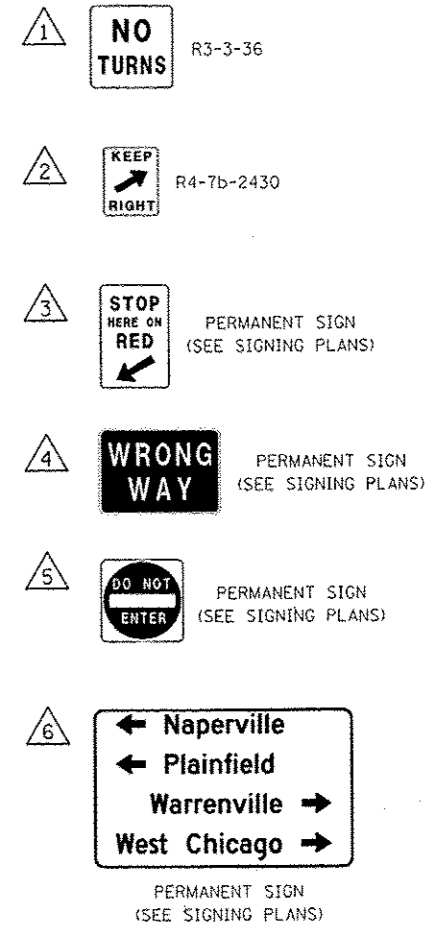

ALIGNMENT LEGEND

+39.5 INDICATES STATION MEASURED FROM SB BASELINE
+39.5 INDICATES STATION MEASURED FROM NB BASELINE

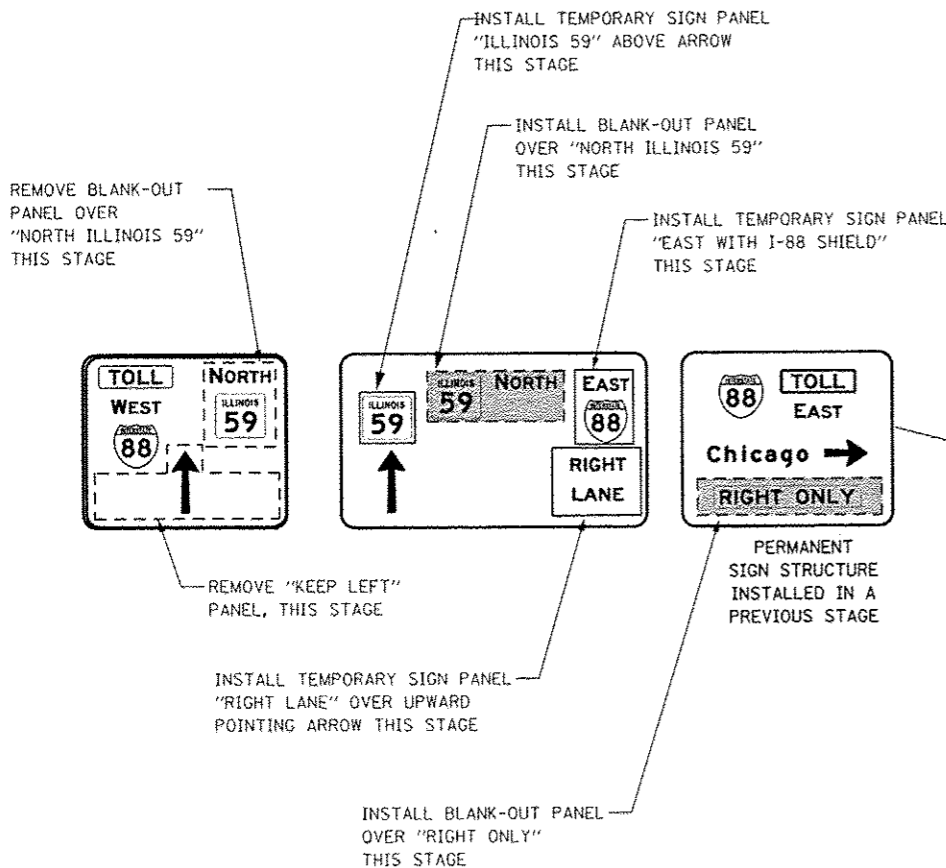

NOTES

1. PERMANENT SIGN INSTALLED ON SIGNAL MAST ARM TO BE VISIBLE THIS STAGE. SEE TRAFFIC SIGNAL PLANS.
2. ALL BLANK OUT PANELS AND TEMPORARY SIGN PANELS MOUNTED ON OVERHEAD SIGNS SHALL HAVE AN ORANGE BACKGROUND.

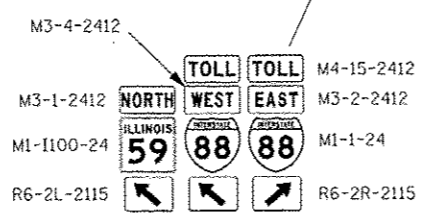

**STATE OF ILLINOIS
DEPARTMENT OF TRANSPORTATION**

**MAINTENANCE OF TRAFFIC - STAGE 4A
ILLINOIS ROUTE 59**

SCALE: SHEET NO. 111 OF 118 SHEETS STA. 4051+00 TO STA. 4058+00

F.A.P. RTE.	SECTION	COUNTY	TOTAL SHEETS	SHEET NO.
338	(112 & 113) WRS-5	DUPAGE	963	227
				CONTRACT NO. 60131
ILLINOIS FED. AID PROJECT				

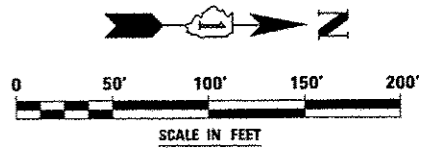

FILE NAME	USER NAME - RUSCH	DESIGNED - PJO	REVISED -
#FILE#		DRAWN - KES	REVISED -
		CHECKED - JCM	REVISED -
		DATE - 10/15/2012	REVISED -