

EB INTERSTATE 88

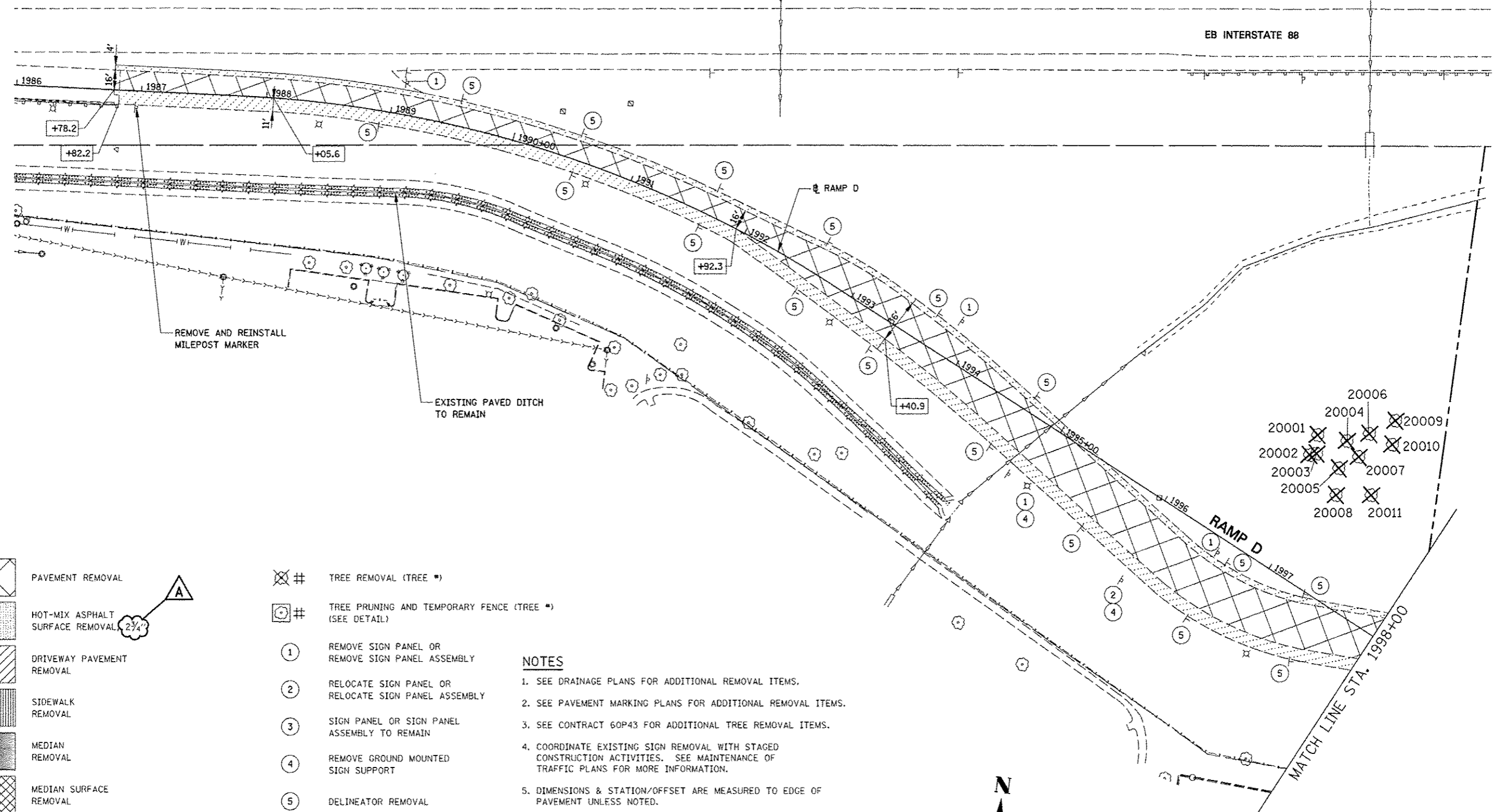

- 20001
- 20002
- 20003
- 20005
- 20006
- 20004
- 20007
- 20008
- 20009
- 20010
- 20011

LEGEND

- PAVEMENT REMOVAL
- HOT-MIX ASPHALT SURFACE REMOVAL
- DRIVEWAY PAVEMENT REMOVAL
- SIDEWALK REMOVAL
- MEDIAN REMOVAL
- MEDIAN SURFACE REMOVAL
- PAVED SHOULDER REMOVAL
- COMBINATION CURB AND GUTTER REMOVAL
- VARIOUS REMOVAL (AS NOTED)
- TREE REMOVAL (TREE *)
- TREE PRUNING AND TEMPORARY FENCE (TREE *) (SEE DETAIL)
- REMOVE SIGN PANEL OR REMOVE SIGN PANEL ASSEMBLY
- RELOCATE SIGN PANEL OR RELOCATE SIGN PANEL ASSEMBLY
- SIGN PANEL OR SIGN PANEL ASSEMBLY TO REMAIN
- REMOVE GROUND MOUNTED SIGN SUPPORT
- DELINEATOR REMOVAL
- STRUCTURE TO BE RECONSTRUCTED
- STRUCTURE TO BE ADJUSTED
- PR IL 59 STATIONING
- PR RAMP STATIONING

NOTES

1. SEE DRAINAGE PLANS FOR ADDITIONAL REMOVAL ITEMS.
2. SEE PAVEMENT MARKING PLANS FOR ADDITIONAL REMOVAL ITEMS.
3. SEE CONTRACT 60P43 FOR ADDITIONAL TREE REMOVAL ITEMS.
4. COORDINATE EXISTING SIGN REMOVAL WITH STAGED CONSTRUCTION ACTIVITIES. SEE MAINTENANCE OF TRAFFIC PLANS FOR MORE INFORMATION.
5. DIMENSIONS & STATION/OFFSET ARE MEASURED TO EDGE OF PAVEMENT UNLESS NOTED.
6. MEDIAN SURFACE REMOVAL DIMENSIONS ARE MEASURED FROM BACK OF CURB TO BACK OF CURB.

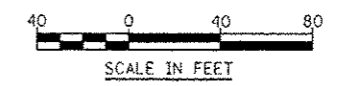
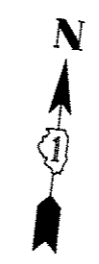

FILE NAME =	USER NAME = #USER#	DESIGNED <i>PJO</i>	REVISED - ADDENDUM A 12/17/2012
#FILE#		DRAWN <i>KES</i>	REVISED -
	PLOT SCALE = #SCALE#	CHECKED <i>JCM</i>	REVISED -
	PLOT DATE = #DATE#	DATE <i>10/15/2012</i>	REVISED -

**STATE OF ILLINOIS
DEPARTMENT OF TRANSPORTATION**

**REMOVAL PLANS
RAMP D**

F.A.P. RTE.	SECTION	COUNTY	TOTAL SHEETS	SHEET NO.
338	(112 & 113) WRS-5	DUPAGE	963	243
CONTRACT NO. 60131			ILLINOIS FED. AID PROJECT	

SCALE: SHEET NO. 9 OF 9 SHEETS STA. 1986+00 TO STA. 1998+00