

INFORMATION SHOWN IS FOR SOUTHBOUND PROFILE SEE NORTHBOUND PROFILE SHEETS FOR MORE INFORMATION

**NOTES**

- FOR PROPOSED ILLINOIS ROUTE 59 AND I-88 RAMP BASELINE INFORMATION SEE ALIGNMENT, BENCHMARKS AND TIES - ILLINOIS ROUTE 59 NORTHBOUND AND SOUTHBOUND BASELINE AND I-88 RAMP DATA SHEETS.
- FOR PROPOSED ILLINOIS ROUTE 59 AND I-88 RAMP PAVEMENT GEOMETRY INFORMATION SEE GEOMETRIC LAYOUT - ILLINOIS ROUTE 59 AND GEOMETRIC LAYOUT - I-88 RAMP SHEETS.
- FOR PROPOSED SIDEWALK, SHARED-USE PATH, AND FENCE INFORMATION SEE SIDEWALK / SHARED-USE PATH/ FENCE PLANS.
- FOR PROPOSED BRIDGE STRUCTURES, APPROACH PAVEMENTS, AND RETAINING WALLS SEE STRUCTURAL PLANS.
- FOR COMBINATION CURB AND GUTTER INFORMATION SEE GEOMETRIC LAYOUT - ILLINOIS ROUTE 59 CHANNELIZATION ISLAND DETAILS SHEET.
- FOR PROPOSED GRADING INFORMATION SEE PAVEMENT JOINTING AND ELEVATION PLANS.

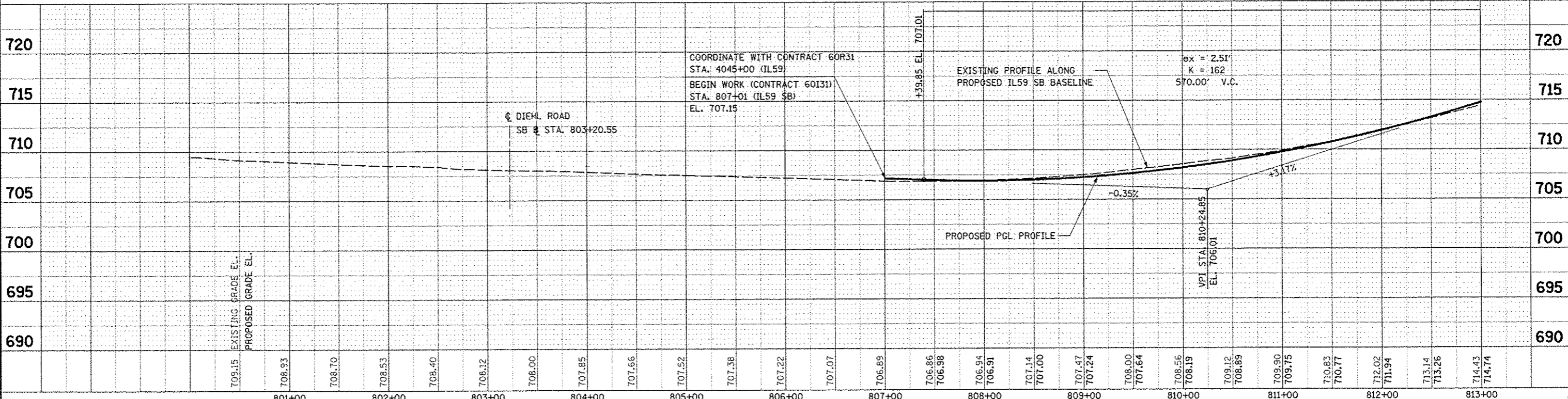
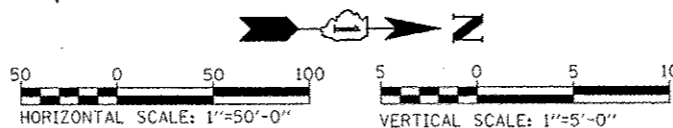
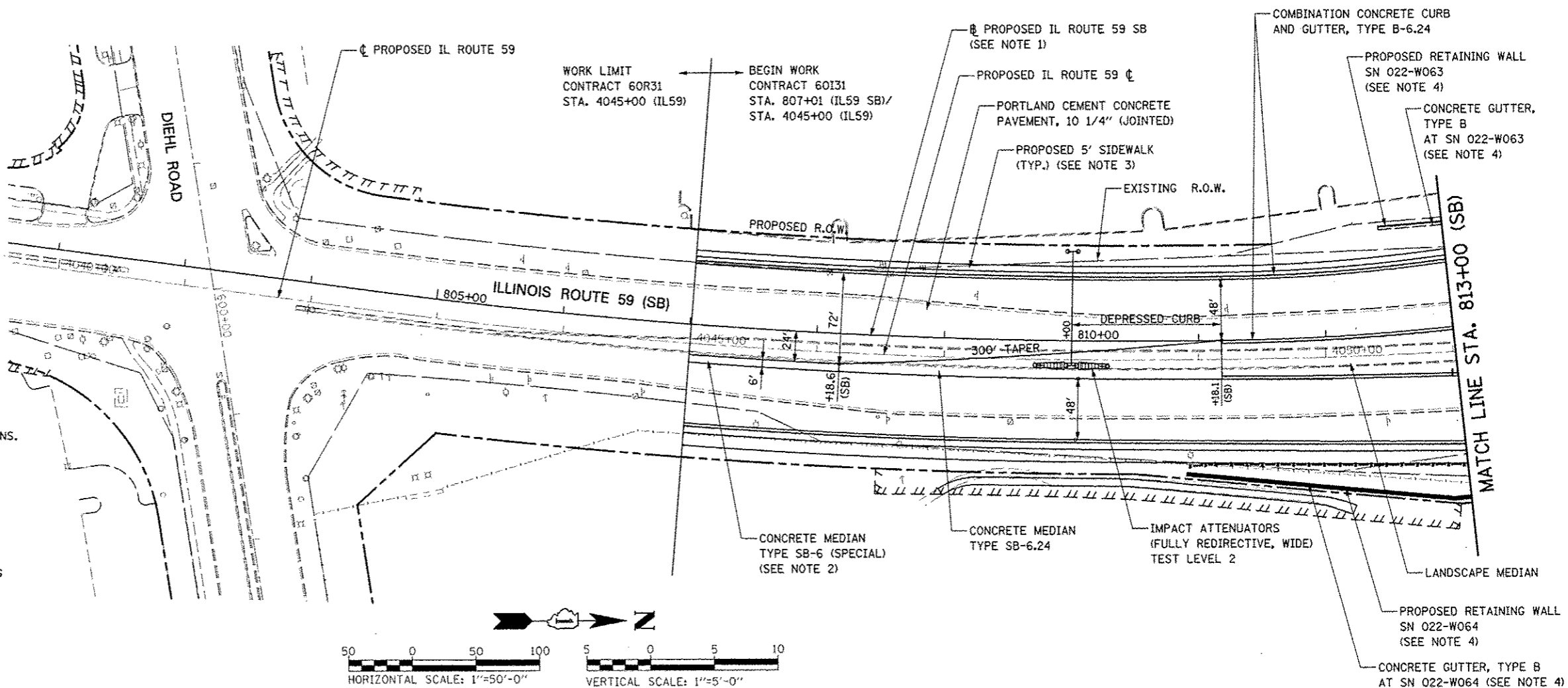

|                      |                   |               |                  |   |   |                           |                           |                    |                  |               |  |
|----------------------|-------------------|---------------|------------------|---|---|---------------------------|---------------------------|--------------------|------------------|---------------|--|
| FILE NAME:<br>#FILE# | USER NAME: BUSCRS | DESIGNED: PJO | REVISIONS:       | STATE OF ILLINOIS<br>DEPARTMENT OF TRANSPORTATION | PLAN AND PROFILE - ILLINOIS ROUTE 59 (SB) | F.A.P. RTE. 338           | SECTION (112 & 113) WRS-5 | COUNTY DUPAGE      | TOTAL SHEETS 963 | SHEET NO. 249 |  |
| PLT1 SCALE: #SCALE#  | PLT1 DATE: #DATE# | CHECKED: JCM  | DATE: 10/15/2012 | SCALE: AS SHOWN                                   | SHEET NO. 5 OF 18 SHEETS                  | STA. 807+01               | TO STA. 813+00            | CONTRACT NO. 60I31 |                  |               |  |
|                      |                   |               |                  |   |   | ILLINOIS FED. AID PROJECT |                           |                    |                  |               |  |