

DATE	
BY	
PROJECT	
LOCATION	
NOTE BOOK	
NO.	
FILE NAME	

DATE	
BY	
PROJECT	
LOCATION	
NOTE BOOK	
NO.	
FILE NAME	

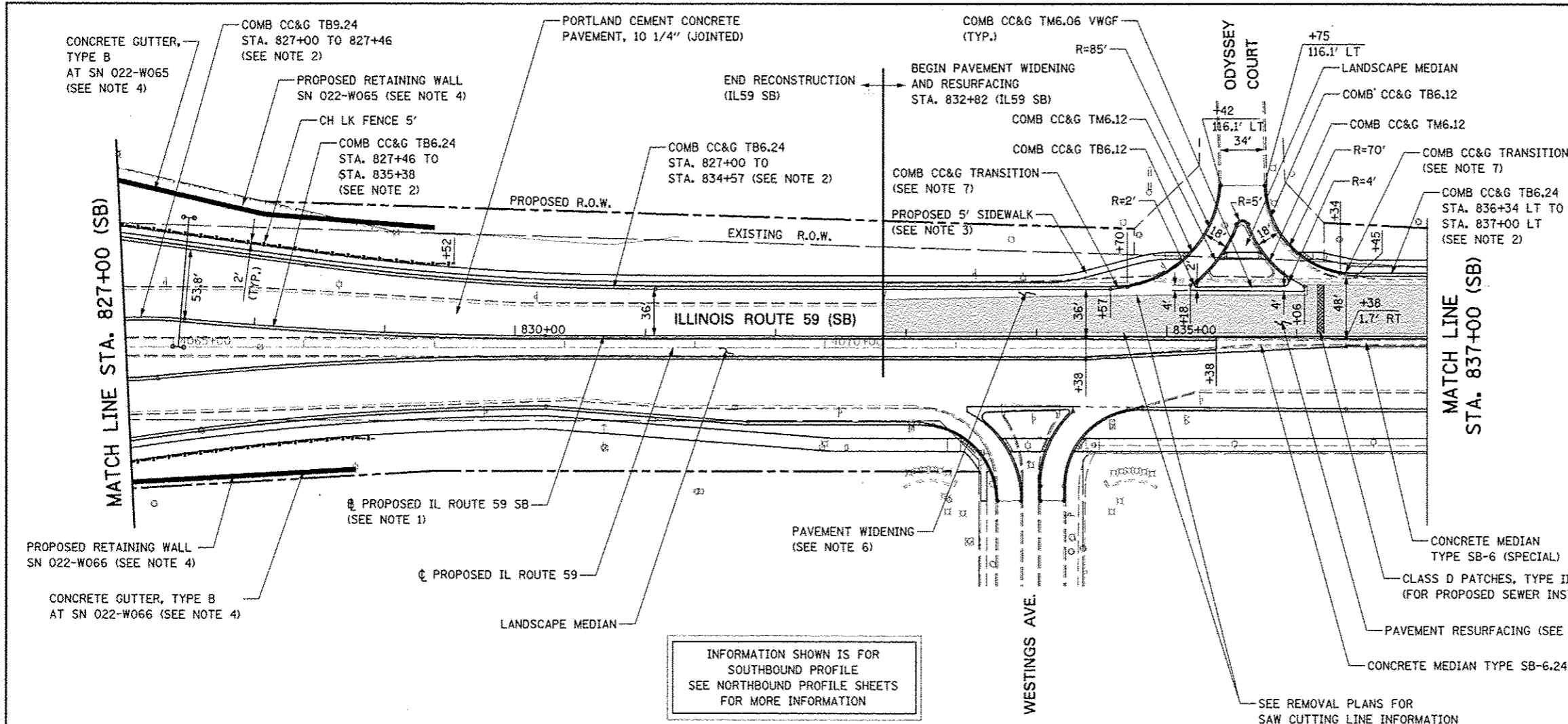

- ### NOTES
- FOR PROPOSED ILLINOIS ROUTE 59 AND I-88 RAMP BASELINE INFORMATION SEE ALIGNMENT, BENCHMARKS, AND TIES - ILLINOIS ROUTE 59 NORTHBOUND & SOUTHBOUND BASELINE AND I-88 RAMP DATA SHEETS.
  - FOR PROPOSED ILLINOIS ROUTE 59 AND I-88 RAMP PAVEMENT GEOMETRY INFORMATION SEE GEOMETRIC LAYOUT - ILLINOIS ROUTE 59 AND GEOMETRIC LAYOUT - I-88 RAMP SHEETS.
  - FOR PROPOSED SIDEWALK, SHARED-USE PATH, AND FENCE INFORMATION SEE SIDEWALK / SHARED-USE PATH/ FENCE PLANS.
  - FOR PROPOSED BRIDGE STRUCTURES, APPROACH PAVEMENTS, AND RETAINING WALLS SEE STRUCTURAL PLANS.
  - PAVEMENT RESURFACING SHALL CONSIST OF POLYMERIZED HMA SURFACE COURSE, MIX "F", N90, 2", LEVELING BINDER (MACHINE METHOD), N70, 3/4".
  - PAVEMENT WIDENING SHALL CONSIST OF THE FOLLOWING: HOT-MIX ASPHALT PAVEMENT (FULL-DEPTH), 10 1/4" AGGREGATE SUBGRADE IMPROVEMENT, 12" GEOTECHNICAL FABRIC FOR GROUND STABILIZATION.
  - ALL WORK REQUIRED FOR THE CONSTRUCTION OF COMBINATION CONCRETE CURB AND GUTTER TRANSITION SHALL BE PAID FOR AS COMBINATION CONCRETE CURB AND GUTTER, TYPE B-6.24.
  - FOR PROPOSED GRADING INFORMATION SEE PAVEMENT JOINTING AND ELEVATION PLANS.

INFORMATION SHOWN IS FOR SOUTHBOUND PROFILE SEE NORTHBOUND PROFILE SHEETS FOR MORE INFORMATION

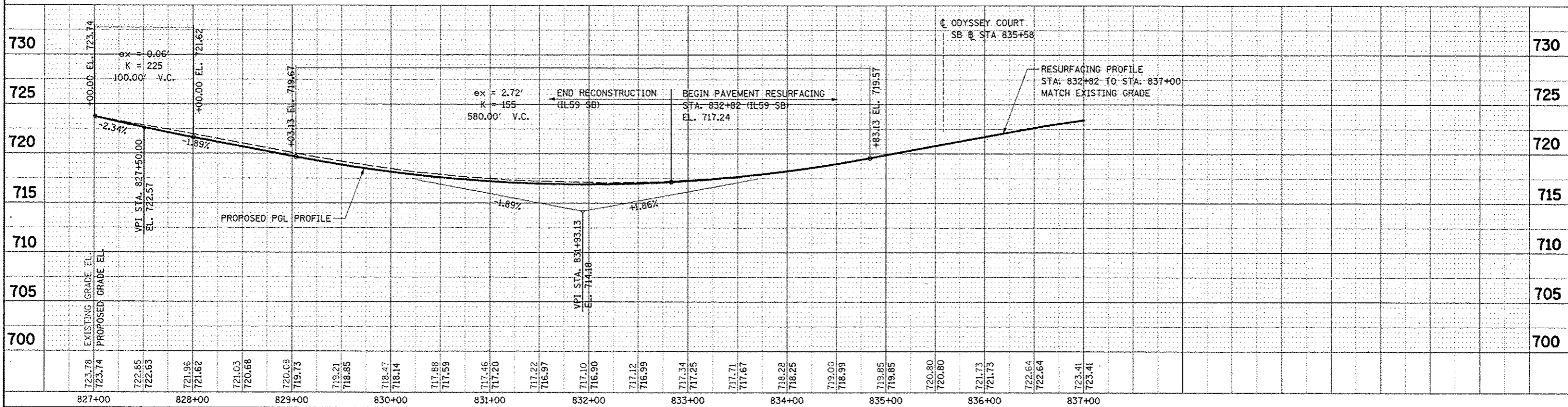
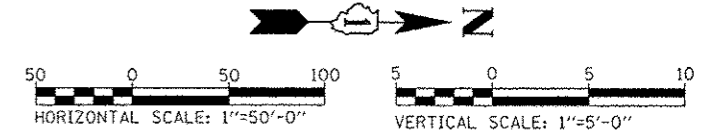

FILE NAME	USER NAME	DESIGNED	REVISIONS	F.A.P. RTE.	SECTION	COUNTY	TOTAL SHEET NO.
		PJO		338	(112 & 113) WRS-5	DUPAGE	963
DESIGNED	CHECKED	DATE	REVISIONS	SCALE: AS SHOWN		SHEET NO. 7 OF 18 SHEETS	
KE'S	JCM	10/15/2012		STA. 827+00 TO STA. 837+00		CONTRACT NO. 60131	
STATE OF ILLINOIS DEPARTMENT OF TRANSPORTATION				ILLINOIS FED. AID PROJECT			