

PLAN	DATE
NOTE BOOK	BY
NO. OF REV. CHECKED	BY
NO.	DATE

PROFILE	DATE
NO. OF REV. CHECKED	BY
NO.	DATE

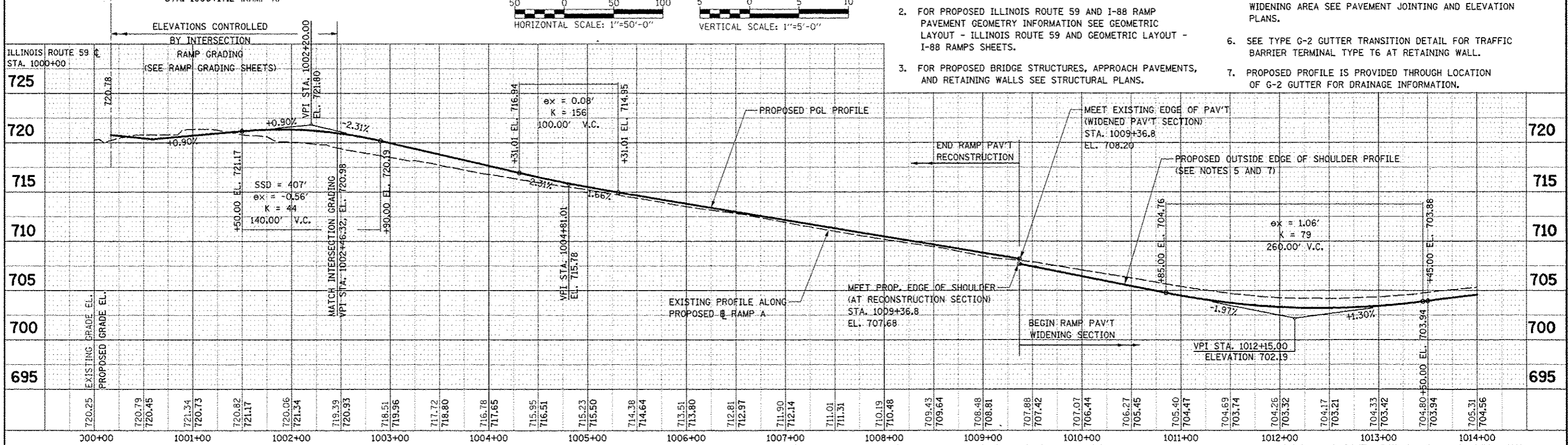
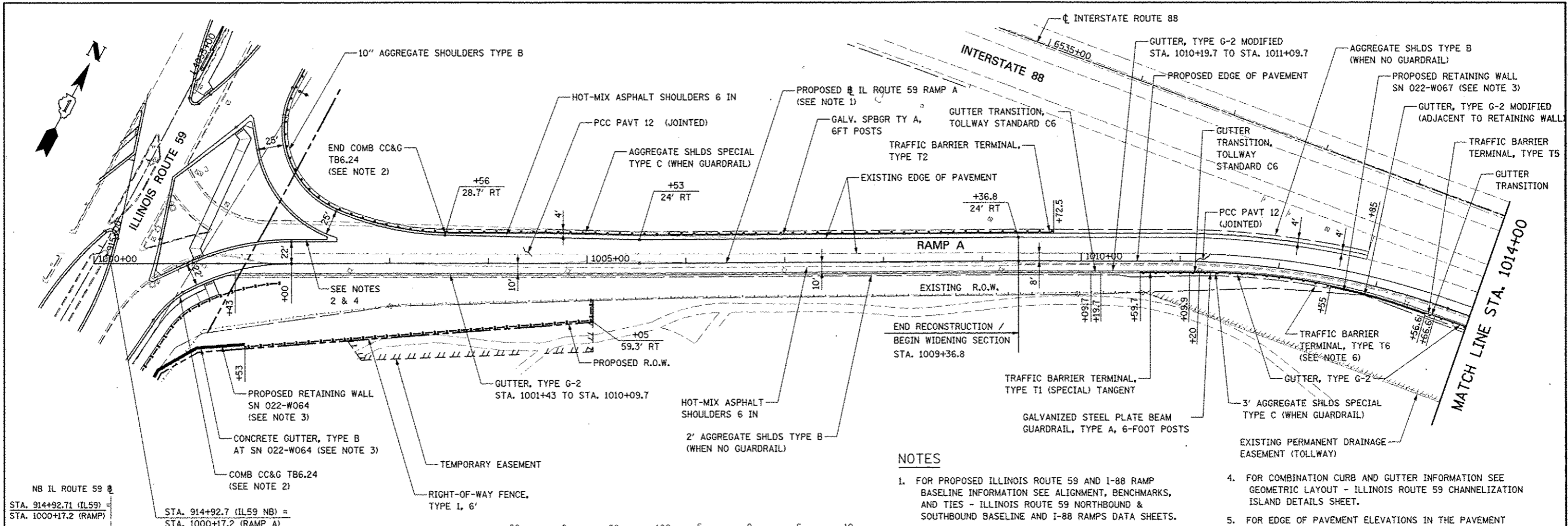

NOTES

- FOR PROPOSED ILLINOIS ROUTE 59 AND I-88 RAMP BASELINE INFORMATION SEE ALIGNMENT, BENCHMARKS, AND TIES - ILLINOIS ROUTE 59 NORTHBOUND & SOUTHBOUND BASELINE AND I-88 RAMP DATA SHEETS.
- FOR PROPOSED ILLINOIS ROUTE 59 AND I-88 RAMP PAVEMENT GEOMETRY INFORMATION SEE GEOMETRIC LAYOUT - ILLINOIS ROUTE 59 AND GEOMETRIC LAYOUT - I-88 RAMP SHEETS.
- FOR PROPOSED BRIDGE STRUCTURES, APPROACH PAVEMENTS, AND RETAINING WALLS SEE STRUCTURAL PLANS.
- FOR COMBINATION CURB AND GUTTER INFORMATION SEE GEOMETRIC LAYOUT - ILLINOIS ROUTE 59 CHANNELIZATION ISLAND DETAILS SHEET.
- FOR EDGE OF PAVEMENT ELEVATIONS IN THE PAVEMENT WIDENING AREA SEE PAVEMENT JOINTING AND ELEVATION PLANS.
- SEE TYPE G-2 GUTTER TRANSITION DETAIL FOR TRAFFIC BARRIER TERMINAL TYPE T6 AT RETAINING WALL.
- PROPOSED PROFILE IS PROVIDED THROUGH LOCATION OF G-2 GUTTER FOR DRAINAGE INFORMATION.

FILE NAME:	USER NAME: KUSER	DESIGNED: PJO	REVISED:	STATE OF ILLINOIS DEPARTMENT OF TRANSPORTATION	PLAN AND PROFILE - RAMP A				F.A.P. RTE.:	SECTION:	COUNTY:	TOTAL SHEETS:	SHEET NO.:
#FILE#:		DRAWN: RES	REVISED:		338	(112 & 113) WRS-5	DUPAGE	963	253				
PLOT SCALE: 1"=50'-0"	CHECKED: JCM	REVISED:	SCALE: AS SHOWN		SHEET NO. 9 OF 18 SHEETS	STA. 1000+00 TO STA. 1014+00	ILLINOIS	FED. AID PROJECT					
PLOT DATE: 10/15/2012	DATE: 10/15/2012	REVISED:	CONTRACT NO. 60131										