





**REMOVAL LEGEND**

-  HOT-MIX ASPHALT SURFACE REMOVAL, 2"
-  MEDIAN SURFACE REMOVAL
-  COMBINATION CURB AND GUTTER REMOVAL

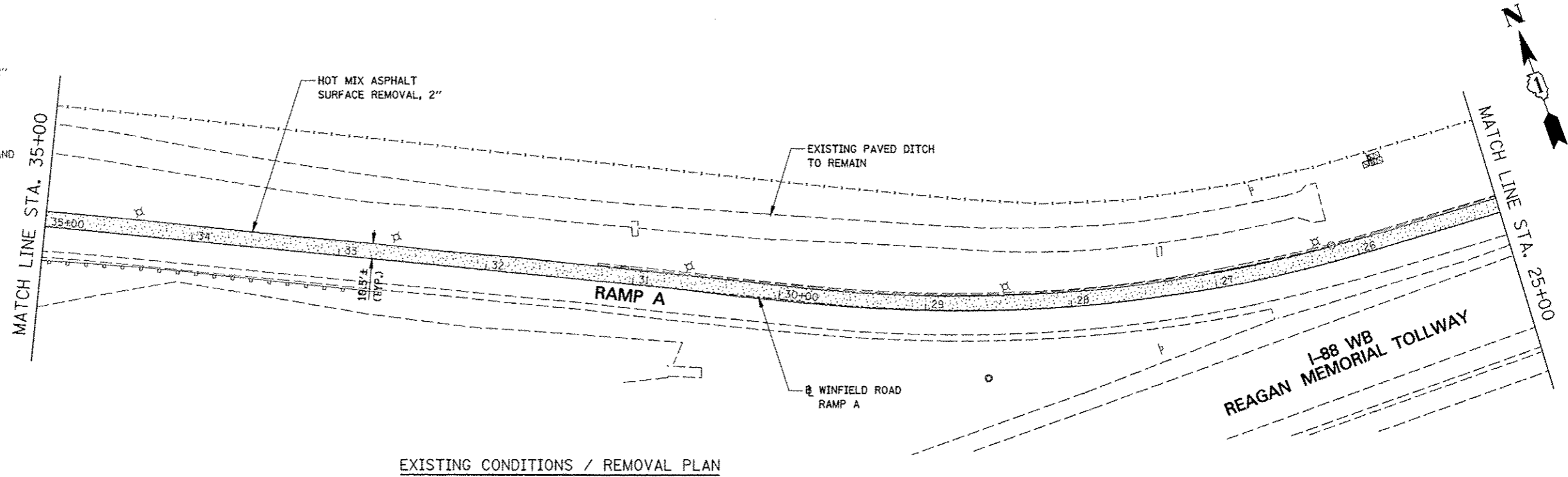

**EXISTING CONDITIONS / REMOVAL PLAN**

**LEGEND**

-  HOT-MIX ASPHALT SURFACE COURSE, MIX "D", N70

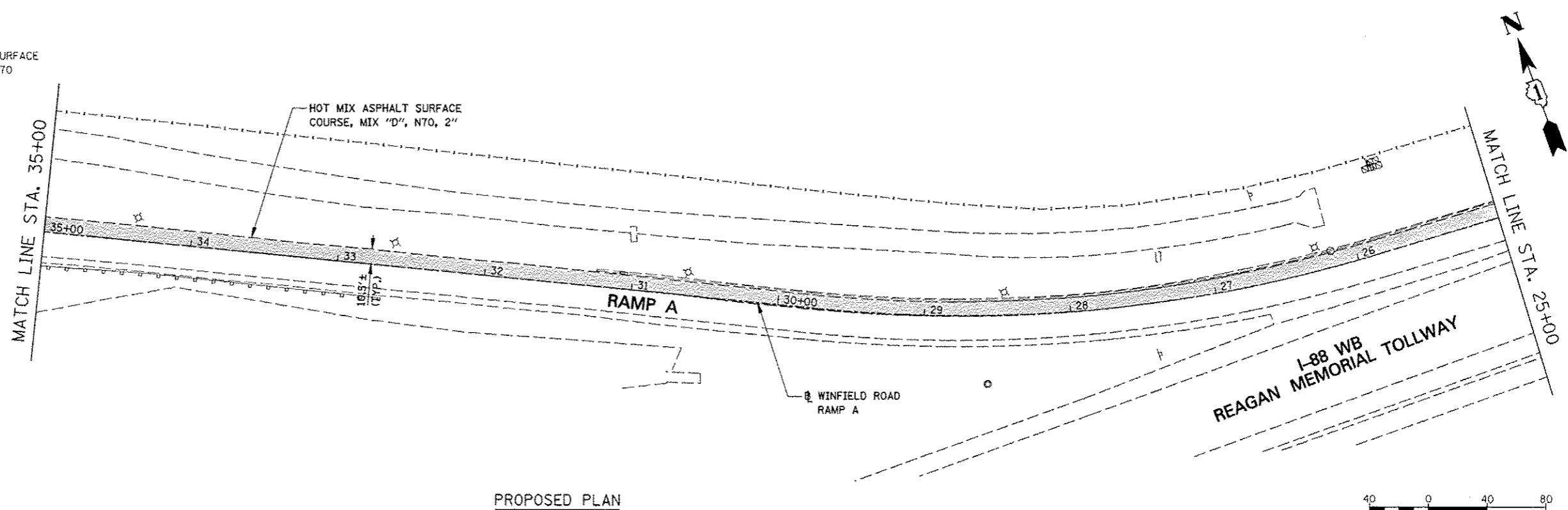

**PROPOSED PLAN**

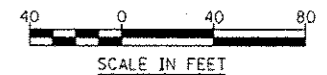

FILE NAME :	USER NAME : *USER*	DESIGNED <i>PJO</i>	REVISED - ADDENDUM A 12/17/2012
*FILEL*		DRAWN <i>KES</i>	REVISED -
	PLOT SCALE : *SCALE*	CHECKED <i>JCM</i>	REVISED -
	PLOT DATE : *DATE*	DATE <i>12/17/2012</i>	REVISED -

**STATE OF ILLINOIS  
DEPARTMENT OF TRANSPORTATION**

**REMOVAL AND PROPOSED PLAN  
WINFIELD ROAD RAMP A**

SCALE: 1" = 40' SHEET NO. 2 OF 4 SHEETS STA. 35+00 TO STA. 25+00

F.A.P. RTE.	SECTION	COUNTY	TOTAL SHEETS	SHEET NO.
338	(112 & 113) WRS-5	DUPAGE	963	262B
				CONTRACT NO. 60131
ILLINOIS FED. AID PROJECT				