

MATCH LINE STA. 4055+50

MATCH LINE STA. 4061+25

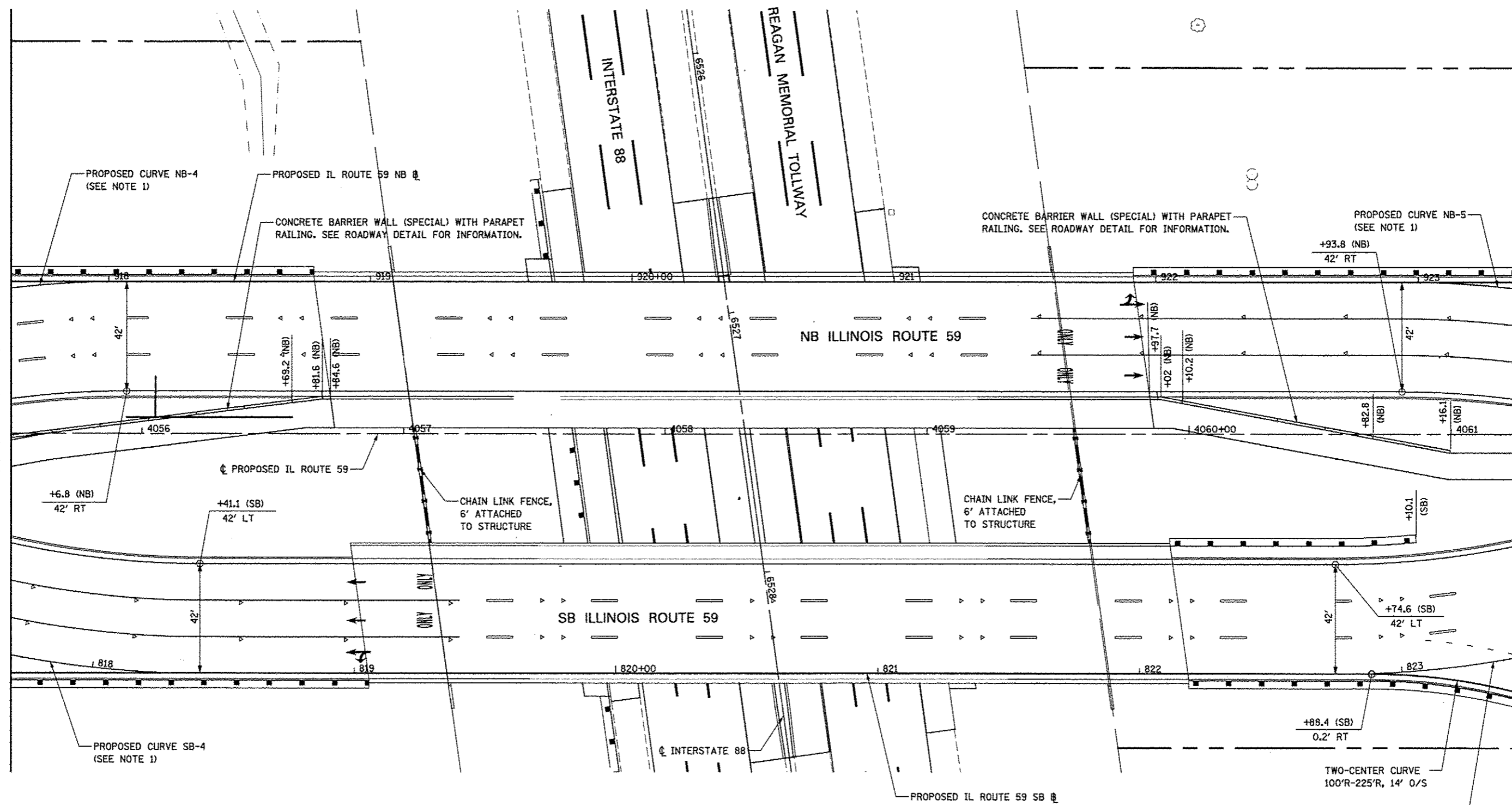

**NOTES**

- FOR PROPOSED ILLINOIS ROUTE 59 AND I-88 RAMP BASELINE INFORMATION SEE ALIGNMENT, BENCHMARKS, AND TIES - ILLINOIS ROUTE 59 NORTHBOUND & SOUTHBOUND BASELINE AND I-88 RAMP DATA SHEETS.
- FOR PROPOSED PAVEMENT, CURB & GUTTER, AND PROFILE INFORMATION SEE PLAN / PROFILE - ILLINOIS ROUTE 59 AND PLAN / PROFILE - I-88 RAMP SHEETS.
- FOR PROPOSED PAVEMENT MARKING & SIGNAGE INFORMATION SEE PAVEMENT MARKING AND SIGNING - ILLINOIS ROUTE 59 AND PAVEMENT MARKING AND SIGNING - I-88 RAMP SHEETS.
- FOR PROPOSED SIDEWALK AND SHARED-USE PATH INFORMATION SEE SIDEWALK / SHARED-USE PATH PLANS.

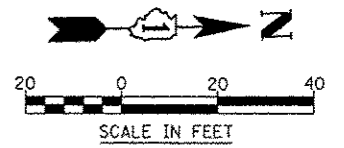

FILE NAME #FILCL#	USER NAME #USER#	DESIGNED PJO	REVISED -	<b>STATE OF ILLINOIS DEPARTMENT OF TRANSPORTATION</b>	<b>GEOMETRIC LAYOUT - ILLINOIS ROUTE 59</b>			F.A.P. RTE. 338	SECTION (112 & 113) WRS-5	COUNTY DUPAGE	TOTAL SHEETS 963	SHEET NO. 265
		DRAWN KES	REVISED -		SCALE: AS SHOWN	SHEET NO. 3 OF 21 SHEETS	STA. 4055+50 TO STA. 4061+25	CONTRACT NO. 60131				
		CHECKED JCM	REVISED -		ILLINOIS FED. AID PROJECT							
		DATE 10/15/2012	REVISED -									