

FOR CONTINUATION SEE ILLINOIS ROUTE 59 SHEETS

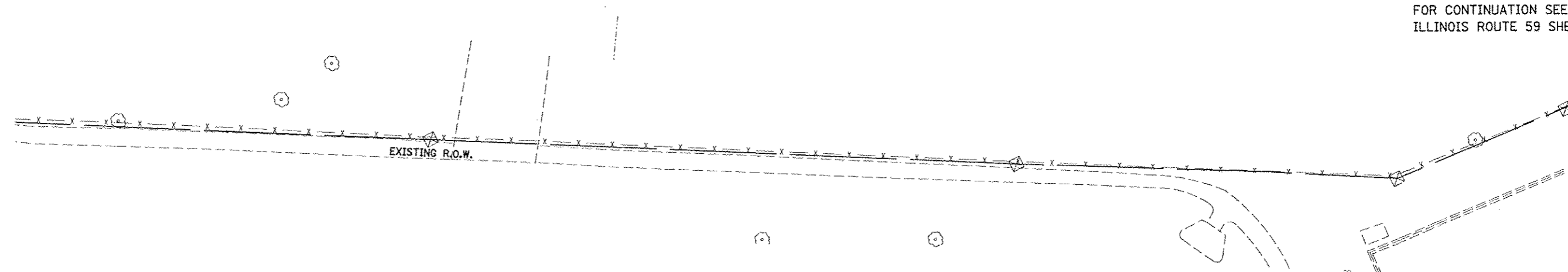

NOTES

1. FOR PROPOSED ILLINOIS ROUTE 59 AND I-88 RAMP BASELINE INFORMATION SEE ALIGNMENT, BENCHMARKS, AND TIES - ILLINOIS ROUTE 59 NORTHBOUND & SOUTHBOUND BASELINE AND I-88 RAMP DATA SHEETS.
2. FOR PROPOSED PAVEMENT, CURB & GUTTER, AND PROFILE INFORMATION SEE PLAN / PROFILE - ILLINOIS ROUTE 59 AND PLAN / PROFILE - I-88 RAMP SHEETS.
3. FOR PROPOSED PAVEMENT MARKING & SIGNAGE INFORMATION SEE PAVEMENT MARKING AND SIGNING - ILLINOIS ROUTE 59 AND PAVEMENT MARKING AND SIGNING - I-88 RAMP SHEETS.
4. TRANSITION WIDTH OF HMA SHOULDER TO MEET COMB CC&G TB6.24 (4' TO 2').

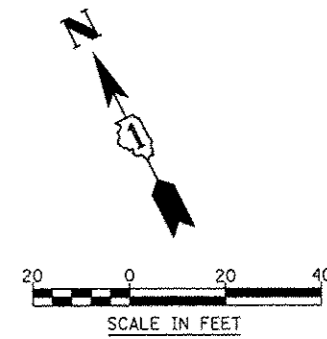

FILE NAME	USER NAME	DESIGNED	REVISED	STATE OF ILLINOIS DEPARTMENT OF TRANSPORTATION	GEOMETRIC LAYOUT - RAMP D	F.A.P. RTE.	SECTION	COUNTY	TOTAL SHEETS	SHEET NO.	
#FILE#		DRAWN	REVISED			338	(112 & 113) WRS-5	DUPAGE	963	282	
		CHECKED	REVISED			CONTRACT NO. 60131					
		DATE	REVISED			ILLINOIS FED. AID PROJECT					
				SCALE: AS SHOWN		SHEET NO. 20 OF 21 SHEETS		STA. 1992+50 TO STA. 1998+00			