

MATCH LINE STA. 1014+00  
SEE DRAWING DE-08

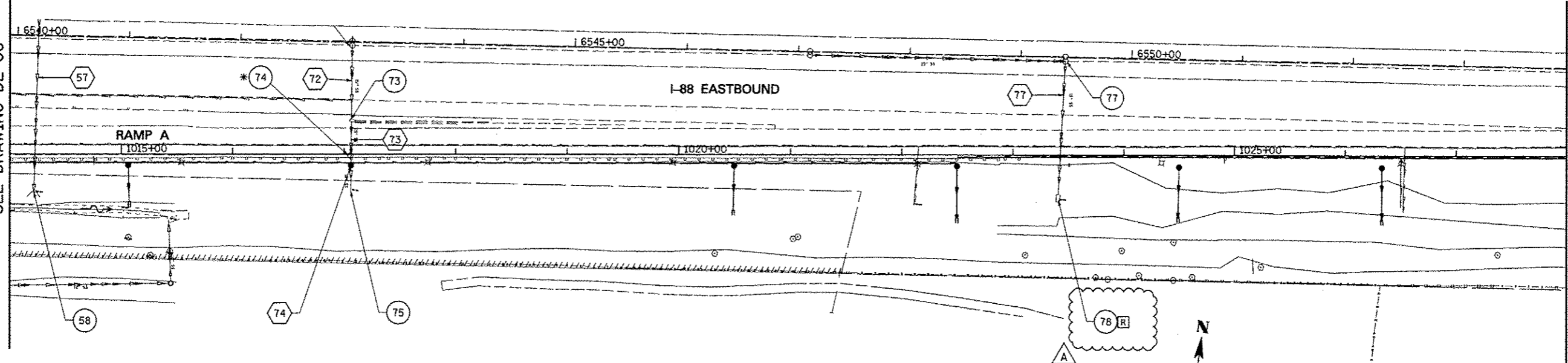

\* REMOVE CATCH BASIN TO MAINTAIN FLOW.

NOTE:  
1. SEE DRAWING DN-01 FOR EXISTING DRAINAGE LEGEND.

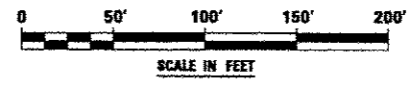

MATCH LINE STA. 1028+00  
SEE BELOW

MATCH LINE STA. 1028+00  
SEE ABOVE

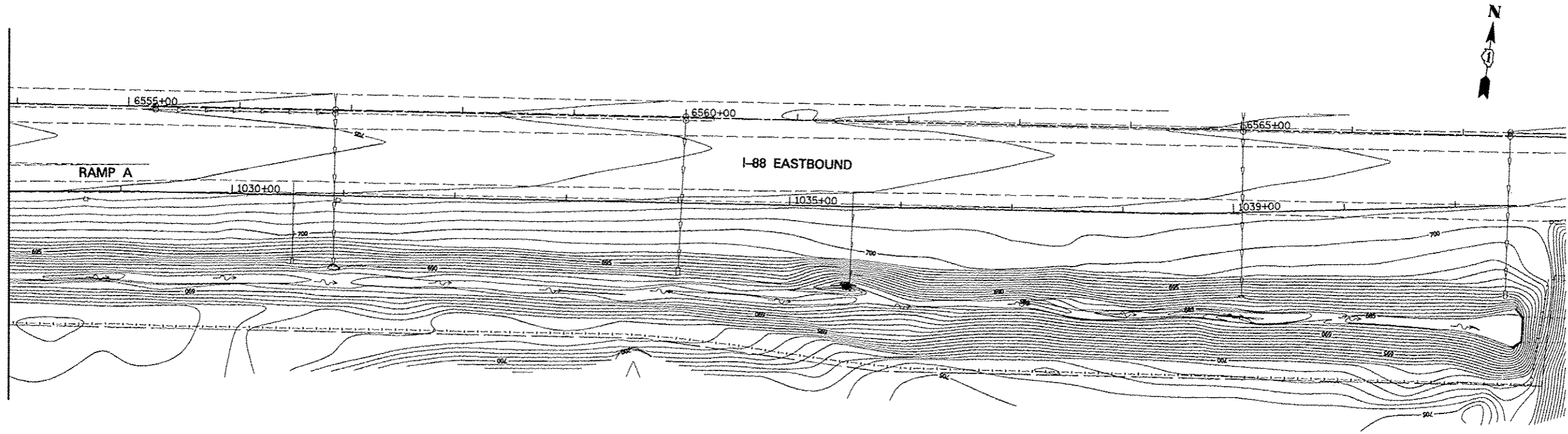

FILE NAME * #FILE#	USER NAME * #USER#	DESIGNED <i>PJO</i>	REVISED ADDENDUM A 12/17/2012	<b>STATE OF ILLINOIS DEPARTMENT OF TRANSPORTATION</b>	<b>EXISTING DRAINAGE PLAN - RAMP A</b>	F.A.P. RTE.	SECTION	COUNTY	TOTAL SHEETS	SHEET NO.
		DRAWN <i>KES</i>	REVISED -			338	(112 & 113) WRS-5	DUPAGE	963	336
		CHECKED <i>JCM</i>	REVISED -			<b>DE-09</b>		CONTRACT NO. 60131		
		DATE <i>10/15/2012</i>	REVISED -			SCALE: 1"=50'	SHEET NO. 9 OF 10 SHEETS	STA. 1014+00 TO STA. 1028+00	ILLINOIS FED. AID PROJECT	