

SEE SIGN STRUCTURE DETAIL SHEET

NOTES

1. TRAFFIC SIGN TO BE MOUNTED TO SIGNAL MAST ARM. SEE PROPOSED TRAFFIC SIGNAL PLANS.
2. THIS SIGNAL POLE CONTAINS PEDESTRIAN PUSH BUTTON(S). EACH PUSH BUTTON SHALL HAVE REGULATORY SIGN R10-36-915 (LEGEND 10R/10L) INSTALLED ABOVE THE PUSH BUTTON. SEE PEDESTRIAN BUTTON SIGN MOUNT DETAIL ON REGULATORY SIGN LEGEND SHEET.
3. PAVEMENT MARKINGS AND RAISED REFLECTIVE PAVEMENT MARKERS SHALL BE PLACED IN ACCORDANCE WITH IDOT DISTRICT 1 DETAILS TC-11 AND TC-13.
4. SIGN LOCATIONS MAY VARY BASED ON FIELD CONDITIONS.
5. ALL POST-MOUNTED SIGNS SHALL BE MOUNTED ON TELESCOPING POLES IN ACCORDANCE WITH HIGHWAY STANDARD 728001 UNLESS OTHERWISE NOTED.

SYMBOL LEGEND

- INDICATES SIGN IS MOUNTED TO A TRAFFIC SIGNAL POLE (TYP.)
- 1 REGULATORY SIGN (R SERIES)
- 1 WARNING SIGN (W SERIES)
- 1 GUIDE SIGN (D/M SERIES)
- 1 SPECIAL/OTHER SIGNS

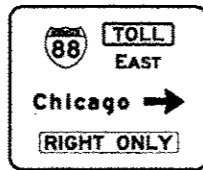
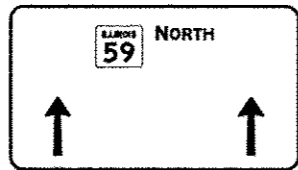
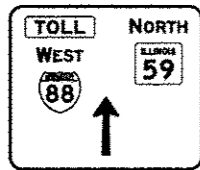

SEE SIGN STRUCTURE DETAIL SHEET

FOR PAVEMENT MARKINGS SEE SHEET 2 OF 21

SIGN LEGEND

- 3 R3-2-36
- 4 R3-1-36
- 9 R10-6-2436

- 10R R10-36R-915
- 10L R10-36L-915

- 12R ONE WAY R6-1R-3612
- 12L ONE WAY R6-1L-3612
- 13 KEEP RIGHT R4-7b-2430
- 15 KEEP LEFT R4-8b-2430
- 16 DO NOT ENTER R5-1-36

- 17 NO TURNS R3-3-36
- 18 NO TURN ON RED R10-11a-3648
- 23 WRONG WAY R5-1a-4230
- 26 ONLY ONLY R3-8-5430

- 2 W11-2-36 AHEAD W16-9P-2412
- 3 W11-2-36 W16-7L-2412
- 7 W4-3L-36

- 6 M3-4-2412 TOLL NORTH WEST EAST M4-15-2412 M3-2-2412 M1-1100-24 ILLINOIS 59 88 88 M1-1-24 M6-2L-2115 M6-2R-2115
- 8 TOLL M4-15-2412 WEST M3-4-2412 M1-1-24 M5-2L-2115
- 11 M3-1-2412 NORTH SOUTH M3-3-2412 ILLINOIS ILLINOIS 59 59 M1-1100-24 M6-2L-2115 M6-2R-2115

- 15 Warrenville West Chicago Naperville Plainfield

D1-3-8448 DESTINATION GUIDE RELOCATE SIGN PANEL TYPE 3 ON NEW WOOD SIGN SUPPORTS

ALIGNMENT LEGEND

- +39.5 INDICATES STATION MEASURED FROM SB BASELINE
- +39.5 INDICATES STATION MEASURED FROM NB BASELINE

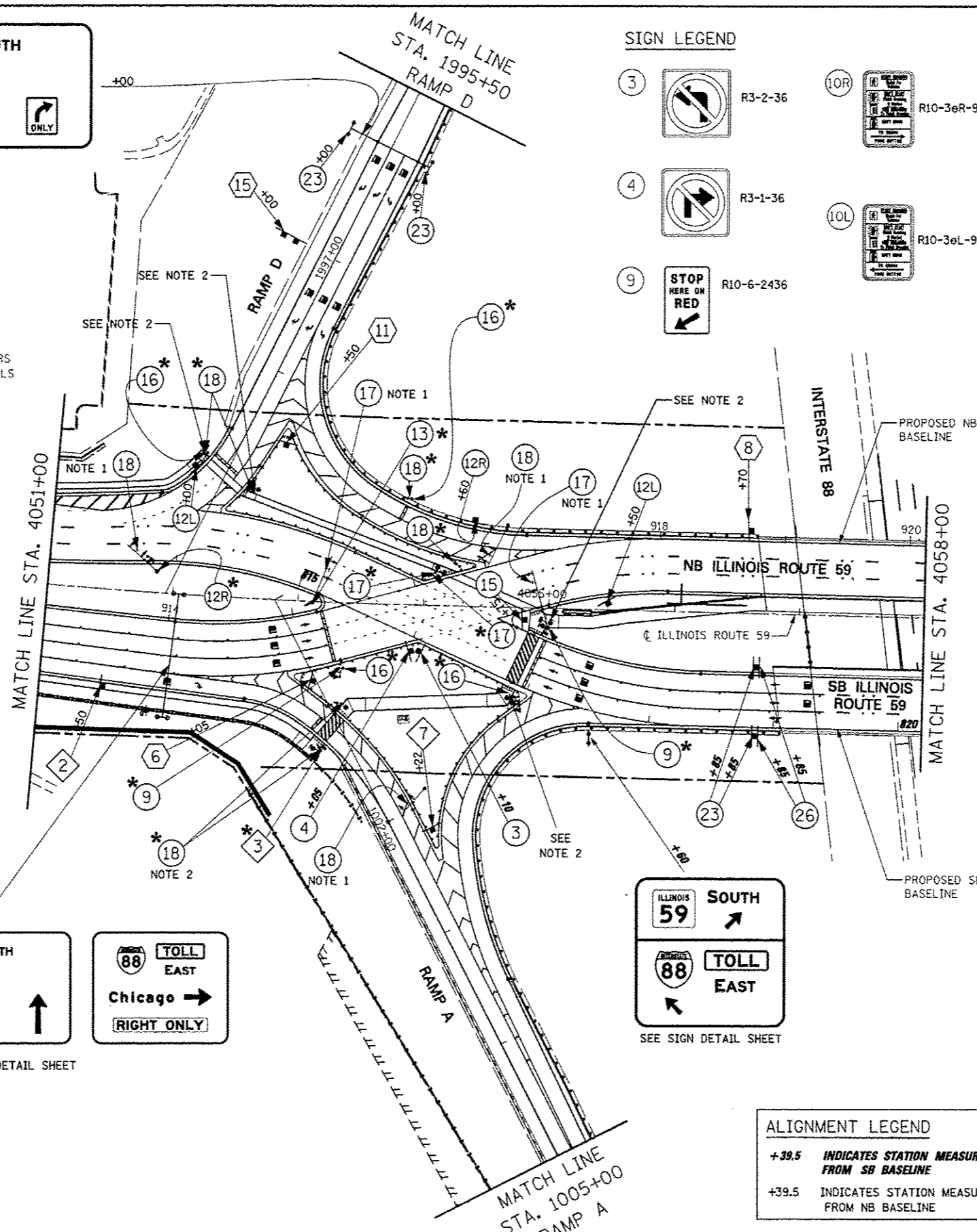
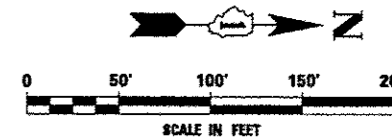

FILE NAME *	USER NAME * #USER#	DESIGNED PJO	REVISED -	STATE OF ILLINOIS DEPARTMENT OF TRANSPORTATION	PAVEMENT MARKING AND SIGNING ILLINOIS ROUTE 59	F.A.P. RTE.	SECTION	COUNTY	TOTAL SHEETS	SHEET NO.	
*FILE#		DRAWN KES	REVISED -			338	(112 & 113) WRS-5	DUPAGE	963	381	
	PLOT SCALE * #SCALE#	CHECKED JCM	REVISED -			CONTRACT NO. 60131					
	PLOT DATE * #DATE#	DATE 10/15/2012	REVISED -			ILLINOIS FED. AID PROJECT					