





**STAGE 1B TEMPORARY TRAFFIC SIGNALS**  
SEE SHEET TS-3 FOR STAGE 1B TEMPORARY CABLE PLAN

RESTORATION OF WORK AREA. RESTORATION OF THE TRAFFIC SIGNAL WORK AREA SHALL BE INCIDENTAL TO THE RELATED PAY ITEM SUCH AS FOUNDATION, CONDUIT, HANDHOLE, TRENCH AND BACKFILL, ETC., AND NO EXTRA COMPENSATION SHALL BE ALLOWED. ALL ROADWAY SURFACES SUCH AS SHOULDERS, MEDIANS, SIDEWALKS, PAVEMENT, ETC. SHALL BE REPLACED IN KIND. ALL DAMAGE TO MOWED LAWNS SHALL BE REPLACED WITH AN APPROVED SOD, AND ALL DAMAGE TO UNMOWED FIELDS SHALL BE SEEDED IN ACCORDANCE WITH STANDARD SPECIFICATIONS 252 AND 250 RESPECTIVELY.

THE TRAFFIC SIGNAL CONTROLLER EQUIPMENT SHALL BE "ECONOLITE" TO MATCH THE EXISTING ADJACENT SYSTEM.

- LEGEND**
-  CONSTRUCTION WORK ZONE
  -  TEMPORARY PAVEMENT PLACED IN THIS STAGE
  -  DIRECTION OF TRAFFIC
  -  VIDEO DETECTION ZONE

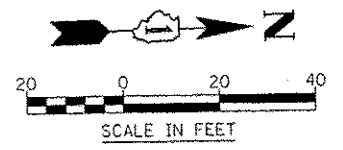
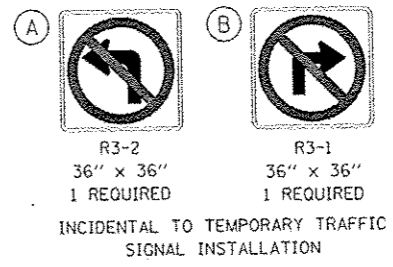

FILE NAME	USER NAME = #USER#	DESIGNED <i>MJM</i>	REVISED	<b>STATE OF ILLINOIS DEPARTMENT OF TRANSPORTATION</b>	<b>TEMPORARY TRAFFIC SIGNAL INSTALLATION MOT STAGES 1B ILLINOIS ROUTE 59 AND I-88 NORTH RAMPS</b>	F.A.P. RTE. 338	SECTION (112 & 113) WRS-5	COUNTY DUPAGE	TOTAL SHEETS 963	SHEET NO. 421		
FILE#	PLT SCALE = #SCALE#	DRAWN <i>KES</i>	REVISED			SCALE: AS SHOWN	SHEET NO. 6 OF 53 SHEETS	STA. TO STA.	<b>TS-6</b>		CONTRACT NO. 60I31	
	PLT DATE = #DATE#	CHECKED <i>JCM</i>	REVISED			ILLINOIS FED. AID PROJECT						
		DATE <i>10/15/2012</i>	REVISED									