

CONSTRUCTION NOTES

1. ALL EXISTING MAST ARM MOUNTED SIGNAL HEADS SHALL BE REMOVED FROM THE MAST ARMS AND SHALL REMAIN PROPERTY OF THE DUPAGE COUNTY DIVISION OF TRANSPORTATION. THE CONTRACTOR SHALL SAFELY STORE THE EQUIPMENT AND SHALL REINSTALL THE EQUIPMENT UPON REMOVAL OF THE TEMPORARY TRAFFIC SIGNAL OR WHEN OTHERWISE DIRECTED BY THE ENGINEER. THIS WORK SHALL BE INCLUDED IN THE UNIT PRICE FOR TEMPORARY TRAFFIC SIGNAL INSTALLATION AND NO ADDITIONAL COMPENSATION WILL BE ALLOWED.
2. ALL EXISTING TRAFFIC SIGNAL HEADS, PEDESTRIAN SIGNALS AND PEDESTRIAN PUSH-BUTTONS SHALL BE BAGGED AND DEACTIVATED WHILE THE TEMPORARY TRAFFIC SIGNAL INSTALLATION IS OPERATIONS.
3. TEMPORARY TRAFFIC SIGNAL INSTALLATION SHALL BE OPERATIONAL FOR ALL MAINTENANCE OF TRAFFIC STAGES ALONG IL ROUTE 59 AND FOR THE ENTIRE DURATION OF CONTRACT 60131.
4. THE EXISTING HANDHOLE SHALL BE ADJUSTED DOWN TO THE ELEVATION OF THE BOTTOM OF TEMPORARY PAVEMENT AND A STEEL PLATE 36"X36"X3/4" (ASTM A36) SHALL BE PLACED OVER THE OPENING AND BOLTED TO THE REMAINING PORTION OF THE HANDHOLE WITH 4-3/4" DIAMETER EPOXY ANCHOR BOLTS WITH NUTS AND WASHERS LOCATED AT THE 4 CORNERS. MINIMUM EMBEDMENT 4". TEMPORARY PAVEMENT SHALL BE PLACED OVER THE STEEL PLATE DURING THE TEMPORARY TRAFFIC SIGNAL INSTALLATION. UPON REMOVAL OF THE TEMPORARY PAVEMENT AND REPLACEMENT OF THE RAISED CORNER ISLAND, THE HANDHOLE SHALL BE REBUILT TO THE FINAL GRADE. THIS WORK WILL BE PAID FOR SEPARATELY UNDER THE ITEM REBUILD EXISTING HANDHOLE, SPECIAL.
5. THE CONTRACTOR SHALL MAINTAIN THE EXISTING TELEPHONE SERVICE CONNECTION FOR THE TEMPORARY MASTER CONTROLLER. THIS WORK SHALL BE INCLUDED IN THE UNIT PRICE FOR TEMPORARY TRAFFIC SIGNAL INSTALLATION.

RESTORATION OF WORK AREA. RESTORATION OF THE TRAFFIC SIGNAL WORK AREA SHALL BE INCIDENTAL TO THE RELATED PAY ITEM SUCH AS FOUNDATION, CONDUIT, HANDHOLE, TRENCH AND BACKFILL, ETC., AND NO EXTRA COMPENSATION SHALL BE ALLOWED. ALL ROADWAY SURFACES SUCH AS SHOULDERS, MEDIANS, SIDEWALKS, PAVEMENT, ETC. SHALL BE REPLACED IN KIND. ALL DAMAGE TO MOWED LAWNS SHALL BE REPLACED WITH AN APPROVED SOD, AND ALL DAMAGE TO UNMOWED FIELDS SHALL BE SEEDED IN ACCORDANCE WITH STANDARD SPECIFICATIONS 252 AND 250 RESPECTIVELY.

THE TRAFFIC SIGNAL CONTROLLER EQUIPMENT SHALL BE "ECONOLITE" TO MATCH THE EXISTING ADJACENT SYSTEM.

THE EXACT LOCATION OF ALL UTILITIES SHALL BE FIELD VERIFIED BY THE CONTRACTOR PRIOR TO BEGINNING ANY WORK. FOR LOCATIONS OF UTILITIES AND LOCALLY OWNED EQUIPMENT, CONTACT THE LOCAL COUNTIES, MUNICIPALITIES FOR LOCATES. THE CONTRACTOR SHALL CALL "JULIE" AT (800) 892-0123 FOR FIELD LOCATIONS OF BURIED UTILITIES (48 HOURS NOTIFICATION REQUIRED).

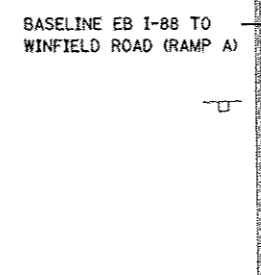
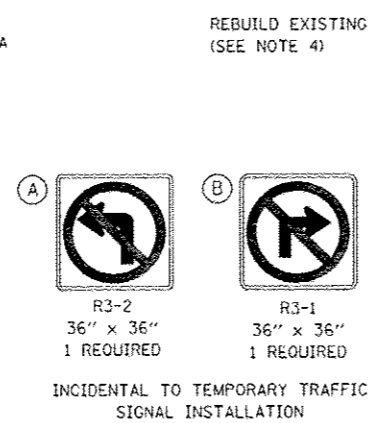
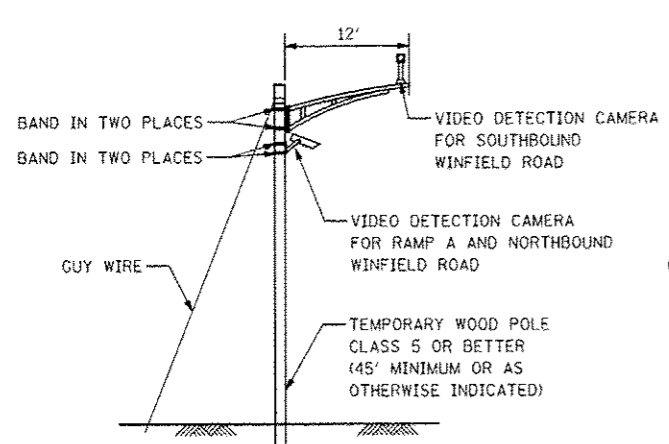
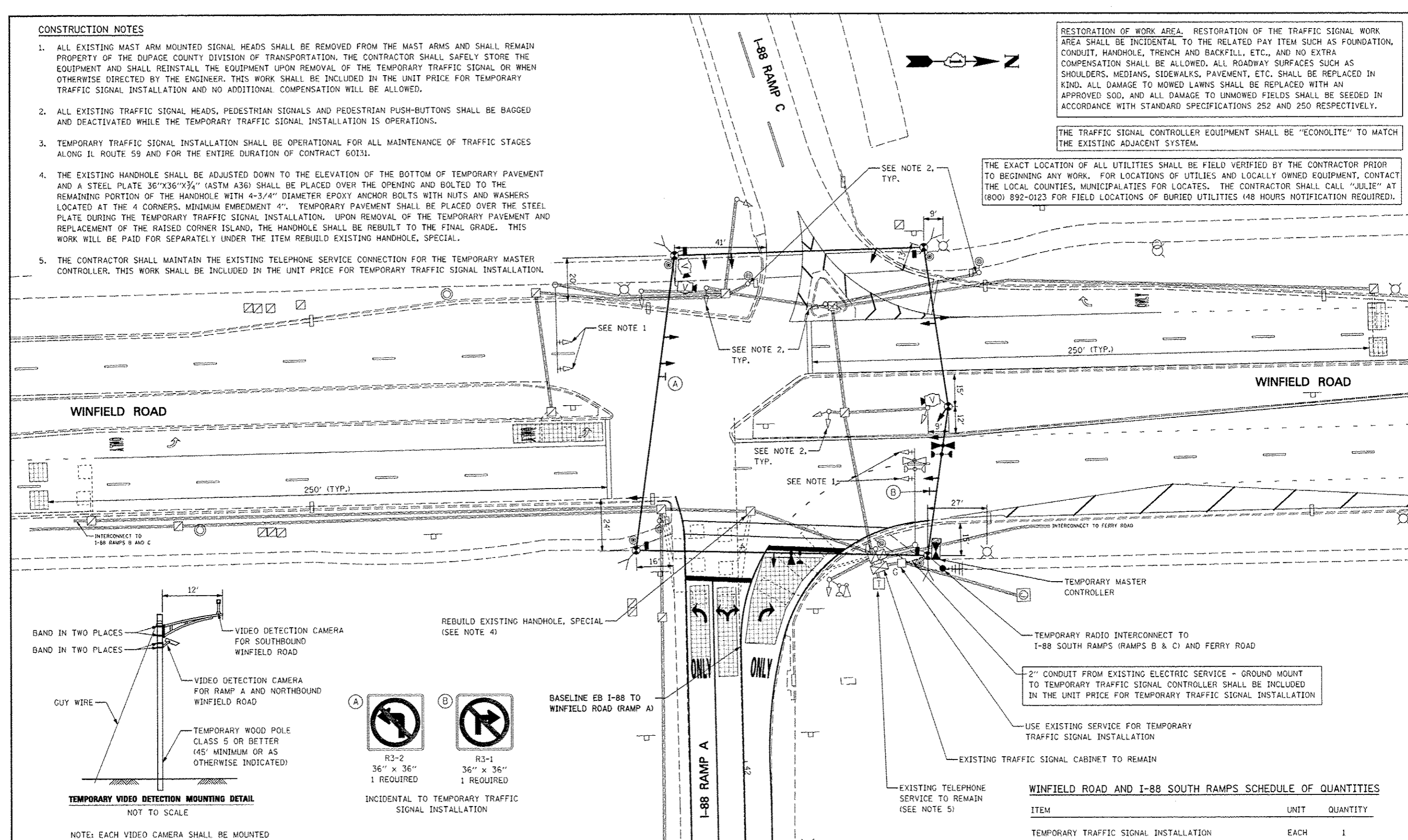

2" CONDUIT FROM EXISTING ELECTRIC SERVICE - GROUND MOUNT TO TEMPORARY TRAFFIC SIGNAL CONTROLLER SHALL BE INCLUDED IN THE UNIT PRICE FOR TEMPORARY TRAFFIC SIGNAL INSTALLATION

USE EXISTING SERVICE FOR TEMPORARY TRAFFIC SIGNAL INSTALLATION

EXISTING TELEPHONE SERVICE TO REMAIN (SEE NOTE 5)

WINFIELD ROAD AND I-88 SOUTH RAMPS SCHEDULE OF QUANTITIES

ITEM	UNIT	QUANTITY
TEMPORARY TRAFFIC SIGNAL INSTALLATION	EACH	1
TEMPORARY TRAFFIC SIGNAL TIMING	EACH	1
REBUILD EXISTING HANDHOLE, SPECIAL	EACH	1

NOTE: EACH VIDEO CAMERA SHALL BE MOUNTED ON A 12' ALUMINUM MAST ARM OR WOOD POLE AS INDICATED ABOVE. THIS WORK WILL BE INCLUDED IN THE COST FOR TEMPORARY TRAFFIC SIGNAL INSTALLATION.

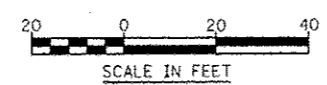

TEMPORARY TRAFFIC SIGNALS - ALL STAGES

SEE TEMPORARY CABLE PLAN FOR TEMPORARY TRAFFIC SIGNAL GENERAL NOTES
TEMPORARY TRAFFIC SIGNAL TO BE OPERATIONAL FOR THE ENTIRE DURATION OF CONTRACT 60131

FILE NAME :	USER NAME : #USER#	DESIGNED : <i>MJM</i>	REVISED : -ADDENDUM A 12/17/2012	STATE OF ILLINOIS DEPARTMENT OF TRANSPORTATION	TEMPORARY TRAFFIC SIGNAL INSTALLATION AND EXISTING SIGNAL EQUIPMENT PLAN WINFIELD ROAD AND I-88 NORTH RAMPS (RAMPS A & D)	F.A.P. RTE.	SECTION	COUNTY	TOTAL SHEETS	SHEET NO.
#FILE#	PLOT SCALE : #SCALE#	DRAWN : <i>KES</i>	REVISED :			338	(112 & 113) WRS-5	DUPAGE	93	468A
	PLOT DATE : #DATE#	CHECKED : <i>JCM</i>	REVISED :			TS-52A		CONTRACT NO. 60131		
		DATE : <i>12/17/2012</i>	REVISED :			SCALE: AS SHOWN	SHEET NO. 53A OF 53 SHEETS	STA.	TO STA.	ILLINOIS FED. AID PROJECT