

NOTES

1. EXISTING FIBER OPTIC INTERCONNECT SHALL REMAIN OPERATIONAL TO WINFIELD ROAD AT TORCH PARKWAY, FERRY ROAD AT BELLA VISTA PARKWAY AND FERRY ROAD AT TORCH PARKWAY.
2. EXISTING FIBER OPTIC INTERCONNECT SHALL REMAIN OPERATIONAL TO WINFIELD ROAD AT DIEHL ROAD.

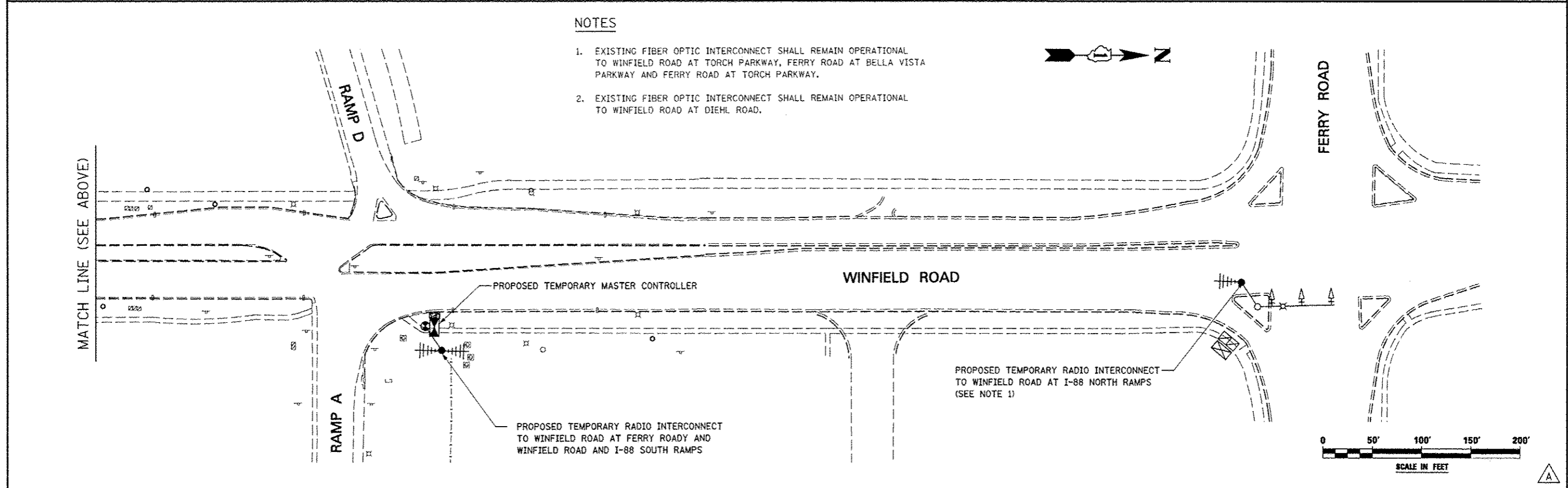

FILE NAME :	USER NAME : *USER*	DESIGNED <i>PJO</i>	REVISED - ADDENDUM A 12/17/2012	STATE OF ILLINOIS DEPARTMENT OF TRANSPORTATION	TEMPORARY INTERCONNECT PLAN WINFIELD ROAD FROM I-88 SOUTH RAMPS TO FERRY ROAD			F.A.P. RTE. 338	SECTION (112 & 113) WRS-5	COUNTY DUPAGE	TOTAL SHEETS 463	SHEET NO. 468C
FILE# :	PLLOT SCALE = *SCALE*	CHECKED <i>JCM</i>	REVISED -		SCALE: 1" = 50'	SHEET NO. 53C OF 53 SHEETS	STA. _____	TO STA. _____	TS-52C		CONTRACT NO. 60I31	
	PLLOT DATE = *DATE*	DATE <i>12/17/2012</i>	REVISED -		ILLINOIS FED. AID PROJECT							
A												