

PT	STATION	OFFSET	ELEV.
A	903+19.74	19.7' LT	585.27
B	903+39.69	20.4' LT	585.33
C	903+59.64	21.1' LT	585.40
D	903+79.58	21.9' LT	585.46
E	903+99.52	22.8' LT	585.52
F	904+11.62	23.2' LT	585.56

- NOTES:
- ELEVATIONS ARE GIVEN EVERY 20' ON EVEN STATIONS UNLESS OTHERWISE NOTED.
  - SEE IDOT STD 420001, 420201 AND 420301 FOR ADDITIONAL INFORMATION ON RAMP AND PAVEMENT JOINTING.

**LEGEND:**

- LONGITUDINAL KEYED CONSTRUCTION JOINT PER STD 420001 (SHALL BE INCLUDED IN THE COST OF THE PAY ITEM PORTLAND CEMENT CONCRETE PAVEMENT, (JOINTED) OF THE SPECIFIED THICKNESS)
- LONGITUDINAL SAWED OR CONSTRUCTION JOINT PER STD 420001 (SHALL BE INCLUDED IN THE COST OF THE PAY ITEM PORTLAND CEMENT CONCRETE PAVEMENT, (JOINTED) OF THE SPECIFIED THICKNESS)
- SAWED TRANSVERSE CONTRACTION JOINT PER STD 420001 WITH HOT POUR SEAL

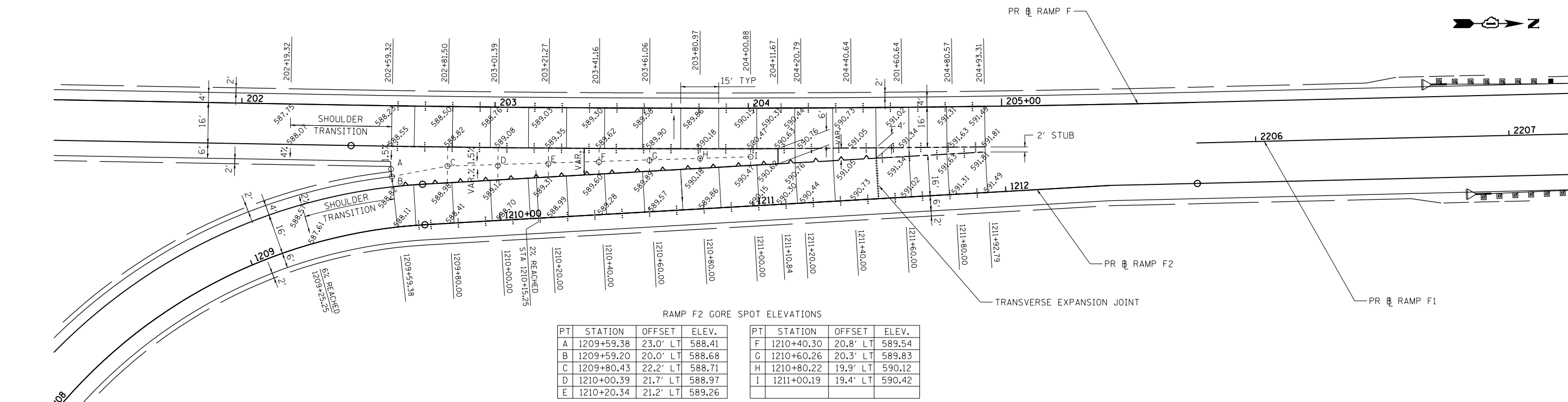
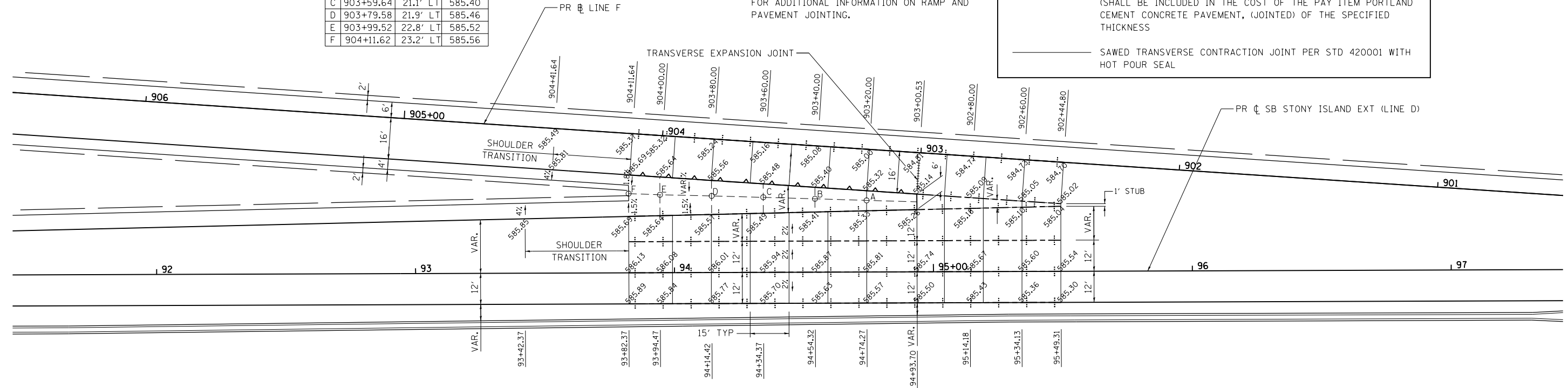

RAMP F2 GORE SPOT ELEVATIONS

PT	STATION	OFFSET	ELEV.	PT	STATION	OFFSET	ELEV.
A	1209+59.38	23.0' LT	588.41	F	1210+40.30	20.8' LT	589.54
B	1209+59.20	20.0' LT	588.68	G	1210+60.26	20.3' LT	589.83
C	1209+80.43	22.2' LT	588.71	H	1210+80.22	19.9' LT	590.12
D	1210+00.39	21.7' LT	588.97	I	1211+00.19	19.4' LT	590.42
E	1210+20.34	21.2' LT	589.26				

BOWMAN, BARRETT & ASSOCIATES INC.  
CONSULTING ENGINEERS  
Chicago, Illinois  
312.228.0100  
www.bbainc.com

FILE NAME =	USER NAME = default	DESIGNED -	REVISED -
#FILE#		DRAWN - JAM	REVISED -
	PLOT SCALE = #SCALE#	CHECKED - RGR	REVISED -
	PLOT DATE = 3/29/2013	DATE - 03/29/2013	REVISED -

**STATE OF ILLINOIS  
DEPARTMENT OF TRANSPORTATION**

**GORE DETAILS**

SCALE: 1"=20' SHEET NO. OF SHEETS STA. TO STA.

F.A.I. RTE.	SECTION	COUNTY	TOTAL SHEETS	SHEET NO.
94	2012-059-BR	COOK	631	216
CONTRACT NO. 60J12				
ILLINOIS FED. AID PROJECT				

S:\1072-05-CADD\1068\12 Sheets\1068\12-shr-gore details.dwg