

**TYPICAL TRUSS UNIT**  
 For Section B-B and Section C-C, see Base Sheet OSC-A-3.

Note:  
 There are twice as many horizontal diagonals as there are vertical diagonals.

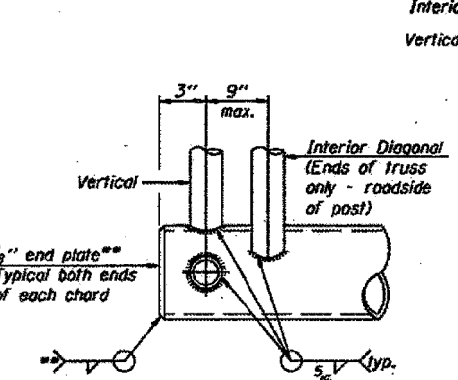

**CANTILEVER END JOINT DETAIL**  
 \*\* Contractor may alternatively use standard aluminum drive-fit cap to close ends.

OSC-A-2

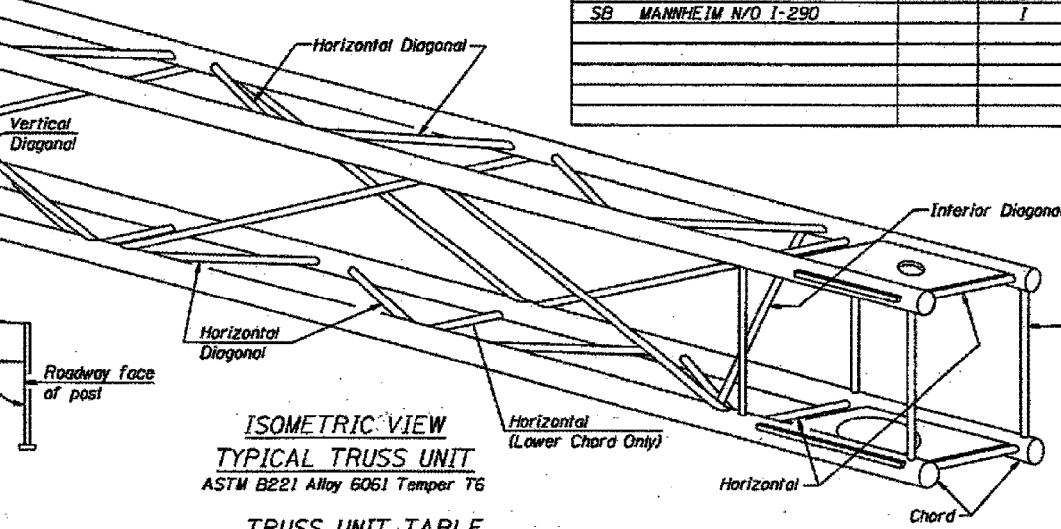
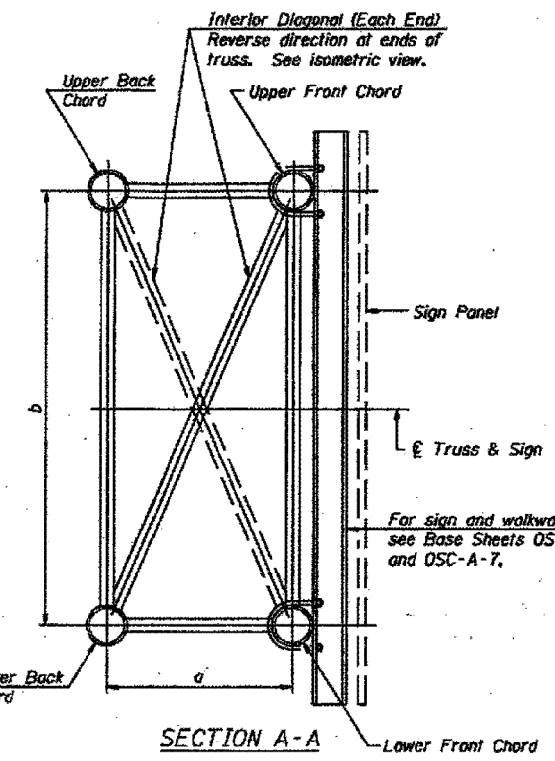

**TYPICAL TRUSS UNIT**  
 ASTM B221 Alloy 6061 Temper T6

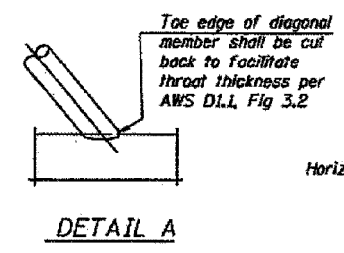

**DETAIL A**

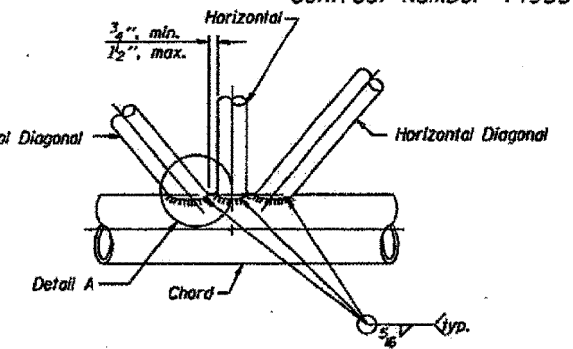

**TRUSS INTERIOR JOINT DETAIL**

Structure Number	Station	Truss Type	Design Length (L)	Number of Panels Per Unit	Panel Length (P)*
SB STONEY ISLAND N/O I-94		III	25 Ft.	5	4.6 Ft.
WB 159TH W/O DIXIE HWY.		I	25 Ft.	6	3.9 Ft.
EB 159TH W/O CRAWFORD		III	25 Ft.	5	4.6 Ft.
SB MANNHEIM S/O I-190		III	35 Ft.	6	5.5 Ft.
NB MANNHEIM S/O ICRP BRIDGE		I	25 Ft.	6	3.9 Ft.
SB MANNHEIM N/O I-290		I	25 Ft.	6	3.9 Ft.

**SHOP CAMBER TABLE**

Unit Length (L)	Shop Camber at End
15'	1 1/2"
16'-17'	1 3/4"
18'-20'	2"
21'-22'	2 1/4"
23'-25'	2 1/2"
26'-27'	2 3/4"
28'-30'	3"
31'-32'	3 1/4"
33'-35'	3 1/2"
36'-37'	4"
38'-40'	4 1/2"

**CAMBER DIAGRAM**  
 (For Fabrication Only)

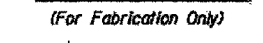

**TRUSS UNIT TABLE**

Truss Type	Dimension "a"	Dimension "b"	Dimension "c"	Limits for Panel Spacing (P)*	Up. & Low. Chord O.D.		Verticals, Horizontals, Vertical, Horizontal, and Interior Diagonals O.D.	
					Wall	Wall	Wall	Wall
I-C-A	24"	54"	15"	36" min. to 48" max.	5"	5/16"	2 1/2"	5/16"
II-C-A	36"	66"	21"	42" min. to 54" max.	6 1/2"	5/16"	3 1/4"	5/16"
III-C-A (35' Max.)	36"	84"	21"	48" min. to 66" max.	7"	3/8"	3 1/2"	3/8"
III-C-A (35' to 40')	36"	84"	21"	48" min. to 66" max.	8"	3/8"	3 1/2"	3/8"

\*P = L-5-3" / # Panels

NUMBER	REVISION	DATE

ILLINOIS DEPARTMENT OF TRANSPORTATION

**CANTILEVER SIGN STRUCTURES TRUSS DETAILS**  
**ALUMINUM TRUSS & STEEL POST**

SCALE: VERT. N.T.S.  
 HORIZ. DATE-TIME=

DRAWN BY: JSH  
 DESIGNED BY: JDO  
 CHECKED BY: JAD