

GENERAL NOTES

1. THE FOLLOWING ITEMS HAVE BEEN PROVIDED FOR VEGETATION MANAGEMENT. THE ACTUAL NEED FOR THESE ITEMS WILL BE DETERMINED IN THE FIELD AT THE TIME OF CONSTRUCTION BY THE ENGINEER. IF THESE PAY ITEMS ARE NOT USED OR ARE NOT USED IN THEIR ENTIRETY, THE REMAINING QUANTITY SHALL BE DEDUCTED FROM THE TOTAL AND NO ADDITIONAL COMPENSATION WILL BE DUE TO THE CONTRACTOR: WEED CONTROL, AQUATIC, WEED CONTROL, TEASEL, WEED CONTROL, NATIVE GRASS RESTORATION, MOWING & MOWING (SPECIAL).
2. TOPSOIL FURNISH AND PLACE, 12" WILL BE USED FOR ALL TREE PLANTING BEDS TO IMPROVE THE EXISTING SOIL FOR PLANTING.
3. CONTACT STEVE LIPKIE OF THE ROADSIDE DEVELOPMENT UNIT 48 HOURS PRIOR TO SELECTIVE CLEARING AT 847-705-4171.

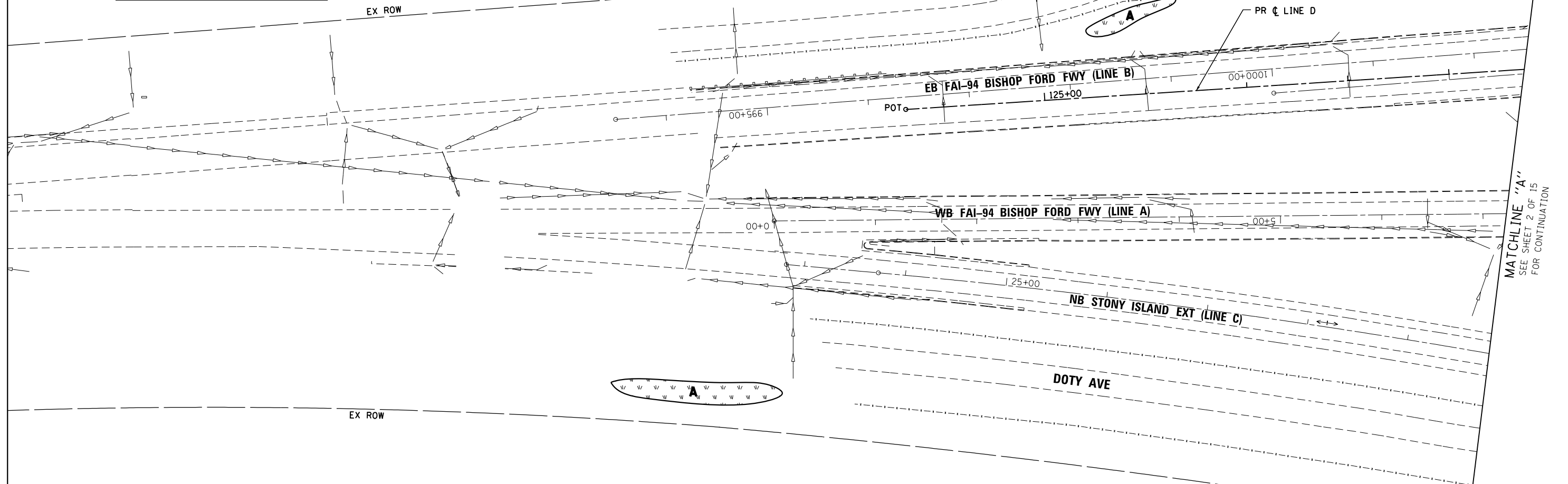

LEGEND

- SEEDING, CLASS 2A
EROSION CONTROL BLANKET
TOPSOIL EXCAVATION AND PLACE (6") •
- INTERSEEDING CLASS 4
WEED CONTROL, NATIVE GRASS RESTORATION
MOWING
- INTERSEEDING CLASS 4
EROSION CONTROL BLANKET (EXCEPT WHERE TRM IS SPECIFIED)
TOP SOIL EXCAVATION AND PLACE (6") •

- WEED CONTROL, AQUATIC (A)
SEEDING CLASS 4
MULCH METHOD 4
EROSION CONTROL BLANKET
TOPSOIL EXCAVATION & PLACE (6") •
- WEED CONTROL, TEASEL (T)
SEEDING CLASS 4
MULCH METHOD 4
EROSION CONTROL BLANKET
TOPSOIL EXCAVATION & PLACE (6") •

- TREE
- ORNAMENTAL TREE
- TREE GROVE WITH MULCH BED
TOPSOIL FURNISH AND PLACE, 12"
- EVERGREEN TREE
- SHRUB BED

• "TOPSOIL EXCAVATION AND PLACEMENT" INCLUDES ALL EXCAVATING, HAULING, STOCKPILING, AND FINAL PLACEMENT OF TOPSOIL OBTAINED ON-SITE AS INDICATED IN THE CONTRACT PLANS AND DIRECTED BY THE ENGINEER. IF ADDITIONAL TOPSOIL IS REQUIRED, IT SHALL BE FURNISHED AND PLACED BY CONTRACTOR UNDER THE CONTRACT PAY ITEM "TOPSOIL FURNISH AND PLACE, 6".

BOWMAN, BARRETT & ASSOCIATES INC.
CONSULTING ENGINEERS
Chicago, Illinois
312.228.0100
www.bbandainc.com



FILE NAME =	USER NAME = default	DESIGNED -	PTG	REVISED -	
#FILE#		DRAWN -	PTG	REVISED -	
	PLOT SCALE = #SCALE#	CHECKED -	RGR	REVISED -	
	PLOT DATE = 3/29/2013	DATE -	03/29/2013	REVISED -	

**STATE OF ILLINOIS
DEPARTMENT OF TRANSPORTATION**

**LANDSCAPING & VEGETATION MANAGEMENT PLAN
STONY ISLAND EXTENSION**

SCALE: 1"=50' SHEET NO. 1 OF 14 SHEETS STA. TO STA.

F.A.I. RTE.	SECTION	COUNTY	TOTAL SHEETS	SHEET NO.
94	2012-059-BR	COOK	631	263
CONTRACT NO. 60J12				
ILLINOIS FED. AID PROJECT				

MATCHLINE "A"
SEE SHEET 2 OF 15
FOR CONTINUATION