

Section 11-37-14
City of Chicago - Hyde Park
Population 3,550,404

COUNTY PROGRAM		SHEET
ITEM No.	YEAR	No.
	1969	4

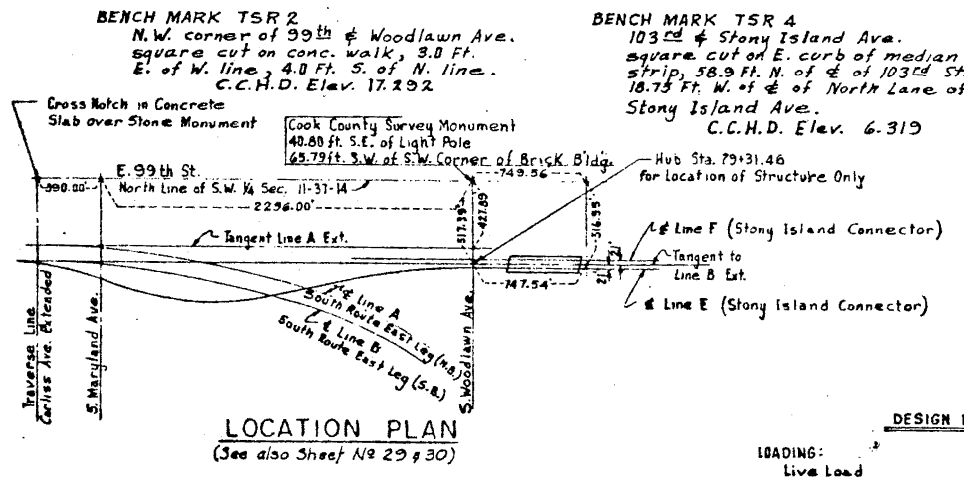
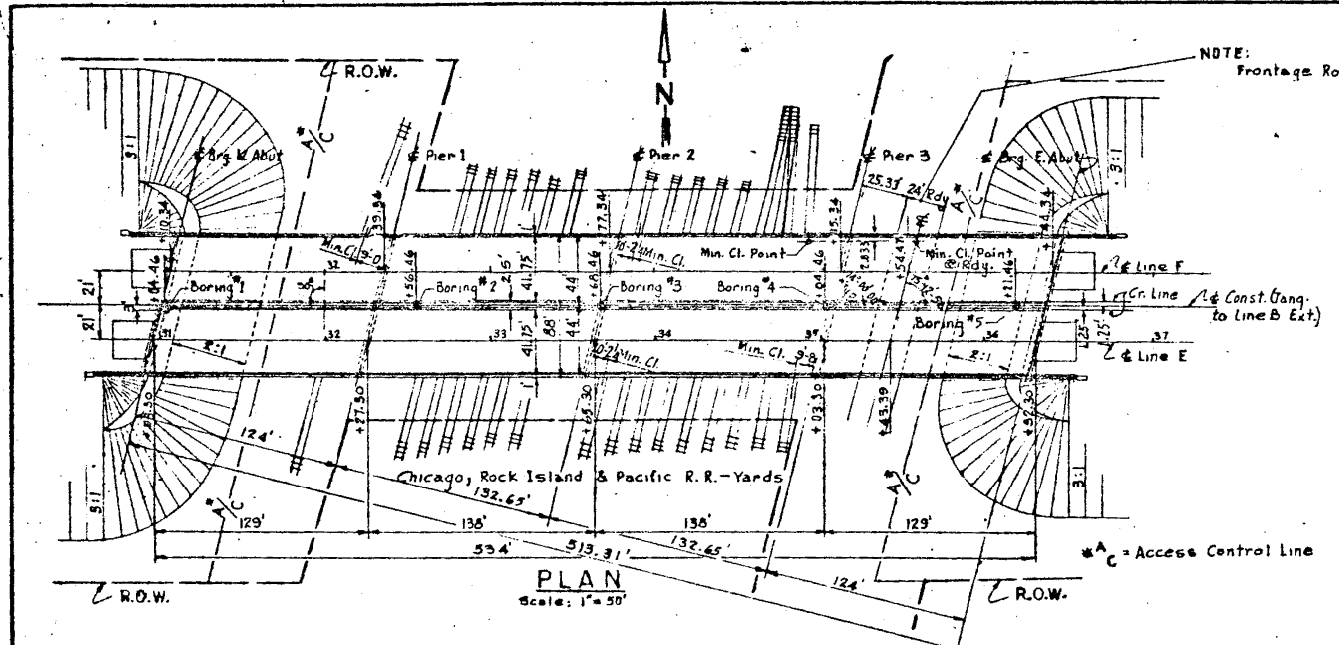

DESIGN DATA

LOADING:
Live Load HS20-44 & Alternate

SPECIFICATIONS:
Design A.A.S.H.O. Specifications for Highway Bridges, 1965 & as Amended to Date.

CONSTRUCTION & MATERIAL:
Standard Specifications for Road and Bridge Construction of the State of Illinois, 1968, and as Amended to Date.

WELDING:
A.W.S. Standard Specifications for Welded Highway & Railway Bridges, 1969 and as Amended to Date.

ALLOWABLE STRESSES:
F_s Structural Steel A.S.T.M.-A36 20,000 P.S.I.
F_s Reinforcement Bars 20,000 P.S.I.
F_c Compressive Stress of Concrete:
Without Earth Pressure 1,200 P.S.I.
with Earth Pressure 1,000 P.S.I.
Earth Pressure 40% C.F. Equiv. Fluid

SUPERSTRUCTURE:
All Girders are Designed as 60" Welded Plate Girders with Non-Composite Sections.
2' Roadways @ 24'-0" Plus 10'-0" Shoulders on the Right Plus 6'-0" Shoulders on the Left & 6'-0" Flush Median

SUBSTRUCTURES
Reinforced Concrete Pile Cap Abutments on Steel Piles.
Reinforced Concrete Piers on Steel Piles.

DESIGN DESIGNATION:
3350 (87) FR-3
1987 Average Daily Traffic 33,450 Vehicles
1987 Design Hour Volume 4,020 Vehicles
1987 Average Daily Truck Traffic 3,350 Trucks
West Bound 3,350 Trucks
East Bound 3,350 Trucks
Design Speed 60 Miles per Hour

HANDRAIL:
A.A.S.H.O. Interim Specifications, 1966-1967.

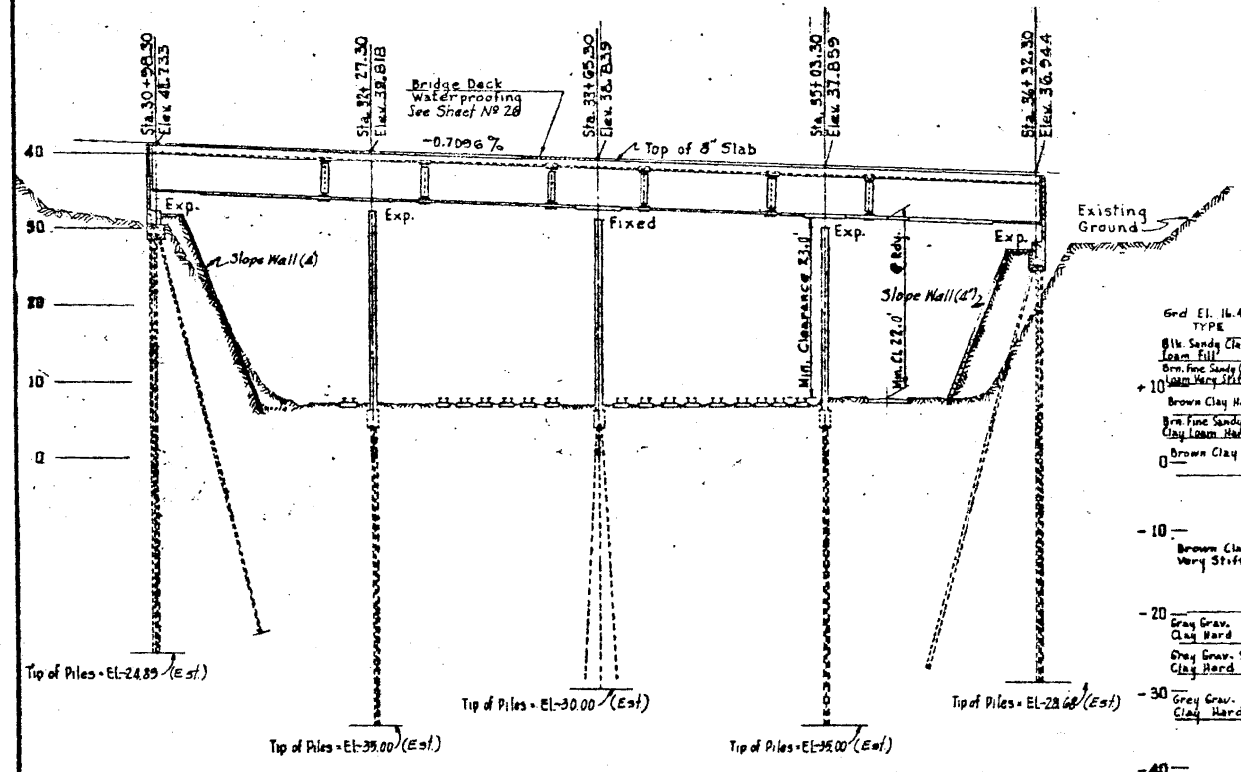

BORING NO. 1	BORING NO. 2	BORING NO. 3	BORING NO. 4	BORING NO. 5
173' East of & Woodlawn Ave. & 928' South of & 99th St.	325' East of & Woodlawn Ave. & 517' South of & 99th St.	437' East of & Woodlawn Ave. & 517' South of & 99th St.	573' East of & Woodlawn Ave. & 517' South of & 99th St.	698' East of & Woodlawn Ave. & 517' South of & 99th St.
Grd. El. 16.4 TYPE Blk. Sandy Clay Loam Fill Gr. fine Sandy Clay Med. Heavy Stiff Brown Clay Hard Br. fine Sand Clay Loam Hard Brown Clay Hard M.O.	Grd. El. 8.8 TYPE Black Cinder Fill Brown Course Sand Wet Med. Heavy Brown Clay Stiff Brown Clay Very Stiff M.O.	Grd. El. 8.8 TYPE Black Cinder Fill Brown Grav. Clay Stiff M.O.	Grd. El. 7.2 TYPE Brown Slag & Cinder Fill Brown Clay Stiff Brown Clay Stiff Grey Clay Very Stiff Grey Grav. Clay Very Stiff Grey Grav. Clay Very Stiff Grey Silty Clay Hard	Grd. El. 8.3 TYPE Brown Slag Fill Brown Clay Stiff Brown Clay Stiff Brown Clay Stiff Grey Grav. Clay Very Stiff Grey Grav. Clay Hard Grey Grav. Clay Hard Grey Clay Hard

PROFILE - ALONG LINE "E"
PROFILE ALONG LINE "F" - SIMILAR
STATIONS & ELEVATIONS SHOWN FOR LINE "E" ONLY
Scales: Vert. 3/2"=1'-0"
Horiz. 1"=30'

REVISIONS

DATE	BY	DESCRIPTION
4/16/67	J.M.	Added Bench Marks & Seal Location
5-7-70	J.S.	Deleted "Future Load"
		R.W.S. - 3rd Spec. for Welded
		12" x 8" Bridges, 1966 changed
		to 1969

DEPARTMENT OF HIGHWAYS
COOK COUNTY, ILLINOIS

GEORGE W. DUNNE
PRESIDENT BOARD OF COMMISSIONERS

THOMAS G. COTS
SECRETARY BOARD OF COMMISSIONERS

PLAN & PROFILE
STONY ISLAND EXP CONNECTOR
TO F.A.I. 94 OVER
CHICAGO ROCK ISLAND & PACIFIC R.R.

COMPUTED: PROJECT EBU-EBUG-246 (64)
CHECKED: SUBMITTED: 3-10-67
DRAWN: C.M. CLARK
CHECKED: J.B. SMITH

EXAMINED: [Signature]
CHIEF ENGINEER OF DISTRICT

SECTION NUMBER: 174 A
SHEET NO.: 4
DATE: 4/21/67

3/29/2013 3:29:49 PM SA:\072_05_CADD\Structure\1\SN_0162440\CADD_Sheets\0162440-60J12-037-F101.dgn