

SCALE: 1" = 40'

NOTES:

- SEE TRAFFIC CONTROL DETAILS FOR FREEWAY SHOULDER CLOSURES AND PARTIAL RAMP CLOSURES (TC-17) FOR ADDITIONAL SIGNS AND SIGNING DETAILS.
- MARKERS ON RIGHT SHALL BE CRYSTAL AND MARKERS ON THE LEFT SHALL BE AMBER.

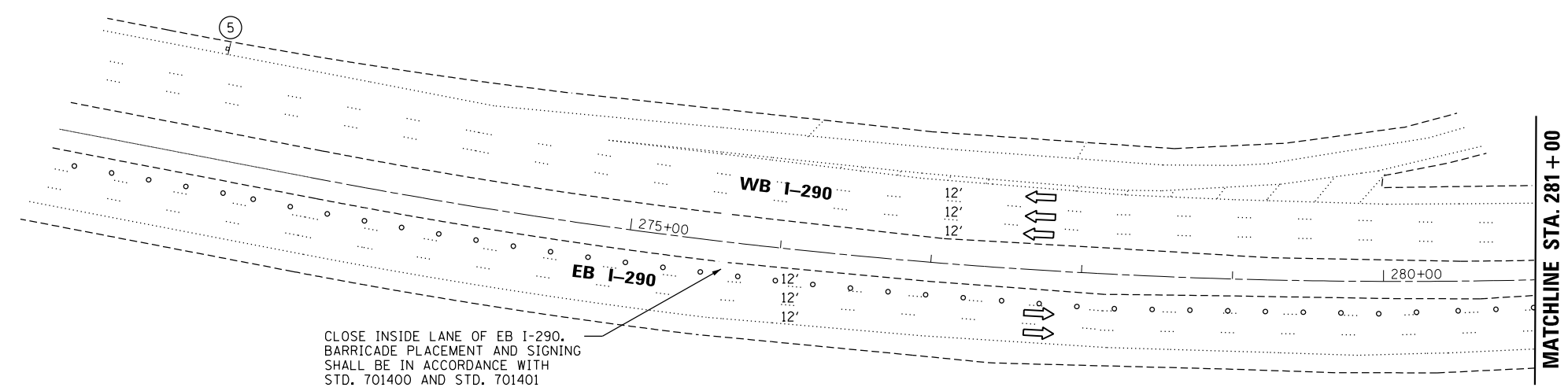

CLOSE INSIDE LANE OF EB I-290. BARRICADE PLACEMENT AND SIGNING SHALL BE IN ACCORDANCE WITH STD. 701400 AND STD. 701401

MATCHLINE STA. 281+00

SIGN LEGEND

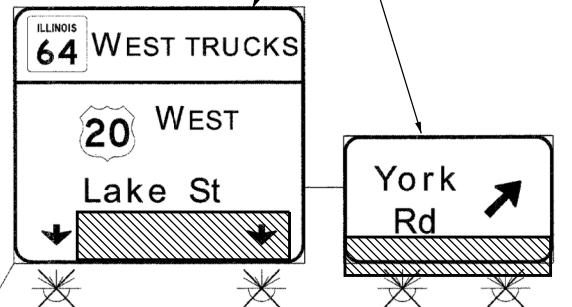
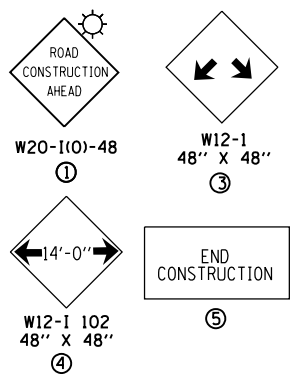

MAINTAIN SIGN CONFIGURATION AND SIGN OVERLAY PANELS FROM STAGE I.

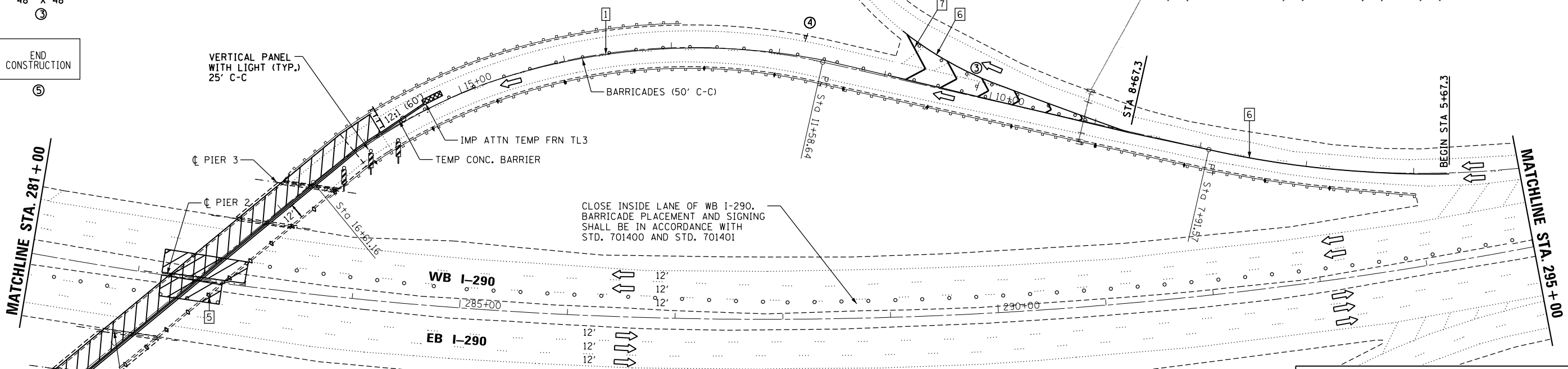

CLOSE INSIDE LANE OF WB I-290. BARRICADE PLACEMENT AND SIGNING SHALL BE IN ACCORDANCE WITH STD. 701400 AND STD. 701401

PAVEMENT MARKING LEGEND

- 1 4" WHITE LINE, TYPE III WET REFLECTIVE TAPE
- 2 4" YELLOW LINE, TYPE III WET REFLECTIVE TAPE
- 3 NOT USED
- 4 TEMPORARY PAVEMENT MARKING - LINE 6" WHITE (ON LOWER SLOPE OF BARRIER WALL)
- 5 NOT USED
- 6 8" WHITE, TYPE III WET REFLECTIVE TAPE
- 7 12" WHITE, TYPE III WET REFLECTIVE TAPE

LEGEND

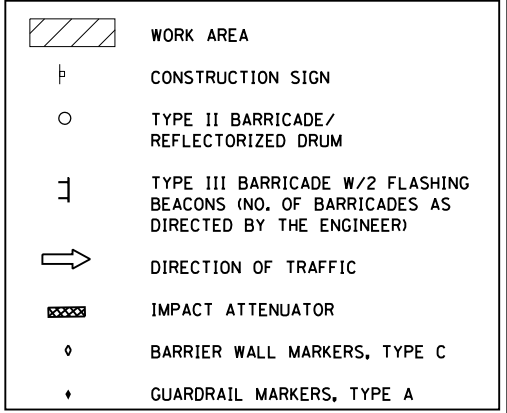

FILE NAME =	USER NAME = mremper	DESIGNED - JMS	REVISED -	STATE OF ILLINOIS DEPARTMENT OF TRANSPORTATION	US ROUTE 20 WB (LAKE ST) MAINTENANCE OF TRAFFIC STAGE II			F.A.I. RTE. 290	SECTION 22-3HB-1	COUNTY DuPAGE	TOTAL SHEETS 37	SHEET NO. 13
	PLOT SCALE = 100.0000' / in.	CHECKED - JMH	REVISED -		SCALE: 6"	SHEET NO.	OF SHEETS	STA.	TO STA.	CONTRACT NO. 60M97		
PLOT DATE = 12/6/2012	DATE - JANUARY, 2013	REVISED -							ILLINOIS FED. AID PROJECT			

9FILES