

Existing Structure: Existing Structure 022-0090 carries two lanes of traffic from northwest bound I-290 to west bound Lake Street (US Route 20) over I-290. This bridge consists of a four-span continuous steel superstructure with a reinforced concrete deck and substructure. The original structure was constructed in 1962, and the deck was replaced in 1985. Staged construction will be utilized to maintain traffic during construction.

No Salvage

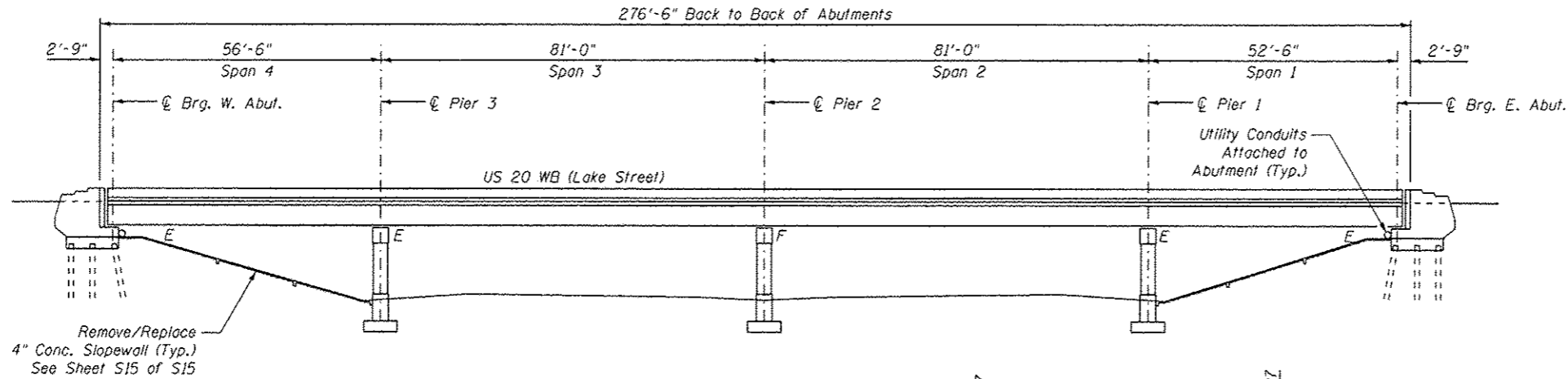

ELEVATION

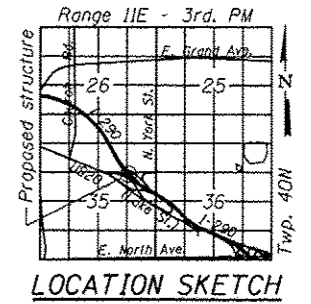
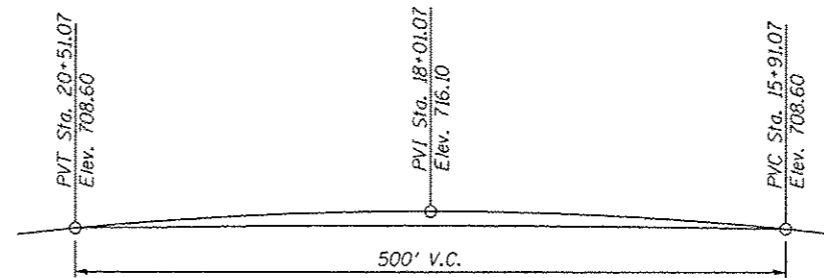

PROFILE GRADE US 20 WB

SCOPE OF WORK

1. Install Protective Shield.
2. Bridge deck scarification.
3. Reconstruct deck joints at each abutment with preformed strip seal.
4. Repair bridge deck.
5. Repair approach slab pavement.
6. Place new overlay on bridge deck and approach slabs.
7. Structural concrete repairs at abutments and piers.
8. Replace slope walls.
9. Replace East and West Abutment bearings.
10. Replace diaphragm at West Abutment between Beams 5-6.
11. Remove abandoned attachments at north fascia girder.
12. Reconstruct and/or clean/adjust inlet boxes.

DESIGN SPECIFICATIONS
2002 AASHTO Standard Specifications for Highway Bridges (17th Edition)

LOADING HS20-44

DESIGN STRESSES

FIELD UNITS
 $f'_c = 3,500$ psi
 $f_y = 60,000$ psi (reinforcement)
 $f_y = 36,000$ psi (structural steel)



COLLINS ENGINEERS, INC.
JAMES M. HAMELKA
NO. 81-6116
EXPIRES 11-30-2014

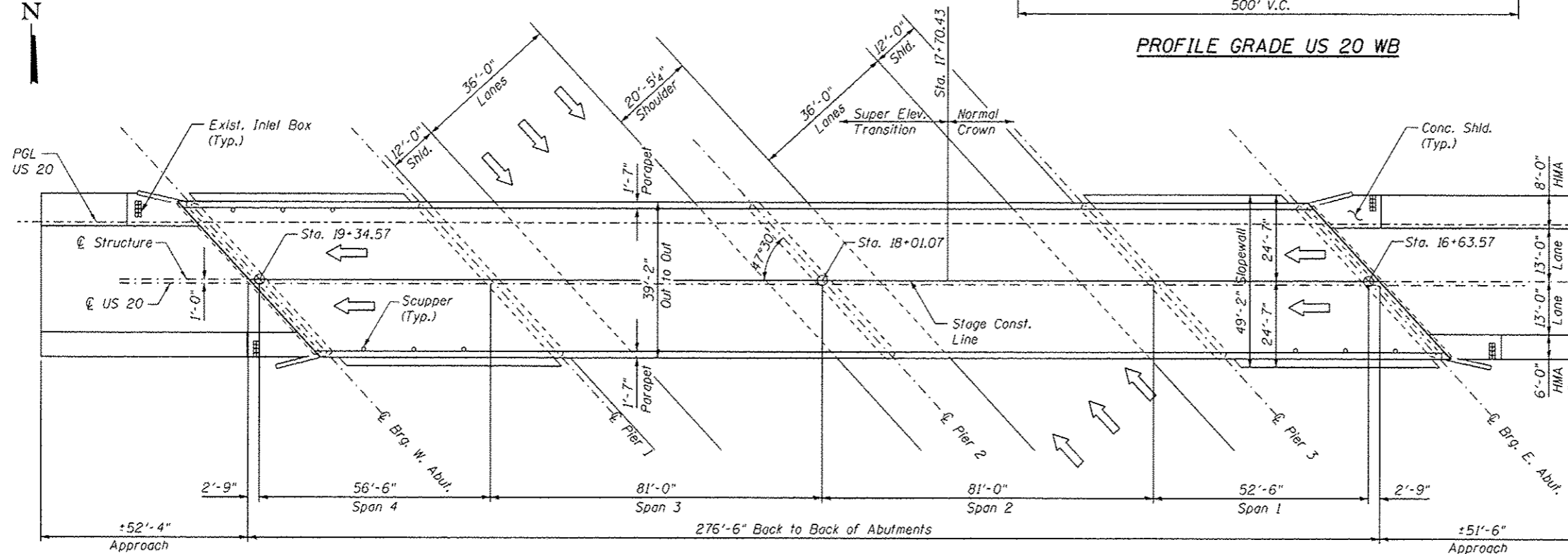
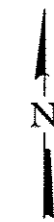

PLAN

FILE NAME *	USER NAME *	DESIGNED - JMS	REVISED -	STATE OF ILLINOIS DEPARTMENT OF TRANSPORTATION	GENERAL PLAN AND ELEVATION US 20 WB OVER I-290 STRUCTURE NO. 022-0090	F.A.I. RTE.	SECTION	COUNTY	TOTAL SHEETS	SHEET NO.	
	PLOT SCALE *	CHECKED - JMH	REVISED -			290	22-3HB-1	DU PAGE	37	16	
	PLOT DATE *	DRAWN - DR	REVISED -			CONTRACT NO. 60M97					
		CHECKED - JMH	REVISED -			SHEET NO. S1 OF S15 SHEETS					

ILLINOIS FED. AID PROJECT