

QUANTITY
 4 (100) LINE = 64.1 ft. (19.7 m)
 21.1 sq. ft. (1.97 sq. m)

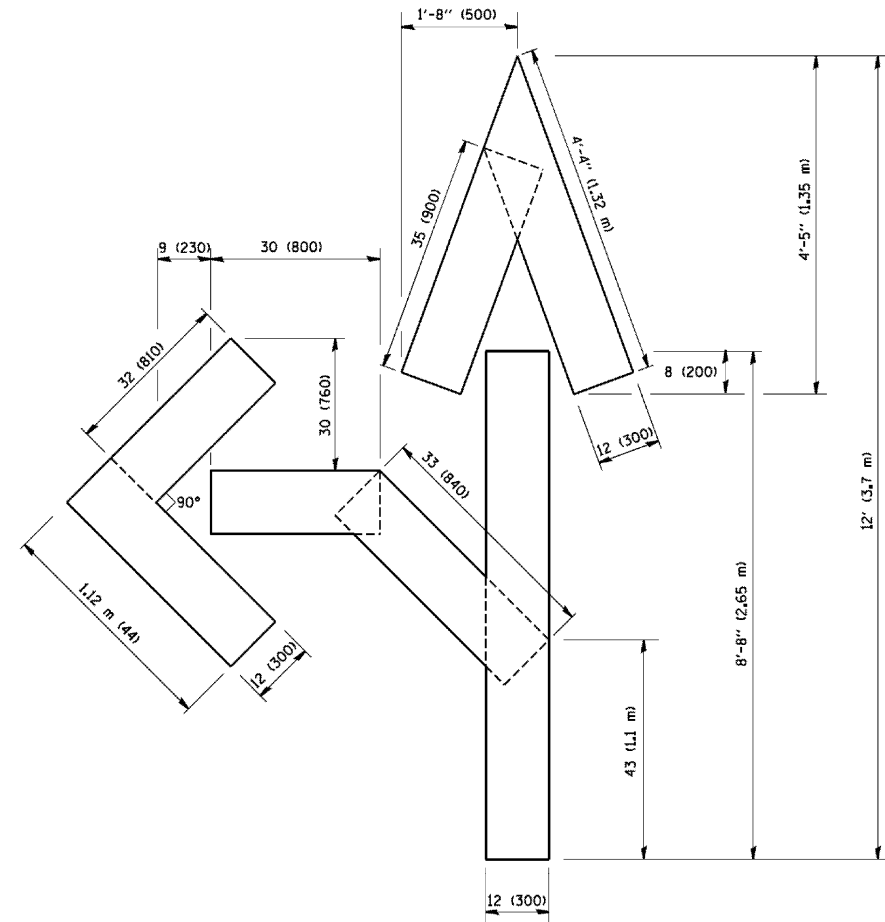

QUANTITY
 4 (100) LINE = 82.5 ft. (25.3 m)
 27.5 sq. ft. (2.53 sq. m)

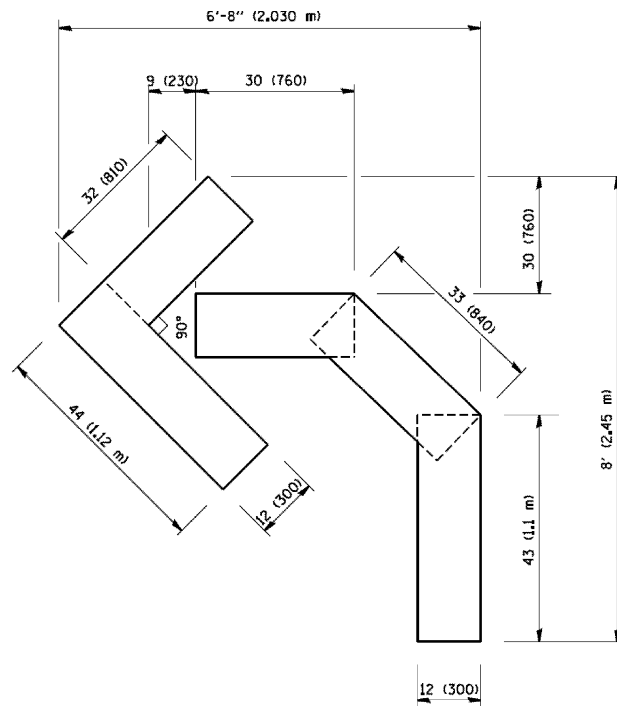

QUANTITY
 4 (100) LINE = 45.5 ft. (13.9 m)
 15.2 sq. ft. (1.39 sq. m)

All dimensions are in inches (millimeters) unless otherwise shown.

COPYRIGHT © 2011 BY BAXTER & WOODMAN, INC.
 ALL RIGHTS RESERVED. THIS DOCUMENT IS THE PROPERTY OF BAXTER & WOODMAN, INC. AND IS TO BE USED ONLY FOR THE PROJECT AND SITE SPECIFICALLY IDENTIFIED IN THE TITLE BLOCK.
 ANY REUSE OR REPRODUCTION OF THIS DOCUMENT WITHOUT THE WRITTEN PERMISSION OF BAXTER & WOODMAN, INC. IS STRICTLY PROHIBITED.
 W:\diststa\22x34\tol6.dgn
 USER: geglennob
 DATE: 1/4/2008
 TIME: 2:57:03 PM

FILE NAME = W:\diststa\22x34\tol6.dgn	USER NAME = geglennob	DESIGNED -	REVISED - T, RAMMACHER 06-05-96
		DRAWN -	REVISED - T, RAMMACHER 11-04-97
	PLOT SCALE = 50.0000' / IN.	CHECKED -	REVISED - T, RAMMACHER 03-02-98
	PLOT DATE = 1/4/2008	DATE = 09-18-94	REVISED - E. GOMEZ 08-28-00

**STATE OF ILLINOIS
 DEPARTMENT OF TRANSPORTATION**

PAVEMENT MARKING LETTERS AND SYMBOLS FOR TRAFFIC STAGING				
F.A.P. RTE.	SECTION	COUNTY	TOTAL SHEETS	SHEET NO.
066	21-RS-3	MCHENRY	32	30
TC-16		CONTRACT NO.	60N27	
FED. ROAD DIST. NO. 1 ILLINOIS FED. AID PROJECT				

SCALE: NONE SHEET NO. 1 OF 1 SHEETS STA. TO STA.