

**PIER ELEVATION  
LOOKING WEST**

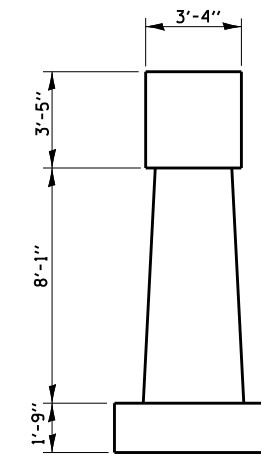

**END VIEW**

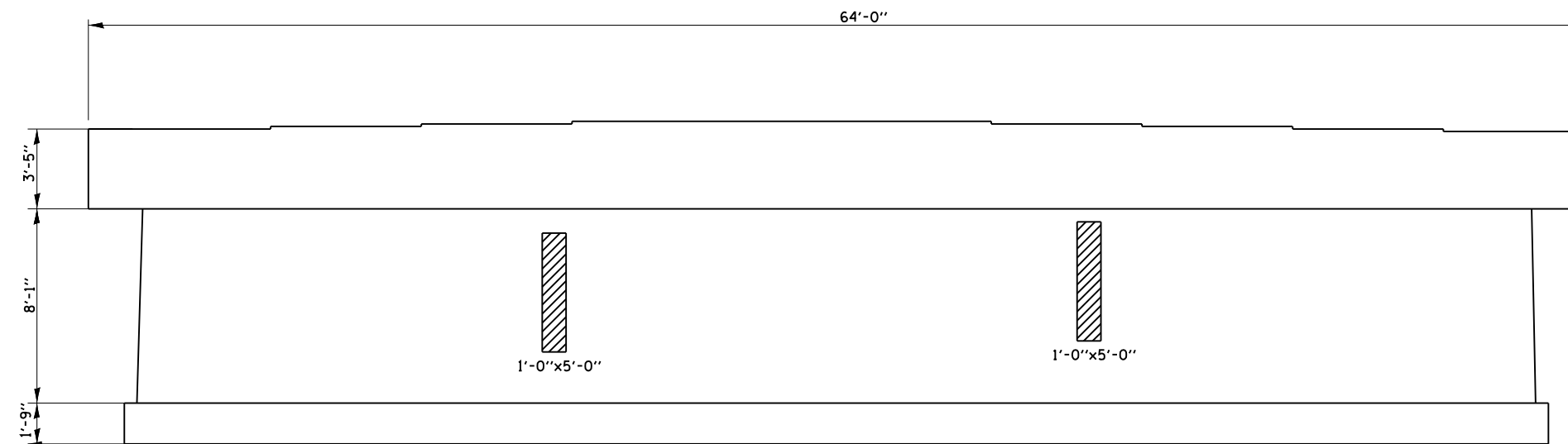

**PIER ELEVATION  
LOOKING EAST**

**BILL OF MATERIALS**

ITEM	UNIT	QUANTITY
STRUCTURAL REPAIR OF CONCRETE <5"	SQ.FT.	16

**LEGEND:**

 STRUCTURAL REPAIR OF CONCRETE <5"

FILE NAME =	USER NAME = gorengautab	DESIGNED - MVT	REVISED -	<b>STATE OF ILLINOIS DEPARTMENT OF TRANSPORTATION</b>	<b>ILL 38 (ROOSEVELT ROAD) AT WEST BRANCH DUPAGE RIVER</b>			F.A.P. RTE.	SECTION	COUNTY	TOTAL SHEETS	SHEET NO.
et:\pw\work\p\dot\gorengautab\d0101671\022-0022.dgn	DRAWN - MVT	REVISED -	347					2011-067-1	DUPAGE	29	8	
PLOT SCALE = 100.0000' / in.	CHECKED -	REVISED -	<b>PIER REPAIR S.N. 022-0022</b>				<b>CONTRACT NO. 60P86</b>					
PLOT DATE = 12/14/2012	DATE - 12-20-2011	REVISED -	SCALE:		SHEET NO. 4 OF 9 SHEETS	STA.	TO STA.	ILLINOIS FED. AID PROJECT				