

MAX WIDTH 10'-0" 1 MILE AHEAD

W12-1103 48" x 48"

PLACE THIS SIGN ON NORTHBOUND IL. RTE. 53 PRIOR TO WEST RIVER ROAD

PLACE THIS SIGN ON SOUTHBOUND IL. RTE. 53 PRIOR TO NEW RIVER ROAD

1,080' - WET REFLECTIVE TEMPORARY TAPE, TYPE III, 4 INCH (WHITE)

TRAFFIC CONTROL AND STAGING LEGEND

- WORK ZONE
- DIRECTION OF TRAFFIC
- TRAFFIC SIGNAL W/ POLE
- TRAFFIC SIGNAL
- POLE
- TYPE III BARRICADES WITH FLASHING LIGHTS
- BARRICADE TYPE II OR DRUMS WITH STEADY BURNING BI-DIRECTIONAL LIGHT
- SIGN ON PORTABLE OR PREEMINENT SUPPORT
- PAVEMENT MARKING REMOVAL
- TEMPORARY RUMBLE STRIPS

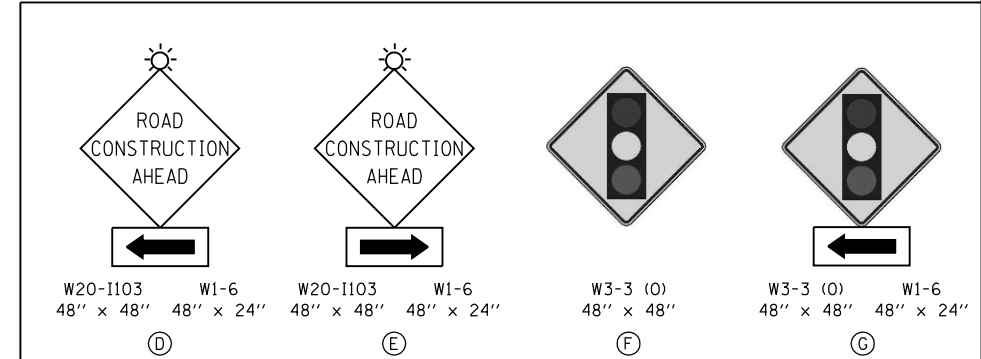
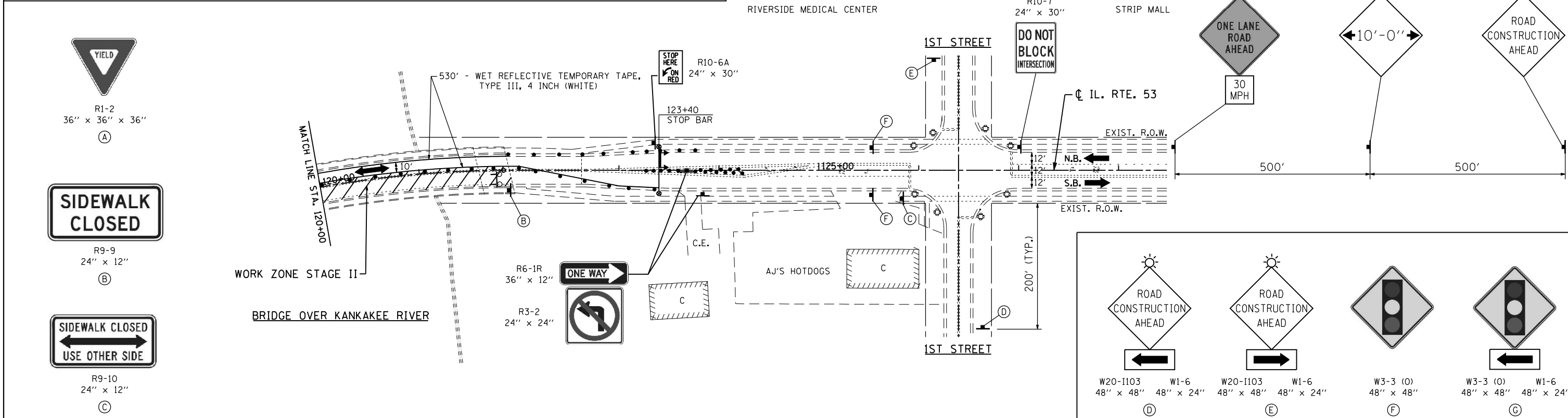

FILE NAME = D160R63-sht-staging3.dgn
 PLOT DATE = 1/7/2013
 PLOT SCALE = 100.0000' / IN.

CHRISTIAN-ROGE & ASSOCIATES, INC.
 ENGINEERS-PLANNERS-SURVEYORS
 211 WEST WACKER DRIVE
 CHICAGO, ILLINOIS 60606
 PHONE: (312)372-2023 FAX: (312)372-8274

DESIGNED - S.J.P.	REVISED -
DRAWN - A.C.S.	REVISED -
CHECKED - M.P.	REVISED -
DATE - OCTOBER 9, 2012	REVISED -

**STATE OF ILLINOIS
 DEPARTMENT OF TRANSPORTATION**

**SUGGESTED TRAFFIC CONTROL AND PROTECTION - STAGE II
 IL. RTE. 53 OVER KANKAKEE RIVER**

SCALE: NONE SHEET NO. 2 OF 2 SHEETS STA. 114+15 TO STA. 123+02

F.A.P. RTE.	SECTION	COUNTY	TOTAL SHEETS	SHEET NO.
846	K-29-A-BR-1	WILL	55	10
CONTRACT NO. 60R63				
FED. ROAD DIST. NO. 1 ILLINOIS FED. AID PROJECT				