

QUANTITY
 4 (100) LINE = 64.1 ft. (19.7 m)
 21.1 sq. ft. (1.97 sq. m)

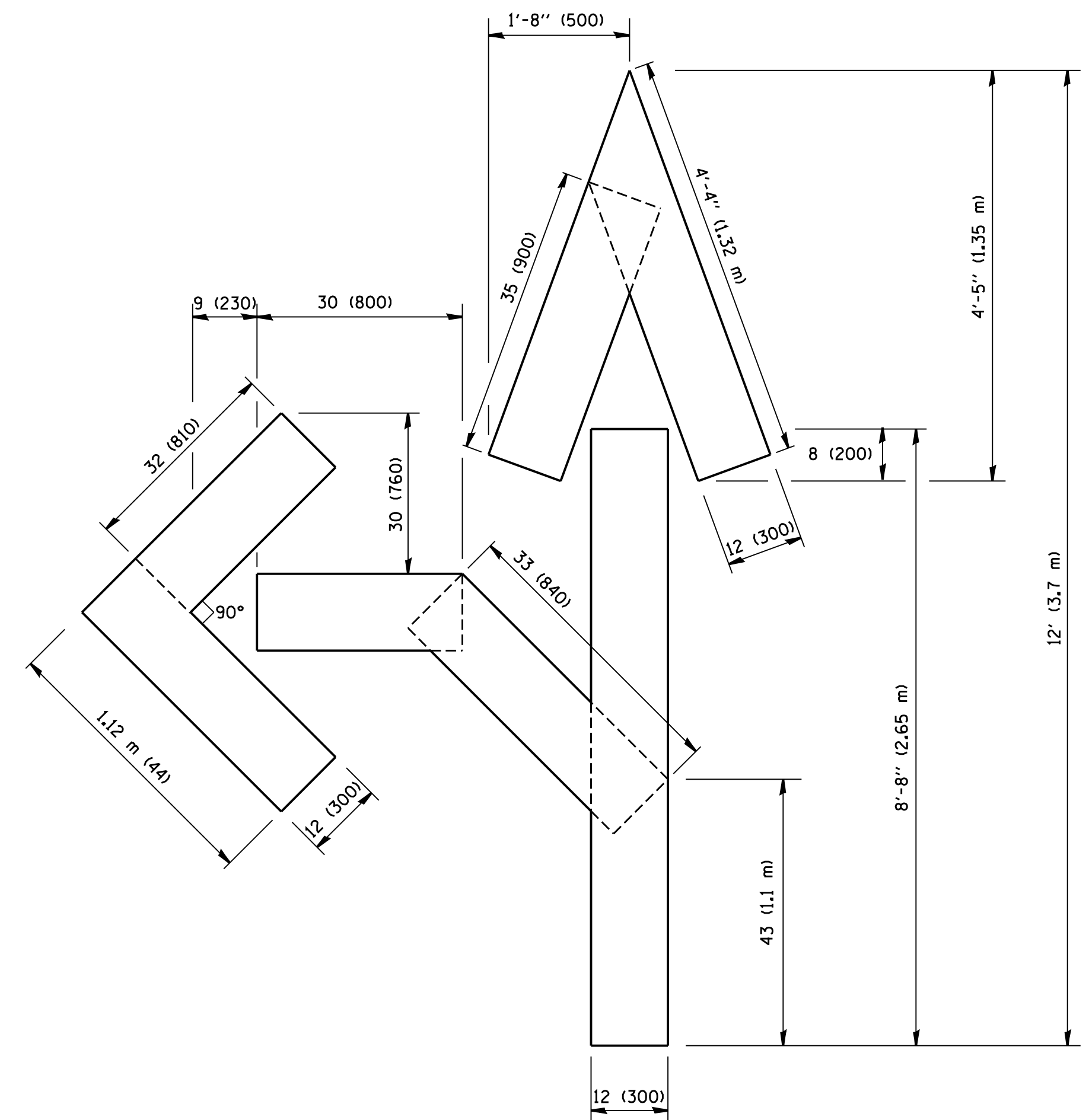

QUANTITY
 4 (100) LINE = 82.5 ft. (25.3 m)
 27.5 sq. ft. (2.53 sq. m)

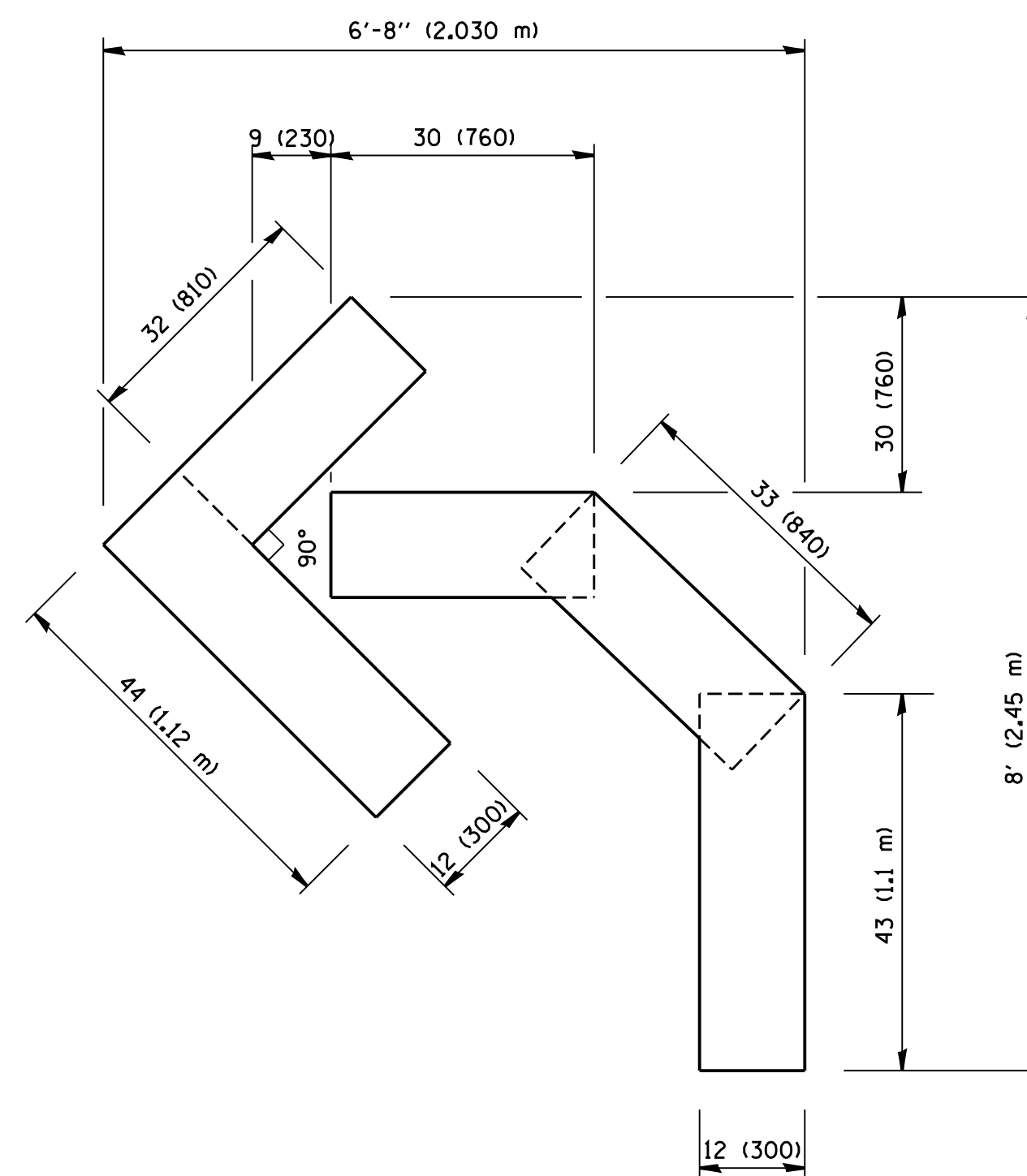

QUANTITY
 4 (100) LINE = 45.5 ft. (13.9 m)
 15.2 sq. ft. (1.39 sq. m)

All dimensions are in inches (millimeters) unless otherwise shown.

| | | | |
|--|-----------------------------|-----------------|--------------------------------|
| FILE NAME = W:\diststd\22x34\tbl6.dgn | USER NAME = gaglionobt | DESIGNED - | REVISED -T. RAMMACHER 06-05-96 |
| | | DRAWN - | REVISED -T. RAMMACHER 11-04-97 |
| | PLOT SCALE = 50.0000' / IN. | CHECKED - | REVISED -T. RAMMACHER 03-02-98 |
| | PLOT DATE = 1/4/2008 | DATE - 09-18-94 | REVISED -E. GOMEZ 08-28-00 |

**STATE OF ILLINOIS
 DEPARTMENT OF TRANSPORTATION**

**PAVEMENT MARKING LETTERS AND SYMBOLS
 FOR TRAFFIC STAGING**

SCALE: NONE SHEET NO. 1 OF 1 SHEETS STA. TO STA.

| | | | | |
|---|---------|--------------|-----------------|--------------|
| F.A.P. RTE. | SECTION | COUNTY | TOTAL SHEETS | SHEET NO. |
| 334 | TR-TS | LAKE | 58 | 46 |
| TC-16 | | CONTRACT NO. | 60T88 | |
| FED. ROAD DIST. NO. 1 ILLINOIS FED. AID PROJECT | | | | |