

- W20-1103(O)-48
 ①
- W20-5(O)-48
 2L
- W20-5(O)-48
 2R
- W20-5(O)-48
 3L
- W20-5(O)-48
 3R
- W4-2R(O)-48
 5R
- W4-2R(O)-48
 5L
- W20-1103(O)-48
 6
- W20-7(O)-48
 7
- G20-1103(O)-3660
 8

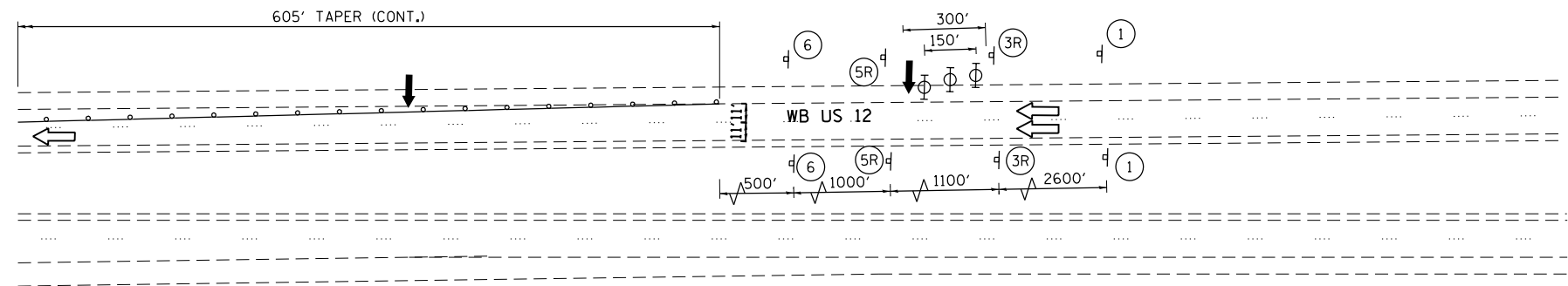

- LEGEND**
- WORK AREA
 - TYPE II BARRICADES OR DRUMS WITH STEADY BURN MONODIRECTIONAL LIGHT (AT SPECIFIED SPACING)
 - DIRECTION OF TRAFFIC FLOW
 - SIGN
 - ARROW BOARD

NOTES:

1. FOR ADDITIONAL TRAFFIC CONTROL AND SIGN DETAILS SEE HIGHWAY STANDARDS 701411 AND 701422

FILE NAME =	USER NAME = r9e11	DESIGNED -	REVISED -	STATE OF ILLINOIS DEPARTMENT OF TRANSPORTATION	US 12 /IL 59 OVER IL RT 176 MAINTENANCE OF TRAFFIC STAGE II	F.A.P. RTE.	SECTION	COUNTY	TOTAL SHEETS	SHEET NO.	
		DRAWN -	REVISED -			334	(TH-BJBR)	LAKE	25	11	
		CHECKED -	REVISED -			CONTRACT NO. 60W19					
		DATE -	REVISED -			ILLINOIS FED. AID PROJECT					
					SCALE:	SHEET OF SHEETS		STA. TO STA.			