

**SCHEDULE OF QUANTITIES**  
IL 53 (BOLINGBROOK DR) AT LEE LANE / NORTHRIDGE AVENUE

NO.	QUANT.	UNIT	DESCRIPTION
1.	1	EACH	MAINTENANCE OF EXISTING TRAFFIC SIGNAL INSTALLATION
2.	4	EACH	PEDESTRIAN SIGNAL HEAD, LED, 2-FACE, BRACKET MOUNTED WITH COUNTDOWN TIMER
3.	1	EACH	REMOVE EXISTING TRAFFIC SIGNAL EQUIPMENT
4.	5	EACH	PEDESTRIAN PUSH-BUTTON, NON-LATCHING

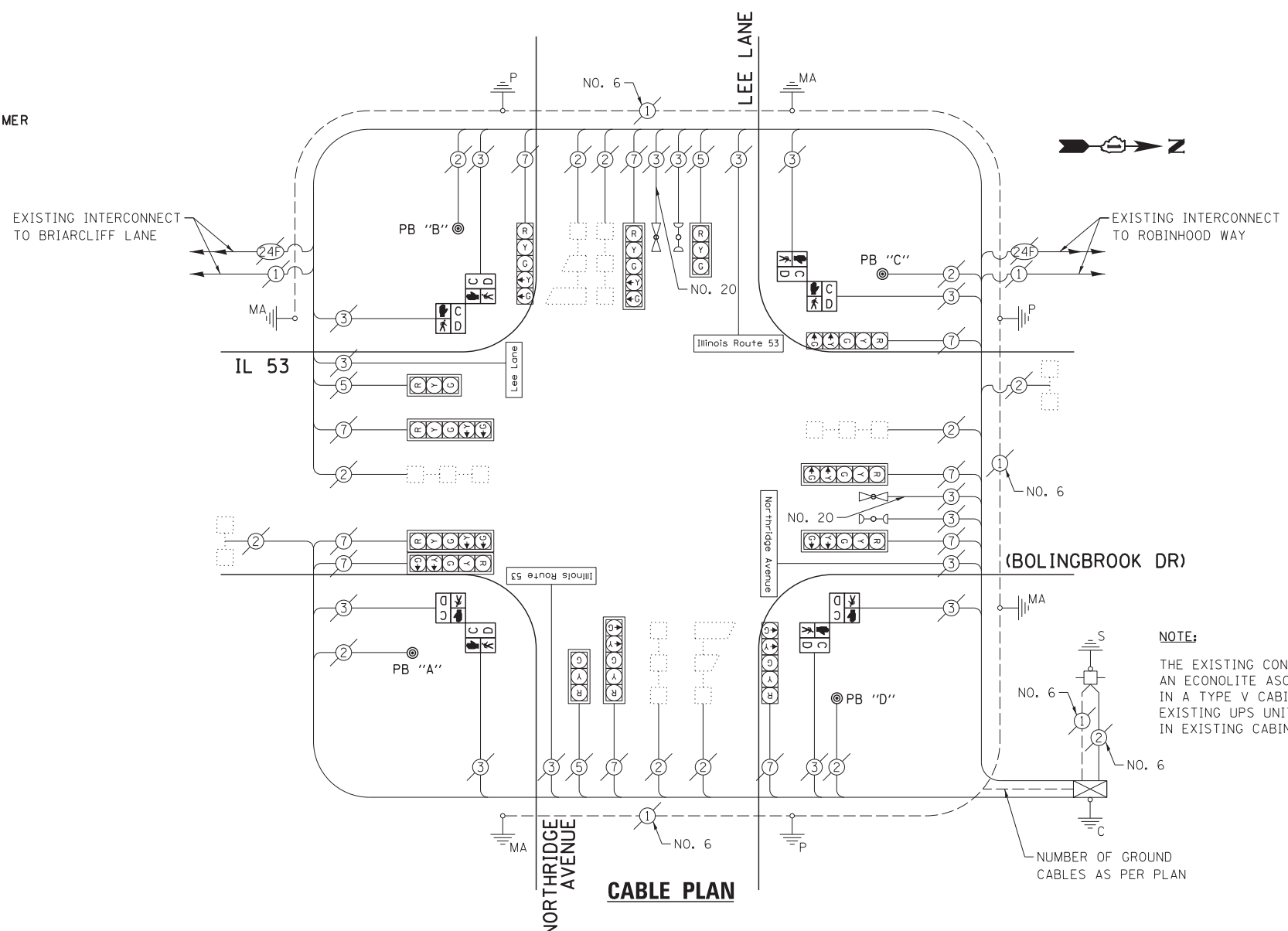

**NOTE:**  
THE EXISTING CONTROLLER IS AN ECONOLITE ASC/25-1000 IN A TYPE V CABINET. EXISTING UPS UNIT LOCATED IN EXISTING CABINET.

NUMBER OF GROUND CABLES AS PER PLAN

THE FOLLOWING ITEMS SHALL BE REMOVED BY THE CONTRACTOR AND SHALL BE DISPOSED OF BY THEM OUTSIDE THE RIGHT-OF-WAY AT THEIR EXPENSE. THE SALVAGE VALUE OF THE REMOVED EQUIPMENT SHALL BE REFLECTED IN THE CONTRACT BID PRICE.

- 4 EACH PEDESTRIAN SIGNAL HEAD, 2-FACE
- 4 EACH PEDESTRIAN PUSH-BUTTON

**EXISTING CONTROLLER SEQUENCE**

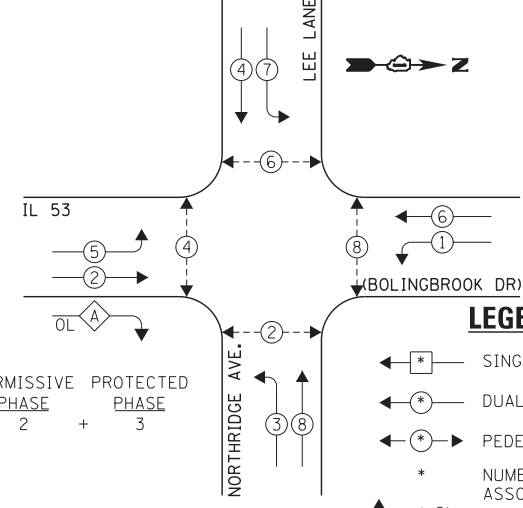

**EXISTING EMERGENCY VEHICLE PREEMPTION SEQUENCE**



**NOTE:**  
PUSH BUTTON "A" SHALL PLACE A CALL IN PHASES 2 AND 4.  
PUSH BUTTON "B" SHALL PLACE A CALL IN PHASES 4 AND 6.  
PUSH BUTTON "C" SHALL PLACE A CALL IN PHASES 6 AND 8.  
PUSH BUTTON "D" SHALL PLACE A CALL IN PHASES 2 AND 8.

I.D.O.T. TRAFFIC SIGNAL INSTALLATION ELECTRICAL SERVICE REQUIREMENTS				TOTAL WATTAGE	
TYPE	NO. LAMPS	WATTAGE	OPERATION		
		INCAND.	L.E.D.		
SIGNAL (RED)	13	135	17	0.50	110.5
SIGNAL (YELLOW)	13	135	25	0.25	81.25
SIGNAL (GREEN)	13	135	15	0.25	48.75
ARROW	20	135	12	0.10	24.0
PED. SIGNAL	8	90	25	1.00	200.0
CONTROLLER	1	-	100	1.00	100.0
LUMINAIRE	-	-	250	0.50	-
L.E.D. ST. NAME SIGN	2	-	64	0.50	64.0
VIDEO SYSTEM	-	-	150	1.00	-
BATTERY BACKUP	1	-	25	1.00	25.0
ILLUMINATED SIGN	-	-	25	0.05	-
TOTAL =					653.5

ENERGY COSTS - BILLED TO: IL DEPT. OF TRANSPORTATION  
(ADDRESS) 201 W. CENTER COURT  
(ADDRESS) SCHALMBURG, IL 60196-1096  
ENERGY SUPPLY - CONTACT: IL YAS MOHIUDDIN  
PHONE: 708-235-2692  
COMPANY: COMED - BOLINGBROOK

THE TRAFFIC SIGNAL CONTROL EQUIPMENT FOR THIS PROJECT SHALL BE "ECONOLITE" TO MATCH THE EXISTING ADJACENT SYSTEM.

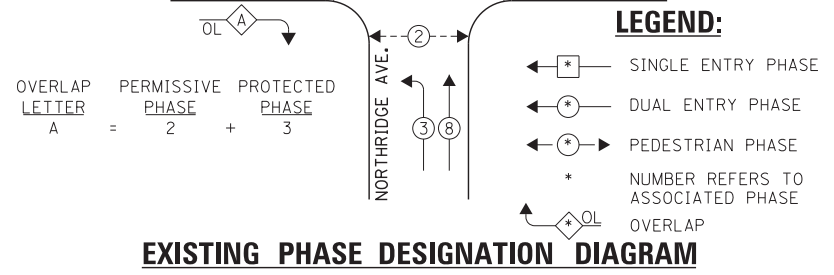

EXISTING EMERGENCY VEHICLE PREEMPTORS	
EMERGENCY VEHICLE PREEMPTOR	3 4
MOVEMENT	← → ↑ ↓

**EXISTING PHASE DESIGNATION DIAGRAM**

FILE NAME = 60W21-018-IL53(Bolingbrook Dr)@Lee Ln-Northridge Plaza.dgn	USER NAME = gwhitten	DESIGNED - JRD	REVISED -
60W21-018	PLOT SCALE = 1:20	DRAWN - GW3	REVISED -
	PLOT DATE = 3/28/2013	CHECKED - KLB	REVISED -
		DATE - 03-28-13	REVISED -

STATE OF ILLINOIS  
DEPARTMENT OF TRANSPORTATION

**SCHEDULE OF QUANTITIES, CABLE PLAN, PHASE DESIGNATION DIAGRAM, & EMERGENCY VEHICLE PREEMPTION SEQUENCE**  
IL 53 (BOLINGBROOK DR) AT LEE LANE /NORTHRIDGE AVENUE

F.A. RTE.	SECTION	COUNTY	TOTAL SHEETS	SHEET NO.
VAR	2013-003-I	WILL	89	18
CONTRACT NO. 60W21				
ILLINOIS FED. AID PROJECT				