

SCHEDULE OF QUANTITIES
IL 53 (BOLINGBROOK DR) AT LILY CACHE LANE

NO.	QUANT.	UNIT	DESCRIPTION
1.	1	EACH	MAINTENANCE OF EXISTING TRAFFIC SIGNAL INSTALLATION
2.	2	EACH	TRAFFIC SIGNAL POST, GALVANIZED STEEL 14 FT.
3.	1	EACH	TRAFFIC SIGNAL POST, GALVANIZED STEEL 18 FT.
4.	3	EACH	RELOCATE EXISTING SIGNAL HEAD
5.	1	EACH	RELOCATE EXISTING EMERGENCY VEHICLE PRIORITY SYSTEM, DETECTOR UNIT
6.	1	EACH	REMOVE EXISTING TRAFFIC SIGNAL EQUIPMENT

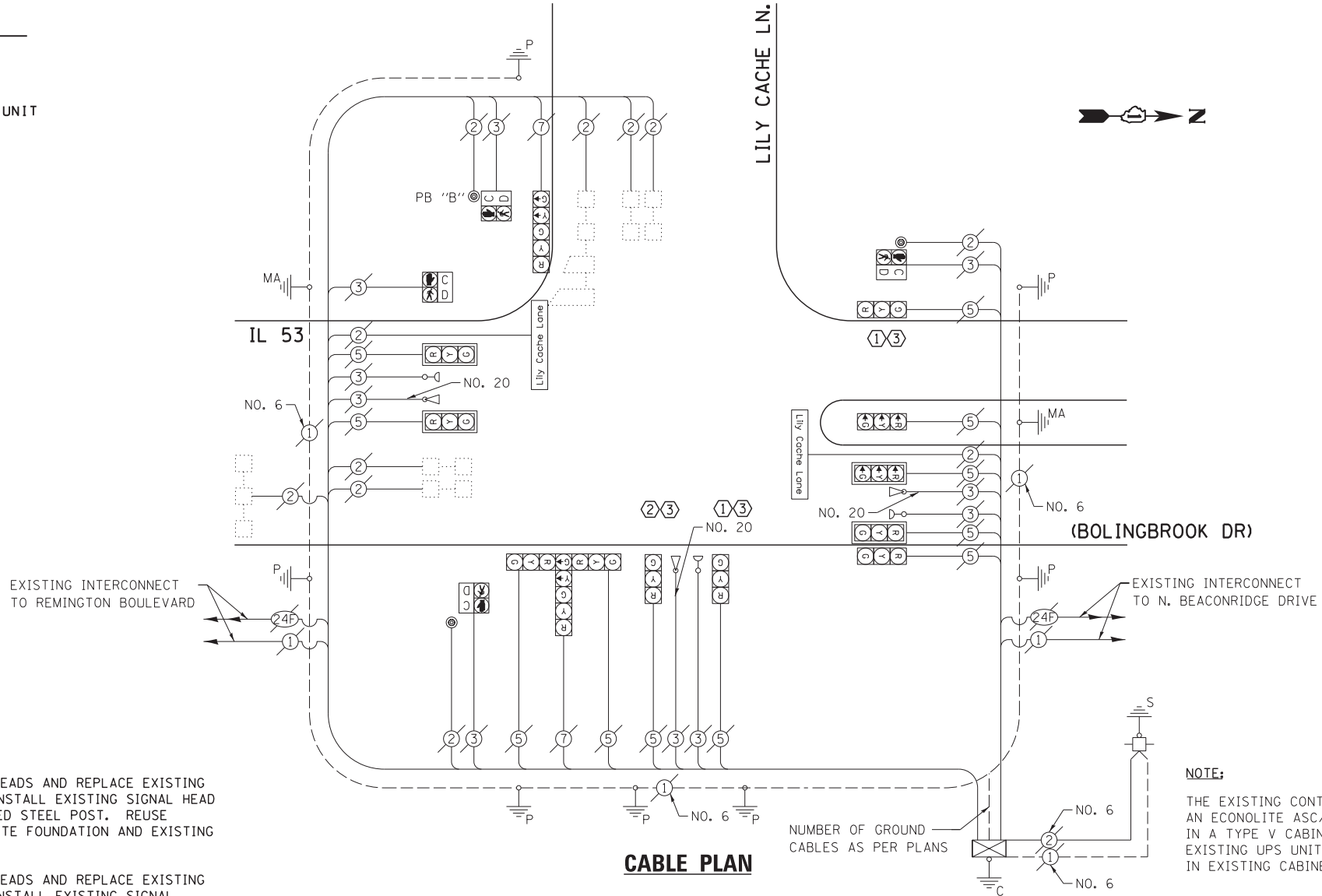

CABLE PLAN

- CONSTRUCTION NOTE:**
- 1 REMOVE EXISTING SIGNAL HEADS AND REPLACE EXISTING 14 FOOT PAINTED POST. INSTALL EXISTING SIGNAL HEAD ON NEW 14 FOOT GALVANIZED STEEL POST. REUSE EXISTING TYPE "A" CONCRETE FOUNDATION AND EXISTING CABLES.
 - 2 REMOVE EXISTING SIGNAL HEADS AND REPLACE EXISTING 14 FOOT PAINTED POST. INSTALL EXISTING SIGNAL HEADS AND EXISTING EMERGENCY VEHICLE PRIORITY SYSTEM UNIT ON NEW 18 FOOT GALVANIZED STEEL POST. REUSE EXISTING TYPE "A" CONCRETE FOUNDATION AND EXISTING CABLES.
 - 3 AT LOCATIONS ON THE PLANS WHERE TRAFFIC SIGNAL POST REMOVAL AND NEW TRAFFIC SIGNAL POST INSTALLATIONS ARE SPECIFIED, THE CONTRACTOR SHALL INSPECT THE EXISTING POST FOUNDATIONS. PRIOR TO REMOVING THE EXISTING TRAFFIC SIGNAL POST TO BE REPLACED, THE CONTRACTOR SHALL VERIFY THAT THE EXISTING CONDITION OF THE ANCHOR BOLT IS ACCEPTABLE. IF THE EXISTING ANCHOR BOLT CONDITION IS NOT ACCEPTABLE, THE EXISTING TRAFFIC SIGNAL POST SHALL REMAIN IN PLACE AND NOT BE REMOVED AFTER THE CONTRACTOR HAS VERIFIED THE CONDITION OF THE ANCHOR BOLT WITH THE ENGINEER. THE CONTRACTOR SHALL BE PAID FOR THE NUMBER OF TRAFFIC SIGNAL POSTS INSTALLED AND NO OTHER COMPENSATION WILL BE PROVIDED.

THE FOLLOWING ITEMS SHALL BE REMOVED BY THE CONTRACTOR AND SHALL BE DISPOSED OF BY THEM OUTSIDE THE RIGHT-OF-WAY AT THEIR EXPENSE. THE SALVAGE VALUE OF THE REMOVED EQUIPMENT SHALL BE REFLECTED IN THE CONTRACT BID PRICE.

3 EACH TRAFFIC SIGNAL POST

NOTE:
THE EXISTING CONTROLLER IS AN ECONOLITE ASC/2S-1000 IN A TYPE V CABINET. EXISTING UPS UNIT LOCATED IN EXISTING CABINET.

NOTE:
PUSH BUTTON "B" SHALL PLACE A CALL IN PHASES 4 AND 6.

EXISTING CONTROLLER SEQUENCE

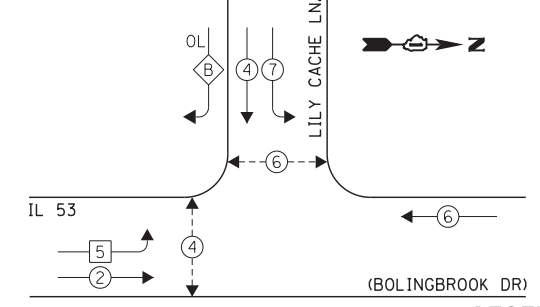

EXISTING EMERGENCY VEHICLE PREEMPTION SEQUENCE

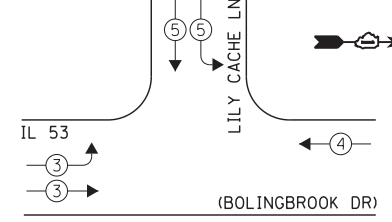

LEGEND:

- ← * → SINGLE ENTRY PHASE
 - ← * → DUAL ENTRY PHASE
 - ← * → PEDESTRIAN PHASE
 - * NUMBER REFERS TO ASSOCIATED PHASE
 - ← * OL → OVERLAP
- OVERLAP LETTER B = PERMISSIVE PHASE 4 + PROTECTED PHASE 5

EXISTING PHASE DESIGNATION DIAGRAM

EXISTING EMERGENCY VEHICLE PREEMPTORS		
EMERGENCY VEHICLE PREEMPTOR	3	4
MOVEMENT	→	←

I.D.O.T. TRAFFIC SIGNAL INSTALLATION ELECTRICAL SERVICE REQUIREMENTS					TOTAL WATTAGE
TYPE	NO. LAMPS	INCAND.	L.E.D.	OPERATION	
SIGNAL (RED)	13	135	17	0.50	110.5
SIGNAL (YELLOW)	13	135	25	0.25	81.25
SIGNAL (GREEN)	13	135	15	0.25	48.75
ARROW	4	135	12	0.10	4.8
PED. SIGNAL	4	90	25	1.00	100.0
CONTROLLER	1	-	100	1.00	100.0
LUMINAIRE	-	-	250	0.50	-
L.E.D. ST. NAME SIGN	-	-	64	0.50	-
VIDEO SYSTEM	-	-	150	1.00	-
BATTERY BACKUP	1	-	25	1.00	25.0
ILLUMINATED SIGN	-	-	25	0.05	-
TOTAL =					470.3

THE TRAFFIC SIGNAL CONTROL EQUIPMENT FOR THIS PROJECT SHALL BE "ECONOLITE" TO MATCH THE EXISTING ADJACENT SYSTEM.

ENERGY COSTS - BILLED TO: IL DEPT. OF TRANSPORTATION
(ADDRESS) 201 W. CENTER COURT
(ADDRESS) SCHAUMBURG, IL 60196-1096
ENERGY SUPPLY - CONTACT: IL YAS MOHIUDDIN
PHONE: 708-235-2692
COMPANY: COMED - BOLINGBROOK

FILE NAME = 60W21-021-IL53(Bolingbrook Dr)@Lily Cache	USER NAME = gwhitten	DESIGNED - JRD	REVISED -
Ln.dgn		DRAWN - GW3	REVISED -
PLOT SCALE = 1:20		CHECKED - KLB	REVISED -
PLOT DATE = 3/28/2013		DATE - 03-28-13	REVISED -

STATE OF ILLINOIS
DEPARTMENT OF TRANSPORTATION

SCHEDULE OF QUANTITIES, CABLE PLAN, PHASE DESIGNATION DIAGRAM, & EMERGENCY VEHICLE PREEMPTION SEQUENCE
IL 53 (BOLINGBROOK DR) AT LILY CACHE LANE

SCALE: SHEET OF SHEETS STA. TO STA.

F.A. RTE.	SECTION	COUNTY	TOTAL SHEETS	SHEET NO.
VAR	2013-003-I	WILL	89	21
CONTRACT NO. 60W21				