

MAIN PANEL PLUG-IN REQUIREMENTS

LS1 VEH 1	LS2 VEH 2	LS3 VEH 3	LS4 VEH 4	LS5 VEH 5	LS6 VEH 6	LS7 VEH 7	LS8 VEH 8	FL1 1CKT	FL2 1CKT
LS9 PED 2 BEACON	LS10 PED 4 BEACON	LS11 PED 6 BEACON	LS12 PED 8 BEACON	LS13 VEH 9	LS14 VEH 10	LS15 VEH 11	LS16 VEH 12	LS17 PED 10 BEACON	LS18 PED 12 BEACON
FR1 L/R V1/V5	FR2 L/R V2/V6	FR3 L/R V3/V7	FR4 L/R V4/V8	FR5 L/R V9/V12	FR6 L/R V10/V11	K1 CMU SENSOR	K2 +24V CONT.		

■ DENOTES TYPE OF OPERATION AND/OR WHERE PLUG-IN IS REQUIRED. L = LEFT, R = RIGHT.
 ☒ DENOTES WHERE "UNUSED RED" JUMPER PART NUMBER 32448G1 IS REQUIRED. INSTALL BETWEEN PINS 1 & 3 FOR LOAD SWITCH OR PINS 6 & 8 AND 5 & 7 FOR FLASH TRANSFER RELAY.

FLASH:
 □ 02&6 YELLOW, ALL OTHERS RED
 ■ ALL RED
 □ RELAYS DE-ENERGIZED FOR FLASH
 □ RELAYS ENERGIZED FOR FLASH
 ■ CMU DISCONNECTED
 □ CMU DISCONNECTED & DOOR CLOSED

SEQUENCE

1	2	3	4	9	10
5	6	7	8	11	12

SPECIAL DATA MODULE REQUIRED C7522

SHEET 1 OF 10

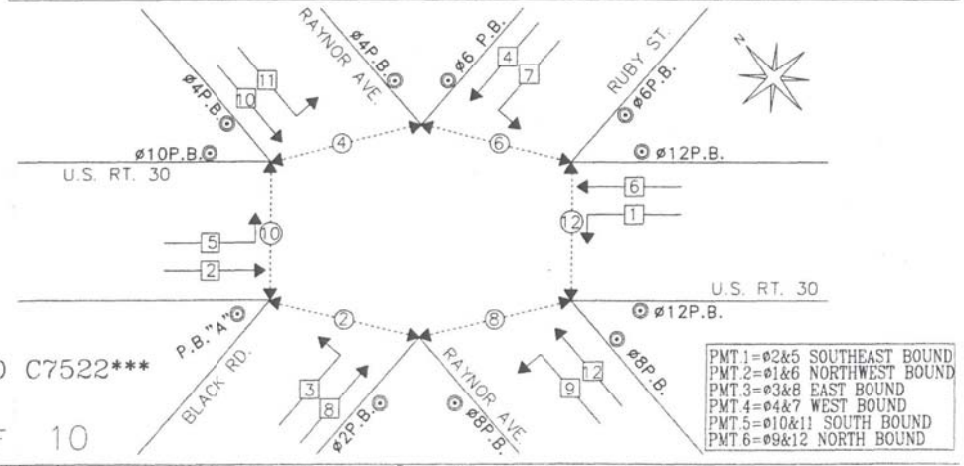

DESIGNER G.V. T.C.C.	DATE 2-3-97	ECONOLITE CONTROL PRODUCTS INC.	TRAFFIC CONTROL CORPORATION	780 W. BELDEN SUITE D. ADDISON, IL 60101
DRAWN C.M. T.C.C.	05/06/02	CABINET SPECIFICATION: TS-1 97 SPEC. 18 POS.		
CHECKED		CUSTOMER: IDOT		
INSPECTED		INTERSECTION: U.S. RT. 30 @ RAYNOR AVE./U.S. RT. 30 @ BLACK RD./RUBY ST.		
APPROVED		LOCATION: JOLIET		
CUSTOMER P.O. 905400	INSTALLED BY ALDRIDGE	SALES ORDER NO. 770240-IL7522	SIZE B	DRAWING #TS197N-IL7522 RT. 30 @ RAYNOR & BLACK/RUBY

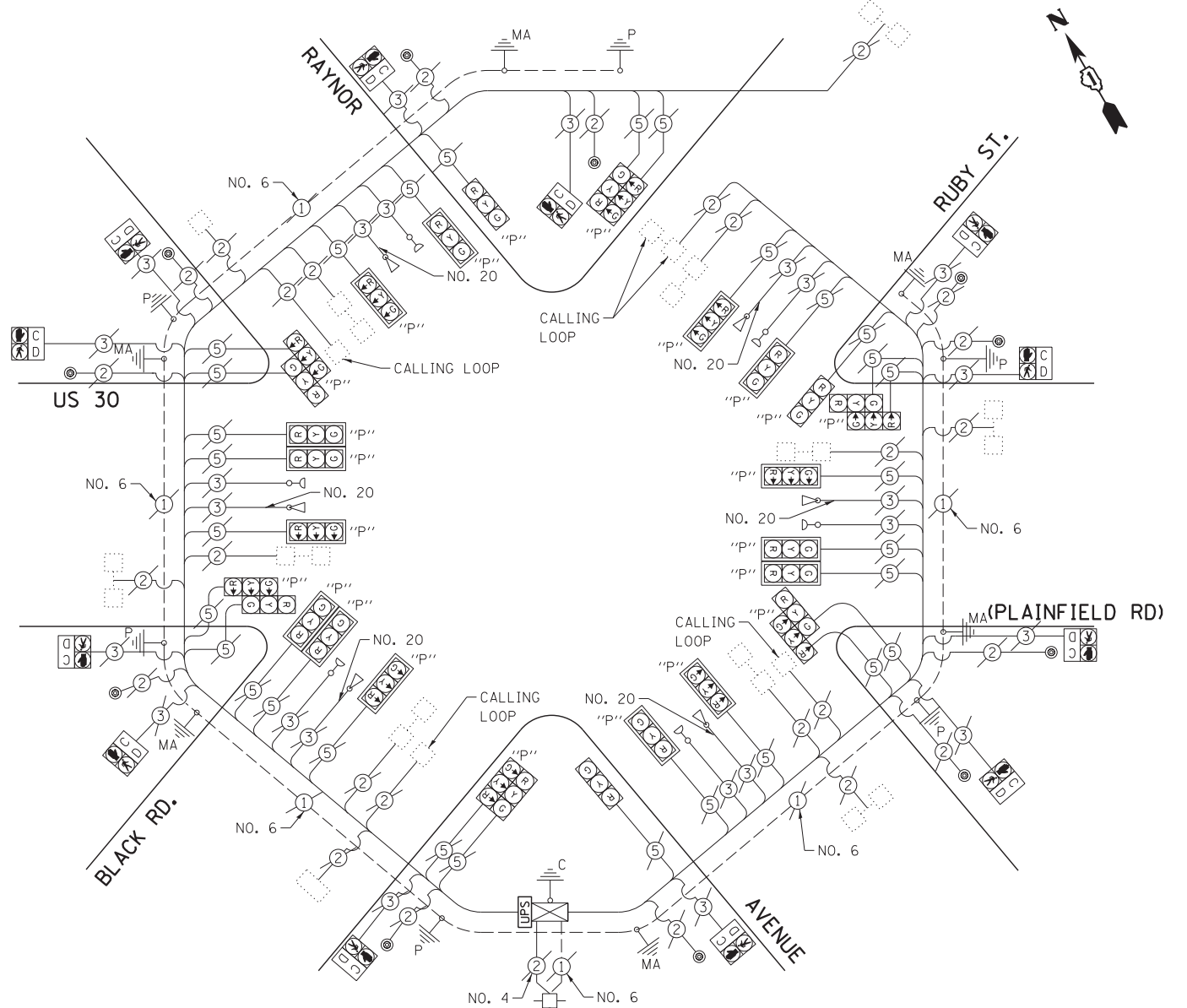

CABLE PLAN

NOTE:
THE EXISTING CONTROLLER IS AN ECONOLITE ASC/2S-2100 IN A TYPE V CABINET.

SCHEDULE OF QUANTITIES

U.S. 30 (PLAINFIELD RD) AT RAYNOR AVENUE / BLACK ROAD

NO.	QUANT.	UNIT	DESCRIPTION
1.	1	EACH	MAINTENANCE OF EXISTING TRAFFIC SIGNAL INSTALLATION
2.	1	EACH	MODIFY EXISTING CONTROLLER CABINET
3.	1	EACH	UNINTERRUPTABLE POWER SUPPLY, SPECIAL

I.D.O.T. TRAFFIC SIGNAL INSTALLATION ELECTRICAL SERVICE REQUIREMENTS				TOTAL WATTAGE
TYPE	NO. LAMPS	WATTAGE INCAND. L.E.D.	OPERATION	
SIGNAL (RED)	30	135 17	0.50	255.0
SIGNAL (YELLOW)	30	135 25	0.25	187.5
SIGNAL (GREEN)	30	135 15	0.25	112.5
ARROW	-	135 12	0.10	-
PED. SIGNAL	12	90 25	1.00	300.0
CONTROLLER	1	-	100	100.0
LUMINAIRE	-	-	250	-
L.E.D. ST. NAME SIGN	-	-	64	-
VIDEO SYSTEM	-	-	150	-
BATTERY BACKUP	1	-	25	25.0
ILLUMINATED SIGN	-	-	0.05	-
TOTAL =				980.0

ENERGY COSTS - BILLED TO: IL DEPT. OF TRANSPORTATION
 (ADDRESS) 201 W. CENTER COURT
 (ADDRESS) SCHAUMBURG, IL 60196-1096
 ENERGY SUPPLY - CONTACT: TIM COSLET
 PHONE: 815-724-5010
 COMPANY: COMED - JOLIET

THE TRAFFIC SIGNAL CONTROL EQUIPMENT FOR THIS PROJECT SHALL BE "ECONOLITE" TO MATCH THE EXISTING ADJACENT SYSTEM.

FILE NAME =	USER NAME = gwhitten	DESIGNED - JRD	REVISED -
60W21-051-US30(Plainfield Rd)@Raynor Ave-Black Rd.dgn		DRAWN - GW3	REVISED -
		CHECKED - KLB	REVISED -
60W21-051	PLOT DATE = 3/28/2013	DATE - 03-28-13	REVISED -

**STATE OF ILLINOIS
DEPARTMENT OF TRANSPORTATION**

SCHEDULE OF QUANTITIES, CABLE PLAN, PHASE DESIGNATION DIAGRAM, & EMERGENCY VEHICLE PREEMPTION SEQUENCE US 30 (PLAINFIELD RD) AT RAYNOR AVENUE /BLACK ROAD			
SCALE:	SHEET	OF SHEETS	STA. TO STA.

F.A. RTE.	SECTION	COUNTY	TOTAL SHEETS	SHEET NO.
	2013-003-I	WILL	89	51
CONTRACT NO. 60W21				
ILLINOIS FED. AID PROJECT				