

**EXISTING TYPICAL SECTION
SUMMIT AVENUE
STA 199+70.73 TO STA 202+81**

SCALE
1" = 10' HORIZ.
1" = 5' VERT.

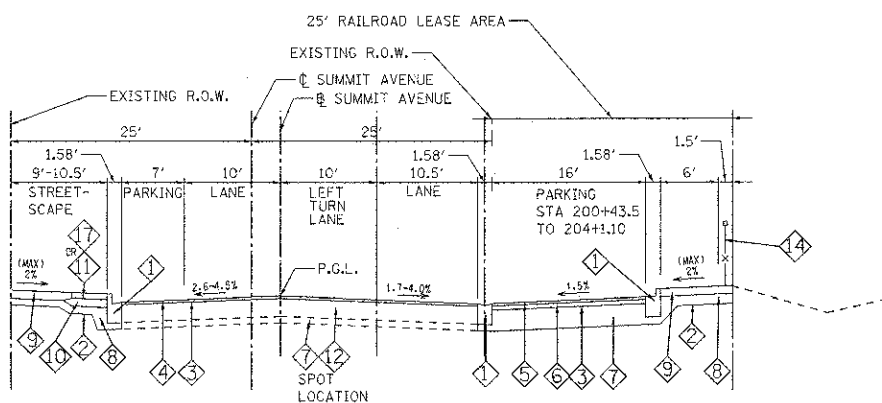

**PROPOSED TYPICAL SECTION
SUMMIT AVENUE
STA 199+70.73 TO STA 202+13**

SCALE
1" = 10' HORIZ.
1" = 5' VERT.

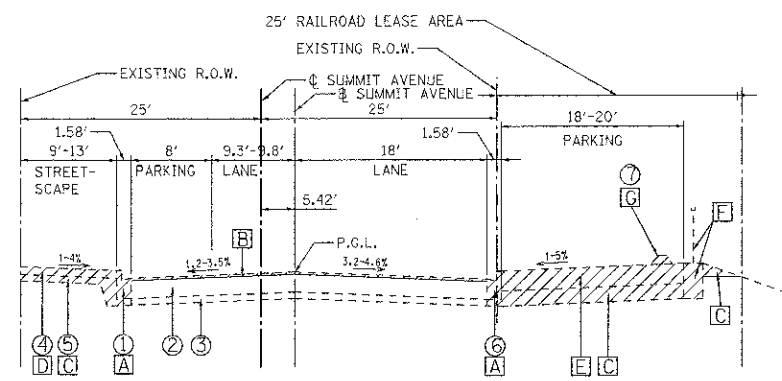

**EXISTING TYPICAL SECTION
SUMMIT AVENUE
STA 202+81 TO STA 204+37**

SCALE
1" = 10' HORIZ.
1" = 5' VERT.

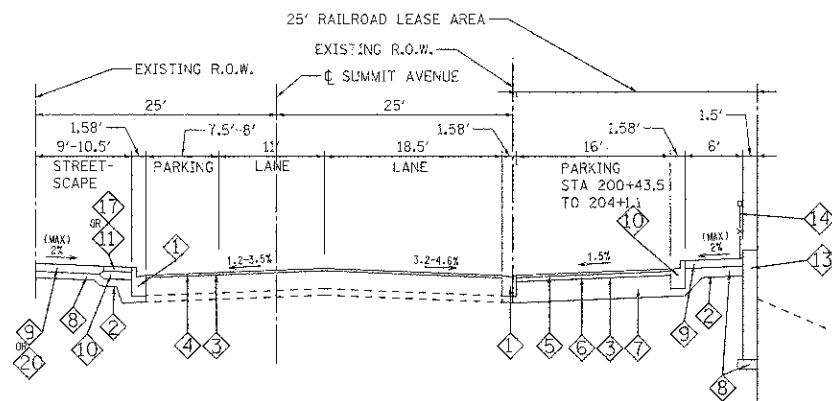

**PROPOSED TYPICAL SECTION
SUMMIT AVENUE
STA 202+13 TO STA 204+20.4**

SCALE
1" = 10' HORIZ.
1" = 5' VERT.

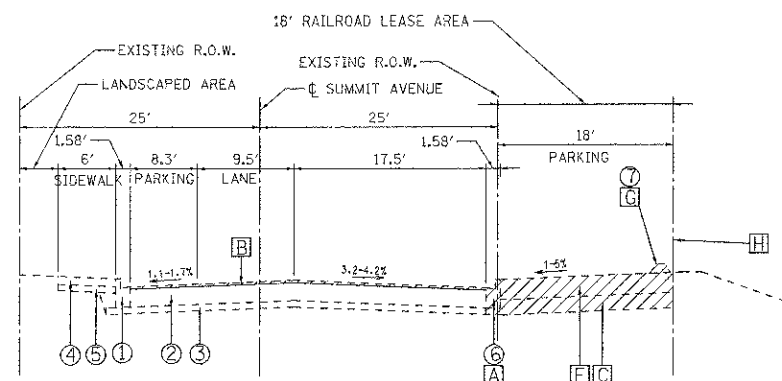

**EXISTING TYPICAL SECTION
SUMMIT AVENUE
STA 204+37 TO STA 207+89.50**

SCALE
1" = 10' HORIZ.
1" = 5' VERT.

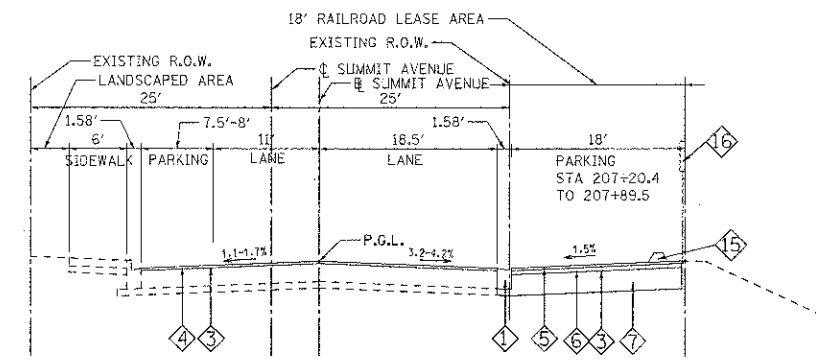

**PROPOSED TYPICAL SECTION
SUMMIT AVENUE
STA 204+20.4 TO STA 208+44.40**

SCALE
1" = 10' HORIZ.
1" = 5' VERT.

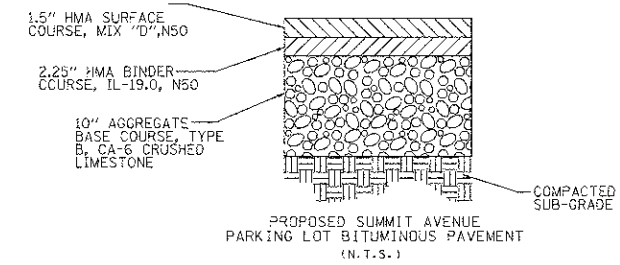

EXISTING ITEMS

- ① EXISTING CONCRETE CURB AND GUTTER, TYPE B6.12
- ② EXISTING ASPHALT PAVEMENT
- ③ EXISTING SUB-BASE GRANULAR MATERIAL
- ④ EXISTING P.C.C. SIDEWALK (+/-5")
- ⑤ EXISTING SIDEWALK SUB-BASE GRANULAR MATERIAL
- ⑥ EXISTING CONCRETE CURB AND GUTTER, M3.12
- ⑦ EXISTING PARKING BLOCK

REMOVAL PAY ITEMS (PAY ITEM #)

- Ⓐ COMBINATION CURB AND GUTTER REMOVAL (44000500)
- Ⓑ HOT MIX ASPHALT (HMA) SURFACE REMOVAL (2") (44000157)
- Ⓒ EXCAVATION / SUB-BASE REMOVAL (20200100)
- Ⓓ SIDEWALK REMOVAL (44000600)
- Ⓔ PAVEMENT REMOVAL (44000100)
- Ⓕ PARKING METER POST TO BE REMOVED (73700100)
- Ⓖ REMOVE EXISTING PARKING BLOCK (X0301339)
- Ⓗ REMOVE AND RESET RAILROAD PARKING STALL NUMBER SIGN (20051500)

PROPOSED ITEMS (PAY ITEM #)

- ① COMBINATION CONCRETE CURB AND GUTTER B6.12 MODIFIED ,(60604100)
- * ② FILTER FABRIC, (28200200)
- ③ PRIME COAT, (40600100, 40600300)
- ④ PROPOSED HOT-MIX ASPHALT SURFACE COURSE, MIX "D" N50-2" ,(40603335)
- ⑤ PROPOSED HOT-MIX ASPHALT SURFACE COURSE, MIX "D" N50-1 1/2" ,(40603335)
- ⑥ PROPOSED HOT-MIX ASPHALT, BINDER COURSE, IL-19.0, N50-2 1/4" ,(40603080)
- ⑦ AGGREGATE BASE COURSE, TYPE B, 10" ,(35102200)
- * ⑧ AGGREGATE BASE COURSE, TYPE B, 6" ,(35101800)
- * ⑨ PCC SIDEWALK 5", SPECIAL ,(X4240430)
- * ⑩ REINFORCED CONCRETE SLAB, 4" ,(X0325942)
- * ⑪ BRICK PAVER ,(X0540000)
- * ⑫ PCC PAVEMENT 8", SPECIAL ,(X4200408)
- * ⑬ PRECAST MODULAR RETAINING WALL ,(X0323443)
- * ⑭ ORNAMENTAL METAL FENCE ,(XX004101)
- ⑮ PRECAST CONCRETE PARKING BLOCK ,(X0301430)
- ⑯ RAILROAD PARKING STALL NUMBER SIGN ,(20051500)
- * ⑰ TREE GRATE WITH CONCRETE BANDING ,(X0539800)
- * ⑱ CONCRETE PAVER SIDEWALK ,(LR4300050)

* SEE LANDSCAPE PLANS FOR DETAILS

FILE NAME = 3737_167S01.DGN	USER NAME = bkrovets	DESIGNED - BS	REVISED -	STATE OF ILLINOIS DEPARTMENT OF TRANSPORTATION	TYPICAL SECTIONS SUMMIT AVENUE			F.A. RTE.	SECTION	COUNTY	TOTAL SHEETS	SHEET NO.
		DRAWN -	REVISED -		SCALE:	SHEET	1	OF 2	SHEETS	STA.	TO STA.	ILLINOIS FED. AID PROJECT
		CHECKED - JCK	REVISED -									CONTRACT NO. 63723
		DATE -	REVISED -									