

- LEGEND**
- TW= TOP OF WALL ELEVATION
  - BW= BOTTOM OF WALL ELEVATION
  - R= RIM ELEVATION
  - T/P= TOP OF PLANTER
  - X.XX SLOPE
  - X XX.XX SURFACE ELEVATION
  - XX.XX CURB ELEVATION
  - XX.XX FLOW LINE ELEVATION
  - REVERSE PITCH GUTTER
  - STANDARD PITCH GUTTER
  - SUMMIT POINT
  - SLOPE BREAK LINE
  - LIMIT OF CONSTRUCTION

- NOTES:**
1. THE LIMITS OF PROPOSED DEPRESSED OR MOUNTABLE CURB ACROSS EXISTING DRIVEWAYS SHOULD MATCH EXISTING.
  2. ADD 600 TO ALL PROPOSED ELEVATIONS SHOWN TO OBTAIN USGS ELEVATION.

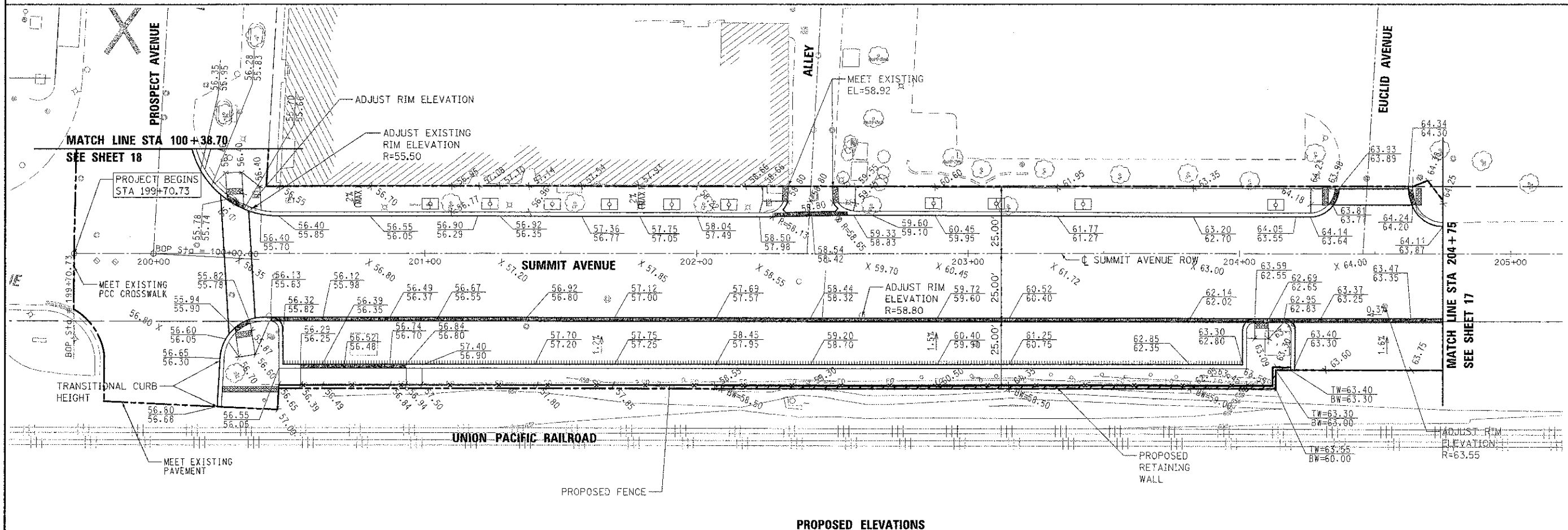

FILE NAME = 3737_16DRBLDGN	USER NAME = bkrevets	DESIGNED - BS	REVISED -	<b>STATE OF ILLINOIS DEPARTMENT OF TRANSPORTATION</b>	<b>PROPOSED AND EXISTING ELEVATIONS PLAN SUMMIT AVENUE</b>				F.A. RTE.	SECTION	COUNTY	TOTAL SHEETS	SHEET NO.
	PLOT SCALE = 1:20	DRAWN -	REVISED -		SCALE: 1"=20'	SHEET 1 OF 3 SHEETS	STA. 199+70	TO STA. 204+75	10-00149-00-LS	COOK	69	16	
	PLOT DATE = 4/8/2013	CHECKED - JCK	REVISED -						<b>CONTRACT NO. 63723</b>				
		DATE -	REVISED -						[ILLINOIS] FED. AID PROJECT				