

PARK RIDGE PUBLIC LIBRARY

MATCH LINE STA. 100+50

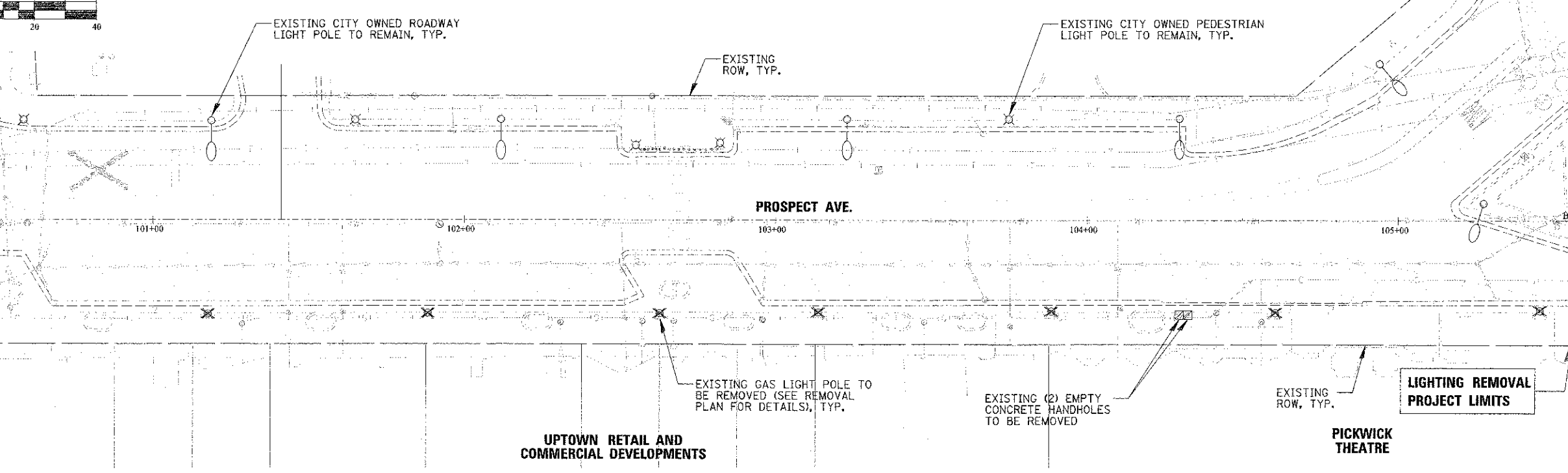

REMOVAL LEGEND

- EXISTING CITY OF PARK RIDGE OWNED ROADWAY LIGHT POLE
- EXISTING CITY OF PARK RIDGE OWNED PEDESTRIAN LIGHT POLE
- EXISTING CITY OF PARK RIDGE OWNED GAS LIGHT POLE
- EXISTING COMBINATION TRAFFIC SIGNAL/LIGHT POLE TO REMAIN
- INDICATES EXISTING ITEMS TO BE REMOVED
- EXISTING ELECTRIC
- EXISTING CABLES/CONDUIT TO BE ABANDONED
- EXISTING SANITARY SEWER
- EXISTING STORM SEWER
- EXISTING WATERMAIN
- EXISTING OVERHEAD WIRES
- EXISTING GAS LINE

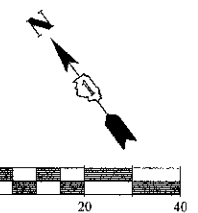

NOTES:

1. CONTRACTOR SHALL REMOVE LIGHT POLE AT THE LOCATION SHOWN ON PLANS AND RETURN TO THE CITY OF PARK RIDGE PUBLIC WORKS. ALL ELECTRIC CABLES CONNECTED TO EXISTING LIGHT POLES SHALL BE DISCONNECTED AT POWER SOURCE AND ABANDONED IN THE CONDUIT. POLE SHALL NOT BE REMOVED UNTIL PROPOSED LIGHTING IS INSTALLED AND OPERATIONAL.
2. EXISTING CONDUIT & CABLES SHALL BE DISCONNECTED AND REMOVED TO 1 FT. BELOW GRADE AND ABANDONED IN ACCORDANCE WITH ARTICLE 842 OF THE STANDARD SPECIFICATIONS. THE CONTRACTOR MAY ELECT TO REMOVE EXISTING CABLES AND SALVAGE AT NO ADDITIONAL COST TO THE OWNER.

MATCH LINE STA. 100+50

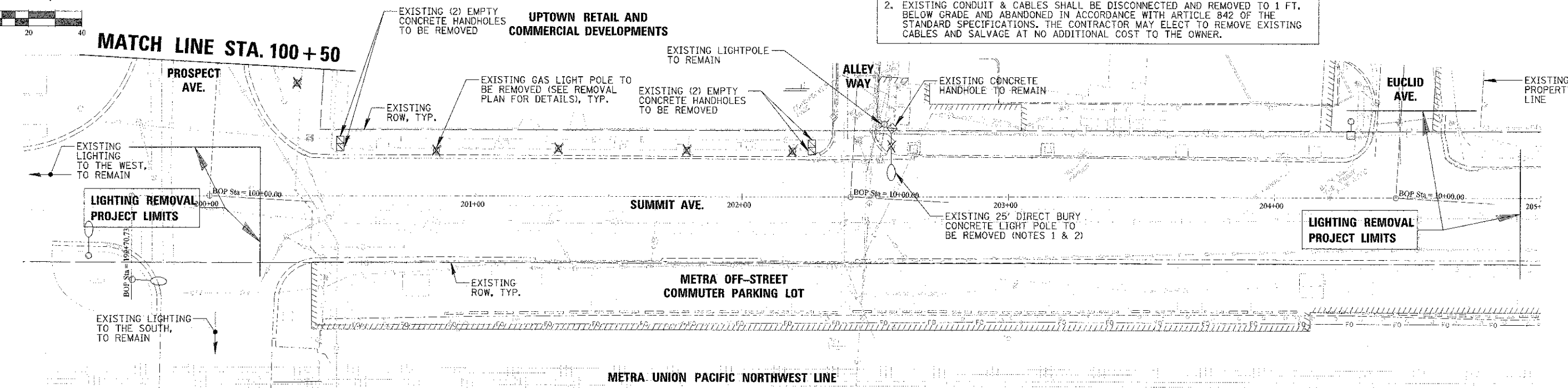

CHRISTOPHER B. BURKE ENGINEERING, LTD.
 9576 W. Higgins Road, Suite 600
 Rosemont, Illinois 60018
 (647) 823-0500

FILE NAME - RZ_L07_100352.dwg	USER NAME - eburke	DESIGNED - A.J.D.	REVISED -	STATE OF ILLINOIS DEPARTMENT OF TRANSPORTATION	LIGHTING REMOVAL PLAN (1 OF 1) PROSPECT AVENUE	F.A. RTE. -	SECTION -	COUNTY -	TOTAL SHEETS -
		DRAWN - K.B., K.W.B.	REVISED -			10-00149-00-LS	COOK	69	40
		CHECKED - A.J.D.	REVISED -						
		DATE - 8/14/2012	REVISED -						
					SCALE: 1"=20'	SHEET	OF	SHEETS	STA. TO STA.
									CONTRACT NO. 63723
									(ILLINOIS) FED. AID PROJECT