

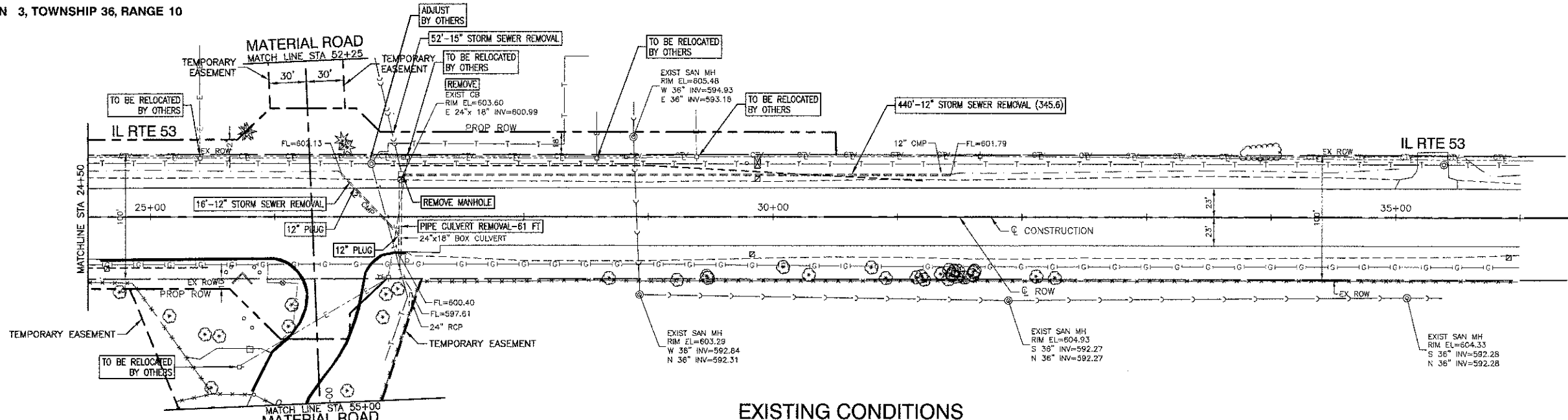

DATE	BY	REVIEWED	CHECKED
PLAN	NOTE BOOK	ALIGNED	FILE NAME

DATE	BY	REVIEWED	CHECKED
PROFILE	NOTE BOOK	GRADES	NOTED



- 3 121'-15" RCP SST1 @ 0.40% (14.6)
- 4 92'-18" RCP SST1 @ 0.40%
- 6 30'-15" RCP SST1 @ 1.48
- 7 93' EQUIVALENT 24" (30"x19") RCP SST1 @ 0.94% (10.1)

**NOTES**

1. ALL OFFSETS AND ELEVATIONS TO CURB LINE STRUCTURES ARE GIVEN TO THE EDGE OF PAVEMENT. OFFSETS AND ELEVATIONS FOR FLARED END SECTIONS ARE GIVEN AT THE FLARED END. ALL OTHER OFFSETS AND ELEVATIONS ARE GIVEN TO THE CENTER OF THE STRUCTURE.
2. (XX.X) DENOTES CUBIC YARDS TRENCH BACKFILL.
3. ALL 4" PIPE UNDERDRAIN SHALL BE INSTALLED 1 FT INSIDE AND 1 FT BELOW THE OUTSIDE EDGE OF AGGREGATE SUBGRADE IMPROVEMENT, 12"
4. THE GENERAL CONTRACTOR IS REQUIRED TO HIRE AN ENVIRONMENTAL FIRM WITH AT LEAST FIVE (5) DOCUMENTED LEAVING UNDERGROUND STORAGE TANK CLEANUPS OR THAT IS PRE-QUALIFIED IN HAZARDOUS WASTE BY THE DEPARTMENT TO REMEDIATE THE SOIL CONTAMINATION AND MONITOR FOR WORKER PROTECTION.

**BENCH MARK:**

2 NAILS IN EAST FACE OF 9TH POWER POLE NORTH OF TAYLOR ROAD, ON WEST SIDE OF ROUTE 53. ELEVATION=605.76

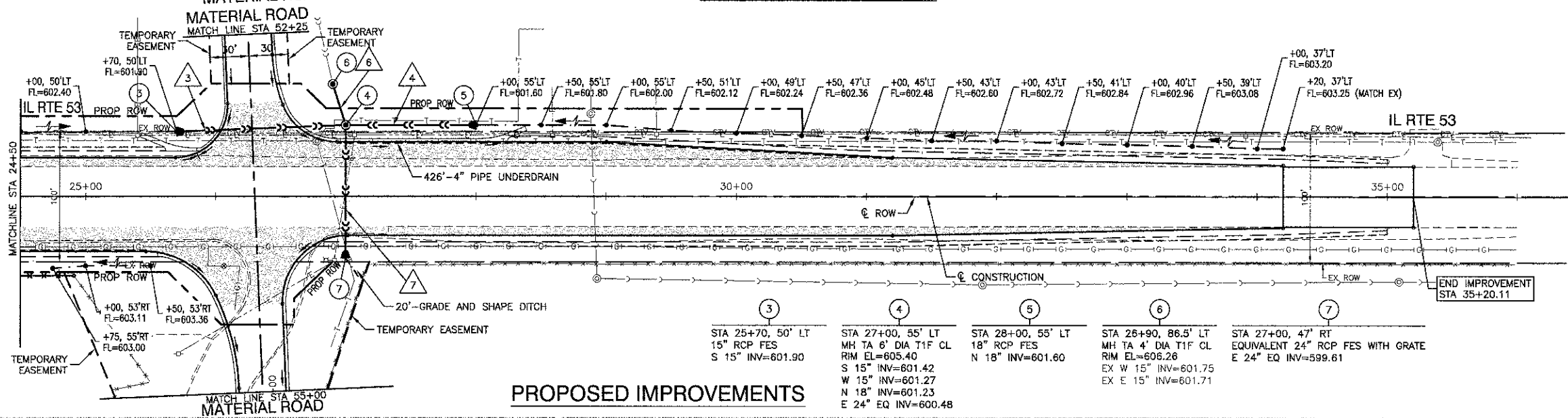

- 3 STA 25+70, 50' LT 15" RCP FES S 15" INV=601.90
- 4 STA 27+00, 55' LT MH TA 6" DIA T1F CL RIM EL=605.40 S 15" INV=601.42 W 15" INV=601.27 N 18" INV=601.23 E 24" EQ INV=600.48
- 5 STA 28+00, 55' LT 18" RCP FES N 18" INV=601.60
- 6 STA 26+90, 86.5' LT MH TA 4" DIA T1F CL RIM EL=608.26 EX W 15" INV=601.75 EX E 15" INV=601.71
- 7 STA 27+00, 47' RT EQUIVALENT 24" RCP FES WITH GRATE E 24" EQ INV=599.61

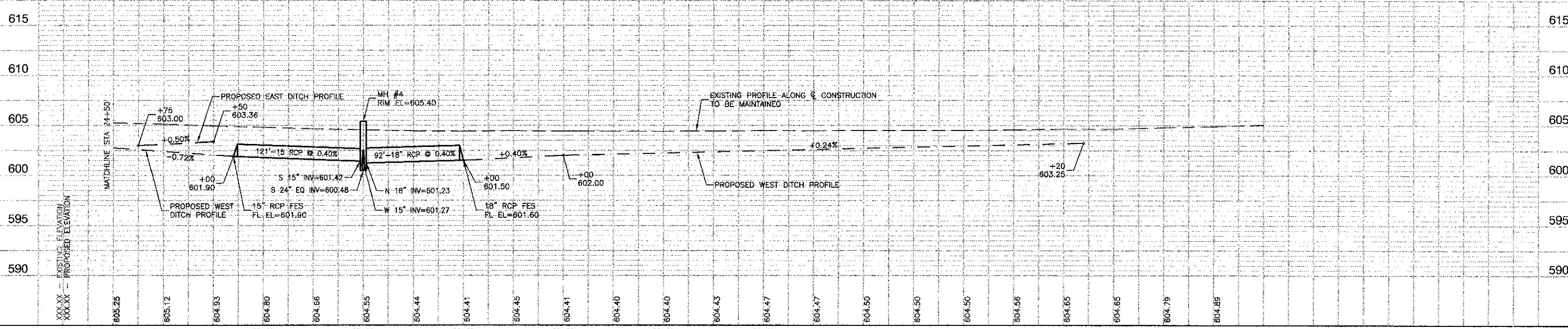

FILE NAME = 08361_02-PLPR-01 - STORM02	USER NAME =	DESIGNED = WPD	REVISED = 01-07-13 - TEMP EASE	STATE OF ILLINOIS DEPARTMENT OF TRANSPORTATION	IL RTE 53 AT MATERIAL ROAD STA 24+50 TO END IMPROVEMENTS DRAINAGE & UTILITIES	F.A.P. RTE = 112	SECTION = 09-00655-00-CH	COUNTY = WILL	TOTAL SHEETS = 54	SHEET NO. = 19	
	PLOT SCALE = 1"=50'	CHECKED = PB	REVISOR =			SCALE: H 1"=50' V 1"=5'	SHEET NO. 19 OF 54 SHEETS	STA. TO STA.	FED. ROAD DIST. NO. 1	ILLINOIS	FED. AID PROJECT M-9003(829)
	PLOT DATE = 02-28-13	DRAWN = AG	REVISOR =			CONTRACT NO. 83753					
		CHECKED = PS	REVISOR =								