

THE FOLLOWING EXISTING TRAFFIC SIGNAL EQUIPMENT SHALL BE REMOVED BY THE CONTRACTOR AND SHALL BE DISPOSED OF OUTSIDE THE RIGHT-OF-WAY AT THEIR EXPENSE. THE SALVAGE VALUE OF THE REMOVED EQUIPMENT SHALL BE REFLECTED IN THE CONTRACT BID PRICE.

- 2 EACH SIGNAL HEAD, 1-FACE 3-SECTION, MAST ARM MOUNTED
- 2 EACH SIGNAL HEAD, 1-FACE 5-SECTION, MAST ARM MOUNTED
- 1 EACH SIGNAL HEAD, 1-FACE 3-SECTION, BRACKET MOUNTED
- 7 EACH SIGNAL HEAD, 1-FACE 5-SECTION, BRACKET MOUNTED
- 1 EACH ECONOLITE CONTROLLER AND TYPE IV CABINET
- 4 EACH 2-CHANNEL LOOP DETECTOR AMP
- 2 EACH LUMINAIRE, SODIUM VAPOR, HORIZONTAL MOUNT, 310 WATT
- 2 EACH EMERGENCY VEHICLE PREEMPTION BEACON (1-DIRECTION)
- 1 EACH EMERGENCY VEHICLE PREEMPTION BEACON (2-DIRECTION)
- 2 EACH EMERGENCY VEHICLE PREEMPTION DETECTOR (1-DIRECTION)
- 1 EACH EMERGENCY VEHICLE PREEMPTION DETECTOR (2-DIRECTION)
- 1 EACH EMERGENCY VEHICLE PREEMPTION CARD
- 1 LSUM TRAFFIC SIGNAL CABLING
- 10 EACH TRAFFIC SIGNAL LOAD SWITCHES
- 1 EACH CONFLICT MONITORING UNIT (CMU)
- 2 EACH COMBO MAST ARM POLE AND MAST ARM
- 6 EACH TRAFFIC SIGNAL POLE

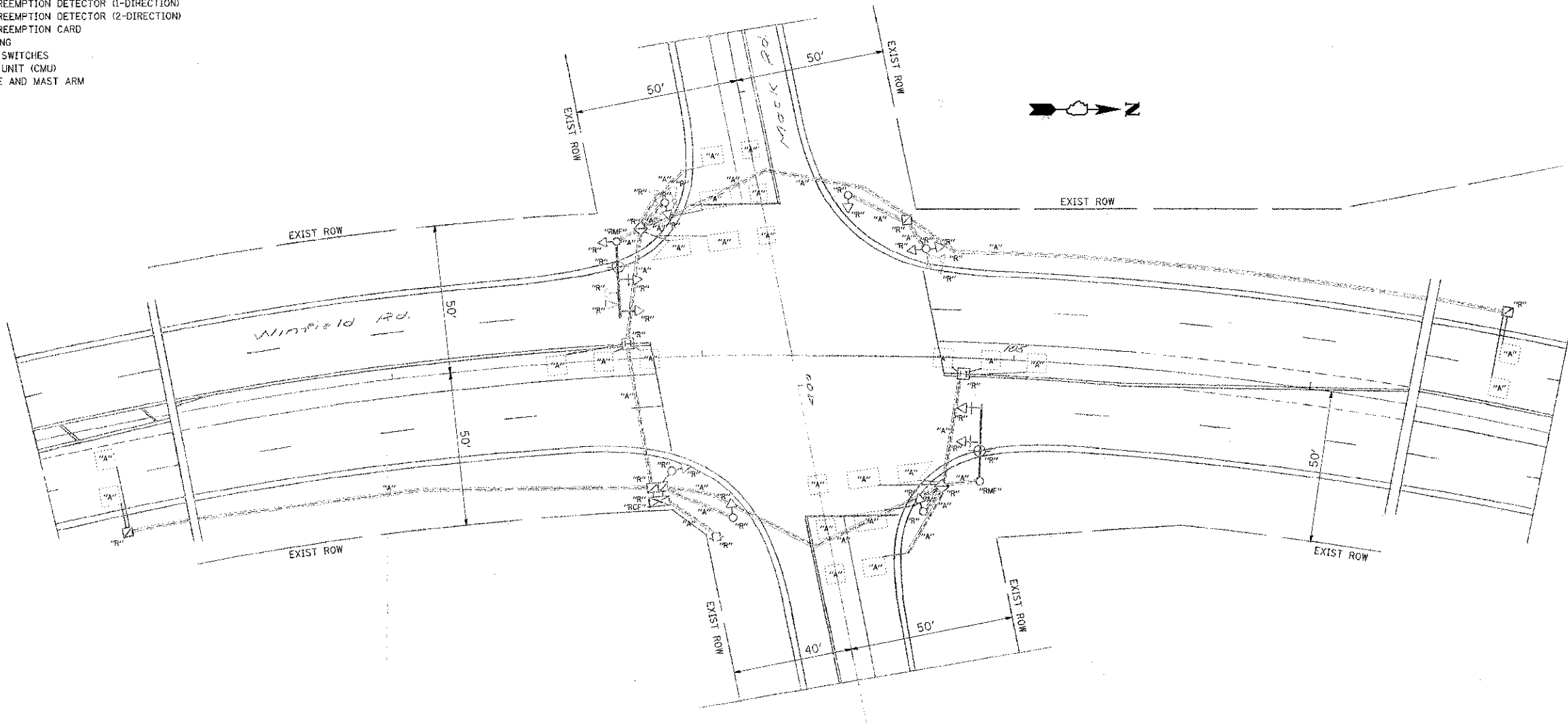

CONSTRUCTION NOTES:

- 1. ALL DETECTOR LOOPS TO BE ABANDONED.
- 2. ALL UNDERGROUND CONDUIT TO BE ABANDONED.

RESTORATION OF WORK AREA. RESTORATION OF THE TRAFFIC SIGNAL WORK AREA SHALL BE INCIDENTAL TO THE RELATED PAY ITEM SUCH AS FOUNDATION, CONDUIT, HANDHOLD, TRENCH AND BACKFILL, ETC. AND NO EXTRA COMPENSATION SHALL BE ALLOWED. ALL ROADWAY SURFACED SUCH AS SHOULDERS, MEDIANS, SIDEWALKS, PAVEMENT, ETC. SHALL BE REPLACED IN KIND. ALL DAMAGE TO MOWED LAWNS SHALL BE REPLACED WITH AN APPROVED SOD. AND ALL DAMAGE TO UNMOWED FIELDS SHALL BE SEEDED IN ACCORDANCE WITH STANDARD SPECIFICATIONS 252 AND 250 RESPECTIVELY.

FILE NAME =	USER NAME = \$USER\$	DESIGNED - BF	REVISED -	STATE OF ILLINOIS DEPARTMENT OF TRANSPORTATION	HLR	EXISTING TRAFFIC SIGNAL & REMOVAL PLAN WINFIELD ROAD & MACK ROAD	SCALE: 1" = 20'	SHEET NO. OF SHEETS STA. TO STA.	F.A.U. RTE.	SECTION	COUNTY	TOTAL SHEET SHEETS, NO.
PA\2012\120123\road\phase 2\dwg\120123-sh	Winfield & Mack-EX traffic signal.dgn	DRAWN - BF	REVISED -						11-00232-06-SP	DUPAGE	21	10
PLOT SCALE = \$SCALE\$		CHECKED - JS	REVISED -						HLR PROJECT NO. 12.0123.350			CONTRACT NO. 63777
PLOT DATE = 12/13/2012		DATE - 12-13-12	REVISED -							ILLINOIS FED. AID PROJECT		