

DATE	
BY	
CHECKED	
DESIGNED	
DRAWN	
IN CHARGE	
PROJECT	
CLIENT	
SCALE	
SHEET NO.	
TOTAL SHEETS	
CONTRACT NO.	

DATE	
BY	
CHECKED	
DESIGNED	
DRAWN	
IN CHARGE	
PROJECT	
CLIENT	
SCALE	
SHEET NO.	
TOTAL SHEETS	
CONTRACT NO.	

NOTES:  
 IRRIGATION PIPING SHALL BE FIELD LOCATED TO AVOID IMPACTS TO TREES, WETLAND AREAS OR OTHER OBSTRUCTIONS  
 THE GENERAL CONTRACTOR IS REQUIRED TO HIRE AN ENVIRONMENTAL FIRM WITH AT LEAST FIVE (5) DOCUMENTED LEAKING UNDERGROUND STORAGE TANK CLEANUPS OR THAT IS PRE-QUALIFIED IN HAZARDOUS WASTE BY THE DEPARTMENT TO REMEDIATE THE SOIL CONTAMINATION AND MONITOR FOR WORKER PROTECTION FROM 12+90 TO 16+90.

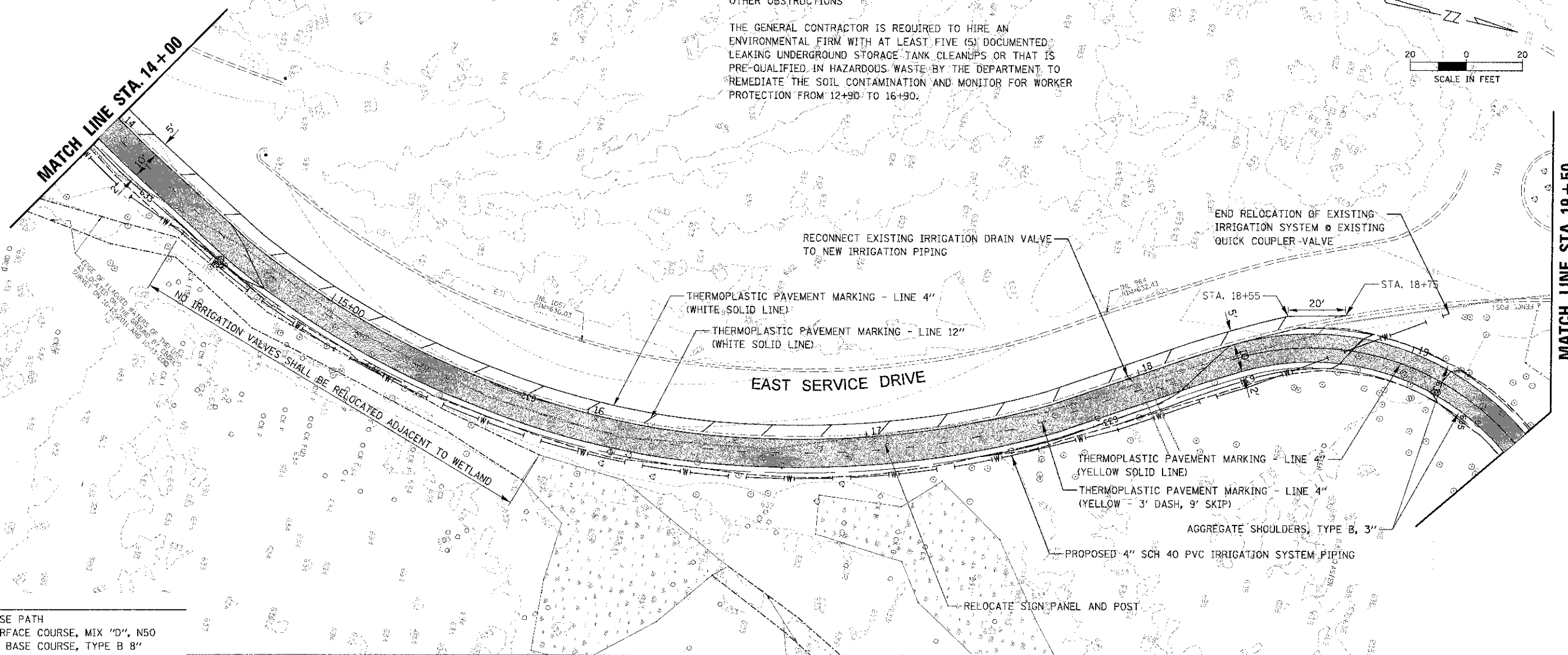
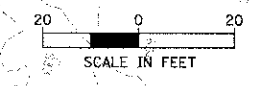

**LEGEND:**

- HMA MULTI-USE PATH  
 - 3" HMA SURFACE COURSE, MIX "D", N50  
 - AGGREGATE BASE COURSE, TYPE B 8"
- HMA PAVING  
 - 2" HMA SURFACE COURSE, MIX "D", N50  
 - HMA BASE COURSE, 6"  
 - AGGREGATE BASE COURSE, TYPE B 4"
- PORTLAND CEMENT CONCRETE SIDEWALK 5 INCH

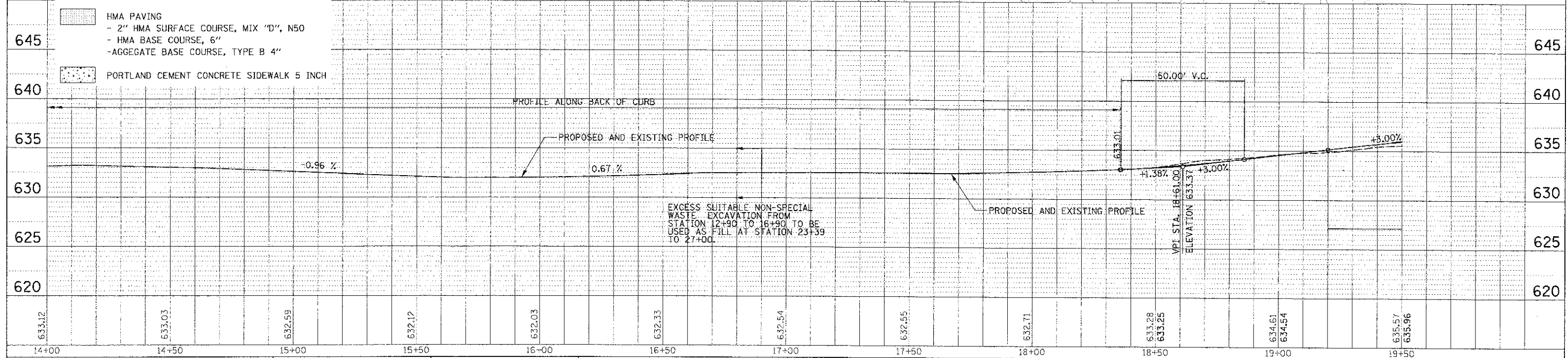

	9575 W. Higgins Road, Suite 600 Rosemont, Illinois 60018 (847) 823-0500	DESIGNED - MBT DRAWN - PWN CHECKED - MEK DATE - 4/11/13	REVISED - REVISED - REVISED - REVISED -	<b>STATE OF ILLINOIS</b> <b>DEPARTMENT OF TRANSPORTATION</b>	<b>LAKE COOK ROADWORTH BRANCH BICYCLE TRAIL EXTENSION</b> <b>PROPOSED PLAN AND PROFILE</b>	E.A.U. R.T.E. 3726 10-F3000-22-B7	COUNTY COOK/LAKE CONTRACT NO. 63781	TOTAL SHEETS 89 SHEET NO. 19
	FILE NAME: I:\BPI\110459_02.S11		SCALE: 1" = 20' SHEET NO. OF SHEETS STA. TO STA.		ILLINOIS FED. AID PROJECT			